



00213284

RECEIVED

JAN 9 1975

COLO. OIL & GAS CONS. COMM.

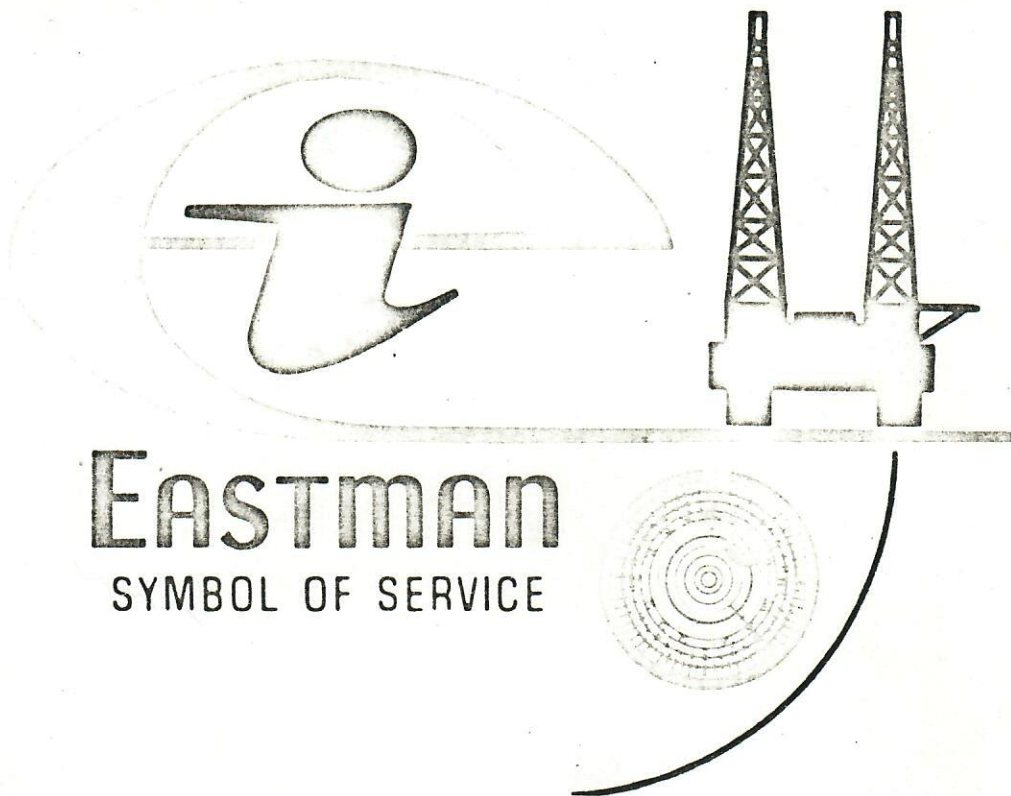

**EASTMAN**  
SYMBOL OF SERVICE

# SURVEY REPORT

**EASTMAN OIL WELL SURVEY COMPANY**

*File*

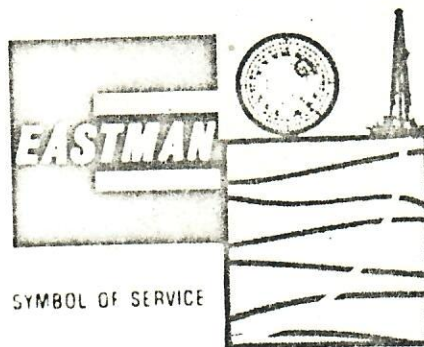

# REPORT of SUB-SURFACE DIRECTIONAL SURVEY

Trend Exploration Limited  
COMPANY

Deakins #1  
WELL NAME

Craig, Colorado  
LOCATION

JOB NUMBER

TM-5773-D30 &  
TM-8073-S26

TYPE OF SURVEY

Single Shot & DMS

DATE

SURVEY BY  
Dilsaver & Moreland

OFFICE  
Rocky Mtn.

PLAN

**EASTMAN**  
OIL WELL  
SURVEY COMPANY

**RECEIVED**

APR 29 1974

OIL & GAS CONS. COMM.



DEPTH 8259.00'  
NORTH 691.68'  
WEST 271.42'

N 21° 26' W

742.76'

6086'

4884'

3832'

SURFACE

Well - Deakins #1

JOB NO. SS



## SURVEY TABULATION SHEET

TREND EXPLORATION LIMITED  
% MINERALS MANAGEMENT INC.

STOMER

LL NO. DEAKINS No. 1

LD SOUTH CRAIG  
MOFFAT COUNTY, COLORADO

GYROSCOPIC MULTISHOT

SHEET NO. 1 OF 3

SURVEY  
JOB NO. SU3-11935

SURVEY  
DATE JULY 17, 1973

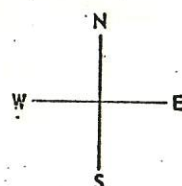

RECTED TIME	MEASURED DEPTH		VERTICAL DEPTH		ANGLE OF INCLINATION	COURSE DEV.	DIRECTION OF INCLINATION						MEASURED COURSE DISPLACEMENT				TOTAL DISPLACEMENT			
	COURSE	TOTAL	COURSE	TOTAL			OBSERVED		CORR.	CORRECTED		NORTH	SOUTH	EAST	WEST	NORTH	SOUTH	EAST	WEST	
		0																		
0-00	100	100	100.00	100.00	1/4°					N	04	E	.43		.03		.43	.03		
1-20	100	200	100.00	200.00	0					-----					.43		.03			
3-00	100	300	100.00	300.00	1/4°					S	37	W		.35		.26	.08	.23		
4-20	100	400	100.00	400.00	1/2°					S	25	W		.79		.37		.60		
5-00	100	500	99.99	499.99	3/4°					S	24	W		1.20		.53	1.91	1.13		
6-40	100	600	99.99	599.98	3/4°					S	24	W		1.20		.53	3.11	1.66		
7-00	100	700	99.98	699.98	1°					S	41	W		1.32		1.14	4.43	2.80		
8-20	100	800	99.98	799.94	1 1/4°					S	38	W		1.72		1.34	6.15	4.14		
9-00	100	900	99.98	899.92	1 1/4°					S	21	W		2.04		.78	8.19	4.92		
10-40	100	1000	99.97	999.89	1 1/2°					S	26	W		2.35		1.15	10.54	6.07		
11-00	100	1100	99.97	1099.86	1 1/2°					S	26	W		2.35		1.15	12.89	7.22		
12-20	100	1200	99.97	1199.83	1 1/2°					S	26	W		2.35		1.15	15.24	8.37		
13-00	100	1300	99.98	1299.81	1 1/4°					S	40	W		1.67		1.40	16.91	9.77		
14-40	100	1400	99.95	1399.76	3/4°					S	25	W		2.77		1.29	19.68	11.06		
15-00	100	1500	99.97	1499.73	1 1/2°					S	20	W		2.46		.90	22.14	11.96		
16-20	100	1600	99.98	1599.71	1 1/4°					S	22	W		2.02		.82	24.16	12.78		
17-00	100	1700	99.97	1699.68	1 1/2°					S	22	W		2.43		.98	26.59	13.76		
18-20	100	1800	99.95	1799.63	3/4°					S	32	W		2.59		1.62	29.18	15.38		
19-40	100	1900	99.95	1899.58	3/4°					S	21	W		2.85		1.09	32.03	16.47		
20-20	100	2000	99.94	1999.52	2°					S	27	W		3.11		1.58	35.14	18.05		
21-00	100	2100	99.94	2099.46	2°					S	29	W		3.05		1.69	38.19	19.74		
22-20	100	2200	99.94	2199.40	2°					S	34	W		2.89		1.95	41.08	21.69		
23-40	100	2300	99.90	2299.30	2 1/2°					S	27	W		3.89		1.98	44.97	23.67		
24-00	100	2400	99.90	2399.20	2 1/2°					S	30	W		3.78		2.18	48.75	25.85		
25-20	100	2500	99.86	2499.06	3°					S	30	W		4.53		2.62	53.28	28.47		
26-00	100	2600	99.86	2598.92	3°					S	28	W		4.62		2.46	57.90	30.93		
27-00	100	2700	99.84	2698.76	3 1/4°					S	30	W		4.91		2.83	62.81	33.76		
28-00	100	2800	99.84	2798.60	3 1/4°					S	30	W		4.91		2.83	67.72	36.59		
29-00	100	2900	99.84	2898.44	3 1/4°					S	33	W		4.75		3.09	72.47	39.68		
BY: <i>MRC</i>	<i>MRC</i>	<i>MRC</i>	<i>MRC</i>	<i>MRC</i>	<i>MRC</i>					<i>MRC</i>			<i>MRC</i>	<i>MRC</i>	<i>MRC</i>	<i>MRC</i>	<i>MRC</i>	<i>MRC</i>		
<i>MM</i>	<i>MM</i>	<i>MM</i>	<i>MM</i>	<i>MM</i>	<i>MM</i>					<i>MM</i>			<i>MM</i>	<i>MM</i>	<i>MM</i>	<i>MM</i>	<i>MM</i>	<i>MM</i>		



## SURVEY TABULATION SHEET

TREND EXPLORATION LIMITED  
CUSTOMER % MINERALS MANAGEMENT INC.

WELL NO. PEAKINS No. 1

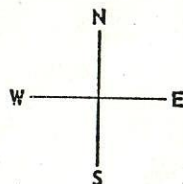
FIELD SOUTH CRAIG  
MOFFAT COUNTY, COLORADO

SHEET NO. 2 OF 3

SURVEY  
JOB NO. MS-11935SURVEY  
DATE JULY 17, 1973

## GYROSCOPIC MULTISHOT

CORRECTED TIME	MEASURED DEPTH		VERTICAL DEPTH		ANGLE OF INCLIN- ATION	COURSE DEV.	DIRECTION OF INCLINATION			MEASURED COURSE DISPLACEMENT				TOTAL DISPLACEMENT			
	COURSE	TOTAL	COURSE	TOTAL			OBSERVED	CORR.	CORRECTED	NORTH	SOUTH	EAST	WEST	NORTH	SOUTH	EAST	WEST
77-20	100	3000	99.84	2998.28	3 1/4°				S 29 W		4.96		2.75		77.43		42.43
78-40	100	3100	99.84	3098.12	3 1/4°				S 24 W		5.18		2.31		82.61		44.74
80-00	100	3200	99.86	3197.98	3°				S 27 W		4.66		2.38		87.27		47.12
81-20	100	3300	99.86	3297.84	3°				S 26 W		4.70		2.29		91.97		49.41
82-40	100	3400	99.86	3397.70	3°				S 23 W		4.82		2.05		96.79		51.46
84-00	100	3500	99.88	3497.58	2 3/4°				S 20 W		4.51		1.64		101.30		53.10
85-20	100	3600	99.86	3597.44	3°				S 15 W		5.06		1.35		106.36		54.45
86-40	100	3700	99.86	3697.30	3°				S 19 W		4.95		1.70		111.31		56.15
88-00	100	3800	99.86	3797.16	3°				S 17 W		5.01		1.53		116.32		57.68
89-20	100	3900	99.79	3896.95	3 3/4°				S 18 W		6.22		2.02		122.54		59.70
91-00	100	4000	99.79	3996.74	3 3/4°				S 20 W		6.15		2.24		128.69		61.94
97-00	100	4100	99.76	4096.50	4°				S 19 W		6.60		2.27		135.29		64.21
98-20	100	4200	99.69	4196.19	4 1/2°				S 17 W		7.50		2.29		142.79		66.50
100-00	100	4300	99.62	4295.81	5°				S 15 W		8.42		2.26		151.21		68.76
101-20	100	4400	99.62	4395.43	5°				S 16 W		8.38		2.40		159.59		71.16
102-20	100	4500	99.58	4495.01	5 1/4°				S 14 W		8.88		2.21		168.47		73.37
103-40	100	4600	99.50	4594.51	5 3/4°				S 15 W		9.68		2.59		178.15		75.96
105-00	100	4700	99.54	4694.05	5 1/2°				S 13 W		9.34		2.16		187.49		78.12
106-00	100	4800	99.45	4793.50	6°				S 14 W		10.14		2.53		197.63		80.65
107-20	100	4900	99.36	4892.86	6 1/2°				S 12 W		11.07		2.35		208.70		83.00
108-40	100	5000	99.25	4992.11	7°				S 10 W		12.00		2.12		220.70		85.12
110-00	100	5100	99.20	5091.31	7 1/4°				S 09 W		12.46		1.97		233.16		87.09
111-20	100	5200	99.25	5190.56	7°				S 11 W		11.96		2.33		245.12		89.42
117-20	100	5300	99.20	5289.76	7 1/4°				S 11 W		12.39		2.41		257.51		91.83
118-40	100	5400	99.25	5389.01	7°				S 13 W		11.87		2.74		269.38		94.57
120-20	100	5500	99.31	5488.32	6 3/4°				S 12 W		11.50		2.44		280.88		97.01
121-40	100	5600	99.36	5587.68	6 1/2°				S 14 W		10.98		2.74		291.86		99.75
123-00	100	5700	99.25	5686.93	7°				S 07 W		12.10		1.49		303.96		101.24
124-20	100	5800	99.14	5786.07	7 1/2°				S 02 W		13.05		.46		317.01		101.70
125-20	100	5900	99.14	5885.21	7 1/2°				S 05 W		13.00		1.14		330.01		102.84
NE BY:	MAN	MAN	MAN	MAN	MAN				MAN		MAN		MAN		MAN		MAN
BY:	MAN	MAN	MAN	MAN	MAN				MAN		MAN		MAN		MAN		MAN



**SURVEY TABULATION SHEET**

TREND EXPLORATION LIMITED  
% MINERALS MANAGEMENT INC.

## ISOMER

DEAKINS No. 1

LL NO.

SOUTH CRAIG

MOFFAT COUNTY, COLORADO

LD

GYROSCOPIC MULTISHOT

SHEET NO. 3 OF 3

SURVEY  
JOB NO. SU3-11935

SURVEY  
DATE JULY 17, 1973

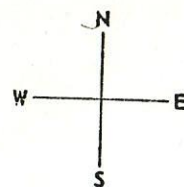

RECTED TIME	MEASURED DEPTH		VERTICAL DEPTH		ANGLE OF INCLIN- ATION	COURSE DEV.	DIRECTION OF INCLINATION						MEASURED COURSE DISPLACEMENT				TOTAL DISPLACEMENT			
	COURSE	TOTAL	COURSE	TOTAL			OBSERVED	CORR.	CORRECTED		NORTH	SOUTH	EAST	WEST	NORTH	SOUTH	EAST	WEST		
07-00	100	6000	99.25	5984.46	7°					S	04	W		12.16		.85		342.17		103.69
08-20	100	6100	99.36	6083.82	6½°					S	06	W		11.26		1.18		353.43		104.87
01-00	100	6200	99.20	6183.02	7¼°					S	06	W		12.55		1.32		365.98		106.19
07-40	100	6300	99.03	6282.05	8°					S	03	W		13.90		.73		379.88		106.92
09-00	100	6400	98.56	6380.61	9¼°					S	05	W		16.87		1.48		396.75		108.40
0-40	100	6500	98.25	6478.86	10¼°					S	10	W		18.37		3.24		415.12		111.64
2-00	100	6600	98.16	6577.02	11°					S	10	W		18.79		3.31		433.91		114.95
3-20	100	6700	98.08	6675.10	11¼°					S	17	W		18.66		5.70		452.57		120.65
5-00	100	6800	98.08	6773.18	11¼°					S	15	W		18.84		5.05		471.41		125.70
6-20	100	6900	97.81	6870.99	12°					S	17	W		19.88		6.08		491.29		131.78
8-00	100	7000	97.72	6968.71	12¼°					S	15	W		20.50		5.49		511.79		137.27
9-20	100	7100	97.44	7066.15	13°					S	20	W		21.14		7.69		532.93		144.96
0-40	100	7200	96.48	7162.63	15¼°					S	15	W		25.41		6.81		558.34		151.77
2-00	100	7300	96.13	7258.76	16°					S	20	W		25.90		9.43		584.24		161.20
3-00	100	7400	96.59	7355.35	15°					S	22	W		24.00		9.70		608.24		170.90

HORIZONTAL DISPLACEMENT = 631.79 FEET AT SOUTH 15° 42' WEST

BY:

 $Y =$





# RECORD OF SURVEY

Deakins #1

RM-5773-D30 &

JOB NO. RM-8073-S26

DATE

Page 1 of 3

CHECKED BY

STATION	MEASURED DEPTH	DRIFT ANGLE	TRUE VERTICAL DEPTH		COURSE DEVIATION		DRIFT DIRECTION	RECTANGULAR COORDINATES							
								NORTH		SOUTH		EAST		WEST	
	3100	3°15'	3098	12			S24W			82	61			44	74
	3120	3°			1	05	S18W			83	61			45	06
	3188	45'				89	S62W			84	03			45	85
	3218	3°			1	57	N41E			82	85			44	82
	3273	5°15'			5	03	N55E			79	96			40	70
	3305	5°45'			3	21	N58E			78	26			37	98
	3367	8°30'	3363	99	9	16	N40E			71	24			32	09
	3409	10°45'			7	83	N29E			64	39			28	29
	3438	11°30'			5	78	N28E			59	29			25	58
	3488	11°45'	3482	60	10	18	N10E			49	26			23	81
	3551	11°45'			12	83	N07E			36	53			22	25
	3608	14°15'			14	03	North			22	50			22	25
	3677	18°15'			21	61	N05W				97			24	13
	3739	18°30'			19	67	N05W	18	63					25	84
	3832	18°15'	3812	18	29	12	N04W	47	68					27	87
	3927	18°	3902	53	29	36	N05W	76	93					30	43
	4014	18°15'			27	25	N04W	104	11					32	33
	4108	18°			29	05	N05W	133	05					34	86
	4200	17°	4162	53	26	90	N08W	159	69					38	60
	4289	17°30'			26	76	N08W	186	19					42	32
	4413	18°	4365	34	38	32	N09W	224	04					48	31
	4537	18°45'	4482	76	39	86	N07W	263	60					53	17
	4664	19°	4602	84	41	35	N06W	304	72					57	49
	4757	19°	4690	77	30	28	N04W	334	93					59	60
	4884	19°45'	4810	30	42	92	N03W	377	79					61	85
	5018	20°	4936	22	45	83	N01W	423	61					62	65
	5112	20°15'	5024	41	32	54	N02W	456	13					63	79





# RECORD OF SURVEY

Deakins #1

RM-5773-D30 &

RM-8073-S26

JOB NO.

DATE

Page 2 of 3

CHECKED BY \_\_\_\_\_

STATION	MEASURED DEPTH	DRIFT ANGLE	TRUE VERTICAL DEPTH		COURSE DEVIATION		DRIFT DIRECTION	RECTANGULAR COORDINATES							
								NORTH		SOUTH		EAST		WEST	
	5207	20°45'	5113	25	33	66	N01E	489	78					63	20
	5300	21°45'	5199	63	34	46	N13W	523	36					70	95
	5427	21°15'	5317	99	46	03	N15W	567	82					82	86
	5520	20°45'	5404	96	32	95	N14W	599	79					90	81
	5678	20°	5553	43	54	04	N11W	652	84					101	12
	5835	19°45'	5701	19	53	05	N10W	705	08					110	33
	5992	19°30'	5849	18	52	41	N06W	757	20					115	81
	6086	18°45'	5938	19	30	22	N04W	787	35					117	92
	6241	18°	6085	60	47	90	N02W	835	22					119	59
	6398	17°	6235	74	45	90	N02E	881	09					117	99
	6571	16°	6402	04	47	69	N04E	928	66					114	66
	6630	14°	6459	29	14	27	N01E	942	93					114	41
	6680	12°30'	6508	10	10	82	N03W	953	74					114	98
	6720	10°	6547	49	6	95	N07W	960	64					115	83
63	6803	9°			12	98	N03E	973	60					115	15
61	6894	8°			12	66	North	986	26					115	15
59	6985	3°	6810	46	4	76	N11W	990	94					116	06
57	7076	4°			6	35	S40W	986	08					120	14
55	7167	4°			6	35	S34W	980	82					123	69
53	7258	7°			11	09	S22W	970	54					127	84
51	7349	10°			15	80	S19W	955	60					132	98
48	7440	12°	7260	97	18	92	S23W	938	18					140	37
42	7531	14°			22	01	S24W	918	07					149	32
40	7622	15°			23	55	S24W	896	55					158	90
37	7713	17°			26	61	S25W	872	44					170	14
35	7804	18°			28	12	S27W	847	38					182	91
32	7895	20°	7696	25	31	12	S29W	820	16					198	00





# RECORD OF SURVEY

Deakins #1

RM-5773-D30 &

JOB NO. RM-8073-S26

DATE

Page 3 of 3

CHECKED BY

STATION	MEASURED DEPTH	DRIFT ANGLE	TRUE VERTICAL DEPTH		COURSE DEVIATION		DRIFT DIRECTION	RECTANGULAR COORDINATES							
								NORTH		SOUTH		EAST		WEST	
28	7986	23°			35	56	S29W	789	06					215	24
26	8077	23°			35	56	S29W	757	96					232	48
24	8168	25°			38	46	S30W	724	65					251	71
21	8259	25°	8028	73	38	46	S31W	691	68					271	42
CLOSURE DIRECTION								N21°26'W							
CLOSURE DISTANCE								742.76 feet							





PLAN

EASTMAN  
OIL WELL  
SURVEY COMPANY

DEPTH 8259.00'  
NORTH 691.68'  
WEST 271.42'

N 21° 26' W

742.76'

6985'

6086'

4884'

3832'

SURFACE

Well - Deakins #1

JOB NO. SS



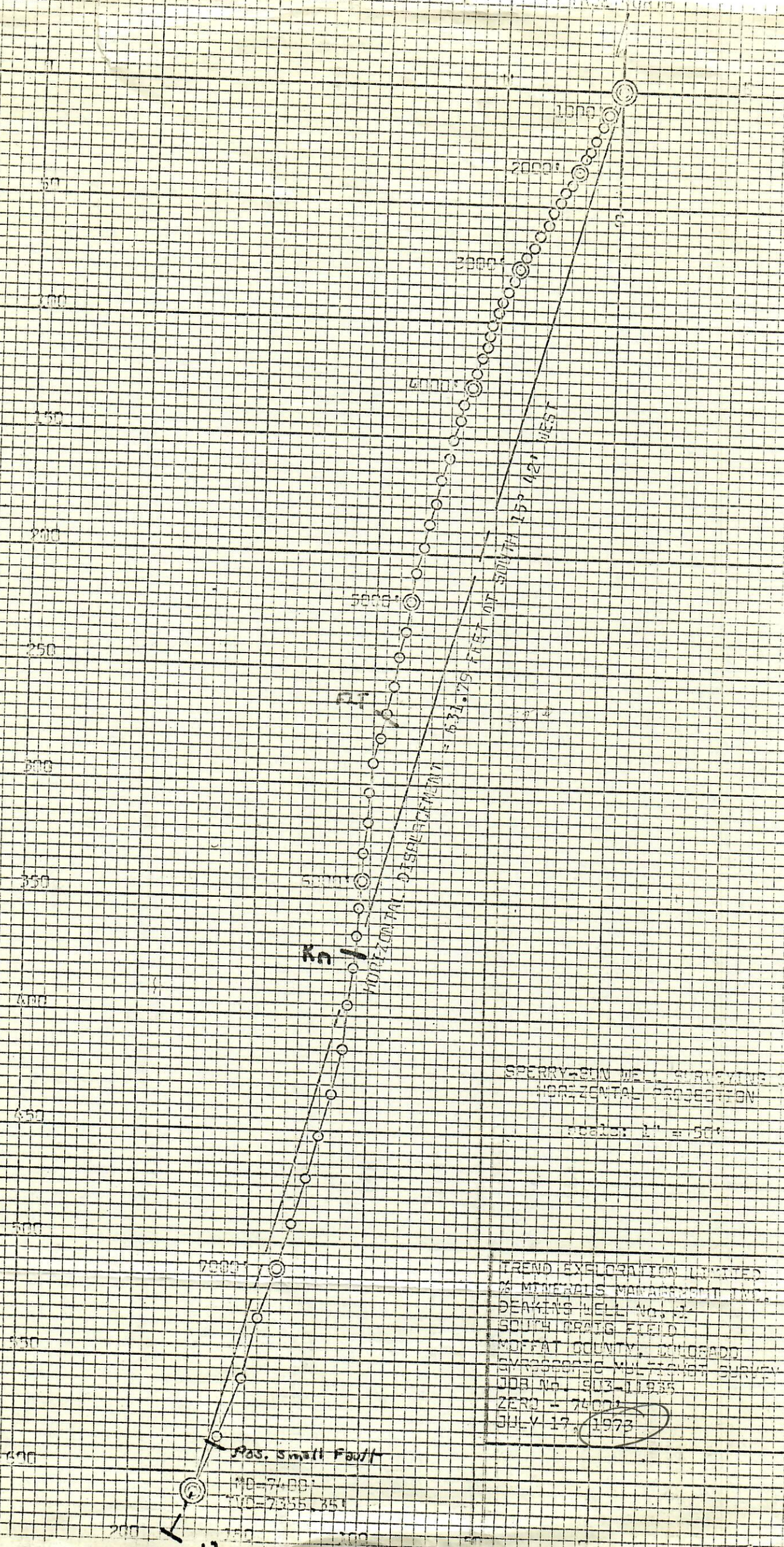

SPERRY-SUN WELL SURVEYING CO.  
HORIZONTAL PROJECTION  
Scale: 1" = 50'

TREND EXPLORATION LIMITED  
X MINERALS MANAGEMENT INC.  
DEAKINS WELL NO. 1  
SOUTH CRAIG FIELD  
MOFFAT COUNTY, COLORADO  
SPERRY-SUN MULTIBOIST SURVEY  
JOB NO. 803-11935  
ZERO - 7400'  
JULY 17, 1973

Pos. Small Fault  
MD-7400'  
TV-7355' 35"

carl hte