



00241530

# Cultural Resource Management Report

MILLER USA #1

Lead Field Investigator Bob Williams

Principal Investigator Marcia J. Tate

Date Aug. 18, 1981 For K & E Petroleum-LeClair Westwood, Inc.

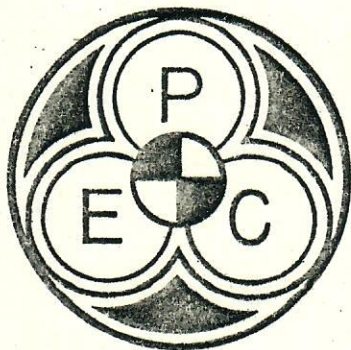

**POWERS ELEVATION**

CHERRY CREEK PLAZA, SUITE 1201  
600 SOUTH CHERRY ST., DENVER, COLORADO 80222  
(303) 321-2217

**Archæology Division**

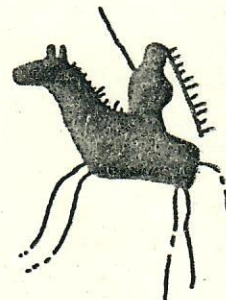

A DIVISION OF PETROLEUM INFORMATION CORPORATION/A SUBSIDIARY OF A.C. NIELSEN COMPANY

45



DEPARTMENT OF THE INTERIOR  
BUREAU OF LAND MANAGEMENT  
COLORADO  
REPORT OF EXAMINATION FOR CULTURAL RESOURCES

2.b. Case File # \_\_\_\_\_  
Oil & Gas Lease \_\_\_\_\_  
Coal: \_\_\_\_\_ Explor.: \_\_\_\_\_  
Lease: \_\_\_\_\_ Right-of-way \_\_\_\_\_  
Other \_\_\_\_\_

1. Abstract: A cultural resource survey for K & E Petroleum-LeClair Westwood, Miller USA #1, well pad and access, Logan County, Colorado; Canon City District Office Bureau of Land Management.
- 2.a. Resource Area: Northeast Resource Area      Planning Unit:  
Location: T 9N R 55W Sec. 8      USGS Quad: Avalo SE, 7.5', 1977  
660' FSL, 660' FEL; SE $\frac{1}{4}$ SE $\frac{1}{4}$
3. Project Description: well pad and access      Size: 20.4 acres - access  
40 acres - well pad and easement  
60.4 acres - total area surveyed  
Topography: The project is located in a rolling grassland terrain east of Pawnee National Grassland and dissected by Spring Creek, an intermittent tributary of the South Platte. Several large depressions collect residual runoff and support swarms of mosquitoes. The area is drained by Spring Creek, a meandering (cont.)  
Vegetation: Cover was estimated at 50% and ground visibility was good. The area supports a plains-grassland community of short grasses, prickly pear, yucca and minor quantities of thistle.
4. Examination Procedure: The cultural resource survey was performed on August 18, 1981, by Robert A. Williams and John Shimmin of Powers Elevation. The procedure consisted of parallel pedestrian transects at 15 meter intervals over the 40 acre primary and secondary impact easement. Approximately 0.5 mile of two-track dirt road and 1.2 miles of flagged right-of-way were surveyed in zig-zag transects to produce a 200 foot access corridor. A file search conducted with the (cont.)
5. Findings: No cultural resources were observed during the field investigation. Numerous coils of barbed wire were noted along the southern fence of Section 8, the remains of ongoing fence maintenance. These were apparently fairly recent (less than 20 years old) and were not recorded.
6. Recommendations:

We recommend no additions or amendments to the proposed K & E Petroleum-LeClair Westwood, Miller USA #1 well location and access. This recommendation is based on the absence of cultural resources in the 40 acre area and 1.7 miles of access.

Permit: 81-CO-232  
(BLM work-job code)

I certify that this examination complies with EO 11593.

August 18, 1981  
Date(s) of Examination

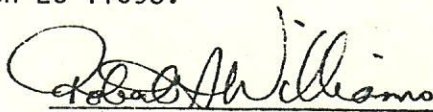
  
Archaeologist/Historian

\_\_\_\_\_  
This report meets (does not meet) applicable standards of acceptability.  
A 106 statement \_\_\_\_ is \_\_\_\_ is not required for this project.

\_\_\_\_\_  
Date

\_\_\_\_\_  
BLM Reviewing Archaeologist/Historian

A clear copy of (or an original of) the USGS Topographic Map of the project and the area surveyed must be attached.

K & E Petroleum-LeClair Westwood  
Miller USA #1  
Page 2

TOPOGRAPHY: intermittent dendritic stream which is the major erosional force in the area. Spring Creek was not flowing at the time of the investigation, but isolated pools were standing in several meanders. The soil is a silty loam-loess with some collected organic material in the depressions.

EXAMINATION PROCEDURE: Colorado Preservation Office on July 27, 1981, revealed no previously recorded cultural resources in the project area.



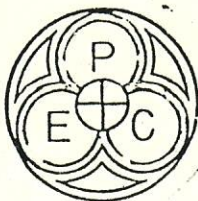

# POWERS ELEVATION

A DIVISION OF PETROLEUM INFORMATION CORP.

K & E PETROLEUM-LECLAIR  
MILLER USA #1 WESTWOOD  
SE/SE SEC 8, T9N, R55W  
LOGAN COUNTY, CO  
ALVO SE QUAD. 7.5' 1977

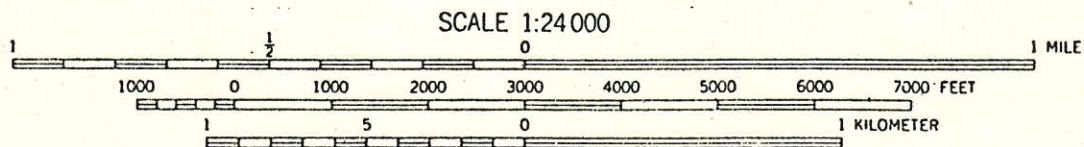
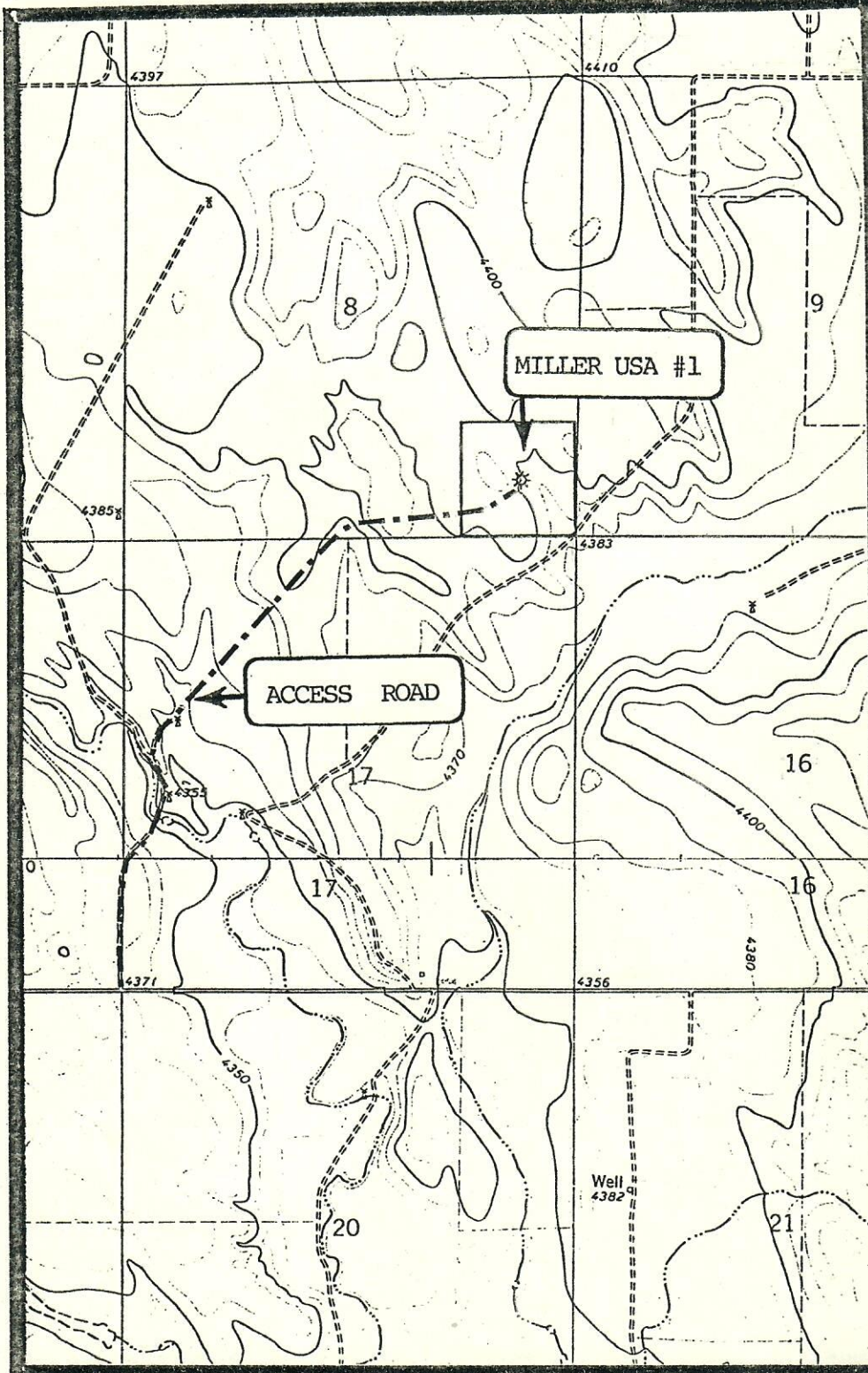

CONTOUR INTERVAL 40 FEET  
DATUM IS MEAN SEA LEVEL.

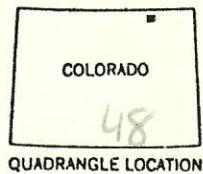



K & E PETROLEUM, INC.  
730 SEVENTEENTH STREET SUITE 801  
DENVER, COLORADO 80202

Exploration  
&  
Production

ROBERT M. WAKEFIELD  
DIVISION EXPLORATION MANAGER

(303) 893-0435

July 16, 1981

LeClair-Westwood, Inc.  
388 Denver Club Building  
Denver, Colorado 80202

RE: K & E Petroleum, Inc.  
#1 Miller - USA  
SE SE Section 8-9N-55W  
Logan County, Colorado

Attn: Lisa Green

K & E Petroleum, Inc. hereby authorizes representatives of your company to act as our agent in preparation and submission to the appropriate governmental agencies for all forms and reports necessary to obtain an approved drilling permit for the captioned well. This includes authorization for you to have the well location staked and for you to enter upon the lease to obtain information for the applicable notice to Lessee letter.

We request that you contact our Mr. Davis in this office before going to the lease so that he may advise the surface owner, Mr. Miller, that you will be acting on our behalf.

Yours very truly,

K & E PETROLEUM, INC.

Robert M. Wakefield  
Vice President-RM Exploration

RMW:km



Lease No.: \_\_\_\_\_; Well Name and No.: K & E Petroleum, Inc. - Miller #1

Location: SE<sup>1</sup>/<sub>4</sub>SE<sup>1</sup>/<sub>4</sub>, Sec. 8; T 9 N., R 55 W, Logan County Colorado.

K & E Petroleum, Inc. intends to drill a well on surface owned by

Albert & Ethel Mae Miller. The lessee/operator agrees to complete the following rehabilitation work if the well is a producer:

☒ Yes ☐ No Maintain access road and provide adequate drainage to road.

☒ Yes ☐ No Reshape and reseed any area in excess of the pump and support facilities.

Other requirements: Fence pump, tank battery and other facilities to keep cattle out

The following work will be completed when the well is abandoned:

☒ Yes ☐ No Site will require reshaping to conform to existing topography.

☐ Yes ☒ No Pit will be fenced until dry, then filled to conform to topography.

☐ Yes ☒ No Entire disturbed area will be reseeded. If yes, the following seed mixture will be used:

Reseeding to be done by surface owner.

☐ Yes ☒ No Access road will be rehabilitated and reseeded using the same seed mixture as above.

☒ Yes ☐ No Access road will remain for landowner's use.

Other requirements: \_\_\_\_\_

Landowner

Name: Albert and Ethel Mae Miller

Address Route 3

City, State & Zip Sterling, Colorado 80751

Telephone: (303) 522-4336

Operator/Lessee

Name: K & E Petroleum, Inc.

Address 730 - 17th St., Suite 801

City, State & Zip Denver, Colorado 80202

Telephone: (303) 893-0493

This agreement covers rehabilitation requirements only and does not affect any other agreements between the lessee/operator and surface owner.

Albert & Ethel Mae Miller  
Landowner

K & E Petroleum, Inc.  
Operator-Lessee

August 12, 1981  
Date

August 12, 1981  
Date

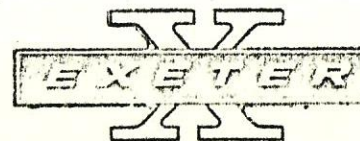

EXETER DRILLING NORTHERN, INC.  
2300 LINCOLN CENTER BUILDING  
DENVER COLORADO 80202  
(303) 622 6141

## CLOW OUT PREVENTER EQUIPMENT

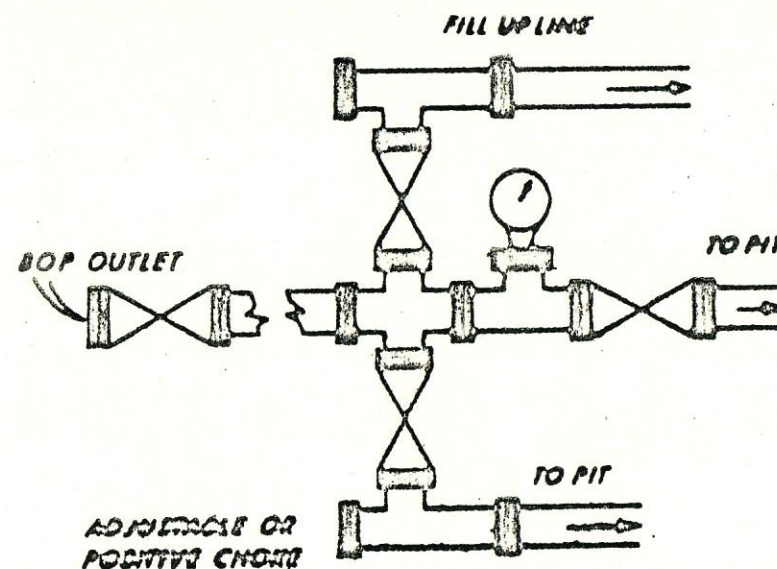
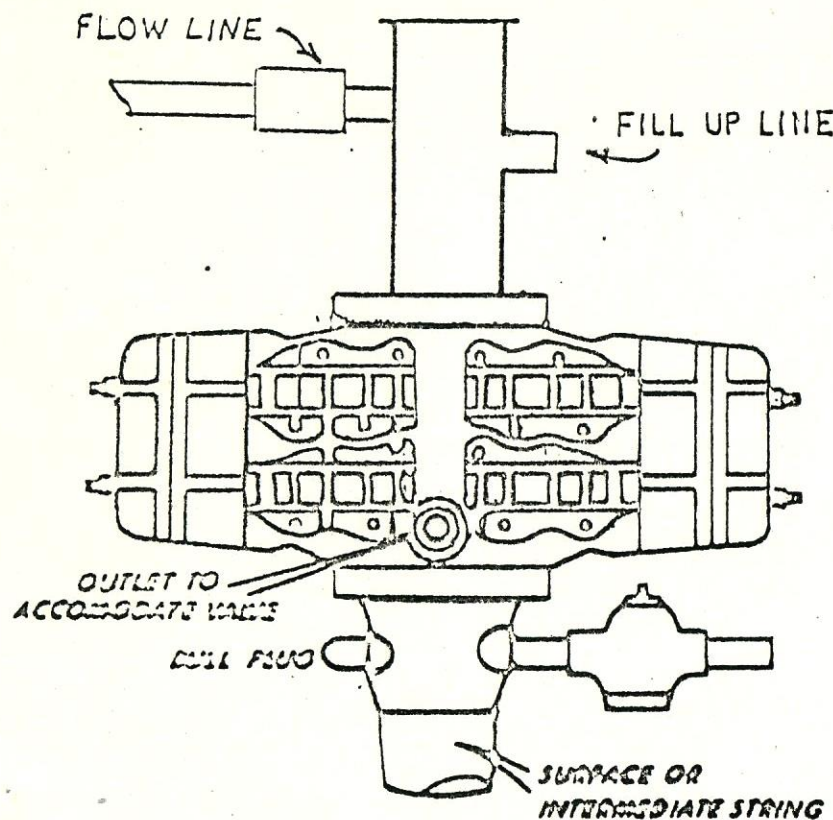

1. BOP VALVES AND ALL WORKING FITTINGS SHOULD BE IN GOOD WORKING CONDITION.
2. ALL BOLTS TO BE INSTALLED AND TIGHT.
3. ALL VALVES TO BE 3000# W.P. OR BETTER.
4. AFTER NIPPLING UP TEST RAMS AND PRESSURE UP TO 1000# FOR 15 MINUTES AND CHECK FOR POSSIBLE LEAKS.
5. ALL CREW MEMBERS TO BE FAMILIAR WITH BOP AND ACCUMULATORS.
6. KEEP HOLE FULL ON TRIPS
7. USE ONLY FLANGE TYPE FITTINGS
8. RECHECK BOLTS FOR TIGHTNESS BEFORE 5000 FT. OR ENTERING PRODUCTION ZONES.
9. WHEN DRILLING USE,  
TOP PREVENTER - DRILL PIPE RAMS  
BOTTOM PREVENTER CLIND RAMS
10. WHEN RUNNING CASING USE,  
TOP PREVENTER - CASING RAMS  
BOTTOM PREVENTER CLIND RAMS



K & E Petroleum, Inc.  
 Suite #801  
 730 17th Street  
 Denver, Colorado 80202  
 303-893-0435

## Representatives:

Scott Stewart, District Geologist  
 R. M. Wakefield, Vice President, RM Expl.

K & E Petroleum, Inc.  
 #1 Miller - USA  
 SE SE Sec. 8-9N-55W  
 Logan County, Colorado  
 4600' J-Sand test Wildcat  
 Elevation: 4406 KB, 4396 GL

PREFERRED COMMENCEMENT DATE: November 1-15, 1981

CASING PROGRAM

<u>Hole size</u>	<u>Casing size</u>	<u>Depth</u>	<u>Cement</u>
12 $\frac{1}{4}$ "	8-5/8"	200'	Circ. to surface
7-7/8"	4 $\frac{1}{2}$ "	TD	125 sx

ESTIMATED FORMATION TOPS

<u>Formation</u>	<u>Depth</u>
Pierre	1200'
Niobrara	4665'
Ft. Hayes	4980'
X-Bentonite	5400'
D-Sand	5505'
Huntsman	5530'
J-1 Sand	5580'
J-2 Sand	5605'
J-3 Sand	5655'
Total depth	5700'

ELECTRIC LOGS

Dual induction-laterallog: Base of surface casing to TD.  
 Gamma ray-FC Density w/caliper: Minimum run.

DRILL STEM TEST

✓ One DST in J-1 Sand very probable.

CORES None.

SAMPLES

30' samples: 4000' to 5300'  
 10' samples: 5300' to total depth  
 5' samples and circulation samples at geologist's request.

MUDLOGGER None.

MUD PROGRAM

As customary in the area. Maintain water loss at 5 cc or less and viscosity such that samples of the D and J-sands are adequate for evaluation.

WELLSITE GEOLOGIST Will advise.

MORNING REPORTS Call morning reports to K & E Denver office, 893-0435.



SUPERVISOR, OIL AND GAS OPERATIONS:

## DESIGNATION OF OPERATOR

The undersigned is, on the records of the Bureau of Land Management, holder of oil and gas lease

DISTRICT LAND OFFICE: Grand Junction, Colorado  
SERIAL NO.: C-25755

and hereby designates

NAME: K & E Petroleum, Inc.  
ADDRESS: 730 Seventeenth Street, Suite 801  
Denver, Colorado 80202

as his operator and local agent, with full authority to act in his behalf in complying with the terms of the lease and regulations applicable thereto and on whom the supervisor or his representative may serve written or oral instructions in securing compliance with the Oil and Gas Operating Regulations with respect to (describe acreage to which this designation is applicable):

LOGAN COUNTY, COLORADO  
T. 9 N., R. 55 W.  
Section 8: S $\frac{1}{2}$

It is understood that this designation of operator does not relieve the lessee of responsibility for compliance with the terms of the lease and the Oil and Gas Operating Regulations. It is also understood that this designation of operator does not constitute an assignment of any interest in the lease.

In case of default on the part of the designated operator, the lessee will make full and prompt compliance with all regulations, lease terms, or orders of the Secretary of the Interior or his representative.

The lessee agrees promptly to notify the oil and gas supervisor of any change in the designated operator.

  
(Signature of lessee)

ROBERT H. STEED, Attorney in Fact

P. O. Box 120, Casper, Wyoming 82602  
(Address)

8-7-81  
(Date)

MINERAL RIGHTS

SUPERVISOR, OIL AND GAS OPERATIONS:

## DESIGNATION OF OPERATOR

The undersigned is, on the records of the Bureau of Land Management, holder of oil and gas lease

DISTRICT LAND OFFICE: Grand Junction, Colorado

SEPARATE NO. C-25755

and hereby designates

NAME: K &amp; E Petroleum, Inc.

ADDRESS: 730 Seventeenth Street, Suite 801  
Denver, Colorado 80202

as his operator and local agent, with full authority to act in his behalf in complying with the terms of the lease and regulations applicable thereto and on whom the supervisor or his representative may serve written or oral instructions in securing compliance with the Oil and Gas Operating Regulations with respect to (describe acreage to which this designation is applicable):

LOGAN COUNTY, COLORADO

T. 9 N., R. 55 W.

Section 8: S $\frac{1}{2}$ 

It is understood that this designation of operator does not relieve the lessee of responsibility for compliance with the terms of the lease and the Oil and Gas Operating Regulations. It is also understood that this designation of operator does not constitute an assignment of any interest in the lease.

In case of default on the part of the designated operator, the lessee will make full and prompt compliance with all regulations, lease terms, or orders of the Secretary of the Interior or his representative.

The lessee agrees promptly to notify the oil and gas supervisor of any change in the designated operator.

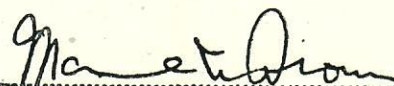

(Signature of lessee)

MAURICE W. BROWN

648 S. Greeley Hwy., Cheyenne, WY 82001

(Address)

Aug 2, 1981  
(Date)



RECEIVED  
AUG 24 1981  
COLO. OIL & GAS CONS. COMM.

NTL-6 PROGRAM

APPROVAL OF OPERATIONS

MILLER U.S.A. #1  
660' FSL and 600' FEL  
SEC. 8, T9N - R55W  
LOGAN COUNTY, COLORADO

Prepared For:

K & E PETROLEUM, INC.

By:

LeCLAIR-WESTWOOD, INC.  
388 Denver Club Building  
Denver, Colorado 80202

Copies sent to:

- 4 - U.S.G.S. - Grand Junction, Colorado
- 1 - B.L.M. - Canyon City, Colorado
- 1 - J.B. Johnson - Dirt Contractor - Ft. Morgan, Colorado
- 1 - Drilling Contractor
- 2 - K & E Petroleum, Inc. - Denver, Colorado
- 1 - Colorado Oil & Gas Commission - Denver, Colorado
- 3 - LeClair-Westwood, Inc. - Denver, Colorado

DVR	
FJP	
HHM	
JAM	
JJO	
RLS	
CSM	

