

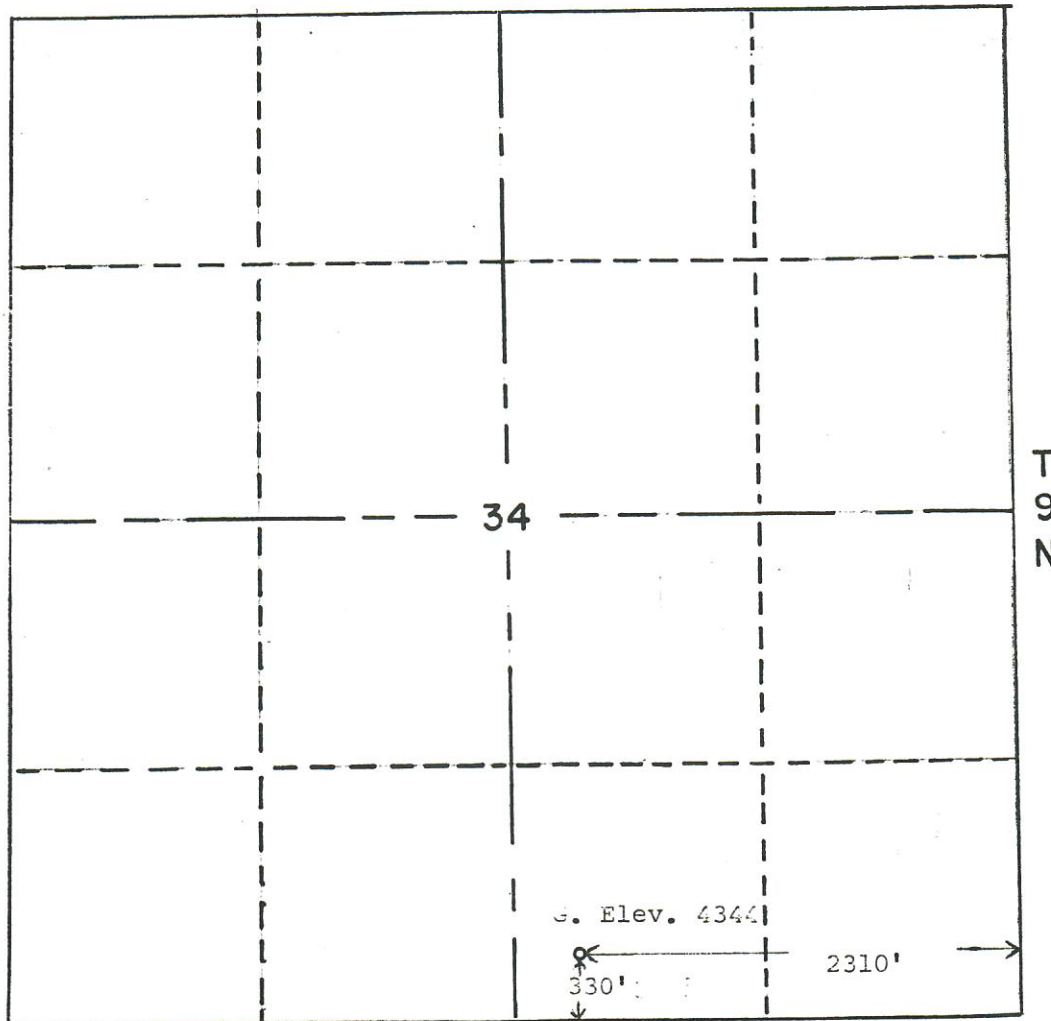

00238991

R 54 W



Scale ... 1" = 1000'

Plat showing location of Sandlin Oil Corp. No.1 Koenig-Ashby
to be C-SW-SW-SE of Section 34 of T 9 N of R 54 W of
the 6th Principal Meridian in Adams County, Colorado.

Source of dimensions: USGS Wild Horse Lake Quadrangle
and field measurements.

Date: