

CONFLUENCE RESOURCES



Location:	COLORADO	Slot:	SLOT#15 CANAL 22-2-2L (185°FSL & 1321°FWL,SEC.22)
Field:	WELD COUNTY (NAD83, TRUE NORTH)	Well:	CANAL 22-2-2L
Facility:	SEC.22-T01N-R65W	Wellbore:	CANAL 22-2-2L PWB
Plot reference wellpath is CANAL 22-2-2L PWP Rev-A.0		Grid System: NAD83 / Lambert Colorado SP, Northern Zone (501), US feet	
True vertical depths are referenced to Rig (23) (KB)		North Reference: True north	
Reference wellpath measured depths are referenced to Rig (23) (KB)		Scale: True distance	
Rig (23) (KB) to Mean Sea Level: 5118 feet		Coordinates are in feet referenced to Slot	
Mean Sea Level to Mud line (At Slot: SLOT#15 CANAL 22-2-2L (185°FSL & 1321°FWL,SEC.22)): 0 feet		Depths are in feet	
Offset wellpath MDs are referenced to each path's default MD datum		Created by: painsetr on 2021-05-17; Database: WellArcheolDB	

Well Profile Data							
Design Comment	MD (ft)	Inc (°)	Az (°)	TVD (ft)	Local N (ft)	Local E (ft)	VS (ft)
Tie On	23.00	0.000	96.325	23.00	0.00	0.00	0.00
End of Tangent	500.00	0.000	96.325	500.00	0.00	0.00	0.00
Build (XS)	1743.13	24.863	96.325	1704.48	-29.25	263.90	50.72
KOP	7260.80	24.863	96.325	6710.77	-284.84	2569.64	493.91
LANDING	8180.70	90.000	1.588	7249.00	280.66	2833.98	1112.50
TD	17838.11	90.000	1.588	7249.00	9934.36	3101.60	10407.28

Location Information			
Facility Name		Grid East (US ft)	Grid North (US ft)
SEC.22-T01N-R65W		3236383.461	1254962.137
Slot		Local N (ft)	Local E (ft)
SLOT#15 CANAL 22-2-2L (185°FSL & 1321°FWL,SEC.22)		0.00	274.44
Rig (23) (KB) to Mud line (At Slot: SLOT#15 CANAL 22-2-2L (185°FSL & 1321°FWL,SEC.22))		Grid East (US ft)	Grid North (US ft)
Mean Sea Level to Mud line (At Slot: SLOT#15 CANAL 22-2-2L (185°FSL & 1321°FWL,SEC.22))		3236657.878	1254964.751
Rig (23) (KB) to Mean Sea Level		Latitude	Longitude
		40°01'48.6120"N	104°39'17.5320"W
		5118ft	
		5118ft	

Hole and Casing Sections											
Name	Start MD (ft)	End MD (ft)	Interval (ft)	Start TVD (ft)	End TVD (ft)	Start Local N (ft)	Start Local E (ft)	End Local N (ft)	End Local E (ft)	Wellbore	
9.625in Casing Surface	23.00	1550.00	1527.00	23.00	1526.65	0.00	0.00	-20.96	189.12	CANAL 22-2-2L PWB	

Bottom Hole Location							
MD (ft)	Inc (°)	Az (°)	TVD (ft)	Local N (ft)	Local E (ft)	Grid East (US ft)	Grid North (US ft)
17838.11	90.000	1.588	7249.00	9934.36	3101.60	3239664.55	1264927.85
						Latitude	Longitude
						40°03'26.7840"N	104°38'37.6440"W

Targets							
Name	MD (ft)	TVD (ft)	Local N (ft)	Local E (ft)	Grid East (US ft)	Grid North (US ft)	Latitude
SEC.15/22-T01N-R65W (SB 460)	N/A	6.50	0.00	-274.44	3236383.46	1254962.14	40°01'48.6120"N
SEC.15-T01N-R65W	N/A	10.00	0.00	-274.44	3236383.46	1254962.14	40°01'48.6120"N
SEC.22-T01N-R65W	N/A	10.00	0.00	-274.44	3236383.46	1254962.14	40°01'48.6120"N
CANAL 22-2-2L BHL REV-1(470°FNL & 920°FEL,SEC.15)	17838.11	7249.00	9934.36	3101.60	3239664.55	1264927.85	40°03'26.7840"N
CANAL 22-2-2L LP REV-1(470°FSL & 1120°FEL,SEC.22)	8180.70	7249.00	280.66	2833.98	3239488.94	1255272.40	40°01'51.3840"N

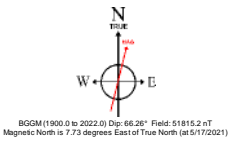
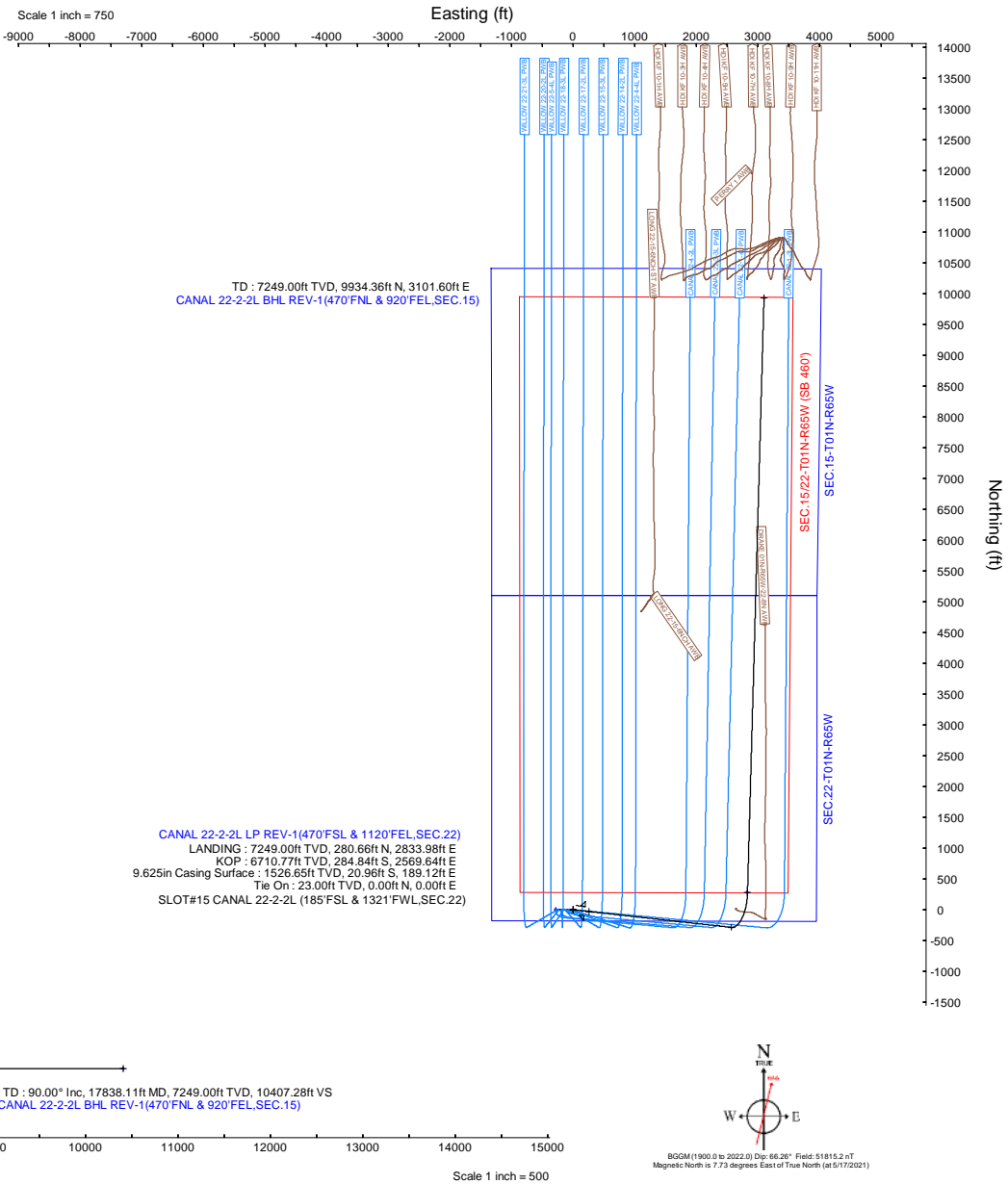
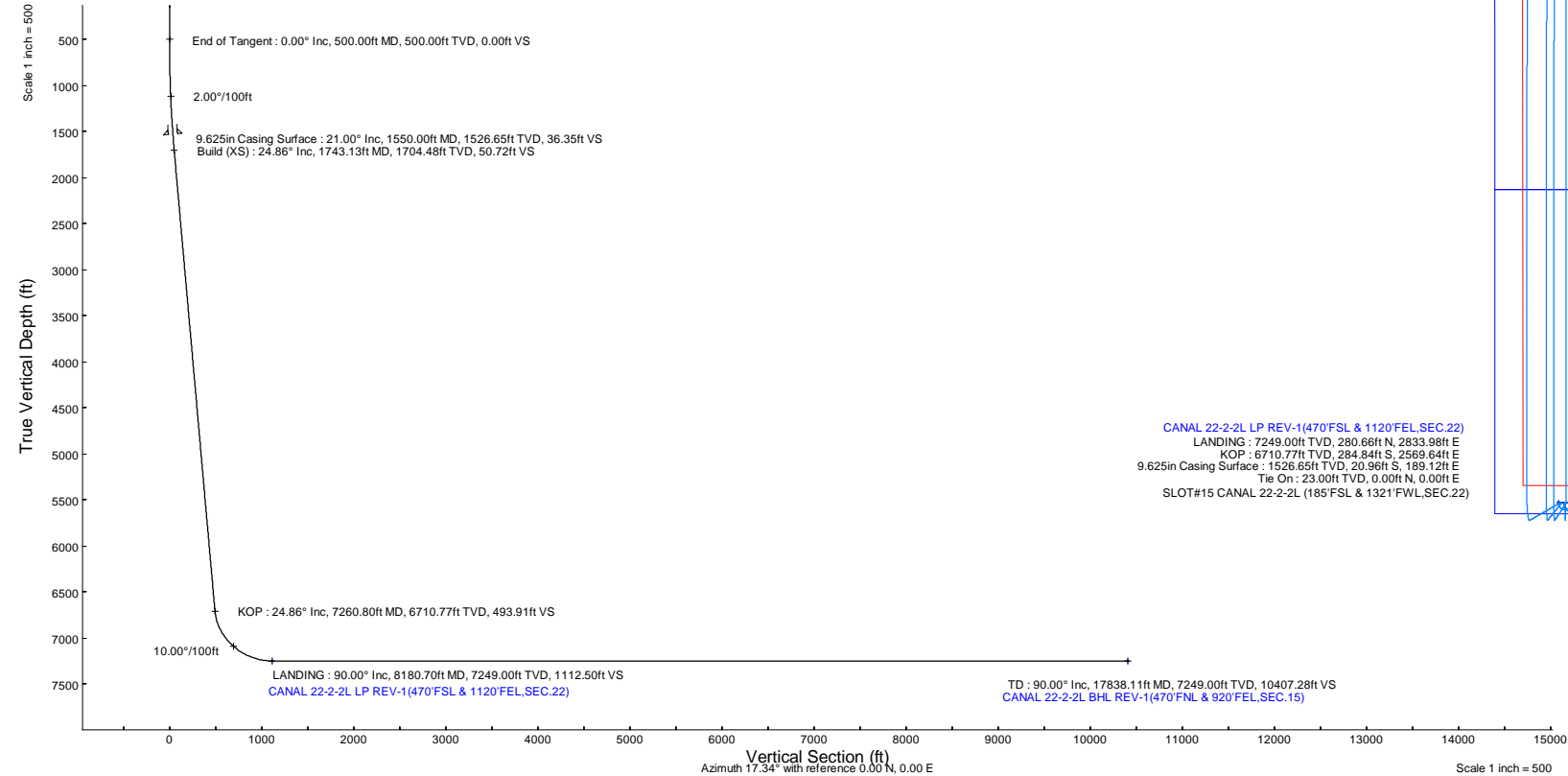

Planned Wellpath Report

CANAL 22-2-2L PWP Rev-A.0

Page 1 of 10

REFERENCE WELLPATH IDENTIFICATION

Operator	CONFLUENCE RESOURCES	Well	CANAL 22-2-2L
Field	WELD COUNTY (NAD83, TRUE NORTH)	API/Legal	
Facility	SEC.22-T01N-R65W	Wellbore	CANAL 22-2-2L PWB
Slot	SLOT#15 CANAL 22-2-2L (185'FSL & 1321'FWL,SEC.22)		

REPORT SETUP INFORMATION

Projection System	NAD83 / Lambert Colorado SP, Northern Zone (501), US feet	Software System	WellArchitect® 6.0
North Reference	True	User	Painsetr
Scale	0.999964	Report Generated	5/17/2021 at 1:37:55 PM
Convergence at slot	0.55° East	Database	WellArchitectDB

WELLPATH LOCATION

	Local coordinates		Grid coordinates		Geographic coordinates	
	North[ft]	East[ft]	Easting[US ft]	Northing[US ft]	Latitude	Longitude
Slot Location	0.00	274.44	3236657.88	1254964.75	40.0301700°	-104.6548700°
Facility Reference Pt			3236383.46	1254962.14	40.0301700°	-104.6558500°
Field Reference Pt			3230456.90	1245096.09	40.0032400°	-104.6773400°

WELLPATH DATUM

Calculation method	Minimum curvature	Rig (23') (KB) to Facility Vertical Datum	5118.00ft
Horizontal Reference Pt	Slot	Rig (23') (KB) to Mean Sea Level	5118.00ft
Vertical Reference Pt	Rig (23') (KB)	Rig (23') (KB) to Mud Line at Slot (SLOT#15 CANAL 22-2-2L (185'FSL & 1321'FWL,SEC.22))	5118.00ft
MD Reference Pt	Rig (23') (KB)	Section Origin	N 0.00, E 0.00 ft
Field Vertical Reference	Mean Sea Level	Section Azimuth	17.34°

Planned Wellpath Report

CANAL 22-2-2L PWP Rev-A.0

Page 2 of 10

REFERENCE WELLPATH IDENTIFICATION

Operator	CONFLUENCE RESOURCES	Well	CANAL 22-2-2L
Field	WELD COUNTY (NAD83, TRUE NORTH)	API/Legal	
Facility	SEC.22-T01N-R65W	Wellbore	CANAL 22-2-2L PWB
Slot	SLOT#15 CANAL 22-2-2L (185'FSL & 1321'FWL,SEC.22)		

WELLPATH DATA (185 stations) † = interpolated, ‡ = extrapolated station

MD [ft]	Inclination [°]	Azimuth [°]	TVD [ft]	Vert Sect [ft]	North [ft]	East [ft]	Grid East [US ft]	Grid North [US ft]	Latitude	Longitude	DLS [°/100ft]	Comments
0.00†	0.000	96.325	0.00	0.00	0.00	0.00	3236657.88	1254964.75	40.0301700	-104.6548700	0.00	
23.00	0.000	96.325	23.00	0.00	0.00	0.00	3236657.88	1254964.75	40.0301700	-104.6548700	0.00	Tie On
123.00†	0.000	96.325	123.00	0.00	0.00	0.00	3236657.88	1254964.75	40.0301700	-104.6548700	0.00	
223.00†	0.000	96.325	223.00	0.00	0.00	0.00	3236657.88	1254964.75	40.0301700	-104.6548700	0.00	
323.00†	0.000	96.325	323.00	0.00	0.00	0.00	3236657.88	1254964.75	40.0301700	-104.6548700	0.00	
423.00†	0.000	96.325	423.00	0.00	0.00	0.00	3236657.88	1254964.75	40.0301700	-104.6548700	0.00	
500.00	0.000	96.325	500.00	0.00	0.00	0.00	3236657.88	1254964.75	40.0301700	-104.6548700	0.00	End of Tangent
523.00†	0.460	96.325	523.00	0.02	-0.01	0.09	3236657.97	1254964.74	40.0301700	-104.6548697	2.00	
623.00†	2.460	96.325	622.96	0.50	-0.29	2.62	3236660.50	1254964.48	40.0301692	-104.6548606	2.00	
723.00†	4.460	96.325	722.77	1.66	-0.96	8.62	3236666.51	1254963.88	40.0301674	-104.6548392	2.00	
823.00†	6.460	96.325	822.32	3.47	-2.00	18.08	3236675.97	1254962.92	40.0301645	-104.6548054	2.00	
923.00†	8.460	96.325	921.46	5.96	-3.43	30.98	3236688.89	1254961.61	40.0301606	-104.6547594	2.00	
1023.00†	10.460	96.325	1020.10	9.09	-5.25	47.32	3236705.24	1254959.96	40.0301556	-104.6547010	2.00	
1123.00†	12.460	96.325	1118.10	12.89	-7.43	67.06	3236725.01	1254957.96	40.0301496	-104.6546305	2.00	
1223.00†	14.460	96.325	1215.35	17.34	-10.00	90.20	3236748.16	1254955.61	40.0301426	-104.6545479	2.00	
1323.00†	16.460	96.325	1311.73	22.43	-12.93	116.69	3236774.68	1254952.93	40.0301345	-104.6544533	2.00	
1423.00†	18.460	96.325	1407.11	28.16	-16.24	146.51	3236804.53	1254949.91	40.0301254	-104.6543468	2.00	
1523.00†	20.460	96.325	1501.40	34.53	-19.91	179.62	3236837.67	1254946.55	40.0301153	-104.6542286	2.00	
1623.00†	22.460	96.325	1594.46	41.51	-23.94	215.98	3236874.07	1254942.87	40.0301043	-104.6540987	2.00	
1723.00†	24.460	96.325	1686.19	49.12	-28.33	255.55	3236913.67	1254938.86	40.0300922	-104.6539575	2.00	
1743.13	24.863	96.325	1704.48	50.72	-29.25	263.90	3236922.03	1254938.02	40.0300897	-104.6539277	2.00	Build (XS)
1823.00†	24.863	96.325	1776.95	57.14	-32.95	297.27	3236955.44	1254934.63	40.0300795	-104.6538085	0.00	
1923.00†	24.863	96.325	1867.68	65.17	-37.58	339.06	3236997.27	1254930.40	40.0300668	-104.6536592	0.00	
2023.00†	24.863	96.325	1958.41	73.20	-42.22	380.85	3237039.10	1254926.17	40.0300541	-104.6535100	0.00	
2123.00†	24.863	96.325	2049.15	81.24	-46.85	422.64	3237080.93	1254921.93	40.0300414	-104.6533608	0.00	
2223.00†	24.863	96.325	2139.88	89.27	-51.48	464.43	3237122.76	1254917.70	40.0300287	-104.6532116	0.00	
2323.00†	24.863	96.325	2230.61	97.30	-56.11	506.21	3237164.58	1254913.47	40.0300160	-104.6530624	0.00	
2423.00†	24.863	96.325	2321.34	105.33	-60.75	548.00	3237206.41	1254909.23	40.0300032	-104.6529131	0.00	
2523.00†	24.863	96.325	2412.07	113.36	-65.38	589.79	3237248.24	1254905.00	40.0299905	-104.6527639	0.00	
2623.00†	24.863	96.325	2502.80	121.40	-70.01	631.58	3237290.07	1254900.77	40.0299778	-104.6526147	0.00	

Planned Wellpath Report

CANAL 22-2-2L PWP Rev-A.0

Page 3 of 10

REFERENCE WELLPATH IDENTIFICATION

Operator	CONFLUENCE RESOURCES	Well	CANAL 22-2-2L
Field	WELD COUNTY (NAD83, TRUE NORTH)	API/Legal	
Facility	SEC.22-T01N-R65W	Wellbore	CANAL 22-2-2L PWB
Slot	SLOT#15 CANAL 22-2-2L (185'FSL & 1321'FWL,SEC.22)		

WELLPATH DATA (185 stations) † = interpolated, ‡ = extrapolated station

MD [ft]	Inclination [°]	Azimuth [°]	TVD [ft]	Vert Sect [ft]	North [ft]	East [ft]	Grid East [US ft]	Grid North [US ft]	Latitude	Longitude	DLS [°/100ft]	Comments
2723.00†	24.863	96.325	2593.54	129.43	-74.64	673.37	3237331.90	1254896.53	40.0299651	-104.6524655	0.00	
2823.00†	24.863	96.325	2684.27	137.46	-79.27	715.16	3237373.73	1254892.30	40.0299524	-104.6523162	0.00	
2923.00†	24.863	96.325	2775.00	145.49	-83.91	756.94	3237415.56	1254888.07	40.0299396	-104.6521670	0.00	
3023.00†	24.863	96.325	2865.73	153.53	-88.54	798.73	3237457.39	1254883.83	40.0299269	-104.6520178	0.00	
3123.00†	24.863	96.325	2956.46	161.56	-93.17	840.52	3237499.22	1254879.60	40.0299142	-104.6518686	0.00	
3223.00†	24.863	96.325	3047.20	169.59	-97.80	882.31	3237541.05	1254875.36	40.0299015	-104.6517194	0.00	
3323.00†	24.863	96.325	3137.93	177.62	-102.43	924.10	3237582.88	1254871.13	40.0298888	-104.6515701	0.00	
3423.00†	24.863	96.325	3228.66	185.65	-107.07	965.89	3237624.70	1254866.90	40.0298760	-104.6514209	0.00	
3523.00†	24.863	96.325	3319.39	193.69	-111.70	1007.68	3237666.53	1254862.66	40.0298633	-104.6512717	0.00	
3623.00†	24.863	96.325	3410.12	201.72	-116.33	1049.46	3237708.36	1254858.43	40.0298506	-104.6511225	0.00	
3723.00†	24.863	96.325	3500.86	209.75	-120.96	1091.25	3237750.19	1254854.20	40.0298379	-104.6509732	0.00	
3823.00†	24.863	96.325	3591.59	217.78	-125.60	1133.04	3237792.02	1254849.96	40.0298252	-104.6508240	0.00	
3923.00†	24.863	96.325	3682.32	225.82	-130.23	1174.83	3237833.85	1254845.73	40.0298124	-104.6506748	0.00	
4023.00†	24.863	96.325	3773.05	233.85	-134.86	1216.62	3237875.68	1254841.50	40.0297997	-104.6505256	0.00	
4123.00†	24.863	96.325	3863.78	241.88	-139.49	1258.41	3237917.51	1254837.26	40.0297870	-104.6503764	0.00	
4223.00†	24.863	96.325	3954.51	249.91	-144.12	1300.19	3237959.34	1254833.03	40.0297743	-104.6502271	0.00	
4323.00†	24.863	96.325	4045.25	257.94	-148.76	1341.98	3238001.17	1254828.80	40.0297616	-104.6500779	0.00	
4423.00†	24.863	96.325	4135.98	265.98	-153.39	1383.77	3238043.00	1254824.56	40.0297488	-104.6499287	0.00	
4523.00†	24.863	96.325	4226.71	274.01	-158.02	1425.56	3238084.82	1254820.33	40.0297361	-104.6497795	0.00	
4623.00†	24.863	96.325	4317.44	282.04	-162.65	1467.35	3238126.65	1254816.10	40.0297234	-104.6496303	0.00	
4723.00†	24.863	96.325	4408.17	290.07	-167.28	1509.14	3238168.48	1254811.86	40.0297107	-104.6494810	0.00	
4823.00†	24.863	96.325	4498.91	298.11	-171.92	1550.92	3238210.31	1254807.63	40.0296979	-104.6493318	0.00	
4923.00†	24.863	96.325	4589.64	306.14	-176.55	1592.71	3238252.14	1254803.39	40.0296852	-104.6491826	0.00	
5023.00†	24.863	96.325	4680.37	314.17	-181.18	1634.50	3238293.97	1254799.16	40.0296725	-104.6490334	0.00	
5123.00†	24.863	96.325	4771.10	322.20	-185.81	1676.29	3238335.80	1254794.93	40.0296598	-104.6488842	0.00	
5223.00†	24.863	96.325	4861.83	330.23	-190.45	1718.08	3238377.63	1254790.69	40.0296470	-104.6487349	0.00	
5323.00†	24.863	96.325	4952.57	338.27	-195.08	1759.87	3238419.46	1254786.46	40.0296343	-104.6485857	0.00	
5423.00†	24.863	96.325	5043.30	346.30	-199.71	1801.65	3238461.29	1254782.23	40.0296216	-104.6484365	0.00	
5523.00†	24.863	96.325	5134.03	354.33	-204.34	1843.44	3238503.11	1254777.99	40.0296089	-104.6482873	0.00	
5623.00†	24.863	96.325	5224.76	362.36	-208.97	1885.23	3238544.94	1254773.76	40.0295962	-104.6481381	0.00	

Planned Wellpath Report

CANAL 22-2-2L PWP Rev-A.0

Page 4 of 10

REFERENCE WELLPATH IDENTIFICATION

Operator	CONFLUENCE RESOURCES	Well	CANAL 22-2-2L
Field	WELD COUNTY (NAD83, TRUE NORTH)	API/Legal	
Facility	SEC.22-T01N-R65W	Wellbore	CANAL 22-2-2L PWB
Slot	SLOT#15 CANAL 22-2-2L (185'FSL & 1321'FWL,SEC.22)		

WELLPATH DATA (185 stations) † = interpolated, ‡ = extrapolated station

MD [ft]	Inclination [°]	Azimuth [°]	TVD [ft]	Vert Sect [ft]	North [ft]	East [ft]	Grid East [US ft]	Grid North [US ft]	Latitude	Longitude	DLS [°/100ft]	Comments
5723.00†	24.863	96.325	5315.49	370.40	-213.61	1927.02	3238586.77	1254769.53	40.0295834	-104.6479888	0.00	
5823.00†	24.863	96.325	5406.22	378.43	-218.24	1968.81	3238628.60	1254765.29	40.0295707	-104.6478396	0.00	
5923.00†	24.863	96.325	5496.96	386.46	-222.87	2010.60	3238670.43	1254761.06	40.0295580	-104.6476904	0.00	
6023.00†	24.863	96.325	5587.69	394.49	-227.50	2052.39	3238712.26	1254756.83	40.0295453	-104.6475412	0.00	
6123.00†	24.863	96.325	5678.42	402.52	-232.14	2094.17	3238754.09	1254752.59	40.0295325	-104.6473920	0.00	
6223.00†	24.863	96.325	5769.15	410.56	-236.77	2135.96	3238795.92	1254748.36	40.0295198	-104.6472427	0.00	
6323.00†	24.863	96.325	5859.88	418.59	-241.40	2177.75	3238837.75	1254744.13	40.0295071	-104.6470935	0.00	
6423.00†	24.863	96.325	5950.62	426.62	-246.03	2219.54	3238879.58	1254739.89	40.0294944	-104.6469443	0.00	
6523.00†	24.863	96.325	6041.35	434.65	-250.66	2261.33	3238921.41	1254735.66	40.0294816	-104.6467951	0.00	
6623.00†	24.863	96.325	6132.08	442.69	-255.30	2303.12	3238963.23	1254731.42	40.0294689	-104.6466459	0.00	
6723.00†	24.863	96.325	6222.81	450.72	-259.93	2344.90	3239005.06	1254727.19	40.0294562	-104.6464966	0.00	
6823.00†	24.863	96.325	6313.54	458.75	-264.56	2386.69	3239046.89	1254722.96	40.0294434	-104.6463474	0.00	
6923.00†	24.863	96.325	6404.28	466.78	-269.19	2428.48	3239088.72	1254718.72	40.0294307	-104.6461982	0.00	
7023.00†	24.863	96.325	6495.01	474.81	-273.82	2470.27	3239130.55	1254714.49	40.0294180	-104.6460490	0.00	
7123.00†	24.863	96.325	6585.74	482.85	-278.46	2512.06	3239172.38	1254710.26	40.0294053	-104.6458998	0.00	
7223.00†	24.863	96.325	6676.47	490.88	-283.09	2553.85	3239214.21	1254706.02	40.0293925	-104.6457505	0.00	
7260.80	24.863	96.325	6710.77	493.91	-284.84	2569.64	3239230.02	1254704.42	40.0293877	-104.6456941	0.00	KOP
7323.00†	25.124	81.583	6767.20	502.16	-284.35	2595.73	3239256.10	1254705.16	40.0293891	-104.6456010	10.00	
7423.00†	28.356	60.420	6856.70	528.80	-269.48	2637.48	3239297.71	1254720.43	40.0294299	-104.6454519	10.00	
7523.00†	34.118	44.560	6942.31	571.19	-237.69	2677.92	3239337.84	1254752.60	40.0295171	-104.6453075	10.00	
7623.00†	41.357	33.231	7021.43	628.04	-189.96	2715.80	3239375.26	1254800.69	40.0296482	-104.6451722	10.00	
7723.00†	49.419	24.889	7091.67	697.64	-127.72	2749.97	3239408.84	1254863.25	40.0298190	-104.6450501	10.00	
7823.00†	57.949	18.395	7150.88	777.86	-52.86	2779.40	3239437.55	1254938.38	40.0300245	-104.6449450	10.00	
7923.00†	66.752	13.031	7197.27	866.27	32.32	2803.19	3239460.53	1255023.79	40.0302583	-104.6448600	10.00	
8023.00†	75.715	8.340	7229.42	960.17	125.26	2820.62	3239477.07	1255116.88	40.0305134	-104.6447977	10.00	
8123.00†	84.763	4.014	7246.36	1056.73	223.12	2831.16	3239486.68	1255214.83	40.0307820	-104.6447601	10.00	
8180.70	90.000	1.588	7249.00†	1112.50	280.66	2833.98	3239488.94	1255272.40	40.0309400	-104.6447500	10.00	LANDING
8223.00†	90.000	1.588	7249.00	1153.21	322.95	2835.15	3239489.71	1255314.69	40.0310561	-104.6447458	0.00	
8323.00†	90.000	1.588	7249.00	1249.46	422.91	2837.92	3239491.53	1255414.67	40.0313305	-104.6447359	0.00	
8423.00†	90.000	1.588	7249.00	1345.70	522.87	2840.69	3239493.35	1255514.65	40.0316049	-104.6447259	0.00	

Planned Wellpath Report

CANAL 22-2-2L PWP Rev-A.0

Page 5 of 10

REFERENCE WELLPATH IDENTIFICATION

Operator	CONFLUENCE RESOURCES	Well	CANAL 22-2-2L
Field	WELD COUNTY (NAD83, TRUE NORTH)	API/Legal	
Facility	SEC.22-T01N-R65W	Wellbore	CANAL 22-2-2L PWB
Slot	SLOT#15 CANAL 22-2-2L (185'FSL & 1321'FWL,SEC.22)		

WELLPATH DATA (185 stations) † = interpolated, ‡ = extrapolated station

MD [ft]	Inclination [°]	Azimuth [°]	TVD [ft]	Vert Sect [ft]	North [ft]	East [ft]	Grid East [US ft]	Grid North [US ft]	Latitude	Longitude	DLS [°/100ft]	Comments
8523.00†	90.000	1.588	7249.00	1441.95	622.83	2843.46	3239495.17	1255614.63	40.0318793	-104.6447160	0.00	
8623.00†	90.000	1.588	7249.00	1538.19	722.79	2846.23	3239496.98	1255714.61	40.0321537	-104.6447060	0.00	
8723.00†	90.000	1.588	7249.00	1634.44	822.76	2849.00	3239498.80	1255814.59	40.0324281	-104.6446961	0.00	
8823.00†	90.000	1.588	7249.00	1730.68	922.72	2851.77	3239500.62	1255914.57	40.0327025	-104.6446862	0.00	
8923.00†	90.000	1.588	7249.00	1826.93	1022.68	2854.55	3239502.44	1256014.55	40.0329769	-104.6446762	0.00	
9023.00†	90.000	1.588	7249.00	1923.17	1122.64	2857.32	3239504.26	1256114.53	40.0332513	-104.6446663	0.00	
9123.00†	90.000	1.588	7249.00	2019.42	1222.60	2860.09	3239506.08	1256214.51	40.0335257	-104.6446564	0.00	
9223.00†	90.000	1.588	7249.00	2115.66	1322.56	2862.86	3239507.89	1256314.49	40.0338001	-104.6446464	0.00	
9323.00†	90.000	1.588	7249.00	2211.91	1422.52	2865.63	3239509.71	1256414.47	40.0340745	-104.6446365	0.00	
9423.00†	90.000	1.588	7249.00	2308.15	1522.49	2868.40	3239511.53	1256514.45	40.0343489	-104.6446266	0.00	
9523.00†	90.000	1.588	7249.00	2404.40	1622.45	2871.17	3239513.35	1256614.43	40.0346233	-104.6446166	0.00	
9623.00†	90.000	1.588	7249.00	2500.64	1722.41	2873.94	3239515.17	1256714.41	40.0348977	-104.6446067	0.00	
9723.00†	90.000	1.588	7249.00	2596.89	1822.37	2876.72	3239516.99	1256814.39	40.0351721	-104.6445967	0.00	
9823.00†	90.000	1.588	7249.00	2693.13	1922.33	2879.49	3239518.81	1256914.37	40.0354465	-104.6445868	0.00	
9923.00†	90.000	1.588	7249.00	2789.38	2022.29	2882.26	3239520.62	1257014.35	40.0357209	-104.6445769	0.00	
10023.00†	90.000	1.588	7249.00	2885.62	2122.26	2885.03	3239522.44	1257114.33	40.0359953	-104.6445669	0.00	
10123.00†	90.000	1.588	7249.00	2981.87	2222.22	2887.80	3239524.26	1257214.30	40.0362697	-104.6445570	0.00	
10223.00†	90.000	1.588	7249.00	3078.11	2322.18	2890.57	3239526.08	1257314.28	40.0365441	-104.6445470	0.00	
10323.00†	90.000	1.588	7249.00	3174.36	2422.14	2893.34	3239527.90	1257414.26	40.0368185	-104.6445371	0.00	
10423.00†	90.000	1.588	7249.00	3270.60	2522.10	2896.11	3239529.72	1257514.24	40.0370929	-104.6445272	0.00	
10523.00†	90.000	1.588	7249.00	3366.85	2622.06	2898.89	3239531.53	1257614.22	40.0373673	-104.6445172	0.00	
10623.00†	90.000	1.588	7249.00	3463.09	2722.03	2901.66	3239533.35	1257714.20	40.0376417	-104.6445073	0.00	
10723.00†	90.000	1.588	7249.00	3559.34	2821.99	2904.43	3239535.17	1257814.18	40.0379161	-104.6444974	0.00	
10823.00†	90.000	1.588	7249.00	3655.58	2921.95	2907.20	3239536.99	1257914.16	40.0381905	-104.6444874	0.00	
10923.00†	90.000	1.588	7249.00	3751.83	3021.91	2909.97	3239538.81	1258014.14	40.0384649	-104.6444775	0.00	
11023.00†	90.000	1.588	7249.00	3848.07	3121.87	2912.74	3239540.63	1258114.12	40.0387393	-104.6444675	0.00	
11123.00†	90.000	1.588	7249.00	3944.32	3221.83	2915.51	3239542.44	1258214.10	40.0390137	-104.6444576	0.00	
11223.00†	90.000	1.588	7249.00	4040.56	3321.80	2918.28	3239544.26	1258314.08	40.0392881	-104.6444477	0.00	
11323.00†	90.000	1.588	7249.00	4136.81	3421.76	2921.06	3239546.08	1258414.06	40.0395625	-104.6444377	0.00	
11423.00†	90.000	1.588	7249.00	4233.05	3521.72	2923.83	3239547.90	1258514.04	40.0398369	-104.6444278	0.00	

Planned Wellpath Report

CANAL 22-2-2L PWP Rev-A.0

Page 6 of 10

REFERENCE WELLPATH IDENTIFICATION

Operator	CONFLUENCE RESOURCES	Well	CANAL 22-2-2L
Field	WELD COUNTY (NAD83, TRUE NORTH)	API/Legal	
Facility	SEC.22-T01N-R65W	Wellbore	CANAL 22-2-2L PWB
Slot	SLOT#15 CANAL 22-2-2L (185'FSL & 1321'FWL,SEC.22)		

WELLPATH DATA (185 stations) † = interpolated, ‡ = extrapolated station

MD [ft]	Inclination [°]	Azimuth [°]	TVD [ft]	Vert Sect [ft]	North [ft]	East [ft]	Grid East [US ft]	Grid North [US ft]	Latitude	Longitude	DLS [°/100ft]	Comments
11523.00†	90.000	1.588	7249.00	4329.30	3621.68	2926.60	3239549.72	1258614.02	40.0401113	-104.6444178	0.00	
11623.00†	90.000	1.588	7249.00	4425.54	3721.64	2929.37	3239551.54	1258714.00	40.0403857	-104.6444079	0.00	
11723.00†	90.000	1.588	7249.00	4521.79	3821.60	2932.14	3239553.35	1258813.98	40.0406601	-104.6443980	0.00	
11823.00†	90.000	1.588	7249.00	4618.03	3921.56	2934.91	3239555.17	1258913.96	40.0409345	-104.6443880	0.00	
11923.00†	90.000	1.588	7249.00	4714.28	4021.53	2937.68	3239556.99	1259013.94	40.0412089	-104.6443781	0.00	
12023.00†	90.000	1.588	7249.00	4810.52	4121.49	2940.45	3239558.81	1259113.92	40.0414833	-104.6443681	0.00	
12123.00†	90.000	1.588	7249.00	4906.77	4221.45	2943.23	3239560.63	1259213.90	40.0417577	-104.6443582	0.00	
12223.00†	90.000	1.588	7249.00	5003.01	4321.41	2946.00	3239562.45	1259313.88	40.0420321	-104.6443483	0.00	
12323.00†	90.000	1.588	7249.00	5099.26	4421.37	2948.77	3239564.26	1259413.86	40.0423065	-104.6443383	0.00	
12423.00†	90.000	1.588	7249.00	5195.50	4521.33	2951.54	3239566.08	1259513.84	40.0425809	-104.6443284	0.00	
12523.00†	90.000	1.588	7249.00	5291.75	4621.30	2954.31	3239567.90	1259613.82	40.0428553	-104.6443184	0.00	
12623.00†	90.000	1.588	7249.00	5388.00	4721.26	2957.08	3239569.72	1259713.80	40.0431297	-104.6443085	0.00	
12723.00†	90.000	1.588	7249.00	5484.24	4821.22	2959.85	3239571.54	1259813.78	40.0434041	-104.6442986	0.00	
12823.00†	90.000	1.588	7249.00	5580.49	4921.18	2962.62	3239573.36	1259913.76	40.0436785	-104.6442886	0.00	
12923.00†	90.000	1.588	7249.00	5676.73	5021.14	2965.40	3239575.17	1260013.74	40.0439529	-104.6442787	0.00	
13023.00†	90.000	1.588	7249.00	5772.98	5121.10	2968.17	3239576.99	1260113.72	40.0442273	-104.6442687	0.00	
13123.00†	90.000	1.588	7249.00	5869.22	5221.07	2970.94	3239578.81	1260213.70	40.0445017	-104.6442588	0.00	
13223.00†	90.000	1.588	7249.00	5965.47	5321.03	2973.71	3239580.63	1260313.68	40.0447761	-104.6442489	0.00	
13323.00†	90.000	1.588	7249.00	6061.71	5420.99	2976.48	3239582.45	1260413.65	40.0450505	-104.6442389	0.00	
13423.00†	90.000	1.588	7249.00	6157.96	5520.95	2979.25	3239584.27	1260513.63	40.0453249	-104.6442290	0.00	
13523.00†	90.000	1.588	7249.00	6254.20	5620.91	2982.02	3239586.08	1260613.61	40.0455993	-104.6442190	0.00	
13623.00†	90.000	1.588	7249.00	6350.45	5720.87	2984.79	3239587.90	1260713.59	40.0458737	-104.6442091	0.00	
13723.00†	90.000	1.588	7249.00	6446.69	5820.84	2987.57	3239589.72	1260813.57	40.0461481	-104.6441992	0.00	
13823.00†	90.000	1.588	7249.00	6542.94	5920.80	2990.34	3239591.54	1260913.55	40.0464225	-104.6441892	0.00	
13923.00†	90.000	1.588	7249.00	6639.18	6020.76	2993.11	3239593.36	1261013.53	40.0466969	-104.6441793	0.00	
14023.00†	90.000	1.588	7249.00	6735.43	6120.72	2995.88	3239595.18	1261113.51	40.0469713	-104.6441693	0.00	
14123.00†	90.000	1.588	7249.00	6831.67	6220.68	2998.65	3239596.99	1261213.49	40.0472457	-104.6441594	0.00	
14223.00†	90.000	1.588	7249.00	6927.92	6320.64	3001.42	3239598.81	1261313.47	40.0475201	-104.6441494	0.00	
14323.00†	90.000	1.588	7249.00	7024.16	6420.60	3004.19	3239600.63	1261413.45	40.0477945	-104.6441395	0.00	
14423.00†	90.000	1.588	7249.00	7120.41	6520.57	3006.96	3239602.45	1261513.43	40.0480689	-104.6441296	0.00	

Planned Wellpath Report

CANAL 22-2-2L PWP Rev-A.0

Page 7 of 10

REFERENCE WELLPATH IDENTIFICATION

Operator	CONFLUENCE RESOURCES	Well	CANAL 22-2-2L
Field	WELD COUNTY (NAD83, TRUE NORTH)	API/Legal	
Facility	SEC.22-T01N-R65W	Wellbore	CANAL 22-2-2L PWB
Slot	SLOT#15 CANAL 22-2-2L (185'FSL & 1321'FWL,SEC.22)		

WELLPATH DATA (185 stations) † = interpolated, ‡ = extrapolated station

MD [ft]	Inclination [°]	Azimuth [°]	TVD [ft]	Vert Sect [ft]	North [ft]	East [ft]	Grid East [US ft]	Grid North [US ft]	Latitude	Longitude	DLS [°/100ft]	Comments
14523.00†	90.000	1.588	7249.00	7216.65	6620.53	3009.74	3239604.27	1261613.41	40.0483433	-104.6441196	0.00	
14623.00†	90.000	1.588	7249.00	7312.90	6720.49	3012.51	3239606.09	1261713.39	40.0486177	-104.6441097	0.00	
14723.00†	90.000	1.588	7249.00	7409.14	6820.45	3015.28	3239607.90	1261813.37	40.0488921	-104.6440997	0.00	
14823.00†	90.000	1.588	7249.00	7505.39	6920.41	3018.05	3239609.72	1261913.35	40.0491665	-104.6440898	0.00	
14923.00†	90.000	1.588	7249.00	7601.63	7020.37	3020.82	3239611.54	1262013.33	40.0494409	-104.6440799	0.00	
15023.00†	90.000	1.588	7249.00	7697.88	7120.34	3023.59	3239613.36	1262113.31	40.0497153	-104.6440699	0.00	
15123.00†	90.000	1.588	7249.00	7794.12	7220.30	3026.36	3239615.18	1262213.29	40.0499897	-104.6440600	0.00	
15223.00†	90.000	1.588	7249.00	7890.37	7320.26	3029.13	3239617.00	1262313.27	40.0502641	-104.6440500	0.00	
15323.00†	90.000	1.588	7249.00	7986.61	7420.22	3031.90	3239618.81	1262413.25	40.0505385	-104.6440401	0.00	
15423.00†	90.000	1.588	7249.00	8082.86	7520.18	3034.68	3239620.63	1262513.23	40.0508129	-104.6440301	0.00	
15523.00†	90.000	1.588	7249.00	8179.10	7620.14	3037.45	3239622.45	1262613.21	40.0510873	-104.6440202	0.00	
15623.00†	90.000	1.588	7249.00	8275.35	7720.11	3040.22	3239624.27	1262713.19	40.0513617	-104.6440103	0.00	
15723.00†	90.000	1.588	7249.00	8371.59	7820.07	3042.99	3239626.09	1262813.17	40.0516361	-104.6440003	0.00	
15823.00†	90.000	1.588	7249.00	8467.84	7920.03	3045.76	3239627.91	1262913.15	40.0519105	-104.6439904	0.00	
15923.00†	90.000	1.588	7249.00	8564.08	8019.99	3048.53	3239629.72	1263013.13	40.0521849	-104.6439804	0.00	
16023.00†	90.000	1.588	7249.00	8660.33	8119.95	3051.30	3239631.54	1263113.11	40.0524593	-104.6439705	0.00	
16123.00†	90.000	1.588	7249.00	8756.57	8219.91	3054.07	3239633.36	1263213.09	40.0527337	-104.6439605	0.00	
16223.00†	90.000	1.588	7249.00	8852.82	8319.87	3056.85	3239635.18	1263313.07	40.0530081	-104.6439506	0.00	
16323.00†	90.000	1.588	7249.00	8949.06	8419.84	3059.62	3239637.00	1263413.05	40.0532825	-104.6439407	0.00	
16423.00†	90.000	1.588	7249.00	9045.31	8519.80	3062.39	3239638.82	1263513.03	40.0535569	-104.6439307	0.00	
16523.00†	90.000	1.588	7249.00	9141.55	8619.76	3065.16	3239640.63	1263613.00	40.0538313	-104.6439208	0.00	
16623.00†	90.000	1.588	7249.00	9237.80	8719.72	3067.93	3239642.45	1263712.98	40.0541057	-104.6439108	0.00	
16723.00†	90.000	1.588	7249.00	9334.04	8819.68	3070.70	3239644.27	1263812.96	40.0543801	-104.6439009	0.00	
16823.00†	90.000	1.588	7249.00	9430.29	8919.64	3073.47	3239646.09	1263912.94	40.0546545	-104.6438909	0.00	
16923.00†	90.000	1.588	7249.00	9526.53	9019.61	3076.24	3239647.91	1264012.92	40.0549289	-104.6438810	0.00	
17023.00†	90.000	1.588	7249.00	9622.78	9119.57	3079.02	3239649.73	1264112.90	40.0552033	-104.6438711	0.00	
17123.00†	90.000	1.588	7249.00	9719.03	9219.53	3081.79	3239651.54	1264212.88	40.0554777	-104.6438611	0.00	
17223.00†	90.000	1.588	7249.00	9815.27	9319.49	3084.56	3239653.36	1264312.86	40.0557521	-104.6438512	0.00	
17323.00†	90.000	1.588	7249.00	9911.52	9419.45	3087.33	3239655.18	1264412.84	40.0560265	-104.6438412	0.00	
17423.00†	90.000	1.588	7249.00	10007.76	9519.41	3090.10	3239657.00	1264512.82	40.0563009	-104.6438313	0.00	

Planned Wellpath Report

CANAL 22-2-2L PWP Rev-A.0

Page 8 of 10

REFERENCE WELLPATH IDENTIFICATION

Operator	CONFLUENCE RESOURCES	Well	CANAL 22-2-2L
Field	WELD COUNTY (NAD83, TRUE NORTH)	API/Legal	
Facility	SEC.22-T01N-R65W	Wellbore	CANAL 22-2-2L PWB
Slot	SLOT#15 CANAL 22-2-2L (185'FSL & 1321'FWL,SEC.22)		

WELLPATH DATA (185 stations) † = interpolated, ‡ = extrapolated station

MD [ft]	Inclination [°]	Azimuth [°]	TVD [ft]	Vert Sect [ft]	North [ft]	East [ft]	Grid East [US ft]	Grid North [US ft]	Latitude	Longitude	DLS [°/100ft]	Comments
17523.00†	90.000	1.588	7249.00	10104.01	9619.38	3092.87	3239658.82	1264612.80	40.0565753	-104.6438213	0.00	
17623.00†	90.000	1.588	7249.00	10200.25	9719.34	3095.64	3239660.64	1264712.78	40.0568497	-104.6438114	0.00	
17723.00†	90.000	1.588	7249.00	10296.50	9819.30	3098.41	3239662.45	1264812.76	40.0571241	-104.6438014	0.00	
17823.00†	90.000	1.588	7249.00	10392.74	9919.26	3101.19	3239664.27	1264912.74	40.0573985	-104.6437915	0.00	
17838.11	90.000	1.588	7249.00 [‡]	10407.28	9934.36	3101.60	3239664.55	1264927.85	40.0574400	-104.6437900	0.00	TD

HOLE & CASING SECTIONS - Ref Wellbore: CANAL 22-2-2L PWB Ref Wellpath: CANAL 22-2-2L PWP Rev-A.0

String/Diameter	Start MD [ft]	End MD [ft]	Interval [ft]	Start TVD [ft]	End TVD [ft]	Start N/S [ft]	Start E/W [ft]	End N/S [ft]	End E/W [ft]
9.625in Casing Surface	23.00	1550.00	1527.00	23.00	1526.65	0.00	0.00	-20.96	189.12

REFERENCE WELLPATH IDENTIFICATION

Operator	CONFLUENCE RESOURCES	Well	CANAL 22-2-2L
Field	WELD COUNTY (NAD83, TRUE NORTH)	API/Legal	
Facility	SEC.22-T01N-R65W	Wellbore	CANAL 22-2-2L PWB
Slot	SLOT#15 CANAL 22-2-2L (185'FSL & 1321'FWL,SEC.22)		

TARGETS

Name	MD [ft]	TVD [ft]	North [ft]	East [ft]	Grid East [US ft]	Grid North [US ft]	Latitude	Longitude	Shape
SEC.15/22-T01N-R65W (SB 460')	N/A	6.50	0.00	-274.44	3236383.46	1254962.14	40.0301700	-104.6558500	polygon
	2D Polygon: dimensions not calculated								
SEC.15-T01N-R65W	N/A	10.00	0.00	-274.44	3236383.46	1254962.14	40.0301700	-104.6558500	polygon
	2D Polygon: dimensions not calculated								
SEC.22-T01N-R65W	N/A	10.00	0.00	-274.44	3236383.46	1254962.14	40.0301700	-104.6558500	polygon
	2D Polygon: dimensions not calculated								
2) CANAL 22-2-2L BHL REV-1 (470'FNL & 920'FEL,SEC.15)	17838.11	7249.00	9934.36	3101.60	3239664.55	1264927.85	40.0574400	-104.6437900	point
1) CANAL 22-2-2L LP REV-1 (470'FSL & 1120'FEL,SEC.22)	8180.70	7249.00	280.66	2833.98	3239488.94	1255272.40	40.0309400	-104.6447500	point

SURVEY PROGRAM - Ref Wellbore: CANAL 22-2-2L PWB Ref Wellpath: CANAL 22-2-2L PWP Rev-A.0

Start MD [ft]	End MD [ft]	Positional Uncertainty Model	Log Name/Comment	Wellbore
23.00	1550.00	BH NaviTrak (2019) (Axial)		CANAL 22-2-2L PWB
1550.00	17838.11	BH AutoTrak Curve/eXpress (2019) (Short spacing)		CANAL 22-2-2L PWB

Planned Wellpath Report

CANAL 22-2-2L PWP Rev-A.0

Page 10 of 10

REFERENCE WELLPATH IDENTIFICATION

Operator	CONFLUENCE RESOURCES	Well	CANAL 22-2-2L
Field	WELD COUNTY (NAD83, TRUE NORTH)	API/Legal	
Facility	SEC.22-T01N-R65W	Wellbore	CANAL 22-2-2L PWB
Slot	SLOT#15 CANAL 22-2-2L (185'FSL & 1321'FWL,SEC.22)		

DESIGN COMMENTS

MD [ft]	Inclination [°]	Azimuth [°]	TVD [ft]	Comment
23.00	0.000	96.325	23.00	Tie On
500.00	0.000	96.325	500.00	End of Tangent
1743.13	24.863	96.325	1704.48	Build (XS)
7260.80	24.863	96.325	6710.77	KOP
8180.70	90.000	1.588	7249.00	LANDING
17838.11	90.000	1.588	7249.00	TD