

Inspection Photos

Loc#335508

Operator: Terra

Insp#: 692402639

Insp Date: 10/29/20



COLORADO
Oil & Gas Conservation
Commission
Department of Natural Resources



Photo#1:
Overview of Location to North.

October 29, 2020



COLORADO
Oil & Gas Conservation
Commission
Department of Natural Resources

Inspection Photos: Terra RWF Loc#335508



Photo#2:
Overview of Location to South.

October 29, 2020



COLORADO
Oil & Gas Conservation
Commission
Department of Natural Resources

Inspection Photos: Terra RWF Loc#335508

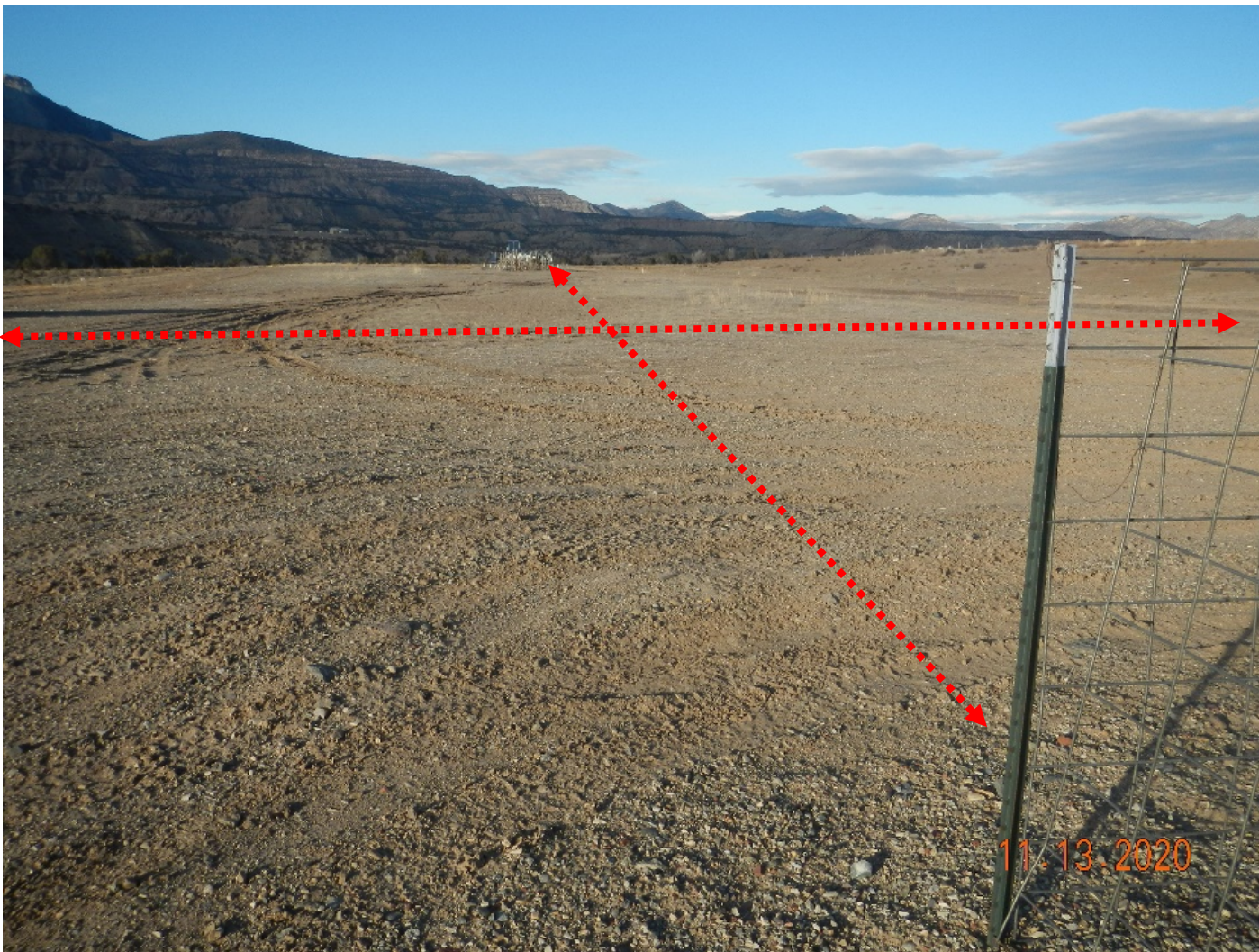

Photo#3:

View of Location to North. Approx.375 ft between equipment and wells; Pad length approx.540 ft; Pad width approx. 180 ft.

October 29, 2020



COLORADO
Oil & Gas Conservation
Commission
Department of Natural Resources

Inspection Photos: Terra RWF Loc#335508



Photo#4:
GE 2016 aerial of Location.
*



Photo#5:
COGCC 2019 aerial; vegetation visible thought to be
weed growth, not interim Veg, see 2020 Photos.

October 29, 2020



COLORADO
Oil & Gas Conservation
Commission
Department of Natural Resources

Inspection Photos: Terra RWF Loc#335508



Photo#6:
Well lineup; residue of Debris weeds.



Photo:#7
Well lineup; residue of Debris weeds.

October 29, 2020