



FORM F-106



00800738

RECEIVED

OCT 20 1974

COLD, OIL &amp; GAS COMIS. COMM.

BEST COPY  
AVAILABLE

R. 78W.

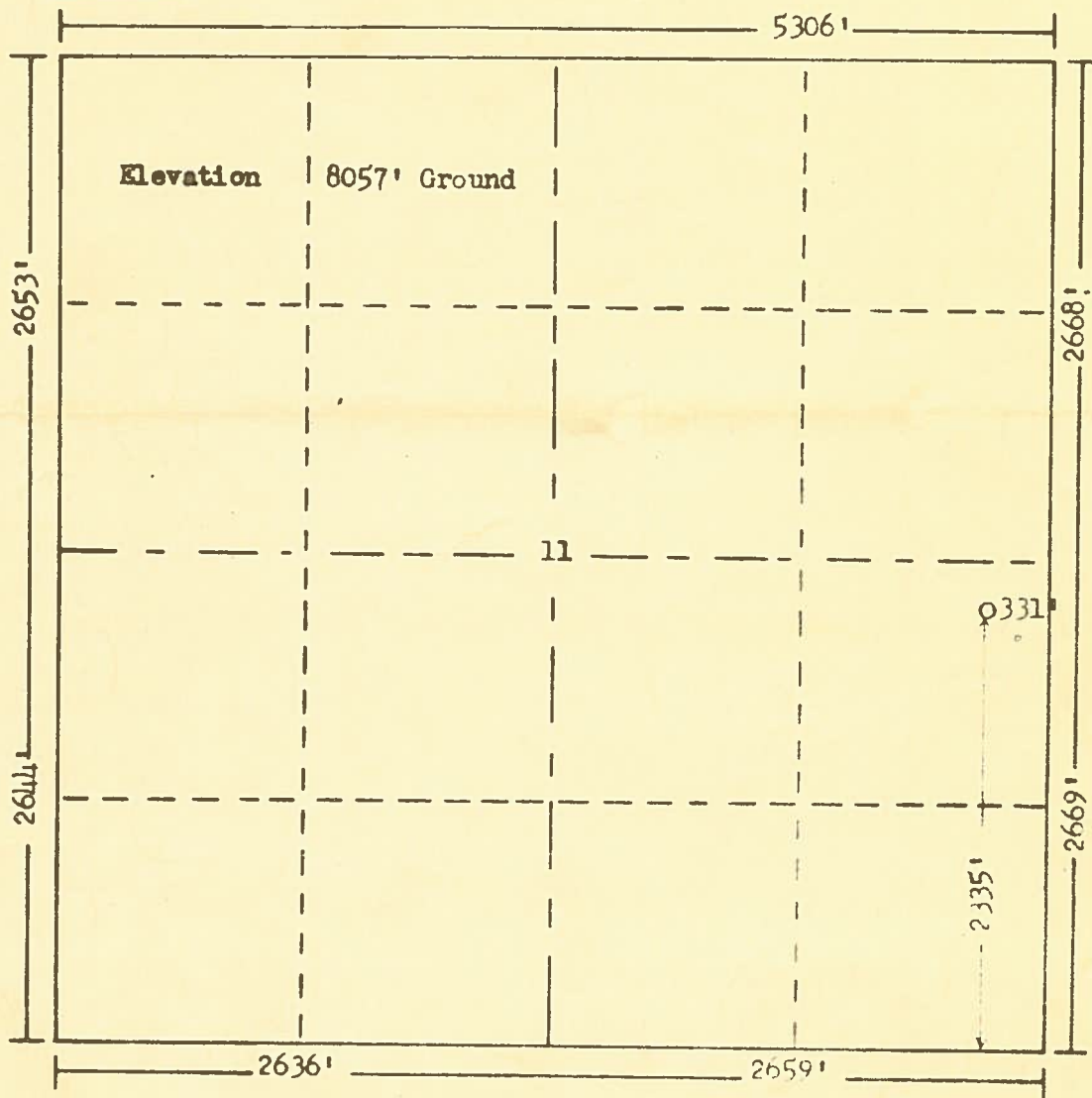
T.  
9  
N.

Scale 1" = 1000'

Powers Elevation Company, Inc. of Denver, Colorado  
has in accordance with a request from Al Markin  
for Helton Engineering  
determined the location of #1-Blevins-"A"  
to be NE NE SE Section 11 Township 9N.  
Range 78W. of the 6th. Principal Meridian  
Jackson County, Colorado

I hereby certify that this plat is an  
accurate representation of a correct  
survey showing the location of  
#1-Blevins-"A"

Date: 10-1-74

*David T. White*  
Licensed Land Surveyor No. 1671  
State of Colorado

file  
13