

Location:	COLORADO	Slot:	SLOT#22 JODSTER NORTH 25-10HZ (1653'FNL & 1091'FEL,SEC.25)
Field:	LARIMER COUNTY	Well:	JODSTER NORTH 25-10HZ
Facility:	SEC.25-T5N-R68W	Wellbore:	JODSTER NORTH 25-10HZ PWB

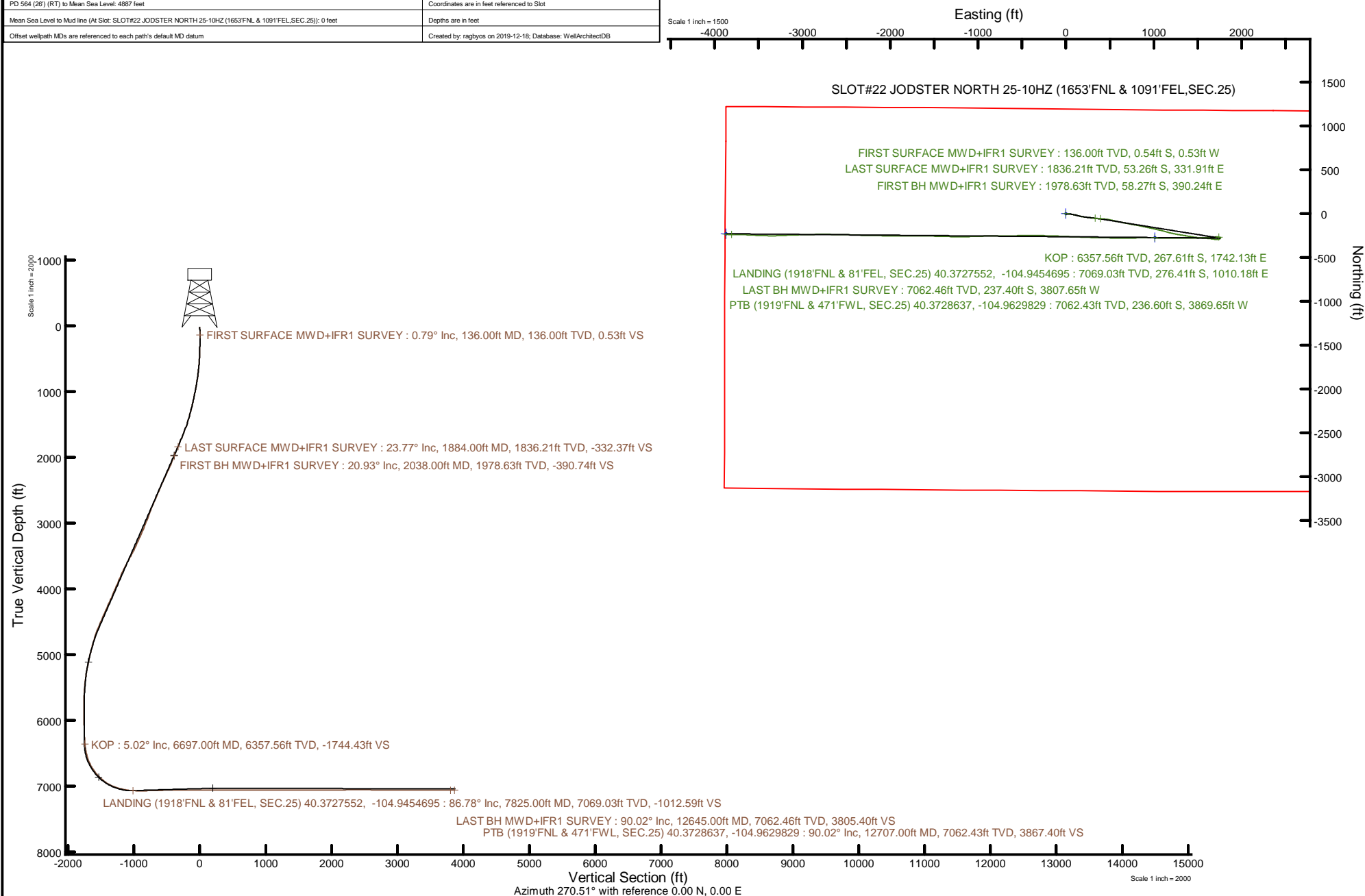

Plot reference wellpath is JODSTER NORTH 25-104Z PWP Rev A.0	Grid System: NAD83 / UTM Zone 13 North, US feet
True vertical depths are referenced to PD 564 (26) (RT)	North Reference: True north
Reference wellpath measured depths are referenced to PD 564 (26) (RT)	Scale: True distance
PD 564 (26) (RT) to Mean Sea Level: 4887 feet	Coordinates are in feet referenced to Slot
Mean Sea Level to Mud line (At Slot: SLOT#22_JODSTER NORTH 25-104Z (1653FNL & 1091FEL_SEC.25)): 0 feet	Depths are in feet
Offset wellpath MDs are referenced to each path's default MD datum	Created by: raybos on 2019-12-18; Database: WellArchitectDB



# Actual Wellpath Report

JODSTER NORTH 25-10HZ AWP

Page 1 of 6

## REFERENCE WELLPATH IDENTIFICATION

Operator	KERR-MCGEE OIL & GAS ONSHORE LP (WA)	Well	JODSTER NORTH 25-10HZ
Field	LARIMER COUNTY	API/Legal	
Facility	SEC.25-T5N-R68W	Wellbore	JODSTER NORTH 25-10HZ AWB
Slot	SLOT#22 JODSTER NORTH 25-10HZ (1653'FNL & 1091'FEL,SEC.25)		

## REPORT SETUP INFORMATION

Projection System	NAD83 / UTM Zone 13 North, US feet	Software System	WellArchitect® 6.0
North Reference	True	User	Ragbyos
Scale	0.999600	Report Generated	12/18/2019 at 2:34:45 PM
Convergence at slot	0.03° East	Database	WellArchitectDB

## WELLPATH LOCATION

	Local coordinates		Grid coordinates		Geographic coordinates	
	North[ft]	East[ft]	Easting[US ft]	Northing[US ft]	Latitude	Longitude
Slot Location	547.52	-379.71	1654594.68	14662753.50	40.3735140°	-104.9490950°
Facility Reference Pt			1654974.57	14662206.42	40.3720111°	-104.9477322°
Field Reference Pt			0.00	0.00	0.0000000°	-109.4887439°

## WELLPATH DATUM

Calculation method	Minimum curvature	PD 564 (26') (RT) to Facility Vertical Datum	4887.00ft
Horizontal Reference Pt	Slot	PD 564 (26') (RT) to Mean Sea Level	4887.00ft
Vertical Reference Pt	PD 564 (26') (RT)	PD 564 (26') (RT) to Mud Line at Slot (SLOT#22 JODSTER NORTH 25-10HZ (1653'FNL & 1091'FEL,SEC.25))	4887.00ft
MD Reference Pt	PD 564 (26') (RT)	Section Origin	N 0.00, E 0.00 ft
Field Vertical Reference	Mean Sea Level	Section Azimuth	270.51°

# Actual Wellpath Report

JODSTER NORTH 25-10HZ AWP

Page 2 of 6

## REFERENCE WELLPATH IDENTIFICATION

Operator	KERR-MCGEE OIL & GAS ONSHORE LP (WA)	Well	JODSTER NORTH 25-10HZ
Field	LARIMER COUNTY	API/Legal	
Facility	SEC.25-T5N-R68W	Wellbore	JODSTER NORTH 25-10HZ AWP
Slot	SLOT#22 JODSTER NORTH 25-10HZ (1653'FNL & 1091'FEL,SEC.25)		

## WELLPATH DATA (145 stations) † = interpolated, ‡ = extrapolated station

MD [ft]	Inclination [°]	Azimuth [°]	TVD [ft]	Vert Sect [ft]	North [ft]	East [ft]	Grid East [US ft]	Grid North [US ft]	Latitude	Longitude	DLS [°/100ft]	Comments
0.00†	0.000	224.380	0.00	0.00	0.00	0.00	1654594.68	14662753.50	40.3735140	-104.9490950	0.00	
26.00	0.000	224.380	26.00	0.00	0.00	0.00	1654594.68	14662753.50	40.3735140	-104.9490950	0.00	
136.00	0.790	224.380	136.00	0.53	-0.54	-0.53	1654594.15	14662752.95	40.3735125	-104.9490969	0.72	FIRST SURFACE MWD+IFR1 SURVEY
232.00	0.440	177.800	231.99	0.97	-1.38	-0.98	1654593.70	14662752.11	40.3735102	-104.9490985	0.61	
327.00	1.540	114.600	326.98	-0.22	-2.28	0.20	1654594.88	14662751.22	40.3735077	-104.9490943	1.47	
423.00	2.550	107.040	422.92	-3.44	-3.44	3.41	1654598.09	14662750.06	40.3735046	-104.9490828	1.09	
517.00	3.380	96.850	516.79	-8.20	-4.39	8.16	1654602.84	14662749.12	40.3735020	-104.9490657	1.04	
612.00	4.750	93.600	611.55	-14.91	-4.97	14.87	1654609.55	14662748.54	40.3735004	-104.9490416	1.46	
707.00	6.860	90.080	706.06	-24.51	-5.22	24.47	1654619.14	14662748.29	40.3734997	-104.9490072	2.25	
802.00	8.130	88.850	800.24	-36.90	-5.09	36.86	1654631.53	14662748.42	40.3735000	-104.9489627	1.35	
897.00	10.590	95.530	893.97	-52.32	-5.80	52.27	1654646.93	14662747.73	40.3734981	-104.9489074	2.83	
993.00	11.340	101.240	988.22	-70.38	-8.49	70.30	1654664.96	14662745.05	40.3734907	-104.9488427	1.37	
1088.00	11.910	100.720	1081.27	-89.20	-12.13	89.10	1654683.75	14662741.42	40.3734807	-104.9487752	0.61	
1183.00	13.270	102.650	1173.99	-109.51	-16.35	109.37	1654704.02	14662737.22	40.3734691	-104.9487025	1.50	
1278.00	14.190	106.690	1266.27	-131.35	-22.08	131.16	1654725.80	14662731.50	40.3734534	-104.9486243	1.40	
1374.00	15.600	102.910	1359.05	-155.26	-28.34	155.02	1654749.65	14662725.25	40.3734362	-104.9485387	1.78	
1469.00	17.140	100.450	1450.20	-181.53	-33.74	181.23	1654775.86	14662719.88	40.3734214	-104.9484446	1.78	
1564.00	21.230	96.670	1539.90	-212.43	-38.27	212.10	1654806.72	14662715.36	40.3734089	-104.9483338	4.50	
1658.00	21.090	97.110	1627.57	-246.15	-42.34	245.79	1654840.39	14662711.31	40.3733978	-104.9482129	0.23	
1754.00	22.680	97.460	1716.64	-281.68	-46.89	281.28	1654875.87	14662706.79	40.3733853	-104.9480855	1.66	
1848.00	23.250	97.290	1803.19	-318.10	-51.59	317.65	1654912.23	14662702.11	40.3733724	-104.9479550	0.61	
1884.00	23.770	96.060	1836.21	-332.37	-53.26	331.91	1654926.49	14662700.45	40.3733678	-104.9479038	1.99	LAST SURFACE MWD+IFR1 SURVEY
2038.00	20.930	93.600	1978.63	-390.74	-58.27	390.24	1654984.80	14662695.48	40.3733541	-104.9476944	1.94	FIRST BH MWD+IFR1 SURVEY
2127.00	21.860	93.670	2061.49	-423.16	-60.32	422.64	1655017.19	14662693.44	40.3733484	-104.9475781	1.05	
2216.00	23.970	95.970	2143.47	-457.71	-63.27	457.16	1655051.70	14662690.52	40.3733403	-104.9474543	2.58	
2305.00	25.420	102.050	2224.34	-494.43	-69.13	493.83	1655088.36	14662684.67	40.3733242	-104.9473227	3.28	
2395.00	25.380	102.510	2305.64	-532.22	-77.35	531.55	1655126.07	14662676.49	40.3733017	-104.9471873	0.22	
2484.00	25.120	102.600	2386.13	-569.35	-85.60	568.61	1655163.11	14662668.26	40.3732790	-104.9470543	0.30	
2574.00	23.250	101.560	2468.23	-605.46	-93.33	604.66	1655199.15	14662660.56	40.3732578	-104.9469249	2.13	
2663.00	22.900	101.940	2550.11	-639.68	-100.43	638.81	1655233.29	14662653.48	40.3732383	-104.9468023	0.43	
2752.00	23.880	100.830	2631.80	-674.37	-107.40	673.45	1655267.92	14662646.53	40.3732192	-104.9466780	1.21	
2842.00	24.240	101.470	2713.98	-710.43	-114.49	709.45	1655303.91	14662639.46	40.3731997	-104.9465488	0.49	
2931.00	21.210	100.940	2796.06	-744.21	-121.18	743.17	1655337.62	14662632.79	40.3731813	-104.9464278	3.41	
3021.00	20.660	100.580	2880.12	-775.85	-127.19	774.76	1655369.20	14662626.80	40.3731648	-104.9463144	0.63	
3110.00	20.670	100.460	2963.39	-806.78	-132.92	805.64	1655400.07	14662621.09	40.3731491	-104.9462036	0.05	
3200.00	22.300	99.820	3047.13	-839.28	-138.72	838.09	1655432.51	14662615.32	40.3731332	-104.9460871	1.83	
3289.00	24.460	102.500	3128.82	-873.97	-145.59	872.72	1655467.13	14662608.47	40.3731143	-104.9459629	2.70	
3378.00	24.360	101.560	3209.87	-910.01	-153.25	908.69	1655503.09	14662600.83	40.3730933	-104.9458338	0.45	
3468.00	24.510	100.990	3291.81	-946.59	-160.53	945.20	1655539.59	14662593.57	40.3730733	-104.9457027	0.31	
3557.00	25.680	103.280	3372.41	-983.55	-168.48	982.09	1655576.48	14662585.65	40.3730515	-104.9455703	1.71	
3647.00	28.810	103.100	3452.41	-1023.74	-177.88	1022.20	1655616.58	14662576.28	40.3730257	-104.9454264	3.48	
3736.00	28.980	103.800	3530.33	-1065.65	-187.88	1064.03	1655658.39	14662566.30	40.3729982	-104.9452763	0.43	
3826.00	28.960	105.000	3609.07	-1107.97	-198.72	1106.25	1655700.60	14662555.49	40.3729685	-104.9451247	0.65	
3915.00	27.450	104.950	3687.50	-1148.70	-209.59	1146.88	1655741.22	14662544.65	40.3729386	-104.9449789	1.70	
4005.00	24.110	102.950	3768.53	-1186.75	-219.06	1184.85	1655779.18	14662535.20	40.3729126	-104.9448426	3.83	

# Actual Wellpath Report

JODSTER NORTH 25-10HZ AWP

Page 3 of 6

## REFERENCE WELLPATH IDENTIFICATION

Operator	KERR-MCGEE OIL & GAS ONSHORE LP (WA)	Well	JODSTER NORTH 25-10HZ
Field	LARIMER COUNTY	API/Legal	
Facility	SEC.25-T5N-R68W	Wellbore	JODSTER NORTH 25-10HZ AWP
Slot	SLOT#22 JODSTER NORTH 25-10HZ (1653'FNL & 1091'FEL,SEC.25)		

## WELLPATH DATA (145 stations) † = interpolated, ‡ = extrapolated station

MD [ft]	Inclination [°]	Azimuth [°]	TVD [ft]	Vert Sect [ft]	North [ft]	East [ft]	Grid East [US ft]	Grid North [US ft]	Latitude	Longitude	DLS [°/100ft]	Comments
4095.00	23.460	102.790	3850.89	-1222.20	227.15	1220.24	1655814.56	14662527.14	40.3728904	-104.9447156	0.73	
4184.00	23.680	99.790	3932.47	-1257.15	234.11	1255.13	1655849.44	14662520.20	40.3728713	-104.9445904	1.37	
4273.00	23.250	99.060	4014.11	-1292.16	239.92	1290.08	1655884.39	14662514.42	40.3728554	-104.9444650	0.58	
4363.00	23.340	99.050	4096.77	-1327.36	245.52	1325.23	1655919.52	14662508.84	40.3728400	-104.9443388	0.10	
4452.00	24.760	101.120	4178.04	-1363.11	251.89	1360.93	1655955.21	14662502.49	40.3728225	-104.9442107	1.86	
4542.00	23.760	99.390	4260.10	-1399.55	258.48	1397.32	1655991.59	14662495.92	40.3728044	-104.9440801	1.36	
4631.00	24.430	98.320	4341.34	-1435.50	264.07	1433.22	1656027.47	14662490.36	40.3727890	-104.9439513	0.90	
4721.00	23.500	97.920	4423.58	-1471.73	269.23	1469.41	1656063.65	14662485.22	40.3727749	-104.9438214	1.05	
4811.00	23.770	95.250	4506.03	-1507.61	273.37	1505.24	1656099.47	14662481.11	40.3727635	-104.9436928	1.23	
4900.00	21.450	94.200	4588.19	-1541.72	276.20	1539.34	1656133.56	14662478.29	40.3727557	-104.9435704	2.65	
4990.00	20.470	94.830	4672.23	-1573.84	278.73	1571.43	1656165.64	14662475.78	40.3727488	-104.9434552	1.12	
5079.00	16.390	94.030	4756.65	-1601.90	280.92	1599.48	1656193.68	14662473.61	40.3727427	-104.9433546	4.59	
5168.00	15.370	96.120	4842.25	-1626.18	283.06	1623.73	1656217.92	14662471.48	40.3727369	-104.9432675	1.31	
5258.00	14.430	97.810	4929.23	-1649.17	285.86	1646.70	1656240.88	14662468.70	40.3727292	-104.9431851	1.15	
5347.00	13.250	98.630	5015.64	-1670.27	288.90	1667.77	1656261.95	14662465.67	40.3727209	-104.9431095	1.34	
5462.00	11.850	97.010	5127.89	-1695.05	292.31	1692.52	1656286.69	14662462.27	40.3727115	-104.9430207	1.26	
5552.00	10.550	90.110	5216.18	-1712.47	293.46	1709.93	1656304.10	14662461.14	40.3727083	-104.9429582	2.07	
5641.00	8.220	81.610	5303.99	-1726.90	292.55	1724.38	1656318.53	14662462.06	40.3727108	-104.9429063	3.04	
5731.00	6.810	81.370	5393.21	-1738.53	290.81	1736.02	1656330.17	14662463.80	40.3727156	-104.9428645	1.57	
5820.00	5.650	68.530	5481.69	-1747.80	288.41	1745.31	1656339.46	14662466.20	40.3727222	-104.9428312	2.03	
5909.00	4.050	59.870	5570.37	-1754.57	285.23	1752.11	1656346.25	14662469.39	40.3727309	-104.9428068	1.97	
5999.00	2.870	49.110	5660.20	-1758.99	282.16	1756.56	1656350.70	14662472.46	40.3727393	-104.9427908	1.49	
6088.00	2.110	36.200	5749.12	-1761.62	279.38	1759.21	1656353.35	14662475.24	40.3727470	-104.9427813	1.06	
6178.00	1.680	17.130	5839.07	-1762.97	276.78	1760.58	1656354.71	14662477.84	40.3727541	-104.9427764	0.84	
6267.00	2.140	322.400	5928.03	-1762.31	274.22	1759.95	1656354.08	14662480.40	40.3727611	-104.9427786	2.03	
6357.00	2.440	306.770	6017.96	-1759.73	271.74	1757.39	1656351.52	14662482.88	40.3727679	-104.9427878	0.77	
6446.00	2.410	284.740	6106.88	-1756.39	270.13	1754.06	1656348.20	14662484.48	40.3727723	-104.9427998	1.04	
6535.00	2.260	286.350	6195.81	-1752.89	269.16	1750.57	1656344.70	14662485.45	40.3727750	-104.9428123	0.18	
6625.00	2.600	280.800	6285.72	-1749.17	268.28	1746.86	1656341.00	14662486.33	40.3727774	-104.9428256	0.46	
6697.00†	5.017	276.601	6357.56	-1744.43	267.61	1742.13	1656336.27	14662487.00	40.3727793	-104.9428426	3.38	KOP
6714.00	5.590	276.140	6374.49	-1742.87	267.43	1740.57	1656334.70	14662487.17	40.3727797	-104.9428482	3.38	
6804.00	11.150	272.690	6463.49	-1729.80	266.56	1727.51	1656321.65	14662488.04	40.3727822	-104.9428951	6.20	
6893.00	15.660	267.780	6550.05	-1709.19	266.62	1706.90	1656301.05	14662487.97	40.3727820	-104.9429691	5.22	
6983.00	22.850	266.580	6634.96	-1679.59	268.13	1677.28	1656271.44	14662486.44	40.3727778	-104.9430754	8.00	
7072.00	31.140	267.990	6714.19	-1639.29	269.97	1636.96	1656231.14	14662484.57	40.3727728	-104.9432201	9.34	
7162.00	37.640	266.510	6788.43	-1588.57	272.47	1586.22	1656180.42	14662482.05	40.3727660	-104.9434022	7.28	
7251.00	44.020	267.090	6855.73	-1530.53	275.69	1528.15	1656122.37	14662478.79	40.3727571	-104.9436106	7.18	
7341.00	51.200	267.950	6916.37	-1464.19	278.54	1461.78	1656056.04	14662475.91	40.3727493	-104.9438488	8.01	
7431.00	60.420	268.530	6966.89	-1389.89	280.80	1387.45	1655981.74	14662473.60	40.3727431	-104.9441155	10.26	
7520.00	69.260	270.280	7004.69	-1309.43	281.59	1306.98	1655901.30	14662472.77	40.3727410	-104.9444043	10.09	
7609.00	73.680	270.580	7032.97	-1225.06	280.96	1222.62	1655816.97	14662473.35	40.3727427	-104.9447071	4.98	
7699.00	79.390	271.520	7053.92	-1137.58	279.35	1135.15	1655729.53	14662474.91	40.3727471	-104.9450210	6.43	
7788.00	84.650	271.290	7066.27	-1049.48	277.19	1047.07	1655641.49	14662477.02	40.3727531	-104.9453372	5.92	
7825.00†	86.783	271.119	7069.03	-1012.59	276.41	1010.18	1655604.61	14662477.78	40.3727552	-104.9454695	5.78	LANDING (1918'FNL & 81'FEL, SEC.25) 40.3727552, -104.9454695
7877.00	89.780	270.880	7070.59	-960.62	275.50	958.22	1655552.67	14662478.65	40.3727577	-104.9456560	5.78	

# Actual Wellpath Report

JODSTER NORTH 25-10HZ AWP

Page 4 of 6

## REFERENCE WELLPATH IDENTIFICATION

Operator	KERR-MCGEE OIL & GAS ONSHORE LP (WA)	Well	JODSTER NORTH 25-10HZ
Field	LARIMER COUNTY	API/Legal	
Facility	SEC.25-T5N-R68W	Wellbore	JODSTER NORTH 25-10HZ AWB
Slot	SLOT#22 JODSTER NORTH 25-10HZ (1653'FNL & 1091'FEL,SEC.25)		

## WELLPATH DATA (145 stations)

MD [ft]	Inclination [°]	Azimuth [°]	TVD [ft]	Vert Sect [ft]	North [ft]	East [ft]	Grid East [US ft]	Grid North [US ft]	Latitude	Longitude	DLS [°/100ft]	Comments
7967.00	90.220	269.150	7070.59	-870.63	-275.48	868.22	1655462.71	14662478.62	40.3727578	-104.9459790	1.98	
8056.00	90.990	268.600	7069.65	-781.67	-277.23	779.24	1655373.77	14662476.83	40.3727530	-104.9462983	1.06	
8146.00	92.160	270.170	7067.18	-691.73	-278.19	689.29	1655283.85	14662475.81	40.3727504	-104.9466212	2.18	
8235.00	91.380	270.530	7064.43	-602.77	-277.65	600.33	1655194.93	14662476.30	40.3727519	-104.9469404	0.97	
8325.00	90.960	270.600	7062.59	-512.79	-276.76	510.35	1655104.99	14662477.14	40.3727543	-104.9472634	0.47	
8414.00	91.780	270.540	7060.46	-423.81	-275.88	421.39	1655016.06	14662477.97	40.3727567	-104.9475827	0.92	
8504.00	90.670	272.050	7058.54	-333.85	-273.84	331.43	1654926.14	14662479.95	40.3727623	-104.9479055	2.08	
8593.00	89.610	272.720	7058.32	-244.90	-270.14	242.51	1654837.25	14662483.60	40.3727725	-104.9482246	1.41	
8683.00	89.050	271.980	7059.38	-154.95	-266.45	152.59	1654747.37	14662487.24	40.3727826	-104.9485473	1.03	
8772.00	90.160	272.910	7059.99	-66.01	-262.65	63.68	1654658.49	14662490.98	40.3727930	-104.9488665	1.63	
8862.00	90.250	272.060	7059.67	23.94	-258.75	-26.23	1654568.61	14662494.83	40.3728037	-104.9491892	0.95	
8951.00	89.470	271.830	7059.88	112.91	-255.73	-115.18	1654479.69	14662497.80	40.3728120	-104.9495084	0.91	
9040.00	89.900	271.940	7060.37	201.88	-252.80	-204.13	1654390.78	14662500.68	40.3728201	-104.9498276	0.50	
9130.00	89.350	270.980	7060.96	291.87	-250.51	-294.10	1654300.85	14662502.92	40.3728264	-104.9501505	1.23	
9219.00	90.320	271.220	7061.22	380.86	-248.80	-383.08	1654211.90	14662504.57	40.3728311	-104.9504699	1.12	
9309.00	90.120	268.260	7060.87	470.84	-249.21	-473.07	1654121.95	14662504.11	40.3728299	-104.9507928	3.30	
9398.00	91.470	268.260	7059.64	559.76	-251.91	-562.02	1654033.03	14662501.36	40.3728225	-104.9511120	1.52	
9488.00	90.760	269.710	7057.89	649.71	-253.51	-651.98	1653943.11	14662499.72	40.3728181	-104.9514349	1.79	
9577.00	89.300	269.720	7057.84	738.70	-253.95	-740.98	1653854.15	14662499.22	40.3728169	-104.9517543	1.64	
9667.00	89.930	269.130	7058.45	828.68	-254.85	-830.97	1653764.19	14662498.27	40.3728144	-104.9520773	0.96	
9756.00	88.440	268.880	7059.71	917.64	-256.40	-919.95	1653675.25	14662496.67	40.3728102	-104.9523966	1.70	
9846.00	89.020	268.260	7061.71	1007.56	-258.64	-1009.90	1653585.34	14662494.37	40.3728040	-104.9527195	0.94	
9935.00	89.810	267.630	7062.61	1096.47	-261.83	-1098.83	1653496.44	14662491.13	40.3727952	-104.9530386	1.14	
10025.00	90.720	269.970	7062.20	1186.42	-263.72	-1188.81	1653406.51	14662489.20	40.3727900	-104.9533615	2.79	
10114.00	89.960	271.190	7061.67	1275.42	-262.82	-1277.80	1653317.55	14662490.05	40.3727925	-104.9536809	1.61	
10204.00	91.240	271.650	7060.73	1365.40	-260.59	-1367.76	1653227.62	14662492.22	40.3727986	-104.9540038	1.51	
10293.00	90.350	271.690	7059.49	1454.37	-257.99	-1456.72	1653138.70	14662494.77	40.3728057	-104.9543231	1.00	
10382.00	89.610	271.470	7059.52	1543.35	-255.54	-1545.68	1653049.77	14662497.17	40.3728124	-104.9546424	0.87	
10472.00	90.580	270.930	7059.37	1633.35	-253.66	-1635.66	1652959.83	14662499.00	40.3728176	-104.9549653	1.23	
10562.00	90.120	269.690	7058.82	1723.34	-253.17	-1725.65	1652869.87	14662499.43	40.3728189	-104.9552883	1.47	
10651.00	90.950	268.990	7057.99	1812.32	-254.19	-1814.64	1652780.91	14662498.36	40.3728161	-104.9556076	1.22	
10740.00	90.150	270.040	7057.14	1901.30	-254.95	-1903.63	1652691.96	14662497.55	40.3728140	-104.9559270	1.48	
10829.00	89.560	271.400	7057.36	1990.30	-253.83	-1992.62	1652603.00	14662498.62	40.3728170	-104.9562464	1.67	
10919.00	90.410	270.830	7057.39	2080.29	-252.08	-2082.61	1652513.06	14662500.32	40.3728218	-104.9565693	1.14	
11009.00	90.120	270.880	7056.97	2170.29	-250.73	-2172.60	1652423.10	14662501.61	40.3728255	-104.9568923	0.33	
11098.00	91.660	271.260	7055.59	2259.27	-249.07	-2261.57	1652334.17	14662503.22	40.3728300	-104.9572116	1.78	
11188.00	91.250	272.510	7053.30	2349.21	-246.11	-2351.49	1652244.28	14662506.13	40.3728381	-104.9575343	1.46	
11277.00	88.530	272.310	7053.48	2438.15	-242.37	-2440.40	1652155.40	14662509.82	40.3728484	-104.9578534	3.06	
11366.00	88.610	271.510	7055.70	2527.10	-239.41	-2529.32	1652066.51	14662512.73	40.3728565	-104.9581726	0.90	
11455.00	90.080	271.000	7056.71	2616.08	-237.46	-2618.29	1651977.58	14662514.63	40.3728618	-104.9584919	1.75	
11545.00	89.010	270.410	7057.43	2706.08	-236.35	-2708.28	1651887.63	14662515.68	40.3728648	-104.9588149	1.36	
11634.00	89.650	269.790	7058.47	2795.07	-236.19	-2797.27	1651798.67	14662515.79	40.3728652	-104.9591342	1.00	
11724.00	91.150	268.770	7057.84	2885.04	-237.33	-2887.26	1651708.72	14662514.60	40.3728621	-104.9594572	2.02	
11813.00	90.080	268.220	7056.89	2973.98	-239.66	-2976.22	1651619.79	14662512.22	40.3728557	-104.9597765	1.35	
11902.00	88.240	267.920	7058.19	3062.89	-242.66	-3065.16	1651530.90	14662509.17	40.3728474	-104.9600957	2.09	

### REFERENCE WELLPATH IDENTIFICATION

Operator	KERR-MCGEE OIL & GAS ONSHORE LP (WA)	Well	JODSTER NORTH 25-10HZ
Field	LARIMER COUNTY	API/Legal	
Facility	SEC.25-T5N-R68W	Wellbore	JODSTER NORTH 25-10HZ AWB
Slot	SLOT#22 JODSTER NORTH 25-10HZ (1653'FNL & 1091'FEL,SEC.25)		

### WELLPATH DATA (145 stations) † = interpolated, ‡ = extrapolated station

MD [ft]	Inclination [°]	Azimuth [°]	TVD [ft]	Vert Sect [ft]	North [ft]	East [ft]	Grid East [US ft]	Grid North [US ft]	Latitude	Longitude	DLS [°/100ft]	Comments
11992.00	89.150	267.720	7060.24	3152.76	-246.08	-3155.07	1651441.02	14662505.70	40.3728380	-104.9604183	1.04	
12081.00	90.330	267.500	7060.64	3241.65	-249.79	-3243.99	1651352.14	14662501.94	40.3728278	-104.9607375	1.35	
12171.00	89.960	269.400	7060.42	3331.58	-252.23	-3333.95	1651262.22	14662499.45	40.3728210	-104.9610603	2.15	
12260.00	88.950	272.150	7061.26	3420.57	-251.02	-3422.93	1651173.27	14662500.60	40.3728243	-104.9613797	3.29	
12349.00	89.510	272.390	7062.46	3509.52	-247.50	-3511.85	1651084.38	14662504.07	40.3728339	-104.9616988	0.68	
12439.00	90.870	272.860	7062.16	3599.45	-243.38	-3601.75	1650994.52	14662508.14	40.3728452	-104.9620215	1.60	
12528.00	89.470	271.600	7061.90	3688.41	-239.92	-3690.68	1650905.62	14662511.55	40.3728547	-104.9623406	2.12	
12617.00	89.850	271.070	7062.42	3777.40	-237.84	-3779.66	1650816.68	14662513.57	40.3728604	-104.9626600	0.73	
12645.00	90.020	270.740	7062.46	3805.40	-237.40	-3807.65	1650788.70	14662514.00	40.3728616	-104.9627604	1.33	LAST BH MWD+IFR1 SURVEY
12707.00†	90.020	270.740	7062.43	3867.40	-236.60	-3869.65	1650726.73	14662514.77	40.3728637	-104.9629829	0.00	PTB (1919'FNL & 471'FWL, SEC.25) 40.3728637, -104.9629829

### TARGETS

Name	TVD [ft]	North [ft]	East [ft]	Grid East [US ft]	Grid North [US ft]	Latitude	Longitude	Shape
SEC.25-T5N-R68W	0.00	-547.52	379.72	1654974.57	14662206.42	40.3720111	-104.9477322	polygon
	2D Polygon: dimensions not calculated							
SEC.29-T5N-R67W	0.00	-547.52	379.72	1654974.56	14662206.42	40.3720111	-104.9477322	polygon
	2D Polygon: dimensions not calculated							
SEC.30-T5N-R67W	0.00	-547.52	379.72	1654974.56	14662206.42	40.3720111	-104.9477322	polygon
	2D Polygon: dimensions not calculated							
JODSTER NORTH 25-10HZ BHL REV-1 (1911'FNL & 470'FWL,SEC.25)	7041.00	-229.21	-3870.50	1650725.87	14662522.15	40.3728840	-104.9629860	point
JODSTER NORTH 25-10HZ HEEL REV-1 (1915'FNL & 75'FEL,SEC.25)	7068.00	-272.48	1012.84	1655607.27	14662481.70	40.3727660	-104.9454600	point
JODSTER NORTH 25-10HZ LANDBOX	7068.00	0.00	0.00	1654594.68	14662753.50	40.3735140	-104.9490950	polygon
	2D Polygon: dimensions not calculated							

### WELLPATH COMPOSITION - Ref Wellbore: JODSTER NORTH 25-10HZ AWP Ref Wellpath: JODSTER NORTH 25-10HZ AWP

Start MD [ft]	End MD [ft]	Positional Uncertainty Model	Log Name/Comment	Wellbore	Survey Date
26.00	1884.00	Custom APC ISCWSA REV 2 MWD+IFR1 (approximation)	Custom APC ISCWSA Rev-2 MWD+IFR1 <136 - 1884 >	JODSTER NORTH 25-10HZ AWB	11/15/2019
1884.00	12707.00	Custom APC ISCWSA REV 2 MWD+IFR1 (approximation)	BH Custom APC ISCWSA Rev-2 MWD+IFR1 <2038 -12645 >	JODSTER NORTH 25-10HZ AWB	12/12/2019

### REFERENCE WELLPATH IDENTIFICATION

Operator	KERR-MCGEE OIL & GAS ONSHORE LP (WA)	Well	JODSTER NORTH 25-10HZ
Field	LARIMER COUNTY	API/Legal	
Facility	SEC.25-T5N-R68W	Wellbore	JODSTER NORTH 25-10HZ AWB
Slot	SLOT#22 JODSTER NORTH 25-10HZ (1653'FNL & 1091'FEL,SEC.25)		

### WELLPATH COMMENTS

MD [ft]	Inclination [°]	Azimuth [°]	TVD [ft]	Comment
136.00	0.790	224.380	136.00	FIRST SURFACE MWD+IFR1 SURVEY
1884.00	23.770	96.060	1836.21	LAST SURFACE MWD+IFR1 SURVEY
2038.00	20.930	93.600	1978.63	FIRST BH MWD+IFR1 SURVEY
6697.00	5.017	276.601	6357.56	KOP
7825.00	86.783	271.119	7069.03	LANDING (1918'FNL & 81'FEL, SEC.25) 40.3727552, -104.9454695
12645.00	90.020	270.740	7062.46	LAST BH MWD+IFR1 SURVEY
12707.00	90.020	270.740	7062.43	PTB (1919'FNL & 471'FWL, SEC.25) 40.3728637, -104.9629829