

T10N, R78W, 6th P.M.

Gulf Exploration L.L.C.

BASIS OF BEARINGS:

US STATE PLANE 1983
CO NORTH 0501 GRID

LEASE AREA PLAN

EAGLE HILL #1-32 located
as shown in the NW1/4NE1/4
of Section 32, T10N, R78W, 6th P.M.
Jackson County, Colorado.

BASIS OF ELEVATION

NAVD88 Computed using GEOID12B
as measured using a combination of
Static and Kinematic GPS based on
an OPUS Solution Report.

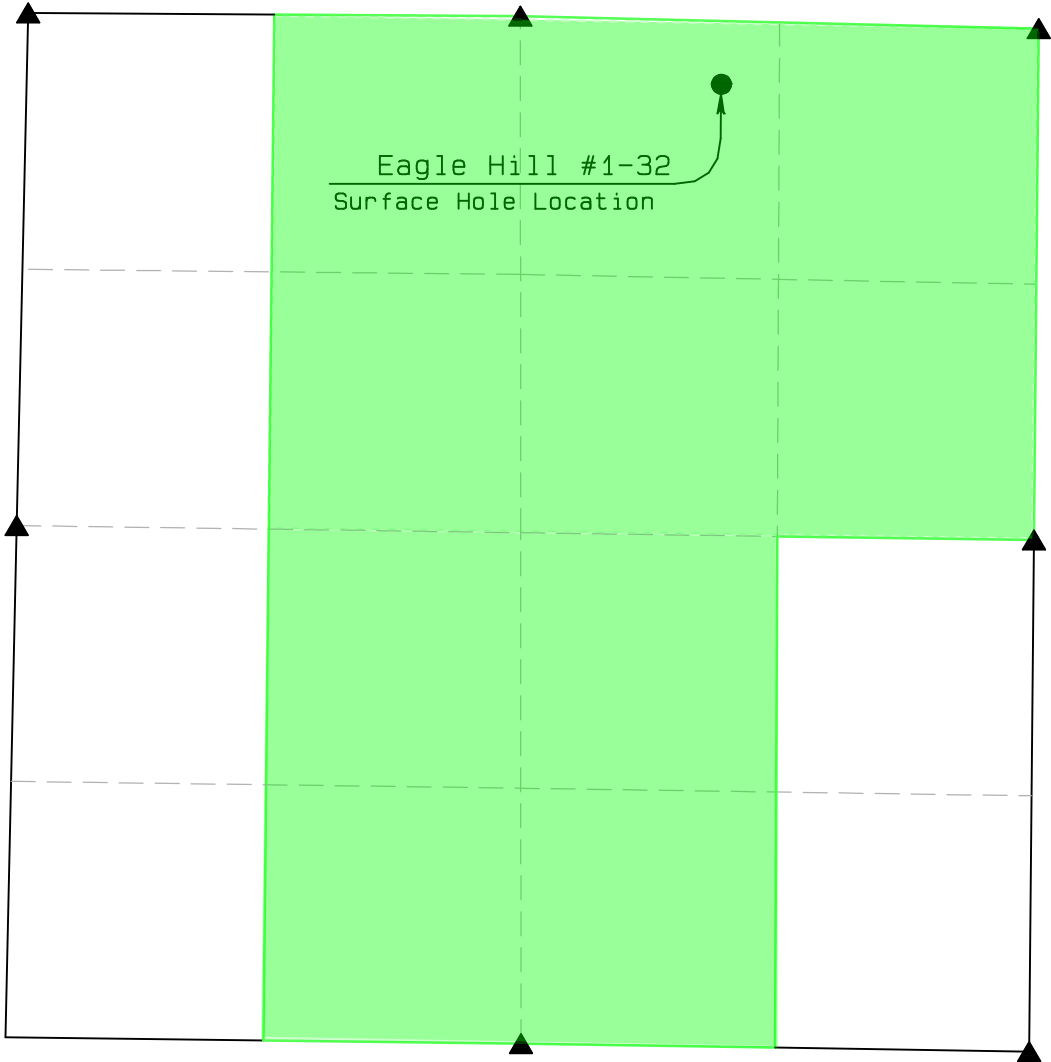

STATE OF COLORADO #110500

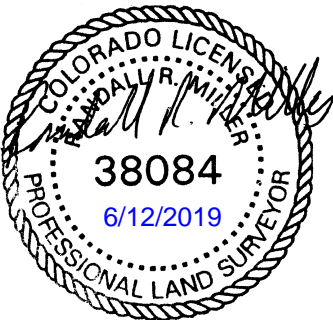

LEGEND

FOUND CORNER
PROPOSED SHL



GRAPHIC SCALE 1"=1000'



NORTH PARK ENGINEERING &
CONSULTING, INC.

P.O. BOX 395
WALDEN, CO 80480
(970) 723-3725

DATE OF FIELD WORK: JUNE 5, 2019 DRAWING COMPLETION: JUNE 7, 2019

SURVEYED BY: LEVY KURTZER DRAWN BY: ALEX LANTON CHECKED BY: RANDALL MILLER