

2115 117th Avenue
Greeley, CO 80634

Tel: 970.304.5000
Fax: 970.304.5099

www.nobleenergyinc.com



Land Department

October 31, 2018

Ms. Julie Murphy, Director
Colorado Oil and Gas Conservation Commission
1120 Lincoln Street, Suite 801
Denver, Colorado 80203

RE: **COGCC Rule 318A.e.: Proposed Spacing Unit**
C23-10 Pad: NWSE Section 23, Township 4 North, Range 64 West
Proposed Wells: Sater C23-785 (Doc# 401812511), Sater C23-775 (Doc# 401812512), Sater C23-770 (Doc# 401812513), Sater C23-765 (Doc# 401812514), Sater C23-755 (Doc# 401812515), Sater C23-750 (Doc# 401812516)
C23-08 Pad: SENE Section 23, Township 4 North, Range 64 West
Proposed Wells: Sater C23-745 (Doc# 401812518), Sater C23-735 (Doc# 401812519), Sater C23-730 (Doc# 401812520), Sater C23-725 (Doc# 401812521), Sater C23-715 (Doc# 401812522)
Weld County, Colorado

Dear Director Murphy,

Noble Energy, Inc. (Noble) is planning to drill the above referenced wells in accordance with the provisions set out in Colorado Oil and Gas Conservation Commission (COGCC) Rule 318A.e. and Noble's Final Comprehensive Drilling Plan. Noble's Proposed Spacing Unit consists of:

All of Sections 11, 14, and N/2 of Section 23 Township 4 North, Range 64 West
Containing 1,600 acres, more or less

Noble is not the only owner within the Proposed Spacing Unit and has provided notice to the remaining owners, as required by COGCC Rule 318A.e.(6). Copies of the required notification letters are on file at Noble's office. The required thirty (30) day notice period has lapsed absent the receipt by Noble of any objection to their proposal by the owners within the Proposed Spacing Unit for the subject wells.

If you have any questions or issues, please do not hesitate to contact me at (303) 228-4209 or Matthew.Otness@nblenergy.com should you have any questions.

Very truly yours,

NOBLE ENERGY, INC.

A handwritten signature in blue ink, appearing to read 'Matthew Otness'.

Matthew Otness
Land Supervisor

C23-10 PAD & C23-08 PAD
PROPOSED 318A.a.(4)D. SPACING UNIT
T4N R64W SEC. 11 & 14
T4N R64W SEC. 23: N2

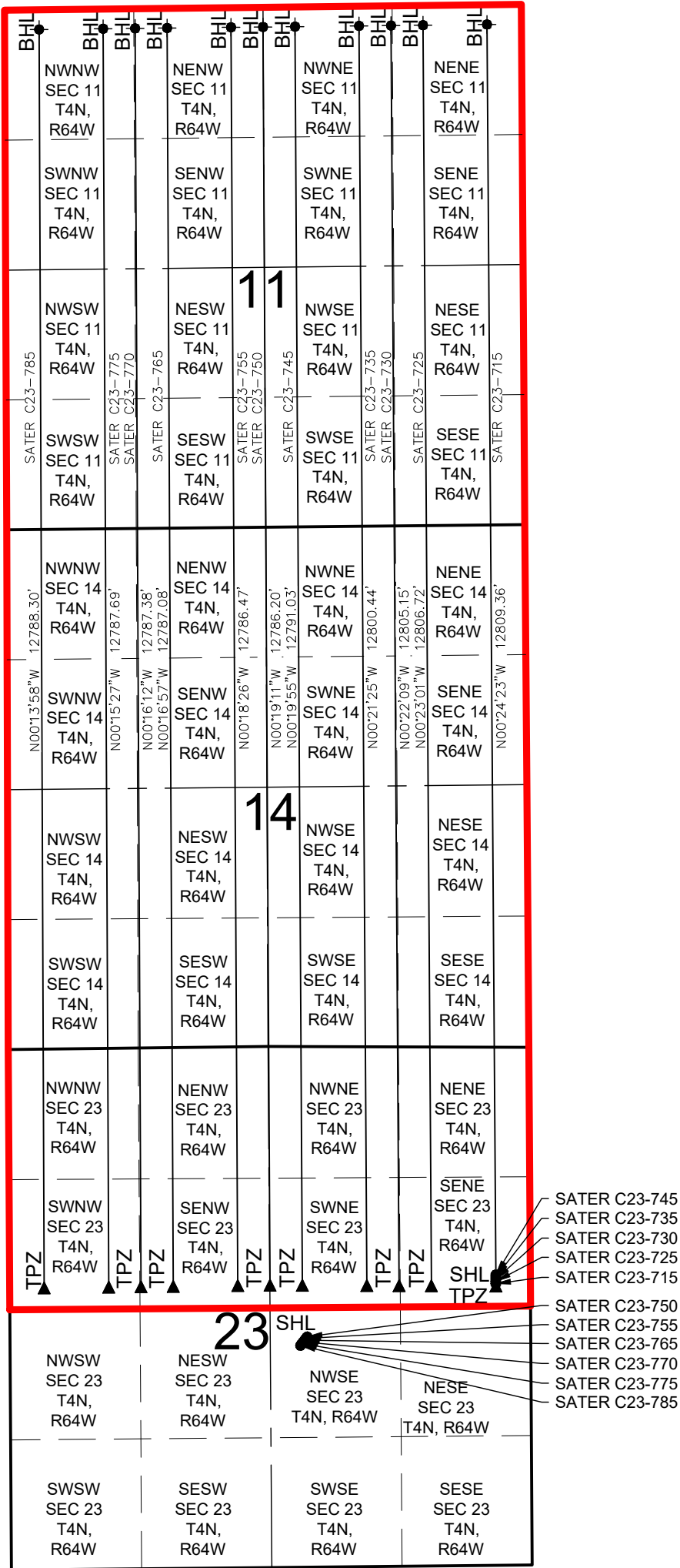

SATER C23-785 SHL TO BE LOCATED 2250' FSL AND 2339' FEL
SATER C23-775 SHL TO BE LOCATED 2268' FSL AND 2325' FEL
SATER C23-770 SHL TO BE LOCATED 2285' FSL AND 2311' FEL
SATER C23-765 SHL TO BE LOCATED 2303' FSL AND 2297' FEL
SATER C23-755 SHL TO BE LOCATED 2320' FSL AND 2283' FEL
SATER C23-750 SHL TO BE LOCATED 2338' FSL AND 2270' FEL

SATER C23-745 SHL TO BE LOCATED 2310' FNL AND 351' FEL
SATER C23-735 SHL TO BE LOCATED 2332' FNL AND 351' FEL
SATER C23-730 SHL TO BE LOCATED 2355' FNL AND 351' FEL
SATER C23-725 SHL TO BE LOCATED 2377' FNL AND 351' FEL
SATER C23-715 SHL TO BE LOCATED 2440' FNL AND 351' FEL

LEGEND

- = PROPOSED WELL
- = BOTTOM HOLE
- ▲ = TOP OF PRODUCTION ZONE
- SHL = SURFACE HOLE LOCATION
- BHL = BOTTOM HOLE LOCATION
- TPZ = TOP OF PRODUCTION ZONE

DISCLAIMER:
THIS PLOT DOES NOT REPRESENT A MONUMENTED LAND SURVEY AND SHOULD NOT BE
RELIED UPON TO DETERMINE BOUNDARY LINES, PROPERTY OWNERSHIP OR OTHER
PROPERTY INTERESTS. PARCEL LINES, IF DEPICTED HAVE NOT BEEN FIELD VERIFIED AND
MAY BE BASED UPON PUBLICLY AVAILABLE DATA THAT ALSO HAS NOT BEEN
INDEPENDENTLY VERIFIED.

