

Weld County, Colorado Section 06-T07N-R64W Almont 5-01-01L plan1

Section Details

Sec	MD	Inc	Azi	TVD	+N/-S	+E/-W	Dleg	Vsect	Annotation
1	0.00	0.00	0.00	0.00	0.00	0.00	0.00	0.00	
2	3000.00	0.00	0.00	3000.00	0.00	0.00	0.00	0.00	KOP Begin 1°/100' build
3	4066.33	10.66	22.92	4060.18	91.13	38.54	1.00	44.48	Begin 10.66° tangent
4	6563.17	10.66	22.92	6513.91	516.65	218.49	0.00	252.17	Begin 10°/100' build/turn
5	7421.02	90.00	89.52	7037.00	611.82	789.12	10.00	827.85	Begin 90.00° lateral
6	17086.60	90.00	89.52	7037.00	692.80	10454.36	0.00	10477.29	PBHL/TD 17086.60 MD/7037.00 TVD

DESIGN TARGET DETAILS

Name	TVD	+N/-S	+E/-W	Northing	Easting	Latitude	Longitude
Almont 5-01-01L LP 470 FNL 470 FWL	7037.00	611.82	789.12	14748366.26	1756638.72	40.60785536	-104.58126076
Almont 5-01-01L PBHL 470 FNL 470 FEL	7037.00	692.80	10454.36	14748492.90	1766303.45	40.60807160	-104.54643812

Almont 5-01-01L Surf loc: 1072 FNL 325 FEL Section 06-T08N-R64W			
NAD83 Colorado - HARN Universal Transverse Mercator (US Survey Feet) Zone 13N (108 W to 102 W) RKB=5001+24 @ 5025.00ft			
Northing	Easting	Latitude	Longitude
14747750.72	1755852.50	40.60617542	-104.58410386

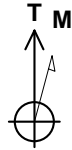

Azimuths to True North
Magnetic North: 8.00°

Magnetic Field
Strength: 52363.1snT
Dip Angle: 66.98°
Date: 2/22/2018
Model: HDGM

Azimuth Corrections:

To convert a Magnetic Direction to a True Direction, Add 8.00° East

West(-)/East(+) (1500 ft/in)

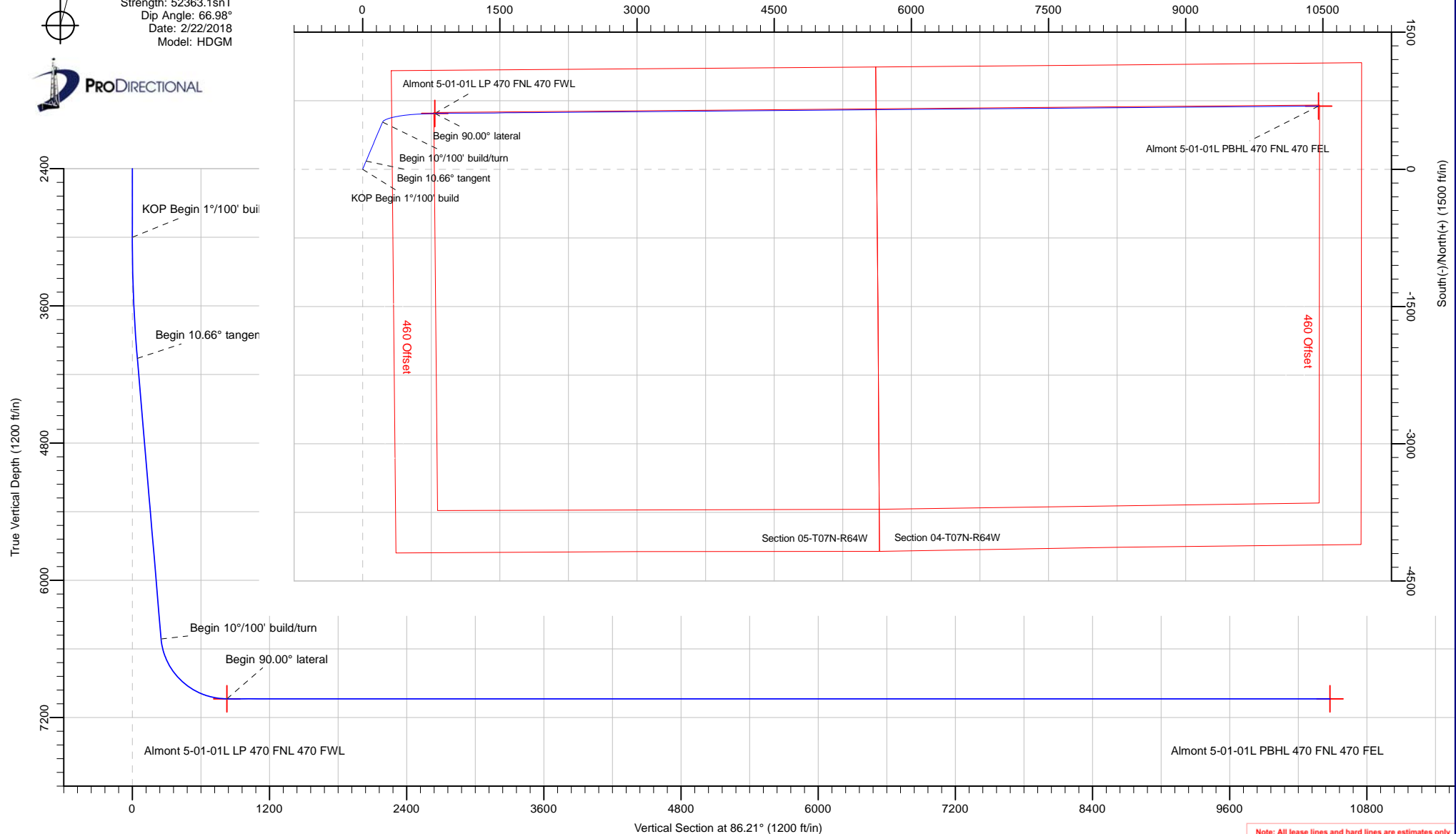

Note: All lease lines and hard lines are estimates only and are subject to customers approval.

Database:	DB_Jul2216dt_v14	Local Co-ordinate Reference:	Well Almont 5-01-01L
Company:	Confluence Resources	TVD Reference:	RKB=5001+24 @ 5025.00ft
Project:	Weld County, Colorado	MD Reference:	RKB=5001+24 @ 5025.00ft
Site:	Section 06-T07N-R64W	North Reference:	True
Well:	Almont 5-01-01L	Survey Calculation Method:	Minimum Curvature
Wellbore:	Original Hole		
Design:	plan1		

Project	Weld County, Colorado		
Map System:	Universal Transverse Mercator (US Survey Feet)	System Datum:	Mean Sea Level
Geo Datum:	NAD83 Colorado - HARN		
Map Zone:	Zone 13N (108 W to 102 W)		

Site		Section 06-T07N-R64W			
Site Position:		Northing:	14,746,184.54 usft	Latitude:	40.60187654
From:	Map	Easting:	1,755,730.03 usft	Longitude:	-104.58457171
Position Uncertainty:	0.00 ft	Slot Radius:	13-3/16 "	Grid Convergence:	0.27 °

Well	Almont 5-01-01L, Surf loc: 1072 FNL 325 FEL Section 06-T08N-R64W					
Well Position	+N/-S	1,565.59 ft	Northing:	14,747,750.72 usft	Latitude:	40.60617542
	+E/-W	129.86 ft	Easting:	1,755,852.50 usft	Longitude:	-104.58410385
Position Uncertainty		0.00 ft	Wellhead Elevation:		Ground Level:	5,001.00 ft

Wellbore	Original Hole				
Magnetics	Model Name	Sample Date	Declination (°)	Dip Angle (°)	Field Strength (nT)
	HDGM	2/22/2018	8.00	66.98	52,363.10000000

Design	plan1			
Audit Notes:				
Version:	Phase:	PLAN	Tie On Depth:	0.00
Vertical Section:	Depth From (TVD) (ft)	+N/-S (ft)	+E/-W (ft)	Direction (°)
	0.00	0.00	0.00	86.21

Plan Survey Tool Program	Date	2/22/2018		
Depth From (ft)	Depth To (ft)	Survey (Wellbore)	Tool Name	Remarks
1	0.00	17,085.93	plan1 (Original Hole)	

Plan Sections										
Measured Depth (ft)	Inclination (°)	Azimuth (°)	Vertical Depth (ft)	+N/-S (ft)	+E/-W (ft)	Dogleg Rate (°/100ft)	Build Rate (°/100ft)	Turn Rate (°/100ft)	TFO (°)	Target
0.00	0.00	0.00	0.00	0.00	0.00	0.00	0.00	0.00	0.00	
3,000.00	0.00	0.00	3,000.00	0.00	0.00	0.00	0.00	0.00	0.00	
4,066.33	10.66	22.92	4,060.18	91.13	38.54	1.00	1.00	0.00	22.92	
6,563.17	10.66	22.92	6,513.91	516.65	218.49	0.00	0.00	0.00	0.00	
7,421.02	90.00	89.52	7,037.00	611.82	789.12	10.00	9.25	7.76	66.96	Almont 5-01-01L LP 4
17,086.60	90.00	89.52	7,037.00	692.80	10,454.36	0.00	0.00	0.00	0.00	Almont 5-01-01L PBH

Database:	DB_Jul2216dt_v14	Local Co-ordinate Reference:	Well Almont 5-01-01L
Company:	Confluence Resources	TVD Reference:	RKB=5001+24 @ 5025.00ft
Project:	Weld County, Colorado	MD Reference:	RKB=5001+24 @ 5025.00ft
Site:	Section 06-T07N-R64W	North Reference:	True
Well:	Almont 5-01-01L	Survey Calculation Method:	Minimum Curvature
Wellbore:	Original Hole		
Design:	plan1		

Planned Survey									
Measured Depth (ft)	Inclination (°)	Azimuth (°)	Vertical Depth (ft)	+N/-S (ft)	+E/-W (ft)	Vertical Section (ft)	Dogleg Rate (°/100ft)	Build Rate (°/100ft)	Turn Rate (°/100ft)
0.00	0.00	0.00	0.00	0.00	0.00	0.00	0.00	0.00	0.00
100.00	0.00	0.00	100.00	0.00	0.00	0.00	0.00	0.00	0.00
200.00	0.00	0.00	200.00	0.00	0.00	0.00	0.00	0.00	0.00
300.00	0.00	0.00	300.00	0.00	0.00	0.00	0.00	0.00	0.00
400.00	0.00	0.00	400.00	0.00	0.00	0.00	0.00	0.00	0.00
500.00	0.00	0.00	500.00	0.00	0.00	0.00	0.00	0.00	0.00
600.00	0.00	0.00	600.00	0.00	0.00	0.00	0.00	0.00	0.00
700.00	0.00	0.00	700.00	0.00	0.00	0.00	0.00	0.00	0.00
800.00	0.00	0.00	800.00	0.00	0.00	0.00	0.00	0.00	0.00
900.00	0.00	0.00	900.00	0.00	0.00	0.00	0.00	0.00	0.00
1,000.00	0.00	0.00	1,000.00	0.00	0.00	0.00	0.00	0.00	0.00
1,100.00	0.00	0.00	1,100.00	0.00	0.00	0.00	0.00	0.00	0.00
1,200.00	0.00	0.00	1,200.00	0.00	0.00	0.00	0.00	0.00	0.00
1,300.00	0.00	0.00	1,300.00	0.00	0.00	0.00	0.00	0.00	0.00
1,400.00	0.00	0.00	1,400.00	0.00	0.00	0.00	0.00	0.00	0.00
1,500.00	0.00	0.00	1,500.00	0.00	0.00	0.00	0.00	0.00	0.00
1,600.00	0.00	0.00	1,600.00	0.00	0.00	0.00	0.00	0.00	0.00
1,700.00	0.00	0.00	1,700.00	0.00	0.00	0.00	0.00	0.00	0.00
1,800.00	0.00	0.00	1,800.00	0.00	0.00	0.00	0.00	0.00	0.00
1,900.00	0.00	0.00	1,900.00	0.00	0.00	0.00	0.00	0.00	0.00
2,000.00	0.00	0.00	2,000.00	0.00	0.00	0.00	0.00	0.00	0.00
2,100.00	0.00	0.00	2,100.00	0.00	0.00	0.00	0.00	0.00	0.00
2,200.00	0.00	0.00	2,200.00	0.00	0.00	0.00	0.00	0.00	0.00
2,300.00	0.00	0.00	2,300.00	0.00	0.00	0.00	0.00	0.00	0.00
2,400.00	0.00	0.00	2,400.00	0.00	0.00	0.00	0.00	0.00	0.00
2,500.00	0.00	0.00	2,500.00	0.00	0.00	0.00	0.00	0.00	0.00
2,600.00	0.00	0.00	2,600.00	0.00	0.00	0.00	0.00	0.00	0.00
2,700.00	0.00	0.00	2,700.00	0.00	0.00	0.00	0.00	0.00	0.00
2,800.00	0.00	0.00	2,800.00	0.00	0.00	0.00	0.00	0.00	0.00
2,900.00	0.00	0.00	2,900.00	0.00	0.00	0.00	0.00	0.00	0.00
3,000.00	0.00	0.00	3,000.00	0.00	0.00	0.00	0.00	0.00	0.00
KOP Begin 1°/100' build									
3,100.00	1.00	22.92	3,099.99	0.80	0.34	0.39	1.00	1.00	0.00
3,200.00	2.00	22.92	3,199.96	3.21	1.36	1.57	1.00	1.00	0.00
3,300.00	3.00	22.92	3,299.86	7.23	3.06	3.53	1.00	1.00	0.00
3,400.00	4.00	22.92	3,399.68	12.85	5.44	6.27	1.00	1.00	0.00
3,500.00	5.00	22.92	3,499.37	20.08	8.49	9.80	1.00	1.00	0.00
3,600.00	6.00	22.92	3,598.90	28.91	12.23	14.11	1.00	1.00	0.00
3,700.00	7.00	22.92	3,698.26	39.33	16.63	19.20	1.00	1.00	0.00
3,800.00	8.00	22.92	3,797.40	51.36	21.72	25.07	1.00	1.00	0.00
3,900.00	9.00	22.92	3,896.30	64.97	27.48	31.71	1.00	1.00	0.00
4,000.00	10.00	22.92	3,994.93	80.17	33.90	39.13	1.00	1.00	0.00
4,066.33	10.66	22.92	4,060.18	91.13	38.54	44.48	1.00	1.00	0.00
Begin 10.66° tangent									
4,100.00	10.66	22.92	4,093.27	96.87	40.96	47.28	0.00	0.00	0.00
4,200.00	10.66	22.92	4,191.55	113.91	48.17	55.60	0.00	0.00	0.00
4,300.00	10.66	22.92	4,289.82	130.95	55.38	63.92	0.00	0.00	0.00
4,400.00	10.66	22.92	4,388.09	147.99	62.59	72.23	0.00	0.00	0.00
4,500.00	10.66	22.92	4,486.37	165.03	69.79	80.55	0.00	0.00	0.00
4,600.00	10.66	22.92	4,584.64	182.08	77.00	88.87	0.00	0.00	0.00
4,700.00	10.66	22.92	4,682.91	199.12	84.21	97.19	0.00	0.00	0.00
4,800.00	10.66	22.92	4,781.19	216.16	91.41	105.51	0.00	0.00	0.00
4,900.00	10.66	22.92	4,879.46	233.20	98.62	113.83	0.00	0.00	0.00

Database:	DB_Jul2216dt_v14	Local Co-ordinate Reference:	Well Almont 5-01-01L
Company:	Confluence Resources	TVD Reference:	RKB=5001+24 @ 5025.00ft
Project:	Weld County, Colorado	MD Reference:	RKB=5001+24 @ 5025.00ft
Site:	Section 06-T07N-R64W	North Reference:	True
Well:	Almont 5-01-01L	Survey Calculation Method:	Minimum Curvature
Wellbore:	Original Hole		
Design:	plan1		

Planned Survey									
Measured Depth (ft)	Inclination (°)	Azimuth (°)	Vertical Depth (ft)	+N/-S (ft)	+E/-W (ft)	Vertical Section (ft)	Dogleg Rate (°/100ft)	Build Rate (°/100ft)	Turn Rate (°/100ft)
5,000.00	10.66	22.92	4,977.73	250.25	105.83	122.14	0.00	0.00	0.00
5,100.00	10.66	22.92	5,076.01	267.29	113.04	130.46	0.00	0.00	0.00
5,200.00	10.66	22.92	5,174.28	284.33	120.24	138.78	0.00	0.00	0.00
5,300.00	10.66	22.92	5,272.55	301.37	127.45	147.10	0.00	0.00	0.00
5,400.00	10.66	22.92	5,370.82	318.42	134.66	155.42	0.00	0.00	0.00
5,500.00	10.66	22.92	5,469.10	335.46	141.87	163.74	0.00	0.00	0.00
5,600.00	10.66	22.92	5,567.37	352.50	149.07	172.06	0.00	0.00	0.00
5,700.00	10.66	22.92	5,665.64	369.54	156.28	180.37	0.00	0.00	0.00
5,800.00	10.66	22.92	5,763.92	386.58	163.49	188.69	0.00	0.00	0.00
5,900.00	10.66	22.92	5,862.19	403.63	170.69	197.01	0.00	0.00	0.00
6,000.00	10.66	22.92	5,960.46	420.67	177.90	205.33	0.00	0.00	0.00
6,100.00	10.66	22.92	6,058.74	437.71	185.11	213.65	0.00	0.00	0.00
6,200.00	10.66	22.92	6,157.01	454.75	192.32	221.97	0.00	0.00	0.00
6,300.00	10.66	22.92	6,255.28	471.80	199.52	230.28	0.00	0.00	0.00
6,400.00	10.66	22.92	6,353.56	488.84	206.73	238.60	0.00	0.00	0.00
6,500.00	10.66	22.92	6,451.83	505.88	213.94	246.92	0.00	0.00	0.00
6,563.17	10.66	22.92	6,513.91	516.65	218.49	252.17	0.00	0.00	0.00
Begin 10°/100' build/turn									
6,600.00	12.57	38.69	6,549.99	522.91	222.32	256.41	10.00	5.16	42.81
6,700.00	20.33	61.72	6,645.92	539.68	244.48	279.63	10.00	7.76	23.03
6,800.00	29.44	71.69	6,736.58	555.67	283.21	319.33	10.00	9.11	9.97
6,900.00	38.96	77.18	6,819.22	570.40	337.33	374.31	10.00	9.52	5.49
7,000.00	48.65	80.77	6,891.31	583.43	405.21	442.90	10.00	9.69	3.59
7,100.00	58.42	83.42	6,950.68	594.35	484.77	523.01	10.00	9.77	2.65
7,200.00	68.24	85.56	6,995.51	602.84	573.61	612.22	10.00	9.82	2.14
7,300.00	78.08	87.43	7,024.45	608.65	669.02	707.81	10.00	9.84	1.86
7,400.00	87.93	89.16	7,036.62	611.58	768.11	806.87	10.00	9.85	1.73
7,421.02	90.00	89.52	7,037.00	611.82	789.12	827.85	10.00	9.85	1.70
Begin 90.00° lateral									
7,500.00	90.00	89.52	7,037.00	612.48	868.10	906.70	0.00	0.00	0.00
7,600.00	90.00	89.52	7,037.00	613.32	968.10	1,006.53	0.00	0.00	0.00
7,700.00	90.00	89.52	7,037.00	614.16	1,068.09	1,106.37	0.00	0.00	0.00
7,800.00	90.00	89.52	7,037.00	614.99	1,168.09	1,206.20	0.00	0.00	0.00
7,900.00	90.00	89.52	7,037.00	615.83	1,268.09	1,306.03	0.00	0.00	0.00
8,000.00	90.00	89.52	7,037.00	616.67	1,368.08	1,405.87	0.00	0.00	0.00
8,100.00	90.00	89.52	7,037.00	617.51	1,468.08	1,505.70	0.00	0.00	0.00
8,200.00	90.00	89.52	7,037.00	618.35	1,568.08	1,605.53	0.00	0.00	0.00
8,300.00	90.00	89.52	7,037.00	619.18	1,668.07	1,705.36	0.00	0.00	0.00
8,400.00	90.00	89.52	7,037.00	620.02	1,768.07	1,805.20	0.00	0.00	0.00
8,500.00	90.00	89.52	7,037.00	620.86	1,868.07	1,905.03	0.00	0.00	0.00
8,600.00	90.00	89.52	7,037.00	621.70	1,968.06	2,004.86	0.00	0.00	0.00
8,700.00	90.00	89.52	7,037.00	622.53	2,068.06	2,104.70	0.00	0.00	0.00
8,800.00	90.00	89.52	7,037.00	623.37	2,168.06	2,204.53	0.00	0.00	0.00
8,900.00	90.00	89.52	7,037.00	624.21	2,268.05	2,304.36	0.00	0.00	0.00
9,000.00	90.00	89.52	7,037.00	625.05	2,368.05	2,404.20	0.00	0.00	0.00
9,100.00	90.00	89.52	7,037.00	625.89	2,468.04	2,504.03	0.00	0.00	0.00
9,200.00	90.00	89.52	7,037.00	626.72	2,568.04	2,603.86	0.00	0.00	0.00
9,300.00	90.00	89.52	7,037.00	627.56	2,668.04	2,703.70	0.00	0.00	0.00
9,400.00	90.00	89.52	7,037.00	628.40	2,768.03	2,803.53	0.00	0.00	0.00
9,500.00	90.00	89.52	7,037.00	629.24	2,868.03	2,903.36	0.00	0.00	0.00
9,600.00	90.00	89.52	7,037.00	630.07	2,968.03	3,003.19	0.00	0.00	0.00
9,700.00	90.00	89.52	7,037.00	630.91	3,068.02	3,103.03	0.00	0.00	0.00
9,800.00	90.00	89.52	7,037.00	631.75	3,168.02	3,202.86	0.00	0.00	0.00
9,900.00	90.00	89.52	7,037.00	632.59	3,268.02	3,302.69	0.00	0.00	0.00

Database:	DB_Jul2216dt_v14	Local Co-ordinate Reference:	Well Almont 5-01-01L
Company:	Confluence Resources	TVD Reference:	RKB=5001+24 @ 5025.00ft
Project:	Weld County, Colorado	MD Reference:	RKB=5001+24 @ 5025.00ft
Site:	Section 06-T07N-R64W	North Reference:	True
Well:	Almont 5-01-01L	Survey Calculation Method:	Minimum Curvature
Wellbore:	Original Hole		
Design:	plan1		

Planned Survey									
Measured Depth (ft)	Inclination (°)	Azimuth (°)	Vertical Depth (ft)	+N/-S (ft)	+E/-W (ft)	Vertical Section (ft)	Dogleg Rate (°/100ft)	Build Rate (°/100ft)	Turn Rate (°/100ft)
10,000.00	90.00	89.52	7,037.00	633.43	3,368.01	3,402.53	0.00	0.00	0.00
10,100.00	90.00	89.52	7,037.00	634.26	3,468.01	3,502.36	0.00	0.00	0.00
10,200.00	90.00	89.52	7,037.00	635.10	3,568.01	3,602.19	0.00	0.00	0.00
10,300.00	90.00	89.52	7,037.00	635.94	3,668.00	3,702.03	0.00	0.00	0.00
10,400.00	90.00	89.52	7,037.00	636.78	3,768.00	3,801.86	0.00	0.00	0.00
10,500.00	90.00	89.52	7,037.00	637.61	3,868.00	3,901.69	0.00	0.00	0.00
10,600.00	90.00	89.52	7,037.00	638.45	3,967.99	4,001.52	0.00	0.00	0.00
10,700.00	90.00	89.52	7,037.00	639.29	4,067.99	4,101.36	0.00	0.00	0.00
10,800.00	90.00	89.52	7,037.00	640.13	4,167.99	4,201.19	0.00	0.00	0.00
10,900.00	90.00	89.52	7,037.00	640.97	4,267.98	4,301.02	0.00	0.00	0.00
11,000.00	90.00	89.52	7,037.00	641.80	4,367.98	4,400.86	0.00	0.00	0.00
11,100.00	90.00	89.52	7,037.00	642.64	4,467.97	4,500.69	0.00	0.00	0.00
11,200.00	90.00	89.52	7,037.00	643.48	4,567.97	4,600.52	0.00	0.00	0.00
11,300.00	90.00	89.52	7,037.00	644.32	4,667.97	4,700.36	0.00	0.00	0.00
11,400.00	90.00	89.52	7,037.00	645.15	4,767.96	4,800.19	0.00	0.00	0.00
11,500.00	90.00	89.52	7,037.00	645.99	4,867.96	4,900.02	0.00	0.00	0.00
11,600.00	90.00	89.52	7,037.00	646.83	4,967.96	4,999.85	0.00	0.00	0.00
11,700.00	90.00	89.52	7,037.00	647.67	5,067.95	5,099.69	0.00	0.00	0.00
11,800.00	90.00	89.52	7,037.00	648.51	5,167.95	5,199.52	0.00	0.00	0.00
11,900.00	90.00	89.52	7,037.00	649.34	5,267.95	5,299.35	0.00	0.00	0.00
12,000.00	90.00	89.52	7,037.00	650.18	5,367.94	5,399.19	0.00	0.00	0.00
12,100.00	90.00	89.52	7,037.00	651.02	5,467.94	5,499.02	0.00	0.00	0.00
12,200.00	90.00	89.52	7,037.00	651.86	5,567.94	5,598.85	0.00	0.00	0.00
12,300.00	90.00	89.52	7,037.00	652.69	5,667.93	5,698.69	0.00	0.00	0.00
12,400.00	90.00	89.52	7,037.00	653.53	5,767.93	5,798.52	0.00	0.00	0.00
12,500.00	90.00	89.52	7,037.00	654.37	5,867.93	5,898.35	0.00	0.00	0.00
12,600.00	90.00	89.52	7,037.00	655.21	5,967.92	5,998.19	0.00	0.00	0.00
12,700.00	90.00	89.52	7,037.00	656.05	6,067.92	6,098.02	0.00	0.00	0.00
12,800.00	90.00	89.52	7,037.00	656.88	6,167.91	6,197.85	0.00	0.00	0.00
12,900.00	90.00	89.52	7,037.00	657.72	6,267.91	6,297.68	0.00	0.00	0.00
13,000.00	90.00	89.52	7,037.00	658.56	6,367.91	6,397.52	0.00	0.00	0.00
13,100.00	90.00	89.52	7,037.00	659.40	6,467.90	6,497.35	0.00	0.00	0.00
13,200.00	90.00	89.52	7,037.00	660.23	6,567.90	6,597.18	0.00	0.00	0.00
13,300.00	90.00	89.52	7,037.00	661.07	6,667.90	6,697.02	0.00	0.00	0.00
13,400.00	90.00	89.52	7,037.00	661.91	6,767.89	6,796.85	0.00	0.00	0.00
13,500.00	90.00	89.52	7,037.00	662.75	6,867.89	6,896.68	0.00	0.00	0.00
13,600.00	90.00	89.52	7,037.00	663.59	6,967.89	6,996.52	0.00	0.00	0.00
13,700.00	90.00	89.52	7,037.00	664.42	7,067.88	7,096.35	0.00	0.00	0.00
13,800.00	90.00	89.52	7,037.00	665.26	7,167.88	7,196.18	0.00	0.00	0.00
13,900.00	90.00	89.52	7,037.00	666.10	7,267.88	7,296.01	0.00	0.00	0.00
14,000.00	90.00	89.52	7,037.00	666.94	7,367.87	7,395.85	0.00	0.00	0.00
14,100.00	90.00	89.52	7,037.00	667.77	7,467.87	7,495.68	0.00	0.00	0.00
14,200.00	90.00	89.52	7,037.00	668.61	7,567.87	7,595.51	0.00	0.00	0.00
14,300.00	90.00	89.52	7,037.00	669.45	7,667.86	7,695.35	0.00	0.00	0.00
14,400.00	90.00	89.52	7,037.00	670.29	7,767.86	7,795.18	0.00	0.00	0.00
14,500.00	90.00	89.52	7,037.00	671.13	7,867.86	7,895.01	0.00	0.00	0.00
14,600.00	90.00	89.52	7,037.00	671.96	7,967.85	7,994.85	0.00	0.00	0.00
14,700.00	90.00	89.52	7,037.00	672.80	8,067.85	8,094.68	0.00	0.00	0.00
14,800.00	90.00	89.52	7,037.00	673.64	8,167.84	8,194.51	0.00	0.00	0.00
14,900.00	90.00	89.52	7,037.00	674.48	8,267.84	8,294.35	0.00	0.00	0.00
15,000.00	90.00	89.52	7,037.00	675.31	8,367.84	8,394.18	0.00	0.00	0.00
15,100.00	90.00	89.52	7,037.00	676.15	8,467.83	8,494.01	0.00	0.00	0.00
15,200.00	90.00	89.52	7,037.00	676.99	8,567.83	8,593.84	0.00	0.00	0.00
15,300.00	90.00	89.52	7,037.00	677.83	8,667.83	8,693.68	0.00	0.00	0.00

Database:	DB_Jul2216dt_v14	Local Co-ordinate Reference:	Well Almont 5-01-01L
Company:	Confluence Resources	TVD Reference:	RKB=5001+24 @ 5025.00ft
Project:	Weld County, Colorado	MD Reference:	RKB=5001+24 @ 5025.00ft
Site:	Section 06-T07N-R64W	North Reference:	True
Well:	Almont 5-01-01L	Survey Calculation Method:	Minimum Curvature
Wellbore:	Original Hole		
Design:	plan1		

Planned Survey

Measured Depth (ft)	Inclination (°)	Azimuth (°)	Vertical Depth (ft)	+N/-S (ft)	+E/-W (ft)	Vertical Section (ft)	Dogleg Rate (°/100ft)	Build Rate (°/100ft)	Turn Rate (°/100ft)
15,400.00	90.00	89.52	7,037.00	678.67	8,767.82	8,793.51	0.00	0.00	0.00
15,500.00	90.00	89.52	7,037.00	679.50	8,867.82	8,893.34	0.00	0.00	0.00
15,600.00	90.00	89.52	7,037.00	680.34	8,967.82	8,993.18	0.00	0.00	0.00
15,700.00	90.00	89.52	7,037.00	681.18	9,067.81	9,093.01	0.00	0.00	0.00
15,800.00	90.00	89.52	7,037.00	682.02	9,167.81	9,192.84	0.00	0.00	0.00
15,900.00	90.00	89.52	7,037.00	682.85	9,267.81	9,292.68	0.00	0.00	0.00
16,000.00	90.00	89.52	7,037.00	683.69	9,367.80	9,392.51	0.00	0.00	0.00
16,100.00	90.00	89.52	7,037.00	684.53	9,467.80	9,492.34	0.00	0.00	0.00
16,200.00	90.00	89.52	7,037.00	685.37	9,567.80	9,592.17	0.00	0.00	0.00
16,300.00	90.00	89.52	7,037.00	686.21	9,667.79	9,692.01	0.00	0.00	0.00
16,400.00	90.00	89.52	7,037.00	687.04	9,767.79	9,791.84	0.00	0.00	0.00
16,500.00	90.00	89.52	7,037.00	687.88	9,867.79	9,891.67	0.00	0.00	0.00
16,600.00	90.00	89.52	7,037.00	688.72	9,967.78	9,991.51	0.00	0.00	0.00
16,700.00	90.00	89.52	7,037.00	689.56	10,067.78	10,091.34	0.00	0.00	0.00
16,800.00	90.00	89.52	7,037.00	690.39	10,167.77	10,191.17	0.00	0.00	0.00
16,900.00	90.00	89.52	7,037.00	691.23	10,267.77	10,291.01	0.00	0.00	0.00
17,000.00	90.00	89.52	7,037.00	692.07	10,367.77	10,390.84	0.00	0.00	0.00
17,086.60	90.00	89.52	7,037.00	692.80	10,454.36	10,477.29	0.00	0.00	0.00
PBHL/TD 17086.60 MD/7037.00 TVD									

Design Targets

Target Name - hit/miss target - Shape	Dip Angle (°)	Dip Dir. (°)	TVD (ft)	+N/-S (ft)	+E/-W (ft)	Northing (usft)	Easting (usft)	Latitude	Longitude
Almont 5-01-01L PBHL 4 - plan hits target center - Point	0.00	0.00	7,037.00	692.80	10,454.36	14,748,492.90	1,766,303.45	40.60807160	-104.54643811
Almont 5-01-01L LP 470 - plan hits target center - Point	0.00	0.00	7,037.00	611.82	789.12	14,748,366.26	1,756,638.72	40.60785535	-104.58126076

Plan Annotations

Measured Depth (ft)	Vertical Depth (ft)	Local Coordinates		Comment
		+N/-S (ft)	+E/-W (ft)	
3,000.00	3,000.00	0.00	0.00	KOP Begin 1°/100' build
4,066.33	4,060.18	91.13	38.54	Begin 10.66° tangent
6,563.17	6,513.91	516.65	218.49	Begin 10°/100' build/turn
7,421.02	7,037.00	611.82	789.12	Begin 90.00° lateral
17,086.60	7,037.00	692.80	10,454.36	PBHL/TD 17086.60 MD/7037.00 TVD

Database:	DB_Jul2216dt_v14	Local Co-ordinate Reference:	Well Almost 5-01-01L
Company:	Confluence Resources	TVD Reference:	RKB=5001+24 @ 5025.00ft
Project:	Weld County, Colorado	MD Reference:	RKB=5001+24 @ 5025.00ft
Site:	Section 06-T07N-R64W	North Reference:	True
Well:	Almost 5-01-01L	Survey Calculation Method:	Minimum Curvature
Wellbore:	Original Hole		
Design:	plan1		

Project	Weld County, Colorado		
Map System:	Universal Transverse Mercator (US Survey Feet)	System Datum:	Mean Sea Level
Geo Datum:	NAD83 Colorado - HARN		
Map Zone:	Zone 13N (108 W to 102 W)		

Site		Section 06-T07N-R64W			
Site Position:		Northing:	14,746,184.54 usft	Latitude:	40.60187654
From:	Map	Easting:	1,755,730.03 usft	Longitude:	-104.58457171
Position Uncertainty:	0.00 ft	Slot Radius:	13-3/16 "	Grid Convergence:	0.27 °

Well	Almost 5-01-01L, Surf loc: 1072 FNL 325 FEL Section 06-T08N-R64W					
Well Position	+N/-S	0.00 ft	Northing:	14,747,750.72 usft	Latitude:	40.60617542
	+E/-W	0.00 ft	Easting:	1,755,852.50 usft	Longitude:	-104.58410385
Position Uncertainty		0.00 ft	Wellhead Elevation:		Ground Level:	5,001.00 ft

Wellbore	Original Hole				
Magnetics	Model Name	Sample Date	Declination (°)	Dip Angle (°)	Field Strength (nT)
	HDGM	2/22/2018	8.00	66.98	52,363.10000000

Design	plan1			
Audit Notes:				
Version:	Phase:	PLAN	Tie On Depth:	0.00
Vertical Section:	Depth From (TVD) (ft)	+N/-S (ft)	+E/-W (ft)	Direction (°)
	0.00	0.00	0.00	86.21

Plan Survey Tool Program	Date	2/22/2018		
Depth From (ft)	Depth To (ft)	Survey (Wellbore)	Tool Name	Remarks
1	0.00	17,085.93 plan1 (Original Hole)		

Plan Sections										
Measured Depth (ft)	Inclination (°)	Azimuth (°)	Vertical Depth (ft)	+N/-S (ft)	+E/-W (ft)	Dogleg Rate (°/100ft)	Build Rate (°/100ft)	Turn Rate (°/100ft)	TFO (°)	Target
0.00	0.00	0.00	0.00	0.00	0.00	0.00	0.00	0.00	0.00	
3,000.00	0.00	0.00	3,000.00	0.00	0.00	0.00	0.00	0.00	0.00	
4,066.33	10.66	22.92	4,060.18	91.13	38.54	1.00	1.00	0.00	22.92	
6,563.17	10.66	22.92	6,513.91	516.65	218.49	0.00	0.00	0.00	0.00	
7,421.02	90.00	89.52	7,037.00	611.82	789.12	10.00	9.25	7.76	66.96	Almost 5-01-01L LP 4
17,086.60	90.00	89.52	7,037.00	692.80	10,454.36	0.00	0.00	0.00	0.00	Almost 5-01-01L PBH

Database:	DB_Jul2216dt_v14	Local Co-ordinate Reference:	Well Almont 5-01-01L
Company:	Confluence Resources	TVD Reference:	RKB=5001+24 @ 5025.00ft
Project:	Weld County, Colorado	MD Reference:	RKB=5001+24 @ 5025.00ft
Site:	Section 06-T07N-R64W	North Reference:	True
Well:	Almont 5-01-01L	Survey Calculation Method:	Minimum Curvature
Wellbore:	Original Hole		
Design:	plan1		

Planned Survey									
Measured Depth (ft)	Inclination (°)	Azimuth (°)	Vertical Depth (ft)	+N/-S (ft)	+E/-W (ft)	Map Northing (usft)	Map Easting (usft)	Latitude	Longitude
0.00	0.00	0.00	0.00	0.00	0.00	14,747,750.72	1,755,852.50	40.60617542	-104.58410385
100.00	0.00	0.00	100.00	0.00	0.00	14,747,750.72	1,755,852.50	40.60617542	-104.58410385
200.00	0.00	0.00	200.00	0.00	0.00	14,747,750.72	1,755,852.50	40.60617542	-104.58410385
300.00	0.00	0.00	300.00	0.00	0.00	14,747,750.72	1,755,852.50	40.60617542	-104.58410385
400.00	0.00	0.00	400.00	0.00	0.00	14,747,750.72	1,755,852.50	40.60617542	-104.58410385
500.00	0.00	0.00	500.00	0.00	0.00	14,747,750.72	1,755,852.50	40.60617542	-104.58410385
600.00	0.00	0.00	600.00	0.00	0.00	14,747,750.72	1,755,852.50	40.60617542	-104.58410385
700.00	0.00	0.00	700.00	0.00	0.00	14,747,750.72	1,755,852.50	40.60617542	-104.58410385
800.00	0.00	0.00	800.00	0.00	0.00	14,747,750.72	1,755,852.50	40.60617542	-104.58410385
900.00	0.00	0.00	900.00	0.00	0.00	14,747,750.72	1,755,852.50	40.60617542	-104.58410385
1,000.00	0.00	0.00	1,000.00	0.00	0.00	14,747,750.72	1,755,852.50	40.60617542	-104.58410385
1,100.00	0.00	0.00	1,100.00	0.00	0.00	14,747,750.72	1,755,852.50	40.60617542	-104.58410385
1,200.00	0.00	0.00	1,200.00	0.00	0.00	14,747,750.72	1,755,852.50	40.60617542	-104.58410385
1,300.00	0.00	0.00	1,300.00	0.00	0.00	14,747,750.72	1,755,852.50	40.60617542	-104.58410385
1,400.00	0.00	0.00	1,400.00	0.00	0.00	14,747,750.72	1,755,852.50	40.60617542	-104.58410385
1,500.00	0.00	0.00	1,500.00	0.00	0.00	14,747,750.72	1,755,852.50	40.60617542	-104.58410385
1,600.00	0.00	0.00	1,600.00	0.00	0.00	14,747,750.72	1,755,852.50	40.60617542	-104.58410385
1,700.00	0.00	0.00	1,700.00	0.00	0.00	14,747,750.72	1,755,852.50	40.60617542	-104.58410385
1,800.00	0.00	0.00	1,800.00	0.00	0.00	14,747,750.72	1,755,852.50	40.60617542	-104.58410385
1,900.00	0.00	0.00	1,900.00	0.00	0.00	14,747,750.72	1,755,852.50	40.60617542	-104.58410385
2,000.00	0.00	0.00	2,000.00	0.00	0.00	14,747,750.72	1,755,852.50	40.60617542	-104.58410385
2,100.00	0.00	0.00	2,100.00	0.00	0.00	14,747,750.72	1,755,852.50	40.60617542	-104.58410385
2,200.00	0.00	0.00	2,200.00	0.00	0.00	14,747,750.72	1,755,852.50	40.60617542	-104.58410385
2,300.00	0.00	0.00	2,300.00	0.00	0.00	14,747,750.72	1,755,852.50	40.60617542	-104.58410385
2,400.00	0.00	0.00	2,400.00	0.00	0.00	14,747,750.72	1,755,852.50	40.60617542	-104.58410385
2,500.00	0.00	0.00	2,500.00	0.00	0.00	14,747,750.72	1,755,852.50	40.60617542	-104.58410385
2,600.00	0.00	0.00	2,600.00	0.00	0.00	14,747,750.72	1,755,852.50	40.60617542	-104.58410385
2,700.00	0.00	0.00	2,700.00	0.00	0.00	14,747,750.72	1,755,852.50	40.60617542	-104.58410385
2,800.00	0.00	0.00	2,800.00	0.00	0.00	14,747,750.72	1,755,852.50	40.60617542	-104.58410385
2,900.00	0.00	0.00	2,900.00	0.00	0.00	14,747,750.72	1,755,852.50	40.60617542	-104.58410385
3,000.00	0.00	0.00	3,000.00	0.00	0.00	14,747,750.72	1,755,852.50	40.60617542	-104.58410385
KOP Begin 1°/100' build									
3,100.00	1.00	22.92	3,099.99	0.80	0.34	14,747,751.52	1,755,852.84	40.60617763	-104.58410263
3,200.00	2.00	22.92	3,199.96	3.21	1.36	14,747,753.94	1,755,853.84	40.60618425	-104.58409895
3,300.00	3.00	22.92	3,299.86	7.23	3.06	14,747,757.97	1,755,855.52	40.60619528	-104.58409283
3,400.00	4.00	22.92	3,399.68	12.85	5.44	14,747,763.60	1,755,857.87	40.60621072	-104.58408427
3,500.00	5.00	22.92	3,499.37	20.08	8.49	14,747,770.84	1,755,860.90	40.60623056	-104.58407326
3,600.00	6.00	22.92	3,598.90	28.91	12.23	14,747,779.69	1,755,864.59	40.60625480	-104.58405981
3,700.00	7.00	22.92	3,698.26	39.33	16.63	14,747,790.13	1,755,868.95	40.60628343	-104.58404392
3,800.00	8.00	22.92	3,797.40	51.36	21.72	14,747,802.18	1,755,873.97	40.60631644	-104.58402561
3,900.00	9.00	22.92	3,896.30	64.97	27.48	14,747,815.82	1,755,879.67	40.60635382	-104.58400486
4,000.00	10.00	22.92	3,994.93	80.17	33.90	14,747,831.05	1,755,886.02	40.60639556	-104.58398170
4,066.33	10.66	22.92	4,060.18	91.13	38.54	14,747,842.03	1,755,890.61	40.60642564	-104.58396501
Begin 10.66° tangent									
4,100.00	10.66	22.92	4,093.27	96.87	40.96	14,747,847.78	1,755,893.01	40.60644140	-104.58395627
4,200.00	10.66	22.92	4,191.55	113.91	48.17	14,747,864.85	1,755,900.13	40.60648819	-104.58393030
4,300.00	10.66	22.92	4,289.82	130.95	55.38	14,747,881.93	1,755,907.26	40.60653499	-104.58390433
4,400.00	10.66	22.92	4,388.09	147.99	62.59	14,747,899.01	1,755,914.39	40.60658178	-104.58387837
4,500.00	10.66	22.92	4,486.37	165.03	69.79	14,747,916.08	1,755,921.51	40.60662858	-104.58385240
4,600.00	10.66	22.92	4,584.64	182.08	77.00	14,747,933.16	1,755,928.64	40.60667538	-104.58382643
4,700.00	10.66	22.92	4,682.91	199.12	84.21	14,747,950.23	1,755,935.77	40.60672217	-104.58380047
4,800.00	10.66	22.92	4,781.19	216.16	91.41	14,747,967.31	1,755,942.89	40.60676897	-104.58377450
4,900.00	10.66	22.92	4,879.46	233.20	98.62	14,747,984.39	1,755,950.02	40.60681576	-104.58374854
5,000.00	10.66	22.92	4,977.73	250.25	105.83	14,748,001.46	1,755,957.14	40.60686256	-104.58372257

Database:	DB_Jul2216dt_v14	Local Co-ordinate Reference:	Well Almont 5-01-01L
Company:	Confluence Resources	TVD Reference:	RKB=5001+24 @ 5025.00ft
Project:	Weld County, Colorado	MD Reference:	RKB=5001+24 @ 5025.00ft
Site:	Section 06-T07N-R64W	North Reference:	True
Well:	Almont 5-01-01L	Survey Calculation Method:	Minimum Curvature
Wellbore:	Original Hole		
Design:	plan1		

Planned Survey									
Measured Depth (ft)	Inclination (°)	Azimuth (°)	Vertical Depth (ft)	+N/-S (ft)	+E/-W (ft)	Map Northing (usft)	Map Easting (usft)	Latitude	Longitude
5,100.00	10.66	22.92	5,076.01	267.29	113.04	14,748,018.54	1,755,964.27	40.60690935	-104.58369660
5,200.00	10.66	22.92	5,174.28	284.33	120.24	14,748,035.62	1,755,971.40	40.60695615	-104.58367064
5,300.00	10.66	22.92	5,272.55	301.37	127.45	14,748,052.69	1,755,978.52	40.60700295	-104.58364467
5,400.00	10.66	22.92	5,370.82	318.42	134.66	14,748,069.77	1,755,985.65	40.60704974	-104.58361870
5,500.00	10.66	22.92	5,469.10	335.46	141.87	14,748,086.84	1,755,992.78	40.60709654	-104.58359274
5,600.00	10.66	22.92	5,567.37	352.50	149.07	14,748,103.92	1,755,999.90	40.60714333	-104.58356677
5,700.00	10.66	22.92	5,665.64	369.54	156.28	14,748,121.00	1,756,007.03	40.60719013	-104.58354080
5,800.00	10.66	22.92	5,763.92	386.58	163.49	14,748,138.07	1,756,014.16	40.60723692	-104.58351484
5,900.00	10.66	22.92	5,862.19	403.63	170.69	14,748,155.15	1,756,021.28	40.60728372	-104.58348887
6,000.00	10.66	22.92	5,960.46	420.67	177.90	14,748,172.22	1,756,028.41	40.60733052	-104.58346290
6,100.00	10.66	22.92	6,058.74	437.71	185.11	14,748,189.30	1,756,035.54	40.60737731	-104.58343694
6,200.00	10.66	22.92	6,157.01	454.75	192.32	14,748,206.38	1,756,042.66	40.60742411	-104.58341097
6,300.00	10.66	22.92	6,255.28	471.80	199.52	14,748,223.45	1,756,049.79	40.60747090	-104.58338500
6,400.00	10.66	22.92	6,353.56	488.84	206.73	14,748,240.53	1,756,056.92	40.60751770	-104.58335903
6,500.00	10.66	22.92	6,451.83	505.88	213.94	14,748,257.61	1,756,064.04	40.60756449	-104.58333307
6,563.17	10.66	22.92	6,513.91	516.65	218.49	14,748,268.39	1,756,068.55	40.60759405	-104.58331666
Begin 10°/100' build/turn									
6,600.00	12.57	38.69	6,549.99	522.91	222.32	14,748,274.68	1,756,072.35	40.60761126	-104.58330285
6,700.00	20.33	61.72	6,645.92	539.68	244.48	14,748,291.54	1,756,094.42	40.60765729	-104.58322304
6,800.00	29.44	71.69	6,736.58	555.67	283.21	14,748,307.72	1,756,133.08	40.60770120	-104.58308350
6,900.00	38.96	77.18	6,819.22	570.40	337.33	14,748,322.71	1,756,187.13	40.60774165	-104.58288850
7,000.00	48.65	80.77	6,891.31	583.43	405.21	14,748,336.05	1,756,254.94	40.60777742	-104.58264395
7,100.00	58.42	83.42	6,950.68	594.35	484.77	14,748,347.36	1,756,334.46	40.60780741	-104.58235728
7,200.00	68.24	85.56	6,995.51	602.84	573.61	14,748,356.27	1,756,423.26	40.60783073	-104.58203721
7,300.00	78.08	87.43	7,024.45	608.65	669.02	14,748,362.52	1,756,518.64	40.60784665	-104.58169345
7,400.00	87.93	89.16	7,036.62	611.58	768.11	14,748,365.92	1,756,617.71	40.60785469	-104.58133646
7,421.02	90.00	89.52	7,037.00	611.82	789.12	14,748,366.26	1,756,638.72	40.60785535	-104.58126076
Begin 90.00° lateral									
7,500.00	90.00	89.52	7,037.00	612.48	868.10	14,748,367.29	1,756,717.69	40.60785716	-104.58097620
7,600.00	90.00	89.52	7,037.00	613.32	968.10	14,748,368.60	1,756,817.69	40.60785945	-104.58061593
7,700.00	90.00	89.52	7,037.00	614.16	1,068.09	14,748,369.91	1,756,917.68	40.60786174	-104.58025565
7,800.00	90.00	89.52	7,037.00	614.99	1,168.09	14,748,371.23	1,757,017.67	40.60786403	-104.57989538
7,900.00	90.00	89.52	7,037.00	615.83	1,268.09	14,748,372.54	1,757,117.66	40.60786632	-104.57953511
8,000.00	90.00	89.52	7,037.00	616.67	1,368.08	14,748,373.85	1,757,217.65	40.60786860	-104.57917483
8,100.00	90.00	89.52	7,037.00	617.51	1,468.08	14,748,375.16	1,757,317.64	40.60787089	-104.57881456
8,200.00	90.00	89.52	7,037.00	618.35	1,568.08	14,748,376.47	1,757,417.63	40.60787317	-104.57845428
8,300.00	90.00	89.52	7,037.00	619.18	1,668.07	14,748,377.78	1,757,517.62	40.60787545	-104.57809401
8,400.00	90.00	89.52	7,037.00	620.02	1,768.07	14,748,379.09	1,757,617.62	40.60787773	-104.57773373
8,500.00	90.00	89.52	7,037.00	620.86	1,868.07	14,748,380.40	1,757,717.61	40.60788001	-104.57737346
8,600.00	90.00	89.52	7,037.00	621.70	1,968.06	14,748,381.71	1,757,817.60	40.60788229	-104.57701319
8,700.00	90.00	89.52	7,037.00	622.53	2,068.06	14,748,383.02	1,757,917.59	40.60788457	-104.57665291
8,800.00	90.00	89.52	7,037.00	623.37	2,168.06	14,748,384.33	1,758,017.58	40.60788685	-104.57629264
8,900.00	90.00	89.52	7,037.00	624.21	2,268.05	14,748,385.64	1,758,117.57	40.60788912	-104.57593236
9,000.00	90.00	89.52	7,037.00	625.05	2,368.05	14,748,386.95	1,758,217.56	40.60789140	-104.57557209
9,100.00	90.00	89.52	7,037.00	625.89	2,468.04	14,748,388.26	1,758,317.55	40.60789367	-104.57521181
9,200.00	90.00	89.52	7,037.00	626.72	2,568.04	14,748,389.57	1,758,417.55	40.60789594	-104.57485154
9,300.00	90.00	89.52	7,037.00	627.56	2,668.04	14,748,390.88	1,758,517.54	40.60789821	-104.57449127
9,400.00	90.00	89.52	7,037.00	628.40	2,768.03	14,748,392.19	1,758,617.53	40.60790048	-104.57413099
9,500.00	90.00	89.52	7,037.00	629.24	2,868.03	14,748,393.50	1,758,717.52	40.60790275	-104.57377072
9,600.00	90.00	89.52	7,037.00	630.07	2,968.03	14,748,394.81	1,758,817.51	40.60790502	-104.57341044
9,700.00	90.00	89.52	7,037.00	630.91	3,068.02	14,748,396.12	1,758,917.50	40.60790729	-104.57305017
9,800.00	90.00	89.52	7,037.00	631.75	3,168.02	14,748,397.43	1,759,017.49	40.60790955	-104.57268989
9,900.00	90.00	89.52	7,037.00	632.59	3,268.02	14,748,398.74	1,759,117.48	40.60791182	-104.57232962
10,000.00	90.00	89.52	7,037.00	633.43	3,368.01	14,748,400.05	1,759,217.48	40.60791408	-104.57196934

Database:	DB_Jul2216dt_v14	Local Co-ordinate Reference:	Well Almont 5-01-01L
Company:	Confluence Resources	TVD Reference:	RKB=5001+24 @ 5025.00ft
Project:	Weld County, Colorado	MD Reference:	RKB=5001+24 @ 5025.00ft
Site:	Section 06-T07N-R64W	North Reference:	True
Well:	Almont 5-01-01L	Survey Calculation Method:	Minimum Curvature
Wellbore:	Original Hole		
Design:	plan1		

Planned Survey									
Measured Depth (ft)	Inclination (°)	Azimuth (°)	Vertical Depth (ft)	+N/-S (ft)	+E/-W (ft)	Map Northing (usft)	Map Easting (usft)	Latitude	Longitude
10,100.00	90.00	89.52	7,037.00	634.26	3,468.01	14,748,401.36	1,759,317.47	40.60791634	-104.57160907
10,200.00	90.00	89.52	7,037.00	635.10	3,568.01	14,748,402.67	1,759,417.46	40.60791860	-104.57124880
10,300.00	90.00	89.52	7,037.00	635.94	3,668.00	14,748,403.98	1,759,517.45	40.60792086	-104.57088852
10,400.00	90.00	89.52	7,037.00	636.78	3,768.00	14,748,405.29	1,759,617.44	40.60792312	-104.57052825
10,500.00	90.00	89.52	7,037.00	637.61	3,868.00	14,748,406.60	1,759,717.43	40.60792538	-104.57016797
10,600.00	90.00	89.52	7,037.00	638.45	3,967.99	14,748,407.91	1,759,817.42	40.60792763	-104.56980770
10,700.00	90.00	89.52	7,037.00	639.29	4,067.99	14,748,409.22	1,759,917.41	40.60792989	-104.56944742
10,800.00	90.00	89.52	7,037.00	640.13	4,167.99	14,748,410.53	1,760,017.40	40.60793214	-104.56908715
10,900.00	90.00	89.52	7,037.00	640.97	4,267.98	14,748,411.84	1,760,117.40	40.60793440	-104.56872687
11,000.00	90.00	89.52	7,037.00	641.80	4,367.98	14,748,413.15	1,760,217.39	40.60793665	-104.56836660
11,100.00	90.00	89.52	7,037.00	642.64	4,467.97	14,748,414.46	1,760,317.38	40.60793890	-104.56800632
11,200.00	90.00	89.52	7,037.00	643.48	4,567.97	14,748,415.77	1,760,417.37	40.60794115	-104.56764605
11,300.00	90.00	89.52	7,037.00	644.32	4,667.97	14,748,417.08	1,760,517.36	40.60794340	-104.56728578
11,400.00	90.00	89.52	7,037.00	645.15	4,767.96	14,748,418.39	1,760,617.35	40.60794564	-104.56692550
11,500.00	90.00	89.52	7,037.00	645.99	4,867.96	14,748,419.70	1,760,717.34	40.60794789	-104.56656523
11,600.00	90.00	89.52	7,037.00	646.83	4,967.96	14,748,421.01	1,760,817.33	40.60795014	-104.56620495
11,700.00	90.00	89.52	7,037.00	647.67	5,067.95	14,748,422.32	1,760,917.33	40.60795238	-104.56584468
11,800.00	90.00	89.52	7,037.00	648.51	5,167.95	14,748,423.63	1,761,017.32	40.60795462	-104.56548440
11,900.00	90.00	89.52	7,037.00	649.34	5,267.95	14,748,424.94	1,761,117.31	40.60795686	-104.56512413
12,000.00	90.00	89.52	7,037.00	650.18	5,367.94	14,748,426.25	1,761,217.30	40.60795911	-104.56476385
12,100.00	90.00	89.52	7,037.00	651.02	5,467.94	14,748,427.56	1,761,317.29	40.60796135	-104.56440358
12,200.00	90.00	89.52	7,037.00	651.86	5,567.94	14,748,428.87	1,761,417.28	40.60796358	-104.56404330
12,300.00	90.00	89.52	7,037.00	652.69	5,667.93	14,748,430.18	1,761,517.27	40.60796582	-104.56368303
12,400.00	90.00	89.52	7,037.00	653.53	5,767.93	14,748,431.50	1,761,617.26	40.60796806	-104.56332275
12,500.00	90.00	89.52	7,037.00	654.37	5,867.93	14,748,432.81	1,761,717.26	40.60797029	-104.56296248
12,600.00	90.00	89.52	7,037.00	655.21	5,967.92	14,748,434.12	1,761,817.25	40.60797253	-104.56260220
12,700.00	90.00	89.52	7,037.00	656.05	6,067.92	14,748,435.43	1,761,917.24	40.60797476	-104.56224193
12,800.00	90.00	89.52	7,037.00	656.88	6,167.91	14,748,436.74	1,762,017.23	40.60797699	-104.56188165
12,900.00	90.00	89.52	7,037.00	657.72	6,267.91	14,748,438.05	1,762,117.22	40.60797922	-104.56152138
13,000.00	90.00	89.52	7,037.00	658.56	6,367.91	14,748,439.36	1,762,217.21	40.60798145	-104.56116110
13,100.00	90.00	89.52	7,037.00	659.40	6,467.90	14,748,440.67	1,762,317.20	40.60798368	-104.56080083
13,200.00	90.00	89.52	7,037.00	660.23	6,567.90	14,748,441.98	1,762,417.19	40.60798591	-104.56044055
13,300.00	90.00	89.52	7,037.00	661.07	6,667.90	14,748,443.29	1,762,517.19	40.60798813	-104.56008028
13,400.00	90.00	89.52	7,037.00	661.91	6,767.89	14,748,444.60	1,762,617.18	40.60799036	-104.55972001
13,500.00	90.00	89.52	7,037.00	662.75	6,867.89	14,748,445.91	1,762,717.17	40.60799258	-104.55935973
13,600.00	90.00	89.52	7,037.00	663.59	6,967.89	14,748,447.22	1,762,817.16	40.60799480	-104.55899946
13,700.00	90.00	89.52	7,037.00	664.42	7,067.88	14,748,448.53	1,762,917.15	40.60799702	-104.55863918
13,800.00	90.00	89.52	7,037.00	665.26	7,167.88	14,748,449.84	1,763,017.14	40.60799925	-104.55827891
13,900.00	90.00	89.52	7,037.00	666.10	7,267.88	14,748,451.15	1,763,117.13	40.60800146	-104.55791863
14,000.00	90.00	89.52	7,037.00	666.94	7,367.87	14,748,452.46	1,763,217.12	40.60800368	-104.55755836
14,100.00	90.00	89.52	7,037.00	667.77	7,467.87	14,748,453.77	1,763,317.12	40.60800590	-104.55719808
14,200.00	90.00	89.52	7,037.00	668.61	7,567.87	14,748,455.08	1,763,417.11	40.60800812	-104.55683781
14,300.00	90.00	89.52	7,037.00	669.45	7,667.86	14,748,456.39	1,763,517.10	40.60801033	-104.55647753
14,400.00	90.00	89.52	7,037.00	670.29	7,767.86	14,748,457.70	1,763,617.09	40.60801254	-104.55611725
14,500.00	90.00	89.52	7,037.00	671.13	7,867.86	14,748,459.01	1,763,717.08	40.60801476	-104.55575698
14,600.00	90.00	89.52	7,037.00	671.96	7,967.85	14,748,460.32	1,763,817.07	40.60801697	-104.55539670
14,700.00	90.00	89.52	7,037.00	672.80	8,067.85	14,748,461.63	1,763,917.06	40.60801918	-104.55503643
14,800.00	90.00	89.52	7,037.00	673.64	8,167.84	14,748,462.94	1,764,017.05	40.60802139	-104.55467615
14,900.00	90.00	89.52	7,037.00	674.48	8,267.84	14,748,464.25	1,764,117.04	40.60802360	-104.55431588
15,000.00	90.00	89.52	7,037.00	675.31	8,367.84	14,748,465.56	1,764,217.04	40.60802580	-104.55395560
15,100.00	90.00	89.52	7,037.00	676.15	8,467.83	14,748,466.87	1,764,317.03	40.60802801	-104.55359533
15,200.00	90.00	89.52	7,037.00	676.99	8,567.83	14,748,468.18	1,764,417.02	40.60803021	-104.55323505
15,300.00	90.00	89.52	7,037.00	677.83	8,667.83	14,748,469.49	1,764,517.01	40.60803242	-104.55287478
15,400.00	90.00	89.52	7,037.00	678.67	8,767.82	14,748,470.80	1,764,617.00	40.60803462	-104.55251450
15,500.00	90.00	89.52	7,037.00	679.50	8,867.82	14,748,472.11	1,764,716.99	40.60803682	-104.55215423

Database:	DB_Jul2216dt_v14	Local Co-ordinate Reference:	Well Almont 5-01-01L
Company:	Confluence Resources	TVD Reference:	RKB=5001+24 @ 5025.00ft
Project:	Weld County, Colorado	MD Reference:	RKB=5001+24 @ 5025.00ft
Site:	Section 06-T07N-R64W	North Reference:	True
Well:	Almont 5-01-01L	Survey Calculation Method:	Minimum Curvature
Wellbore:	Original Hole		
Design:	plan1		

Planned Survey									
Measured Depth (ft)	Inclination (°)	Azimuth (°)	Vertical Depth (ft)	+N/-S (ft)	+E/-W (ft)	Map Northing (usft)	Map Easting (usft)	Latitude	Longitude
15,600.00	90.00	89.52	7,037.00	680.34	8,967.82	14,748,473.42	1,764,816.98	40.60803902	-104.55179395
15,700.00	90.00	89.52	7,037.00	681.18	9,067.81	14,748,474.73	1,764,916.97	40.60804122	-104.55143368
15,800.00	90.00	89.52	7,037.00	682.02	9,167.81	14,748,476.04	1,765,016.97	40.60804342	-104.55107340
15,900.00	90.00	89.52	7,037.00	682.85	9,267.81	14,748,477.35	1,765,116.96	40.60804561	-104.55071313
16,000.00	90.00	89.52	7,037.00	683.69	9,367.80	14,748,478.66	1,765,216.95	40.60804781	-104.55035285
16,100.00	90.00	89.52	7,037.00	684.53	9,467.80	14,748,479.97	1,765,316.94	40.60805001	-104.54999258
16,200.00	90.00	89.52	7,037.00	685.37	9,567.80	14,748,481.28	1,765,416.93	40.60805220	-104.54963230
16,300.00	90.00	89.52	7,037.00	686.21	9,667.79	14,748,482.59	1,765,516.92	40.60805439	-104.54927203
16,400.00	90.00	89.52	7,037.00	687.04	9,767.79	14,748,483.90	1,765,616.91	40.60805658	-104.54891175
16,500.00	90.00	89.52	7,037.00	687.88	9,867.79	14,748,485.21	1,765,716.90	40.60805877	-104.54855148
16,600.00	90.00	89.52	7,037.00	688.72	9,967.78	14,748,486.52	1,765,816.90	40.60806096	-104.54819120
16,700.00	90.00	89.52	7,037.00	689.56	10,067.78	14,748,487.83	1,765,916.89	40.60806315	-104.54783092
16,800.00	90.00	89.52	7,037.00	690.39	10,167.77	14,748,489.14	1,766,016.88	40.60806534	-104.54747065
16,900.00	90.00	89.52	7,037.00	691.23	10,267.77	14,748,490.45	1,766,116.87	40.60806752	-104.54711037
17,000.00	90.00	89.52	7,037.00	692.07	10,367.77	14,748,491.77	1,766,216.86	40.60806971	-104.54675010
17,086.60	90.00	89.52	7,037.00	692.80	10,454.36	14,748,492.90	1,766,303.45	40.60807160	-104.54643811
PBHL/TD 17086.60 MD/7037.00 TVD									

Design Targets									
Target Name	Dip Angle (°)	Dip Dir. (°)	TVD (ft)	+N/-S (ft)	+E/-W (ft)	Northing (usft)	Easting (usft)	Latitude	Longitude
- hit/miss target									
- Shape									
Almont 5-01-01L PBHL 4	0.00	0.00	7,037.00	692.80	10,454.36	14,748,492.90	1,766,303.45	40.60807160	-104.54643811
- plan hits target center									
- Point									
Almont 5-01-01L LP 470	0.00	0.00	7,037.00	611.82	789.12	14,748,366.26	1,756,638.72	40.60785535	-104.58126076
- plan hits target center									
- Point									

Plan Annotations				
Measured Depth (ft)	Vertical Depth (ft)	Local Coordinates		Comment
		+N/-S (ft)	+E/-W (ft)	
3,000.00	3,000.00	0.00	0.00	KOP Begin 1°/100' build
4,066.33	4,060.18	91.13	38.54	Begin 10.66° tangent
6,563.17	6,513.91	516.65	218.49	Begin 10°/100' build/turn
7,421.02	7,037.00	611.82	789.12	Begin 90.00° lateral
17,086.60	7,037.00	692.80	10,454.36	PBHL/TD 17086.60 MD/7037.00 TVD