



November 9, 2017

Mr. Matt Lepore, Director
Colorado Oil and Gas Conservation Commission
1120 Lincoln Street, Suite 801
Denver, Colorado 80203

**RE: COGCC Rule 318A.e.: Proposed Spacing Unit
G & D Hanks QA-27-28HN Well: SWSE Section 27, Township 7 North, Range 66 West
Weld County, Colorado**

Dear Mr. Lepore:

Bayswater Exploration & Production, LLC (Bayswater) is planning to drill the above referenced well in accordance with the provisions set out in Colorado Oil and Gas Conservation Commission (COGCC) Rule 318A.e. Bayswater's Proposed Spacing Unit consists of:

S½ of Section 27 & 28, Township 7 North, Range 66 West
E½SE¼ of Section 29, Township 7 North, Range 66 West
Containing 720.00 acres, more or less

Bayswater is not the only owner within the Proposed Spacing Unit and has provided notice to the remaining owners, as required by COGCC Rule 318A.e.(6). Copies of the required notification letters are on file at Bayswater's office. The required thirty (30) day notice period has elapsed absent the receipt by Bayswater of any objection to their proposal by the owners within the Proposed Spacing Unit for the subject well.

Enclosed is the Proposed Spacing Unit Exhibit to assist in your review and approval of Bayswater's proposed Application for Permit to Drill for the G & D Hanks QA-27-28HN Well. Many thanks for your attention to this matter.

Respectfully,

A handwritten signature in black ink, appearing to read 'Justin Garrett', written over a light blue horizontal line.

Justin Garrett
Regulatory Analyst
Agent for Bayswater Exploration & Production, LLC

:jg

Enclosure: Proposed Spacing Unit Exhibit

G & D HANKS 27-N PAD
PROPOSED 318A.a.(4)D. SPACING UNIT
SEC 27, T7N, R66W: S2
SEC 28, T7N, R66W: S2
SEC 29, T7N, R66W: E2SE4

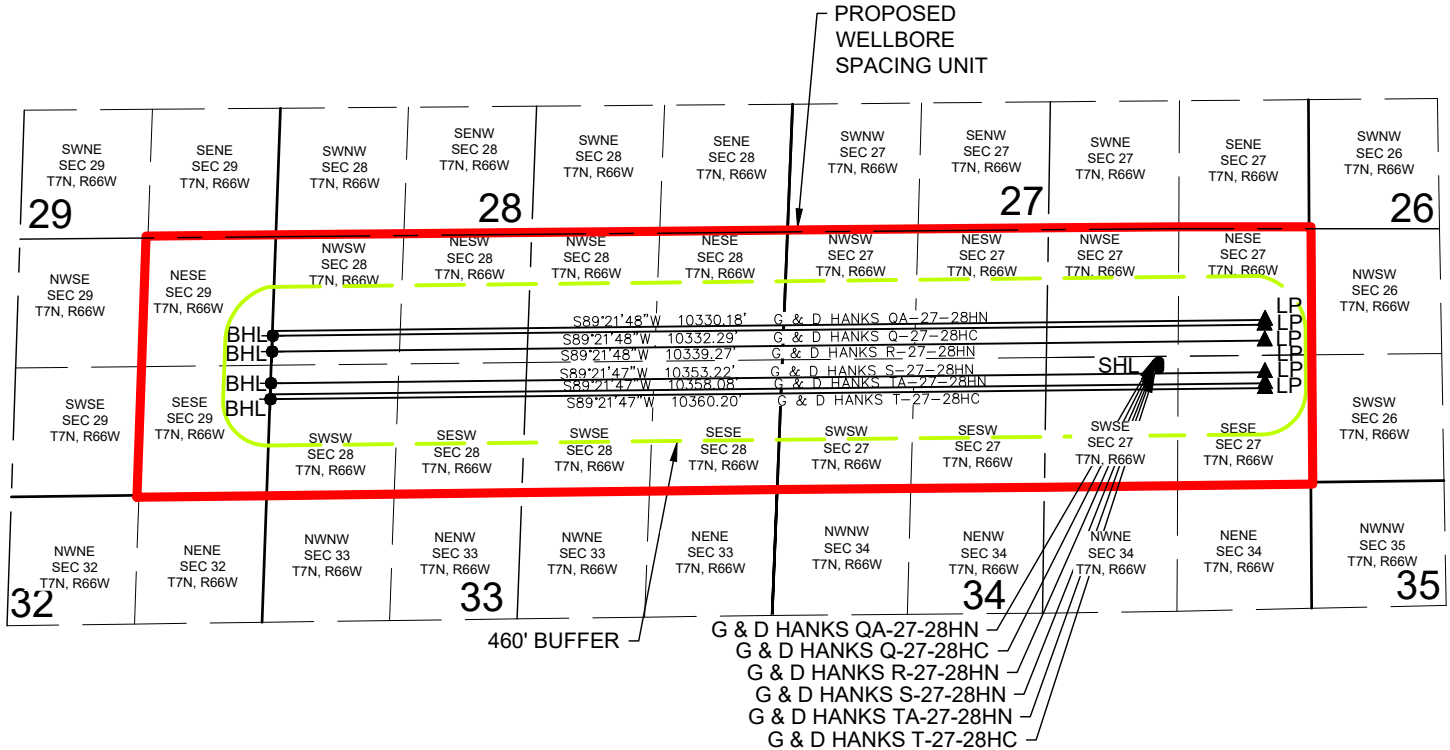

G & D HANKS QA-27-28HN WELL TO BE LOCATED 1273' FSL AND 1574' FEL, SEC 27, T7N, R66W
G & D HANKS Q-27-28HC WELL TO BE LOCATED 1258' FSL AND 1574' FEL, SEC 27, T7N, R66W
G & D HANKS R-27-28HN WELL TO BE LOCATED 1243' FSL AND 1574' FEL, SEC 27, T7N, R66W
G & D HANKS S-27-28HN WELL TO BE LOCATED 1228' FSL AND 1575' FEL, SEC 27, T7N, R66W
G & D HANKS TA-27-28HN WELL TO BE LOCATED 1213' FSL AND 1575' FEL, SEC 27, T7N, R66W
G & D HANKS T-27-28HC WELL TO BE LOCATED 1198' FSL AND 1575' FEL, SEC 27, T7N, R66W

LEGEND

● = PROPOSED WELL
 ● = BOTTOM HOLE
 ▲ = LANDING POINT
 SHL = SURFACE HOLE LOCATION
 BHL = BOTTOM HOLE LOCATION
 LP = LANDING POINT

DISCLAIMER:
 THIS PLOT DOES NOT REPRESENT A MONUMENTED LAND SURVEY AND SHOULD NOT BE
 RELIED UPON TO DETERMINE BOUNDARY LINES, PROPERTY OWNERSHIP OR OTHER
 PROPERTY INTERESTS. PARCEL LINES, IF DEPICTED HAVE NOT BEEN FIELD VERIFIED AND
 MAY BE BASED UPON PUBLICLY AVAILABLE DATA THAT ALSO HAS NOT BEEN
 INDEPENDENTLY VERIFIED.

