

#### LEGEND:

PROPOSED LOCATION



#### BISON EXPLORATION

**DALTON 5-64 2 PAD**  
SW 1/4 NW 1/4, SECTION 2, T5S, R64W, 6th P.M.  
ARAPAHOE COUNTY, COLORADO



**UELS, LLC**  
Corporate Office \* 85 South 200 East  
Vernal, UT 84078 \* (435) 789-1017

|                        |            |          |               |
|------------------------|------------|----------|---------------|
| SURVEYED BY            | J.C., G.W. | 04-05-17 | SCALE         |
| DRAWN BY               | B.R.       | 04-06-17 | 1 : 100,000   |
| <b>ACCESS ROAD MAP</b> |            |          | <b>TOPO A</b> |



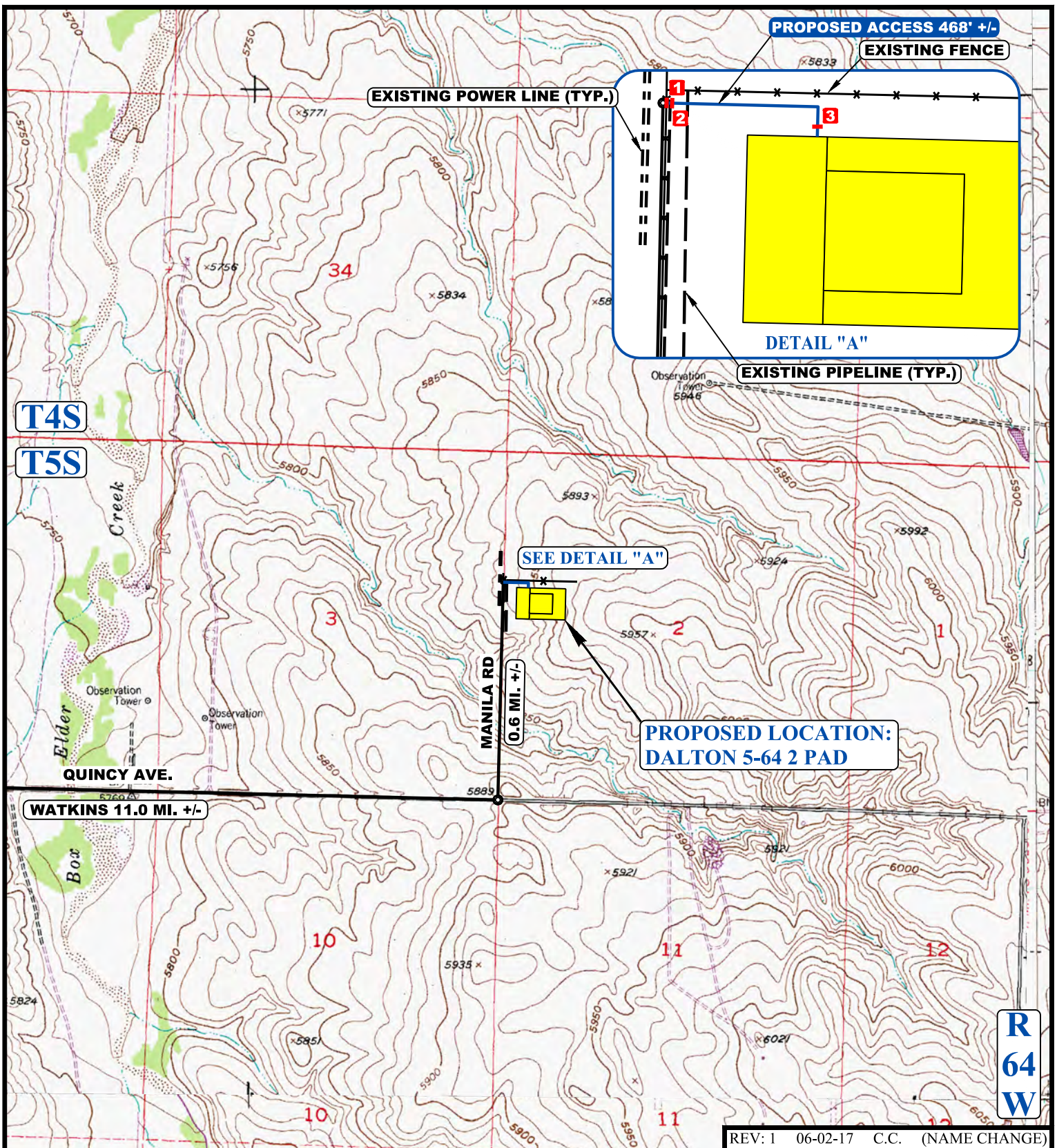

NOTE: PARCEL DATA SHOWN HAS BEEN OBTAINED FROM VARIOUS SOURCES AND SHOULD BE USED FOR MAPPING, GRAPHIC AND PLANNING PURPOSES ONLY. NO WARRANTY IS MADE BY UINTAH ENGINEERING AND LAND SURVEYING (UELS) FOR ACCURACY OF THE PARCEL DATA.

#### LEGEND:

|  |                      |          |                      |
|--|----------------------|----------|----------------------|
|  | <b>PROPOSED ROAD</b> | <b>1</b> | INSTALL CATTLE GUARD |
|  | EXISTING ROAD        | <b>2</b> | INSTALL 36" CULVERT  |
|  | EXISTING PIPELINE    | <b>3</b> | INSTALL 18" CULVERT  |
|  | EXISTING FENCE       |          |                      |
|  | EXISTING POWER LINE  |          |                      |



#### BISON EXPLORATION

**DALTON 5-64 2 PAD**  
 SW 1/4 NW 1/4, SECTION 2, T5S, R64W, 6th P.M.  
 ARAPAHOE COUNTY, COLORADO

|                        |            |          |               |
|------------------------|------------|----------|---------------|
| SURVEYED BY            | J.C., G.W. | 04-05-17 | SCALE         |
| DRAWN BY               | B.R.       | 04-06-17 | 1 : 24,000    |
| <b>ACCESS ROAD MAP</b> |            |          | <b>TOPO B</b> |



**UELS, LLC**  
 Corporate Office \* 85 South 200 East  
 Vernal, UT 84078 \* (435) 789-1017