

77N, R80W, 6th P.M.

RAY RANCH 0780 4-16H

Landing Point Location  
300' FSL, 350' FEL N=1452036.53, E=2758250.25

N89°32'35"W 2635.67' (Meas.)

N88°35'37"W 2677.95' (Meas.)

GLO Brass Cap 1939  
N=1451793.69, E=2755918.63

GLO Brass Cap 1939  
N=1451814.71, E=2753283.04

RAY RANCH 0780 4-16H

Surface Location  
Elev. Ungraded  
Ground=8235'  
250' FNL, 1912' FEL  
N=1451524.43, E=2756680.97

S00°58'28"W 2635.32' (Meas.)

GLO Brass Cap 1939  
N=1449179.77, E=2753238.22

21

GLO Brass Cap 1939  
N=1449064.26  
E=2758557.48

S01°18'12"W 2643.19' (Meas.)

N88°57'45"W 2704.58' (Meas.)

GLO Brass Cap 1939  
N=1446537.26, E=2753178.10

S88°49'51"E 2641.94' (Meas.)

GLO Brass Cap 1939  
N=1446488.29, E=2755882.24

N00°44'14"E 2630.09' (Meas.)

N00°49'25"E 2663.97' (Meas.)

GLO Brass Cap 1939  
N=1446434.39, E=2758523.63

GLO Brass Cap 1939  
N=1451727.96, E=2758595.77 Elev. = 8223'

## SandRidge Exploration & Production, LLC

Surface Location, RAY RANCH 0780 4-16H, located as shown in the NW1/4NE1/4 of Section 21, T7N, R80W, 6th P.M., Jackson County, Colorado.

### BASIS OF BEARINGS:

US STATE PLANE 1983  
CO NORTH 0501 GRID

### BASIS OF ELEVATION

SPOT ELEVATION AT THE NE CORNER OF SECTION 21, T7N, R80W, 6TH PM, TAKEN FROM THE COALMONT QUADRANGLE, USGS 7.5 MIN QUAD (TOPOGRAPHIC MAP) WITH SAID ELEVATION MARKED AS BEING 8223 FEET.

### SURFACE USE

AGRICULTURAL/GRAZING

GRAPHIC SCALE 1"=1000'

1000 0 1000



I RANDALL R. MILLER, BEING A REGISTERED LAND SURVEYOR IN THE STATE OF COLORADO, DO HEREBY CERTIFY THAT THIS PLAT WAS MADE BY ME AND/OR UNDER MY DIRECT SUPERVISION AND THAT IT IS ACCURATE TO THE BEST OF MY KNOWLEDGE.

DATED THIS \_\_\_\_\_ DAY OF \_\_\_\_\_

RANDALL R. MILLER, COLORADO PLSD# 38084

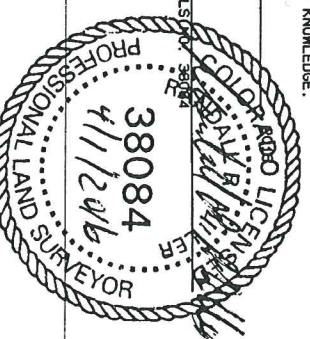

### LEGEND

90° SYMBOL  
FOUND CORNER  
PROPOSED WELL  
PROPOSED BHL/LPL

NAD 83 (TARGET BOTTOM HOLE)  
LATITUDE=40.584242° N  
LONGITUDE=106.370133° W

NAD 83 (SURFACE LOCATION)  
LATITUDE=40.569535° N  
LONGITUDE=106.375849° W  
PDOP=1.736

NORTH PARK ENGINEERING & CONSULTING, INC.  
P.O. BOX 395  
WALDEN, CO 80480  
(970) 723-3725  
DATE OF FIELD WORK: JUL 22, 2015  
DRAWING COMPLETION: MAR 30, 2016  
SURVEYED BY: RAS  
DRAWN BY: THH  
CHECKED BY: RRM

T7N, R80W, 6th P.M.

Aluminum Cap PLS 38084  
N=1457126.92, E=2756016.35

GLO Brass Cap 1939  
PLS 17492 2008  
N=1457081.47, E=2753355.52

GLO Brass Cap 1939  
N=1457172.68, E=2758675.95

N89°01'04"E 2660.60' (Meas.)

RAY RANCH 0780 4-16H  
Target Bottom Hole  
300' FSL, 350' FEL  
N=1456866.55, E=2758321.38

GLO Brass Cap 1939  
N=1454447.37, E=2758635.58

16

RAY RANCH 0780 4-16H

Landing Point Location  
300' FSL, 350' FEL  
N=1452036.53, E=2758250.25

GLO Brass Cap 1939  
N=1451793.69  
E=2755918.63

N89°32'35"W 2635.67' (Meas.)

GLO Brass Cap 1939  
N=1451814.71, E=2753283.04

N88°35'37"W 2677.95' (Meas.)

N00°50'19"E 2719.71' (Meas.)

N00°50'55"E 2725.60' (Meas.)

GLO Brass Cap 1939  
N=1451727.96, E=2758595.77

SandRidge Exploration & Production, LLC

Target Bottom Hole, RAY RANCH 0780 4-16H Located as shown in the NE1/4NE1/4 of Section 16, T7N, R80W, 6th P.M., Jackson County, Colorado.

BASIS OF BEARINGS:

US STATE PLANE 1983  
CO NORTH 0501 GRID

BASIS OF ELEVATION

SPOT ELEVATION AT THE NE CORNER OF SECTION 21, T7N, R80W, 6TH PM, TAKEN FROM THE COALMONT QUADRANGLE, USGS 7.5 MIN QUAD (TOPOGRAPHIC MAP) WITH SAID ELEVATION MARKED AS BEING 8223 FEET.

SURFACE USE

AGRICULTURAL/GRAZING

GRAPHIC SCALE 1"=1000'

1000 0 1000



I, RANDALL R. MILLER, BEING A REGISTERED LAND SURVEYOR IN THE STATE OF COLORADO, DO HEREBY CERTIFY THAT I HAVE MADE BY ME AND/OR UNDER MY DIRECT SUPERVISION AND THAT IT IS ACCURATE TO THE BEST OF MY KNOWLEDGE.

DATED THIS \_\_\_\_\_ DAY OF \_\_\_\_\_

RANDALL R. MILLER, COLORADO PLS NO. 38084

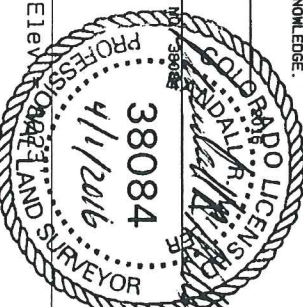

NORTH PARK ENGINEERING & CONSULTING, INC.

P.O. BOX 395  
MALDEN, CO 80480  
(970) 723-3725

DATE OF FIELD WORK: JUL 22, 2015 DRAWING COMPLETION: MAR 30, 2016  
SURVEYED BY: RAS DRAWN BY: THH CHECKED BY: RRM

LEGEND

90° SYMBOL  
FOUND CORNER  
PROPOSED WELL  
PROPOSED BHL/LPL

NAD 83 (TARGET BOTTOM HOLE)	NAD 83 (SURFACE LOCATION)
LATITUDE=40.584242°N LONGITUDE=106.370133°W	LATITUDE=40.569535°N LONGITUDE=106.375849°W PDOP=1.736
NAD 83 (LANDING POINT LOCATION)	
LATITUDE=40.570983°N LONGITUDE=106.370219°W	