



August 26, 2015

Mr. Matt Lepore, Director
Colorado Oil and Gas Conservation Commission
1120 Lincoln Street, Suite 801
Denver, Colorado 80203

7535 Hilltop Circle
Denver, CO 80221
www.petro-fs.com

**RE: COGCC Rule 318A.e.: Proposed Spacing Unit
Wilkinson H-12HC Well: SWSW Section 1, Township 6 North, Range 65 West
Weld County, Colorado**

Dear Mr. Lepore:

Bayswater Exploration & Production, LLC (Bayswater) is planning to drill the above referenced well in accordance with the provisions set out in Colorado Oil and Gas Conservation Commission (COGCC) Rule 318A.e. Bayswater's Proposed Spacing Unit consists of:

S½SW¼ of Section 1, Township 6 North, Range 65 West
W½ of Section 12, Township 6 North, Range 65 West
Containing 400.00 acres, more or less

Bayswater is not the only owner within the Proposed Spacing Unit and has provided notice to the remaining owners, as required by COGCC Rule 318A.e.(6). Copies of the required notification letters are on file at Bayswater's office. The required thirty (30) day notice period has elapsed absent the receipt by Bayswater of any objection to their proposal by the owners within the Proposed Spacing Unit for the subject well.

Enclosed is the Proposed Spacing Unit Exhibit to assist in your review and approval of Bayswater's proposed Application for Permit to Drill for the Wilkinson H-12HC Well. Many thanks for your attention to this matter.

Respectfully,



Jennifer Grosshans
Regulatory Analyst
Agent for Bayswater Exploration & Production, LLC

:jg

Enclosure: Proposed Spacing Unit Exhibit

We are what we repeatedly do. Excellence, then, is not an act, but a habit.

-Aristotle

**WILKINSON 1-P PAD
PROPOSED 318A.e. SPACING UNIT
SEC. 1: S2SW4
SEC. 12: W2**

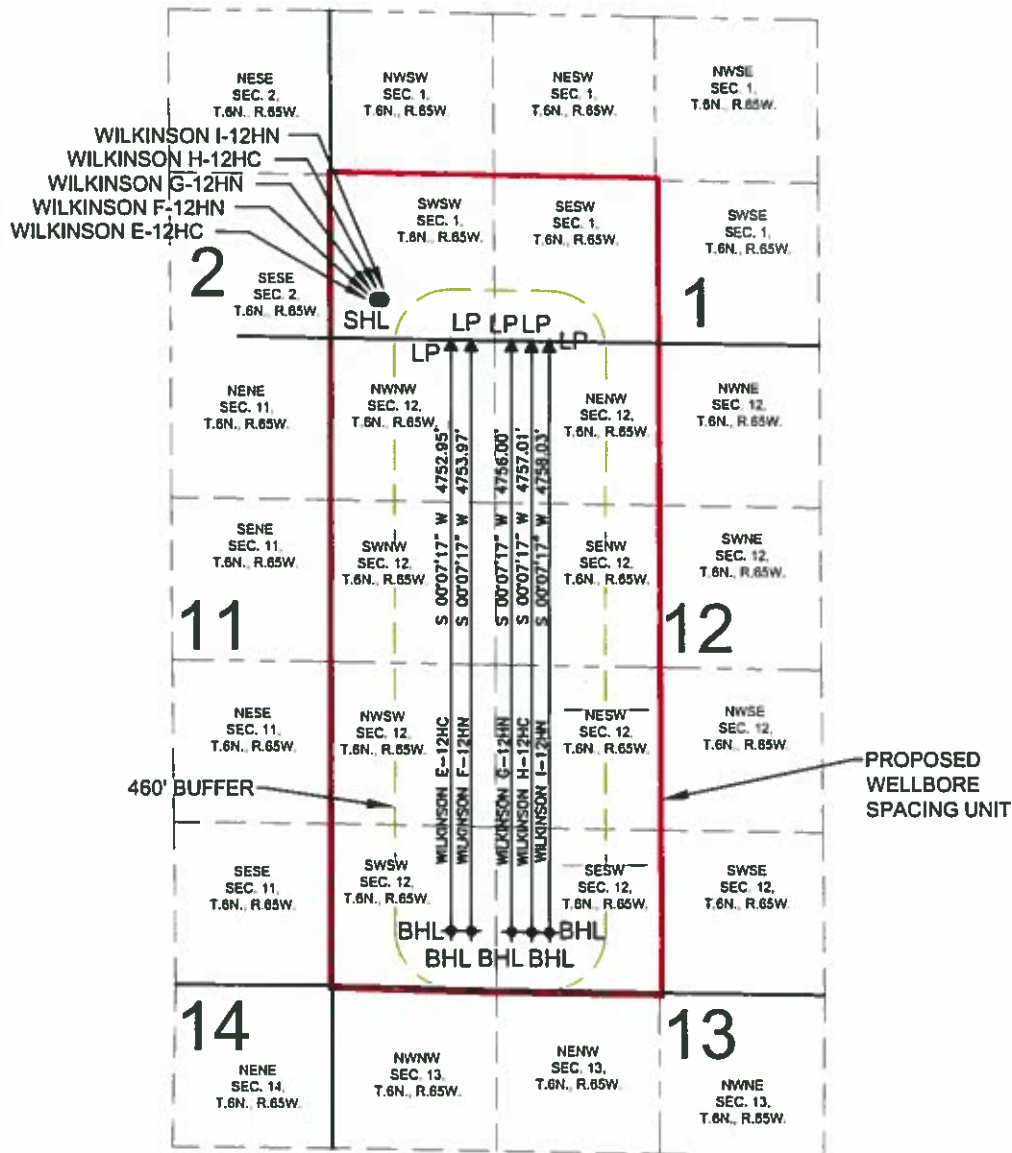

WELL WILKINSON E-12HC TO BE LOCATED 316' FSL AND 360' FWL, SEC. 1, T.6N, R.65W
WELL WILKINSON F-12HN TO BE LOCATED 316' FSL AND 375' FWL, SEC. 1, T.6N, R.65W
WELL WILKINSON G-12HN TO BE LOCATED 316' FSL AND 390' FWL, SEC. 1, T.6N, R.65W
WELL WILKINSON H-12HC TO BE LOCATED 316' FSL AND 405' FWL, SEC. 1, T.6N, R.65W
WELL WILKINSON I-12HN TO BE LOCATED 316' FSL AND 420' FWL, SEC. 1, T.6N, R.65W

LEGEND

- = PROPOSED WELL
- ▲ = LANDING POINT
- ⬇ = BOTTOM HOLE
- SHL = SURFACE HOLE
- LP = LANDING POINT
- BHL = BOTTOM HOLE

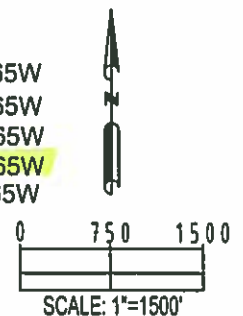

PREPARED BY:



FIELD DATE:

06-23-15

DRAWING DATE:

07-14-15

BY:

CSG

CHECKED BY:

MDC

SITE NAME:

WILKINSON 1-P PAD

SURFACE LOCATION:

SW 1/4 SW 1/4, SEC. 1, T.6N, R.65W, 6TH P.M.

WELD COUNTY, COLORADO

PREPARED FOR:

