

Location:	COLORADO	Slot:	SLOT#43 JESTER 41N-14HZ (1320°FNL & 265°FWL, SEC.15)
Field:	WELD COUNTY (UTM/TRUE NORTH)	Well:	JESTER 41N-14HZ
Facility:	SEC.15-T3N-R67W	Wellbore:	JESTER 41N-14HZ PWB

Plot reference wellpath is JESTER 41N-14HZ (REV-B.O) PWP	
True vertical depths are referenced to PRECISION 460 (20'KB) (RKB)	Grid System: NAD83 / UTM Zone 13 North, US feet
Measured depths are referenced to PRECISION 460 (20'KB) (RKB)	North Reference: True north
PRECISION 460 (20'KB) (RKB) to Mean Sea Level: 4813 feet	Scale: True distance
Mean Sea Level to Mud line (At Slot: SLOT#43 JESTER 41N-14HZ (1320'FNL & 265'FWL, SEC.15)): 0 feet	Depths are in feet
Coordinates are in feet referenced to Slot	Created by: amarcam on 26/Jun/2015

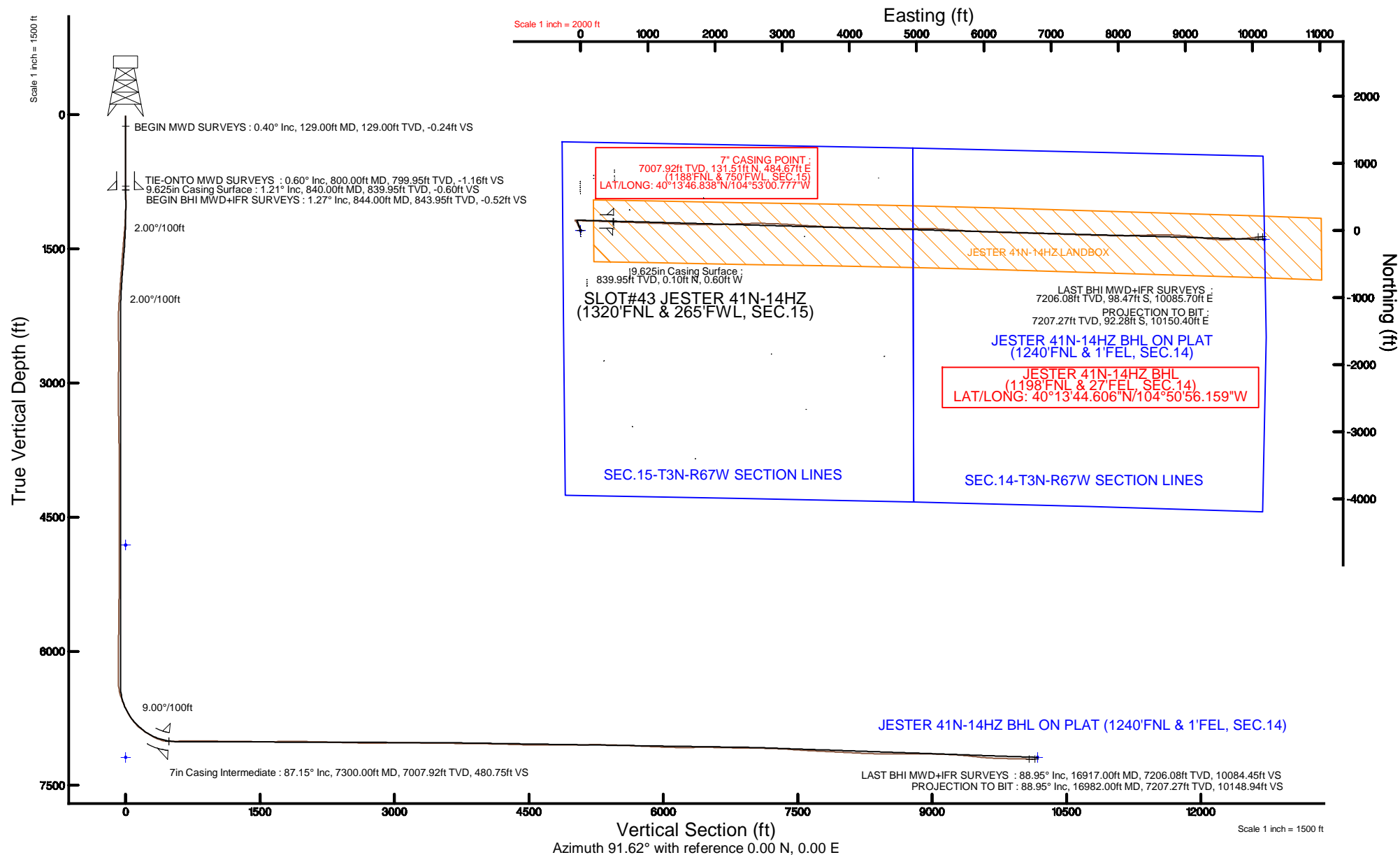



Actual Wellpath Report

JESTER 41N-14HZ AWP
Page 1 of 7



REFERENCE WELLPATH IDENTIFICATION

Operator	KERR-MCGEE OIL & GAS ONSHORE LP (WA)	Slot	SLOT#43 JESTER 41N-14HZ (1320'FNL & 265'FWL, SEC.15)
Area	COLORADO	Well	JESTER 41N-14HZ
Field	WELD COUNTY (UTM/TRUE NORTH)	Wellbore	JESTER 41N-14HZ AWP <16982>
Facility	SEC.15-T3N-R67W		

REPORT SETUP INFORMATION

Projection System	NAD83 / UTM Zone 13 North, US feet	Software System	WellArchitect® 4.0.0
North Reference	True	User	Amarcar
Scale	0.999601	Report Generated	26/Jun/2015 at 09:33
Convergence at slot	0.07° East	Database/Source file	KERR MCGEE UTM/JESTER_41N-14HZ_AWP__16982_.xml

WELLPATH LOCATION

	Local coordinates		Grid coordinates		Geographic coordinates	
	North[ft]	East[ft]	Easting[US ft]	Northing[US ft]	Latitude	Longitude
Slot Location	693.75	-1740.65	1672434.99	14610259.10	40°13'45.538"N	104°53'07.026"W
Facility Reference Pt			1674175.89	14609568.00	40°13'38.683"N	104°52'44.584"W
Field Reference Pt			1698235.31	14552047.82	40°04'09.600"N	104°47'36.000"W

WELLPATH DATUM

Calculation method	Minimum curvature	PRECISION 460 (20'KB) (RKB) to Facility Vertical Datum	4813.00ft
Horizontal Reference Pt	Slot	PRECISION 460 (20'KB) (RKB) to Mean Sea Level	4813.00ft
Vertical Reference Pt	PRECISION 460 (20'KB) (RKB)	PRECISION 460 (20'KB) (RKB) to Mud Line at Slot (SLOT#43 JESTER 41N-14HZ (1320'FNL & 265'FWL, SEC.15))	4813.00ft
MD Reference Pt	PRECISION 460 (20'KB) (RKB)	Section Origin	N 0.00, E 0.00 ft
Field Vertical Reference	Mean Sea Level	Section Azimuth	91.62°

Actual Wellpath Report

JESTER 41N-14HZ AWP

Page 2 of 7

REFERENCE WELLPATH IDENTIFICATION

Operator	KERR-MCGEE OIL & GAS ONSHORE LP (WA)	Slot	SLOT#43 JESTER 41N-14HZ (1320°FNL & 265°FWL, SEC.15)
Area	COLORADO	Well	JESTER 41N-14HZ
Field	WELD COUNTY (UTM/TRUE NORTH)	Wellbore	JESTER 41N-14HZ AWP <16982>
Facility	SEC.15-T3N-R67W		

WELLPATH DATA (173 stations) † = interpolated/extrapolated station

MD [ft]	Inclination [°]	Azimuth [°]	TVD [ft]	Vert Sect [ft]	North [ft]	East [ft]	Latitude	Longitude	DLS [°/100ft]	Comments
0.00†	0.000	322.300	0.00	0.00	0.00	0.00	40°13'45.538"N	104°53'07.026"W	0.00	
20.00	0.000	322.300	20.00	0.00	0.00	0.00	40°13'45.538"N	104°53'07.026"W	0.00	
129.00	0.400	322.300	129.00	-0.24	0.30	-0.23	40°13'45.541"N	104°53'07.029"W	0.37	BEGIN MWD SURVEYS
190.00	0.400	319.800	190.00	-0.52	0.63	-0.50	40°13'45.544"N	104°53'07.032"W	0.03	
252.00	0.600	315.000	252.00	-0.90	1.03	-0.87	40°13'45.548"N	104°53'07.037"W	0.33	
314.00	1.000	292.400	313.99	-1.64	1.46	-1.60	40°13'45.552"N	104°53'07.047"W	0.81	
376.00	1.100	332.200	375.98	-2.44	2.20	-2.38	40°13'45.560"N	104°53'07.057"W	1.16	
461.00	0.200	36.500	460.97	-2.75	3.04	-2.67	40°13'45.568"N	104°53'07.060"W	1.21	
544.00	0.500	102.400	543.97	-2.32	3.08	-2.23	40°13'45.568"N	104°53'07.055"W	0.55	
629.00	0.700	176.100	628.97	-1.90	2.48	-1.83	40°13'45.562"N	104°53'07.050"W	0.87	
713.00	0.900	168.900	712.96	-1.71	1.32	-1.67	40°13'45.551"N	104°53'07.048"W	0.27	
800.00	0.600	121.400	799.95	-1.16	0.41	-1.15	40°13'45.542"N	104°53'07.041"W	0.76	TIE-ONTO MWD SURVEYS
844.00	1.270	117.930	843.95	-0.52	0.06	-0.52	40°13'45.539"N	104°53'07.033"W	1.53	BEGIN BHI MWD+IFR SURVEYS
938.00	1.540	26.930	937.93	0.95	0.70	0.97	40°13'45.545"N	104°53'07.013"W	2.14	
1033.00	3.400	341.590	1032.84	0.53	4.51	0.66	40°13'45.583"N	104°53'07.018"W	2.70	
1127.00	6.760	341.490	1126.46	-2.33	12.40	-1.98	40°13'45.661"N	104°53'07.052"W	3.57	
1221.00	8.930	334.540	1219.58	-7.56	24.24	-6.87	40°13'45.778"N	104°53'07.115"W	2.52	
1316.00	8.750	328.210	1313.45	-14.89	37.04	-13.85	40°13'45.904"N	104°53'07.205"W	1.04	
1410.00	8.830	326.100	1406.35	-23.02	49.10	-21.64	40°13'46.023"N	104°53'07.305"W	0.35	
1504.00	9.600	333.070	1499.14	-30.96	62.08	-29.21	40°13'46.151"N	104°53'07.403"W	1.44	
1594.00	10.220	336.690	1587.79	-37.91	76.11	-35.77	40°13'46.290"N	104°53'07.487"W	0.98	
1683.00	11.210	341.840	1675.24	-44.17	91.58	-41.59	40°13'46.443"N	104°53'07.562"W	1.55	
1773.00	10.550	338.250	1763.63	-50.40	107.54	-47.37	40°13'46.601"N	104°53'07.637"W	1.05	
1863.00	8.830	330.270	1852.34	-57.26	121.20	-53.85	40°13'46.736"N	104°53'07.720"W	2.42	
1953.00	7.380	329.060	1941.44	-63.97	132.15	-60.25	40°13'46.844"N	104°53'07.803"W	1.62	
2042.00	5.240	315.010	2029.90	-70.00	139.93	-66.06	40°13'46.921"N	104°53'07.878"W	2.95	
2132.00	3.890	301.980	2119.62	-75.62	144.45	-71.56	40°13'46.965"N	104°53'07.949"W	1.88	
2222.00	2.220	285.070	2209.49	-79.95	146.52	-75.83	40°13'46.986"N	104°53'08.004"W	2.09	
2312.00	0.450	327.830	2299.46	-81.84	147.28	-77.70	40°13'46.993"N	104°53'08.028"W	2.13	
2402.00	0.870	106.290	2389.46	-81.38	147.38	-77.24	40°13'46.994"N	104°53'08.022"W	1.38	
2491.00	0.690	97.590	2478.45	-80.19	147.12	-76.06	40°13'46.992"N	104°53'08.007"W	0.24	
2761.00	0.500	201.930	2748.44	-78.98	145.82	-74.88	40°13'46.979"N	104°53'07.991"W	0.35	
3030.00	0.550	270.050	3017.43	-80.68	144.73	-76.61	40°13'46.968"N	104°53'08.014"W	0.22	
3120.00	0.410	85.160	3107.43	-80.79	144.76	-76.72	40°13'46.968"N	104°53'08.015"W	1.07	
3299.00	0.400	172.190	3286.43	-80.05	144.19	-76.00	40°13'46.963"N	104°53'08.006"W	0.31	
3389.00	0.520	79.260	3376.43	-79.60	143.96	-75.56	40°13'46.961"N	104°53'08.000"W	0.75	
3568.00	1.110	97.670	3555.41	-77.09	143.88	-73.04	40°13'46.960"N	104°53'07.968"W	0.36	
3748.00	1.040	97.050	3735.38	-73.73	143.44	-69.69	40°13'46.955"N	104°53'07.925"W	0.04	
4017.00	0.610	165.090	4004.35	-70.89	141.76	-66.90	40°13'46.939"N	104°53'07.889"W	0.37	
4197.00	0.620	228.840	4184.34	-71.33	140.19	-67.39	40°13'46.923"N	104°53'07.895"W	0.36	
4287.00	0.480	194.420	4274.34	-71.77	139.51	-67.85	40°13'46.917"N	104°53'07.901"W	0.39	
4466.00	0.670	24.900	4453.34	-71.52	139.73	-67.59	40°13'46.919"N	104°53'07.897"W	0.64	
4735.00	0.910	348.000	4722.31	-71.40	143.25	-67.38	40°13'46.954"N	104°53'07.895"W	0.20	
4825.00	1.160	358.190	4812.30	-71.63	144.86	-67.55	40°13'46.969"N	104°53'07.897"W	0.34	
4915.00	0.960	356.650	4902.28	-71.75	146.52	-67.63	40°13'46.986"N	104°53'07.898"W	0.22	

Actual Wellpath Report

JESTER 41N-14HZ AWP

Page 3 of 7

REFERENCE WELLPATH IDENTIFICATION

Operator	KERR-MCGEE OIL & GAS ONSHORE LP (WA)	Slot	SLOT#43 JESTER 41N-14HZ (1320'FNL & 265'FWL, SEC.15)
Area	COLORADO	Well	JESTER 41N-14HZ
Field	WELD COUNTY (UTM/TRUE NORTH)	Wellbore	JESTER 41N-14HZ AWP <16982>
Facility	SEC.15-T3N-R67W		

WELLPATH DATA (173 stations) † = interpolated/extrapolated station

MD [ft]	Inclination [°]	Azimuth [°]	TVD [ft]	Vert Sect [ft]	North [ft]	East [ft]	Latitude	Longitude	DLS [°/100ft]	Comments
5094.00	0.770	339.250	5081.26	-72.34	149.14	-68.14	40°13'47.012"N	104°53'07.905"W	0.18	
5364.00	0.590	311.300	5351.24	-74.10	151.76	-69.83	40°13'47.038"N	104°53'07.926"W	0.14	
5723.00	0.830	253.260	5710.22	-77.99	152.23	-73.71	40°13'47.042"N	104°53'07.976"W	0.20	
5903.00	1.000	295.620	5890.20	-80.66	152.53	-76.37	40°13'47.045"N	104°53'08.011"W	0.38	
6082.00	1.010	245.540	6069.18	-83.50	152.55	-79.21	40°13'47.046"N	104°53'08.047"W	0.48	
6172.00	0.560	102.190	6159.17	-83.78	152.13	-79.51	40°13'47.041"N	104°53'08.051"W	1.66	
6262.00	0.400	109.550	6249.17	-83.05	151.93	-78.78	40°13'47.039"N	104°53'08.042"W	0.19	
6351.00	0.680	149.100	6338.16	-82.47	151.38	-78.22	40°13'47.034"N	104°53'08.034"W	0.51	
6441.00	10.700	90.900	6427.62	-73.81	150.78	-69.57	40°13'47.028"N	104°53'07.923"W	11.51	
6531.00	17.520	91.130	6514.86	-51.88	150.39	-47.64	40°13'47.024"N	104°53'07.640"W	7.58	
6621.00	24.460	95.340	6598.84	-19.70	148.38	-15.50	40°13'47.004"N	104°53'07.226"W	7.89	
6711.00	27.650	93.440	6679.68	19.78	145.39	23.90	40°13'46.975"N	104°53'06.718"W	3.66	
6800.00	33.990	90.120	6756.08	65.34	144.10	69.45	40°13'46.962"N	104°53'06.131"W	7.37	
6890.00	45.090	91.490	6825.38	122.54	143.22	126.64	40°13'46.953"N	104°53'05.393"W	12.37	
6980.00	54.080	91.590	6883.67	190.99	141.37	195.07	40°13'46.935"N	104°53'04.511"W	9.99	
7070.00	58.570	92.210	6933.56	265.86	138.88	269.91	40°13'46.910"N	104°53'03.546"W	5.02	
7160.00	65.730	91.660	6975.58	345.39	136.21	349.38	40°13'46.884"N	104°53'02.521"W	7.97	
7249.00	79.590	91.730	7002.04	430.14	133.70	434.10	40°13'46.859"N	104°53'01.429"W	15.57	
7300.00†	87.150	93.209	7007.92	480.75	131.51	484.67	40°13'46.838"N	104°53'00.777"W	15.10	7" CASING POINT
7335.00	92.340	94.210	7008.08	515.71	129.25	519.58	40°13'46.815"N	104°53'00.327"W	15.10	
7439.00	91.820	91.930	7004.30	619.61	123.68	623.36	40°13'46.760"N	104°52'58.989"W	2.25	
7484.00	91.480	91.210	7003.01	664.59	122.45	668.32	40°13'46.748"N	104°52'58.409"W	1.77	
7574.00	89.410	91.440	7002.31	754.58	120.37	758.29	40°13'46.727"N	104°52'57.249"W	2.31	
7664.00	89.820	92.150	7002.91	844.57	117.55	848.24	40°13'46.699"N	104°52'56.090"W	0.91	
7753.00	89.080	91.850	7003.77	933.57	114.45	937.18	40°13'46.669"N	104°52'54.943"W	0.90	
7843.00	88.950	91.780	7005.31	1023.55	111.60	1027.13	40°13'46.641"N	104°52'53.783"W	0.16	
7933.00	88.890	91.970	7007.01	1113.54	108.65	1117.06	40°13'46.611"N	104°52'52.624"W	0.22	
8023.00	89.350	92.070	7008.39	1203.52	105.48	1206.99	40°13'46.580"N	104°52'51.464"W	0.52	
8112.00	89.380	92.230	7009.38	1292.51	102.14	1295.93	40°13'46.547"N	104°52'50.318"W	0.18	
8202.00	89.630	92.230	7010.16	1382.51	98.64	1385.86	40°13'46.512"N	104°52'49.158"W	0.28	
8292.00	89.970	91.750	7010.47	1472.50	95.51	1475.80	40°13'46.481"N	104°52'47.999"W	0.65	
8382.00	89.940	92.130	7010.54	1562.50	92.47	1565.75	40°13'46.451"N	104°52'46.839"W	0.42	
8471.00	90.120	91.560	7010.49	1651.50	89.60	1654.70	40°13'46.423"N	104°52'45.692"W	0.67	
8561.00	90.920	91.440	7009.68	1741.50	87.25	1744.67	40°13'46.400"N	104°52'44.532"W	0.90	
8651.00	89.700	89.460	7009.19	1831.47	86.54	1834.66	40°13'46.392"N	104°52'43.372"W	2.58	
8741.00	89.640	89.080	7009.71	1921.39	87.69	1924.65	40°13'46.404"N	104°52'42.212"W	0.43	
8830.00	89.800	88.580	7010.14	2010.29	89.50	2013.63	40°13'46.422"N	104°52'41.064"W	0.59	
8920.00	88.720	88.580	7011.31	2100.15	91.73	2103.59	40°13'46.444"N	104°52'39.905"W	1.20	
9010.00	88.470	88.210	7013.51	2189.98	94.25	2193.53	40°13'46.468"N	104°52'38.745"W	0.50	
9100.00	88.220	87.910	7016.11	2279.77	97.30	2283.44	40°13'46.498"N	104°52'37.586"W	0.43	
9189.00	88.160	88.060	7018.92	2368.54	100.43	2372.34	40°13'46.529"N	104°52'36.440"W	0.18	
9279.00	88.000	88.200	7021.94	2458.33	103.36	2462.24	40°13'46.558"N	104°52'35.281"W	0.24	
9369.00	88.770	88.920	7024.47	2548.16	105.62	2552.18	40°13'46.580"N	104°52'34.121"W	1.17	
9459.00	89.760	89.960	7025.63	2638.09	106.50	2642.16	40°13'46.589"N	104°52'32.961"W	1.60	
9549.00	89.540	90.990	7026.18	2728.07	105.76	2732.16	40°13'46.582"N	104°52'31.801"W	1.17	

Actual Wellpath Report

JESTER 41N-14HZ AWP

Page 4 of 7

REFERENCE WELLPATH IDENTIFICATION

Operator	KERR-MCGEE OIL & GAS ONSHORE LP (WA)	Slot	SLOT#43 JESTER 41N-14HZ (1320°FNL & 265°FWL, SEC.15)
Area	COLORADO	Well	JESTER 41N-14HZ
Field	WELD COUNTY (UTM/TRUE NORTH)	Wellbore	JESTER 41N-14HZ AWP <16982>
Facility	SEC.15-T3N-R67W		

WELLPATH DATA (173 stations)

MD [ft]	Inclination [°]	Azimuth [°]	TVD [ft]	Vert Sect [ft]	North [ft]	East [ft]	Latitude	Longitude	DLS [°/100ft]	Comments
9638.00	90.220	92.030	7026.37	2817.06	103.41	2821.12	40°13'46.558"N	104°52'30.653"W	1.40	
9728.00	90.930	91.950	7025.46	2907.06	100.28	2911.06	40°13'46.527"N	104°52'29.494"W	0.79	
9818.00	90.400	93.020	7024.42	2997.04	96.38	3000.97	40°13'46.489"N	104°52'28.335"W	1.33	
9908.00	89.850	93.210	7024.22	3087.01	91.49	3090.84	40°13'46.440"N	104°52'27.176"W	0.65	
9997.00	89.940	93.200	7024.38	3175.97	86.52	3179.70	40°13'46.391"N	104°52'26.030"W	0.10	
10092.00	89.110	94.070	7025.17	3270.91	80.49	3274.50	40°13'46.331"N	104°52'24.808"W	1.27	
10186.00	89.600	93.880	7026.23	3364.82	73.98	3368.27	40°13'46.267"N	104°52'23.599"W	0.56	
10280.00	89.010	93.580	7027.37	3458.75	67.86	3462.06	40°13'46.206"N	104°52'22.390"W	0.70	
10374.00	89.720	93.430	7028.41	3552.70	62.12	3555.88	40°13'46.149"N	104°52'21.180"W	0.77	
10469.00	88.430	92.850	7029.95	3647.65	56.91	3650.72	40°13'46.098"N	104°52'19.958"W	1.49	
10563.00	89.020	92.770	7032.04	3741.60	52.31	3744.59	40°13'46.052"N	104°52'18.747"W	0.63	
10657.00	89.230	92.510	7033.47	3835.58	47.98	3838.48	40°13'46.009"N	104°52'17.537"W	0.36	
10751.00	90.000	92.110	7034.10	3929.57	44.19	3932.40	40°13'45.972"N	104°52'16.326"W	0.92	
10846.00	88.950	91.880	7034.97	4024.56	40.88	4027.33	40°13'45.939"N	104°52'15.102"W	1.13	
10940.00	89.290	91.240	7036.42	4118.55	38.32	4121.29	40°13'45.913"N	104°52'13.891"W	0.77	
11034.00	88.120	91.690	7038.54	4212.52	35.92	4215.23	40°13'45.889"N	104°52'12.680"W	1.33	
11128.00	88.060	90.920	7041.68	4306.47	33.78	4309.15	40°13'45.868"N	104°52'11.469"W	0.82	
11223.00	88.360	90.790	7044.64	4401.41	32.36	4404.10	40°13'45.854"N	104°52'10.245"W	0.34	
11317.00	89.200	91.070	7046.64	4495.38	30.84	4498.06	40°13'45.839"N	104°52'09.033"W	0.94	
11411.00	89.600	90.600	7047.63	4589.37	29.47	4592.05	40°13'45.825"N	104°52'07.821"W	0.66	
11501.00	90.270	90.340	7047.73	4679.35	28.73	4682.04	40°13'45.818"N	104°52'06.661"W	0.80	
11591.00	88.920	89.540	7048.37	4769.31	28.83	4772.04	40°13'45.818"N	104°52'05.501"W	1.74	
11681.00	90.210	89.680	7049.05	4859.25	29.44	4862.03	40°13'45.824"N	104°52'04.340"W	1.44	
11771.00	90.250	88.840	7048.69	4949.17	30.60	4952.02	40°13'45.835"N	104°52'03.180"W	0.93	
11860.00	90.770	89.830	7047.90	5038.09	31.63	5041.01	40°13'45.846"N	104°52'02.033"W	1.26	
11950.00	91.440	91.230	7046.16	5128.06	30.80	5130.99	40°13'45.837"N	104°52'00.873"W	1.72	
12040.00	90.120	91.800	7044.94	5218.05	28.42	5220.94	40°13'45.813"N	104°51'59.713"W	1.60	
12130.00	89.290	93.050	7045.40	5308.03	24.61	5310.86	40°13'45.776"N	104°51'58.554"W	1.67	
12220.00	88.150	94.370	7047.41	5397.95	18.79	5400.65	40°13'45.718"N	104°51'57.396"W	1.94	
12309.00	88.030	94.030	7050.38	5486.81	12.28	5489.36	40°13'45.653"N	104°51'56.252"W	0.40	
12399.00	87.840	93.900	7053.62	5576.67	6.06	5579.08	40°13'45.592"N	104°51'55.096"W	0.26	
12489.00	87.720	93.490	7057.11	5666.55	0.26	5668.83	40°13'45.534"N	104°51'53.939"W	0.47	
12578.00	87.350	93.400	7060.93	5755.42	-5.08	5757.59	40°13'45.481"N	104°51'52.794"W	0.43	
12668.00	87.570	93.230	7064.92	5845.29	-10.28	5847.35	40°13'45.430"N	104°51'51.637"W	0.31	
12758.00	87.170	92.980	7069.05	5935.17	-15.15	5937.12	40°13'45.381"N	104°51'50.480"W	0.52	
12848.00	88.280	92.690	7072.62	6025.08	-19.60	6026.94	40°13'45.337"N	104°51'49.322"W	1.27	
12937.00	88.740	92.180	7074.94	6114.04	-23.38	6115.83	40°13'45.300"N	104°51'48.176"W	0.77	
13027.00	89.660	91.670	7076.20	6204.02	-26.40	6205.77	40°13'45.269"N	104°51'47.016"W	1.17	
13117.00	90.620	91.730	7075.98	6294.02	-29.07	6295.72	40°13'45.243"N	104°51'45.856"W	1.07	
13207.00	91.200	91.970	7074.55	6384.01	-31.97	6385.67	40°13'45.214"N	104°51'44.697"W	0.70	
13296.00	89.600	91.190	7073.92	6473.00	-34.43	6474.63	40°13'45.189"N	104°51'43.550"W	2.00	
13386.00	88.460	91.930	7075.45	6562.99	-36.88	6564.58	40°13'45.165"N	104°51'42.390"W	1.51	
13476.00	88.520	91.480	7077.82	6652.96	-39.56	6654.51	40°13'45.138"N	104°51'41.230"W	0.50	
13566.00	88.710	91.750	7080.00	6742.93	-42.09	6744.44	40°13'45.113"N	104°51'40.071"W	0.37	
13656.00	88.860	91.740	7081.90	6832.91	-44.83	6834.38	40°13'45.086"N	104°51'38.911"W	0.17	

Actual Wellpath Report

JESTER 41N-14HZ AWP

Page 5 of 7

REFERENCE WELLPATH IDENTIFICATION

Operator	KERR-MCGEE OIL & GAS ONSHORE LP (WA)	Slot	SLOT#43 JESTER 41N-14HZ (1320'FNL & 265'FWL, SEC.15)
Area	COLORADO	Well	JESTER 41N-14HZ
Field	WELD COUNTY (UTM/TRUE NORTH)	Wellbore	JESTER 41N-14HZ AWP <16982>
Facility	SEC.15-T3N-R67W		

WELLPATH DATA (173 stations)

MD [ft]	Inclination [°]	Azimuth [°]	TVD [ft]	Vert Sect [ft]	North [ft]	East [ft]	Latitude	Longitude	DLS [°/100ft]	Comments
13745.00	89.510	91.620	7083.17	6921.90	-47.44	6923.33	40°13'45.060"N	104°51'37.765"W	0.74	
13835.00	89.850	91.800	7083.67	7011.90	-50.13	7013.29	40°13'45.033"N	104°51'36.605"W	0.43	
13925.00	88.710	91.540	7084.80	7101.89	-52.75	7103.25	40°13'45.007"N	104°51'35.445"W	1.30	
14015.00	88.000	91.580	7087.39	7191.85	-55.20	7193.17	40°13'44.982"N	104°51'34.286"W	0.79	
14104.00	88.090	92.570	7090.42	7280.80	-58.42	7282.06	40°13'44.950"N	104°51'33.140"W	1.12	
14194.00	86.240	91.890	7094.87	7370.68	-61.92	7371.88	40°13'44.915"N	104°51'31.982"W	2.19	
14284.00	86.330	91.760	7100.71	7460.49	-64.78	7461.65	40°13'44.887"N	104°51'30.824"W	0.18	
14374.00	86.370	91.510	7106.44	7550.31	-67.34	7551.43	40°13'44.861"N	104°51'29.667"W	0.28	
14464.00	86.680	91.580	7111.89	7640.14	-69.76	7641.23	40°13'44.837"N	104°51'28.509"W	0.35	
14553.00	87.070	91.380	7116.74	7729.01	-72.06	7730.07	40°13'44.814"N	104°51'27.364"W	0.49	
14643.00	87.600	91.170	7120.93	7818.91	-74.06	7819.95	40°13'44.794"N	104°51'26.205"W	0.63	
14733.00	87.170	90.750	7125.03	7908.81	-75.56	7909.84	40°13'44.779"N	104°51'25.046"W	0.67	
14823.00	86.610	90.430	7129.92	7998.66	-76.49	7999.70	40°13'44.769"N	104°51'23.887"W	0.72	
14913.00	86.950	89.300	7134.97	8088.47	-76.28	8089.56	40°13'44.771"N	104°51'22.729"W	1.31	
15002.00	87.660	88.600	7139.16	8177.28	-74.65	8178.44	40°13'44.787"N	104°51'21.583"W	1.12	
15092.00	87.910	88.670	7142.63	8267.09	-72.50	8268.35	40°13'44.808"N	104°51'20.424"W	0.29	
15182.00	87.880	88.500	7145.94	8356.90	-70.28	8358.26	40°13'44.830"N	104°51'19.264"W	0.19	
15272.00	89.260	88.270	7148.19	8446.73	-67.75	8448.20	40°13'44.854"N	104°51'18.105"W	1.55	
15362.00	90.000	88.010	7148.77	8536.56	-64.83	8538.15	40°13'44.883"N	104°51'16.945"W	0.87	
15451.00	90.770	88.680	7148.17	8625.41	-62.26	8627.11	40°13'44.908"N	104°51'15.798"W	1.15	
15541.00	90.580	91.350	7147.11	8715.36	-62.28	8717.09	40°13'44.907"N	104°51'14.638"W	2.97	
15631.00	88.800	93.800	7147.60	8805.34	-66.32	8806.99	40°13'44.867"N	104°51'13.479"W	3.36	
15721.00	89.750	94.270	7148.73	8895.25	-72.66	8896.76	40°13'44.804"N	104°51'12.322"W	1.18	
15811.00	89.260	95.350	7149.51	8985.10	-80.20	8986.44	40°13'44.729"N	104°51'11.165"W	1.32	
15900.00	88.990	96.420	7150.87	9073.85	-89.33	9074.96	40°13'44.639"N	104°51'10.024"W	1.24	
15990.00	87.100	97.320	7153.94	9163.41	-100.08	9164.25	40°13'44.532"N	104°51'08.873"W	2.33	
16080.00	87.200	97.490	7158.42	9252.84	-111.67	9253.39	40°13'44.417"N	104°51'07.724"W	0.22	
16170.00	84.970	96.880	7164.56	9342.20	-122.90	9342.47	40°13'44.306"N	104°51'06.575"W	2.57	
16260.00	83.550	93.890	7173.56	9431.55	-131.30	9431.61	40°13'44.223"N	104°51'05.426"W	3.66	
16349.00	83.740	92.300	7183.42	9519.97	-136.08	9519.93	40°13'44.175"N	104°51'04.288"W	1.79	
16439.00	86.520	88.210	7191.06	9609.59	-136.47	9609.58	40°13'44.171"N	104°51'03.132"W	5.48	
16529.00	87.320	86.590	7195.90	9699.21	-132.40	9699.35	40°13'44.211"N	104°51'01.974"W	2.01	
16619.00	88.680	85.160	7199.04	9788.70	-125.93	9789.06	40°13'44.275"N	104°51'00.818"W	2.19	
16709.00	88.430	84.810	7201.31	9878.07	-118.06	9878.69	40°13'44.352"N	104°50'59.662"W	0.48	
16798.00	88.650	84.450	7203.57	9966.38	-109.73	9967.27	40°13'44.434"N	104°50'58.520"W	0.47	
16888.00	88.860	84.660	7205.53	10055.67	-101.20	10056.84	40°13'44.518"N	104°50'57.365"W	0.33	
16917.00	88.950	84.540	7206.08	10084.45	-98.47	10085.70	40°13'44.545"N	104°50'56.993"W	0.52	LAST BHI MWD+IFR SURVEYS
16982.00	88.950	84.540	7207.27	10148.94	-92.28	10150.40	40°13'44.606"N	104°50'56.159"W	0.00	PROJECTION TO BIT

Actual Wellpath Report

JESTER 41N-14HZ AWP

Page 6 of 7

REFERENCE WELLPATH IDENTIFICATION

Operator	KERR-MCGEE OIL & GAS ONSHORE LP (WA)	Slot	SLOT#43 JESTER 41N-14HZ (1320'FNL & 265'FWL, SEC.15)
Area	COLORADO	Well	JESTER 41N-14HZ
Field	WELD COUNTY (UTM/TRUE NORTH)	Wellbore	JESTER 41N-14HZ AWB <16982>
Facility	SEC.15-T3N-R67W		

HOLE & CASING SECTIONS - Ref Wellbore: JESTER 41N-14HZ AWB <16982> Ref Wellpath: JESTER 41N-14HZ AWP

String/Diameter	Start MD [ft]	End MD [ft]	Interval [ft]	Start TVD [ft]	End TVD [ft]	Start N/S [ft]	Start E/W [ft]	End N/S [ft]	End E/W [ft]
13.5in Open Hole	20.00	850.00	830.00	20.00	849.95	0.00	0.00	0.01	-0.41
9.625in Casing Surface	20.00	840.00	820.00	20.00	839.95	0.00	0.00	0.10	-0.60
8.75in Open Hole	850.00	7314.00	6464.00	849.95	7008.36	0.01	-0.41	130.68	498.64
7in Casing Intermediate	20.00	7300.00	7280.00	20.00	7007.92	0.00	0.00	131.51	484.67
6.125in Open Hole	7314.00	16982.00	9668.00	7008.36	7207.27	130.68	498.64	-92.28	10150.40

TARGETS

Name	TVD [ft]	North [ft]	East [ft]	Grid East [US ft]	Grid North [US ft]	Latitude	Longitude	Shape
SEC.14-T3N-R67W SECTION LINES	4813.00	0.00	0.00	1672434.99	14610259.10	40°13'45.538"N	104°53'07.026"W	polygon
SEC.15-T3N-R67W SECTION LINES	4813.00	0.00	0.00	1672434.99	14610259.10	40°13'45.538"N	104°53'07.026"W	polygon
JESTER 41N-14HZ BHL ON PLAT (1240'FNL & 1'FEL, SEC.14)	7187.00	-134.22	10176.69	1682607.77	14610138.09	40°13'44.191"N	104°50'55.820"W	point
JESTER 41N-14HZ LANDBOX	7187.00	0.00	0.00	1672434.99	14610259.10	40°13'45.538"N	104°53'07.026"W	polygon

WELLPATH COMPOSITION - Ref Wellbore: JESTER 41N-14HZ AWB <16982> Ref Wellpath: JESTER 41N-14HZ AWP

Start MD [ft]	End MD [ft]	Positional Uncertainty Model	Log Name/Comment	Wellbore
20.00	800.00	Custom_APC_ISCWSA REV 2 MWD	CATHEDRAL MWD SURVEYS 13.5" <116-787>	JESTER 41N-14HZ AWB <16982>
800.00	7249.00	Custom APC_ISCWSA REV 2 MWD+IFR1 (approximation)	BHI MWD+IFR+MSA SURVEYS 8.75" <844-7249>	JESTER 41N-14HZ AWB <16982>
7249.00	16917.00	Custom APC_ISCWSA REV 2 MWD+IFR1+MSA (approximation)	BHI MWD+IFR+MSA SURVEYS 6.125" <7335-16917>	JESTER 41N-14HZ AWB <16982>
16917.00	16982.00	Blind Drilling (std)	Projection to bit	JESTER 41N-14HZ AWB <16982>



Actual Wellpath Report

JESTER 41N-14HZ AWP
Page 7 of 7



REFERENCE WELLPATH IDENTIFICATION			
Operator	KERR-MCGEE OIL & GAS ONSHORE LP (WA)	Slot	SLOT#43 JESTER 41N-14HZ (1320'FNL & 265'FWL, SEC.15)
Area	COLORADO	Well	JESTER 41N-14HZ
Field	WELD COUNTY (UTM/TRUE NORTH)	Wellbore	JESTER 41N-14HZ AWB <16982>
Facility	SEC.15-T3N-R67W		

WELLPATH COMMENTS					
MD [ft]	Inclination [°]	Azimuth [°]	TVD [ft]	Comment	
129.00	0.400	322.300	129.00	BEGIN MWD SURVEYS	
800.00	0.600	121.400	799.95	TIE-ONTO MWD SURVEYS	
844.00	1.270	117.930	843.95	BEGIN BHI MWD+IFR SURVEYS	
7300.00	87.150	93.209	7007.92	7" CASING POINT	
16917.00	88.950	84.540	7206.08	LAST BHI MWD+IFR SURVEYS	
16982.00	88.950	84.540	7207.27	PROJECTION TO BIT	