

HOFFMAN 34-O PAD FOUNDATION ENERGY PAD LAYOUT

Two 40,000 BBL MBVT's
160 ft diameter

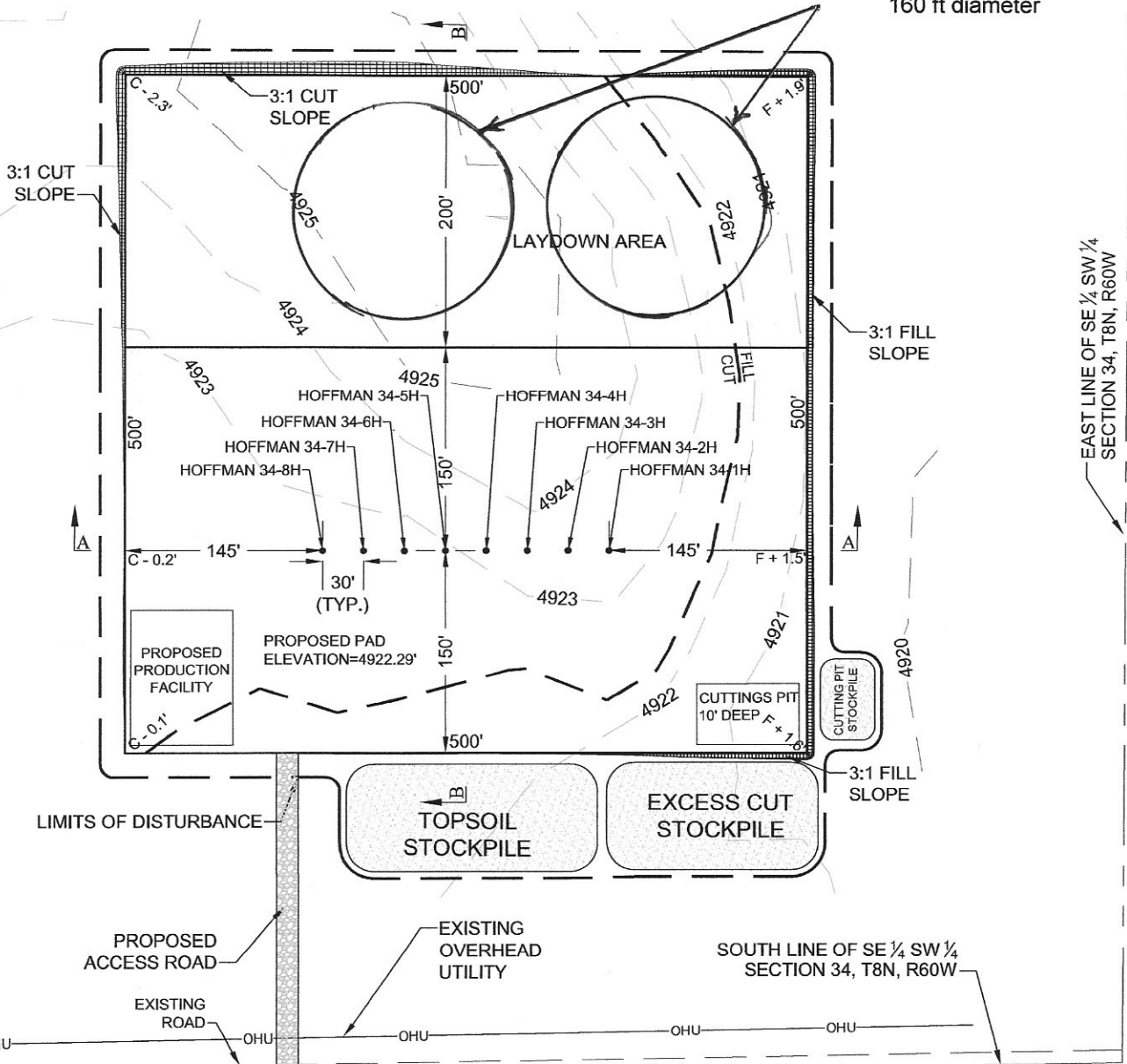

NOTES:

1. A COMPLETE UTILITIES LOCATION IS RECOMMENDED BEFORE CONSTRUCTION.
2. GEOGRAPHIC POSITIONS/COORDINATES SHOWN HEREON ARE IN NAD83 DATUM.
3. EARTHWORK QUANTITIES ARE APPROXIMATE & FOR INFORMATION ONLY. 6" OF TOPSOIL HAS BEEN SUBTRACTED FROM EXISTING SURFACE PRIOR TO PERFORMING EARTHWORK CALCULATIONS.
4. STOCKPILES ARE ASSUMED TO BE 10' IN HEIGHT WITH 2:1 SIDE SLOPES.

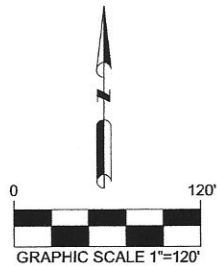

SITE QUANTITIES

FINISHED GRADE ELEVATION	4922.29'
TOTAL CUT FOR WELL PAD	7,499 CY
FILL FOR WELL PAD	3,162 CY
10% FILL FACTOR	316 CY
TOTAL FILL	3,478 CY
NET EXCESS MATERIAL	4,021 CY
TOPSOIL FROM GRADED AREA	4,764 CY
TOTAL DISTURBANCE AREA	7.3 ACRES

PREPARED BY:



FIELD DATE:
07-28-14

DRAWING DATE:
09-08-14

BY:
DWW

CHECKED BY:
KAD

PAD NAME:

HOFFMAN 34-O PAD

SURFACE LOCATION:

SE 1/4, SW 1/4, SEC. 34, T8N, R60W, 6TH P.M.
WELD COUNTY, COLORADO

PREPARED FOR:

