

1. Contact utility line locators before digging. CALL 811
2. Earth work quantities are estimated and should be used at contractors own discretion.
3. Topsoil is included in earth work quantities.
4. ROAD SURFACES TO BE FINISHED WITH AN ADDITIONAL 4 INCHES OF CLASS 6 ROAD BASE AFTER INSTALLATION OF PIPELINE.
5. Excess material is to be added to the fill slopes of the pad.

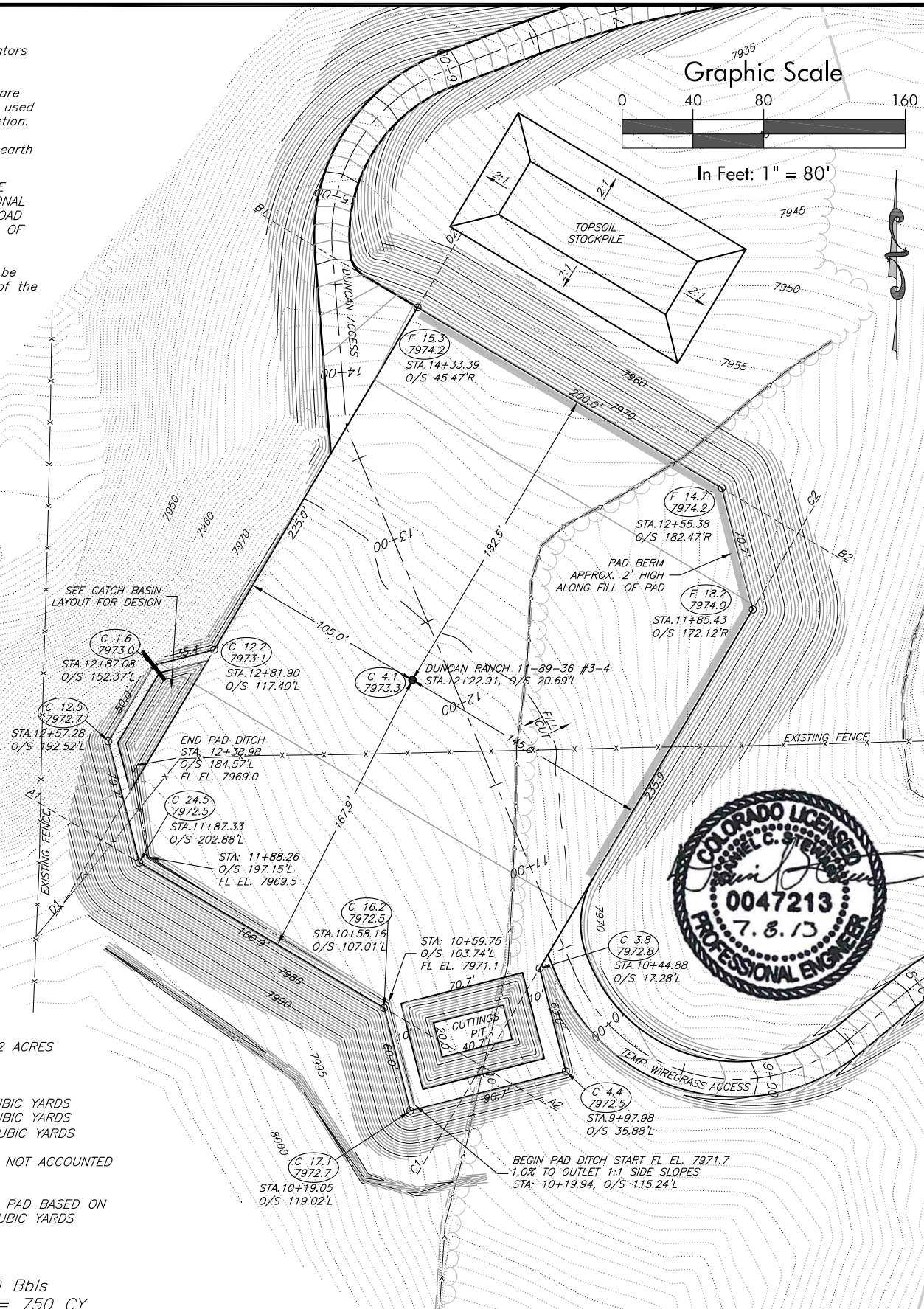
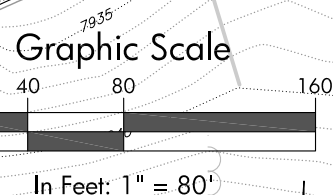

DISTURBED AREA = 2.82 ACRES
CUT SLOPES: 1.5:1
FILL SLOPES: 2:1
PAD QUANTITIES:
TOTAL CUT = 25467 CUBIC YARDS
TOTAL FILL = 17015 CUBIC YARDS
SPOIL = 8450 (CUT) CUBIC YARDS

COMPACTION SHRINKAGE NOT ACCOUNTED
FOR IN VOL. CALCS.

TOP SOIL QUANTITY FOR PAD BASED ON
6 INCH DEPTH: 2250 CUBIC YARDS

CUTTINGS PIT

Capacity with 2' freeboard = 2750 Bbls
Total Pit Volume = 750 CY

44.88
28'L

I:\2013\2013-379_PRM_Carmony\H_Dwgs\03 Duncan Ranch\DRAPD_BM.dwg