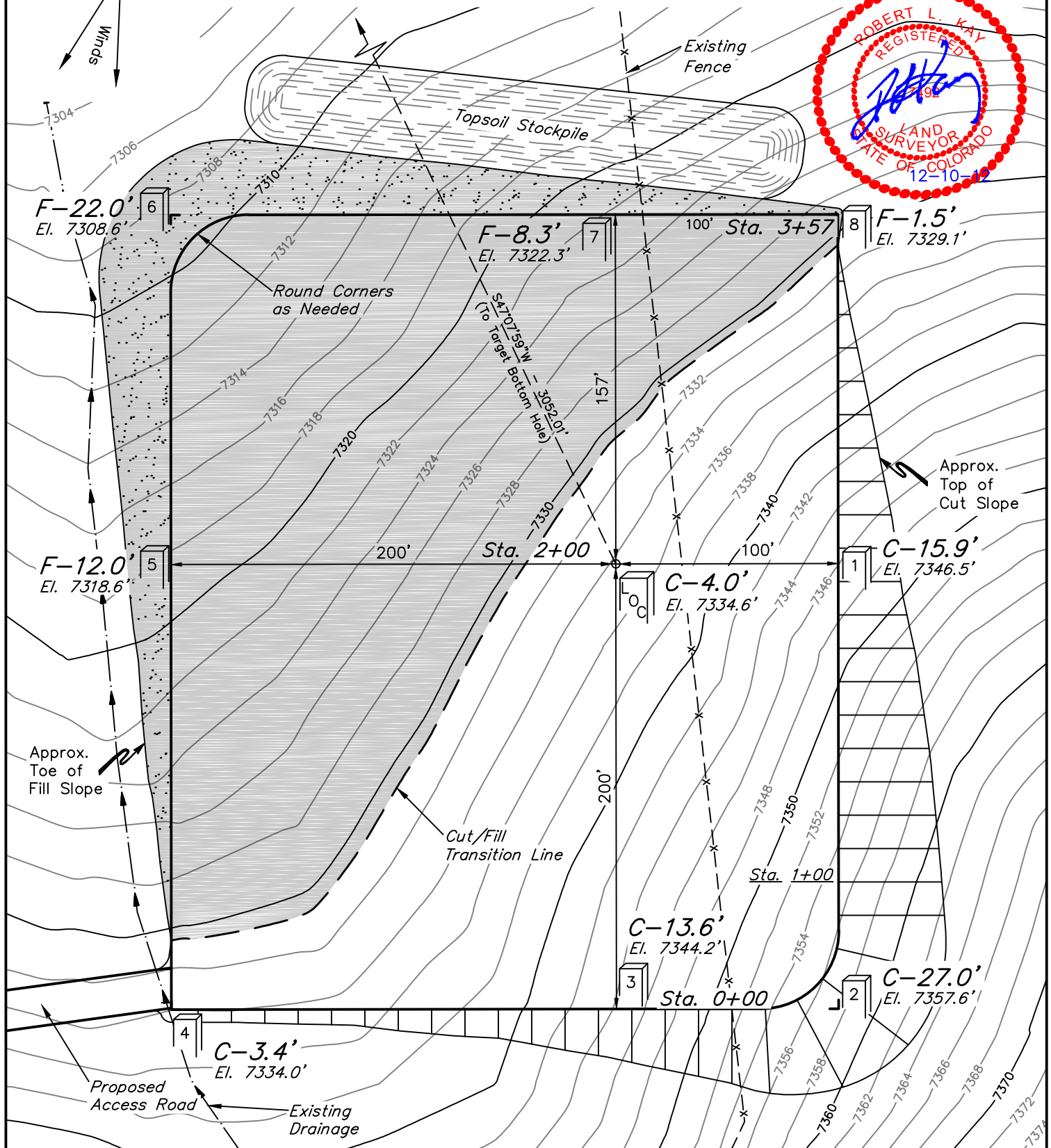

FIGURE #1

REVISOR: 12-10-12 J.G.

ROBERT L. KAY
REGISTERED
719
LAND SURVEYOR
STATE OF COLORADO
12-10-12



Elev. Ungraded Ground At Loc. Stake = 7334.6'
FINISHED GRADE ELEV. AT LOC. STAKE = 7330.6'

UINTAH ENGINEERING & LAND SURVEYING
85 So. 200 East * Vernal, Utah 84078 * (435) 789-1017

SWEPI LP

CONSTRUCTION LAYOUT CROSS SECTIONS FOR MORAPOS CREEK #1-10 SECTION 10, T3N, R91W, 6th P.M. 1763 FNL 2254' FWL

FIGURE #2

1" = 40'
X-Section
Scale
1" = 100'

DATE: 08-20-12
DRAWN BY: S.R.L.
REVISED: 12-03-12 T.B.

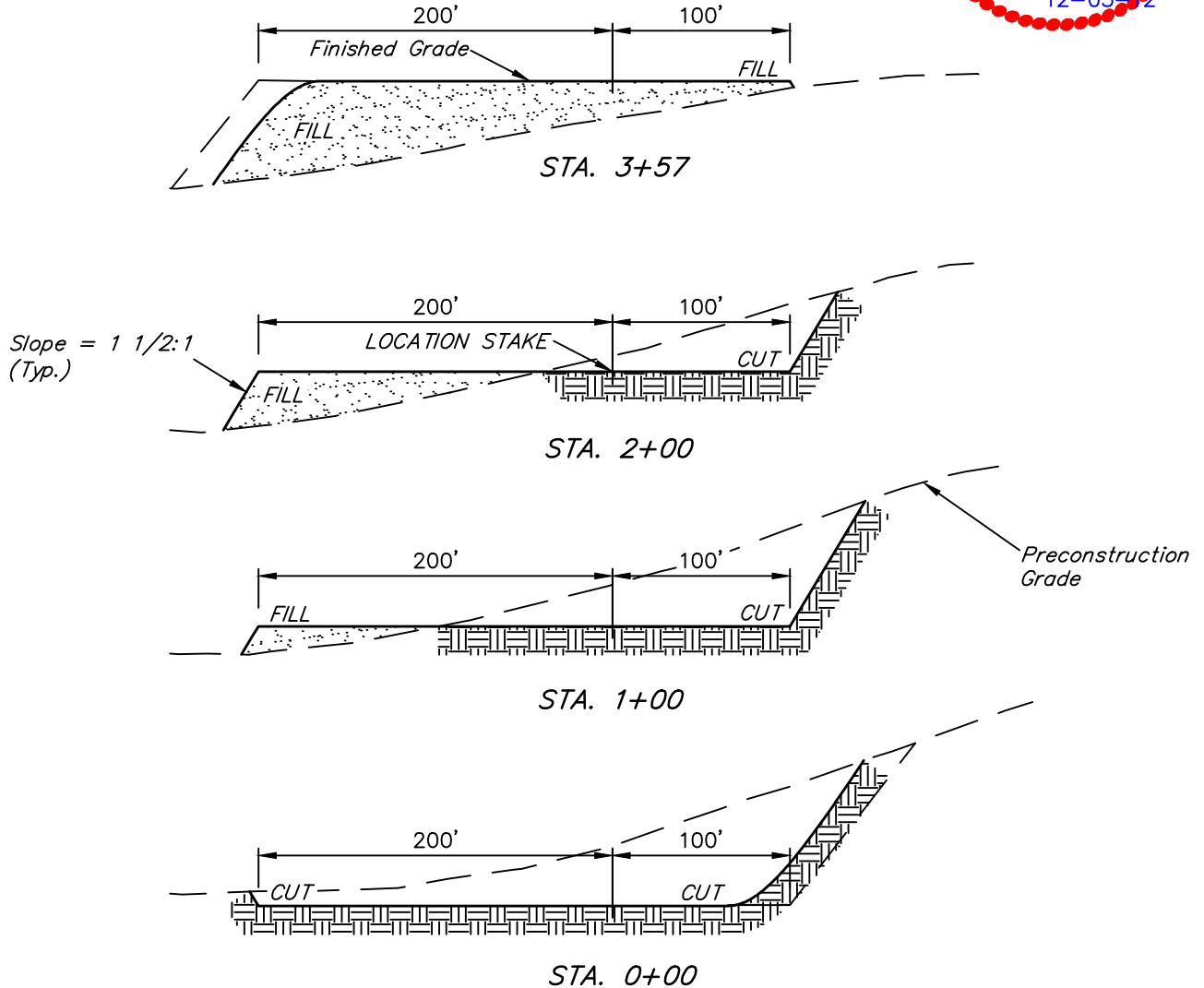

NOTE:

Topsoil should not be Stripped Below Finished Grade on Substructure Area.

APPROXIMATE ACREAGES

WELL SITE DISTURBANCE = ± 3.354 ACRES
ACCESS ROAD DISTURBANCE = ± 2.029 ACRES
TOTAL = ± 5.383 ACRES

* NOTE:

FILL QUANTITY INCLUDES 5% FOR COMPACTION

APPROXIMATE YARDAGES

(6") Topsoil Stripping = 2,540 Cu. Yds.
Remaining Location = 21,140 Cu. Yds.
TOTAL CUT = 23,680 CU. YDS.
FILL = 21,140 CU. YDS.

EXCESS MATERIAL = 2,540 Cu. Yds.
Topsoil = 2,540 Cu. Yds.
EXCESS UNBALANCE = 0 Cu. Yds.
(After Interim Rehabilitation)

UINTAH ENGINEERING & LAND SURVEYING
85 So. 200 East * Vernal, Utah 84078 * (435) 789-1017