

| TEKTON WINDSOR, LLC | | | |
|---------------------|----------------------------|----------|---|
| Location | Windsor, CO, USA(Imported) | Slot | Slot #3 |
| Field | Windsor Project | Well | Pavistma South 3 #1-6-32-090-4-NH |
| Installation | Pavistma South | Wellbore | Pavistma South 3 #1-6-32-090-4-NH (PWB) |

| Slot | Slot #3 |
|------|---------|
| 1 | 1 |
| 2 | 2 |
| 3 | 3 |
| 4 | 4 |
| 5 | 5 |
| 6 | 6 |
| 7 | 7 |
| 8 | 8 |
| 9 | 9 |
| 10 | 10 |
| 11 | 11 |
| 12 | 12 |
| 13 | 13 |
| 14 | 14 |
| 15 | 15 |
| 16 | 16 |
| 17 | 17 |
| 18 | 18 |
| 19 | 19 |
| 20 | 20 |
| 21 | 21 |
| 22 | 22 |
| 23 | 23 |
| 24 | 24 |
| 25 | 25 |
| 26 | 26 |
| 27 | 27 |
| 28 | 28 |
| 29 | 29 |
| 30 | 30 |
| 31 | 31 |
| 32 | 32 |
| 33 | 33 |
| 34 | 34 |
| 35 | 35 |
| 36 | 36 |
| 37 | 37 |
| 38 | 38 |
| 39 | 39 |
| 40 | 40 |
| 41 | 41 |
| 42 | 42 |
| 43 | 43 |
| 44 | 44 |
| 45 | 45 |
| 46 | 46 |
| 47 | 47 |
| 48 | 48 |
| 49 | 49 |
| 50 | 50 |
| 51 | 51 |
| 52 | 52 |
| 53 | 53 |
| 54 | 54 |
| 55 | 55 |
| 56 | 56 |
| 57 | 57 |
| 58 | 58 |
| 59 | 59 |
| 60 | 60 |
| 61 | 61 |
| 62 | 62 |
| 63 | 63 |
| 64 | 64 |
| 65 | 65 |
| 66 | 66 |
| 67 | 67 |
| 68 | 68 |
| 69 | 69 |
| 70 | 70 |
| 71 | 71 |
| 72 | 72 |
| 73 | 73 |
| 74 | 74 |
| 75 | 75 |
| 76 | 76 |
| 77 | 77 |
| 78 | 78 |
| 79 | 79 |
| 80 | 80 |
| 81 | 81 |
| 82 | 82 |
| 83 | 83 |
| 84 | 84 |
| 85 | 85 |
| 86 | 86 |
| 87 | 87 |
| 88 | 88 |
| 89 | 89 |
| 90 | 90 |
| 91 | 91 |
| 92 | 92 |
| 93 | 93 |
| 94 | 94 |
| 95 | 95 |
| 96 | 96 |
| 97 | 97 |
| 98 | 98 |
| 99 | 99 |
| 100 | 100 |

Well Pavistma South 3 #1-6-32-090-4-NH

Wellbore Pavistma South 3 #1-6-32-090-4-NH (PWB)

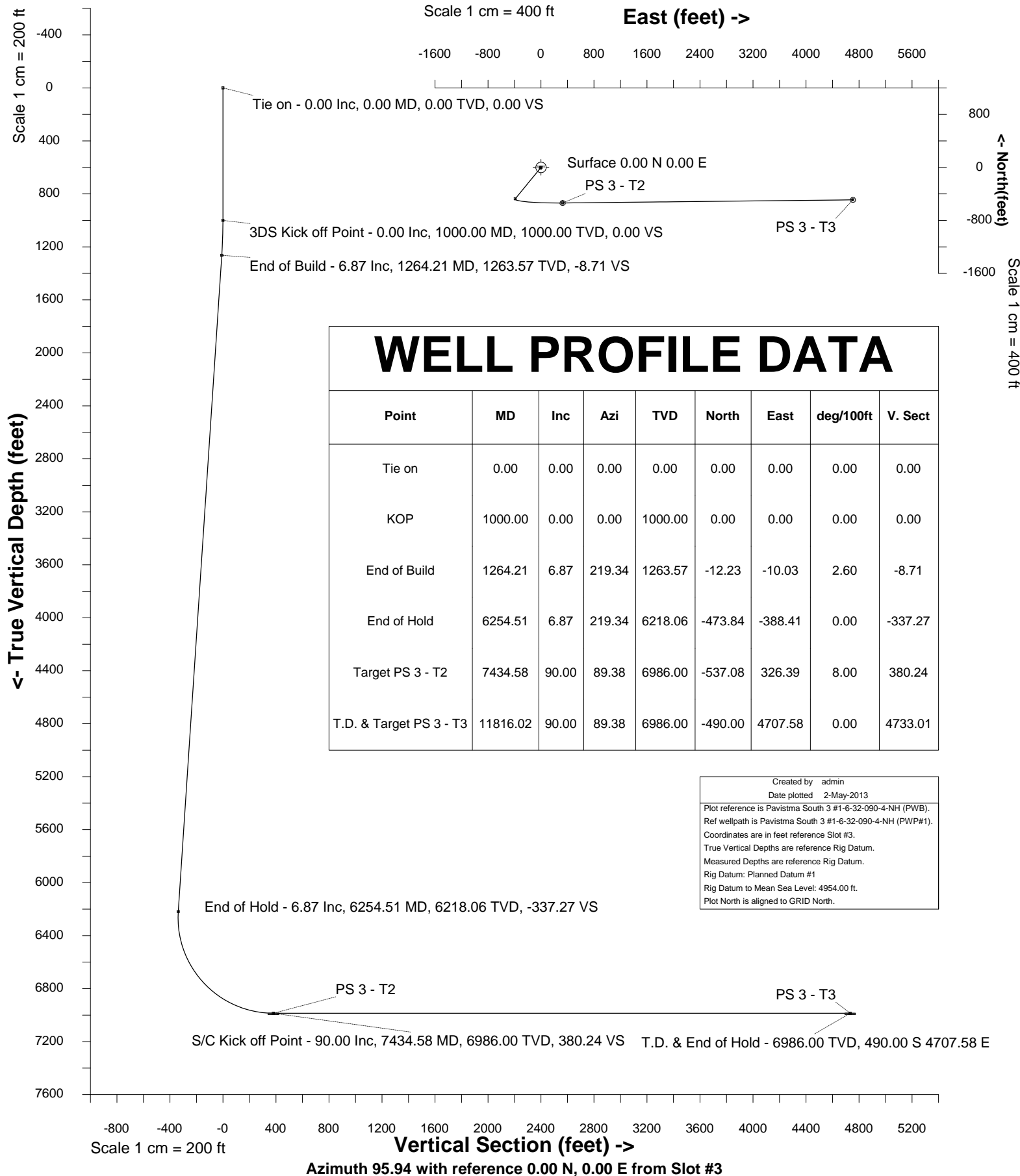

INTEGRATED PETROLEUM TECHNOLOGIES, INC
SYSDRILL
Well Design Combined Report
Wellbore: Pavistma South 3 #1-6-32-090-4-NH (PWB)
Wellpath: Pavistma South 3 #1-6-32-090-4-NH (PWP#1)

| Wellhead Details | | | | | | | |
|------------------|--------------|--------------|----------------|-----------------|--------|--------|-----------------------------------|
| Name | Northing | Easting | Latitude | Longitude | North | East | Slot Elevation Above Installation |
| Slot #3 | 1403819.0640 | 3160085.7243 | N40 26 25.6560 | W104 55 29.4960 | 25.63S | 19.32W | 1.00 |

| Declination | | |
|-------------|----------------------------|-------|
| Date | Source | Time |
| 8-Mar-2013 | IGRF Model [1900.0-2015.0] | 16:01 |

| Site Details | | | | |
|----------------|--------------|--------------|--|-----------------|
| Name | Northing | Easting | Coord System Name | North Alignment |
| Pavistma South | 1403844.6909 | 3160105.0426 | CO83-NF on NORTH AMERICAN DATUM 1983 datum | Grid |

| Summary Wellpath | | | | | | | | | |
|------------------|----------|----------|---------|-----------|----------|--------------------|----------------------|------------|------------|
| MD[ft] | Inc[deg] | Azi[deg] | TVD[ft] | North[ft] | East[ft] | Dogleg [deg/100ft] | Vertical Section[ft] | Northing | Easting |
| 0.00 | 0.00 | 0.000 | 0.00 | 0.00N | 0.00E | | 0.00 | 1403819.06 | 3160085.72 |
| 1000.00 | 0.00 | 0.000 | 1000.00 | 0.00N | 0.00E | ==> | 0.00 | 1403819.06 | 3160085.72 |
| 1264.21 | 6.87 | 219.340 | 1263.57 | 12.23S | 10.03W | 2.60 | -8.71 | 1403806.83 | 3160075.70 |
| 6254.51 | 6.87 | 219.340 | 6218.06 | 473.84S | 388.41W | ==> | -337.27 | 1403345.24 | 3159697.33 |
| 7434.58 | 90.00 | 89.380 | 6986.00 | 537.08S | 326.39E | 8.00 | 380.24 | 1403282.01 | 3160412.10 |
| 11816.02 | 90.00 | 89.380 | 6986.00 | 490.00S | 4707.58E | ==> | 4733.01 | 1403329.08 | 3164793.12 |

| Interpolated Wellpath | | | | | | | | | |
|-----------------------|----------|----------|---------|-----------|----------|--------------------|----------------------|------------|------------|
| MD[ft] | Inc[deg] | Azi[deg] | TVD[ft] | North[ft] | East[ft] | Dogleg [deg/100ft] | Vertical Section[ft] | Northing | Easting |
| 0.00 | 0.00 | 0.000 | 0.00 | 0.00N | 0.00E | | 0.00 | 1403819.06 | 3160085.72 |
| 100.00 | 0.00 | 0.000 | 100.00 | 0.00N | 0.00E | ==> | 0.00 | 1403819.06 | 3160085.72 |
| 200.00 | 0.00 | 0.000 | 200.00 | 0.00N | 0.00E | ==> | 0.00 | 1403819.06 | 3160085.72 |
| 300.00 | 0.00 | 0.000 | 300.00 | 0.00N | 0.00E | ==> | 0.00 | 1403819.06 | 3160085.72 |
| 400.00 | 0.00 | 0.000 | 400.00 | 0.00N | 0.00E | ==> | 0.00 | 1403819.06 | 3160085.72 |
| 500.00 | 0.00 | 0.000 | 500.00 | 0.00N | 0.00E | ==> | 0.00 | 1403819.06 | 3160085.72 |
| 600.00 | 0.00 | 0.000 | 600.00 | 0.00N | 0.00E | ==> | 0.00 | 1403819.06 | 3160085.72 |
| 700.00 | 0.00 | 0.000 | 700.00 | 0.00N | 0.00E | ==> | 0.00 | 1403819.06 | 3160085.72 |
| 800.00 | 0.00 | 0.000 | 800.00 | 0.00N | 0.00E | ==> | 0.00 | 1403819.06 | 3160085.72 |
| 900.00 | 0.00 | 0.000 | 900.00 | 0.00N | 0.00E | ==> | 0.00 | 1403819.06 | 3160085.72 |
| 1000.00 | 0.00 | 0.000 | 1000.00 | 0.00N | 0.00E | ==> | 0.00 | 1403819.06 | 3160085.72 |
| 1100.00 | 2.60 | 219.340 | 1099.97 | 1.75S | 1.44W | 2.60 | -1.25 | 1403817.31 | 3160084.29 |
| 1200.00 | 5.20 | 219.340 | 1199.73 | 7.01S | 5.75W | 2.60 | -4.99 | 1403812.05 | 3160079.97 |
| 1264.21 | 6.87 | 219.340 | 1263.57 | 12.23S | 10.03W | 2.60 | -8.71 | 1403806.83 | 3160075.70 |
| 1300.00 | 6.87 | 219.340 | 1299.11 | 15.55S | 12.74W | ==> | -11.06 | 1403803.52 | 3160072.98 |
| 1400.00 | 6.87 | 219.340 | 1398.39 | 24.80S | 20.32W | ==> | -17.65 | 1403794.27 | 3160065.40 |
| 1500.00 | 6.87 | 219.340 | 1497.67 | 34.05S | 27.91W | ==> | -24.23 | 1403785.02 | 3160057.82 |
| 1600.00 | 6.87 | 219.340 | 1596.96 | 43.30S | 35.49W | ==> | -30.82 | 1403775.77 | 3160050.24 |
| 1700.00 | 6.87 | 219.340 | 1696.24 | 52.55S | 43.07W | ==> | -37.40 | 1403766.52 | 3160042.65 |
| 1800.00 | 6.87 | 219.340 | 1795.52 | 61.80S | 50.65W | ==> | -43.98 | 1403757.27 | 3160035.07 |
| 1900.00 | 6.87 | 219.340 | 1894.80 | 71.05S | 58.24W | ==> | -50.57 | 1403748.02 | 3160027.49 |
| 2000.00 | 6.87 | 219.340 | 1994.09 | 80.30S | 65.82W | ==> | -57.15 | 1403738.77 | 3160019.91 |
| 2100.00 | 6.87 | 219.340 | 2093.37 | 89.55S | 73.40W | ==> | -63.74 | 1403729.52 | 3160012.33 |
| 2200.00 | 6.87 | 219.340 | 2192.65 | 98.80S | 80.98W | ==> | -70.32 | 1403720.27 | 3160004.74 |
| 2300.00 | 6.87 | 219.340 | 2291.93 | 108.05S | 88.57W | ==> | -76.90 | 1403711.02 | 3159997.16 |
| 2400.00 | 6.87 | 219.340 | 2391.21 | 117.30S | 96.15W | ==> | -83.49 | 1403701.77 | 3159989.58 |
| 2500.00 | 6.87 | 219.340 | 2490.50 | 126.55S | 103.73W | ==> | -90.07 | 1403692.52 | 3159982.00 |
| 2600.00 | 6.87 | 219.340 | 2589.78 | 135.80S | 111.31W | ==> | -96.66 | 1403683.27 | 3159974.42 |
| 2700.00 | 6.87 | 219.340 | 2689.06 | 145.05S | 118.90W | ==> | -103.24 | 1403674.02 | 3159966.83 |
| 2800.00 | 6.87 | 219.340 | 2788.34 | 154.30S | 126.48W | ==> | -109.82 | 1403664.77 | 3159959.25 |
| 2900.00 | 6.87 | 219.340 | 2887.62 | 163.55S | 134.06W | ==> | -116.41 | 1403655.52 | 3159951.67 |
| 3000.00 | 6.87 | 219.340 | 2986.91 | 172.80S | 141.64W | ==> | -122.99 | 1403646.27 | 3159944.09 |
| 3100.00 | 6.87 | 219.340 | 3086.19 | 182.05S | 149.23W | ==> | -129.58 | 1403637.03 | 3159936.50 |
| 3200.00 | 6.87 | 219.340 | 3185.47 | 191.30S | 156.81W | ==> | -136.16 | 1403627.78 | 3159928.92 |
| 3300.00 | 6.87 | 219.340 | 3284.75 | 200.55S | 164.39W | ==> | -142.74 | 1403618.53 | 3159921.34 |

All data is in Feet unless otherwise stated
Coordinates are from Slot MD's are from Rig and TVD's are from Rig (Planned Datum #1 4954.0ft above Mean Sea Level)
Vertical Section is from 0.00N 0.00E on azimuth 95.940 degrees
Bottom hole distance is 4733.01 Feet on azimuth 95.94 degrees from Wellhead
Calculation method uses Minimum Curvature method
Prepared by Peterson Energy
Date Printed: 2-May-2013



INTEGRATED PETROLEUM TECHNOLOGIES, INC
SYSDRILL
Well Design Combined Report
Wellbore: Pavistma South 3 #1-6-32-090-4-NH (PWB)
Wellpath: Pavistma South 3 #1-6-32-090-4-NH (PWP#1)

| Interpolated Wellpath | | | | | | | | | |
|-----------------------|----------|----------|---------|-----------|----------|-----------------------|-------------------------|------------|------------|
| MD[ft] | Inc[deg] | Azi[deg] | TVD[ft] | North[ft] | East[ft] | Dogleg [deg/100ft] | Vertical Section[ft] | Northing | Easting |
| 3400.00 | 6.87 | 219.340 | 3384.04 | 209.80S | 171.97W | ==> | -149.33 | 1403609.28 | 3159913.76 |
| 3500.00 | 6.87 | 219.340 | 3483.32 | 219.05S | 179.55W | ==> | -155.91 | 1403600.03 | 3159906.18 |
| 3600.00 | 6.87 | 219.340 | 3582.60 | 228.30S | 187.14W | ==> | -162.50 | 1403590.78 | 3159898.59 |
| 3700.00 | 6.87 | 219.340 | 3681.88 | 237.55S | 194.72W | ==> | -169.08 | 1403581.53 | 3159891.01 |
| 3800.00 | 6.87 | 219.340 | 3781.16 | 246.80S | 202.30W | ==> | -175.66 | 1403572.28 | 3159883.43 |
| 3900.00 | 6.87 | 219.340 | 3880.45 | 256.05S | 209.88W | ==> | -182.25 | 1403563.03 | 3159875.85 |
| 4000.00 | 6.87 | 219.340 | 3979.73 | 265.30S | 217.47W | ==> | -188.83 | 1403553.78 | 3159868.27 |
| 4100.00 | 6.87 | 219.340 | 4079.01 | 274.55S | 225.05W | ==> | -195.42 | 1403544.53 | 3159860.68 |
| 4200.00 | 6.87 | 219.340 | 4178.29 | 283.80S | 232.63W | ==> | -202.00 | 1403535.28 | 3159853.10 |
| 4300.00 | 6.87 | 219.340 | 4277.57 | 293.05S | 240.21W | ==> | -208.58 | 1403526.03 | 3159845.52 |
| 4400.00 | 6.87 | 219.340 | 4376.86 | 302.30S | 247.80W | ==> | -215.17 | 1403516.78 | 3159837.94 |
| 4500.00 | 6.87 | 219.340 | 4476.14 | 311.55S | 255.38W | ==> | -221.75 | 1403507.53 | 3159830.36 |
| 4600.00 | 6.87 | 219.340 | 4575.42 | 320.80S | 262.96W | ==> | -228.34 | 1403498.28 | 3159822.77 |
| 4700.00 | 6.87 | 219.340 | 4674.70 | 330.05S | 270.54W | ==> | -234.92 | 1403489.03 | 3159815.19 |
| 4800.00 | 6.87 | 219.340 | 4773.99 | 339.30S | 278.13W | ==> | -241.50 | 1403479.78 | 3159807.61 |
| 4900.00 | 6.87 | 219.340 | 4873.27 | 348.55S | 285.71W | ==> | -248.09 | 1403470.53 | 3159800.03 |
| 5000.00 | 6.87 | 219.340 | 4972.55 | 357.80S | 293.29W | ==> | -254.67 | 1403461.28 | 3159792.45 |
| 5100.00 | 6.87 | 219.340 | 5071.83 | 367.05S | 300.87W | ==> | -261.26 | 1403452.03 | 3159784.86 |
| 5200.00 | 6.87 | 219.340 | 5171.11 | 376.30S | 308.46W | ==> | -267.84 | 1403442.78 | 3159777.28 |
| 5300.00 | 6.87 | 219.340 | 5270.40 | 385.55S | 316.04W | ==> | -274.42 | 1403433.53 | 3159769.70 |
| 5400.00 | 6.87 | 219.340 | 5369.68 | 394.80S | 323.62W | ==> | -281.01 | 1403424.28 | 3159762.12 |
| 5500.00 | 6.87 | 219.340 | 5468.96 | 404.05S | 331.20W | ==> | -287.59 | 1403415.03 | 3159754.53 |
| 5600.00 | 6.87 | 219.340 | 5568.24 | 413.30S | 338.79W | ==> | -294.18 | 1403405.78 | 3159746.95 |
| 5700.00 | 6.87 | 219.340 | 5667.52 | 422.55S | 346.37W | ==> | -300.76 | 1403396.53 | 3159739.37 |
| 5800.00 | 6.87 | 219.340 | 5766.81 | 431.80S | 353.95W | ==> | -307.34 | 1403387.28 | 3159731.79 |
| 5900.00 | 6.87 | 219.340 | 5866.09 | 441.05S | 361.53W | ==> | -313.93 | 1403378.03 | 3159724.21 |
| 6000.00 | 6.87 | 219.340 | 5965.37 | 450.30S | 369.11W | ==> | -320.51 | 1403368.78 | 3159716.62 |
| 6100.00 | 6.87 | 219.340 | 6064.65 | 459.55S | 376.70W | ==> | -327.10 | 1403359.53 | 3159709.04 |
| 6200.00 | 6.87 | 219.340 | 6163.94 | 468.80S | 384.28W | ==> | -333.68 | 1403350.28 | 3159701.46 |
| 6254.51 | 6.87 | 219.340 | 6218.06 | 473.84S | 388.41W | ==> | -337.27 | 1403345.24 | 3159697.33 |
| 6300.00 | 5.33 | 187.660 | 6263.30 | 478.04S | 390.42W | 8.00 | -338.83 | 1403341.04 | 3159695.32 |
| 6400.00 | 8.94 | 125.310 | 6362.63 | 487.15S | 384.69W | 8.00 | -332.18 | 1403331.93 | 3159701.05 |
| 6500.00 | 16.10 | 108.040 | 6460.22 | 495.95S | 365.12W | 8.00 | -311.82 | 1403323.13 | 3159720.61 |
| 6600.00 | 23.79 | 101.470 | 6554.17 | 504.27S | 332.12W | 8.00 | -278.13 | 1403314.81 | 3159753.62 |
| 6700.00 | 31.63 | 98.010 | 6642.63 | 511.95S | 286.31W | 8.00 | -231.77 | 1403307.13 | 3159799.43 |
| 6800.00 | 39.53 | 95.810 | 6723.90 | 518.84S | 228.59W | 8.00 | -173.64 | 1403300.25 | 3159857.15 |
| 6900.00 | 47.46 | 94.250 | 6796.39 | 524.80S | 160.08W | 8.00 | -104.89 | 1403294.29 | 3159925.65 |
| 7000.00 | 55.40 | 93.040 | 6858.69 | 529.71S | 82.11W | 8.00 | -26.83 | 1403289.37 | 3160003.62 |
| 7100.00 | 63.36 | 92.040 | 6909.58 | 533.49S | 3.79E | 8.00 | 59.00 | 1403285.60 | 3160089.51 |
| 7200.00 | 71.32 | 91.170 | 6948.09 | 536.05S | 95.96E | 8.00 | 150.94 | 1403283.03 | 3160181.68 |
| 7300.00 | 79.28 | 90.390 | 6973.45 | 537.36S | 192.60E | 8.00 | 247.19 | 1403281.73 | 3160278.31 |
| 7400.00 | 87.25 | 89.640 | 6985.17 | 537.37S | 291.82E | 8.00 | 345.89 | 1403281.71 | 3160377.54 |
| 7434.58 | 90.00 | 89.380 | 6986.00 | 537.08S | 326.39E | 8.00 | 380.24 | 1403282.01 | 3160412.10 |
| 7500.00 | 90.00 | 89.380 | 6986.00 | 536.37S | 391.81E | ==> | 445.23 | 1403282.71 | 3160477.51 |
| 7600.00 | 90.00 | 89.380 | 6986.00 | 535.30S | 491.80E | ==> | 544.58 | 1403283.78 | 3160577.50 |
| 7700.00 | 90.00 | 89.380 | 6986.00 | 534.23S | 591.79E | ==> | 643.92 | 1403284.86 | 3160677.49 |
| 7800.00 | 90.00 | 89.380 | 6986.00 | 533.15S | 691.79E | ==> | 743.27 | 1403285.93 | 3160777.49 |
| 7900.00 | 90.00 | 89.380 | 6986.00 | 532.08S | 791.78E | ==> | 842.61 | 1403287.01 | 3160877.48 |
| 8000.00 | 90.00 | 89.380 | 6986.00 | 531.00S | 891.78E | ==> | 941.96 | 1403288.08 | 3160977.47 |
| 8100.00 | 90.00 | 89.380 | 6986.00 | 529.93S | 991.77E | ==> | 1041.30 | 1403289.16 | 3161077.46 |
| 8200.00 | 90.00 | 89.380 | 6986.00 | 528.85S | 1091.77E | ==> | 1140.65 | 1403290.23 | 3161177.45 |
| 8300.00 | 90.00 | 89.380 | 6986.00 | 527.78S | 1191.76E | ==> | 1240.00 | 1403291.31 | 3161277.44 |
| 8400.00 | 90.00 | 89.380 | 6986.00 | 526.70S | 1291.75E | ==> | 1339.34 | 1403292.38 | 3161377.43 |
| 8500.00 | 90.00 | 89.380 | 6986.00 | 525.63S | 1391.75E | ==> | 1438.69 | 1403293.46 | 3161477.42 |
| 8600.00 | 90.00 | 89.380 | 6986.00 | 524.56S | 1491.74E | ==> | 1538.03 | 1403294.53 | 3161577.41 |
| 8700.00 | 90.00 | 89.380 | 6986.00 | 523.48S | 1591.74E | ==> | 1637.38 | 1403295.60 | 3161677.40 |
| 8800.00 | 90.00 | 89.380 | 6986.00 | 522.41S | 1691.73E | ==> | 1736.72 | 1403296.68 | 3161777.39 |
| 8900.00 | 90.00 | 89.380 | 6986.00 | 521.33S | 1791.72E | ==> | 1836.07 | 1403297.75 | 3161877.38 |
| 9000.00 | 90.00 | 89.380 | 6986.00 | 520.26S | 1891.72E | ==> | 1935.42 | 1403298.83 | 3161977.37 |
| 9100.00 | 90.00 | 89.380 | 6986.00 | 519.18S | 1991.71E | ==> | 2034.76 | 1403299.90 | 3162077.36 |
| 9200.00 | 90.00 | 89.380 | 6986.00 | 518.11S | 2091.71E | ==> | 2134.11 | 1403300.98 | 3162177.35 |

All data is in Feet unless otherwise stated
Coordinates are from Slot MD's are from Rig and TVD's are from Rig (Planned Datum #1 4954.0ft above Mean Sea Level)
Vertical Section is from 0.00N 0.00E on azimuth 95.940 degrees
Bottom hole distance is 4733.01 Feet on azimuth 95.94 degrees from Wellhead
Calculation method uses Minimum Curvature method
Prepared by Peterson Energy
Date Printed: 2-May-2013



INTEGRATED PETROLEUM TECHNOLOGIES, INC
SYSDRILL
Well Design Combined Report
Wellbore: Pavistma South 3 #1-6-32-090-4-NH (PWB)
Wellpath: Pavistma South 3 #1-6-32-090-4-NH (PWP#1)

| Interpolated Wellpath | | | | | | | | | |
|-----------------------|----------|----------|---------|-----------|----------|-----------------------|-------------------------|------------|------------|
| MD[ft] | Inc[deg] | Azi[deg] | TVD[ft] | North[ft] | East[ft] | Dogleg [deg/100ft] | Vertical Section[ft] | Northing | Easting |
| 9300.00 | 90.00 | 89.380 | 6986.00 | 517.03S | 2191.70E | ==> | 2233.45 | 1403302.05 | 3162277.34 |
| 9400.00 | 90.00 | 89.380 | 6986.00 | 515.96S | 2291.70E | ==> | 2332.80 | 1403303.13 | 3162377.33 |
| 9500.00 | 90.00 | 89.380 | 6986.00 | 514.88S | 2391.69E | ==> | 2432.14 | 1403304.20 | 3162477.32 |
| 9600.00 | 90.00 | 89.380 | 6986.00 | 513.81S | 2491.68E | ==> | 2531.49 | 1403305.27 | 3162577.31 |
| 9700.00 | 90.00 | 89.380 | 6986.00 | 512.74S | 2591.68E | ==> | 2630.83 | 1403306.35 | 3162677.30 |
| 9800.00 | 90.00 | 89.380 | 6986.00 | 511.66S | 2691.67E | ==> | 2730.18 | 1403307.42 | 3162777.29 |
| 9900.00 | 90.00 | 89.380 | 6986.00 | 510.59S | 2791.67E | ==> | 2829.53 | 1403308.50 | 3162877.28 |
| 10000.00 | 90.00 | 89.380 | 6986.00 | 509.51S | 2891.66E | ==> | 2928.87 | 1403309.57 | 3162977.27 |
| 10100.00 | 90.00 | 89.380 | 6986.00 | 508.44S | 2991.66E | ==> | 3028.22 | 1403310.65 | 3163077.26 |
| 10200.00 | 90.00 | 89.380 | 6986.00 | 507.36S | 3091.65E | ==> | 3127.56 | 1403311.72 | 3163177.25 |
| 10300.00 | 90.00 | 89.380 | 6986.00 | 506.29S | 3191.64E | ==> | 3226.91 | 1403312.80 | 3163277.24 |
| 10400.00 | 90.00 | 89.380 | 6986.00 | 505.21S | 3291.64E | ==> | 3326.25 | 1403313.87 | 3163377.23 |
| 10500.00 | 90.00 | 89.380 | 6986.00 | 504.14S | 3391.63E | ==> | 3425.60 | 1403314.94 | 3163477.22 |
| 10600.00 | 90.00 | 89.380 | 6986.00 | 503.07S | 3491.63E | ==> | 3524.95 | 1403316.02 | 3163577.21 |
| 10700.00 | 90.00 | 89.380 | 6986.00 | 501.99S | 3591.62E | ==> | 3624.29 | 1403317.09 | 3163677.20 |
| 10800.00 | 90.00 | 89.380 | 6986.00 | 500.92S | 3691.62E | ==> | 3723.64 | 1403318.17 | 3163777.19 |
| 10900.00 | 90.00 | 89.380 | 6986.00 | 499.84S | 3791.61E | ==> | 3822.98 | 1403319.24 | 3163877.18 |
| 11000.00 | 90.00 | 89.380 | 6986.00 | 498.77S | 3891.60E | ==> | 3922.33 | 1403320.32 | 3163977.17 |
| 11100.00 | 90.00 | 89.380 | 6986.00 | 497.69S | 3991.60E | ==> | 4021.67 | 1403321.39 | 3164077.16 |
| 11200.00 | 90.00 | 89.380 | 6986.00 | 496.62S | 4091.59E | ==> | 4121.02 | 1403322.47 | 3164177.15 |
| 11300.00 | 90.00 | 89.380 | 6986.00 | 495.54S | 4191.59E | ==> | 4220.37 | 1403323.54 | 3164277.14 |
| 11400.00 | 90.00 | 89.380 | 6986.00 | 494.47S | 4291.58E | ==> | 4319.71 | 1403324.61 | 3164377.13 |
| 11500.00 | 90.00 | 89.380 | 6986.00 | 493.39S | 4391.57E | ==> | 4419.06 | 1403325.69 | 3164477.12 |
| 11600.00 | 90.00 | 89.380 | 6986.00 | 492.32S | 4491.57E | ==> | 4518.40 | 1403326.76 | 3164577.11 |
| 11700.00 | 90.00 | 89.380 | 6986.00 | 491.25S | 4591.56E | ==> | 4617.75 | 1403327.84 | 3164677.11 |
| 11800.00 | 90.00 | 89.380 | 6986.00 | 490.17S | 4691.56E | ==> | 4717.09 | 1403328.91 | 3164777.10 |
| 11816.02 | 90.00 | 89.380 | 6986.00 | 490.00S | 4707.58E | ==> | 4733.01 | 1403329.08 | 3164793.12 |

All data is in Feet unless otherwise stated
Coordinates are from Slot MD's are from Rig and TVD's are from Rig (Planned Datum #1 4954.0ft above Mean Sea Level)
Vertical Section is from 0.00N 0.00E on azimuth 95.940 degrees
Bottom hole distance is 4733.01 Feet on azimuth 95.94 degrees from Wellhead
Calculation method uses Minimum Curvature method
Prepared by Peterson Energy
Date Printed: 2-May-2013



INTEGRATED PETROLEUM TECHNOLOGIES, INC
 SYSDRILL
 Well Design Combined Report
 Wellbore: Pavistma South 3 #1-6-32-090-4-NH (PWB)
 Wellpath: Pavistma South 3 #1-6-32-090-4-NH (PWP#1)

| Hole Sections | | | | | | | | |
|---------------|---------|---------|-----------|----------|----------|---------|-----------|----------|
| Diameter | Start | Start | Start | Start | End | End | End | End |
| [in] | MD[ft] | TVD[ft] | North[ft] | East[ft] | MD[ft] | TVD[ft] | North[ft] | East[ft] |
| 12 1/4 | 0.00 | 0.00 | 0.00N | 0.00E | 850.00 | 850.00 | 0.00N | 0.00E |
| 8 3/4 | 850.00 | 850.00 | 0.00N | 0.00E | 7435.00 | 6986.00 | 537.07S | 326.81E |
| 6 1/8 | 7435.00 | 6986.00 | 537.07S | 326.81E | 11816.02 | 6986.00 | 490.00S | 4707.58E |

| Casings | | | | | | | | |
|---------------------------|---------|---------|-----------|----------|----------|---------|-----------|----------|
| Name | Top | Top | Top | Top | Shoe | Shoe | Shoe | Shoe |
| | MD[ft] | TVD[ft] | North[ft] | East[ft] | MD[ft] | TVD[ft] | North[ft] | East[ft] |
| 9 5/8in Surface Casing | 0.00 | 0.00 | 0.00N | 0.00E | 850.00 | 850.00 | 0.00N | 0.00E |
| 7.0in Intermediate Casing | 0.00 | 0.00 | 0.00N | 0.00E | 7435.00 | 6986.00 | 537.07S | 326.81E |
| 4 1/2in Production Liner | 6300.00 | 6263.30 | 478.04S | 390.42W | 11816.02 | 6986.00 | 490.00S | 4707.58E |

| Targets | | | | | | | | |
|-----------|-----------|----------|---------|----------------|-----------------|------------|------------|--------------|
| Name | North[ft] | East[ft] | TVD[ft] | Latitude | Longitude | Northing | Easting | Last Revised |
| PS 3 - T2 | 537.08S | 326.39E | 6986.00 | N40 26 20.3280 | W104 55 25.3200 | 1403282.01 | 3160412.10 | 8-Mar-2013 |
| PS 3 - T3 | 490.00S | 4707.58E | 6986.00 | N40 26 20.5080 | W104 54 28.6560 | 1403329.08 | 3164793.12 | 8-Mar-2013 |

| Survey Tool Program | | | | | |
|---------------------|-------------|----------|---------|---------------|-------------|
| Reference | Survey Name | MD[ft] | TVD[ft] | Survey Tool | Error Model |
| 5366 | Planned | 11816.02 | 6986.00 | WdW Rate Gyro | Standard |

| Notes |
|-------|
| |

All data is in Feet unless otherwise stated
 Coordinates are from Slot MD's are from Rig and TVD's are from Rig (Planned Datum #1 4954.0ft above Mean Sea Level)
 Vertical Section is from 0.00N 0.00E on azimuth 95.940 degrees
 Bottom hole distance is 4733.01 Feet on azimuth 95.94 degrees from Wellhead
 Calculation method uses Minimum Curvature method
 Prepared by Peterson Energy
 Date Printed: 2-May-2013



SYSDRILL
Closest Approach + Clearance Factor Summary Report
Wellbore: Pavistma South 3 #1-6-32-090-4-NH (PWB)
Wellpath: Pavistma South 3 #1-6-32-090-4-NH (PWP#1)

Ellipse separations are reported ONLY if BOTH wells have uncertainty data
Only Depth and Magnetic Reference Field error terms are correlated across tie points
Cutoff is calculated on CENTRE to CENTRE distance

Summary data uses Closest Approach clearance calculation for all minima
Hole size/Casings ARE included
Hole size/Casings are NOT subtracted from Centre-Centre distance
Confidence limit of 95.00% / 2.80 SD.

| Wellbore | | |
|---|------------|--------------|
| Name | Created | Last Revised |
| Pavistma South 3 #1-6-32-090-4-NH (PWB) | 8-Mar-2013 | 2-May-2013 |

| Well | | |
|-----------------------------------|---------------|--------------|
| Name | Government ID | Last Revised |
| Pavistma South 3 #1-6-32-090-4-NH | | 8-Mar-2013 |

| Slot | | | | | | |
|---------|---------------|--------------|----------------|-----------------|--------|--------|
| Name | Grid Northing | Grid Easting | Latitude | Longitude | North | East |
| Slot #3 | 1403819.0640 | 3160085.7243 | N40 26 25.6560 | W104 55 29.4960 | 25.63S | 19.32W |

| Installation | | | | | |
|----------------|--------------|--------------|--|-----------------|--|
| Name | Easting | Northing | Coord System Name | North Alignment | |
| Pavistma South | 3160105.0426 | 1403844.6909 | CO83-NF on NORTH AMERICAN DATUM 1983 datum | Grid | |

| Field | | | | | |
|-----------------|--------------|--------------|--|-----------------|--|
| Name | Easting | Northing | Coord System Name | North Alignment | |
| Windsor Project | 3162710.0707 | 1407271.6545 | CO83-NF on NORTH AMERICAN DATUM 1983 datum | Grid | |

| Clearance Summary | | | | | | | | | | |
|------------------------------------|--|--------------------|---------------------|-----------------|----------|--------------------|-------------------------|----------------|------------------|------------------|
| Offset WellName | Offset Wellbore | Offset Slot | Offset Structure | Separation [ft] | MD[ft] | Diverging From[ft] | Ellipse Separation [ft] | Ellipse MD[ft] | Clearance Factor | Clearance MD[ft] |
| Pavistma South 4 #1-7-32-09 0-4-CH | Pavistma South 4 #1-7-32-090-4 -CH (PWB) | Slot #4 | Pavistma South | 16.30 | 1235.00 | 1268.48 | 13.65 | 1235.00 | 6.08 | 1268.48 |
| Pavistma South 2 #1-5-32-09 0-4-CH | Pavistma South 2 #1-5-32-090-4 -CH (PWB) | Slot #2 | Pavistma South | 18.33 | 1017.06 | 7434.58 | 16.04 | 1017.06 | 7.60 | 11696.19 |
| Pavistma South 5 #1-8-32-09 0-4-NH | Pavistma South 5 #1-8-32-090-4 -NH (PWB) | Slot #5 | Pavistma South | 30.20 | 1202.76 | 1268.42 | 27.58 | 1236.48 | 9.88 | 11816.02 |
| Pavistma South 1 #1-5-32-09 0-4-NH | Pavistma South 1 #1-5-32-090-4 -NH (PWB) | Slot #1 | Pavistma South | 32.09 | 1000.66 | 1000.66 | 29.83 | 1017.06 | 9.11 | 11646.98 |
| PAVISTMA 19-32 | PAVISTMA 19-32 (AWB) | PAVISTMA 19-32 | Pavistma (Anadarko) | 218.79 | 8215.84 | 8215.84 | 178.37 | 8202.10 | 5.27 | 8169.29 |
| CENTER POINT 5 #8-1-32-18 0-4-NH | CENTER POINT 5 #8-1-32-180-4 -NH (PWB) | Slot #5 | Center Point | 257.73 | 11816.02 | 11816.02 | 199.32 | 11816.02 | 4.41 | 11816.02 |
| PAVISTMA 11-32 | PAVISTMA 11-32 (AWB) | PAVISTMA 11-32 | Pavistma (Anadarko) | 282.09 | 1033.46 | 8874.67 | 278.02 | 1033.46 | 13.31 | 8900.00 |
| FRYE FARM 7-5-32 | FRYE FARM 7-5-32 (AWB) | FRYE FARMS #7-5-32 | Frye Farms | 294.16 | 9680.08 | 9680.08 | 232.19 | 9678.48 | 4.73 | 9662.07 |
| PAVISTMA 12-32 | PAVISTMA 12-32 (AWB) | PAVISTMA 12-32 | Pavistma (Anadarko) | 312.86 | 1017.06 | 7550.75 | 308.73 | 1033.46 | 48.96 | 7627.95 |

All data is in Feet unless otherwise stated
Coordinates are from Slot MD's are from Rig and TVD's are from Rig (Planned Datum #1 4954.0ft above Mean Sea Level)
Vertical Section is from 0.00N 0.00E on azimuth 95.940 degrees
Prepared by Peterson Energy
Date Printed: 2-May-2013



SYSDRILL
Closest Approach + Clearance Factor Summary Report
Wellbore: Pavistma South 3 #1-6-32-090-4-NH (PWB)
Wellpath: Pavistma South 3 #1-6-32-090-4-NH (PWP#1)

| Clearance Summary | | | | | | | | | | |
|----------------------------------|--|-----------------|------------------|-----------------|----------|--------------------|-------------------------|----------------|------------------|------------------|
| Offset WellName | Offset Wellbore | Offset Slot | Offset Structure | Separation [ft] | MD[ft] | Diverging From[ft] | Ellipse Separation [ft] | Ellipse MD[ft] | Clearance Factor | Clearance MD[ft] |
| Lind #13-32 | Lind #13-32 (AWB) | Lind #13-32 | Lind (Anadarko) | 439.55 | 7706.79 | 7706.79 | 404.38 | 7693.57 | 11.78 | 7578.74 |
| PAVISTMA 5-3-32 | PAVISTMA 5-3-32 (AWB) | PAVISTMA 5-3-32 | Pavistma | 486.55 | 0.00 | 8192.55 | 485.19 | 633.12 | 36.41 | 8562.99 |
| PAVISTMA 4-2-32 | PAVISTMA 4-2-32 (AWB) | PAVISTMA 4-2-32 | Pavistma | 504.49 | 0.00 | 7612.38 | 503.24 | 82.02 | 65.33 | 8923.88 |
| PAVISTMA 5-1-32 | PAVISTMA 5-1-32 (AWB) | PAVISTMA 5-1-32 | Pavistma | 518.63 | 154.99 | 154.99 | 517.10 | 180.45 | 95.51 | 6300.00 |
| FRYE FARMS 6 #1-6-33-09 0-4-NH | FRYE FARMS 6 #1-6-33-090-4 -NH (PWB) | Slot #6 | Frye Farms | 530.46 | 11816.02 | 11816.02 | 509.53 | 11816.02 | 25.35 | 11816.02 |
| PAVISTMA 6 #1-4-32-09 0-4-NH | PAVISTMA 6 #1-4-32-090-4 -NH (PWB) | Slot #6 | Pavistma | 568.52 | 1000.66 | 11482.94 | 566.25 | 1000.66 | 17.34 | 11564.96 |
| CENTER POINT 7 #0-1-33-18 0-4-NH | CENTER POINT 7 #0-1-33-180-4 -NH (PWB) | Slot #7 | Center Point | 575.70 | 11816.02 | 11816.02 | 517.14 | 11816.02 | 9.83 | 11816.02 |
| PAVISTMA 7 #1-4-32-09 0-8-CH | PAVISTMA 7 #1-4-32-090-8 -CH (PWB) | Slot #7 | Pavistma | 584.42 | 1000.66 | 11816.02 | 582.15 | 1000.66 | 19.63 | 11816.02 |
| FRYE FARMS 7 #1-6-33-09 0-4-NH | FRYE FARMS 7 #1-6-33-090-4 -NH (PWB) | Slot #7 | Frye Farms | 589.07 | 11816.02 | 11816.02 | 549.85 | 11816.02 | 15.02 | 11816.02 |
| PAVISTMA 8 #1-3-32-09 0-4-NH | PAVISTMA 8 #1-3-32-090-4 -NH (PWB) | Slot #8 | Pavistma | 600.32 | 1000.66 | 11450.13 | 598.05 | 1000.66 | 22.55 | 11646.98 |
| PAVISTMA 9 #1-3-32-09 0-4-NH | PAVISTMA 9 #1-3-32-090-4 -NH (PWB) | Slot #9 | Pavistma | 616.22 | 1000.66 | 1000.66 | 613.96 | 1000.66 | 26.49 | 11745.41 |
| PAVISTMA 10 #1-3-32-09 0-8-CH | PAVISTMA 10 #1-3-32-090-8 -CH (PWB) | Slot #10 | Pavistma | 632.13 | 1000.66 | 11816.02 | 629.87 | 1000.66 | 27.04 | 11816.02 |
| PAVISTMA 11 #1-3-32-09 0-4-NH | PAVISTMA 11 #1-3-32-090-4 -NH (PWB) | Slot #11 | Pavistma | 648.05 | 1000.66 | 11436.28 | 645.78 | 1000.66 | 30.31 | 11816.02 |
| PAVISTMA 12 #1-2-32-09 0-4-NH | PAVISTMA 12 #1-2-32-090-4 -NH (PWB) | Slot #12 | Pavistma | 663.97 | 1000.66 | 11433.73 | 661.70 | 1000.66 | 34.11 | 11816.02 |
| FRYE FARMS 8 #1-5-33-09 0-4-NH | FRYE FARMS 8 #1-5-33-090-4 -NH (PWB) | Slot #8 | Frye Farms | 789.05 | 11816.02 | 11816.02 | 740.91 | 11816.02 | 16.39 | 11816.02 |
| FRYE FARMS 13 #5-5-32-09 0-6-CH | FRYE FARMS 13 #5-5-32-090-6 -CH (PWB) | Slot #13 | Frye Farms | 855.34 | 9570.73 | 9570.73 | 818.20 | 9570.73 | 17.10 | 11816.02 |
| RANCHO WATER | RANCHO WATER | Slot #13 | Rancho | 924.15 | 11816.02 | 11816.02 | 882.00 | 11816.02 | 21.92 | 11816.02 |

All data is in Feet unless otherwise stated
Coordinates are from Slot MD's are from Rig and TVD's are from Rig (Planned Datum #1 4954.0ft above Mean Sea Level)
Vertical Section is from 0.00N 0.00E on azimuth 95.940 degrees
Prepared by Peterson Energy
Date Printed: 2-May-2013



SYSDRILL
Closest Approach + Clearance Factor Summary Report
Wellbore: Pavistma South 3 #1-6-32-090-4-NH (PWB)
Wellpath: Pavistma South 3 #1-6-32-090-4-NH (PWP#1)

| Clearance Summary | | | | | | | | | | |
|--|--|--------------------|------------------------|-----------------|----------|--------------------|-------------------------|----------------|------------------|------------------|
| Offset WellName | Offset Wellbore | Offset Slot | Offset Structure | Separation [ft] | MD[ft] | Diverging From[ft] | Ellipse Separation [ft] | Ellipse MD[ft] | Clearance Factor | Clearance MD[ft] |
| VALLEY 13 #7-6-33-27 0-6-CH | VALLEY 13 #7-6-33-270-6 -CH (PWB) | | Water Valley | | | | | | | |
| RANCHO WATER VALLEY 7 #7-8-33-27 0-5-CH | RANCHO WATER VALLEY 7 #7-8-33-270-5 -CH (PWB) | Slot #07 | Rancho Water Valley | 1011.57 | 11816.02 | 11816.02 | 919.63 | 11809.32 | 11.00 | 11809.32 |
| FRYE FARMS #9-7-32 | FRYE FARMS #9-7-32 (AWB) | FRYE FARMS #9-7-32 | Frye Farms | 1044.99 | 11157.95 | 11157.95 | 996.38 | 11171.26 | 20.44 | 11482.94 |
| RANCHO WATER VALLEY 12 #7-7-33-27 0-4-NH | RANCHO WATER VALLEY 12 #7-7-33-270-4 -NH (PWB) | Slot #12 | Rancho Water Valley | 1049.78 | 11816.02 | 11816.02 | 1001.63 | 11816.02 | 21.80 | 11816.02 |
| FRYE FARMS #9-5-32 | FRYE FARMS #9-5-32 (AWB) | FRYE FARMS #9-5-32 | Frye Farms | 1050.76 | 9848.22 | 9848.22 | 990.95 | 9842.52 | 17.45 | 9744.09 |
| FRYE FARMS 9 #1-5-33-09 0-4-NH | FRYE FARMS 9 #1-5-33-090-4 -NH (PWB) | Slot #9 | Frye Farms | 1052.92 | 11816.02 | 11816.02 | 1002.24 | 11816.02 | 20.78 | 11816.02 |
| Anderson #1 | Anderson #1 (AWB) | Anderson #1 | Anderson (J.K. Wadley) | 1138.37 | 5267.95 | 5267.95 | 1131.81 | 5267.95 | 170.87 | 5429.79 |
| RANCHO WATER VALLEY 11 #7-7-33-27 0-6-CH | RANCHO WATER VALLEY 11 #7-7-33-270-6 -CH (PWB) | Slot #11 | Rancho Water Valley | 1144.80 | 11816.02 | 11816.02 | 1117.62 | 11816.02 | 42.12 | 11816.02 |
| RANCHO WATER VALLEY 11 #7-7-33-27 0-6-CH | RANCHO WATER VALLEY 11 #7-7-33-270-6 -CH (AWB) | Slot #11 | Rancho Water Valley | 1170.85 | 11816.02 | 11816.02 | 1104.44 | 11816.02 | 17.63 | 11816.02 |
| RANCHO WATER VALLEY 6 #0-7-4-270 -5-NH | RANCHO WATER VALLEY 6 #0-7-4-270-5- NH (PWB) | Slot #06 | Rancho Water Valley | 1173.37 | 11816.02 | 11816.02 | 1081.10 | 11816.02 | 12.72 | 11778.19 |
| RANCHO WATER VALLEY 10 #7-8-33-27 0-4-NH | RANCHO WATER VALLEY 10 #7-8-33-270-4 -NH (PWB) | Slot #10 | Rancho Water Valley | 1247.58 | 11816.02 | 11816.02 | 1213.01 | 11816.02 | 36.09 | 11816.02 |
| FRYE FARMS 10 #1-4-33-09 0-4-NH | FRYE FARMS 10 #1-4-33-090-4 -NH (PWB) | Slot #10 | Frye Farms | 1340.06 | 11816.02 | 11816.02 | 1288.98 | 11816.02 | 26.24 | 11816.02 |
| FRYE FARMS 11 #1-4-33-09 0-4-NH | FRYE FARMS 11 #1-4-33-090-4 -NH (PWB) | Slot #11 | Frye Farms | 1701.26 | 11789.98 | 11789.98 | 1650.98 | 11811.02 | 33.72 | 11816.02 |
| RANCHO WATER VALLEY 4 #7-1-4-270 -4-NH | RANCHO WATER VALLEY 4 #7-1-4-270-4- NH (PWB) | Slot #04 | Rancho Water Valley | 1898.72 | 11816.02 | 11816.02 | 1725.09 | 11816.02 | 10.94 | 11816.02 |

All data is in Feet unless otherwise stated
Coordinates are from Slot MD's are from Rig and TVD's are from Rig (Planned Datum #1 4954.0ft above Mean Sea Level)
Vertical Section is from 0.00N 0.00E on azimuth 95.940 degrees
Prepared by Peterson Energy
Date Printed: 2-May-2013



SYSDRILL
Closest Approach + Clearance Factor Summary Report
Wellbore: Pavistma South 3 #1-6-32-090-4-NH (PWB)
Wellpath: Pavistma South 3 #1-6-32-090-4-NH (PWP#1)

| Clearance Summary | | | | | | | | | | |
|--|--|-----------------|---------------------|-----------------|----------|--------------------|-------------------------|----------------|------------------|------------------|
| Offset WellName | Offset Wellbore | Offset Slot | Offset Structure | Separation [ft] | MD[ft] | Diverging From[ft] | Ellipse Separation [ft] | Ellipse MD[ft] | Clearance Factor | Clearance MD[ft] |
| FRYE FARMS 12 #1-3-33-09 0-4-NH | FRYE FARMS 12 #1-3-33-090-4 -NH (PWB) | Slot #12 | Frye Farms | 1974.91 | 11753.19 | 11753.19 | 1925.62 | 11778.22 | 39.62 | 11816.02 |
| RANCHO WATER VALLEY 5 #7-2-4-270 -4-NH | RANCHO WATER VALLEY 5 #7-2-4-270-4 -NH (PWB) | Slot #05 | Rancho Water Valley | 2422.69 | 11816.02 | 11816.02 | 2222.22 | 11816.02 | 12.09 | 11816.02 |
| HILLSIDE 17 #3-1-33-09 0-4-NH | HILLSIDE 17 #3-1-33-090-4 -NH (PWB) | Slot #17 | Hillside | 2479.96 | 11816.02 | 11816.02 | 2414.58 | 11816.02 | 37.93 | 11816.02 |
| HILLSIDE 18 #2-1-33-09 0-4-NH | HILLSIDE 18 #2-1-33-090-4 -NH (PWB) | Slot #18 | Hillside | 2801.18 | 11816.02 | 11816.02 | 2736.59 | 11816.02 | 43.37 | 11816.02 |
| RAINDANCE CE 6 #1-2-32-09 0-4-CH | RAINDANCE 6 #1-2-32-090-4 -CH (PWB) | Slot #6 | Raindance | 2923.80 | 6349.49 | 11419.25 | 2698.09 | 11417.32 | 12.76 | 11400.00 |
| HILLSIDE 15 #2-1-33-09 0-4-CH | HILLSIDE 15 #2-1-33-090-4 -CH (PWB) | Slot #15 | Hillside | 2971.74 | 11816.02 | 11816.02 | 2908.10 | 11816.02 | 46.70 | 11816.02 |
| RAINDANCE CE 5 #1-2-32-09 0-4-NH | RAINDANCE 5 #1-2-32-090-4 -NH (PWB) | Slot #5 | Raindance | 3071.13 | 6102.36 | 11418.97 | 2849.95 | 11418.97 | 13.39 | 11400.00 |
| HILLSIDE 14 #2-1-33-09 0-4-NH | HILLSIDE 14 #2-1-33-090-4 -NH (PWB) | Slot #14 | Hillside | 3127.35 | 11816.02 | 11816.02 | 3063.27 | 11816.02 | 48.80 | 11816.02 |
| RAINDANCE CE 4 #1-1-32-09 0-4-NH | RAINDANCE 4 #1-1-32-090-4 -NH (PWB) | Slot #4 | Raindance | 3397.74 | 6076.79 | 11417.32 | 3178.23 | 11417.32 | 14.84 | 11450.13 |
| CENTER POINT 2 #1-1-33-09 0-4-NH | CENTER POINT 2 #1-1-33-090-4 -NH (PWB) | Slot #2 | Center Point | 3464.67 | 11816.02 | 11816.02 | 3411.39 | 11816.02 | 65.03 | 11816.02 |
| RAINDANCE CE 3 #1-1-32-09 0-4-CH | RAINDANCE 3 #1-1-32-090-4 -CH (PWB) | Slot #3 | Raindance | 3580.56 | 6260.64 | 11417.32 | 3356.23 | 11417.32 | 15.67 | 11482.94 |
| HILLSIDE 2-4-32 | HILLSIDE 2-4-32 (PWB) | HILLSIDE 2-4-32 | Hillside | 3609.67 | 8705.75 | 8705.75 | 3566.12 | 8743.44 | 72.83 | 10039.37 |
| CENTER POINT 1 #1-1-33-09 0-4-CH | CENTER POINT 1 #1-1-33-090-4 -CH (PWB) | Slot #1 | Center Point | 3633.41 | 11816.02 | 11816.02 | 3579.65 | 11816.02 | 67.58 | 11816.02 |
| RAINDANCE CE 2 #1-1-32-09 0-4-NH | RAINDANCE 2 #1-1-32-090-4 -NH | Slot #2 | Raindance | 3723.93 | 6056.04 | 11411.48 | 3506.81 | 11417.32 | 16.30 | 11515.75 |
| CENTER POINT 3 #1-1-33-09 0-4-NH | CENTER POINT 3 #1-1-33-090-4 -NH (PWB) | Slot #3 | Center Point | 3790.65 | 11816.02 | 11816.02 | 3737.24 | 11816.02 | 70.97 | 11816.02 |

All data is in Feet unless otherwise stated
Coordinates are from Slot MD's are from Rig and TVD's are from Rig (Planned Datum #1 4954.0ft above Mean Sea Level)
Vertical Section is from 0.00N 0.00E on azimuth 95.940 degrees
Prepared by Peterson Energy
Date Printed: 2-May-2013



SYSDRILL
Closest Approach + Clearance Factor Summary Report
Wellbore: Pavistma South 3 #1-6-32-090-4-NH (PWB)
Wellpath: Pavistma South 3 #1-6-32-090-4-NH (PWP#1)

| Clearance Summary | | | | | | | | | | |
|-------------------------------------|---|-------------|------------------|-----------------|----------|--------------------|-------------------------|----------------|------------------|------------------|
| Offset WellName | Offset Wellbore | Offset Slot | Offset Structure | Separation [ft] | MD[ft] | Diverging From[ft] | Ellipse Separation [ft] | Ellipse MD[ft] | Clearance Factor | Clearance MD[ft] |
| RAINDAN CE 9 #1-0-32-09 0-4-NH | RAINDANCE 9 #1-0-32-090-4 -NH (PWB) | Slot #9 | Raindance | 4011.00 | 11411.36 | 11411.36 | 3924.95 | 11433.73 | 45.70 | 11816.02 |
| HILLSIDE 11 #0-7-28-00 0-4-CH | HILLSIDE 11 #0-7-28-000-4 -CH (PWB) | Slot #11 | Hillside | 4022.64 | 11729.02 | 11729.02 | 3929.70 | 11761.81 | 43.03 | 11816.02 |
| CENTER POINT 4 #1-0-33-09 0-4-NH | CENTER POINT 4 #1-0-33-090-4 -NH (PWB) | Slot #4 | Center Point | 4027.00 | 11816.02 | 11816.02 | 3973.55 | 11816.02 | 75.33 | 11816.02 |
| RAINDAN CE 1 #1-1-32 | RAINDANCE 1 #1-1-32 (PWB) | Slot #1 | Raindance | 4031.68 | 1000.66 | 1000.66 | 4029.39 | 1000.66 | 208.08 | 10646.33 |
| RAINDAN CE 8 #1-0-32-09 0-4-CH | RAINDANCE 8 #1-0-32-090-4 -CH (PWB) | Slot #8 | Raindance | 4042.35 | 1000.66 | 11408.73 | 4040.06 | 1000.66 | 47.69 | 11816.02 |
| RAINDAN CE 7 #1-0-32-09 0-4-NH | RAINDANCE 7 #1-0-32-090-4 -NH (PWB) | Slot #7 | Raindance | 4043.59 | 1000.66 | 11406.92 | 4041.30 | 1000.66 | 48.23 | 11816.02 |
| HILLSIDE 9 #7-7-29-00 0-4-NH | HILLSIDE 9 #7-7-29-000-4 -NH (PWB) | Slot #9 | Hillside | 4114.30 | 11288.69 | 11288.69 | 4037.49 | 11318.90 | 51.35 | 11816.02 |
| CENTER POINT 6 #1-0-33-09 0-4-CH | CENTER POINT 6 #1-0-33-090-4 -CH (PWB) | Slot #6 | Center Point | 4140.38 | 11816.02 | 11816.02 | 4086.57 | 11816.02 | 76.94 | 11816.02 |
| HILLSIDE 7 #7-7-29-00 0-4-CH | HILLSIDE 7 #7-7-29-000-4 -CH (PWB) | Slot #7 | Hillside | 4160.07 | 11154.86 | 11154.86 | 4109.92 | 11187.66 | 76.94 | 11816.02 |
| HILLSIDE 2 #5-7-29-00 0-4-CH | HILLSIDE 2 #5-7-29-000-4 -CH (PWB) | Slot #2 | Hillside | 4165.59 | 9776.90 | 9776.90 | 4137.19 | 9809.71 | 115.43 | 11816.02 |
| HILLSIDE 10 #8-7-29-00 0-4-NH | HILLSIDE 10 #8-7-29-000-4 -NH (PWB) | Slot #10 | Hillside | 4170.14 | 11608.57 | 11608.57 | 4081.58 | 11646.98 | 46.32 | 11816.02 |
| HILLSIDE 8 #7-7-29-00 0-4-NH | HILLSIDE 8 #7-7-29-000-4 -NH (PWB) | Slot #8 | Hillside | 4173.54 | 11000.08 | 11000.08 | 4107.04 | 11040.03 | 58.72 | 11816.02 |
| HILLSIDE 3 #5-7-29-00 0-4-NH | HILLSIDE 3 #5-7-29-000-4 -NH (PWB) | Slot #3 | Hillside | 4177.09 | 10244.81 | 10244.81 | 4136.37 | 10285.43 | 87.67 | 11816.02 |
| HILLSIDE 4 #5-7-29-00 0-4-NH | HILLSIDE 4 #5-7-29-000-4 -NH (PWB) | Slot #4 | Hillside | 4179.10 | 9694.88 | 9694.88 | 4150.68 | 9727.69 | 117.96 | 11745.41 |
| HILLSIDE 6 #6-7-29-00 0-4-CH | HILLSIDE 6 #6-7-29-000-4 -CH (PWB) | Slot #6 | Hillside | 4203.38 | 10391.02 | 10391.02 | 4157.87 | 10433.07 | 80.36 | 11816.02 |

All data is in Feet unless otherwise stated
Coordinates are from Slot MD's are from Rig and TVD's are from Rig (Planned Datum #1 4954.0ft above Mean Sea Level)
Vertical Section is from 0.00N 0.00E on azimuth 95.940 degrees
Prepared by Peterson Energy
Date Printed: 2-May-2013



SYSDRILL
Closest Approach + Clearance Factor Summary Report
Wellbore: Pavistma South 3 #1-6-32-090-4-NH (PWB)
Wellpath: Pavistma South 3 #1-6-32-090-4-NH (PWP#1)

| Clearance Summary | | | | | | | | | | |
|---|---|---------------|-------------------------------|-----------------|----------|--------------------|-------------------------|----------------|------------------|------------------|
| Offset WellName | Offset Wellbore | Offset Slot | Offset Structure | Separation [ft] | MD[ft] | Diverging From[ft] | Ellipse Separation [ft] | Ellipse MD[ft] | Clearance Factor | Clearance MD[ft] |
| CENTER POINT 8 #1-0-33-09 0-4-NH | CENTER POINT 8 #1-0-33-090-4 -NH (PWB) | Slot #8 | Center Point | 4203.45 | 11816.02 | 11816.02 | 4149.62 | 11816.02 | 78.07 | 11816.02 |
| HILLSIDE 5 #6-7-29-00 0-4-NH | HILLSIDE 5 #6-7-29-000-4 -NH (PWB) | Slot #5 | Hillside | 4204.49 | 10703.87 | 10703.87 | 4148.17 | 10744.75 | 67.73 | 11816.02 |
| RANCHO WATER VALLEY #2-6-4 | RANCHO WATER VALLEY #2-6-4 (AWB) | Slot #03 | Rancho Water Valley | 4253.64 | 11816.02 | 11816.02 | 4205.02 | 11816.02 | 87.50 | 11816.02 |
| Poudre #36-28 | Poudre #36-28 (AWB) | Poudre #36-28 | Poudre (Kerr-McGee Oil & Gas) | 5098.17 | 11816.02 | 11816.02 | 5036.06 | 11816.02 | 82.08 | 11816.02 |
| Poudre #14-28 | Poudre #14-28 (AWB) | Poudre #14-28 | Poudre (Kerr-McGee Oil & Gas) | 5251.46 | 11816.02 | 11816.02 | 5205.16 | 11816.02 | 113.45 | 11816.02 |
| RANCHO WATER VALLEY 9 #8-7-33-00 0-4-CH | RANCHO WATER VALLEY 9 #8-7-33-000-4 -CH (PWB) | Slot #09 | Rancho Water Valley | 5287.19 | 11816.02 | 11816.02 | 5205.63 | 11816.02 | 64.82 | 11816.02 |
| RANCHO WATER VALLEY 8 #8-7-33-00 0-4-NH | RANCHO WATER VALLEY 8 #8-7-33-000-4 -NH (PWB) | Slot #08 | Rancho Water Valley | 5387.20 | 11816.02 | 11816.02 | 5347.82 | 11816.02 | 136.81 | 11816.02 |
| RANCHO WATER VALLEY #2-8-4 | RANCHO WATER VALLEY 2-8-4 (AWB) | Slot #02 | Rancho Water Valley | 5417.54 | 11816.02 | 11816.02 | 5388.68 | 11816.02 | 187.72 | 11816.02 |
| Poudre #19-28 | Poudre #19-28 (AWB) | Poudre #19-28 | Poudre (Kerr-McGee Oil & Gas) | 5757.09 | 11816.02 | 11816.02 | 5692.97 | 11816.02 | 89.78 | 11816.02 |
| Poudre #15-28 | Poudre #15-28 (AWB) | Poudre #15-28 | Poudre (Kerr-McGee Oil & Gas) | 5901.39 | 11816.02 | 11816.02 | 5836.12 | 11816.02 | 90.41 | 11816.02 |
| RANCHO WATER VALLEY #3-9-4 | RANCHO WATER VALLEY #3-9-4 (AWB) | Slot #01 | Rancho Water Valley | 6088.84 | 11816.02 | 11816.02 | 6047.31 | 11816.02 | 146.62 | 11816.02 |
| Poudre #23-28 | Poudre #23-28 (AWB) | Poudre #23-28 | Poudre (Kerr-McGee Oil & Gas) | 6145.56 | 11816.02 | 11816.02 | 6096.99 | 11816.02 | 126.54 | 11816.02 |
| Poudre #11-28 | Poudre #11-28 (AWB) | Poudre #11-28 | Poudre (Kerr-McGee Oil & Gas) | 6553.64 | 11816.02 | 11816.02 | 6497.02 | 11816.02 | 115.75 | 11816.02 |
| Kodak 15 #7-4-28-27 0-4-NH | Kodak 15 #7-4-28-270-4 -NH (PWB) | Slot #15 | Kodak | 6799.76 | 11816.02 | 11816.02 | 6705.91 | 11816.02 | 72.46 | 11816.02 |
| Kodak 14 #7-4-28-27 0-4-CH | Kodak 14 #7-4-28-270-4 -CH (PWB) | Slot #14 | Kodak | 6970.72 | 11816.02 | 11816.02 | 6876.82 | 11816.02 | 74.23 | 11816.02 |
| Poudre #10-28 | Poudre #10-28 (AWB) | Poudre #10-28 | Poudre (Kerr-McGee Oil & Gas) | 7019.74 | 11816.02 | 11816.02 | 6960.63 | 11816.02 | 118.76 | 11816.02 |

All data is in Feet unless otherwise stated
Coordinates are from Slot MD's are from Rig and TVD's are from Rig (Planned Datum #1 4954.0ft above Mean Sea Level)
Vertical Section is from 0.00N 0.00E on azimuth 95.940 degrees
Prepared by Peterson Energy
Date Printed: 2-May-2013



SYSDRILL
Closest Approach + Clearance Factor Summary Report
Wellbore: Pavistma South 3 #1-6-32-090-4-NH (PWB)
Wellpath: Pavistma South 3 #1-6-32-090-4-NH (PWP#1)

| Clearance Summary | | | | | | | | | | |
|----------------------------------|--|-----------------------------|---|-----------------|----------|--------------------|-------------------------|----------------|------------------|------------------|
| Offset WellName | Offset Wellbore | Offset Slot | Offset Structure | Separation [ft] | MD[ft] | Diverging From[ft] | Ellipse Separation [ft] | Ellipse MD[ft] | Clearance Factor | Clearance MD[ft] |
| Kodak 13 #7-4-28-27 0-4-NH | Kodak 13 #7-4-28-270-4 -NH (PWB) | Slot #13 | Kodak | 7128.85 | 11816.02 | 11816.02 | 7034.85 | 11816.02 | 75.84 | 11816.02 |
| Poudre #25-28 | Poudre #25-28 (AWB) | Poudre #25-28 | Poudre (Kerr-McGee Oil & Gas) | 7261.00 | 11816.02 | 11816.02 | 7203.08 | 11816.02 | 125.36 | 11816.02 |
| Kodak 12 #7-3-28-27 0-4-NH | Kodak 12 #7-3-28-270-4 -NH (PWB) | Slot #12 | Kodak | 7458.02 | 11816.02 | 11816.02 | 7363.86 | 11816.02 | 79.21 | 11816.02 |
| W Great Western #27-14 | W Great Western #27-14 (AWB) | Great Western #27-14 | Great Western (Great Western Oil & Gas) | 7621.34 | 11816.02 | 11816.02 | 7589.54 | 11816.02 | 239.65 | 11816.02 |
| Kodak 11 #7-3-28-27 0-4-CH | Kodak 11 #7-3-28-270-4 -CH (PWB) | Slot #11 | Kodak | 7628.48 | 11816.02 | 11816.02 | 7534.27 | 11816.02 | 80.97 | 11816.02 |
| Kodak 10 #7-3-28-27 0-4-NH | Kodak 10 #7-3-28-270-4 -NH (PWB) | Slot #10 | Kodak | 7787.27 | 11816.02 | 11816.02 | 7692.97 | 11816.02 | 82.58 | 11816.02 |
| Kodak 9 #7-2-28-27 0-4-NH | Kodak 9 #7-2-28-270-4 -NH (PWB) | Slot #9 | Kodak | 8116.57 | 11816.02 | 11816.02 | 8022.12 | 11816.02 | 85.94 | 11816.02 |
| Kodak 8 #7-2-28-27 0-4-CH | Kodak 8 #7-2-28-270-4 -CH (PWB) | Slot #8 | Kodak | 8286.58 | 11816.02 | 11816.02 | 8192.08 | 11816.02 | 87.69 | 11816.02 |
| Kodak 7 #7-2-28-27 0-4-NH | Kodak 7 #7-2-28-270-4 -NH (PWB) | Slot #7 | Kodak | 8445.89 | 11816.02 | 11816.02 | 8351.30 | 11816.02 | 89.29 | 11816.02 |
| W Great Western # 27-53 | W Great Western # 27-53 (AWB) | Great Western # 27-53 | Great Western (Great Western Oil & Gas) | 8551.87 | 11816.02 | 11816.02 | 8519.71 | 11816.02 | 265.90 | 11816.02 |
| Great Western 27-13 | W #12 Great Western 27-13 (AWB) | Great Western #27-13 | Great Western (Great Western Oil & Gas) | 8557.89 | 11816.02 | 11816.02 | 8522.94 | 11816.02 | 244.82 | 11816.02 |
| Kodak 6 #7-1-28-27 0-4-NH | Kodak 6 #7-1-28-270-4 -NH (PWB) | Slot #6 | Kodak | 8775.25 | 11816.02 | 11816.02 | 8680.52 | 11816.02 | 92.63 | 11816.02 |
| Kodak 5 #7-1-28-27 0-4-CH | Kodak 5 #7-1-28-270-4 -CH (PWB) | Slot #5 | Kodak | 8944.93 | 11816.02 | 11816.02 | 8850.15 | 11816.02 | 94.37 | 11816.02 |
| W Great Western #27-23 | W Great Western #27-23 (AWB) | Great Western #27-23 | Great Western (Great Western Oil & Gas) | 9093.83 | 11816.02 | 11816.02 | 9062.31 | 11816.02 | 288.53 | 11816.02 |
| Kodak 4 #7-1-28-27 0-4-NH | Kodak 4 #7-1-28-270-4 -NH (PWB) | Slot #4 | Kodak | 9104.70 | 11816.02 | 11816.02 | 9009.82 | 11816.02 | 95.96 | 11816.02 |
| Kodak 3 #7-0-28-27 0-4-NH | Kodak 3 #7-0-28-270-4 -NH (PWB) | Slot #3 | Kodak | 9434.16 | 11816.02 | 11816.02 | 9339.13 | 11816.02 | 99.28 | 11816.02 |
| W Great Western | W Great Western | Great Western | Great Western | 9554.00 | 11816.02 | 11816.02 | 9516.83 | 11816.02 | 257.09 | 11816.02 |

All data is in Feet unless otherwise stated
Coordinates are from Slot MD's are from Rig and TVD's are from Rig (Planned Datum #1 4954.0ft above Mean Sea Level)
Vertical Section is from 0.00N 0.00E on azimuth 95.940 degrees
Prepared by Peterson Energy
Date Printed: 2-May-2013



SYSDRILL
Closest Approach + Clearance Factor Summary Report
Wellbore: Pavistma South 3 #1-6-32-090-4-NH (PWB)
Wellpath: Pavistma South 3 #1-6-32-090-4-NH (PWP#1)

| Clearance Summary | | | | | | | | | | |
|---------------------------------|--|----------------------|----------------------|-----------------|----------|--------------------|-------------------------|----------------|------------------|------------------|
| Offset WellName | Offset Wellbore | Offset Slot | Offset Structure | Separation [ft] | MD[ft] | Diverging From[ft] | Ellipse Separation [ft] | Ellipse MD[ft] | Clearance Factor | Clearance MD[ft] |
| #27-12 | #27-12 (AWB) | #27-12 | 66N67W | | | | | | | |
| Kodak 2 #7-0-28-27 0-4-CH | Kodak 2 #7-0-28-270-4 -CH (PWB) | Slot #2 | Kodak | 9603.53 | 11816.02 | 11816.02 | 9508.45 | 11816.02 | 101.00 | 11816.02 |
| Kodak 1 #7-8-21-27 0-4-NH | Kodak 1 #7-8-21-270-4 -NH (PWB) | Slot #1 | Kodak | 9763.62 | 11816.02 | 11816.02 | 9668.44 | 11816.02 | 102.58 | 11816.02 |
| DIAMOND VALLEY SW 9-5-22 | DIAMOND VALLEY SW 1 #4-7-22-270-6 -NH (PWB #2) | Slot #1 | Diamond Valley SW | 10093.06 | 11816.02 | 11816.02 | 9988.81 | 11816.02 | 96.82 | 11816.02 |
| DIAMOND VALLEY SW 2 | DIAMOND VALLEY SW 2 #4-7-22-270-6 -CH (PWB #2) | Slot #2 | Diamond Valley SW | 10261.12 | 11816.02 | 11816.02 | 10156.81 | 11816.02 | 98.37 | 11816.02 |
| DIAMOND VALLEY SW 9-5-22 | DIAMOND VALLEY SW 1 #4-7-22-270-6 -NH (PWB) | Slot #1 | Diamond Valley SW | 10296.37 | 11816.02 | 11816.02 | 10192.07 | 11816.02 | 98.72 | 11816.02 |
| W Great Western #27-22 | W Great Western #27-22 (AWB) | Great Western #27-22 | Great Western 66N67W | 10301.85 | 11816.02 | 11816.02 | 10267.86 | 11816.02 | 303.08 | 11816.02 |
| DIAMOND VALLEY SW 3 | DIAMOND VALLEY SW 3 #4-7-22-270-6 -NH (PWB #2) | Slot #3 | Diamond Valley SW | 10422.19 | 11816.02 | 11816.02 | 10317.82 | 11816.02 | 99.86 | 11816.02 |
| DIAMOND VALLEY SW 2 | DIAMOND VALLEY SW 2 #3-7-22-270-6 -CH (PWB) | Slot #2 | Diamond Valley SW | 10467.38 | 11816.02 | 11816.02 | 10363.12 | 11816.02 | 100.40 | 11816.02 |
| W Great Western #27-52 | W Great Western #27-52 (AWB) | Great Western #27-52 | Great Western 66N67W | 10477.33 | 11816.02 | 11816.02 | 10440.39 | 11816.02 | 283.65 | 11816.02 |
| W Great Western #27-11 | W Great Western #27-11 (AWB) | Great Western #27-11 | Great Western 66N67W | 10622.45 | 11816.02 | 11816.02 | 10583.75 | 11816.02 | 274.51 | 11816.02 |
| DIAMOND VALLEY SW 3 | DIAMOND VALLEY SW 3 #3-6-22-270-6 -NH (PWB) | Slot #3 | Diamond Valley SW | 10627.42 | 11816.02 | 11816.02 | 10522.98 | 11816.02 | 101.76 | 11816.02 |
| DIAMOND VALLEY SW 4 | DIAMOND VALLEY SW 4 #4-6-22-270-6 -NH (PWB #2) | Slot #4 | Diamond Valley SW | 10751.79 | 11816.02 | 11816.02 | 10647.31 | 11816.02 | 102.91 | 11816.02 |
| DIAMOND VALLEY SW 8-2-22 | DIAMOND VALLEY SW 5 #4-6-22-270-6 -CH (PWB) | Slot #5 | Diamond Valley SW | 10920.55 | 11816.02 | 11816.02 | 10816.03 | 11816.02 | 104.48 | 11816.02 |

All data is in Feet unless otherwise stated
Coordinates are from Slot MD's are from Rig and TVD's are from Rig (Planned Datum #1 4954.0ft above Mean Sea Level)
Vertical Section is from 0.00N 0.00E on azimuth 95.940 degrees
Prepared by Peterson Energy
Date Printed: 2-May-2013



SYSDRILL
Closest Approach + Clearance Factor Summary Report
Wellbore: Pavistma South 3 #1-6-32-090-4-NH (PWB)
Wellpath: Pavistma South 3 #1-6-32-090-4-NH (PWP#1)

| Clearance Summary | | | | | | | | | | |
|--------------------------|--|-----------------------|------------------------------|-----------------|----------|--------------------|-------------------------|----------------|------------------|------------------|
| Offset WellName | Offset Wellbore | Offset Slot | Offset Structure | Separation [ft] | MD[ft] | Diverging From[ft] | Ellipse Separation [ft] | Ellipse MD[ft] | Clearance Factor | Clearance MD[ft] |
| #2) | | | | | | | | | | |
| DIAMOND VALLEY SW 4 | DIAMOND VALLEY SW 4 #3-6-22-270-6-NH (PWB) | Slot #4 | Diamond Valley SW | 10954.84 | 11816.02 | 11816.02 | 10850.29 | 11816.02 | 104.78 | 11816.02 |
| DIAMOND VALLEY SW 6 | DIAMOND VALLEY SW 6 #4-6-22-270-6-NH (PWB #2) | Slot #6 | Diamond Valley SW | 11081.32 | 11816.02 | 11816.02 | 10976.73 | 11816.02 | 105.95 | 11816.02 |
| DIAMOND VALLEY SW 8-2-22 | DIAMOND VALLEY SW 5 #3-6-22-270-6-CH (PWB) | Slot #5 | Diamond Valley SW | 11126.15 | 11816.02 | 11816.02 | 11021.59 | 11816.02 | 106.41 | 11816.02 |
| DIAMOND VALLEY SW 6 | DIAMOND VALLEY SW 6 (PWB) | Slot #6 | Diamond Valley SW | 11285.95 | 11816.02 | 11816.02 | 11181.25 | 11816.02 | 107.80 | 11816.02 |
| Great Western 27-31-8 | Great Western 27-31-8 (AWB) | Great Western 27-31-8 | Great Western Diamond Valley | 11359.86 | 11816.02 | 11816.02 | 11325.02 | 11816.02 | 326.03 | 11816.02 |
| W Great Western #27-21 | W Great Western #27-21 (AWB) | Great Western #27-21 | Great Western 66N67W | 11361.74 | 11816.02 | 11816.02 | 11327.44 | 11816.02 | 331.24 | 11816.02 |
| DIAMOND VALLEY SW 7 | DIAMOND VALLEY SW 7 #4-5-22-270-6-NH (PWB #2) | Slot #7 | Diamond Valley SW | 11410.91 | 11816.02 | 11816.02 | 11306.16 | 11816.02 | 108.94 | 11816.02 |
| DIAMOND VALLEY SW 8 | DIAMOND VALLEY SW 8 #4-5-22-270-6-CH (PWB #2) | Slot #8 | Diamond Valley SW | 11579.44 | 11816.02 | 11816.02 | 11474.63 | 11816.02 | 110.48 | 11816.02 |
| DIAMOND VALLEY SW 7 | DIAMOND VALLEY SW 7 #3-5-22-270-6-NH (PWB) | Slot #7 | Diamond Valley SW | 11617.21 | 11816.02 | 11816.02 | 11512.47 | 11816.02 | 110.92 | 11816.02 |
| DIAMOND VALLEY SW 8 | DIAMOND VALLEY SW 8 #3-5-22-270-6-CH PWB) | Slot #8 | Diamond Valley SW | 11730.08 | 11816.02 | 11816.02 | 11625.31 | 11816.02 | 111.96 | 11816.02 |
| DIAMOND VALLEY SW 9 | DIAMOND VALLEY SW 9 #4-5-22-270-6-NH (PWB #2) | Slot #9 | Diamond Valley SW | 11740.48 | 11816.02 | 11816.02 | 11635.60 | 11816.02 | 111.94 | 11816.02 |
| DIAMOND VALLEY SW 8-2-22 | DIAMOND VALLEY SW 8-2-22 (PWB) | Slot #5 | Diamond Valley SW | 11757.20 | 11816.02 | 11816.02 | 11686.05 | 11816.02 | 165.26 | 11816.02 |
| DIAMOND VALLEY | DIAMOND VALLEY SW 9 | Slot #9 | Diamond Valley SW | 11944.71 | 11816.02 | 11816.02 | 11839.75 | 11816.02 | 113.80 | 11816.02 |

All data is in Feet unless otherwise stated
Coordinates are from Slot MD's are from Rig and TVD's are from Rig (Planned Datum #1 4954.0ft above Mean Sea Level)
Vertical Section is from 0.00N 0.00E on azimuth 95.940 degrees
Prepared by Peterson Energy
Date Printed: 2-May-2013



SYSDRILL
Closest Approach + Clearance Factor Summary Report
Wellbore: Pavistma South 3 #1-6-32-090-4-NH (PWB)
Wellpath: Pavistma South 3 #1-6-32-090-4-NH (PWP#1)

| Clearance Summary | | | | | | | | | | |
|-------------------------|--|-------------------------|------------------------------|-----------------|----------|--------------------|-------------------------|----------------|------------------|------------------|
| Offset WellName | Offset Wellbore | Offset Slot | Offset Structure | Separation [ft] | MD[ft] | Diverging From[ft] | Ellipse Separation [ft] | Ellipse MD[ft] | Clearance Factor | Clearance MD[ft] |
| SW 9 | #3-4-22-270-6 -NH (PWB) | | | | | | | | | |
| DIAMOND VALLEY SW 10 | DIAMOND VALLEY SW 10 #3-4-22-270-6 -NH (PWB) | Slot #10 | Diamond Valley SW | 12276.10 | 11816.02 | 11816.02 | 12171.11 | 11816.02 | 116.93 | 11816.02 |
| Great Western 27-21-3 | Great Western 27-21-3 (AWB) | Great Western 27-21-3 | Great Western Diamond Valley | 12335.09 | 11816.02 | 11816.02 | 12298.55 | 11816.02 | 337.51 | 11816.02 |
| DIAMOND VALLEY SW 2 | DIAMOND VALLEY SW 8-4-22 (PWB) | Slot #2 | Diamond Valley SW | 12475.04 | 11816.02 | 11816.02 | 12433.06 | 11816.02 | 297.14 | 11816.02 |
| DIAMOND VALLEY SW 7 | DIAMOND VALLEY SW 7-3-22 (PWB) | Slot #7 | Diamond Valley SW | 12660.87 | 11816.02 | 11816.02 | 12598.40 | 11816.02 | 202.68 | 11816.02 |
| DIAMOND VALLEY SW 8 | DIAMOND VALLEY SW 6-2-22 (PWB) | Slot #8 | Diamond Valley SW | 12846.04 | 11816.02 | 11816.02 | 12764.48 | 11816.02 | 157.50 | 11816.02 |
| Diamond Valley 22-34 | Diamond Valley 22-34 (AWB) | Diamond Valley 22-34 | Great Western Diamond Valley | 13196.62 | 11816.02 | 11816.02 | 13160.31 | 11816.02 | 363.45 | 11816.02 |
| Great Western 27-31-2 | Great Western 27-31-2 (AWB) | Great Western 27-31-2 | Great Western Diamond Valley | 13200.02 | 11816.02 | 11816.02 | 13165.20 | 11816.02 | 379.03 | 11816.02 |
| Great Western 27-41-10 | Great Western 27-41-10 (AWB) | Great Western 27-41-10 | Great Western Diamond Valley | 13303.47 | 11816.02 | 11816.02 | 13272.37 | 11816.02 | 427.75 | 11816.02 |
| Diamond Valley 22-23-18 | Diamond Valley 22-23-18 (AWB) | Diamond Valley 22-23-18 | Great Western Diamond Valley | 13393.46 | 11816.02 | 11816.02 | 13355.59 | 11816.02 | 353.65 | 11816.02 |
| DIAMOND VALLEY SW 10 | DIAMOND VALLEY SW 6-4-22 (PWB) | Slot #10 | Diamond Valley SW | 13485.34 | 11816.02 | 11816.02 | 13433.18 | 11816.02 | 258.55 | 11816.02 |
| Diamond Valley 22-54 | Diamond Valley 22-54 (AWB) | Diamond Valley 22-54 | Great Western Diamond Valley | 14041.02 | 11816.02 | 11816.02 | 14005.90 | 11816.02 | 399.79 | 11816.02 |
| Diamond Valley 22-22-13 | Diamond Valley 22-22-13 (AWB) | Diamond Valley 22-22-13 | Great Western Diamond Valley | 14067.99 | 11816.02 | 11816.02 | 14033.86 | 11816.02 | 412.26 | 11816.02 |
| Diamond Valley 22-44 | Diamond Valley 22-44 (AWB) | Diamond Valley 22-44 | Great Western Diamond Valley | 14104.88 | 11816.02 | 11816.02 | 14070.77 | 11816.02 | 413.44 | 11816.02 |
| Great Western 27-41-1 | Great Western 27-41-1 (AWB) | Great Western 27-41-1 | Great Western Diamond Valley | 14114.71 | 11816.02 | 11816.02 | 14081.77 | 11816.02 | 428.53 | 11816.02 |
| Diamond Valley 22-33 | Diamond Valley 22-33 (AWB) | Diamond Valley 22-33 | Great Western Diamond Valley | 14138.92 | 11816.02 | 11816.02 | 14104.55 | 11816.02 | 411.29 | 11816.02 |

All data is in Feet unless otherwise stated
Coordinates are from Slot MD's are from Rig and TVD's are from Rig (Planned Datum #1 4954.0ft above Mean Sea Level)
Vertical Section is from 0.00N 0.00E on azimuth 95.940 degrees
Prepared by Peterson Energy
Date Printed: 2-May-2013



SYSDRILL
Closest Approach + Clearance Factor Summary Report
Wellbore: Pavistma South 3 #1-6-32-090-4-NH (PWB)
Wellpath: Pavistma South 3 #1-6-32-090-4-NH (PWP#1)

| Clearance Summary | | | | | | | | | | |
|-------------------------|-------------------------------|-------------------------|------------------------------|-----------------|----------|--------------------|-------------------------|----------------|------------------|------------------|
| Offset WellName | Offset Wellbore | Offset Slot | Offset Structure | Separation [ft] | MD[ft] | Diverging From[ft] | Ellipse Separation [ft] | Ellipse MD[ft] | Clearance Factor | Clearance MD[ft] |
| Diamond Valley 22-32-12 | Diamond Valley 22-32-12 (AWB) | Diamond Valley 22-32-12 | Great Western Diamond Valley | 14279.64 | 11816.02 | 11816.02 | 14246.56 | 11816.02 | 431.74 | 11816.02 |
| Diamond Valley 22-43 | Diamond Valley 22-43 (AWB) | Diamond Valley 22-43 | Great Western Diamond Valley | 14348.41 | 11816.02 | 11816.02 | 14315.68 | 11816.02 | 438.47 | 11816.02 |