

QUICKSILVER RESOURCES, INC.

CONSTRUCTION LAYOUT FOR

WELKER #34-11

SECTION 11, T6N, R92W, 6th P.M.

660' FSL 1898' FEL

FIGURE #1

SCALE: 1" = 60'

DATE: 05-21-12

DRAWN BY: J.W.

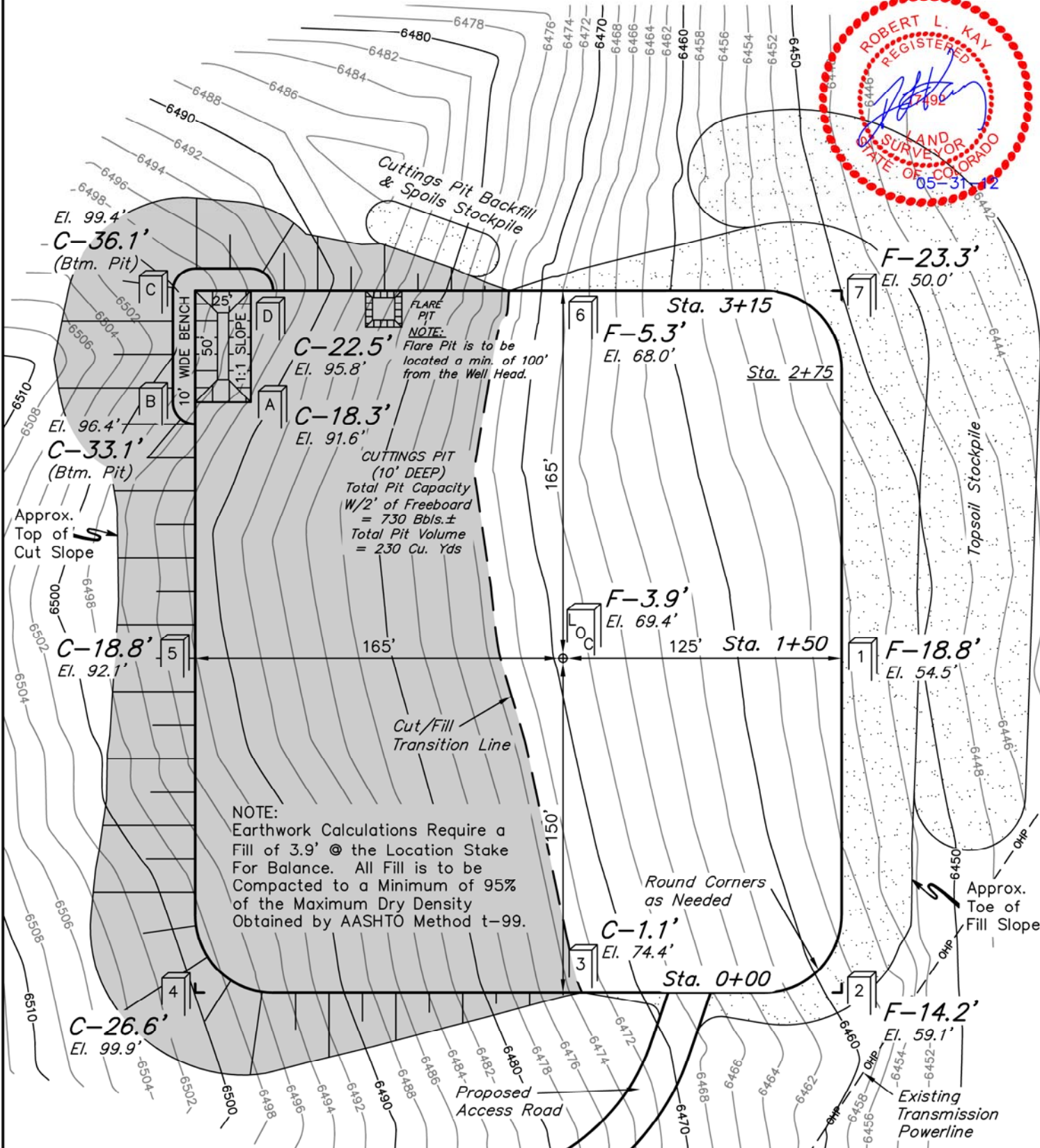
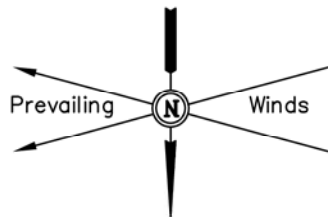

Elev. Ungraded Ground At Loc. Stake = **6469.4'**
FINISHED GRADE ELEV. AT LOC. STAKE = **6473.3'**

UINTAH ENGINEERING & LAND SURVEYING
85 So. 200 East * Vernal, Utah 84078 * (435) 789-1017

1" = 40'
X-Section
Scale
1" = 100'
DATE: 05-21-12
DRAWN BY: J.W.

QUICKSILVER RESOURCES, INC.
CONSTRUCTION LAYOUT CROSS SECTIONS FOR
WELKER #34-11
SECTION 11, T6N, R92W, 6th P.M.
660' FSL 1898' FEL

FIGURE #2

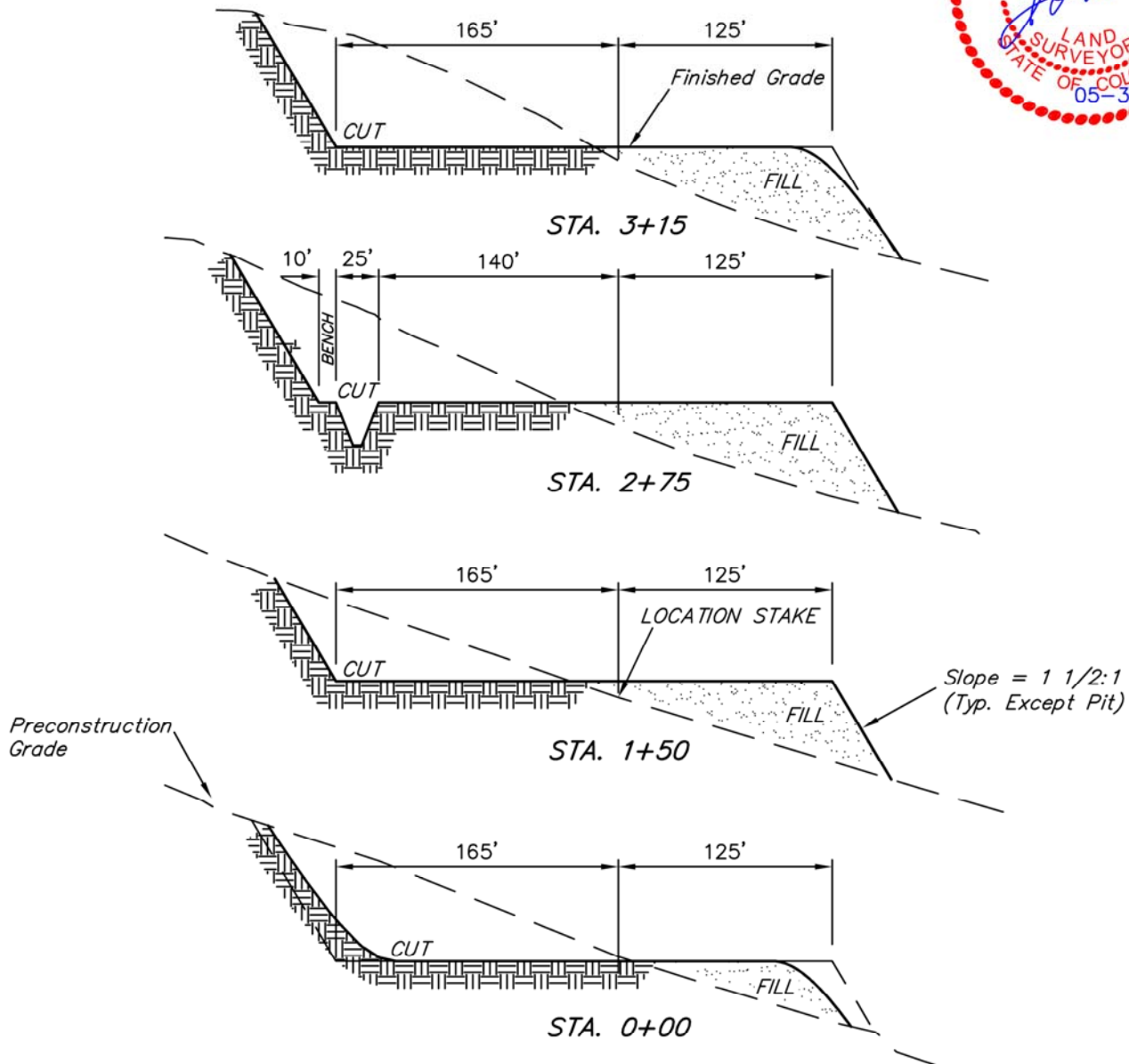

NOTE:

Topsoil should not be Stripped Below Finished Grade on Substructure Area.

APPROXIMATE ACREAGES

WELL SITE DISTURBANCE = ± 3.460 ACRES
ACCESS ROAD DISTURBANCE = ± 1.328 ACRES
TOTAL = ± 4.788 ACRES

*** NOTE:**

FILL QUANTITY INCLUDES 5% FOR COMPACTION

APPROXIMATE YARDAGES

(12") Topsoil Stripping = 4,860 Cu. Yds.
Remaining Location = 25,520 Cu. Yds.
TOTAL CUT = 30,380 CU. YDS.
FILL = 25,400 CU. YDS.

EXCESS MATERIAL = 4,980 Cu. Yds.
Topsoil & Pit Backfill = 4,980 Cu. Yds.
(1/2 Pit Vol.)
EXCESS UNBALANCE = 0 Cu. Yds.
(After Interim Rehabilitation)

UINTAH ENGINEERING & LAND SURVEYING
85 So. 200 East * Vernal, Utah 84078 * (435) 789-1017