



KERR MCGEE OIL & GAS ONSHORE LP

Location: COLORADO Slot: SLOT#06 SWEETGRASS 10-14 (1834'FSL & 872'FEL)
Field: WELD COUNTY (KERR MCGEE) Well: SWEETGRASS 10-14
Facility: SEC.14-T1N-R68W Wellbore: SWEETGRASS 10-14 PWB



Plot reference wellbore to SWEETGRASS 10-14 (REV 8.0) PWB	
True vertical depths are referenced to XTREME 12 (RKB)	Grid System: NAD83 / Lambert Colorado SP, Northern Zone (S01), US feet
Measured depths are referenced to XTREME 12 (RKB)	North Reference: True north
XTREME 12 (RKB) to Mean Sea Level: 5151 feet	Scale: True distance
Mean Sea Level to Mud line (At Slot: SWEETGRASS 10-14 (1834'FSL & 872'FEL)): 6 feet	Depths are in feet
Coordinates are in feet referenced to Slot	Created by: rockdorm on 7/20/2011

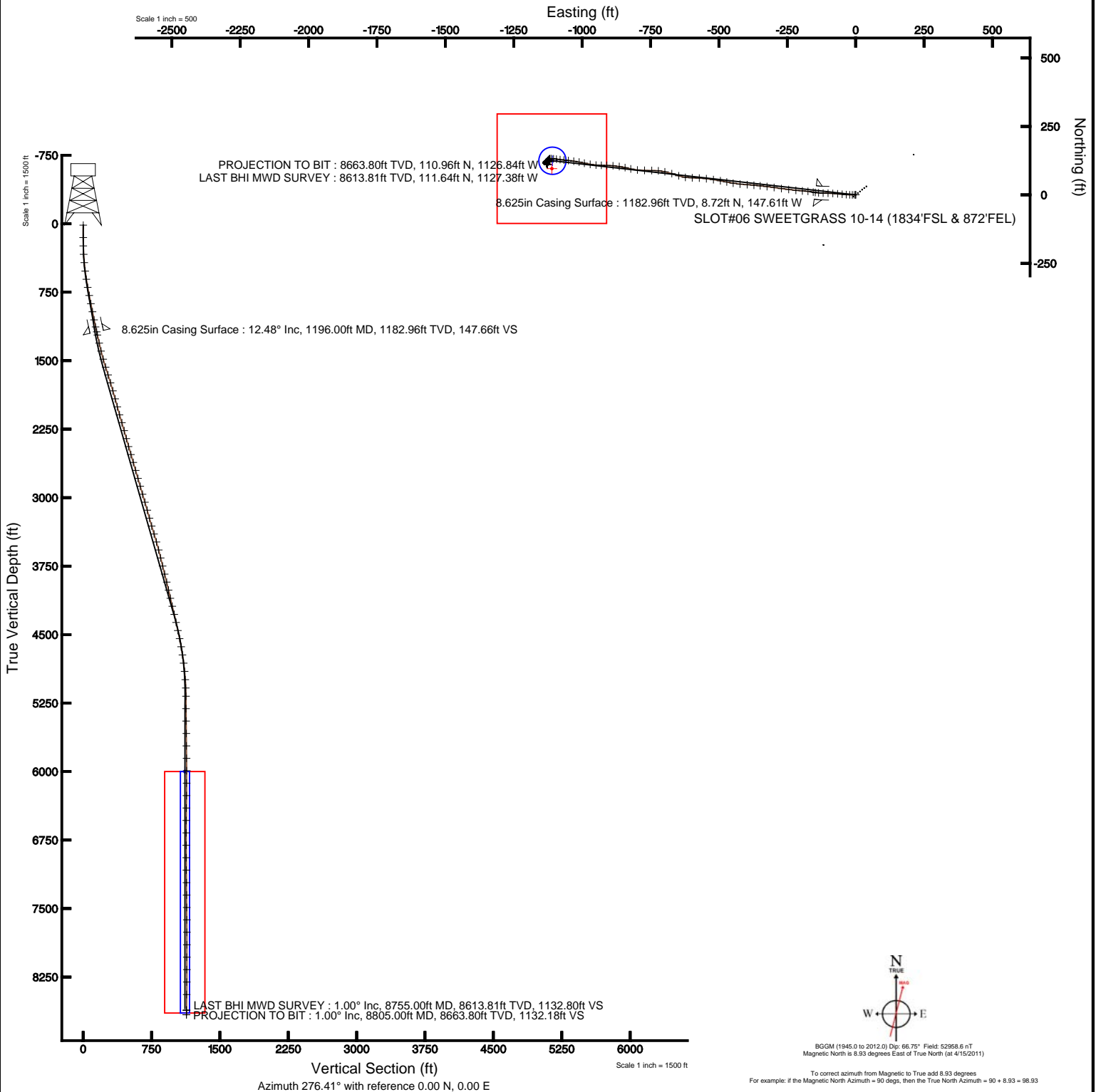



Actual Wellpath Report

SWEETGRASS 10-14 AWP

Page 1 of 4



REFERENCE WELLPATH IDENTIFICATION			
Operator	KERR MCGEE OIL & GAS ONSHORE LP	Slot	SLOT#06 SWEETGRASS 10-14 (1834'FSL & 872'FEL)
Area	COLORADO	Well	SWEETGRASS 10-14
Field	WELD COUNTY (KERR MCGEE)	Wellbore	SWEETGRASS 10-14 AWB
Facility	SEC.14-T1N-R68W		

REPORT SETUP INFORMATION			
Projection System	NAD83 / Lambert Colorado SP, Northern Zone (501), US feet	Software System	WellArchitect® 3.0.0
North Reference	True	User	Cookdanm
Scale	0.999963	Report Generated	7/20/2011 at 2:10:43 PM
Convergence at slot	0.35° East	Database/Source file	WA_DENVER/SWEETGRASS_10-14_AWB.xml

WELLPATH LOCATION						
	Local coordinates		Grid coordinates		Geographic coordinates	
	North[ft]	East[ft]	Easting[US ft]	Northing[US ft]	Latitude	Longitude
Slot Location	-30.96	-39.19	3149965.13	1261229.41	40°02'57.192"N	104°57'51.530"W
Facility Reference Pt			3150004.14	1261260.61	40°02'57.498"N	104°57'51.026"W
Field Reference Pt			3197771.84	1268891.29	40°04'09.600"N	104°47'36.000"W

WELLPATH DATUM			
Calculation method	Minimum curvature	XTREME 12 (RKB) to Facility Vertical Datum	5151.00ft
Horizontal Reference Pt	Slot	XTREME 12 (RKB) to Mean Sea Level	5151.00ft
Vertical Reference Pt	XTREME 12 (RKB)	XTREME 12 (RKB) to Mud Line at Slot (SLOT#06 SWEETGRASS 10-14 (1834'FSL & 872'FEL))	5151.00ft
MD Reference Pt	XTREME 12 (RKB)	Section Origin	N 0.00, E 0.00 ft
Field Vertical Reference	Mean Sea Level	Section Azimuth	276.41°



Actual Wellpath Report

SWEETGRASS 10-14 AWP

Page 2 of 4



REFERENCE WELLPATH IDENTIFICATION			
Operator	KERR MCGEE OIL & GAS ONSHORE LP	Slot	SLOT#06 SWEETGRASS 10-14 (1834'FSL & 872'FEL)
Area	COLORADO	Well	SWEETGRASS 10-14
Field	WELD COUNTY (KERR MCGEE)	Wellbore	SWEETGRASS 10-14 AWP
Facility	SEC.14-T1N-R68W		

WELLPATH DATA (86 stations) † = interpolated/extrapolated station								
MD [ft]	Inclination [°]	Azimuth [°]	TVD [ft]	Vert Sect [ft]	North [ft]	East [ft]	DLS [°/100ft]	Comments
0.00†	0.000	62.600	0.00	0.00	0.00	0.00	0.00	
15.00	0.000	62.600	15.00	0.00	0.00	0.00	0.00	
150.00	0.500	62.600	150.00	-0.49	0.27	0.52	0.37	
242.00	1.400	267.200	241.99	0.29	0.40	-0.24	2.03	
334.00	3.800	265.100	333.89	4.39	0.09	-4.40	2.61	
426.00	5.400	270.000	425.59	11.68	-0.17	-11.77	1.79	
518.00	6.900	272.800	517.06	21.50	0.10	-21.62	1.66	
609.00	8.800	273.200	607.20	33.90	0.75	-34.03	2.09	
699.00	10.500	277.400	695.93	48.98	2.19	-49.04	2.04	
790.00	11.000	273.900	785.33	65.94	3.85	-65.92	0.90	
881.00	11.100	273.900	874.64	83.37	5.04	-83.32	0.11	
972.00	11.100	271.700	963.94	100.85	5.89	-100.82	0.47	
1062.00	11.700	270.700	1052.16	118.56	6.26	-118.60	0.70	
1141.00	13.100	275.600	1129.32	135.48	7.23	-135.52	2.22	
1232.00	12.100	280.500	1218.13	155.31	9.98	-155.17	1.61	
1322.00	12.500	276.700	1306.07	174.46	12.83	-174.12	1.00	
1412.00	13.900	272.400	1393.69	194.98	14.42	-194.59	1.90	
1504.00	16.300	277.000	1482.51	218.92	16.46	-218.45	2.91	
1595.00	17.400	276.300	1569.60	245.30	19.51	-244.65	1.23	
1685.00	17.300	278.800	1655.51	272.13	23.03	-271.25	0.84	
1776.00	17.100	277.700	1742.44	299.02	26.89	-297.88	0.42	
1867.00	16.400	277.000	1829.58	325.24	30.25	-323.89	0.80	
1958.00	15.500	274.900	1917.07	350.24	32.86	-348.76	1.17	
2048.00	14.400	275.300	2004.03	373.46	34.92	-371.88	1.23	
2139.00	16.900	274.900	2091.65	397.99	37.09	-396.33	2.75	
2230.00	16.700	274.600	2178.76	424.29	39.27	-422.54	0.24	
2321.00	15.600	280.200	2266.17	449.57	42.49	-447.62	2.09	
2411.00	15.100	281.600	2352.96	473.32	46.99	-471.01	0.69	
2502.00	15.200	279.800	2440.80	497.03	51.40	-494.38	0.53	
2593.00	17.700	278.800	2528.07	522.76	55.55	-519.81	2.76	
2683.00	16.200	276.300	2614.16	548.99	59.02	-545.81	1.85	
2774.00	16.900	273.900	2701.39	574.90	61.31	-571.63	1.08	
2865.00	16.300	270.000	2788.60	600.80	62.21	-597.59	1.39	
2955.00	15.800	277.700	2875.10	625.61	63.85	-622.37	2.43	
3046.00	16.100	288.600	2962.62	650.33	69.54	-646.61	3.30	
3137.00	17.800	286.500	3049.66	676.36	77.51	-671.91	1.99	
3228.00	15.800	282.900	3136.78	702.37	84.23	-697.32	2.48	
3319.00	14.900	274.200	3224.54	726.37	87.86	-721.07	2.71	
3409.00	16.400	270.700	3311.20	750.58	88.86	-745.32	1.97	
3500.00	17.200	271.400	3398.32	776.77	89.34	-771.61	0.91	
3591.00	16.400	275.600	3485.44	803.02	90.93	-797.85	1.60	
3682.00	14.900	282.600	3573.07	827.50	94.73	-822.06	2.65	
3772.00	12.900	283.700	3660.43	848.97	99.64	-843.11	2.24	
3863.00	14.400	277.400	3748.86	870.36	103.50	-864.21	2.32	
3954.00	14.900	276.000	3836.90	893.37	106.18	-887.06	0.67	
4045.00	13.900	271.400	3925.05	915.96	107.67	-909.63	1.67	
4135.00	11.900	269.600	4012.77	935.95	107.87	-929.71	2.27	
4226.00	13.200	275.200	4101.60	955.65	108.75	-949.45	1.96	
4317.00	14.000	279.100	4190.05	977.03	111.43	-970.66	1.34	
4408.00	13.700	283.300	4278.40	998.73	115.65	-992.02	1.15	
4498.00	11.400	280.900	4366.25	1018.18	119.78	-1011.13	2.62	
4589.00	13.500	278.100	4455.10	1037.77	122.98	-1030.48	2.40	
4680.00	11.600	275.300	4543.93	1057.53	125.32	-1050.10	2.19	
4771.00	9.400	276.700	4633.40	1074.11	127.03	-1066.60	2.43	
4861.00	9.000	277.400	4722.24	1088.50	128.80	-1080.88	0.46	
4952.00	7.700	276.300	4812.27	1101.71	130.38	-1094.00	1.44	
5043.00	5.600	276.300	4902.66	1112.25	131.54	-1104.47	2.31	
5134.00	4.100	272.400	4993.33	1119.94	132.16	-1112.13	1.69	
5225.00	2.500	270.300	5084.17	1125.16	132.31	-1117.37	1.76	

5315.00	0.900	209.500	5174.14	1127.39	131.71	-1119.68	2.45
---------	-------	---------	---------	---------	--------	----------	------



Actual Wellpath Report

SWEETGRASS 10-14 AWP

Page 3 of 4



REFERENCE WELLPATH IDENTIFICATION

Operator	KERR MCGEE OIL & GAS ONSHORE LP	Slot	SLOT#06 SWEETGRASS 10-14 (1834'FSL & 872'FEL)
Area	COLORADO	Well	SWEETGRASS 10-14
Field	WELD COUNTY (KERR MCGEE)	Wellbore	SWEETGRASS 10-14 AWB
Facility	SEC.14-T1N-R68W		

WELLPATH DATA (86 stations)

MD [ft]	Inclination [°]	Azimuth [°]	TVD [ft]	Vert Sect [ft]	North [ft]	East [ft]	DLS [°/100ft]	Comments
5452.00	0.300	156.800	5311.13	1127.63	130.44	-1120.07	0.55	
5588.00	1.400	247.100	5447.11	1128.90	129.47	-1121.46	1.05	
5724.00	1.400	214.100	5583.08	1131.12	127.44	-1123.92	0.58	
5860.00	1.300	180.000	5719.04	1131.72	124.53	-1124.85	0.59	
5996.00	2.000	255.700	5855.00	1133.77	122.40	-1127.15	1.54	
6132.00	0.600	101.200	5990.97	1135.28	121.67	-1128.75	1.88	
6268.00	0.500	72.800	6126.97	1134.03	121.71	-1127.49	0.21	
6405.00	0.800	157.800	6263.96	1133.02	121.00	-1126.56	0.66	
6541.00	0.900	71.700	6399.95	1131.60	120.46	-1125.18	0.85	
6677.00	0.500	95.300	6535.94	1130.03	120.74	-1123.58	0.36	
6813.00	0.700	355.000	6671.94	1129.60	121.51	-1123.06	0.68	
6949.00	0.400	356.800	6807.93	1129.85	122.81	-1123.16	0.22	
7085.00	0.400	305.100	6943.93	1130.34	123.56	-1123.57	0.26	
7221.00	0.600	271.400	7079.92	1131.47	123.85	-1124.67	0.26	
7358.00	0.700	261.900	7216.91	1132.99	123.75	-1126.22	0.11	
7494.00	0.600	234.500	7352.90	1134.33	123.22	-1127.62	0.24	
7630.00	0.900	235.500	7488.89	1135.67	122.20	-1129.08	0.22	
7766.00	1.100	205.100	7624.87	1136.89	120.41	-1130.52	0.41	
7902.00	0.500	181.400	7760.86	1137.26	118.64	-1131.08	0.49	
8039.00	0.300	126.200	7897.86	1136.89	117.83	-1130.81	0.30	
8175.00	0.700	178.900	8033.85	1136.48	116.79	-1130.51	0.42	
8311.00	0.400	201.400	8169.85	1136.49	115.51	-1130.66	0.27	
8447.00	0.300	142.400	8305.84	1136.37	114.79	-1130.62	0.26	
8584.00	1.000	129.400	8442.83	1135.11	113.75	-1129.48	0.52	
8755.00	1.000	141.000	8613.81	1132.80	111.64	-1127.38	0.12	LAST BHI MWD SURVEY
8805.00	1.000	141.000	8663.80	1132.18	110.96	-1126.84	0.00	PROJECTION TO BIT

HOLE & CASING SECTIONS - Ref Wellbore: SWEETGRASS 10-14 AWB Ref Wellpath: SWEETGRASS 10-14 AWP

String/Diameter	Start MD [ft]	End MD [ft]	Interval [ft]	Start TVD [ft]	End TVD [ft]	Start N/S [ft]	Start E/W [ft]	End N/S [ft]	End E/W [ft]
12.25in Open Hole	15.00	1196.00	1181.00	15.00	1182.96	0.00	0.00	8.72	-147.61
8.625in Casing Surface	15.00	1196.00	1181.00	15.00	1182.96	0.00	0.00	8.72	-147.61
7.875in Open Hole	1196.00	8805.00	7609.00	1182.96	8663.80	8.72	-147.61	110.96	-1126.84

TARGETS

Name	MD [ft]	TVD [ft]	North [ft]	East [ft]	Grid East [US ft]	Grid North [US ft]	Latitude	Longitude	Shape
SWEETGRASS 10-14 GEO TARGET 50' RADIUS (1980'FSL & 1980'FEL, REV-1)		6000.00	124.59	-1108.61	3148855.83	1261347.29	40°02'58.423"N	104°58'05.786"W	circle
SWEETGRASS 10-14 LEGAL BOX (229'S,171'N,202'W,198'E OF GEO TARGET)		6000.00	95.61	-1110.65	3148853.97	1261318.30	40°02'58.137"N	104°58'05.812"W	square

WELLPATH COMPOSITION - Ref Wellbore: SWEETGRASS 10-14 AWB Ref Wellpath: SWEETGRASS 10-14 AWP

Start MD [ft]	End MD [ft]	Positional Uncertainty Model	Log Name/Comment	Wellbore
15.00	8755.00	NaviTrak (Standard)	BHI MWD SURVEYS <150-8755>	SWEETGRASS 10-14 AWB
8755.00	8805.00	Blind Drilling (std)	Projection to bit	SWEETGRASS 10-14 AWB



Actual Wellpath Report

SWEETGRASS 10-14 AWP

Page 4 of 4



REFERENCE WELLPATH IDENTIFICATION

Operator	KERR MCGEE OIL & GAS ONSHORE LP	Slot	SLOT#06 SWEETGRASS 10-14 (1834'FSL & 872'FEL)
Area	COLORADO	Well	SWEETGRASS 10-14
Field	WELD COUNTY (KERR MCGEE)	Wellbore	SWEETGRASS 10-14 AWB
Facility	SEC.14-T1N-R68W		

WELLPATH COMMENTS

MD [ft]	Inclination [°]	Azimuth [°]	TVD [ft]	Comment
8755.00	1.000	141.000	8613.81	LAST BHI MWD SURVEY
8805.00	1.000	141.000	8663.80	PROJECTION TO BIT