

Encana OIL & GAS (USA) INC.
WELL PAD 004 696
LOCATED IN GARFIELD COUNTY, COLORADO
SECTION 4, T6S, R96W, 6th P.M.

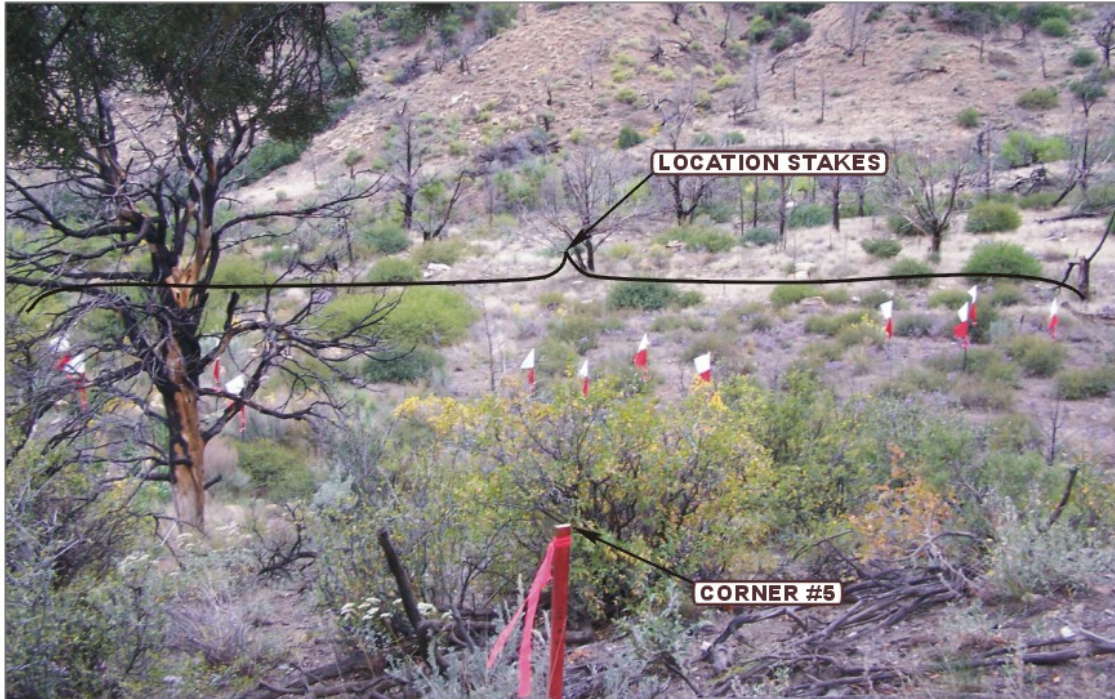

PHOTO: VIEW FROM CORNER #1 TO LOCATION STAKES

CAMERA ANGLE: NORTHWESTERLY



PHOTO: VIEW FROM BEGINNING OF PROPOSED ACCESS

CAMERA ANGLE: EASTERLY



UELS Uintah Engineering & Land Surveying
85 South 200 East Vernal, Utah 84078
(435) 789-1017 * FAX (435) 789-1813

LOCATION PHOTOS

10 **2** **06**
MONTH DAY YEAR

TAKEN BY: B.H. DRAWN BY: J.L.G. REVISED: 07-06-11

PHOTO
P1

Encana OIL & GAS (USA) INC.
WELL PAD 004 696
LOCATED IN GARFIELD COUNTY, COLORADO
SECTION 4, T6S, R96W, 6th P.M.



PHOTO: VIEW OF LOCATION STAKES

CAMERA ANGLE: NORTHERLY



PHOTO: VIEW OF LOCATION STAKES

CAMERA ANGLE: EASTERLY



- Since 1964 -

UELS Uintah Engineering & Land Surveying
85 South 200 East Vernal, Utah 84078
(435) 789-1017 * FAX (435) 789-1813

LOCATION PHOTOS

10
MONTH

2
DAY

06
YEAR

TAKEN BY: B.H.

DRAWN BY: J.L.G.

REVISED: 07-06-11

PHOTO
P2

Encana OIL & GAS (USA) INC.

WELL PAD 004 696

LOCATED IN GARFIELD COUNTY, COLORADO

SECTION 4, T6S, R96W, 6th P.M.



PHOTO: VIEW OF LOCATION STAKES

CAMERA ANGLE: SOUTHERLY



PHOTO: VIEW OF LOCATION STAKES

CAMERA ANGLE: WESTERLY



- Since 1964 -

UELS

Uintah Engineering & Land Surveying
85 South 200 East Vernal, Utah 84078
(435) 789-1017 * FAX (435) 789-1813

LOCATION PHOTOS

10
MONTH

2
DAY

06
YEAR

TAKEN BY: B.H.

DRAWN BY: J.L.G.

REVISED: 07-06-11

PHOTO
P3