

PROPOSED PAD LAYOUT GRIMM 34-4M

SECTION 34, TOWNSHIP 4 SOUTH, RANGE 64 WEST OF THE 6TH PRINCIPAL MERIDIAN

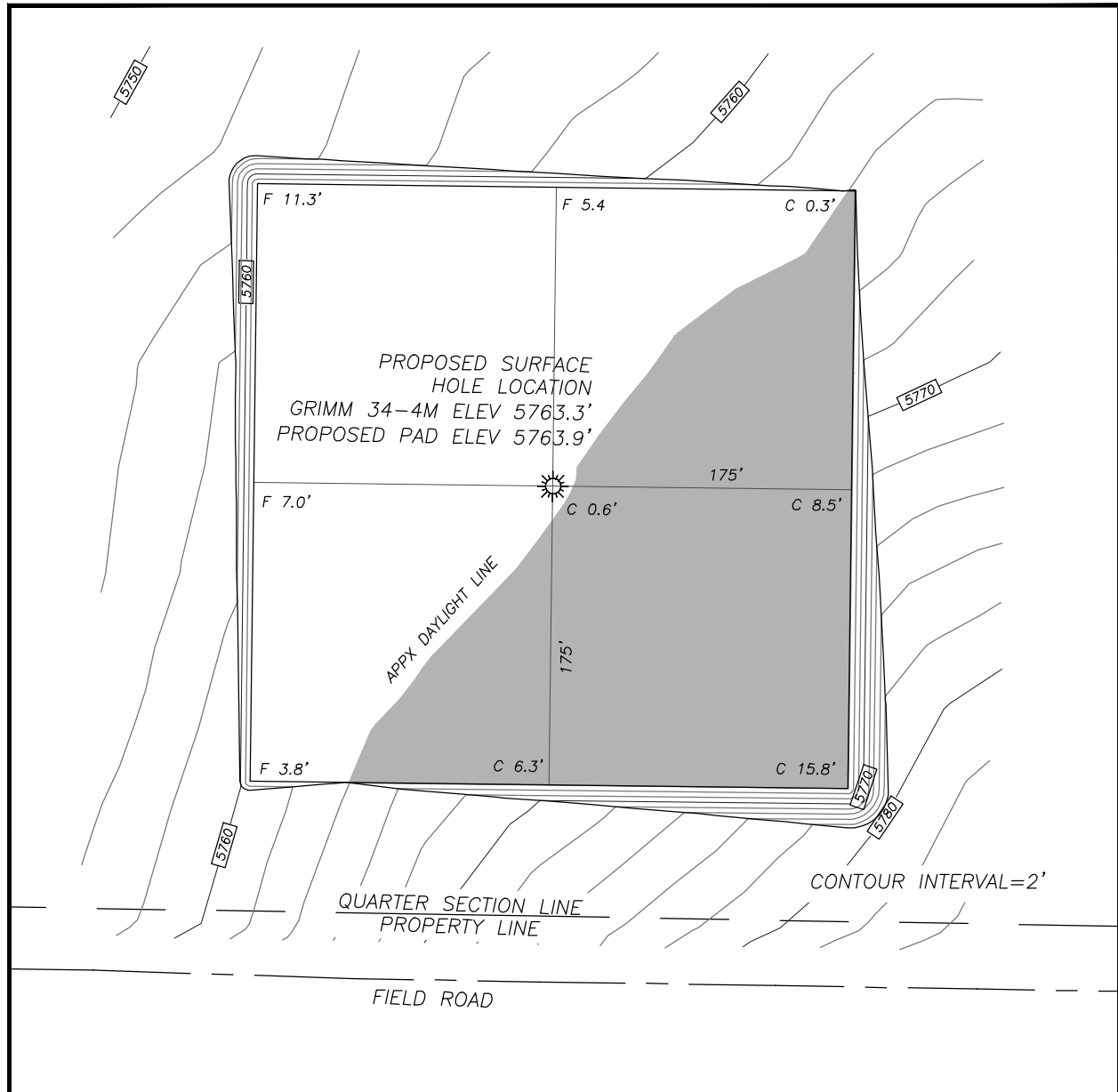

GRIMM 34-4M PAD

Top of pad elevation: 5763.9'

Cut slope ratio: 1.50

Fill slope ratio: 1.50

Cut Swell Factor: 1.00

Fill Shrink Factor: 1.00

Pad Earthwork Volumes

Total cut: 11,877 C.Y.

Total fill: 10,377 C.Y.

Balance Export: 1,500 C.Y. (Topsoil)

Area: 3.2 Acres

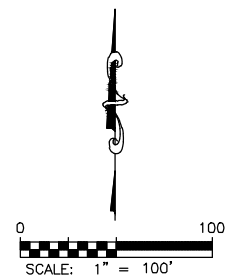

PROPOSED PAD CROSS SECTIONS GRIMM 34-4M
SECTION 34, TOWNSHIP 4 SOUTH, RANGE 64 WEST OF THE 6TH PRINCIPAL MERIDIAN

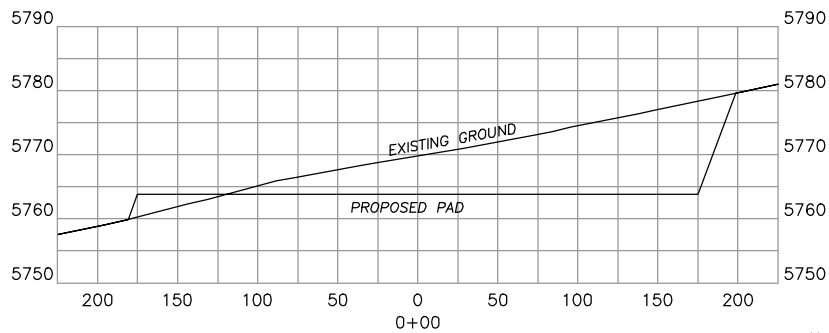
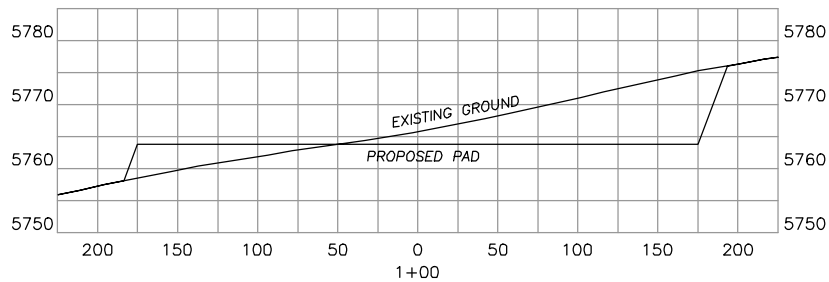
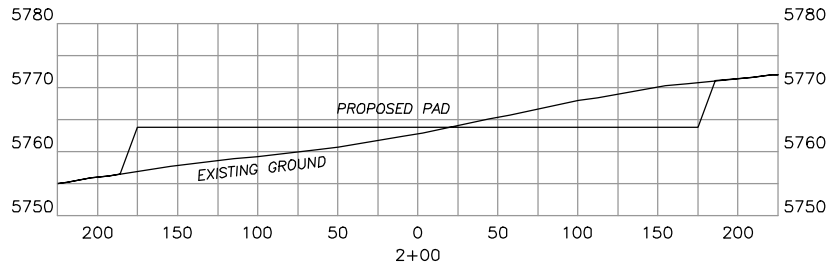
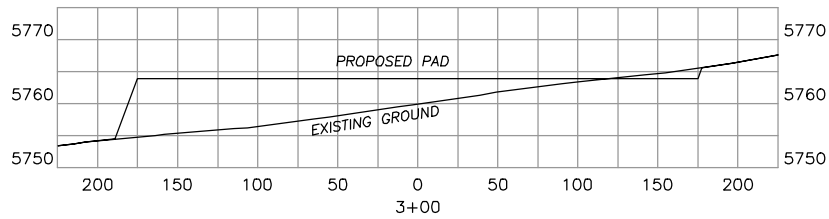
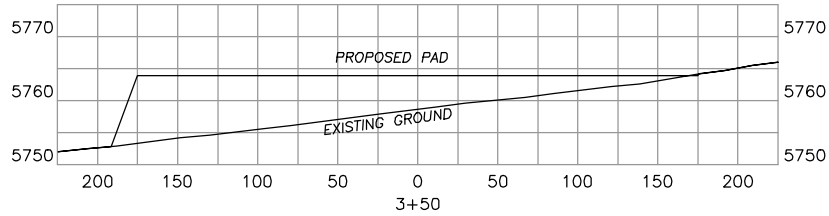

Horizontal Scale 20
Vertical Scale 5

PROPOSED RIG LAYOUT GRIMM 34-4M

SECTION 34, TOWNSHIP 4 SOUTH, RANGE 64 WEST OF THE 6TH PRINCIPAL MERIDIAN

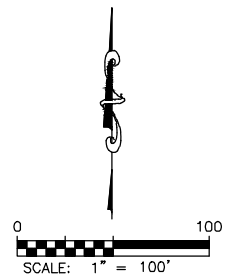
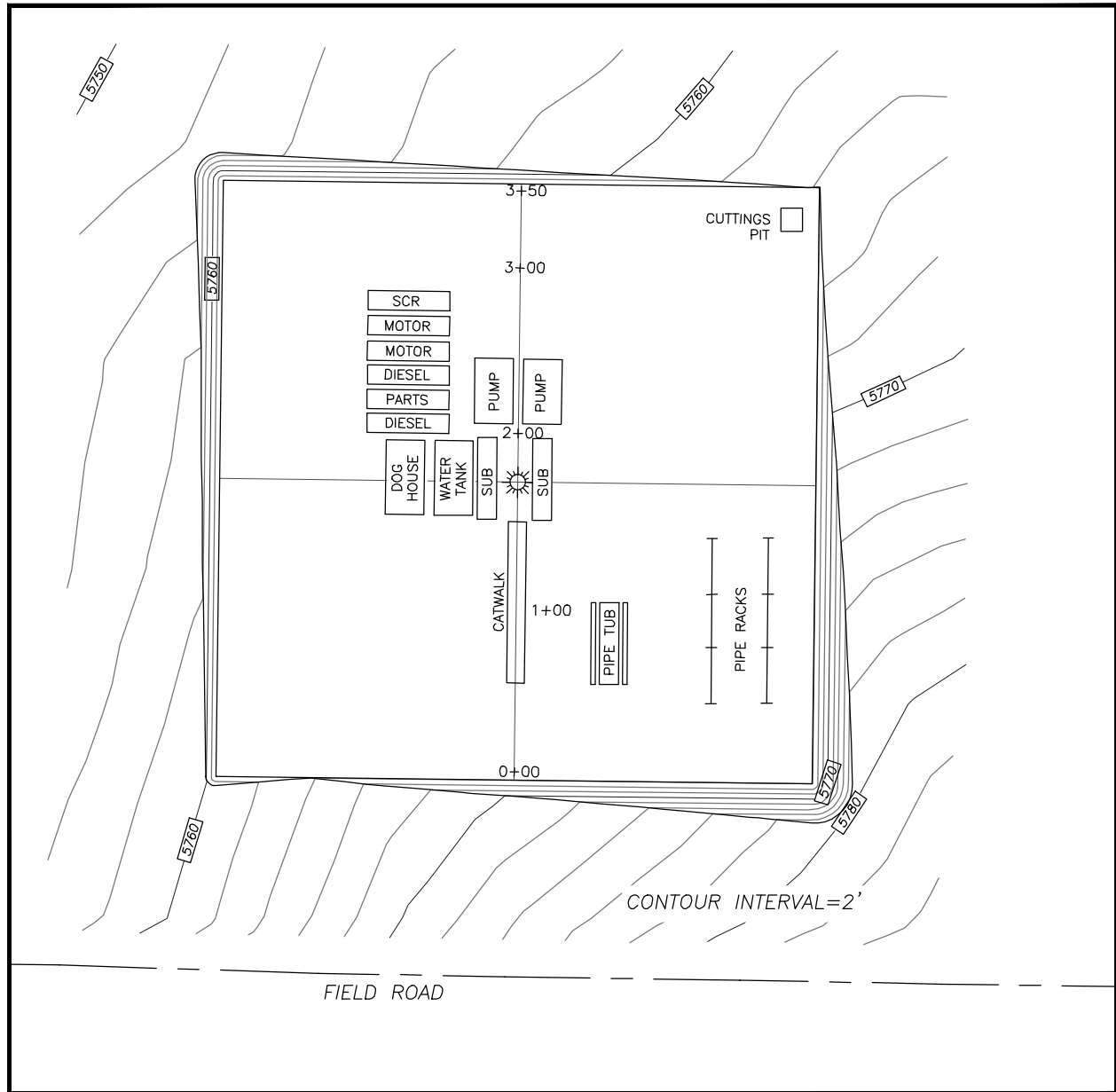

PROPOSED RECLAMATION DIAGRAM GRIMM 34-4M

SECTION 34, TOWNSHIP 4 SOUTH, RANGE 64 WEST OF THE 6TH PRINCIPAL MERIDIAN

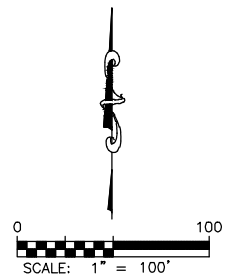
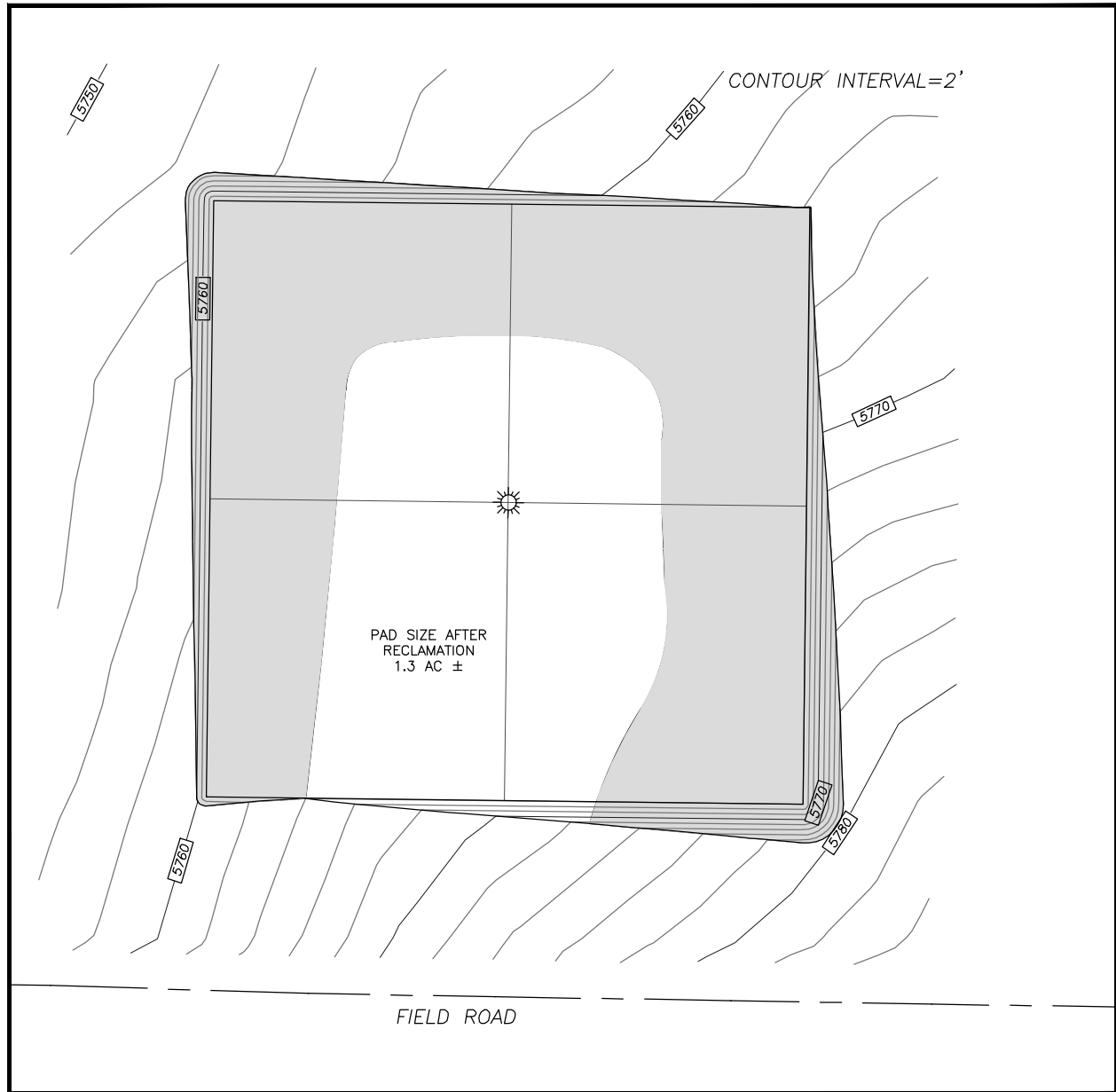

DALEY LAND SURVEYING, INC.

PARKER, CO. 80134

303 953 9841

LOCATION DRAWING GRIMM 34-4M

SECTION 34, TOWNSHIP 4 SOUTH, RANGE 64 WEST OF THE 6TH PRINCIPAL MERIDIAN



IMPROVEMENTS

1. WIRE FENCE: 270'± S
2. FIELD ROAD: 290'± S

DISTANCE TO NEAREST:

BUILDING:	2400'± E
PUBLIC ROAD:	4500'± NE
ABOVE GRND UTILITY:	3440'± NE
RAILROAD:	5280'+
PROP. LINE:	252'± S