

From: Stanczyk, Jane
Sent: Friday, February 05, 2010 1:21 PM
To: 'Craig, Jack'; 'Rick Hutton'
Cc: Andrews, David; Baldwin, Debbie; Canfield, Chris; Fischer, Alex; Halstead, Mary; Harmon, Carol; Kate Fay (kcfay@smtpgate.dphe.state.co.us); King, Kevin; Krabacher, Jay; Kubeczko, Dave; Luke Danielson (luke@ldanielsonlaw.com); Neslin, David; Willis, Rob; Yokley, Bill
Subject: Noble refiles in Project Rulison 3 mile area
Attachments: Project Rulison Noble APDs 6-12-2008.xls

Noble has submitted refile permit applications for all 14 wells on a pad in the SWSE Section 34 7S 95W. The surface location is approximately 2.05 miles from the project well in Tier 2 of the Project Rulison SAP. The BHLs range from 1.82 to 2.16 miles from the project well in Tier 2 and Sectors 8 and 9 of the Project Rulison SAP. The surface and the minerals are fee for all the wells. The permit packets contain a letter from Noble to Jack dated Dec. 9, 2009. The well list spread sheet is attached. Please let me know if you need any additional information.

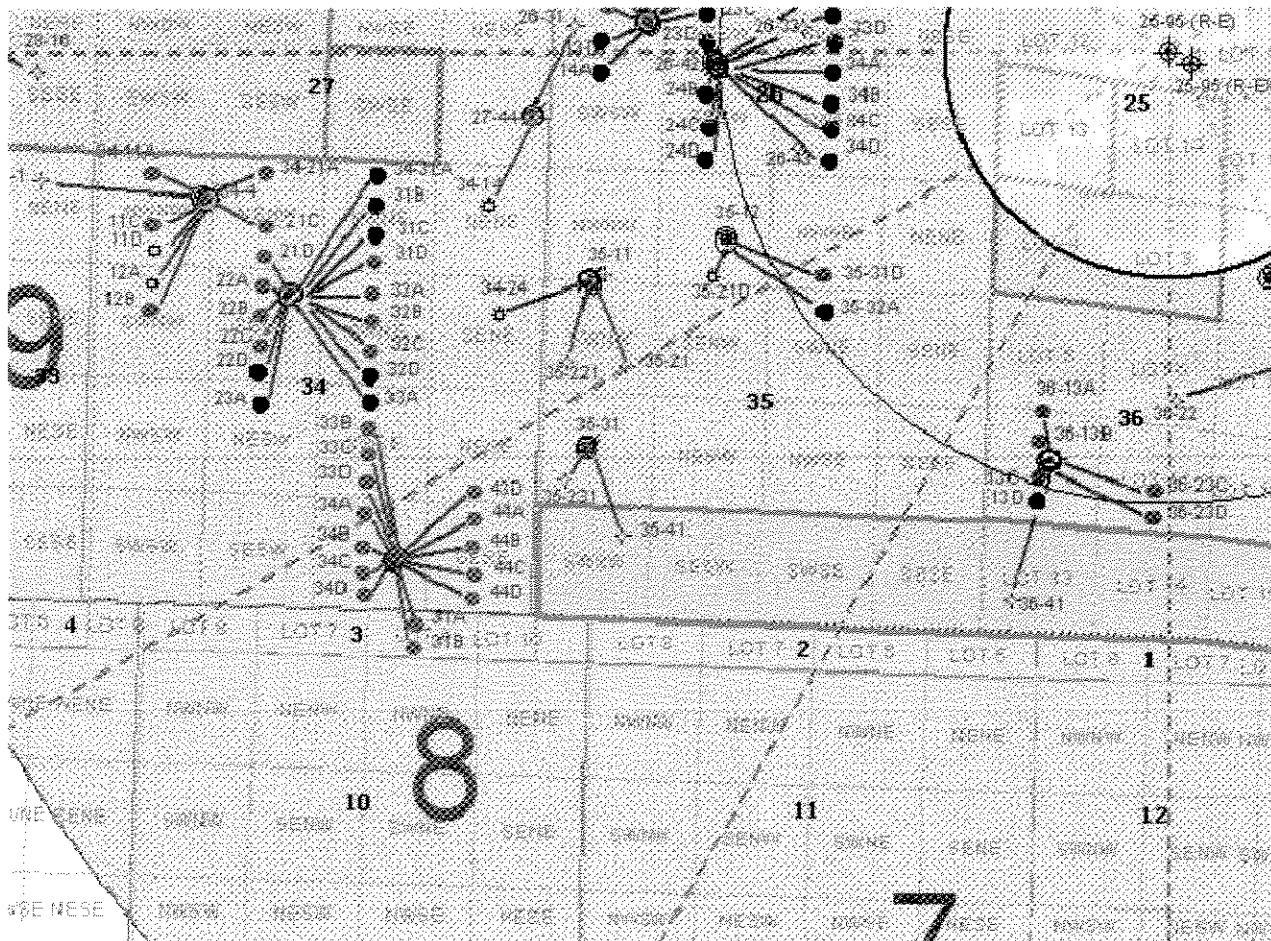

CORRESPONDENCE

Stanczyk, Jane

From: Craig, Jack [Jack.Craig@lm.doe.gov]
Sent: Wednesday, February 17, 2010 8:01 AM
To: Stanczyk, Jane
Cc: Hutton, Rick
Subject: APD's - Noble

Jane:

The Office of Legacy Management (LM) is reviewing aforementioned refile permit applications and the location map provided by COGCC for the following wells and their respective locations:

API #	APDs IN PROCESSING	BOTTOM HOLE LOCATION
05-045- Refile OPERATOR	WELL NAME	WELL # LOCATION N
LATITUDE W LONGITUDE		
95W 39.386335 107.978918	NOBLE	BATTLEMENT MESA 3-31A SWSE 34 7S
95W 39.385644 107.978893	NOBLE	BATTLEMENT MESA 3-31B SWSE 34 7S
39.392615 107.981251	NOBLE	BATTLEMENT MESA 34-33B SWSE 34 7S 95W
39.391702 107.981219	NOBLE	BATTLEMENT MESA 34-33C SWSE 34 7S 95W
39.390769 107.981212	NOBLE	BATTLEMENT MESA 34-33D SWSE 34 7S 95W
39.389854 107.98123	NOBLE	BATTLEMENT MESA 34-34A SWSE 34 7S 95W
39.388959 107.981248	NOBLE	BATTLEMENT MESA 34-34B SWSE 34 7S 95W
39.388046 107.981216	NOBLE	BATTLEMENT MESA 34-34C SWSE 34 7S 95W
39.38721 107.981212	NOBLE	BATTLEMENT MESA 34-34D SWSE 34 7S 95W
39.390693 107.976587	NOBLE	BATTLEMENT MESA 34-43D SWSE 34 7S 95W
39.389802 107.976551	NOBLE	BATTLEMENT MESA 34-44A SWSE 34 7S 95W
39.388883 107.976559	NOBLE	BATTLEMENT MESA 34-44B SWSE 34 7S 95W
39.387998 107.976559	NOBLE	BATTLEMENT MESA 34-44C SWSE 34 7S 95W
39.387127 107.976581	NOBLE	BATTLEMENT MESA 34-44D SWSE 34 7S 95W

At this time, DOE does not request any additional information but would encourage COGCC to place general language in the permit such that the company would accommodate DOE sampling requests in the future. DOE agrees with the COGCC assessment that the pad is located approximately 2.05 miles from the Rulison site located at SWSE Section 34 7S 95W, and the bottom-hole-locations range approximately from 1.82 to 2.16 miles from Project Rulison. Accordingly, DOE agrees with COGCC that all wells fall under the Tier 2 sampling and monitoring of the COGCC Rulison Sample and Analysis Plan and one well is located in Sectors 8

and of the Rulison SAP. DOE will continue to review the proposed locations and subsurface orientations of the propose drilling for documentation when sampling occurs. Thank you for the opportunity to comment on these permit applications. Please e-mail or call at 240-252-8506 if you require further information.

Jack