

EOG RESOURCES, INC.

CONSTRUCTION LAYOUT FOR

GARDEN CREEK #11-18H
SECTION 18, T11N, R62W, 6th P.M.
600' FSL 600' FEL

FIGURE #1

SCALE: 1" = 60'
DATE: 01-05-10
DRAWN BY: K.G.

Proposed Access Road

AREA OF MAX. DISTURBANCE

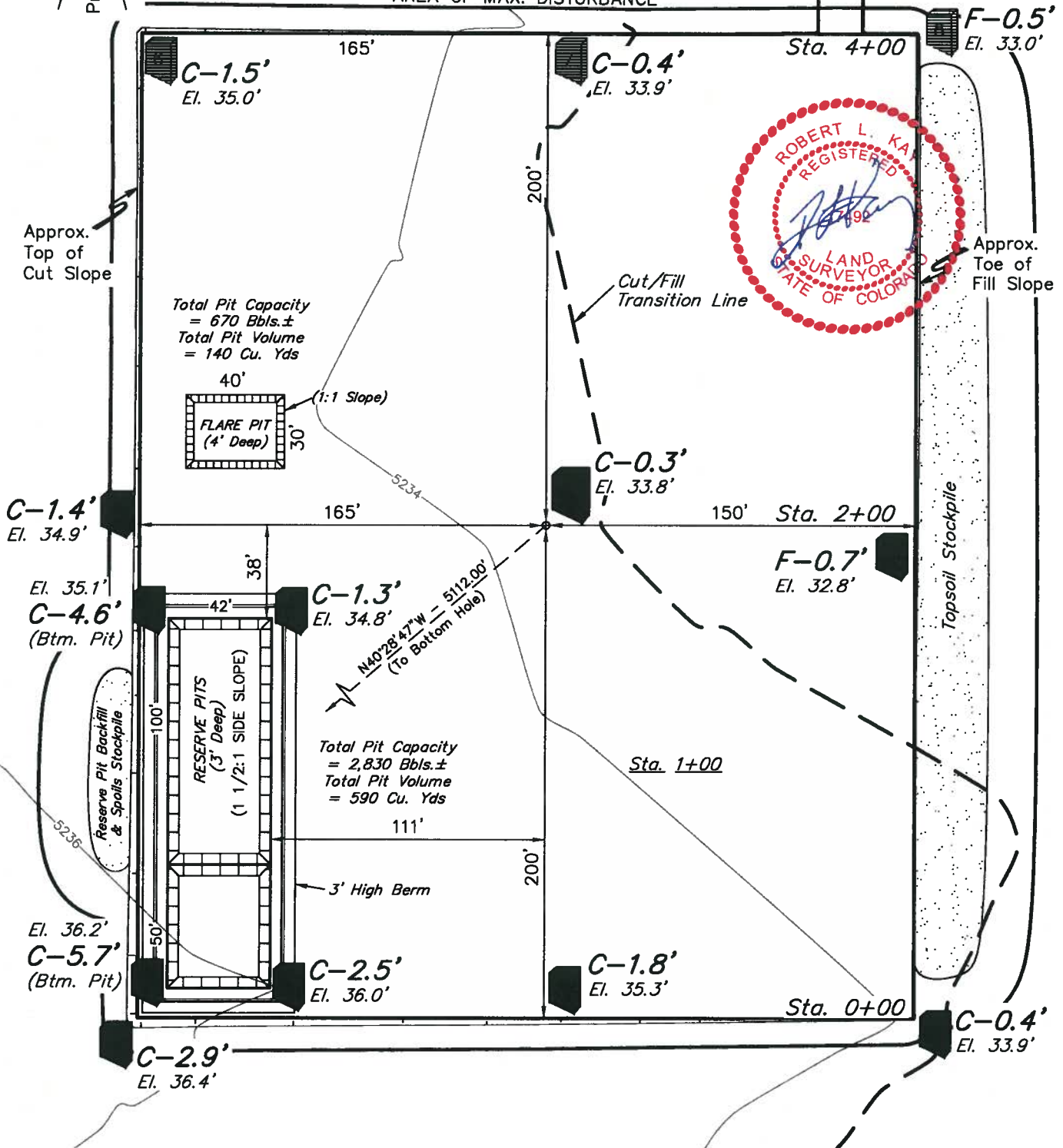
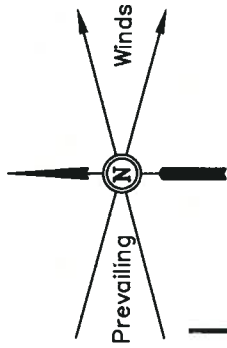

Elev. Ungraded Ground At Loc. Stake = 5233.8'
FINISHED GRADE ELEV. AT LOC. STAKE = 5233.5'

UINTAH ENGINEERING & LAND SURVEYING
85 So. 200 East * Vernal, Utah 84078 * (435) 789-1017

EOG RESOURCES, INC.

FIGURE #2

CONSTRUCTION LAYOUT CROSS SECTION FOR GARDEN CREEK #11-18H SECTION 18, T11N, R62W, 6th P.M. 600' FSL 600' FEL

1" = 40'
X-Section
Scale
1" = 100'
DATE: 01-05-10
DRAWN BY: K.G.

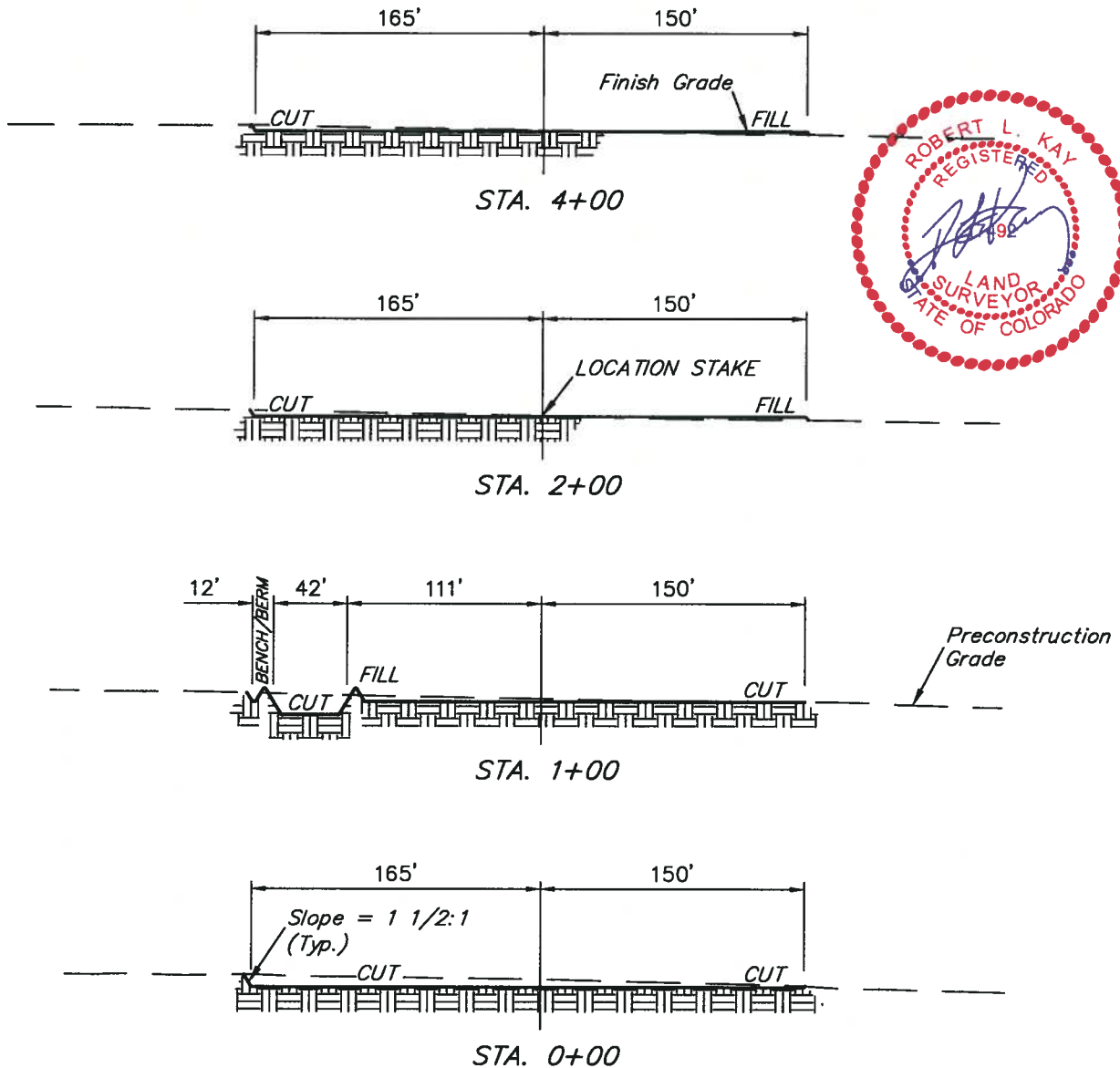

NOTE:

Topsoil should not be Stripped Below Finished Grade on Substructure Area.

APPROXIMATE ACREAGES
WELL SITE DISTURBANCE = ± 3.697 ACRES
ACCESS ROAD DISTURBANCE = ± 0.268 ACRES
TOTAL = ± 3.965 ACRES

* NOTE:
FILL QUANTITY INCLUDES 5% FOR COMPACTION

APPROXIMATE YARDAGES

(6") Topsoil Stripping = 2,400 Cu. Yds.
Remaining Location = 2,000 Cu. Yds.
TOTAL CUT = 4,400 CU.YDS.
FILL = 1,700 CU.YDS.

EXCESS MATERIAL = 2,700 Cu. Yds.
Topsoil & Pit Backfill = 2,700 Cu. Yds.
(1/2 Pit Vol.)
EXCESS UNBALANCE = 0 Cu. Yds.
(After Interim Rehabilitation)

UINTAH ENGINEERING & LAND SURVEYING
85 So. 200 East * Vernal, Utah 84078 * (435) 789-1017

EOG RESOURCES, INC.

TYPICAL RIG LAYOUT FOR

GARDEN CREEK #11-18H
SECTION 18, T11N, R62W, 6th P.M.
600' FSL 600' FEL

FIGURE #3



SCALE: 1" = 60'
DATE: 01-05-10
DRAWN BY: K.G.

Proposed
Access Road

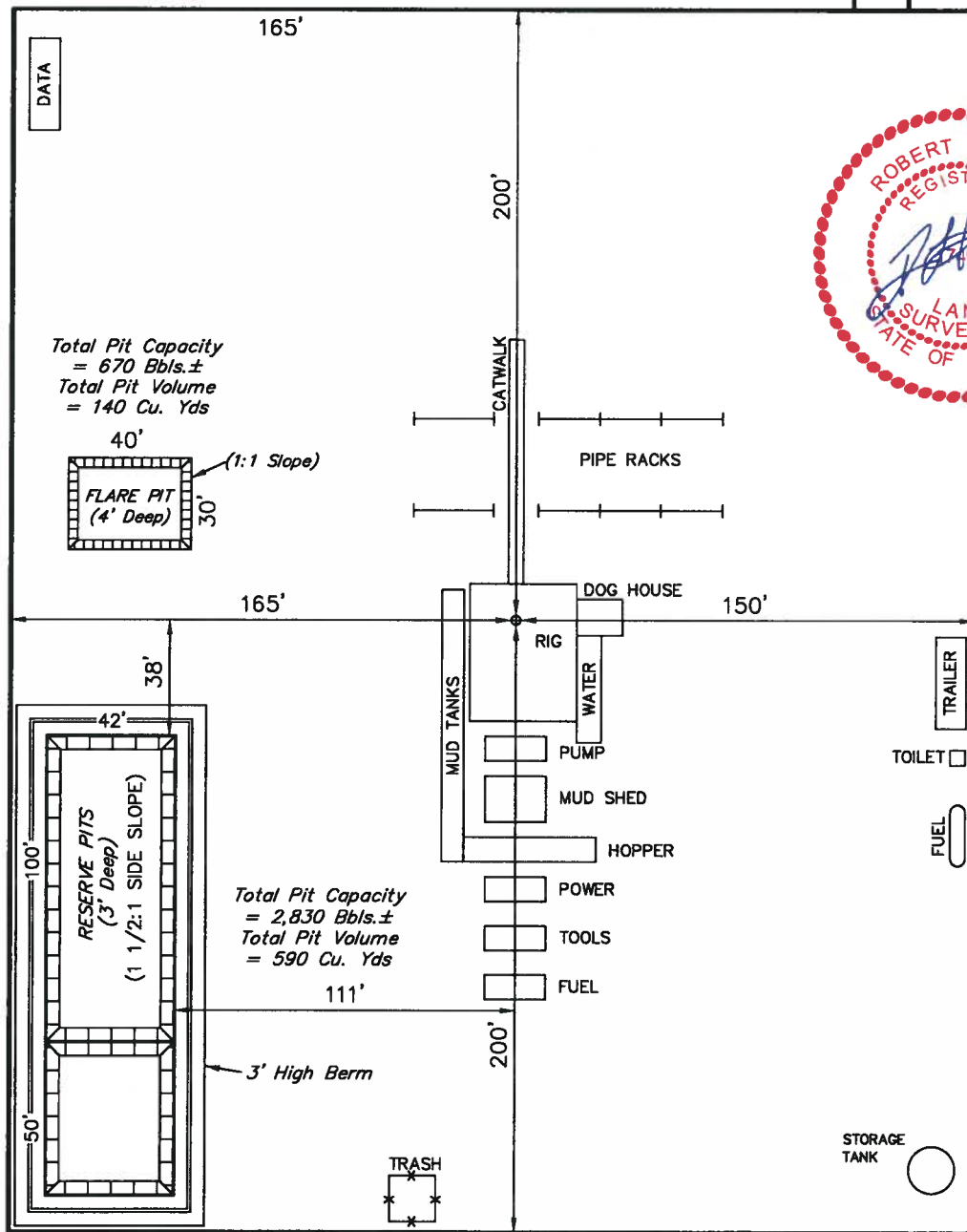



SCALE: 1" = 60'
DATE: 01-05-10
DRAWN BY: K.G.

EOG RESOURCES, INC.

RECLAMATION DIAGRAM FOR

GARDEN CREEK #11-18H
SECTION 18, T11N, R62W, 6th P.M.
600' FSL 600' FEL

FIGURE #4

Access Road

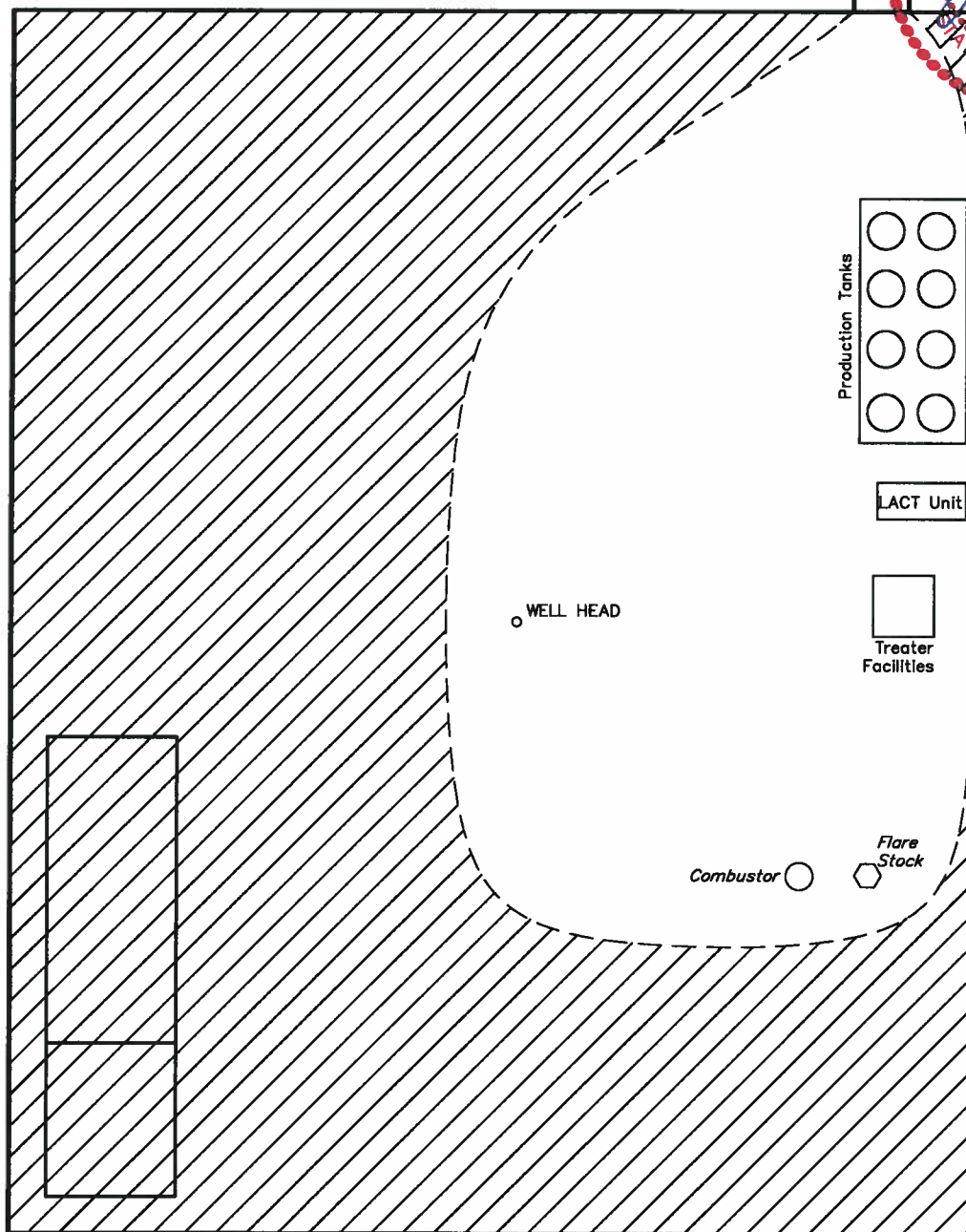

APPROXIMATE ACREAGES
WELL SITE DISTURBANCE = ± 1.007 ACRES



RE-HABBED AREA

UINTAH ENGINEERING & LAND SURVEYING
85 So. 200 East * Vernal, Utah 84078 * (435) 789-1017