

Correspondence

**Stanczyk, Jane**

---

**From:** Craig, Jack [Jack.Craig@lm.doe.gov]  
**Sent:** Thursday, November 19, 2009 8:01 AM  
**To:** Stanczyk, Jane  
**Cc:** Hutton, Rick  
**Subject:** Noble APDs - Rulison

Jane:

The Office of Legacy Management (LM) is reviewing aforementioned applications and the location map provided by COGCC for the following wells and their respective locations:

| APDs IN PROCESSING                                 | BOTTOM HOLE LOCATION |
|--|----------------------|
| EFORM  |                      |
| WELL NAME  | WELL # LOCATION N    |
| LATITUDE W LONGITUDE QQ SEC T R                    | DOCUMENT #           |
| RULISON FEDERAL 19-34ANESE SEC 19 7S 94W 39.420471 |                      |
| 107.925463 SWSE 19 7 94 400011296                  |                      |
| RULISON FEDERAL 19-34BNESE SEC 19 7S 94W 39.419628 |                      |
| 107.925491 SWSE 19 7 94 400011297                  |                      |
| RULISON FEDERAL 19-34CNESE SEC 19 7S 94W 39.418705 |                      |
| 107.925453 SWSE 19 7 94 400011298                  |                      |
| RULISON FEDERAL 19-43BNESE SEC 19 7S 94W 39.423196 | 107.9222             |
| NESE 19 7 94 400011299                             |                      |
| RULISON FEDERAL 19-43CNESE SEC 19 7S 94W 39.422326 |                      |
| 107.922198 NESE 19 7 94 400011300                  |                      |
| RULISON FEDERAL 19-43DNESE SEC 19 7S 94W 39.421441 | 107.9222             |
| NESE 19 7 94 400011301                             |                      |
| RULISON FEDERAL 19-44ANESE SEC 19 7S 94W 39.420455 |                      |
| 107.921549 SESE 19 7 94 400011302                  |                      |
| RULISON FEDERAL 20-14ANESE SEC 19 7S 94W 39.420526 |                      |
| 107.917027 SWSW 20 7 94 400011306                  |                      |
| LONG 20-13BNESE SEC 19 7S 94W 39.423248            |                      |
| 107.91706 NWSW 20 7 94 400011303                   |                      |
| LONG 20-13CNESE SEC 19 7S 94W 39.422344            |                      |
| 107.917054 NWSW 20 7 94 400011304                  |                      |
| LONG 20-13DNESE SEC 19 7S 94W 39.42143             |                      |
| 107.917022 NWSW 20 7 94 400011305                  |                      |
| DOGHEAD 19-33CNESE SEC 19 7S 94W 39.422325         |                      |
| 107.92388 NWSE 19 7 94 400011290                   |                      |
| DOGHEAD 19-33DNESE SEC 19 7S 94W 39.421479         |                      |
| 107.912879 NWSE 19 7 94 400011294                  |                      |

At this time, DOE does not request any additional information but would encourage COGCC to place general language in the permit such that the company would accommodate DOE sampling requests in the future. DOE agrees with the COGCC assessment that the pad is located approximately

1.9 miles from the Rulison site at the NESE of Section 19 7S 94W, and the bottom-hole-locations range approximately from 1.5 to 2.1 miles from Project Rulison. Accordingly, DOE agrees with COGCC that all wells fall under the Tier 2 sampling and monitoring of the COGCC Rulison Sample and Analysis Plan and are located in Sector 2 or 3 of the Rulison SAP. DOE will continue to review the proposed locations and subsurface orientations of the propose drilling for documentation when sampling occurs. Thank you for the opportunity to comment on these permit applications. Please e-mail or call at 240-252-8506 if you require further information.

Sincerely

Jack Craig

---

## Stanczyk, Jane

---

**From:** Stanczyk, Jane  
**Sent:** Tuesday, November 17, 2009 9:01 AM  
**To:** 'Rick Hutton'; 'Craig, Jack'  
**Cc:** Neslin, David; Willis, Rob; Ahlstrand, Dennis; Yokley, Bill; Andrews, David; Krabacher, Jay; King, Kevin; Halstead, Mary; Kubeczko, Dave; Fischer, Alex; Canfield, Chris; Baldwin, Debbie; 'Kate Fay'; 'luke@ldanielsonlaw.com'  
**Subject:** Noble permits in Project Rulison NESE Sec 19 7S 94W  
**Attachments:** Project Rulison NOBLE APDs Sec 19 11-17-09.xls

Jack and Rick

Noble has submitted permits for a new pad in the Project Rulison 3 mile area.

The surface location is in the NESE Section 19 7S 94W, approximately 1.9 miles from the project well.

There are permits for 13 wells with bottom hole locations in Sections 19 and 20 7S 94W, approximately 1.5 to 2.1 miles from the project well.

All the wells are in Tier 2 of the Project Rulison Sampling and Analysis Plan.

Twelve (12) of the wells are in Sector 2 and one well, the 20-14A is very close to the line between Sectors 2 & 3.

The permits include a letter from Noble to Jack dated October 30, 2009.

The well list spreadsheet is attached.

Please let me know if you need any additional information.

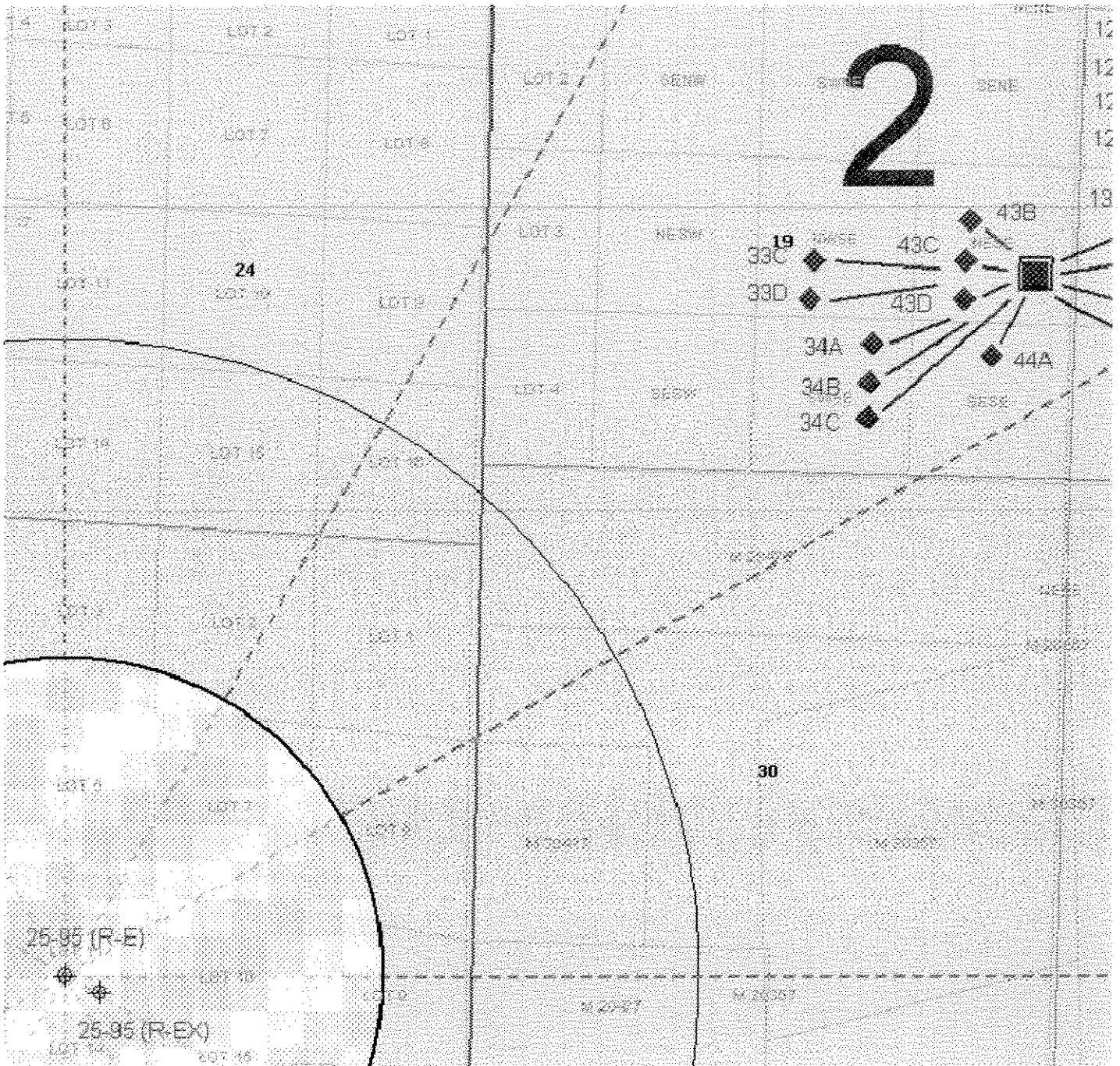

Jane Stanczyk  
 Permitting Technician  
 Colorado Oil and Gas Conservation Commission  
 Phone: (303) 894 2100 ext.5119  
 FAX: (303) 894 2109  
 E-mail: [jane.stanczyk@state.co.us](mailto:jane.stanczyk@state.co.us)