

BEFORE THE OIL AND GAS CONSERVATION COMMISSION  
OF THE STATE OF COLORADO

IN THE MATTER OF THE PROMULGATION ) CAUSE NO.  
AND ESTABLISHMENT OF FIELD RULES )  
TO GOVERN OPERATIONS FOR THE ) DOCKET NO.  
NIOBRARA FORMATION, WATTENBERG )  
FIELD, WELD COUNTY, COLORADO ) TYPE: POOLING

APPLICATION

PDC Energy, Inc. (Operator No. 69175) ("PDC"), by and through its attorneys, Burns, Figa, & Will, P.C., respectfully submits this Application to the Oil and Gas Conservation Commission of the State of Colorado (the "Commission") for an order to amend Order No. 407-1838 to apply only to the as-drilled acreage for the J Klein 7Y-241 Well (API No. 05-123-43003) ("Well"), which consists of the following lands:

Township 5 North, Range 64 West, 6<sup>th</sup> P.M.

Section 5: SW $\frac{1}{4}$ SW $\frac{1}{4}$

Section 6: E $\frac{1}{2}$ E $\frac{1}{2}$

Section 7: E $\frac{1}{2}$ E $\frac{1}{2}$

Section 8: NW $\frac{1}{4}$ SW $\frac{1}{4}$ , W $\frac{1}{2}$ NW $\frac{1}{4}$

Weld County, Colorado, containing 481.48 acres ("Application Lands")

In support of its Application, PDC states and alleges as follows:

1. PDC is a corporation duly authorized to do business in Colorado and is registered as an operator in good standing with the Commission.
2. PDC is an Owner with the right to drill into and produce from the Application Lands.
3. On April 27, 1998, the Commission adopted Rule 318A, the Greater Wattenberg Area Special Well Location, Spacing and Unit Designation Rule. Sections 5, 6, 7, and 8, Township 5 North, Range 64 West, 6<sup>th</sup> P.M., are subject to this Rule for the Niobrara Formation.
4. On February 19, 1992, the Commission entered Order No. 407-87 (amended August 20, 1993) which, among other things, established 80-acre drilling and spacing units for the production of oil, gas, and associated hydrocarbons from the Codell-Niobrara Formations, the Codell Formation, and the Niobrara Formation underlying certain lands, including Sections 5, 6, 7, and 8, Township 5 North, Range 64 West, 6<sup>th</sup> P.M., with the permitted well locations in accordance with the provisions of Order 407-1.
5. On December 15, 2014, the Commission entered Order No. 407-1182, which, among other things, pooled all non-consenting interests in an approximate 160-

acre drilling and spacing unit for the SW $\frac{1}{4}$  of Section 5, Township 5 North, Range 64 West, 6<sup>th</sup> P.M., for the LDS B05-25 Well (API No. 05-123-34204), from the Codell and Niobrara Formations. Order No. 407-1182 is not affected by this Application, and proceeds from any shared lands will be accounted for in the production of the Well.

6. On October 24, 2016, the Commission entered Order No. 407-1821, which, among other things, pooled all non-consenting interests in four approximate 720-acre wellbore spacing units for the W $\frac{1}{2}$  of Section 6 and W $\frac{1}{2}$  of Section 7, Township 5 North, Range 64 West, 6<sup>th</sup> P.M., and the S $\frac{1}{2}$ SW $\frac{1}{4}$  of Section 31, Township 6 North, Range 64 West, 6<sup>th</sup> P.M., for the Dunn 7L-201 Well (API No. 05-123-42830), the Dunn 7L-221 Well (API No. 05-123-42827), the Dunn 7L-301 Well (API No. 05-123-42825), the Dunn 7L-341 Well (API No. 05-123-42832), from the Niobrara Formation. Order No. 407-1821 is not affected by this Application, and proceeds from any shared lands will be accounted for in the production of the Well.

7. Also on October 24, 2016, the Commission entered Order No. 407-1823, which, among other things, pooled all non-consenting interests in an approximate 640-acre wellbore spacing unit for the S $\frac{1}{2}$ S $\frac{1}{2}$  of Section 7, S $\frac{1}{2}$ S $\frac{1}{2}$  of Section 8, N $\frac{1}{2}$ N $\frac{1}{2}$  of Section 17, and the N $\frac{1}{2}$ N $\frac{1}{2}$  of Section 18, Township 5 North, Range 64 West, 6<sup>th</sup> P.M., for the HOP 18E-232 Well (API No. 05-123-43160), from the Niobrara Formation. Order No. 407-1823 is not affected by this Application, and proceeds from any shared lands will be accounted for in the production of the Well.

8. On December 12, 2016, the Commission entered Order No. 407-1837, which, among other things, pooled all non-consenting interests in two approximate 720-acre wellbore spacing units for the W $\frac{1}{2}$ W $\frac{1}{2}$  of Section 5, E $\frac{1}{2}$ E $\frac{1}{2}$  of Section 6, E $\frac{1}{2}$ E $\frac{1}{2}$  of Section 7, and the W $\frac{1}{2}$ W $\frac{1}{2}$  of Section 8, Township 5 North, Range 64 West, 6<sup>th</sup> P.M., and the SE $\frac{1}{4}$ SE $\frac{1}{4}$  of Section 31 and the SW $\frac{1}{4}$ SW $\frac{1}{4}$  of Section 32, Township 6 North, Range 64 West, 6<sup>th</sup> P.M., for the J Klein 7Y-201 Well (API No. 05-123-43004) and the J Klein 7Y-341 Well (API No. 05-123-42998), from the Niobrara Formation. Order No. 407-1837 is not affected by this Application, and proceeds from any shared lands will be accounted for in the production of the Well.

9. On January 30, 2017, the Commission entered Order No. 407-1882, which, among other things, pooled all non-consenting interests in an approximate 240-acre wellbore spacing unit for the W $\frac{1}{2}$ W $\frac{1}{2}$  of Section 5 and the W $\frac{1}{2}$ NW $\frac{1}{4}$  of Section 8, Township 5 North, Range 64 West, 6<sup>th</sup> P.M., for the Ehrlich 5E-323 Well (API No. 05-123-43543), from the Niobrara Formation. Order No. 407-1882 is not affected by this Application, and proceeds from any shared lands will be accounted for in the production of the Well.

10. Also on January 30, 2017, the Commission entered Order No. 407-1886, which, among other things, pooled all non-consenting interests in an approximate 480-acre wellbore spacing unit for the W $\frac{1}{2}$  of Section 5 and the NW $\frac{1}{4}$  of Section 8, Township 5 North, Range 64 West, 6<sup>th</sup> P.M., for the Ehrlich 5J-203 well (API No. 05-123-43540), from the Niobrara Formation. Order No. 407-1886 is not affected by this Application, and proceeds from any shared lands will be accounted for in the production of the Well.

11. Also on January 30, 2017, the Commission entered Order No. 407-1887, which, among other things, pooled all non-consenting interests in an approximate 480-acre wellbore spacing unit for the W $\frac{1}{2}$  of Section 5 and the NW $\frac{1}{4}$  of Section 8, Township 5 North, Range 64 West, 6<sup>th</sup> P.M., for the Ehrlich 5J-243 well (API No. 05-123-43544), from the Niobrara Formation. Order No. 407-1887 is not affected by this Application, and proceeds from any shared lands will be accounted for in the production of the Well.

12. Also on January 30, 2017, the Commission entered Order No. 407-1888, which, among other things, pooled all non-consenting interests in an approximate 480-acre wellbore spacing unit for the W $\frac{1}{2}$  of Section 5 and the NW $\frac{1}{4}$  of Section 8, Township 5 North, Range 64 West, 6<sup>th</sup> P.M., for the Ehrlich 5J-303 well (API No. 05-123-43545), from the Niobrara Formation. Order No. 407-1888 is not affected by this Application, and proceeds from any shared lands will be accounted for in the production of the Well.

13. Also on January 30, 2017, the Commission entered Order No. 407-1889, which, among other things, pooled all non-consenting interests in an approximate 480-acre wellbore spacing unit for the W $\frac{1}{2}$  of Section 5 and the NW $\frac{1}{4}$  of Section 8, Township 5 North, Range 64 West, 6<sup>th</sup> P.M., for the Ehrlich 5J-233 well (API No. 05-123-43539), from the Niobrara Formation. Order No. 407-1889 is not affected by this Application, and proceeds from any shared lands will be accounted for in the production of the Well.

14. On May 1, 2017, the Commission entered Order No. 407-1973, which, among other things, pooled all non-consenting interests in two approximate 800-acre wellbore spacing units for the SE $\frac{1}{4}$ NE $\frac{1}{4}$ , NE $\frac{1}{4}$ SE $\frac{1}{4}$  of Section 7, S $\frac{1}{2}$ N $\frac{1}{2}$ , N $\frac{1}{2}$ S $\frac{1}{2}$  of Section 8, S $\frac{1}{2}$ N $\frac{1}{2}$ , N $\frac{1}{2}$ S $\frac{1}{2}$  of Section 9, and the SW $\frac{1}{4}$ NW $\frac{1}{4}$ , NW $\frac{1}{4}$ SW $\frac{1}{4}$  of Section 10, Township 5 North, Range 64 West, 6<sup>th</sup> P.M., for the Wacker 10G-214 Well (API No. 05-123-43568), and the Wacker 10G-304 Well (API No. 05-123-43562), from the Niobrara Formation. Order No. 407-1973 is not affected by this Application, and proceeds from any shared lands will be accounted for in the production of the Well.

15. On June 11, 2018, the Commission entered Order No. 407-2487, which, among other things, amended Order No. 407-1887 to reflect the as-drilled acreage for the Ehrlich 5J-243 Well (API No. 05-123-43544), which consists of the W $\frac{1}{2}$ NW $\frac{1}{4}$ , SW $\frac{1}{4}$  of Section 5 and the NW $\frac{1}{4}$  of Section 8, Township 5 North, Range 64 West, 6<sup>th</sup> P.M. Order No. 407-2487 is not affected by this Application, and proceeds from any shared lands will be accounted for in the production of the Well.

16. PDC filed this Application to amend Order No. 407-1838. The Commission entered Order No. 407-1838 on December 12, 2016. Order No. 407-1838 pooled, among other things, all non-consenting interests in an approximate 520-acre wellbore spacing unit for the SW $\frac{1}{4}$ SW $\frac{1}{4}$  of Section 5, E $\frac{1}{2}$ E $\frac{1}{2}$  of Section 6, E $\frac{1}{2}$ E $\frac{1}{2}$  of Section 7, W $\frac{1}{2}$ NW $\frac{1}{4}$  of Section 8, Township 5 North, Range 64 West, 6<sup>th</sup> P.M., and the SE $\frac{1}{4}$ SE $\frac{1}{4}$  of Section 31 and the SW $\frac{1}{4}$ SW $\frac{1}{4}$  of Section 32, Township 6 North, Range 64 West, 6<sup>th</sup> P.M., for the J Klein 7Y-241 Well (API No. 05-123-43003), from the Niobrara Formation. After the Commission entered Order No. 407-1838, PDC modified its drilling plans for the Well and, as a result, reduced the size of the wellbore spacing unit for the Well to a 481.48-acre wellbore spacing unit consisting of the following lands:

Township 5 North, Range 64 West, 6<sup>th</sup> P.M.

Section 5: SW $\frac{1}{4}$ SW $\frac{1}{4}$

Section 6: E $\frac{1}{2}$ E $\frac{1}{2}$

Section 7: E $\frac{1}{2}$ E $\frac{1}{2}$

Section 8: NW $\frac{1}{4}$ SW $\frac{1}{4}$ , W $\frac{1}{2}$ NW $\frac{1}{4}$

Weld County, Colorado, containing 481.48 acres ("Wellbore Spacing Unit" in this Application)

17. The COGCC has not published any additional orders affecting the Application Lands as of the date of this Application.

18. On August 3, 2018, COGCC Permitting approved a Form 4/Sundry Notice for the J Klein 7Y-241 Well to modify the wellbore spacing unit to reflect the as-drilled acreage of the Wellbore Spacing Unit (attached as Exhibit B).

19. Under the provisions of Rule 530 and C.R.S. § 34-60-116(6)–(7), PDC requests that the Commission amend Order No. 407-1838 to reflect the as-drilled acreage of the Well and, accordingly, to apply the involuntary pooling provisions of Order No. 407-1838 to only the Wellbore Spacing Unit.

20. PDC requests that the Commission's amended Order No. 407-1838 be made effective as of the earlier date of this Application, or the date that the costs specified in C.R.S. § 34-60-116(7)(b)(II) are first incurred for the drilling of the J Klein 7Y-241 Well to the Niobrara Formation in the Wellbore Spacing Unit.

21. The granting of this Application is in accord with the Oil and Gas Conservation Act, C.R.S. § 34-60-101 et seq., and the Commission Rules.

22. PDC requests that the relief granted under this Application be effective upon oral order of the Commission, and PDC hereby agrees to be bound by such oral order.

23. PDC certifies that copies of this Application will be served on all owners of the mineral estate, as indicated and required by Rule 507.b(2), underlying the tracts of the Wellbore Spacing Unit within seven (7) days of the date hereof, and that at least thirty-five (35) days prior to the hearing on this matter. The list of such Interested Parties, is attached as Exhibit A.

24. In order to prevent waste and to protect correlative rights, all interests and tracts in the Wellbore Spacing Unit should be pooled for the orderly drilling and development of the Niobrara Formation.

WHEREFORE, PDC respectfully requests that this matter be set for hearing at the next available opportunity, that notice be given as required by law, and that the Commission enter an Order:

- A. Amending Order No. 407-1838 to apply only to the Wellbore Spacing Unit for the J Klein 7Y-241 Well, drilled to develop the Niobrara Formation; and
- B. Providing for such other findings and order as the Commission may deem proper or advisable in this matter.

[SIGNATURE PAGE FOLLOWS]

DATED this 18<sup>th</sup> day of October, 2018.

Respectfully submitted,

PDC Energy, Inc.

By: \_\_\_\_\_

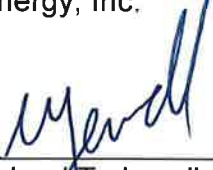
  
Michael T. Jewell, Esq. #40902  
Courtney M. Shephard, Esq. #47668  
Burns, Figa & Will, P.C.  
6400 S. Fiddler's Green Circle – Suite 1000  
Greenwood Village, CO 80111

PDC Energy, Inc.  
Ms. Katherine Wilson  
1775 Sherman Street - Suite 3000  
Denver, CO 80203

VERIFICATION

STATE OF COLORADO                    )  
  )     ss.  
COUNTY OF DENVER                    )

The undersigned, of lawful age, having been first sworn upon her oath, deposes and states that:

1. She is a Regional Landman for PDC Energy, Inc., which address is 1775 Sherman Street, Suite 3000, Denver, CO 80203.
  
2. She has read the attached application to amend Order No. 407-1838 for the J Klein 7Y-241 Well, is familiar with the facts set forth therein, and states that said facts are true and correct to the best of her knowledge and belief.

Further Affiant sayeth not.

  
\_\_\_\_\_  
Katherine Wilson, RPL

Subscribed and sworn to before me this 18<sup>th</sup> day of October, 2018.

Witness my hand and official seal.  
My commission expires: 9.24.22

NICOLE D HEALY  
NOTARY PUBLIC  
STATE OF COLORADO  
NOTARY ID 20104037289  
MY COMMISSION EXPIRES SEPTEMBER 24, 2022

  
\_\_\_\_\_

EXHIBIT A

Interested Parties

J Klein 7Y-241 Well

PDC Energy, Inc.
Bayswater Fund III-A, LLC
Acme Oil Corp, LLC
Bayswater Resources LLC
Incline Niobrara Partners, LP
Michael F. Schmidt
Deborah A. Schmidt
William S. Morris
Heirs and Devisees of Daniel Witter
2004 Patterson Family Revocable Trust u/d/t August 31, 2004
Anita L. Owen
Atomic Capital Minerals LLC
Betsy A. Klein Revocable Trust, dated November 10, 2014
Blackriver Niobrara Partners II, LLC
Blackriver Niobrara Partners, LLC
Blackriver, LLC
BTA Oil Producers LLC
Carolyn Plumb
Corporation of the Presiding Bishop of the Church of Jesus Christ of Latter-Day Saints
Daniel C. Webster
Dorothy Jean Peterson
Douglas Phillip McLeish and Lynne Wright McLeish Trust dated December 12, 2001
Emily Ann Gervais, Trustee of the Gervais Revocable Trust u/a/d 12/14/2000
Geraldine L. Cooper
Harry Lee Alles
Incline Niobrara Partners, LP
James D. Klein Revocable Trust, dated November 10, 2014
Joan M. Johnston



Kathleen L. Berryman
Kimberly A. Hoff
Maxine K. Hurt
Monte R. Schmidt
Nancy Jayne Allnutt
Nancy Stroh
Ovid A. Plumb
Patricia Ellen Burch
Principle Energy, L.L.C.
Ramon V. Klein Revocable Trust
Regal Petroleum, L.L.C.
Roberta Jean Nelson
Sally J. Schmidt Ashby
Springbok Energy Partners, LLC
Tabitha Walter
Tamara Sue Nelson
The Phyllis L. Dunn Living Trust, u/a/d March 7, 2001
Vera Marlene Hoff
Viola M. Amen
Walter E. Hoff
Weld County School District RE-7, c/o Future Farmers of America
William T. Klein
Wolf Resources Holding I, LLC
Wolfhawk Energy Holdings, LLC

EXHIBIT B

Approved APD and Wellbore Spacing Unit Map

J Klein 7Y-241 Well

[ATTACHED]

**State of Colorado**  
**Oil and Gas Conservation Commission**

1120 Lincoln Street, Suite 801, Denver, Colorado 80203  
Phone: (303) 894-2100 Fax: (303) 894-2109



DE	ET	OE	ES
Document Number: <b>401558017</b>			
Date Received: <b>02/28/2018</b>			

**SUNDRY NOTICE**

Submit a signed original. This form is to be used for general, technical and environmental sundry information. For proposed or completed operations, describe in full in Comments or provide as an attachment. Identify Well by API Number; identify Oil and Gas Location by Location ID Number; identify other Facility by Facility ID Number.

OGCC Operator Number: 69175 Contact Name Venessa Chase  
 Name of Operator: PDC ENERGY INC Phone: (303) 318-6102  
 Address: 1775 SHERMAN STREET - STE 3000 Fax: (303) 860-5838  
 City: DENVER State: CO Zip: 80203 Email: venessa.chase@pdce.com

Complete the Attachment  
Checklist

OP OGCC

API Number : 05- 123 43003 00 OGCC Facility ID Number: 445278  
 Well/Facility Name: J Klein Well/Facility Number: 7Y-241  
 Location QtrQtr: SWSE Section: 7 Township: 5N Range: 64W Meridian: 6  
 County: WELD Field Name: WATTENBERG  
 Federal, Indian or State Lease Number: \_\_\_\_\_

Survey Plat		
Directional Survey		
Srfc Eqpmt Diagram		
Technical Info Page		
Other		

**CHANGE OF LOCATION OR AS BUILT GPS REPORT**

- Change of Location \*       As-Built GPS Location Report       As-Built GPS Location Report with Survey

\* Well location change requires new plat. A substantive surface location change may require new Form 2A.

**SURFACE LOCATION GPS DATA** Data must be provided for Change of Surface Location and As Built Reports.

Latitude \_\_\_\_\_ PDOP Reading \_\_\_\_\_ Date of Measurement \_\_\_\_\_  
 Longitude \_\_\_\_\_ GPS Instrument Operator's Name \_\_\_\_\_

**LOCATION CHANGE (all measurements in Feet)**

Well will be: \_\_\_\_\_ (Vertical, Directional, Horizontal)

Change of **Surface** Footage **From** Exterior Section Lines:

Change of **Surface** Footage **To** Exterior Section Lines:

Current **Surface** Location **From** QtrQtr SWSE Sec 7

New **Surface** Location **To** QtrQtr \_\_\_\_\_ Sec \_\_\_\_\_

Change of **Top of Productive Zone** Footage **From** Exterior Section Lines:

Change of **Top of Productive Zone** Footage **To** Exterior Section Lines:

Current **Top of Productive Zone** Location **From** Sec 7

New **Top of Productive Zone** Location **To** Sec \_\_\_\_\_

Change of **Bottomhole** Footage **From** Exterior Section Lines:

Change of **Bottomhole** Footage **To** Exterior Section Lines:

Current **Bottomhole** Location Sec 6 Twp 5N

New **Bottomhole** Location Sec \_\_\_\_\_ Twp \_\_\_\_\_

Is location in High Density Area? \_\_\_\_\_

Distance, in feet, to nearest building \_\_\_\_\_, public road: \_\_\_\_\_, above ground utility: \_\_\_\_\_, railroad: \_\_\_\_\_,

property line: \_\_\_\_\_, lease line: \_\_\_\_\_, well in same formation: \_\_\_\_\_

Ground Elevation \_\_\_\_\_ feet Surface owner consultation date \_\_\_\_\_

FNL/FSL		FEL/FWL	
<u>536</u>	<u>FSL</u>	<u>1818</u>	<u>FEL</u>
_____	_____	_____	_____
Twp <u>5N</u>	Range <u>64W</u>	Meridian <u>6</u>	
Twp _____	Range _____	Meridian _____	
<u>556</u>	<u>FSL</u>	<u>480</u>	<u>FEL</u>
_____	_____	_____	_____
Twp <u>5N</u>	Range <u>64W</u>		
Twp _____	Range _____		
<u>500</u>	<u>FNL</u>	<u>508</u>	<u>FEL</u>
_____	_____	_____	_____
Twp _____	Range _____		
Twp _____	Range _____		

\*\*

\*\*

\*\* attach deviated drilling plan

CHANGE OR ADD OBJECTIVE FORMATION AND/OR SPACING UNIT

<u>Objective Formation</u>	<u>Formation Code</u>	<u>Spacing Order Number</u>	<u>Unit Acreage</u>	<u>Unit Configuration</u>
NIOBRARA	NBRR		480	GWA

OTHER CHANGES

**REMOVE FROM SURFACE BOND** Signed surface use agreement is a required attachment

**CHANGE OF WELL, FACILITY OR OIL & GAS LOCATION NAME OR NUMBER**

From: Name J KLEIN Number 7Y-241 Effective Date: \_\_\_\_\_

To: Name \_\_\_\_\_ Number \_\_\_\_\_

**ABANDON PERMIT: Permit can only be abandoned if the permitted operation has NOT been conducted. Field inspection will be conducted to verify site status.**

WELL: Abandon Application for Permit-to-Drill (Form2) – Well API Number \_\_\_\_\_ has not been drilled.

PIT: Abandon Earthen Pit Permit (Form 15) – COGCC Pit Facility ID Number \_\_\_\_\_ has not been constructed (Permitted and constructed pit requires closure per Rule 905)

CENTRALIZED E&P WASTE MANAGEMENT FACILITY: Abandon Centralized E&P Waste Management Facility Permit (Form 28) – Facility ID Number \_\_\_\_\_ has not been constructed (Constructed facility requires closure per Rule 908)

OIL & GAS LOCATION ID Number: \_\_\_\_\_

Abandon Oil & Gas Location Assessment (Form 2A) – Location has not been constructed and site will not be used in the future.

Keep Oil & Gas Location Assessment (Form 2A) active until expiration date. This site will be used in the future.

**Surface disturbance from Oil and Gas Operations must be reclaimed per Rule 1003 and Rule 1004.**

**REQUEST FOR CONFIDENTIAL STATUS**

**DIGITAL WELL LOG UPLOAD**

**DOCUMENTS SUBMITTED** Purpose of Submission: \_\_\_\_\_

RECLAMATION

**INTERIM RECLAMATION**

Interim Reclamation will commence approximately \_\_\_\_\_

Per Rule 1003.e.(3) operator shall submit Sundry Notice reporting interim reclamation is complete and site is ready for inspection when vegetation reaches 80% coverage.

Interim reclamation complete, site ready for inspection.

Per Rule 1003.e(3) describe interim reclamation procedure in Comments below or provide as an attachment and attach required location photographs.

**Field inspection will be conducted to document Rule 1003.e. compliance**

**FINAL RECLAMATION**

Final Reclamation will commence approximately \_\_\_\_\_

Per Rule 1004.c.(4) operator shall submit Sundry Notice reporting final reclamation is complete and site is ready for inspection when vegetation reaches 80% coverage.

Final reclamation complete, site ready for inspection. Per Rule 1004.c(4) describe final reclamation procedure in Comments below or provide as an attachment.

**Field inspection will be conducted to document Rule 1004.c. compliance**

Comments:

**ENGINEERING AND ENVIRONMENTAL WORK**

NOTICE OF CONTINUED TEMPORARILY ABANDONED STATUS

Indicate why the well is temporarily abandoned and describe future plans for utilization in the COMMENTS box below or provide as an attachment, as required by Rule 319.b.(3).

Date well temporarily abandoned \_\_\_\_\_ Has Production Equipment been removed from site? \_\_\_\_\_

Mechanical Integrity Test (MIT) required if shut in longer than 2 years. Date of last MIT \_\_\_\_\_

SPUD DATE: \_\_\_\_\_

**TECHNICAL ENGINEERING AND ENVIRONMENTAL WORK**

Details of work must be described in full in the COMMENTS below or provided as an attachment.

NOTICE OF INTENT Approximate Start Date \_\_\_\_\_

REPORT OF WORK DONE Date Work Completed \_\_\_\_\_

<input type="checkbox"/> Intent to Recomplete (Form 2 also required)	<input type="checkbox"/> Request to Vent or Flare	<input type="checkbox"/> E&P Waste Mangement Plan
<input type="checkbox"/> Change Drilling Plan	<input type="checkbox"/> Repair Well	<input type="checkbox"/> Beneficial Reuse of E&P Waste
<input type="checkbox"/> Gross Interval Change	<input type="checkbox"/> Rule 502 variance requested. Must provide detailed info regarding request.	
<input type="checkbox"/> Other _____	<input type="checkbox"/> Status Update/Change of Remediation Plans for Spills and Releases	

COMMENTS:

**CASING AND CEMENTING CHANGES**

Casing Type	Size	Of	/	Hole	Size	Of	/	Casing	Wt/Ft	Csg/LinTop	Setting Depth	Sacks of Cement	Cement Bottom	Cement Top

**H2S REPORTING**

**Data Fields in this section are intended to document Sample and Location Data associated with the collection of a Gas Sample that is submitted for Laboratory Analysis.**

**Gas Analysis Report must be attached.**

H2S Concentration: \_\_\_\_\_ in ppm (parts per million) Date of Measurement or Sample Collection \_\_\_\_\_

Description of Sample Point:

Absolute Open Flow Potential \_\_\_\_\_ in CFPD (cubic feet per day)

Description of Release Potential and Duration (If flow is not open to the atmosphere, identify the duration in which the container or pipeline would likely be opened for servicing operations.):

--

Distance to nearest occupied residence, school, church, park, school bus stop, place of business, or other areas where the public could reasonably be expected to frequent: \_\_\_\_\_

Distance to nearest Federal, State, County, or municipal road or highway owned and principally maintained for public use: \_\_\_\_\_

COMMENTS:

--

### Best Management Practices

**No BMP/COA Type**

**Description**

No BMP/COA Type	Description

Operator Comments:

This sundry is being submitted to revise the spacing unit for the subject well to reflect the as drilled wellbore. The proposed spacing unit is: T5N-R64W Section 5: SWSW, Section 6: E2E2, Section 7: E2E2, Section 8: W2NW, NWSW, 480 Acres

I hereby certify all statements made in this form are, to the best of my knowledge, true, correct, and complete.

Signed: \_\_\_\_\_ Print Name: Venessa Chase  
Title: Permitting Supervisor Email: venessa.chase@pdce.com Date: 2/28/2018

Based on the information provided herein, this Sundry Notice (Form 4) complies with COGCC Rules and applicable orders and is hereby approved.

COGCC Approved: GARRISON, PENNY Date: 8/3/2018

### CONDITIONS OF APPROVAL, IF ANY:

**COA Type**

**Description**

COA Type	Description

### General Comments

**User Group**

**Comment**

**Comment Date**

User Group	Comment	Comment Date
		Stamp Upon Approval

Total: 0 comment(s)

### Attachment Check List

**Att Doc Num**

**Name**

401558017	SUNDRY NOTICE APPROVED-OBJ
401558029	PROPOSED SPACING UNIT
401724240	FORM 4 SUBMITTED

Total Attach: 3 Files



---

**Corporate Office**  
1775 Sherman Street, #3000  
Denver, Colorado 80203  
303.860.5800  
www.pdce.com

February 28, 2018

State of Colorado, Oil & Gas Conservation Commission  
Attn: Matt Lepore  
1120 Lincoln Street, Suite 801  
Denver, CO 80203

Re: **30 Day Certification Letter – Rule 318Ae**  
J Klein 7Y-241  
SWSE Section 7, T5N-R64W  
Weld County, Colorado

Dear Director,

PDC Energy, Inc. ("PDC") hereby certifies to the Director that a thirty (30-day) notice has been given by certified mail to all owners in the proposed wellbore spacing unit consisting of T5N-R64W Section 5: SWSW, Section 6: E2E2, Section 7: E2E2, Section 8: W2NW, NWSW, 480 acres. We have not received any objections to such well location or proposed spacing unit, therefore, PDC hereby requests the Director to approve the well.

If you should have any questions or concerns regarding this permit, please contact the undersigned at (303) 318-6102.

Sincerely,

A handwritten signature in blue ink that reads "Venessa Chase".

Venessa Chase  
Permitting Supervisor - Wattenberg  
PDC Energy, Inc.

# J Klein 7Y-241

T5N-R64W Section 5: SWSW, Section 6: E2E2,  
Section 7: E2E2, Section 8: W2NW, NWSW

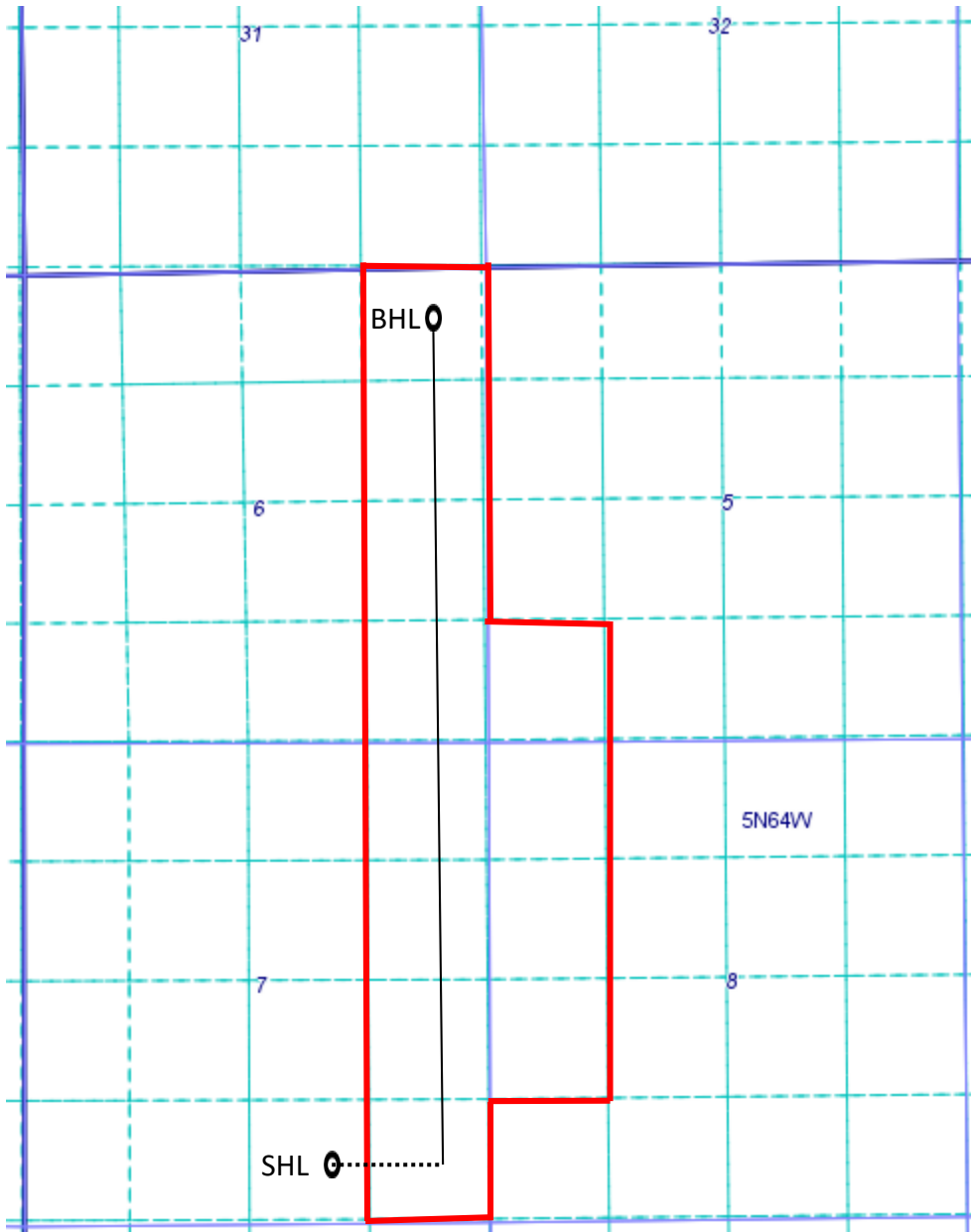

 = 480 Acre Proposed Spacing Unit