

**BEFORE THE OIL & GAS CONSERVATION COMMISSION
OF THE STATE OF COLORADO**

IN THE MATTER OF AN **AMENDED** APPLICATION BY LONGS PEAK RESOURCES, LLC FOR AN ORDER TO, AMONG OTHER THINGS, (1) ESTABLISH AN APPROXIMATE 1280-ACRE DRILLING AND SPACING UNIT FOR PRODUCTION FROM THE **NIOBRARA**, CODELL, CARLILE AND FORT HAYES FORMATIONS AND AUTHORIZE UP TO 6 HORIZONTAL WELLS FOR PRODUCTION FROM THE CODELL, FORT HAYES AND CARLILE FORMATIONS, **AND UP TO 7 HORIZONTAL WELLS FOR PRODUCTION FROM THE NIOBRARA FORMATION** (2) ESTABLISH THE SETBACKS FOR THE DRILLING AND SPACING UNIT ESTABLISHED FOR PRODUCTION FROM THE **NIOBRARA**, CODELL, FORT HAYES AND CARLILE FORMATIONS, ALL FOR SECTIONS 11 AND 14, TOWNSHIP 11 NORTH, RANGE 65 WEST, 6TH P.M., UNNAMED FIELD, WELD COUNTY, COLORADO

CAUSE NO. 535

DOCKET NO. 180300248

TYPE: SPACING AND
DENSITY

AMENDED APPLICATION

Longs Peak Resources, LLC, Operator No. 10611 ("LPR" or "Applicant"), by and through its attorneys, Beatty & Wozniak, P.C., respectfully submits this **Amended** Application to the Oil and Gas Conservation Commission of the State of Colorado ("Commission") for an order: (1) establishing an approximate 1280-acre drilling and spacing unit for the Application Lands (as defined below) for production of oil, gas and associated hydrocarbons from the **Niobrara**, Codell, Carlile and Fort Hayes Formations, and authorize up to six (6) horizontal wells within the proposed unit, for the production of oil, gas and associated hydrocarbons from the Codell, Carlile and Fort Hayes Formations **and up to seven (7) horizontal wells within the proposed unit, for the production of oil, gas and associated hydrocarbons from the Niobrara Formation, and** (2) establishing the setbacks for such drilling and spacing unit. In support of its **Amended** Application, Applicant states and alleges as follows:

1. Applicant is a limited liability company duly authorized to conduct business in the State of Colorado, and has registered as an operator with the Commission.

2. Applicant is an owner in the below-listed lands:

Township 11 North, Range 65 West, 6th P.M.

Section 11: All

Section 14: All

1,280-acres, more or less, Weld County, Colorado.

These lands are hereinafter referred to as the "Application Lands." A map depicting the acreage comprising the Application Lands is attached hereto and marked as **Exhibit A**.

Prior Orders

Prior Orders

3. Rule 318.a. of the Commission Rules provides a well to be drilled 2,500 feet or greater shall be located not less than 600 feet from any lease line, and shall be located not less than 1,200 feet from any other producible oil or gas well when drilling to the same common source of supply, unless authorized by the Commission upon hearing. The Application Lands are subject to Rule 318.a. for the **Niobrara**, Codell, Carlile and Fort Hayes Formations.

4. **On April 4, 2011, the Commission entered Order No. 535-10, which among other things, established two approximate 640-acre drilling and spacing units for Sections 11 and 14, Township 11 North, Range 65 West, 6th P.M., and approved one horizontal well within each unit, for the production of gas and associated hydrocarbons from the Niobrara Formation.**

Establishing a Drilling and Spacing Unit for the **Niobrara**, Codell, Carlile and Fort Hayes Formations

5. Applicant requests the Commission establish the Application Lands as a drilling and spacing unit for the **Niobrara**, Codell, Carlile and Fort Hayes Formations pursuant to Rule 503.b.(1) and §34-60-116(2), C.R.S. For the Application Lands, the proposed drilling unit is not smaller than the maximum area that can be economically and efficiently drained by the horizontal wells proposed to be drilled under this **Amended** Application and completed in the **Niobrara**, Codell, Carlile and Fort Hayes Formations.

Authorizing up to six (6) wells for production from the Codell, Carlile and Fort Hayes Formations

6. Applicant requests it be authorized to drill and complete up to six (6) horizontal wells in the drilling and spacing unit proposed for the Application Lands, for production of oil, gas and associated hydrocarbons from the Codell, Carlile and Fort Hayes Formations. Due to the thickness of the Codell Formation in this area, wellbores may deviate from the Codell Formation into the Carlile and Fort Hayes Formations, however the Codell is the target formation. A total of six (6) horizontal wells within the Application Lands for production from the Codell, Carlile and Fort Hayes Formations is necessary in order to economically and efficiently recover resources, while minimizing surface impacts, creating efficiencies for drilling and production, increasing the ultimate recovery of the reserves, preventing waste, and protecting correlative rights.

Authorizing up to seven (7) wells for production from the Niobrara Formation

7. **Applicant requests it be authorized to drill and complete up to seven (7) horizontal wells in the drilling and spacing unit proposed for the Application Lands, for production of oil, gas and associated hydrocarbons from the Niobrara Formation. A total of seven (7) horizontal wells within the Application Lands for production from the Niobrara Formation is necessary in order to economically and efficiently recover resources, while minimizing surface impacts,**

creating efficiencies for drilling and production, increasing the ultimate recovery of the reserves, preventing waste, and protecting correlative rights.

8. Moreover, one of the DSUs established by Order No. 535-10 (covering Section 11 of the Applications Lands) contains one well that is currently capable of producing from the Niobrara Formation (well is shut-in):

<u>Well Name</u>	<u>API No.</u>	<u>Operator</u>
<u>Wagner #11-65 11-1H</u>	<u>05-123-33110</u>	<u>Ironhorse Resources LLC</u>

9. Applicant requests that production from the Wagner #11-65 11-1H Well continue to be allocated on a 640-acre unit basis pursuant to Order No. 535-10. Accordingly, Applicant requests that the Wagner #11-65 11-1H Well be excluded from the 1,280-acre DSU proposed herein. Applicant requests that the Commission amend, modify or vacate Order No. 535-10 as it deems fit so as to conform with Applicant's request that no additional wells are drilled pursuant to Order No. 535-10 in the Application Lands, that the Wagner #11-65 11-1H Well remain the only well drilled pursuant to Order No. 535-10 in the Application Lands, and production from the Wagner #11-65 11-1H Well continue to be allocated on a 640-acre basis.

Setbacks

10. Applicant requests that setbacks for the Application Lands be as follows:

a. Any horizontal wells to be drilled under this Amended Application for production from the Niobrara, Codell, Carlile and Fort Hayes Formations will be drilled from the surface of the drilling unit, or on adjacent lands with consent of the landowner, from no more than four (4) surface locations, unless an exception is granted by the Director.

b. The wellbores of any horizontal wells to be drilled under this Amended Application may enter the Niobrara, Codell, Carlile and Fort Hayes Formations anywhere within the unit, or on adjacent lands, without exception being granted by the Director.

c. For any permitted wells to be drilled under this Amended Application for production from the Niobrara, Codell, Carlile and Fort Hayes Formations, the treated intervals of the wells shall be not less than 150 feet from the treated interval of another well producing from the same formation unit, without exception being granted by the Director.

d. For any permitted wells to be drilled under this Amended Application for production from the Niobrara, Codell, Carlile and Fort Hayes Formations, the productive interval of any permitted well shall be located no closer than 300 feet from the unit boundary.

11. Applicant requests that relief granted under this **Amended** Application should be effective on oral order by the Commission, and Applicant hereby agrees to be bound by said oral order.

12. The granting of this **Amended** Application is in accord with the Oil and Gas Conservation Act, found at §34-60-101, *et seq.*, C.R.S., and the Commission rules.

13. The undersigned certifies that copies of this **Amended** Application will be served on each interested party as required by Rule 507 within seven (7) days of the filing hereof, as required by Rule 503.e.

WHEREFORE, Applicant respectfully requests that this matter be set for hearing, that notice be given as required by law and that upon such hearing, this Commission enter its order:

A. Establishing a drilling and spacing unit for the Application Lands for the production of oil, gas and associated hydrocarbons from the **Niobrara**, Codell, Carlile and Fort Hayes Formations.

B. Authorizing up to six (6) horizontal wells for the production of oil, gas and associated hydrocarbons from the Codell, Carlile and Fort Hayes Formations.

C. **Authorizing up to seven (7) horizontal wells for the production of oil, gas and associated hydrocarbons from the Niobrara Formation.**

D. **Amending, modifying or vacating the two 640-acre exploratory drilling units established by Order No. 535-10, only as to Sections 11 and 14, Township 11 North, Range 65 West, 6th P.M., so as to ensure no additional wells are drilled pursuant to Order No. 535-10 in the Application Lands, that the Wagner #11-65 11-1H Well remain the only well drilled pursuant to Order No. 535-10 in the Application Lands, and production from the Wagner #11-65 11-1H Well continue to be allocated on a 640-acre basis.**

E. Providing that setbacks for the Application Lands be as follows:

a. Any horizontal wells to be drilled under this **Amended** Application for production from the **Niobrara**, Codell, Carlile and Fort Hayes Formations will be drilled from the surface of the drilling unit, or on adjacent lands with consent of the landowner, from no more than four (4) surface locations, unless an exception is granted by the Director.

b. The wellbores of any horizontal wells to be drilled under this **Amended** Application may enter the **Niobrara**, Codell, Carlile and Fort Hayes Formations anywhere within the unit, or on adjacent lands, without exception being granted by the Director.

c. For any permitted wells to be drilled under this **Amended** Application for production from the **Niobrara**, Codell, Carlile and Fort Hayes Formations, the treated intervals of the wells shall be not less than 150 feet from the treated interval

of another well producing from the same **formation unit**, without exception being granted by the Director.

d. For any permitted wells to be drilled under this **Amended** Application for production from the **Niobrara**, Codell, Carlile and Fort Hayes Formations, the productive interval of any permitted well shall be located no closer than 300 feet from the unit boundary.

F. Providing that relief granted under this **Amended** Application be effective on oral order by the Commission, relying on the Applicant's desire to be bound by said oral order.

G. For such other findings and orders as the Commission may deem proper or advisable in the premises.

DATED this 7th day of ~~January~~ **February**, 2018.

Respectfully submitted,

Longs Peak Resources, LLC

By: 

James Parrot
Jillian Fulcher
Evan Bekkedahl
Beatty & Wozniak, P.C.
Attorneys for Applicant
216 16th Street, Suite 1100
Denver, Colorado 80202
(303) 407-4499
jparrot@bwenergylaw.com
jfulcher@bwenergylaw.com
ebekkedahl@bwenergylaw.com

Address of Applicant

Vertex Energy Partners, LLC, as agent
for Longs Peak Resources, LLC
Kent Snider, Vice President-Land
215 Union Blvd., Suite 400
Lakewood, Colorado 80228

VERIFICATION

STATE OF COLORADO)
) ss.
CITY & COUNTY OF DENVER)

Kent Snider, Vice President-Land for Vertex Energy Partners, LLC, as agent for Longs Peak Resources, LLC, upon oath deposes and says that he has read the foregoing **Amended** Application and that the statements contained therein are true to the best of his knowledge, information and belief.

LONGS PEAK RESOURCES, LLC

Kent Snider

Subscribed and sworn to before me this 24 day of February, 2018,
by Kent Snider, Vice President-Land for Vertex Energy Partners, LLC, as agent for
Longs Peak Resources, LLC.

Witness my hand and official seal.

My commission expires: 3/3/19

Notary Public



Exhibit A

Reference Map for Amended Application

Township 11 North, Range 65 West, 6th P.M.

Section 11: All

Section 14: All

1,280-acres, more or less, Weld County, Colorado.

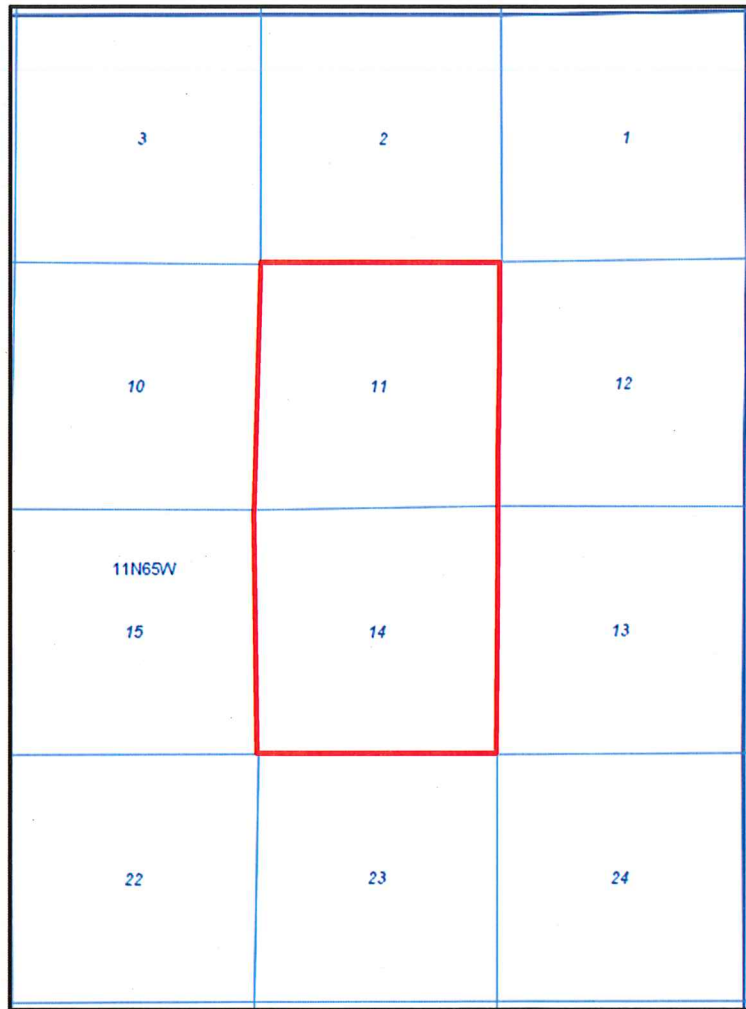

= Application Lands

**BEFORE THE OIL AND GAS CONSERVATION COMMISSION
OF THE STATE OF COLORADO**

IN THE MATTER OF AN APPLICATION BY
LONGS PEAK RESOURCES, LLC FOR AN
ORDER TO, AMONG OTHER THINGS, (1)
ESTABLISH AN APPROXIMATE 1280-ACRE
DRILLING AND SPACING UNIT FOR
PRODUCTION FROM THE CODELL, CARLILE
AND FORT HAYES FORMATIONS AND
AUTHORIZE UP TO 6 HORIZONTAL WELLS FOR
PRODUCTION FROM THE CODELL, FORT
HAYES AND CARLILE FORMATIONS, (2)
ESTABLISH THE SETBACKS FOR THE DRILLING
AND SPACING UNIT ESTABLISHED FOR
PRODUCTION FROM THE CODELL, FORT
HAYES, CARLILE, FORMATIONS, ALL FOR
SECTIONS 11 AND 14, TOWNSHIP 11 NORTH,
RANGE 65 WEST, 6TH P.M., UNNAMED FIELD,
WELD COUNTY, COLORADO

CAUSE NO. 535

DOCKET NO. 180300248

TYPE: SPACING AND
DENSITY

AFFIDAVIT OF MAILING

STATE OF COLORADO)

) ss.

CITY AND COUNTY OF DENVER)

Grace Go-Hoveland, of lawful age, and being first duly sworn upon her oath,
states and declares:

That she is a Legal Assistant at Beatty & Wozniak, P.C., attorneys for Longs
Peak Resources, LLC, and on or before February 14, 2018, caused a copy of the
attached AMENDED Application to be deposited in the United States Mail, postage
prepaid, addressed to the parties listed on Exhibit A attached hereto.



Grace Go-Hoveland

Subscribed and sworn to before me this 14th day of February, 2018.

Witness my hand and official seal.



Notary Public

TERESA L. PETERSON
NOTARY PUBLIC
STATE OF COLORADO

NOTARY ID 19894002026
MY COMMISSION EXPIRES OCTOBER 4, 2021

(00350043)

EXHIBIT A
INTERESTED PARTIES

8 NORTH, LLC
370 17TH STREET, STE. 5300
DENVER, CO 80202

CLEAR CREEK FUND 1-A, LP
717 17TH STREET SUITE 1525
DENVER, CO 80202

ESTATE OF C.G. MACCARTHY
A/K/A CORNEILIUS G. MACCARTHY
C/O DELORES MENNING
4602 FIFIELD ROAD #103
PELLA, IA 50219

ESTATE OF C.G. MACCARTHY
A/K/A CORNEILIUS G. MACCARTHY
C/O DIANE MACNAUGHTON
6885 NW 6TH DRIVE
DES MOINES, IA 50313

ESTATE OF C.G. MACCARTHY
A/K/A CORNEILIUS G. MACCARTHY
C/O JAMES N GALLOWAY
335 WOODLAND ROAD
CHARLOTTESVILLE, VA 22901

ESTATE OF C.G. MACCARTHY
A/K/A CORNEILIUS G. MACCARTHY
C/O MARLYS STARIHA
10106 OLD BON AIR PLACE
RICHMOND, VA 23235

ESTATE OF C.G. MACCARTHY
A/K/A CORNEILIUS G. MACCARTHY
C/O SUSAN AELINE LITSCHKE
78 E 10TH SO. #803
ST. PAUL, MN 55101

ESTATE OF C.G. MACCARTHY
A/K/A CORNEILIUS G. MACCARTHY
C/O ALICE TRUMBULL LONG
12 FORREST DRIVE
CARROLTON, GA 30117

ESTATE OF C.G. MACCARTHY
A/K/A CORNEILIUS G. MACCARTHY
C/O ANNA MAE MILLER
9106 HURON AVENUE
RICHMOND, VA 23294

ESTATE OF C.G. MACCARTHY
A/K/A CORNEILIUS G. MACCARTHY
C/O CHRISTINE A. WNOROSKI
3211 TUSCARONA ROAD
ERIEVILLE, NY 13061

ESTATE OF C.G. MACCARTHY
A/K/A CORNEILIUS G. MACCARTHY
C/O GEORGE RUSEELL ROBERT, JR.
38 BOSTON DRIVE
BERLINE, MD 21811

ESTATE OF C.G. MACCARTHY
A/K/A CORNEILIUS G. MACCARTHY
C/O IONE PICHE
309 PROSPECT
ELMHURST, IL 60126

ESTATE OF C.G. MACCARTHY
A/K/A CORNEILIUS G. MACCARTHY
C/O JEANETTE VERMEER
214 IDAHO DRIVE
PELLA, IA 50219

ESTATE OF C.G. MACCARTHY
A/K/A CORNEILIUS G. MACCARTHY
C/O JUDITH C. WARNS
2400 HUNTINGTON DRIVE
PLANO, TX 75075

ESTATE OF C.G. MACCARTHY
A/K/A CORNEILIUS G. MACCARTHY
C/O LUTHER E. MACNAUGHTON
2402 EAST LAKE DRIVE #8
UNION, NE 68455

ESTATE OF C.G. MACCARTHY
A/K/A CORNEILIUS G. MACCARTHY
C/O SOUTHWEST FLORIDA SYMPHONY
ENDOWMENT FUND, INC.
12651 MCGREGOR BLVD STE 4-403
FT. MYERS, FL 33919

ESTATE OF C.G. MACCARTHY
A/K/A CORNEILIUS G. MACCARTHY
C/O WHITTETAIL MINERALS, LLC
518 17TH STREET STE 1800
DENVER, CO 80202

ESTATE OF CHARLES F. MACCARTHY
C/O WARNER-CALDWELL INVESTMENTS, LLC
110 30TH AVE N STE 4
NASHVILLE, TN 37203

ESTATE OF HARRY E. BROWN
C/O DARCY ARNOLD
3034 GOLF ROAD
STOCKTON, IL 61085

ESTATE OF HARRY E. BROWN
C/O GAIL POLLARD
3122 CENTERVILLE ROAD
ROCKVILLE, IL 61102

ESTATE OF HARRY E. BROWN
C/O SUE ROBERTS
720 N. BOY SCOUT RD
STOCKTON, IL 61085

ESTATE OF HARRY E. BROWN
C/O DARCY ARNOLD
3034 GOLF ROAD
STOCKTON, IL 61085

ESTATE OF HARRY E. BROWN,
C/O WHITETAIL MINERALS, LLC
999 18TH STREET STE 3370
DENVER, CO 80237

ESTATE OF JEAN M MCKILLIPS
C/O SUE ROBERTS
720 N. BOY SCOUT RD
STOCKTON, IL 61085

ESTATE OF JEAN M. MCKILLIPS
C/O ANN COPPERNOLL
203 W PRAIRIE AVE
STOCKTON, IL 61085

ESTATE OF JOYCE VOTTIER
C/O RICHARD W, CHIAPPINI
262 PHILLIPS PEAK
HIGHLANDS RANCH, CO 80129

ESTATE OF KANDI JUNE BROWN
C/O NEXUS BSP, LLC
1129 PENNSYLVANIA STREET
DENVER, CO 80203

ESTATE OF KANDI JUNE BROWN,
C/O WHITETAIL MINERALS, LLC
999 18TH STREET STE 3370
DENVER, CO 80237

ESTATE OF LIBBY BAKER
C/O BRUCE D BAKER
14122 E. MAPLEWOOD AVE
CENTENNIAL, CO 80111

ESTATE OF LIBBY BAKER
C/O JACK H BAKER
5776 S URBAN COURT
LITTLETON, CO 80127

ESTATE OF LOIS COPPERNOLL
C/O ANN COPPERNOLL
203 W PRAIRIE AVE
STOCKTON, IL 61085

ESTATE OF LOIS COPPERNOLL
C/O SUE ROBERTS
720 N. BOY SCOUT RD
STOCKTON, IL 61085

ESTATE OF RC BAKER A/K/A RALPH C BAKER
C/O GAYLE A JENSEN
6638 S. ROBB STREET
LITTLETON, CO 80127

ESTATE OF REOLA BREED MCKILLIPS
C/O DARCY ARNOLD
3034 GOLF ROAD
STOCKTON, IL 61085

ESTATE OF WILLIAM D. LOGAN
26848 AVENUE OF THE OAKS
NEWHALL, CA 91321

ESTATE OF WILLIAM R BROWN,
C/O WHITETAIL MINERALS, LLC
999 18TH STREET STE 3370
DENVER, CO 80237

ESTATE OF WILLIAM R. BROWN
C/O MAGIC M&R, LLC
1720 SOUTH BELLAIRE STREET STE 1209
DENVER, CO 80222

JAN G. WAGNER
18025 WCR 128
NUNN, CO 80648

MARY H. LOGAN
26848 AVENUE OF THE OAKS
NEWHALL, CA 91321

ROBERT A. BROWN
1612 SIXTH STREET
ROCKFORD, IL

ROBERT E. WAGNER, JR. AND JAN G.
WAGNER
18025 WCR 128
NUNN, CO 80648

TRUE RANCHES, LLC
895 WEST RIVER CROSS ROAD
CASPER, WY 82601

BRANDON MARETTE, ENERGY LIAISON
COLORADO PARKS AND WILDLIFE
NORTHEAST REGION OFFICE
6060 BROADWAY
DENVER, CO 80216

TROY SWAIN
WELD COUNTY
DEPARTMENT OF PLANNING SERVICES
1555 NORTH 17TH AVENUE
GREELEY, CO 80631

ANTELOPE ENERGY COMPANY
1801 BROADWAY STE 1550
DENVER, CO 80202

DOROTHY GOERING
335 WEST KIRWIN
SALINA, KS 67401

ESTATE OF C.G. MACCARTHY
A/K/A CORNEILIUS G. MACCARTHY
C/O ALLAN BIRNEY
4625 MILL ROAD
COOPERSBERG, PA 18036

ESTATE OF C.G. MACCARTHY
A/K/A CORNEILIUS G. MACCARTHY
C/O DONA FAE STENSTROM
1118 HARBOR LANE
GULF BREEZE, FL 32563

ESTATE OF C.G. MACCARTHY
A/K/A CORNEILIUS G. MACCARTHY
C/O JANA GRACE WILLIAMS
2833 ITASCA AVENUE
ST MARYS POINT, MN 55043

ESTATE OF C.G. MACCARTHY
A/K/A CORNEILIUS G. MACCARTHY
C/O RYAN BIRNEY
15103 RIVERLOOP DRIVE EAST
BEND, OR 97707

ESTATE OF C.G. MACCARTHY
A/K/A CORNEILIUS G. MACCARTHY
C/O WILLIAM MERRYL HARTNESS
14196 WEST 117TH STREET
OLATHE, KS 66062

ESTATE OF C.G. MACCARTHY
A/K/A CORNEILIUS G. MACCARTHY
C/O ANN C. FASNACHT
1204 ARBOR RIDGE
CHAMBERSBURG, PA 17201

ESTATE OF C.G. MACCARTHY
A/K/A CORNEILIUS G. MACCARTHY
C/O BETTY SIXSMITH
20720 WEST SAN JOSE STREET
CHATSWORTH, CA 91311

ESTATE OF C.G. MACCARTHY
A/K/A CORNEILIUS G. MACCARTHY
C/O FRED W. TAYLOR II
43163 SAN MATEO WAY
HEMET, CA 92544

ESTATE OF C.G. MACCARTHY
A/K/A CORNEILIUS G. MACCARTHY
C/O HELEN D MCCARTHY
270 UMBERGER ROAD #123
SAN JOSE, CA 95111

ESTATE OF C.G. MACCARTHY
A/K/A CORNEILIUS G. MACCARTHY
C/O JAMES E. WHEELER
11454 RIVER RUN DRIVE
GLEN ALLEN, VA 23060

ESTATE OF C.G. MACCARTHY
A/K/A CORNEILIUS G. MACCARTHY
C/O JOHN W. LANKELMA
4324 LOTTIE LANE
PLANO, TX 75074

ESTATE OF C.G. MACCARTHY
A/K/A CORNEILIUS G. MACCARTHY
C/O LOYAL W. TRUMBULL
2800 S. UNIVERSITY BLVD. #41
DENVER, CO 80210

ESTATE OF C.G. MACCARTHY
A/K/A CORNEILIUS G. MACCARTHY
C/O RONALD C. WHEELER
11010 BERRAND ROAD
RICHMOND, VA 23236

ESTATE OF C.G. MACCARTHY
A/K/A CORNEILIUS G. MACCARTHY
C/O WARNER-CALDWELL INVESTMENTS, LLC
110 30TH AVE N STE 4
NASHVILLE, TN 37203

ESTATE OF C.G. MACCARTHY
A/K/A CORNEILIUS G. MACCARTHY
C/O HARRY HARTUNG
P.O. BOX 208
GREAT CACAPON, WV 25422

ESTATE OF CHARLES F. MACCARTHY
C/O WHITETAIL MINERALS, LLC
518 17TH STREET STE 1800
DENVER, CO 80202

ESTATE OF HARRY E. BROWN
C/O ANN COPPERNOLL
203 W PRAIRIE AVE
STOCKTON, IL 61085

ESTATE OF HARRY E. BROWN
C/O NEXUS BSP, LLC
1129 PENNSYLVANIA STREET
DENVER, CO 80203

ESTATE OF HARRY E. BROWN
C/O SUNFLOWER ROYALTIES
1720 SOUTH BELLAIRE STREET STE 1209
DENVER, CO 80222

ESTATE OF HARRY E. BROWN
C/O MAGIC M&R, LLC
1720 SOUTH BELLAIRE STREET STE 1209
DENVER, CO 80222

ESTATE OF HS BAKER
C/O JACK H BAKER
5776 S URBAN COURT
LITTLETON, CO 80127

ESTATE OF JEAN M. MCKILLIPS
C/O GAIL POLLARD
3122 CENTERVILLE ROAD
ROCKVILLE, IL 61102

ESTATE OF JOYCE VOTTIER
C/O CHIAPPINI FAMILY TRUST
6325 SPRINGWOOD DRIVE
RENO, NV 89523

ESTATE OF JOYCE VOTTIER
C/O SUE ANN CHIAPPINI GARDENER
3861 MEADOW VIEW DRIVE
EUGENE, OR 97408

ESTATE OF KANDI JUNE BROWN
C/O SUNFLOWER ROYALTIES
1720 SOUTH BELLAIRE STREET STE 1209
DENVER, CO 80222

ESTATE OF KANDI JUNE BROWN,
C/O MAGIC M&R, LLC
1720 SOUTH BELLAIRE STREET STE 1209
DENVER, CO 80222

ESTATE OF LIBBY BAKER
C/O GAYLE A JENSEN
6638 S. ROBB STREET
LITTLETON, CO 80127

ESTATE OF LIBBY BAKER
C/O STACEY L MOORE
PO BOX 2712
EVERGREEN, CO 80437

ESTATE OF LOIS COPPERNOLL
C/O GAIL POLLARD
3122 CENTERVILLE ROAD
ROCKVILLE, IL 61102

ESTATE OF RC BAKER A/K/A RALPH C BAKER
C/O BRUCE D BAKER
14122 E. MAPLEWOOD AVE
CENTENNIAL, CO 80111

ESTATE OF RC BAKER A/K/A RALPH C BAKER
C/O STACEY L MOORE
PO BOX 2712
EVERGREEN, CO 80437

ESTATE OF RUTH M DREILING
C/O STACEY L MOORE
PO BOX 2712
EVERGREEN, CO 80437

ESTATE OF WILLIAM R BROWN
C/O NEXUS BSP, LLC
1129 PENNSYLVANIA STREET
DENVER, CO 80203

ESTATE OF WILLIAM R. BROWN
C/O SUNFLOWER ROYALTIES
1720 SOUTH BELLAIRE STREET STE 1209
DENVER, CO 80222

IRONHORSE RESOURCES, LLC
216 16TH STREET STE 1200
DENVER, CO 80202

LONGS PEAK RESOURCES
10701 MELODY DRIVE STE 515
NORTHGLENN, CO 80234

OOGC AMERICA, LLC
945 BUNKER HILL RD. SUITE 100
HOUSTON, TX 77024

ROBERT E. WAGNER, JR.
18025 WCR 128
NUNN, CO 80648

TIEL SANFORD MEMORIAL FUND
209 WEST WILLOW
CHEROKEE, IA 51012

VERTEX ENERGY PARTNERS, LLC
10701 MELODY DRIVE STE 515
NORTHGLENN, CO 80234

KENT KUSTER
OIL & GAS CONSULTANT COORDINATOR
COLORADO DEPARTMENT OF
PUBLIC HEALTH & ENVIRONMENT
4300 CHERRY CREEK DRIVE SOUTH
DENVER, CO 80246-1530