



Holloway & Holloway, Inc.  
4218 W. 14th St. Lane  
Greeley, CO 80634  
(303) 867-3715  
(303) 353-9747



00520716

RECEIVED

NOV 21 1988

R. 42W

COLORADO OIL & GAS COMMISSION

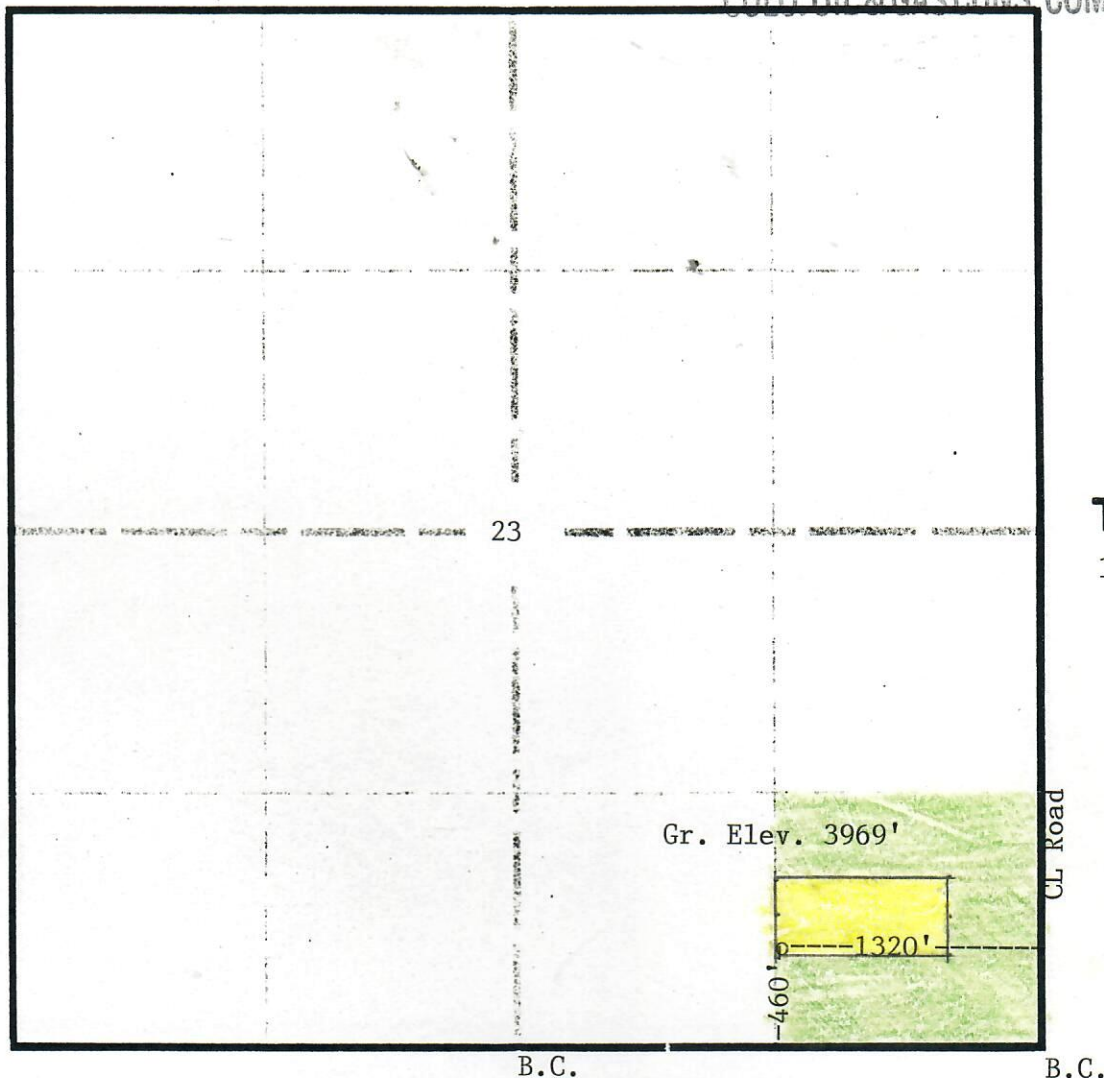

Scale --- 1" = 1000'

In accordance with a request from Union Pacific Resources Company  
the Undersigned has determined the location of the No.1 C L Evans 44-23 well  
to be 460'FSL & 1320'FEL as co-ordinates  
Section 23 Township 16S Range 42W of the 6th principal Meridian  
Cheyenne County, Colorado.

I hereby certify,  
that this oil and/or gas well location certificate was prepared for Union Pacific Resources Company  
that it is not a land survey plat or improvement survey plat, and that it is not to be relied upon for the  
establishment of fence, building or other future improvement lines.

Date 11-15-88

Holloway & Holloway, Inc.  
States of  
Colorado, Nebraska, Wyoming