

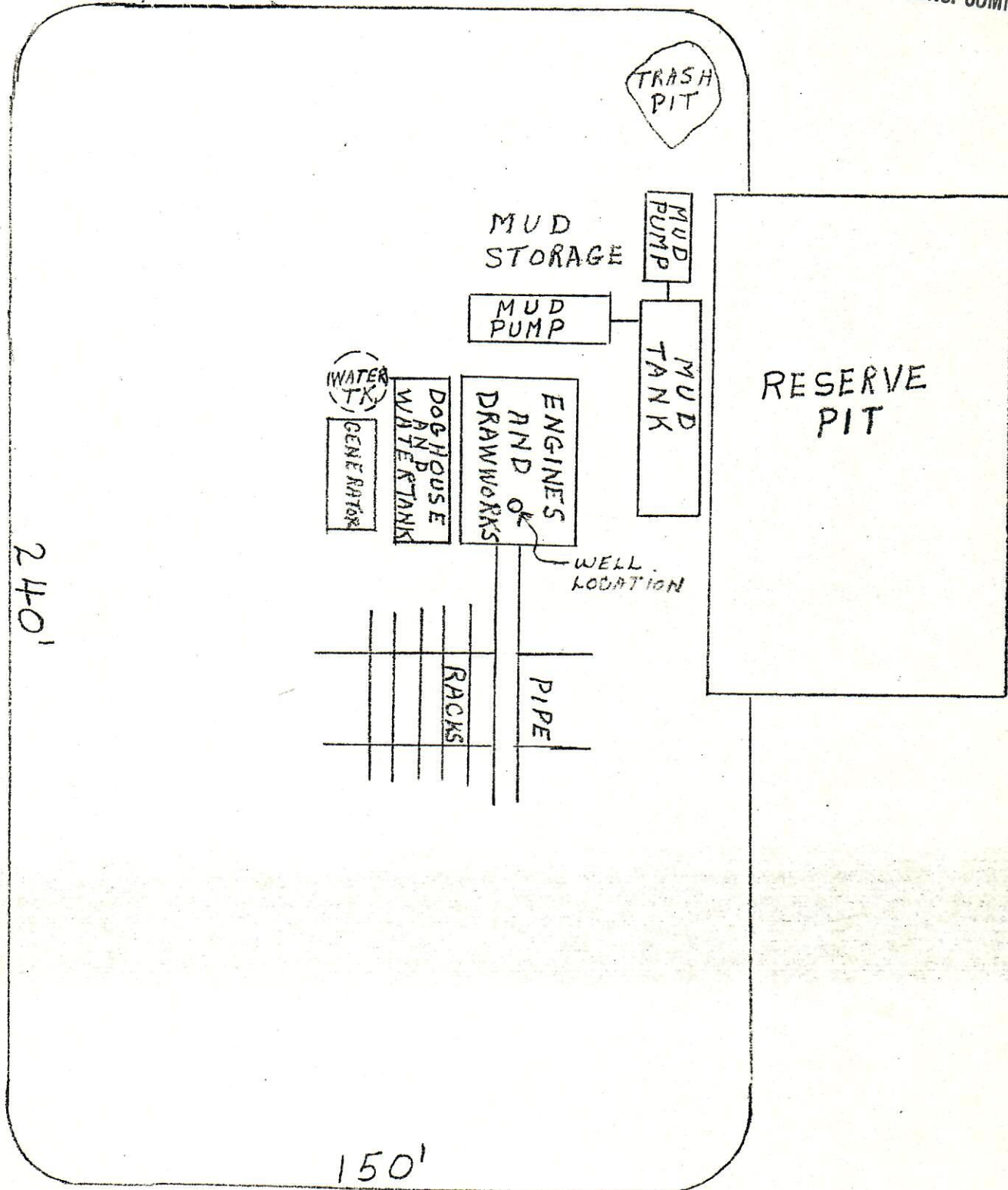

SHEEP MOUNTAIN NO. 5
NW NE Sec. 10, T-27S, R-70W
Huerfano Co., Colorado
Rig Layout

RECEIVED
SEP 9 1975
COLO. OIL & GAS CONS. COMM.



Approximate Scale 1" = 30'

Well stake is near base of steep slope of the northeast face of Little Sheep Mountain. A small ravine just south of the location runs generally east and northeast and becomes a large ravine about 1000' east of the location.