

DEPARTMENT OF NATURAL RESOURCES
OIL AND GAS CONSERVATION COMMISSION
OF THE STATE OF COLORADO

RECEIVED

OCT 14 1971



00416143

COLO. OIL & GAS CONS. COMMISSION

5. LEASE DESIGNATION AND SERIAL NO.

Patented

6. IF INDIAN, ALLOTTEE OR TRIBE NAME

None

7. UNIT AGREEMENT NAME

None

8. FARM OR LEASE NAME

Jolly

9. WELL NO.

1

10. FIELD AND POOL, OR WILDCAT

Wildcat

11. SEC., T., R., M., OR BLK.
AND SURVEY OR AREA

NE/4 SE/4, Sec.33, T3S-R55W

12. COUNTY

Washington

13. STATE

Colorado

APPLICATION FOR PERMIT TO DRILL, DEEPEN, OR PLUG BACK

1a. TYPE OF WORK

DRILL ☒DEEPEN ☐PLUG BACK ☐

b. TYPE OF WELL

OIL
WELL ☐GAS
WELL ☐

OTHER

Wildcat

SINGLE
ZONE ☐MULTIPLE
ZONE ☐

2. NAME OF OPERATOR

William D. Hewit

3. ADDRESS OF OPERATOR

980 Denver Club Building, Denver, Colorado 80202

4. LOCATION OF WELL (Report location clearly and in accordance with any State requirements.)

At surface

1950' from South line and 660' from East line Sec. 33

At proposed prod. zone

Same

14. DISTANCE IN MILES AND DIRECTION FROM NEAREST TOWN OR POST OFFICE

Three miles East and 1/2 mile North of Last Chance

15. DISTANCE FROM PROPOSED

LOCATION TO NEAREST

PROPERTY OR LEASE LINE, FT.

(Also to nearest drlg. line, if any)

660' ✓

16. NO. OF ACRES IN LEASE *

320

17. NO. OF ACRES ASSIGNED
TO THIS WELL

40

18. DISTANCE FROM PROPOSED LOCATION
TO NEAREST WELL, DRILLING, COMPLETED,
OR APPLIED FOR, ON THIS LEASE, FT.

None

19. PROPOSED DEPTH

5000' ✓

20. ROTARY OR CABLE TOOLS

Rotary

21. ELEVATIONS (Show whether DF, RT, GR, etc.)

4837 GR; 4842 KB

22. APPROX. DATE WORK WILL START

October 15, 1971

23.

PROPOSED CASING AND CEMENTING PROGRAM

SIZE OF HOLE	SIZE OF CASING	WEIGHT PER FOOT	SETTING DEPTH	QUANTITY OF CEMENT
12-1/4"	8-5/8"	24#	150'	150 sacks

* DESCRIBE LEASE

Township 3 South, Range 55 West
Section 33: S/2

This well will be drilled to a total depth of approximately 5000 feet or 150 feet into the "J" sandstone.

If the well is productive, William D. Hewit will complete for production. If the well is a dry hole, the well will be properly plugged and the location will be restored by Allison Drilling Company.

IN ABOVE SPACE DESCRIBE PROPOSED PROGRAM: If proposal is to deepen or plug back, give data on present productive zone and proposed new productive zone. If proposal is to drill or deepen directionally, give pertinent data on subsurface locations and measured and true vertical depths. Give blowout preventer program, if any.

24.

SIGNED Louis J. ScopelTITLE GeologistDATE October 6, 1971

(This space for Federal or State office use)

PERMIT NO.

71 794

APPROVAL DATE

APPROVED BY

P. V. Rogers

TITLE

DIRECTOR

DATE

OCT 14 1971

CONDITIONS OF APPROVAL, IF ANY:

See Instructions On Reverse Side

A.P.I. NUMBER

05 121 8616

71-794



RECEIVED

OCT 14 1971

R. 55W

COLO. OIL & GAS CONS. COMM.

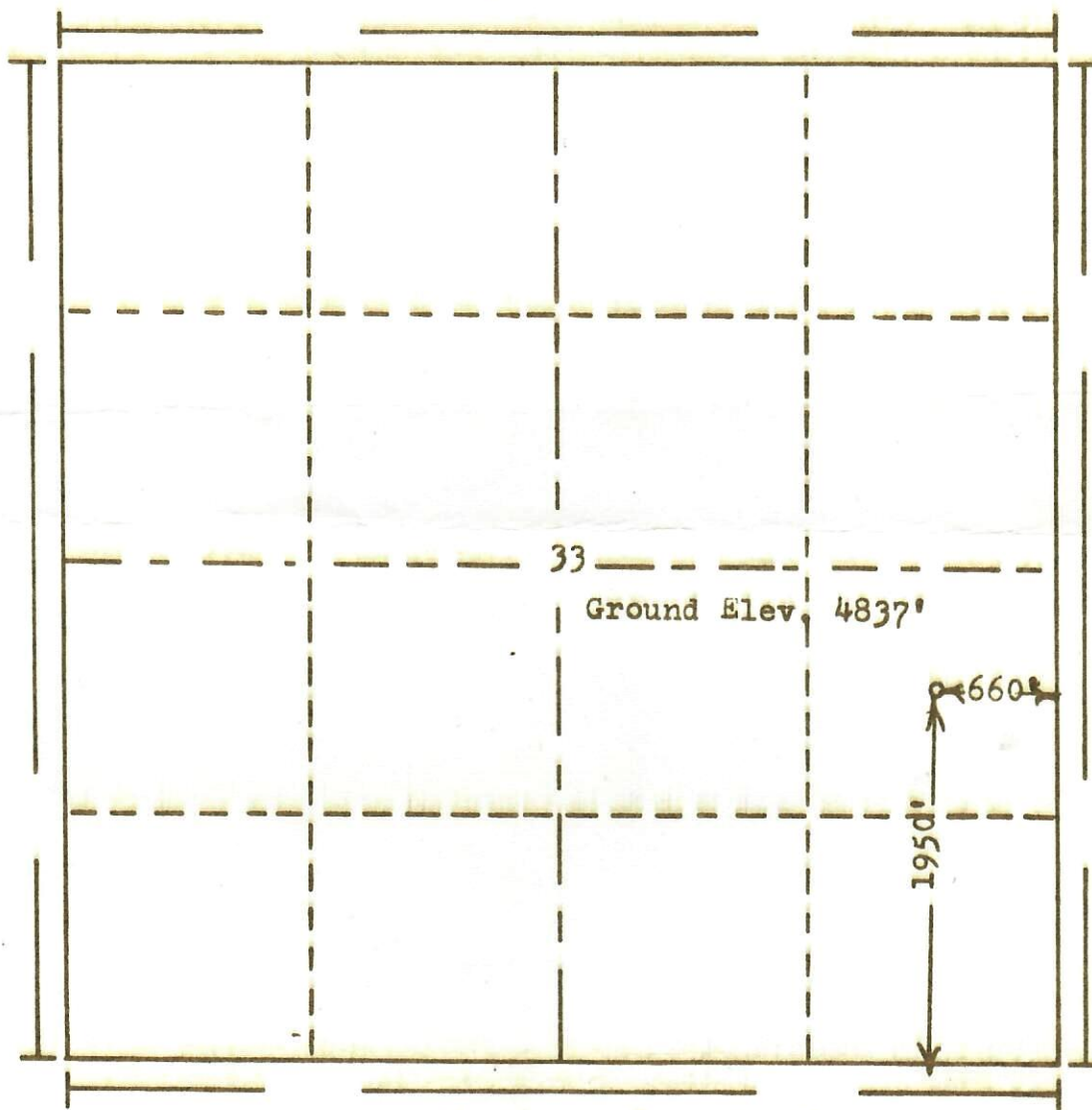

Scale... 1" = 1000'

Powers Elevation Company, Inc. of Denver, Colorado
has in accordance with a request from Mr. Scoepel
for William D. Hewit

determined the location of No. 1 Jolly
to be CNE SE Section 33 Township 3S
Range 55W of the 6th Principal Meridian
Washington County, Colorado

I hereby certify that this plat is an
accurate representation of a correct
survey showing the location of

Date: 10-1-71

B. J. Hall
Licensed Land Surveyor No. 2853
State of Colorado