

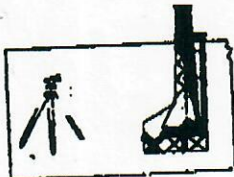

00523147

RECEIVED



ROBINSON SERVICES, INC.

P.O. Box 1574
Garden City, Kansas 67846
(316) 276-8159

836 11 1992
INVOICE NO.

OCCASIONAL GAS CONS. COMM.

DRW Operating Co.
OPERATOR1
NOLowe
FARMCheyenne
COUNTY17 15S 46W
S T RC SW NE (1980' EEL 3300' ESL)
LOCATION

ELEVATION: 4324gr

DRW Operating Co.
P.O. Box 13886
Denver, Co. 80201

Directions: From First View go 3 miles
West on Hwy 40 to Rd. 31 then 4½ miles
South- ½ East- 2/10 Northeast to Stake.

AUTHORIZED BY Doug Wood

SCALE 1" = 1000'

5' Iron rod & 1' wood stakes & flagging
Slightly sloping pasture
Landowner Mr. Lowe & John Julian & toolpusher present

Ingress: W/4C
Flag: same

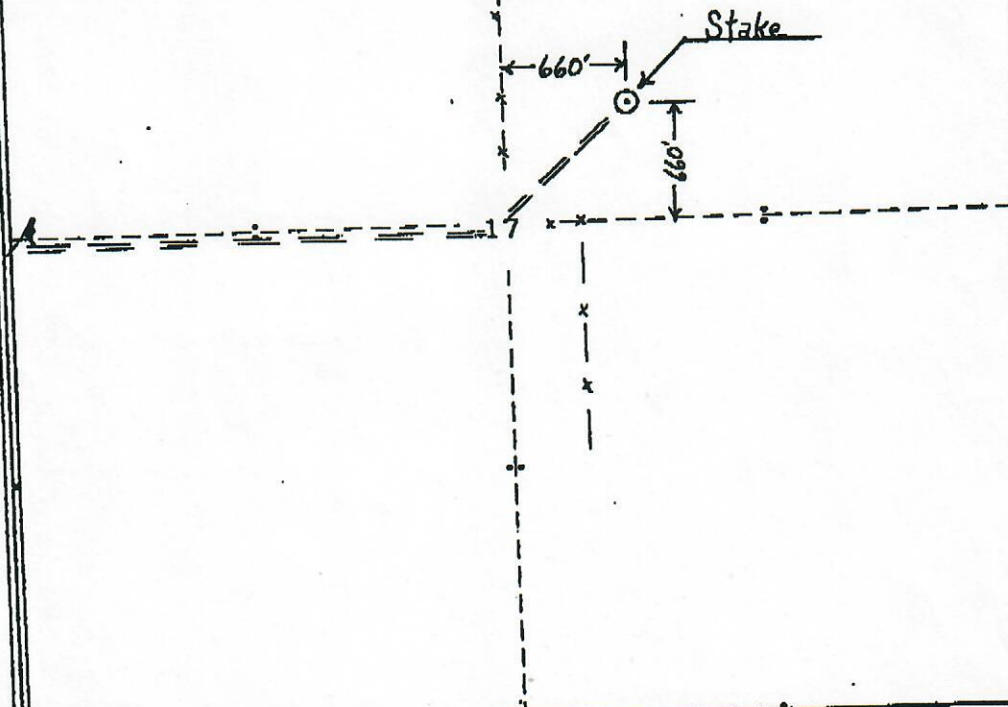

Staked 12/19/92