

PLAT SHOWING

MIRACLE - FIFER DRILLING COMPANY WELL

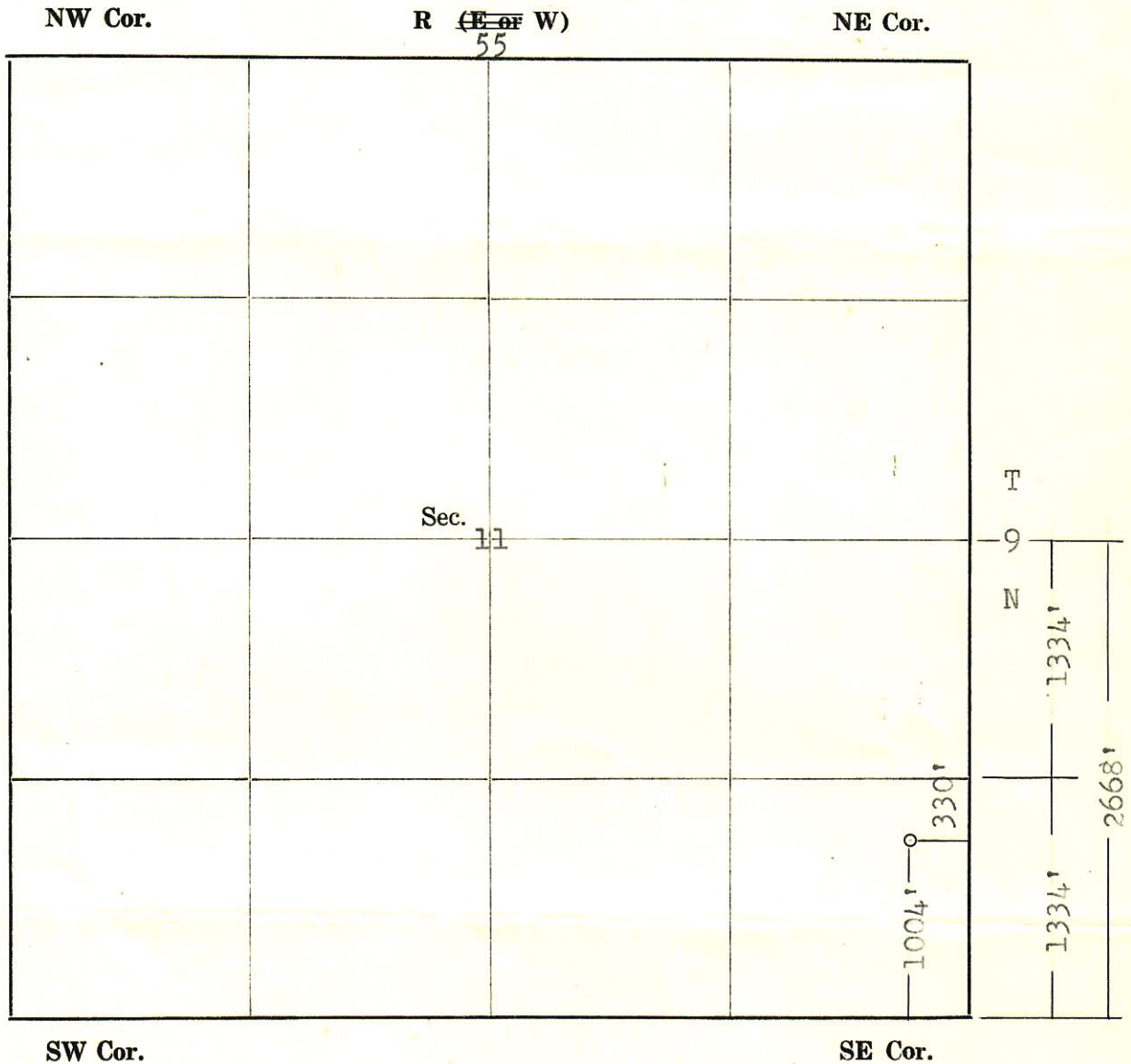

Field: _____ Well: Mathewson No. 1
 Range: 55 West Township 9 North Section: 11
 Meridian: 6 th County Logan State: Colorado
 Well Elev. (Grd) 4378



Scale 1' - 1000'

I, Thomas J. Fleam of Brush, Colorado, do
 (Name) (Town) (State)

hereby certify that this plat correctly shows the location of the Miracle - Fifer Drilling
 Company Well Mathewson No. 1 staked, Nov., 3, 1955 and checked by me; that
 (Date)

said well is located at a point 1004 feet (N ~~or S~~) and 330 feet (E ~~or W~~) of the
Southeast corner of Section 11

Township 9 N Range 55 W of the 6 th P. M., State of Colorado

Signed:

Thomas J. Fleam
 CLS 1854