



FORM F-106



00245137

78-161

RECEIVED

MAR 1 1978

R. 56W

COLO. OIL &amp; GAS CONS. COMM.

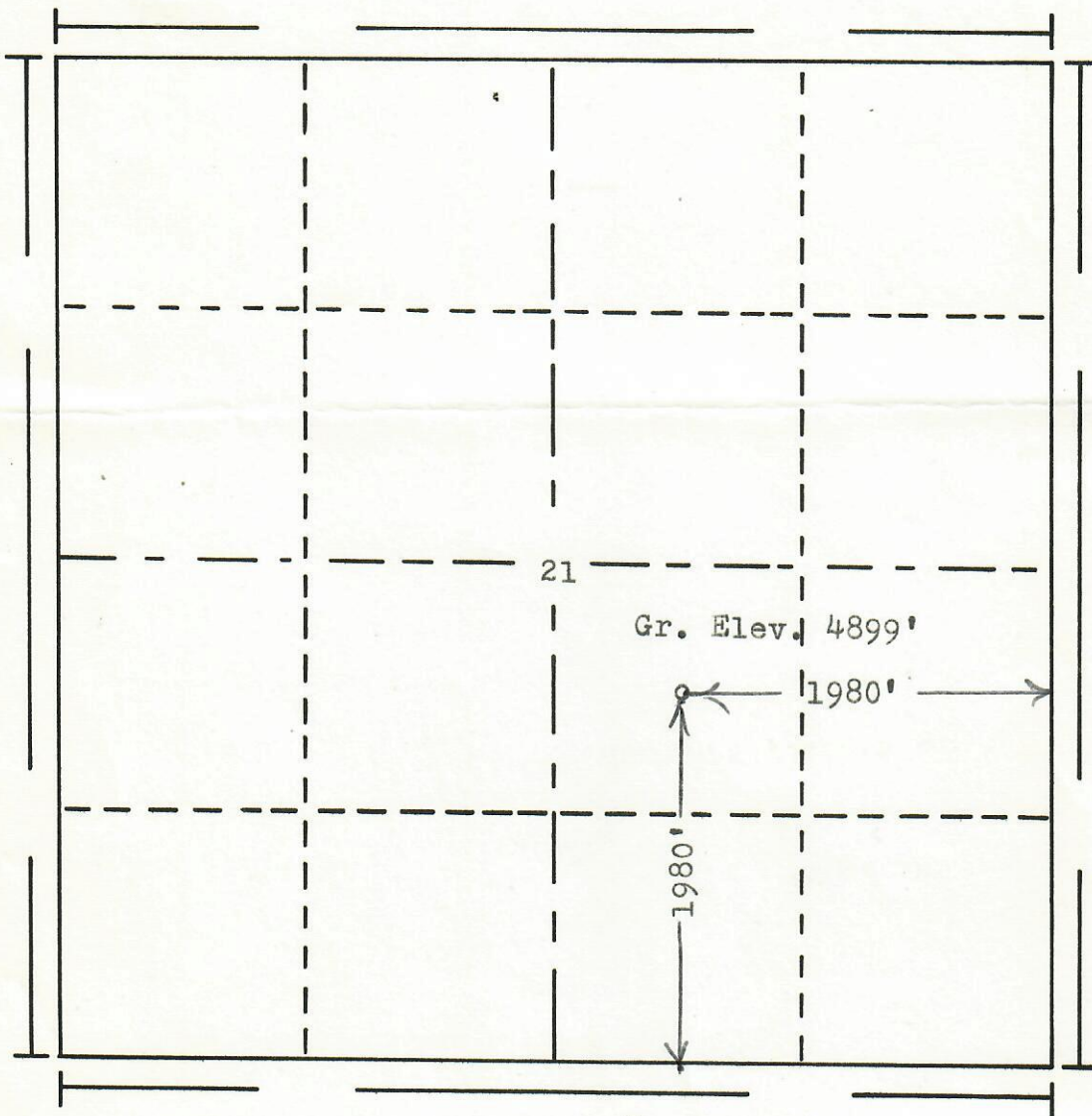
T.  
12  
N

Scale... 1" = 1000'

Powers Elevation Company, Inc. of Denver, Colorado  
has in accordance with a request from Mr. Arnum  
for Ken Tipps & Exeter Drlg. & Exploration Co.  
determined the location of No.1 Klinginsmith  
to be CNW SE Section 21 Township 12N  
Range 56W of the 6th Principal Meridian  
Weld County, Colorado

I hereby certify that this plat is an  
accurate representation of a correct  
survey showing the location of

Date: 2-22-78

*B. J. [Signature]*  
Licensed Land Surveyor No. 2853  
State of Colorado