

C34-14 PAD  
LOCATION DRAWING

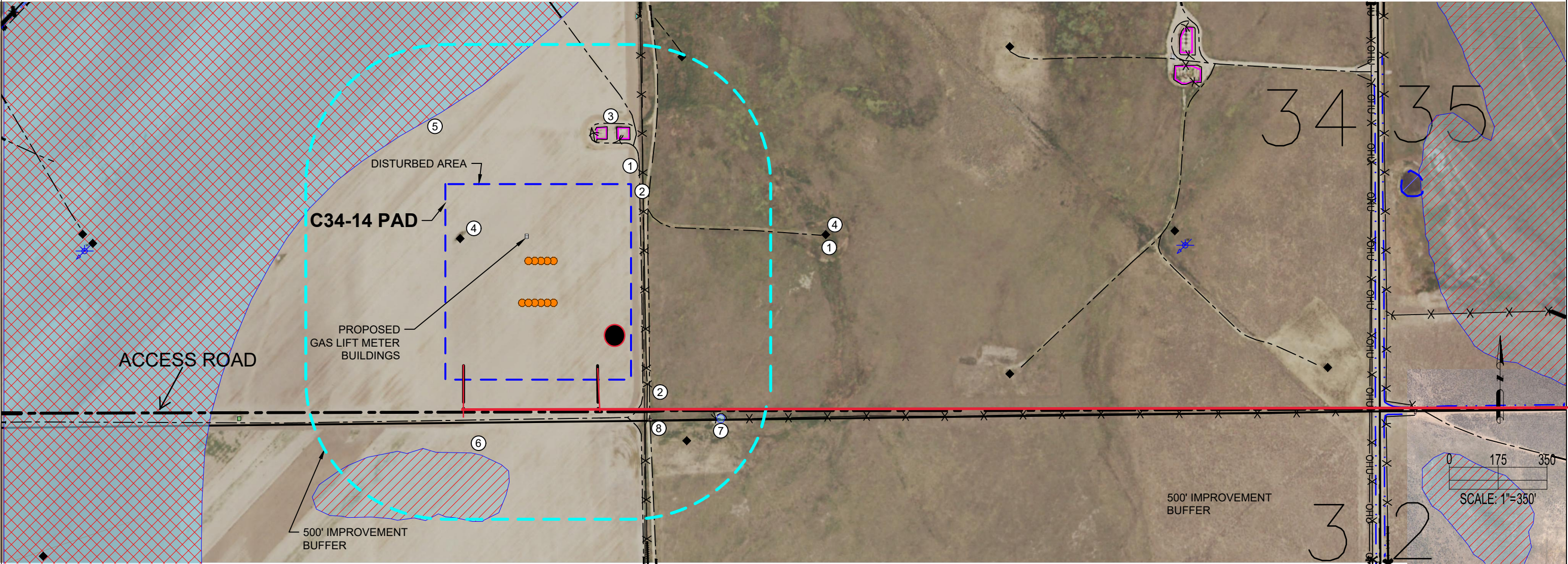

C34-14 PAD

IMPROVEMENTS: (AS MEASURED FROM THE PROPOSED EDGE OF DISTURBANCE)	
1. PRIVATE ROAD:	±31' E, ±61' E, ±61' E, ±135' S, ±137' N, ±147' N
2. FENCE	±43' E, ±153' N, ±159' N, ±166' SE
3. EXISTING PRODUCTION EQUIPMENT (NOBLE):	±162' N, ±156' N
4. OIL/GAS WELL:	0', ±296' SE, ±491' NE
5. FLOODPLAIN:	±230' NW
6. LOW LYING AREA:	±259' S
7. POND:	±335' SE
8. CATTLEGUARD:	±154' SE
PROPERTY LINE:	±42' E, ±148' S

C34-14 PAD

CURRENT SURFACE USE: DRY LAND CROP  
FUTURE SURFACE USE: DRY LAND CROP

DISCLAIMER:  
THIS PLOT DOES NOT REPRESENT A MONUMENTED LAND SURVEY AND SHOULD NOT BE RELIED UPON TO DETERMINE BOUNDARY LINES, PROPERTY OWNERSHIP OR OTHER PROPERTY INTERESTS. PARCEL LINES, IF DEPICTED HAVE NOT BEEN FIELD VERIFIED AND MAY BE BASED UPON PUBLICLY AVAILABLE DATA THAT ALSO HAS NOT BEEN INDEPENDENTLY VERIFIED.

7535 Hilltop Circle  
Denver, CO 80221  
(303) 928-7128  
www.ascentgeomatics.com

FIELD DATE: 09-26-18	DRAWING DATE: 10-19-18
DRAWN BY: NGP	CHECKED BY: RMC

SITE NAME: C34-14 PAD	SITE NAME:
SURFACE LOCATION: SEC. 34, T4N, R64W, 6TH P.M. WELD COUNTY, COLORADO	SURFACE LOCATION:

DATA SOURCE:  
AERIAL IMAGERY: ASCENT 11/2017, NAIP 2017  
WATER WELLS: COLORADO DWR  
NHD: USGS

PUBLICLY AVAILABLE DATA SOURCES HAVE NOT BEEN INDEPENDENTLY VERIFIED BY ASCENT.

**LEGEND:**

● = PROPOSED WELL	☒ = FLOODPLAIN	☒ = POND
◆ = EXISTING WELL	--- = DITCH	☒ = WATER WELL
✕ = FENCE	--- = EXISTING ROAD	☒ = MARSHLAND
—OHU— = OVERHEAD UTILITY		☒ = LOW LYING AREA

--- = PROPOSED ACCESS ROAD	--- = CENTER SECTION LINE
☒ = DISTURBANCE AREA	
☒ = 500' RADIUS	
☒ = EXISTING FACILITY	
☒ = CATTLE GAURD	