



39.77736, -108.63622, 6618.9ft, 3°
07/30/2020 04:13:11 PM



COLORADO
Oil & Gas Conservation
Commission
Department of Natural Resources

Photo 1. Location.

S.E. Douglas Creek 305CBM API: 05-103-10204
Inspection: 700402706

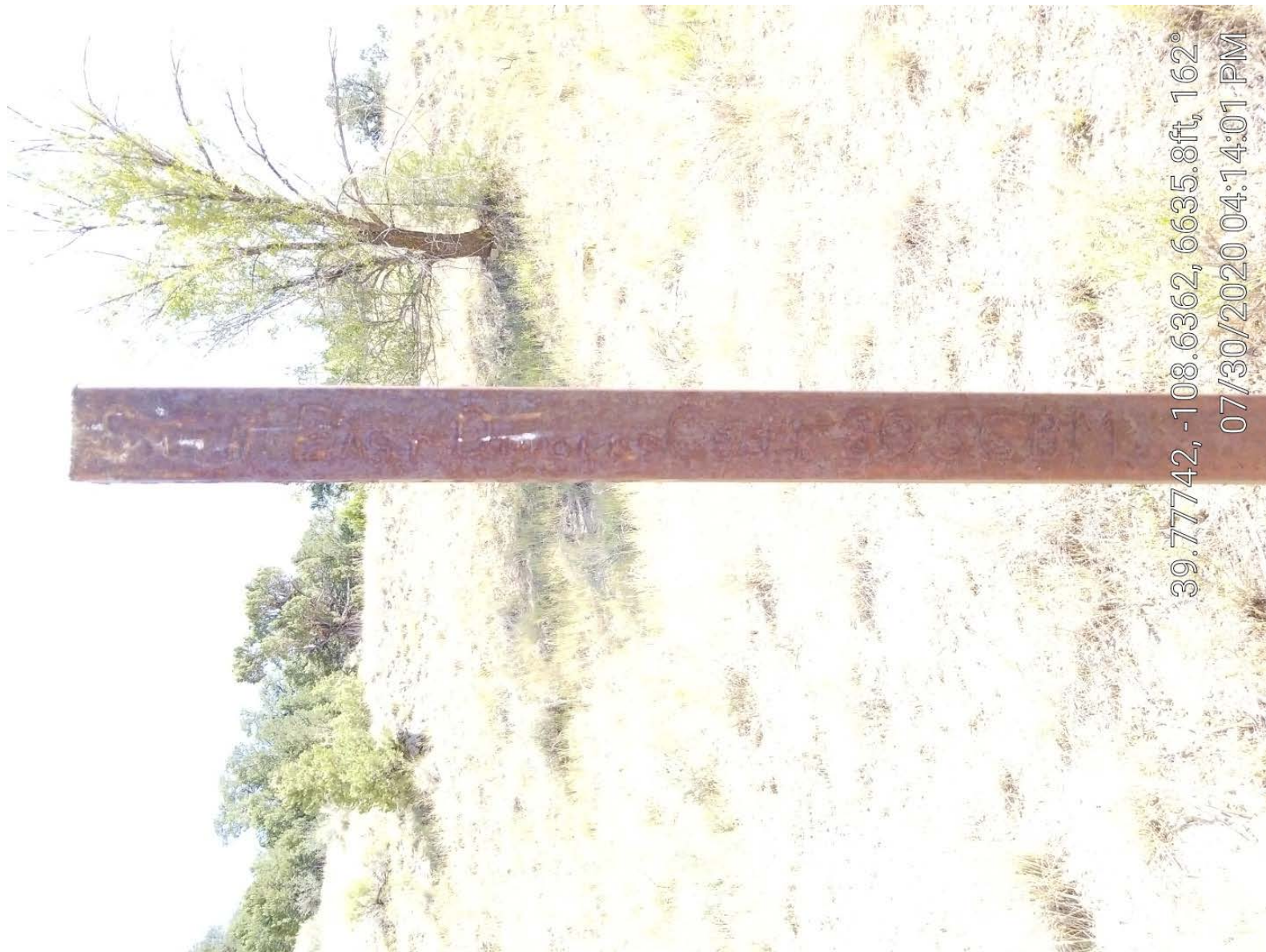

39.77742, -108.6362, 6635.8ft, 162°
07/30/2020 04:14:01 PM