

Great Western Operating Company, LLC

Location	Colorado	Slot	S08 - Tower LD 19-302HC
Field	Wattenburg	Well	Tower LD 19-302HC
Installation	Tower	Wellbore	Tower LD 19-302HC (PWB)

Created by	admin
Date plotted	15-Feb-2019
Plot reference is Tower LD 19-302HC (PWB).	
Ref wellpath is Tower LD 19-302HC (PWP#1).	
Coordinates are in Feet reference S08 - Tower LD 19-302HC.	
True Vertical Depths are reference Rig Datum.	
Measured Depths are reference Rig Datum.	
Rig Datum: Planned Datum #1	
Rig Datum to Mean Sea Level: 5259.60 ft.	
Plot North is aligned to TRUE North.	

Scale 1 cm = 400 ft

East (Feet) ->

-12000 -11200 -10400 -9600 -8800 -8000 -7200 -6400 -5600 -4800 -4000 -3200 -2400 -1600 -800 0 800 1600

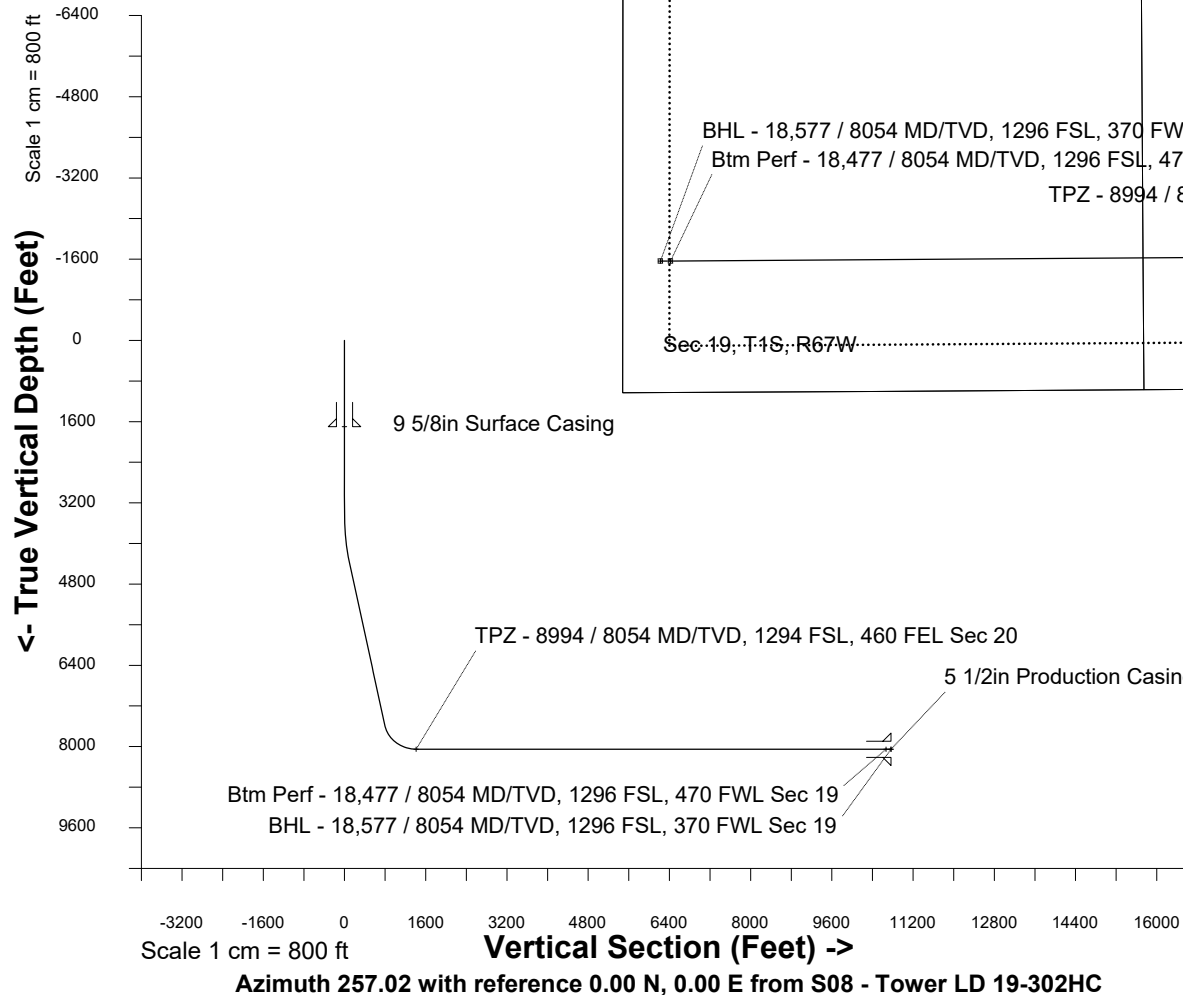

<- North(Feet)

Scale 1 cm = 400 ft

WELL PROFILE DATA								
Point	MD	Inc	Azi	TVD	North	East	deg/100ft	V. Sect
Tie on	0.00	0.00	0.00	0.00	S 0.00	W 0.00		-0.00
KOP	3416.00	0.00	189.15	3416.00	S 0.00	W 0.00	0.00	-0.00
End of Build	4416.00	30.00	189.15	4370.93	S 252.62	W 40.69	3.00	96.40
End of Hold	8141.49	30.00	189.15	7597.30	S 2091.66	W 336.92	0.00	798.18
Target TPZ - ...Sec 20	8994.02	90.00	269.62	8054.00	S 2355.44	W 906.19	10.00	1412.16
Target Btm Pe...Sec 19	18477.05	90.00	269.62	8054.00	S 2417.77	W 10389.01	0.00	10666.62
End of Turn	18478.99	90.00	269.82	8054.00	S 2417.78	W 10390.95	10.00	10668.51
T.D. & Target BHL.... 19	18577.14	90.00	269.82	8054.00	S 2418.09	W 10489.11	0.00	10764.23