



January 28, 2019

Colorado Oil & Gas Conservation Commission  
Attn: Mr. Jeff Robbins, Interim Director  
The Chancery Building  
1120 Lincoln, Street, Suite 801  
Denver, CO 80203

**RE: COGCC Rule 318A.e.: Proposed Spacing Unit**  
**Lochbuie Land 25H-D166 Pad: NWNW Sec 25, Township 1 North, Range 66 West**  
**Proposed Well(s): Lochbuie Land 2J-25H-D166 Doc # 401673118**  
**Weld County, CO**

Dear Director Murphy,

Crestone Peak Resources LLC ("Crestone") is planning to drill the above captioned well in accordance with the provisions of COGCC Rule 318A.e(6). Crestone's proposed spacing unit configuration consists of:

Township 1 North, Range 66 West  
S2N2 Sec 20

Containing 140 acres, more or less for the Niobrara and Codell formations.

Crestone is not the only owner within the proposed spacing unit, and as such provided notice to the remaining owner(s) within said proposed spacing unit as required under COGCC Rule 318A.e(6). The required thirty (30) day notice period has been waived by the owner(s) within the proposed spacing unit for this well.

Attached is a copy of the map illustrating the proposed wellbore spacing unit to assist you in your review and approval of Crestone's proposed APD for the captioned well. Also included is the 30 Day Notice Waiver.

Thank you for your time and attention to this matter. Crestone respectfully requests that the COGCC review the enclosed information and approval of the Sundry for the captioned well.

Sincerely,



Crestone Peak Resources

A handwritten signature in dark blue ink, appearing to read "Meghan Campbell".

Meghan Campbell  
Regulatory Analyst

\Enclosure

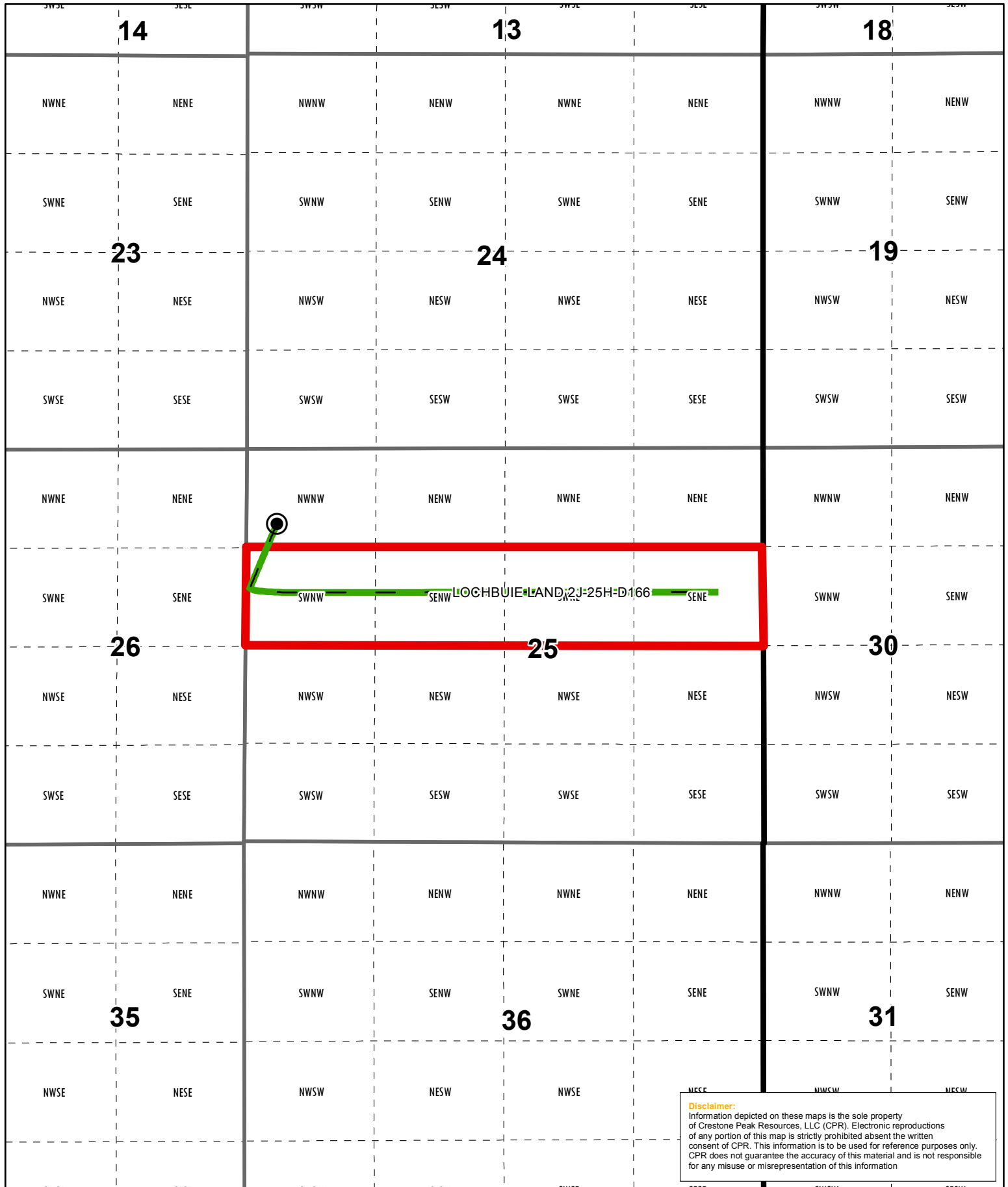

**Disclaimer:**  
 Information depicted on these maps is the sole property of Crestone Peak Resources, LLC (CPR). Electronic reproductions of any portion of this map is strictly prohibited absent the written consent of CPR. This information is to be used for reference purposes only. CPR does not guarantee the accuracy of this material and is not responsible for any misuse or misrepresentation of this information.

- Section QQ
- Crestone Well
- CO Township
- Spaced Wellbore
- CO Section
- Preliminary Proposed Spacing Unit

## Proposed Spacing Unit LOCHBUIE LAND 2J-25H-D166

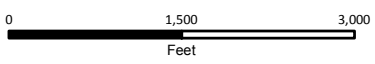

7/9/2018  
 ©Crestone Peak Resources GIS  
 Created by Julie Long

Coordinate System: GCS North American 1983



July 9, 2018

Kerr-McGee Oil & Gas Onshore, LP  
1099 18th Street, Suite 1800  
Denver, CO 80202  
ATTN: John Hasche

Via: Hand Delivery

RE: 30 Day Notice of Application Horizontal Wells  
Township 1 North, Range 66 West, Weld County  
Lochbuie Land 2J-25H-D166 and Lochbuie Land 2K-25H-D166

Dear Working Interest Owner:

Crestone Peak Resources ("Crestone") will soon file an Application for Permit to Drill with the Colorado Oil and Gas Conservation Commission ("COGCC") for each of the Wells listed on the Well Information Exhibit attached hereto. Crestone hereby gives Notice of the wells and the proposed spacing unit pursuant to COGCC Rule 318A.e.(5).

Crestone's preliminary title search reflects that you or your company owns a working interest in the proposed spacing units. Pursuant to COGCC Rule 318A.e.(5), you have thirty (30) days from the date of your receipt of this Notice to object in writing to the permitting of the well. If you have no objection with the proposed well locations and corresponding spacing units, please sign in the space provided below and return the enclosed Waiver of Notice Form as soon as possible.

Title Examination: To ensure complete title examination and identify all relevant title issues, please forward any title materials, including title opinions and pay decks relating to the lands within the horizontal spacing unit.

Land survey plats and a plat of corresponding spacing units which depict the proposed wellbore spacing units are enclosed with this letter.

If you should have any questions, please contact the undersigned at (720) 410-8543. Thank you for your timely consideration in this matter.

Sincerely,

*Laurie J. Wizeman*

Laurie J. Wizeman, RPL  
Land Negotiator

Enc: Waiver of Notice Form, Survey Plats, Spacing Unit Diagrams

1801 California Street, Suite 2500  
Denver, CO 80202  
Phone: 720 410 8500 Fax: 720 410 8510  
[www.crestonepeakresources.com](http://www.crestonepeakresources.com)



**Waiver of Notice Form**

July 9, 2018

Kerr-McGee Oil & Gas Onshore, LP  
1099 18th Street, Suite 1800  
Denver, CO 80202

RE: 30 Day Notice of Application Horizontal Wells  
Township 1 North, Range 66 West, Weld County  
Lochbuie Land 2J-25H-D166 and Lochbuie Land 2K-25H-D166

The undersigned hereby waives the thirty (30) day written notice requirement as specified in Rule 318A.e(6) for the captioned Well.

**KERR-MCGEE OIL & GAS ONSHORE, LP**

DocuSigned by:  
By: John H. Hasche  
400E3DA079904D5...  
Printed Name: John H. Hasche  
Title: Project Land Advisor  
Date: 7/19/2018

**Well Information Exhibit**  
**Respaced Lochbuie Land D, J, and K**

<b>Well Name</b>	<b>Proposed Surface Location</b>	<b>Horizontal Target Foramtion (s)</b>	<b>Productive Interval</b>	<b>Planned Wellbore Spacing Unit Weld County, CO</b>	<b>Wellbore Orientation</b>	<b>Planned Spud Date</b>
<b>Lochbuie Land 2D-25H-D166</b> KMG no longer has an interest in this well	928' FNL and 297' FWL, Section 25, T1N-R66W	Niobrara	From 742' FNL and 460' FWL Section 25, T1N-R66W To: 742' FNL and 460' FEL Section 25; T1N-	<u><b>T1N-R66W</b></u> Section 25: N2N2	West - East	Q3 2018
<b>Lochbuie Land 2J-25H-D166</b>	988' FNL and 297' FWL, Section 25, T1N-R66W	Codell	From 1904' FNL and 460' FWL Section 25, T1N-R66W To: 1904' FNL and 460' FEL Section 25, T1N- R66W	<u><b>T1N-R66W</b></u> Section 25: S2N2	West - East	Q3 2018
<b>Lochbuie Land 2K-25H-D166</b>	998' FNL and 297' FWL, Section 25, T1N-R66W	Niobrara	From 2062' FNL and 460' FWL Section 25, T1N-R66W To: 2062' FNL and 460' FEL Section 25, T1N- R66W	<u><b>T1N-R66W</b></u> Section 25: S2N2	West - East	Q3 2018

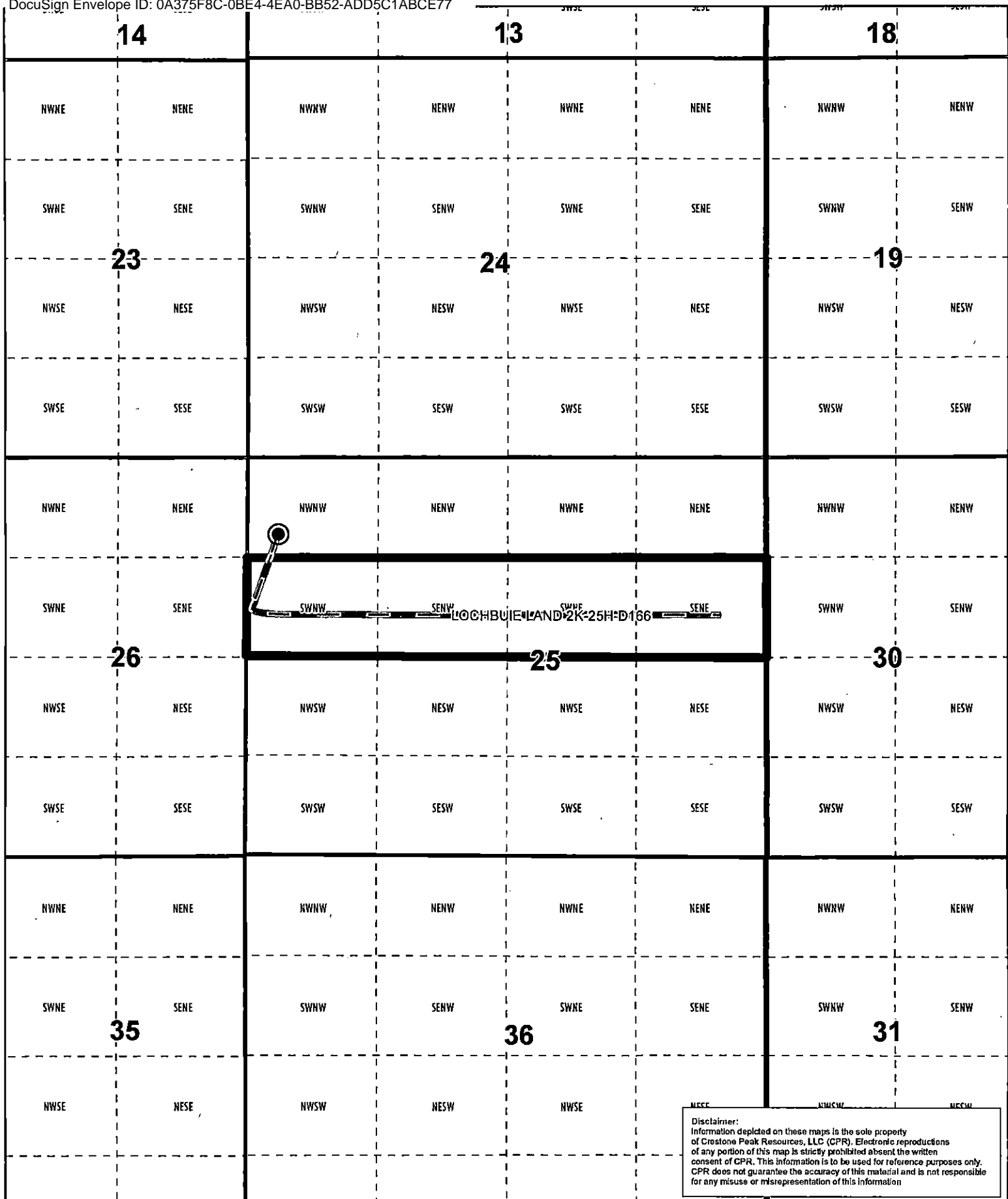

--- Section QQ

Crestone Well

CO Township

CO Section

Preliminary Proposed Spacing Unit

Spaced Wellbore

## Proposed Spacing Unit LOCHBUIE LAND 2K-25H-D166

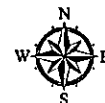

0 1,500 3,000  
Feet





7/9/2018  
©Crestone Peak Resources GIS  
Created by Julie Long



Coordinate System: GCS North American 1983

 Section QQ
  Crestone Well

 CO Township
  Spaced Wellbore

 CO Section

 Preliminary Proposed Spacing Unit

A horizontal scale bar labeled "Feet" with markings at 0, 1,500, and 3,000.

Coordinate System: GCS North American 1983



7/9/2018  
©Crestone Peak Resources GIS  
Created by Julie Long





# LOCHBUIE LAND 2J-25H-D166 WELL LOCATION EXHIBIT

3.25" ALUM CAP  
PLS 12405, 1998

N89°57'41"E 2644.89'

2.5" ALUM CAP  
28686, 1994

2.5" ALUM CAP  
PLS 25636, 2002

N89°55'51"E 2645.65'

LOCHBUIE LAND  
2J-25H-D166

S10°07'19"E  
930.15'

TPZ: 1904' FNL  
460' FWL

N89°56'46"E 4363.24'

BHL: 1904' FNL  
460' FEL

500°11'49"W 2642.55'

N00°01'20"W 2644.66'

2.5" ALUM CAP  
PLS 12405, 1998

3.25" ALUM CAP  
12405, 1998

# 25

SURFACE LOCATION:  
GROUND ELEVATION=5076'  
NAD83  
LATITUDE:40.026822° N  
LONGITUDE:104.733901° W

TOP OF PRODUCTION ZONE LOCATION:  
NAD83  
LATITUDE:40.024309° N  
LONGITUDE:104.733319° W

BOTTOM HOLE LOCATION:  
NAD83  
LATITUDE:40.024314° N  
LONGITUDE:104.717743° W

## NOTES:

BH LOCATION PROVIDED BY CLIENT.  
LAND SURFACE USE- RANGELAND  
SEE LOCATION DRAWING FOR ADDITIONAL  
IMPROVEMENTS WITHIN 500'

PDOP=1.3

GPS OPERATOR: IAN CARABAJAL

3.25" ALUM CAP  
PLS 12405, 1998

500°12'42"W 2642.47'

N00°01'19"W 2645.77'

3.25" ALUM CAP  
ILLEGIBLE, 2002

S89°53'00"W 2634.98'

S89°53'24"W 2634.67'

3.25" ALUM CAP  
PLS 26298, 2008

## LEGEND

- ⊕ = EXISTING MONUMENT    ⊕ = BOTTOM HOLE  
 ○ = CALCULATED POSITION    ▲ = TOP OF PRODUCTION ZONE  
 ● = PROPOSED WELL    TPZ = TOP OF PRODUCTION ZONE  
 ◆ = EXISTING WELL    BHL = BOTTOM HOLE LOCATION  
                                  WC = WITNESS CORNER

## NOTES

- THIS FIELD SURVEY CONFORMS TO THE MINIMUM STANDARDS SET BY THE C.O.G.C.C. RULE NO. 215
- ALL DISTANCES AND BEARINGS SHOWN HEREON ARE GROUND VALUES AS GPS MEASURED IN THE FIELD, WITH TIES TO WELLS MEASURED PERPENDICULAR TO LINES SHOWN HEREON. THIS LOW DISTORTION PROJECTION (LDP) IS BASED ON THE NORTH AMERICAN DATUM OF 1983, U.S. SURVEY FOOT WITH A LATITUDE ORIGIN OF 40.044013°N. A CENTRAL MERIDIAN LONGITUDE OF 104.772738°W, AND A SCALE FACTOR ON THE CENTRAL MERIDIAN OF 1.000238 (EXACT). THE LDP BASIS OF BEARINGS IS GEODETIC NORTH.
- FIELD VERIFICATION OF MONUMENTS COMPLETED WITHIN 1 YEAR OF SIGNATURE DATE, UNLESS OTHERWISE NOTED.

## WELL LOCHBUIE LAND 2J-25H-D166 TO BE LOCATED 988' FNL & 297' FWL

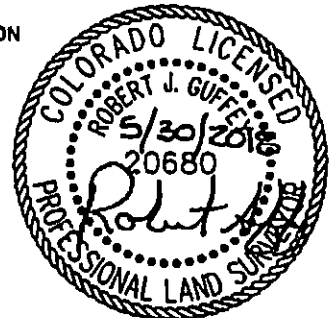

I, ROBERT J. GUFFEY, A LICENSED PROFESSIONAL LAND SURVEYOR IN THE STATE OF COLORADO, DO HEREBY STATE TO CRESTONE PEAK RESOURCES THAT THE WELL LOCATION EXHIBIT SHOWN HEREON WAS PREPARED BY ME OR UNDER MY DIRECT SUPERVISION AND THE DRAWING SHOWN HEREON ACCURATELY DEPICTS THE PROPOSED LOCATION OF THE WELL. THIS EXHIBIT MEETS THE REQUIREMENTS OF A GIS LAND POSITION AS DEFINED BY SECTION 38-51-102 (7.5) C.R.S. AND AS SUCH PER SECTION 38-51-109.3 C.R.S. CANNOT BE RELIED UPON TO DETERMINE OWNERSHIP.

ROBERT J. GUFFEY, PLS 20680  
COLORADO LICENSED PROFESSIONAL LAND SURVEYOR  
FOR AND ON BEHALF OF P.F.S., LLC  
d.b.a. ASCENT GEOMATICS SOLUTIONS



SHEET 1 OF 1

NOTICE: ACCORDING TO COLORADO LAW YOU MUST COMMENCE ANY LEGAL ACTION BASED UPON ANY DEFECT IN THIS SURVEY WITHIN THREE YEARS AFTER YOU FIRST DISCOVER SUCH DEFECT. IN NO EVENT MAY ANY ACTION BASED UPON ANY DEFECT IN THIS SURVEY BE COMMENCED MORE THAN TEN YEARS FROM THIS SAID DATE OF THIS CERTIFICATION SHOWN HEREON.

 <p>7333 Midway Circle Denver, CO 80221 (303) 928-7128 www.ascentgeomatics.com</p>	FIELD DATE: 04-30-18	WELL NAME: LOCHBUIE LAND 2J-25H-D166	PREPARED FOR:   <p>CRESTONE PEAK RESOURCES</p>
	DRAWING DATE: 05-29-18	SURFACE LOCATION: NW 1/4 NW 1/4 SEC. 25, T1N, R66W, 6TH P.M. WELD COUNTY, COLORADO	

# LOCHBUIE LAND 2K-25H-D166 WELL LOCATION EXHIBIT

3.25" ALUM CAP  
PLS 12405, 1998

2.5" ALUM CAP  
PLS 25636, 2002

N89°57'41"E 2644.89'

2.5" ALUM CAP  
28686, 1994

LOCHBUIE LAND  
2K-25H-D166

N00°01'20"W 2644.66'

297'

S08°44'40"E  
1076.18'

N89°56'46"E 4362.64'

TPZ: 2062' FNL  
460' FWL

BHL: 2062' FNL  
460' FEL

2.5" ALUM CAP  
PLS 12405, 1998

3.25" ALUM CAP  
12405, 1998

N00°01'19"W 2645.77'

SURFACE LOCATION:  
GROUND ELEVATION=5076'  
NAD83  
LATITUDE:40.026795° N  
LONGITUDE:104.733901° W

TOP OF PRODUCTION ZONE LOCATION:  
NAD83  
LATITUDE:40.023875° N  
LONGITUDE:104.733319° W

BOTTOM HOLE LOCATION:  
NAD83  
LATITUDE:40.023880° N  
LONGITUDE:104.717745° W

# 25

## NOTES:

BH LOCATION PROVIDED BY CLIENT.  
LAND SURFACE USE- RANGELAND  
SEE LOCATION DRAWING FOR ADDITIONAL  
IMPROVEMENTS WITHIN 500'

PDOP=1.5

GPS OPERATOR: IAN CARABAJAL

3.25" ALUM CAP  
PLS 12405, 1998

S00°12'42"W 2642.47'

3.25" ALUM CAP  
ILLEGIBLE, 2002

S89°53'00"W 2634.98'

S89°53'24"W 2634.67'

3.25" ALUM CAP  
PLS 26298, 2008

## LEGEND

- ⊕ = EXISTING MONUMENT    ⊕ = BOTTOM HOLE  
 ○ = CALCULATED POSITION    ▲ = TOP OF PRODUCTION ZONE  
 ● = PROPOSED WELL    TPZ = TOP OF PRODUCTION ZONE  
 ◆ = EXISTING WELL    BHL = BOTTOM HOLE LOCATION  
                                  WC = WITNESS CORNER

## NOTES

- THIS FIELD SURVEY CONFORMS TO THE MINIMUM STANDARDS SET BY THE C.O.G.C.C. RULE NO. 215
- ALL DISTANCES AND BEARINGS SHOWN HEREON ARE GROUND VALUES AS GPS MEASURED IN THE FIELD, WITH TIES TO WELLS MEASURED PERPENDICULAR TO LINES SHOWN HEREON. THIS LOW DISTORTION PROJECTION (LDP) IS BASED ON THE NORTH AMERICAN DATUM OF 1983, U.S. SURVEY FOOT WITH A LATITUDE ORIGIN OF 40,044,013"N. A CENTRAL MERIDIAN LONGITUDE OF 104,727,36"W, AND A SCALE FACTOR ON THE CENTRAL MERIDIAN OF 1.000238 (EXACT). THE LDP BASIS OF BEARINGS IS GEODEIC NORTH.
- FIELD VERIFICATION OF MONUMENTS COMPLETED WITHIN 1 YEAR OF SIGNATURE DATE, UNLESS OTHERWISE NOTED.

## WELL LOCHBUIE LAND 2K-25H-D166 TO BE LOCATED 998' FNL & 297' FWL

I, ROBERT J. GUFFEY, A LICENSED PROFESSIONAL LAND SURVEYOR IN THE STATE OF COLORADO, DO HEREBY STATE TO CRESTONE PEAK RESOURCES THAT THE WELL LOCATION EXHIBIT SHOWN HEREON WAS PREPARED BY ME OR UNDER MY DIRECT SUPERVISION AND THE DRAWING SHOWN HEREON ACCURATELY DEPICTS THE PROPOSED LOCATION OF THE WELL. THIS EXHIBIT MEETS THE REQUIREMENTS OF A GIS LAND POSITION AS DEFINED BY SECTION 38-51-102 (7.5) C.R.S. AND AS SUCH PER SECTION 38-51-109.3 C.R.S. CANNOT BE RELIED UPON TO DETERMINE OWNERSHIP.

ROBERT J. GUFFEY, PLS 20680  
COLORADO LICENSED PROFESSIONAL LAND SURVEYOR  
FOR AND ON BEHALF OF P.F.S., LLC  
d.b.a. ASCENT GEOMATICS SOLUTIONS

0 500 1000  
SCALE: 1" = 1000'

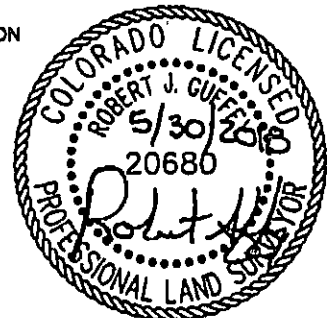

NOTICE: ACCORDING TO COLORADO LAW YOU MUST COMMENCE ANY LEGAL ACTION BASED UPON ANY DEFECT IN THIS SURVEY WITHIN THREE YEARS AFTER YOU FIRST DISCOVER SUCH DEFECT. IN NO EVENT MAY ANY ACTION BASED UPON ANY DEFECT IN THIS SURVEY BE COMMENCED MORE THAN TEN YEARS FROM THIS SAID DATE OF THIS CERTIFICATION SHOWN HEREON

SHEET 1 OF 1

<p>7335 Midway Circle Denver, CO 80221 (303) 918-7121 www.ascentgeomatics.com</p>	FIELD DATE: 04-30-18	WELL NAME: LOCHBUIE LAND 2K-25H-D166	PREPARED FOR <p>CRESTONE PEAK RESOURCES</p>
	DRAWING DATE: 05-29-18	SURFACE LOCATION: NW 1/4 NW 1/4 SEC. 25, T1N, R66W, 6TH P.M. WELD COUNTY, COLORADO	
BY: SMF	CHECKED: CLP		



Kerr-McGee Oil & Gas Onshore, LP  
1099 18th Street, Suite 1800  
Denver, CO 80202

### ACKNOWLEDGMENT OF RECEIPT

I hereby acknowledge the receipt of the following documents hand-delivered from Crestone Peak Resources LLC:

1. 30 Day Notice of Application Horizontal Wells  
Township 1 North, Range 66 West, Weld County  
Lochbuie Land 2J-25H-D166 and Lochbuie Land 2K-25H-D166

Elise Fuller

Signature

Elise Fuller

Printed Name

7/9/18

Date