

2115 117th Avenue
Greeley, CO 80634

Tel: 970.304.5000
Fax: 970.304.5099

www.nobleenergyinc.com



Land Department

October 25, 2018

Ms. Julie Murphy, Director
Colorado Oil and Gas Conservation Commission
1120 Lincoln Street, Suite 801
Denver, Colorado 80203

RE: **COGCC Rule 318A.e.: Proposed Spacing Unit**
DD06-14 Pad: SWSW Section 6, Township 3 North, Range 63 West
Proposed Wells: Guttersen DD18-785 (Doc #401804310), Guttersen DD18-775 (Doc #401804309), Guttersen DD18-770 (Doc #401804308), Guttersen DD18-765 (Doc #401804307), Guttersen DD18-754 (Doc #401804306),
DD06-15 Pad: SESE Section 6, Township 3 North, Range 63 West
Proposed Wells: Guttersen DD18-750 (Doc #401804305), Guttersen DD18-746 (Doc #401804304), Guttersen DD18-735 (Doc #401804303), Guttersen DD18-730 (Doc #401804302), Guttersen DD18-725 (Doc #401804301),
Guttersen DD18-715 (Doc #401804299)
Weld County, Colorado

Dear Director Murphy,

Noble Energy, Inc. (Noble) is planning to drill the above referenced wells in accordance with the provisions set out in Colorado Oil and Gas Conservation Commission (COGCC) Rule 318A.e. and Noble's Final Comprehensive Drilling Plan. Noble's Proposed Spacing Unit consists of:

Township 3 North, Range 63 West
Section 7: All
Section 18: All
Containing 1,280 acres, more or less

Noble is not the only owner within the Proposed Spacing Unit and has provided notice to the remaining owners, as required by COGCC Rule 318A.e.(6). Copies of the required notification letters are on file at Noble's office. The required thirty (30) day notice period has lapsed absent the receipt by Noble of any objection to their proposal by the owners within the Proposed Spacing Unit for the subject wells.

If you have any questions or issues, please do not hesitate to contact me at (303) 228-4209 or Matthew.Otness@nblenergy.com should you have any questions.

Very truly yours,

NOBLE ENERGY, INC.

A handwritten signature in blue ink, appearing to read 'Matthew Otness'.

Matthew Otness
Land Supervisor

DD06-14 PAD & DD06-15 PAD
PROPOSED 318A.a.(4)D. SPACING UNIT
T3N R63W SEC. 7 & 18

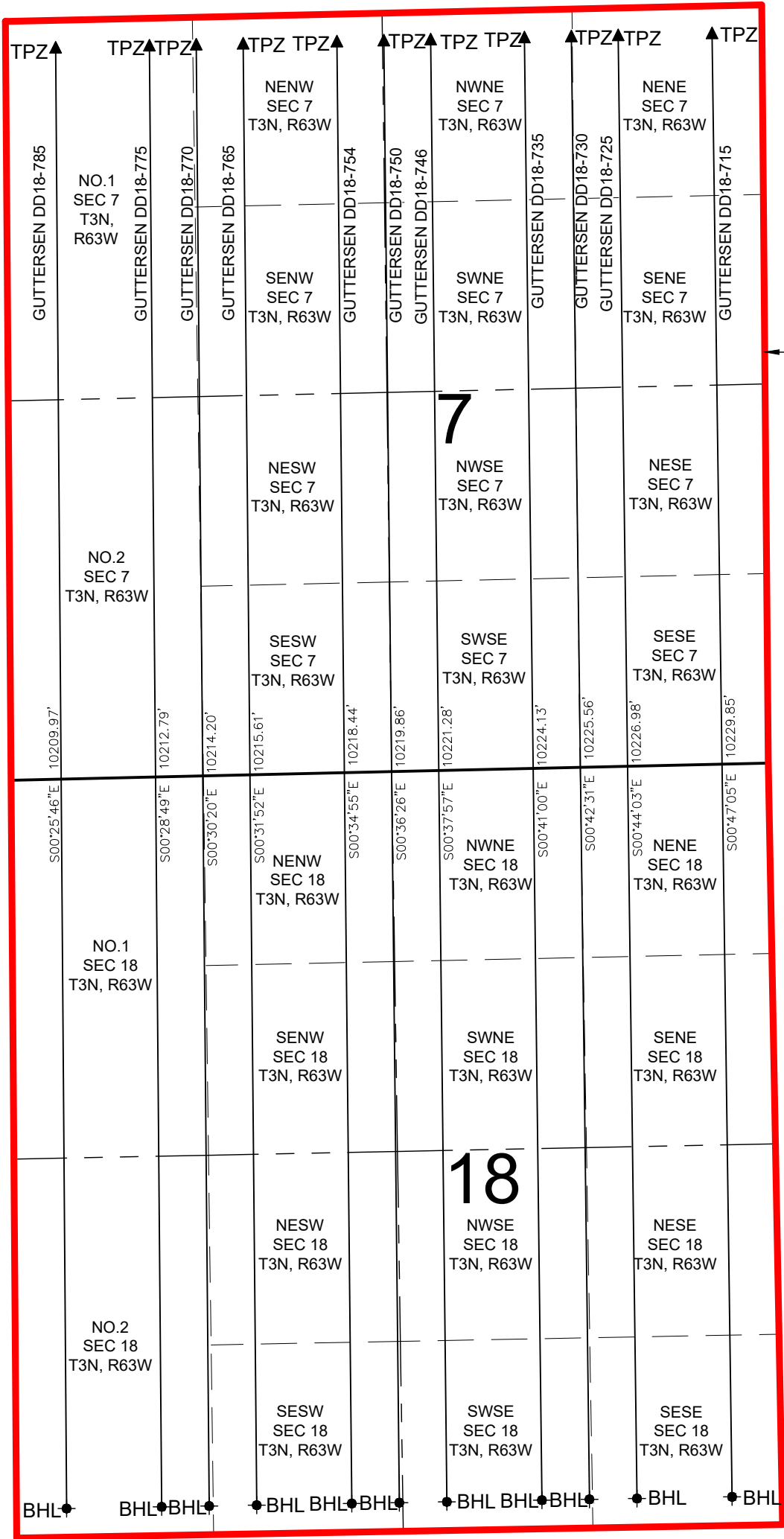
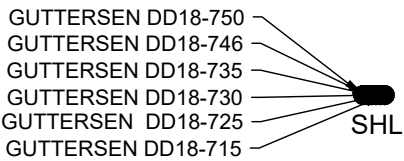
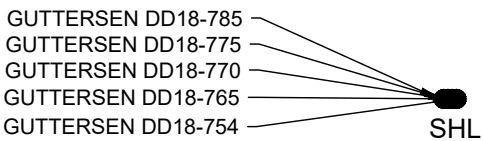

PROPOSED WELLBORE
SPACING UNIT

GUTTERSEN DD18-785 SHL TO BE LOCATED 472' FSL AND 1259' FWL
GUTTERSEN DD18-775 SHL TO BE LOCATED 471' FSL AND 1281' FWL
GUTTERSEN DD18-770 SHL TO BE LOCATED 471' FSL AND 1304' FWL
GUTTERSEN DD18-765 SHL TO BE LOCATED 470' FSL AND 1326' FWL
GUTTERSEN DD18-754 SHL TO BE LOCATED 470' FSL AND 1349' FWL
GUTTERSEN DD18-750 SHL TO BE LOCATED 434' FSL AND 1377' FEL

GUTTERSEN DD18-746 SHL TO BE LOCATED 433' FSL AND 1354' FEL
GUTTERSEN DD18-735 SHL TO BE LOCATED 433' FSL AND 1332' FEL
GUTTERSEN DD18-730 SHL TO BE LOCATED 432' FSL AND 1309' FEL
GUTTERSEN DD18-725 SHL TO BE LOCATED 432' FSL AND 1287' FEL
GUTTERSEN DD18-715 SHL TO BE LOCATED 431' FSL AND 1264' FEL

LEGEND

- = PROPOSED WELL
- = BOTTOM HOLE
- ▲ = TOP OF PRODUCTION ZONE

SHL = SURFACE HOLE LOCATION
BHL = BOTTOM HOLE LOCATION
TPZ = TOP OF PRODUCTION ZONE

DISCLAIMER:
THIS PLOT DOES NOT REPRESENT A MONUMENTED LAND SURVEY AND SHOULD NOT BE
RELIED UPON TO DETERMINE BOUNDARY LINES, PROPERTY OWNERSHIP OR OTHER
PROPERTY INTERESTS, PARCEL LINES, IF DEPICTED HAVE NOT BEEN FIELD VERIFIED AND
MAY BE BASED UPON PUBLICLY AVAILABLE DATA THAT ALSO HAS NOT BEEN
INDEPENDENTLY VERIFIED.

