

2115 117th Avenue
Greeley, CO 80634

Tel: 970.304.5000
Fax: 970.304.5099
www.nobleenergyinc.com



Land Department

October 26, 2018

Ms. Julie Murphy, Director
Colorado Oil and Gas Conservation Commission
1120 Lincoln Street, Suite 801
Denver, Colorado 80203

RE: **COGCC Rule 318A.e.: Proposed Spacing Unit**
C30-07 Multi Pad: SWNE Section 30, Township 4 North, Range 64 West
Proposed Wells: Johnson D06- 730 (Doc #401786862), Johnson D06-734 (Doc #401786861), Johnson D06-744
(Doc #401786860), Johnson D06-756 (Doc #401786856), Johnson D06-761 (Doc #401786855), Johnson D06-766
(Doc #401786854), Johnson D06-777 (Doc #401786848), Johnson D06-785 (Doc #401786847)
Weld County, Colorado

Dear Director Murphy,

Noble Energy, Inc. (Noble) is planning to drill the above referenced wells in accordance with the provisions set out in Colorado Oil and Gas Conservation Commission (COGCC) Rule 318A.e. and Noble's Final Comprehensive Drilling Plan. Noble's Proposed Spacing Unit consists of:

Township 4 North, Range 64 West

Section 30: S2

Section 31: All

Township 3 North, Range 64 West

Section 6: All

Containing 1,600 acres, more or less

Noble is not the only owner within the Proposed Spacing Unit and has provided notice to the remaining owners, as required by COGCC Rule 318A.e.(6). Copies of the required notification letters are on file at Noble's office. The required thirty (30) day notice period has lapsed absent the receipt by Noble of any objection to their proposal by the owners within the Proposed Spacing Unit for the subject wells.

If you have any questions or issues, please do not hesitate to contact me at (303) 228-4209 or Matthew.Otness@nblenergy.com should you have any questions.

Very truly yours,

NOBLE ENERGY, INC.

A handwritten signature in blue ink, appearing to read 'Matthew Otness'.

Matthew Otness
Land Supervisor

C30-07 PAD & C30-08 PAD
PROPOSED 318A.a.(4)D. SPACING UNIT
T4N R64W SEC. 30: S2
T4N R64W SEC. 31
T3N R64W SEC. 6

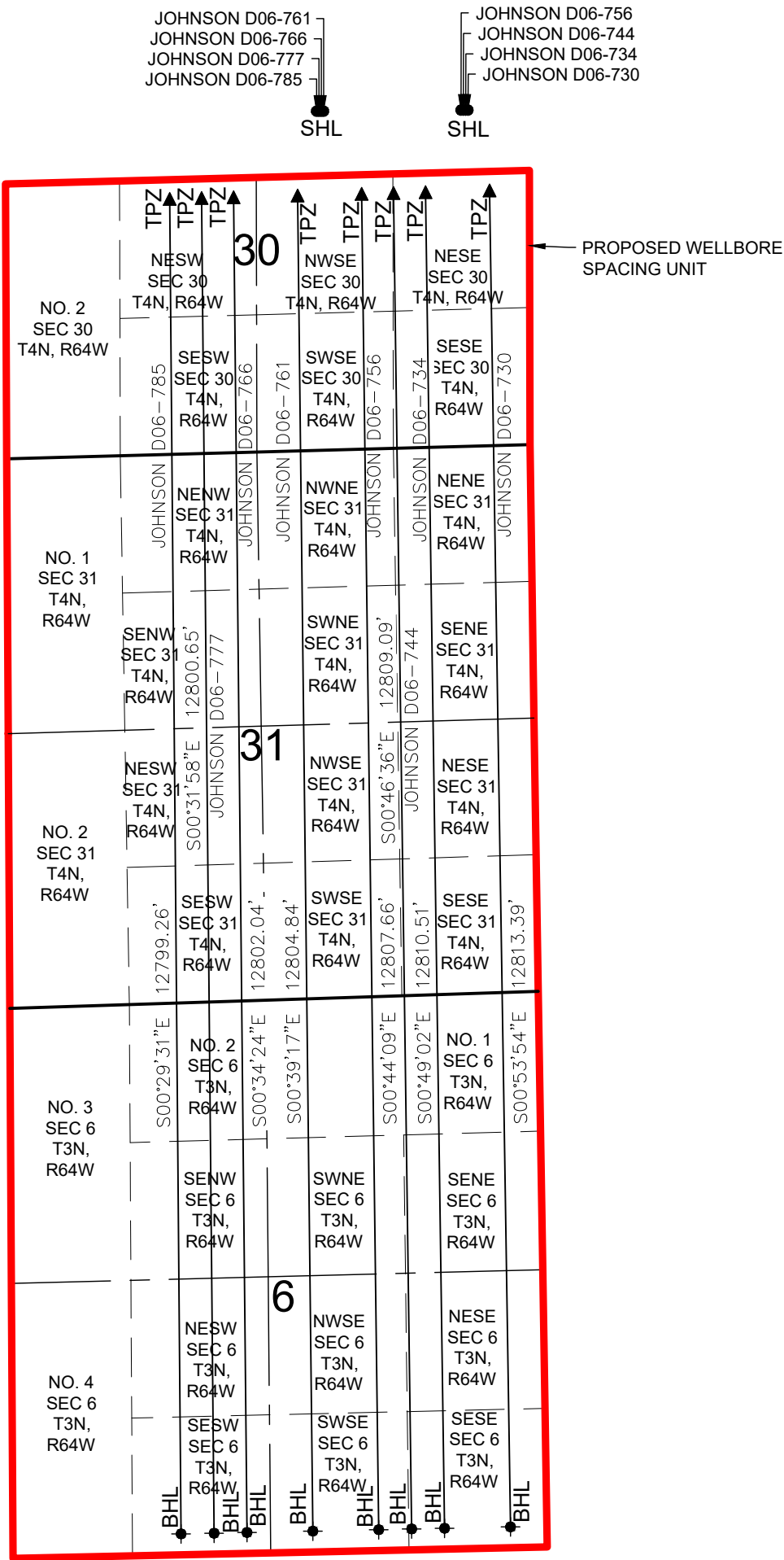

JOHNSON D06-785 SHL TO BE LOCATED 2011' FNL AND 2046' FEL
JOHNSON D06-777 SHL TO BE LOCATED 2012' FNL AND 2023' FEL
JOHNSON D06-766 SHL TO BE LOCATED 2012' FNL AND 2001' FEL
JOHNSON D06-761 SHL TO BE LOCATED 2013' FNL AND 1978' FEL

JOHNSON D06-756 SHL TO BE LOCATED 2037' FNL AND 655' FEL
JOHNSON D06-744 SHL TO BE LOCATED 2037' FNL AND 633' FEL
JOHNSON D06-734 SHL TO BE LOCATED 2038' FNL AND 610' FEL
JOHNSON D06-730 SHL TO BE LOCATED 2038' FNL AND 588' FEL

LEGEND

● = PROPOSED WELL
● = BOTTOM HOLE
▲ = TOP OF PRODUCTION ZONE

SHL = SURFACE HOLE LOCATION
BHL = BOTTOM HOLE LOCATION
TPZ = TOP OF PRODUCTION ZONE

DISCLAIMER:
THIS PLOT DOES NOT REPRESENT A MONUMENTED LAND SURVEY AND SHOULD NOT BE
RELIED UPON TO DETERMINE BOUNDARY LINES, PROPERTY OWNERSHIP OR OTHER
PROPERTY INTERESTS. PARCEL LINES, IF DEPICTED HAVE NOT BEEN FIELD VERIFIED AND
MAY BE BASED UPON PUBLICLY AVAILABLE DATA THAT ALSO HAS NOT BEEN
INDEPENDENTLY VERIFIED.

