

Y05-13 FACILITY, Y05-13 PAD & Y05-15 PAD
LOCATION DRAWING

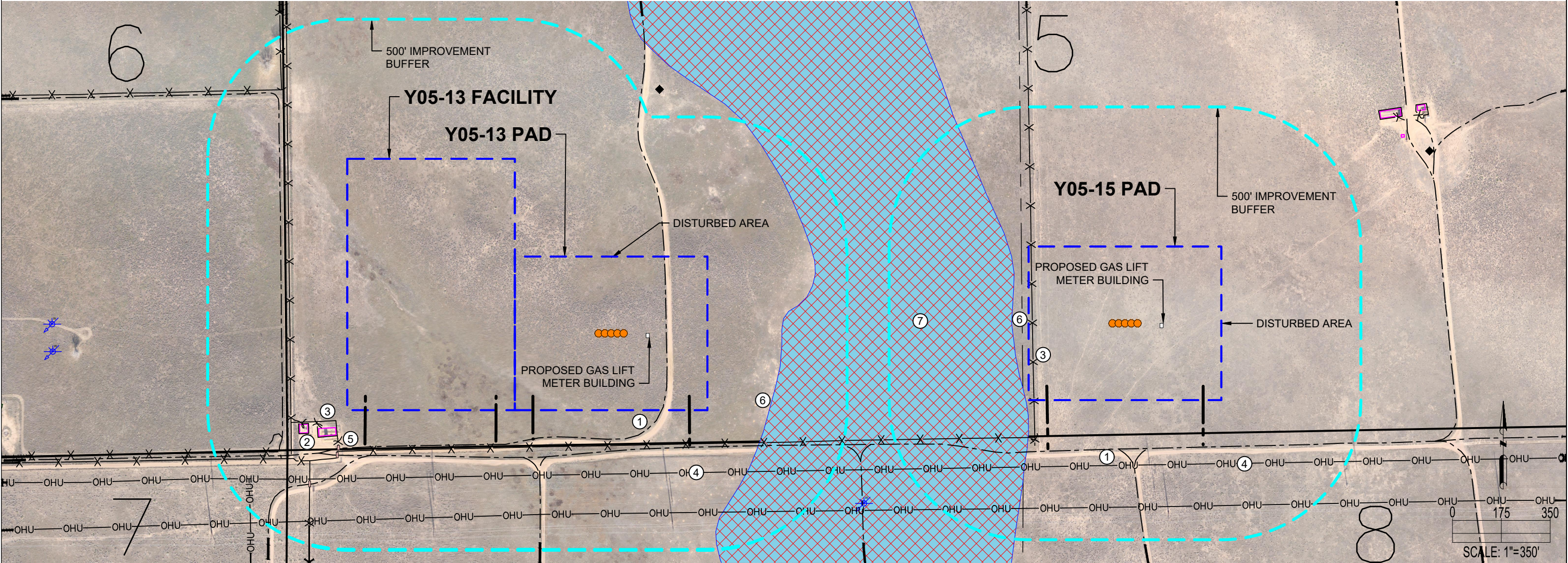

Y05-13 FACILITY & Y05-13 PAD

| IMPROVEMENTS: (AS MEASURED FROM THE PROPOSED EDGE OF DISTURBANCE) | |
|----------------------------------------------------------------------|-----------------------------------------------------------------------------|
| 1. PRIVATE ROAD: | 0', ±131' S, ±163' S, ±213' W, ±231' W, ±231' S, ±274' SW |
| 2. EXISTING PRODUCTION EQUIPMENT (NOBLE): | ±75' SW, ±150' SW |
| 3. FENCE: | ±55' SW, ±120' S, ±147' SW, ±175' SW, ±202± W, ±226' SW, ±313± SW, ±337' NW |
| 4. OVERHEAD UTILITY: | ±223' S, ±366' S, ±430' SW |
| 5. CATTLE GUARD: | ±129' SW, ±155' SW, ±285' SW |
| 6. FLOODPLAIN: | ±214' E |
| 7. INTERMITTENT STREAM: | N/A |
| PROPERTY LINE: | ±115' S, ±216' W, ±258' SW |

Y05-15 PAD

| IMPROVEMENTS: (AS MEASURED FROM THE PROPOSED EDGE OF DISTURBANCE) | |
|----------------------------------------------------------------------|------------------|
| 1. PRIVATE ROAD: | ±166' S, ±238' S |
| 2. EXISTING PRODUCTION EQUIPMENT (NOBLE): | N/A |
| 3. FENCE: | 0', ±133' S |
| 4. OVERHEAD UTILITY: | ±227' S, ±378' S |
| 5. CATTLE GUARD: | N/A |
| 6. FLOODPLAIN: | ±10' W |
| 7. INTERMITTENT STREAM: | ±415' W |
| PROPERTY LINE: | ±20' W , ±177' S |

DISCLAIMER:
THIS PLOT DOES NOT REPRESENT A MONUMENTED LAND SURVEY AND SHOULD NOT BE RELIED UPON TO DETERMINE BOUNDARY LINES, PROPERTY OWNERSHIP OR OTHER PROPERTY INTERESTS. PARCEL LINES, IF DEPICTED HAVE NOT BEEN FIELD VERIFIED AND MAY BE BASED UPON PUBLICLY AVAILABLE DATA THAT ALSO HAS NOT BEEN INDEPENDENTLY VERIFIED.

CURRENT SURFACE USE: RANGELAND
FUTURE SURFACE USE: RANGELAND

7535 Hilltop Circle
Denver, CO 80221
(303) 928-7128
www.ascentgeomatics.com

FIELD DATE:
09-22-18

DRAWN BY:
VQD

DRAWING DATE:
10-09-18

CHECKED BY:
RMC

SITE NAME:
Y05-13 FACILITY, Y05-13 PAD & Y05-15 PAD

SURFACE LOCATION:
SEC. 5, T2N, R64W, 6TH P.M.
WELD COUNTY, COLORADO

DATA SOURCE:
AERIAL IMAGERY: ASCENT 11/2017
WATER WELLS: COLORADO DWR
NHD: USGS

PUBLICLY AVAILABLE DATA SOURCES HAVE NOT BEEN INDEPENDENTLY VERIFIED BY ASCENT.

LEGEND:

- PROPOSED WELL
- EXISTING WELL
- FENCE
- OVERHEAD UTILITY
- WATER WELL
- STREAM
- EXISTING ROAD
- DISTURBANCE AREA
- 500' RADIUS
- EXISTING FACILITY
- CATTLE GAURD
- FLOODPLAIN
- ACCESS ROAD
- SECTION LINE
- CENTER SECTION LINE

EXHIBIT M

Mustang CDP Econode multi-well facility capable of handling up to 32 wells

