

T1N, R66W

NW. COR.
SEC. 23, T1N, R66W
FOUND 2 1/2" ALUM. CAP
L.S. NO. 30120

S 89°32'58" W 2653.78' (M)

S 89°35'35" W 2653.13' (M)

N. 1/4 COR.
SEC. 23, T1N, R66W
FOUND 1 1/4" AXLE

BOTTOM OF HOLE:
27' FNL & 335' FEL

NE. COR.
SEC. 23, T1N, R66W
FOUND 2 1/2" ALUM. CAP
P.L.S. NO. 28656

SURFACE LOCATION: NAD 83
GROUND ELEVATION= 5120.4'
LATITUDE= 40.028279°
LONGITUDE= -104.740974°
LATITUDE= 40°01'41.806"
LONGITUDE= -104°44'27.508"
HEEL LOCATION: NAD 83
LATITUDE= 40.029664°
LONGITUDE= -104.735910°
LATITUDE= 40°01'46.789"
LONGITUDE= -104°44'09.277"
BOTTOM HOLE LOCATION: NAD 83
LATITUDE= 40.043917°
LONGITUDE= -104.736156°
LATITUDE= 40°02'38.101"
LONGITUDE= -104°44'10.162"

23

W. 1/4 COR.
SEC. 23, T1N, R66W
FOUND 2" ALUM. CAP
L.S. NO. 23027

S 89°34'58" W
2650.52' (M)

CENTER 1/4 COR.
SEC. 23, T1N, R66W
FOUND 1 1/2" ALUM. CAP
L.S. NO. 2682

S 89°35'38" W
2650.66' (M)

E. 1/4 COR.
SEC. 23, T1N, R66W
FOUND 2 1/2" ALUM. CAP
P.L.S. NO. 37552

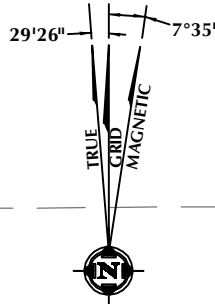

N 00°36'09" W 2630.74' (M)

N 00°33'12" W
2631.70' (M)

N 00°29'54" W 2632.86' (M)

NW. COR.
SEC. 26, T1N, R66W
FOUND 3 1/4" ALUM. CAP
P.L.S. NO. 13155

S 89°36'13" W 2648.25' (M)

N. 1/4 COR.
SEC. 26, T1N, R66W
FOUND 3 1/4" ALUM. CAP
L.S. NO. 12330

S 89°37'08" W 2648.14' (M)

NE. COR.
SEC. 26, T1N, R66W
FOUND 2 1/2" ALUM. CAP
P.L.S. NO. 25636

N 00°30'01" W
2675.59' (M)

W. 1/4 COR.
SEC. 26, T1N, R66W
FOUND 3 1/4" ALUM. CAP
L.S. NO. 25937

CENTER 1/4 COR.
SEC. 26, T1N, R66W
FOUND 3 1/4" ALUM. CAP
L.S. NO. 22098

N 00°27'28" W
2664.88' (M)N 00°29'30" W
2643.82' (M)**CERTIFICATE OF SURVEYOR:**

THIS IS TO CERTIFY THAT THE ABOVE PLAT WAS PREPARED FROM FIELD NOTES OF ACTUAL SURVEYS MADE BY ME OR UNDER MY SUPERVISION AND THAT THE SAME ARE TRUE AND CORRECT TO THE BEST OF MY KNOWLEDGE AND BELIEF. THIS CERTIFICATE DOES NOT REPRESENT A LAND SURVEY PLAT OR IMPROVEMENT SURVEY PLAT AS DEFINED BY C.R.S. 38-5-102 AND CANNOT BE RELIED UPON TO DETERMINE OWNERSHIP.

Randall K. French
5/23/18
RANDALL K. FRENCH
PROFESSIONAL LAND SURVEYOR
COLORADO REGISTRATION NUMBER 38512

NOTICE:
ACCORDING TO COLORADO STATE LAW YOU MUST COMMENCE LEGAL ACTION BASED UPON ANY DEFECT IN THIS SURVEY WITHIN THREE YEARS AFTER YOU FIRST DISCOVER SUCH DEFECT. IN NO EVENT MAY ANY ACTION BASED UPON ANY DEFECT IN THIS SURVEY BE COMMENCED MORE THAN TEN YEARS FROM THE DATE ON THE CERTIFICATION SHOWN HEREON.

BEIERLE 26-16HZ
SURFACE LOCATION

NOTE:
MAGNETIC NORTH IS CURRENT AS OF 5/7/2018.
MAGNETIC NORTH CHANGES WEST 0°06' PER YEAR.

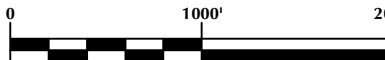

SCALE: 1" = 1000'

NOTES:

- ▲ INDICATES SECTION CORNER.
- INDICATES CALCULATED CORNER.
- ELEVATION BASED ON NAVD88 (GEOID12B).
- BASIS OF BEARING DERIVED FROM COLORADO COORDINATE SYSTEM OF 1983 NORTH ZONE.
- ALL MEASURED DISTANCES ARE GRID.
- COMBINED SCALE FACTOR: .99972212 CALCULATED FROM THE N. 1/4 CORNER OF SECTION 26, T1N, R66W.
- OPERATOR: PRESTON KNUSTEN / PDOP = 1.3.
- SEE ADDENDUM TO WELL LOCATION CERTIFICATE FOR EXISTING IMPROVEMENTS WITHIN 500' OF THE WELL PAD.
- WELL FOOTAGES ARE MEASURED AT RIGHT ANGLES TO THE SECTION LINES.
- THE BOTTOM OF HOLE BEARS N01°15'10"W, 5193' FROM THE HEEL LOCATION.

WELL PAD - BEIERLE 2-26HZ

BEIERLE 26-16HZ
WELL LOCATION CERTIFICATE
460' FNL & 1684' FEL NWNE (SURFACE)
LOCATED IN SECTION 26
47' FSL & 266' FEL SESE (HEEL)
27' FNL & 335' FEL NENE (BOTTOM)
LOCATED IN SECTION 23
T1N, R66W, 6TH P.M.
WELD COUNTY, COLORADO

**Kerr-McGee Oil &
Gas Onshore L.P.**
1099 18th Street
Denver, Colorado 80202

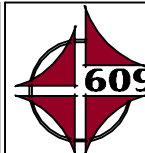
**CONSULTING, LLC**

SHERIDAN OFFICE
1095 Saberton Avenue
Sheridan, Wyoming 82801
Phone 307-674-0609

LOVELAND OFFICE
1635 Foxtrail Drive, Suite 204
Loveland, Colorado 80538
Phone 970-776-4331

DRAFTED BY:	LMO	CHECKED BY:	RKF
DATE DRAFTED:	5/23/18	DATE SURVEYED:	5/7/18
REVISED:		FILE NAME:	17-102