

BAYSWATER E & P LLC



Location: COLORADO Slot: SLOT#13 G & D HANKS V-27-28HN (1168'FSL & 1575'FEL,SEC.27)
Field: WELD COUNTY (NAD83/TRUE NORTH) Well: G & D HANKS V-27-28HN
Facility: SEC.27-T07N-R66W Wellbore: G & D HANKS V-27-28HN PWB

Plot reference wellpath is G & D HANKS V-27-28HN PWP (REV-D.0)

Grid System: NAD83 / Lambert Colorado SP, Northern Zone (501), US feet

True vertical depths are referenced to TRUE 38 (4876'GL + 25'KB @ 4901'RKB) (RKB)

North Reference: True north

Measured depths are referenced to TRUE 38 (4876'GL + 25'KB @ 4901'RKB) (RKB)

Scale: True distance

TRUE 38 (4876'GL + 25'KB @ 4901'RKB) (RKB) to Mean Sea Level: 4901 feet

Depths are in feet

Mean Sea Level to Ground level (At Slot: SLOT#13 G & D HANKS V-27-28HN (1168'FSL & 1575'FEL,SEC.27)): 0 feet

Created by: bushjamh on 2018-06-20

Coordinates are in feet referenced to Slot

Database: Denver

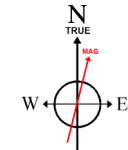

BGGM (1900.0 to 2019.0) Dip: 66.03° Field: 52391.6 nT
Magnetic North is 8.31 degrees East of True North (at 5/1/2018)

To correct azimuth from Magnetic to True add 8.31 degrees

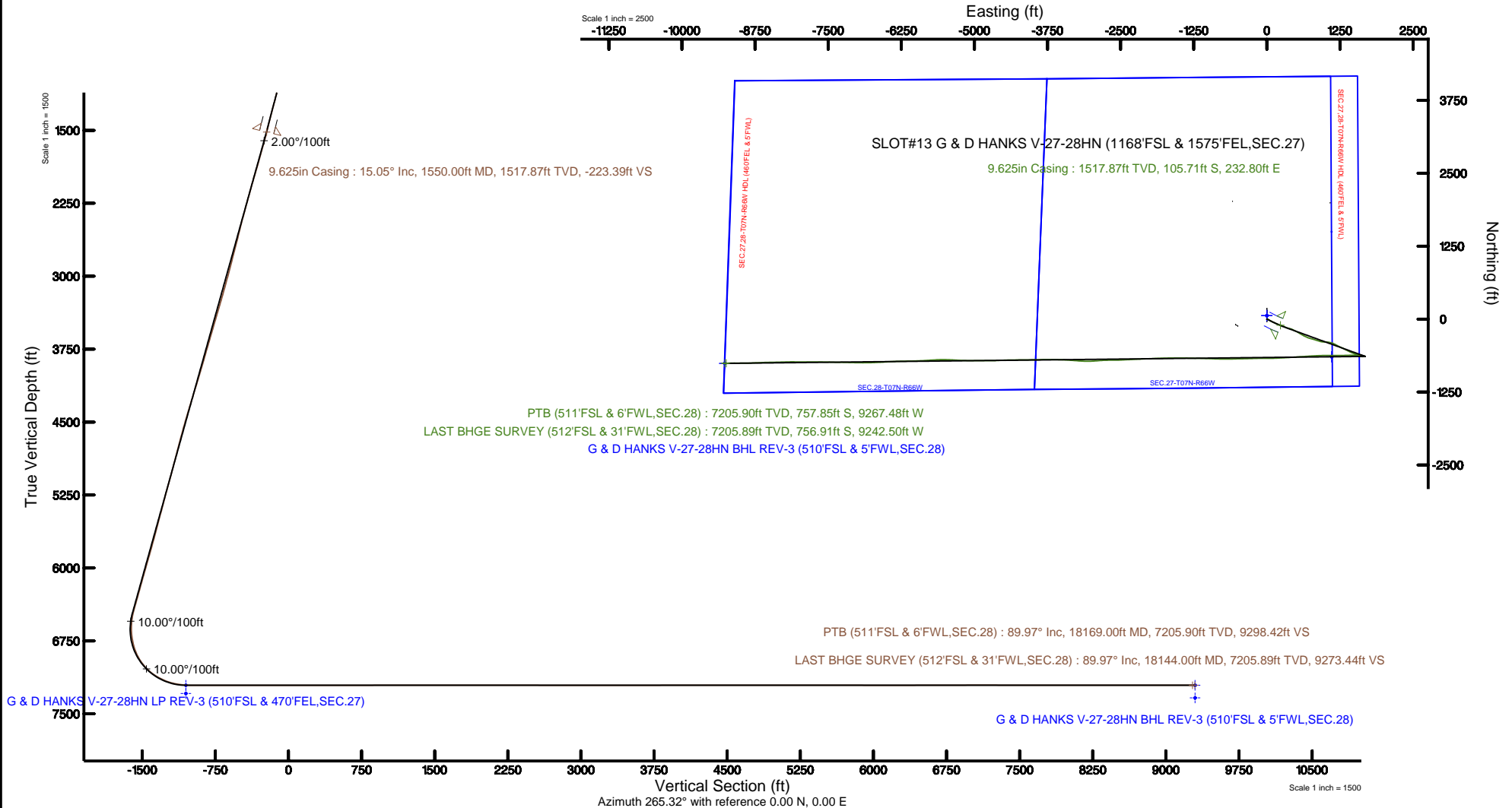

Actual Wellpath Report

G & D HANKS V-27-28HN AWP

Page 1 of 10

REFERENCE WELLPATH IDENTIFICATION			
Operator	BAYSWATER E & P LLC	Slot	SLOT#13 G & D HANKS V-27-28HN (1168'FSL & 1575'FEL,SEC.27)
Area	COLORADO	Well	G & D HANKS V-27-28HN
Field	WELD COUNTY (NAD83/TRUE NORTH)	Wellbore	G & D HANKS V-27-28HN AWB
Facility	SEC.27-T07N-R66W		

REPORT SETUP INFORMATION			
Projection System	NAD83 / Lambert Colorado SP, Northern Zone (501), US feet	Software System	WellArchitect® 5.1
North Reference	True	User	Bushjamh
Scale	0.999970	Report Generated	6/20/2018 at 12:10:57 PM
Convergence at slot	0.48° East	Database/Source file	Denver/G__D_HANKS_V-27-28HN_AWP.xml

WELLPATH LOCATION						
	Local coordinates		Grid coordinates		Geographic coordinates	
	North[ft]	East[ft]	Easting[US ft]	Northing[US ft]	Latitude	Longitude
Slot Location	-179.97	-0.28	3205704.38	1441122.57	40°32'30.930"N	104°45'35.474"W
Facility Reference Pt			3205703.16	1441302.53	40°32'32.708"N	104°45'35.471"W
Field Reference Pt			3174587.00	1430859.71	40°30'51.890"N	104°52'19.470"W

WELLPATH DATUM			
Calculation method	Minimum curvature	TRUE 38 (4876'GL + 25'KB @ 4901'RKB) (RKB) to Facility Vertical Datum	4901.00ft
Horizontal Reference Pt	Slot	TRUE 38 (4876'GL + 25'KB @ 4901'RKB) (RKB) to Mean Sea Level	4901.00ft
Vertical Reference Pt	TRUE 38 (4876'GL + 25'KB @ 4901'RKB) (RKB)	TRUE 38 (4876'GL + 25'KB @ 4901'RKB) (RKB) to Ground Level at Slot (SLOT#13 G & D HANKS V-27-28HN (1168'FSL & 1575'FEL,SEC.27))	4901.00ft
MD Reference Pt	TRUE 38 (4876'GL + 25'KB @ 4901'RKB) (RKB)	Section Origin	N 0.00, E 0.00 ft
Field Vertical Reference	Mean Sea Level	Section Azimuth	265.33°

Actual Wellpath Report

G & D HANKS V-27-28HN AWP

Page 2 of 10

REFERENCE WELLPATH IDENTIFICATION

Operator	BAYSWATER E & P LLC	Slot	SLOT#13 G & D HANKS V-27-28HN (1168'FSL & 1575'FEL,SEC.27)
Area	COLORADO	Well	G & D HANKS V-27-28HN
Field	WELD COUNTY (NAD83/TRUE NORTH)	Wellbore	G & D HANKS V-27-28HN AWP
Facility	SEC.27-T07N-R66W		

WELLPATH DATA (192 stations) † = interpolated/extrapolated station

MD [ft]	Inclination [°]	Azimuth [°]	TVD [ft]	Vert Sect [ft]	North [ft]	East [ft]	Latitude	Longitude	DLS [°/100ft]	Comments
0.00†	0.000	334.660	0.00	0.00	0.00	0.00	40°32'30.930"N	104°45'35.474"W	0.00	
25.00	0.000	334.660	25.00	0.00	0.00	0.00	40°32'30.930"N	104°45'35.474"W	0.00	
137.00	0.500	334.660	137.00	0.17	0.44	-0.21	40°32'30.934"N	104°45'35.477"W	0.45	
232.00	0.250	314.020	232.00	0.46	0.96	-0.54	40°32'30.939"N	104°45'35.481"W	0.30	
326.00	1.210	114.060	325.99	-0.28	0.70	0.22	40°32'30.937"N	104°45'35.472"W	1.54	
421.00	2.770	114.090	420.93	-3.17	-0.65	3.23	40°32'30.924"N	104°45'35.432"W	1.64	
515.00	4.610	110.640	514.73	-8.58	-2.91	8.84	40°32'30.901"N	104°45'35.360"W	1.97	
610.00	7.150	112.920	609.22	-17.27	-6.56	17.86	40°32'30.865"N	104°45'35.243"W	2.68	
705.00	10.020	119.030	703.15	-29.39	-12.87	30.54	40°32'30.803"N	104°45'35.079"W	3.17	
799.00	12.780	118.180	795.29	-44.93	-21.75	46.86	40°32'30.715"N	104°45'34.867"W	2.94	
894.00	14.760	118.130	887.55	-63.93	-32.42	66.79	40°32'30.610"N	104°45'34.609"W	2.08	
988.00	15.810	115.900	978.23	-85.02	-43.66	88.87	40°32'30.499"N	104°45'34.323"W	1.28	
1083.00	17.270	116.180	1069.29	-108.27	-55.53	113.17	40°32'30.381"N	104°45'34.009"W	1.54	
1177.00	16.790	114.180	1159.17	-132.14	-67.25	138.08	40°32'30.265"N	104°45'33.686"W	0.81	
1565.00	14.980	109.590	1532.36	-226.95	-107.02	236.45	40°32'29.872"N	104°45'32.412"W	0.57	
1597.00	16.670	112.560	1563.14	-234.80	-110.17	244.59	40°32'29.841"N	104°45'32.306"W	5.85	
1692.00	17.090	109.010	1654.05	-259.70	-119.94	270.37	40°32'29.745"N	104°45'31.972"W	1.17	
1787.00	17.500	113.510	1744.76	-285.07	-130.19	296.67	40°32'29.644"N	104°45'31.632"W	1.47	
1881.00	17.560	114.450	1834.40	-309.92	-141.70	322.54	40°32'29.530"N	104°45'31.297"W	0.31	
1976.00	17.750	106.330	1924.93	-335.96	-151.70	349.48	40°32'29.431"N	104°45'30.948"W	2.60	
2071.00	16.920	102.700	2015.62	-362.67	-158.81	376.87	40°32'29.361"N	104°45'30.593"W	1.43	
2165.00	16.700	107.690	2105.61	-388.22	-165.92	403.08	40°32'29.290"N	104°45'30.253"W	1.55	
2259.00	17.400	113.240	2195.48	-413.13	-175.57	428.87	40°32'29.195"N	104°45'29.920"W	1.88	
2354.00	17.300	118.730	2286.17	-437.47	-187.97	454.31	40°32'29.073"N	104°45'29.590"W	1.73	
2448.00	17.650	113.790	2375.83	-461.67	-200.44	479.60	40°32'28.949"N	104°45'29.262"W	1.62	
2543.00	16.270	114.040	2466.70	-486.00	-211.67	504.94	40°32'28.838"N	104°45'28.934"W	1.45	
2638.00	17.340	123.550	2557.66	-508.80	-224.92	528.89	40°32'28.707"N	104°45'28.624"W	3.10	
2733.00	17.360	121.990	2648.34	-531.29	-240.25	552.71	40°32'28.556"N	104°45'28.315"W	0.49	
2827.00	17.380	116.850	2738.06	-554.51	-254.02	577.13	40°32'28.420"N	104°45'27.999"W	1.63	
2921.00	17.220	121.920	2827.81	-577.65	-267.72	601.47	40°32'28.284"N	104°45'27.684"W	1.61	

Actual Wellpath Report

G & D HANKS V-27-28HN AWP

Page 3 of 10

REFERENCE WELLPATH IDENTIFICATION

Operator	BAYSWATER E & P LLC	Slot	SLOT#13 G & D HANKS V-27-28HN (1168'FSL & 1575'FEL,SEC.27)
Area	COLORADO	Well	G & D HANKS V-27-28HN
Field	WELD COUNTY (NAD83/TRUE NORTH)	Wellbore	G & D HANKS V-27-28HN AWP
Facility	SEC.27-T07N-R66W		

WELLPATH DATA (192 stations)

MD [ft]	Inclination [°]	Azimuth [°]	TVD [ft]	Vert Sect [ft]	North [ft]	East [ft]	Latitude	Longitude	DLS [°/100ft]	Comments
3016.00	17.550	120.360	2918.47	-600.67	-282.39	625.76	40°32'28.139"N	104°45'27.369"W	0.60	
3110.00	17.430	112.760	3008.14	-624.77	-295.01	650.98	40°32'28.015"N	104°45'27.043"W	2.43	
3205.00	17.440	115.860	3098.77	-649.66	-306.72	676.91	40°32'27.899"N	104°45'26.707"W	0.98	
3300.00	17.400	112.150	3189.42	-674.60	-318.28	702.88	40°32'27.785"N	104°45'26.370"W	1.17	
3394.00	17.490	106.610	3279.10	-700.30	-327.62	729.43	40°32'27.693"N	104°45'26.026"W	1.77	
3488.00	17.360	104.240	3368.79	-726.73	-335.11	756.56	40°32'27.619"N	104°45'25.675"W	0.77	
3583.00	17.180	105.690	3459.51	-753.29	-342.39	783.81	40°32'27.547"N	104°45'25.322"W	0.49	
3678.00	17.380	109.240	3550.22	-779.42	-350.86	810.71	40°32'27.463"N	104°45'24.974"W	1.13	
3773.00	17.400	106.400	3640.88	-805.64	-359.55	837.73	40°32'27.377"N	104°45'24.624"W	0.89	
3867.00	17.330	106.240	3730.60	-831.84	-367.43	864.66	40°32'27.299"N	104°45'24.275"W	0.09	
3962.00	16.940	109.030	3821.38	-857.73	-375.90	891.33	40°32'27.215"N	104°45'23.930"W	0.96	
4057.00	17.050	103.710	3912.24	-883.62	-383.71	917.94	40°32'27.138"N	104°45'23.585"W	1.64	
4151.00	17.090	98.140	4002.10	-910.16	-388.94	945.01	40°32'27.087"N	104°45'23.234"W	1.74	
4245.00	17.110	93.390	4091.95	-937.32	-391.71	972.48	40°32'27.059"N	104°45'22.878"W	1.49	
4340.00	17.240	90.200	4182.72	-965.19	-392.59	1000.51	40°32'27.051"N	104°45'22.515"W	1.00	
4435.00	17.100	94.970	4273.49	-992.99	-393.84	1028.51	40°32'27.038"N	104°45'22.153"W	1.49	
4530.00	17.070	98.730	4364.30	-1020.32	-397.17	1056.20	40°32'27.005"N	104°45'21.794"W	1.16	
4625.00	16.970	103.560	4455.14	-1047.05	-402.54	1083.46	40°32'26.952"N	104°45'21.441"W	1.49	
4720.00	16.980	107.690	4546.01	-1073.05	-410.00	1110.16	40°32'26.878"N	104°45'21.095"W	1.27	
4813.00	16.750	112.350	4635.01	-1097.55	-419.23	1135.49	40°32'26.787"N	104°45'20.767"W	1.47	
4908.00	17.280	116.390	4725.86	-1121.83	-430.70	1160.79	40°32'26.674"N	104°45'20.439"W	1.36	
5003.00	17.310	120.050	4816.56	-1145.53	-444.05	1185.67	40°32'26.542"N	104°45'20.117"W	1.15	
5097.00	17.310	118.090	4906.31	-1168.78	-457.64	1210.11	40°32'26.408"N	104°45'19.801"W	0.62	
5192.00	17.330	116.990	4997.00	-1192.71	-470.72	1235.18	40°32'26.278"N	104°45'19.476"W	0.35	
5287.00	17.300	114.620	5087.70	-1217.07	-483.02	1260.63	40°32'26.157"N	104°45'19.146"W	0.74	
5382.00	17.340	112.250	5178.39	-1242.01	-494.27	1286.58	40°32'26.046"N	104°45'18.810"W	0.74	
5477.00	17.300	116.120	5269.08	-1266.77	-505.85	1312.37	40°32'25.931"N	104°45'18.476"W	1.21	
5571.00	17.320	119.250	5358.83	-1290.39	-518.84	1337.12	40°32'25.803"N	104°45'18.156"W	0.99	
5666.00	17.330	116.340	5449.52	-1314.25	-532.03	1362.14	40°32'25.672"N	104°45'17.831"W	0.91	
5761.00	17.120	116.330	5540.26	-1338.36	-544.51	1387.35	40°32'25.549"N	104°45'17.505"W	0.22	

Actual Wellpath Report

G & D HANKS V-27-28HN AWP

Page 4 of 10



REFERENCE WELLPATH IDENTIFICATION

Operator	BAYSWATER E & P LLC	Slot	SLOT#13 G & D HANKS V-27-28HN (1168'FSL & 1575'FEL,SEC.27)
Area	COLORADO	Well	G & D HANKS V-27-28HN
Field	WELD COUNTY (NAD83/TRUE NORTH)	Wellbore	G & D HANKS V-27-28HN AWP
Facility	SEC.27-T07N-R66W		

WELLPATH DATA (192 stations)

MD [ft]	Inclination [°]	Azimuth [°]	TVD [ft]	Vert Sect [ft]	North [ft]	East [ft]	Latitude	Longitude	DLS [°/100ft]	Comments
5855.00	17.220	116.390	5630.07	-1362.14	-556.83	1412.22	40°32'25.427"N	104°45'17.183"W	0.11	
5950.00	17.370	115.250	5720.78	-1386.47	-569.13	1437.64	40°32'25.306"N	104°45'16.854"W	0.39	
6044.00	17.290	112.040	5810.51	-1411.11	-580.35	1463.28	40°32'25.195"N	104°45'16.522"W	1.02	
6138.00	17.310	108.780	5900.26	-1436.42	-590.10	1489.47	40°32'25.099"N	104°45'16.182"W	1.03	
6233.00	17.220	107.530	5990.98	-1462.40	-598.88	1516.26	40°32'25.012"N	104°45'15.835"W	0.40	
6328.00	17.250	111.380	6081.72	-1488.08	-608.25	1542.78	40°32'24.919"N	104°45'15.492"W	1.20	
6421.00	17.340	112.030	6170.51	-1512.85	-618.48	1568.47	40°32'24.818"N	104°45'15.159"W	0.23	
6516.00	17.290	114.530	6261.21	-1537.82	-629.65	1594.44	40°32'24.708"N	104°45'14.823"W	0.78	
6611.00	17.300	105.860	6351.93	-1563.37	-639.37	1620.87	40°32'24.612"N	104°45'14.480"W	2.71	
6706.00	14.630	83.430	6443.34	-1588.62	-641.86	1646.41	40°32'24.587"N	104°45'14.150"W	7.02	
6800.00	7.800	60.080	6535.54	-1606.28	-637.32	1663.76	40°32'24.632"N	104°45'13.925"W	8.59	
6894.00	1.020	211.200	6629.27	-1611.57	-634.85	1668.86	40°32'24.656"N	104°45'13.859"W	9.26	
6989.00	9.260	280.580	6723.84	-1603.68	-634.17	1660.90	40°32'24.663"N	104°45'13.962"W	9.42	
7084.00	17.750	285.150	6816.13	-1582.65	-628.97	1639.37	40°32'24.714"N	104°45'14.241"W	9.00	
7179.00	27.110	274.180	6903.88	-1547.55	-623.59	1603.70	40°32'24.768"N	104°45'14.703"W	10.75	
7273.00	36.920	271.970	6983.49	-1498.22	-621.05	1554.00	40°32'24.793"N	104°45'15.346"W	10.51	
7368.00	47.880	271.160	7053.54	-1434.63	-619.35	1490.07	40°32'24.809"N	104°45'16.175"W	11.55	
7463.00	57.890	267.410	7110.80	-1359.16	-620.46	1414.44	40°32'24.799"N	104°45'17.154"W	10.99	
7557.00	66.440	269.470	7154.66	-1276.25	-622.66	1331.43	40°32'24.777"N	104°45'18.229"W	9.30	
7652.00	76.700	269.300	7184.65	-1186.47	-623.63	1241.43	40°32'24.767"N	104°45'19.395"W	10.80	
7746.00	83.240	270.130	7201.02	-1094.23	-624.09	1148.92	40°32'24.763"N	104°45'20.593"W	7.01	
7841.00	90.030	270.560	7206.59	-999.81	-623.51	1054.14	40°32'24.769"N	104°45'21.821"W	7.16	
7936.00	89.970	268.550	7206.59	-905.07	-624.25	959.14	40°32'24.761"N	104°45'23.051"W	2.12	
8031.00	89.820	267.270	7206.76	-810.17	-627.72	864.21	40°32'24.727"N	104°45'24.281"W	1.36	
8125.00	89.970	266.680	7206.93	-716.21	-632.68	770.34	40°32'24.678"N	104°45'25.497"W	0.65	
8220.00	89.970	266.260	7206.98	-621.23	-638.53	675.52	40°32'24.620"N	104°45'26.725"W	0.44	
8314.00	90.000	266.080	7207.01	-527.24	-644.81	581.73	40°32'24.558"N	104°45'27.940"W	0.19	
8408.00	90.150	266.600	7206.89	-433.26	-650.81	487.92	40°32'24.499"N	104°45'29.155"W	0.58	
8503.00	90.060	265.990	7206.71	-338.27	-656.95	393.12	40°32'24.438"N	104°45'30.383"W	0.65	
8597.00	89.970	266.830	7206.69	-244.29	-662.83	299.31	40°32'24.380"N	104°45'31.598"W	0.90	

Actual Wellpath Report

G & D HANKS V-27-28HN AWP

Page 5 of 10

REFERENCE WELLPATH IDENTIFICATION

Operator	BAYSWATER E & P LLC	Slot	SLOT#13 G & D HANKS V-27-28HN (1168'FSL & 1575'FEL,SEC.27)
Area	COLORADO	Well	G & D HANKS V-27-28HN
Field	WELD COUNTY (NAD83/TRUE NORTH)	Wellbore	G & D HANKS V-27-28HN AWP
Facility	SEC.27-T07N-R66W		

WELLPATH DATA (192 stations)

MD [ft]	Inclination [°]	Azimuth [°]	TVD [ft]	Vert Sect [ft]	North [ft]	East [ft]	Latitude	Longitude	DLS [°/100ft]	Comments
8692.00	90.030	267.450	7206.69	-149.34	-667.57	204.43	40°32'24.333"N	104°45'32.827"W	0.66	
8787.00	90.060	268.360	7206.61	-54.44	-671.04	109.49	40°32'24.299"N	104°45'34.056"W	0.96	
8881.00	90.150	271.230	7206.44	39.27	-671.38	15.50	40°32'24.296"N	104°45'35.274"W	3.05	
8976.00	89.850	268.890	7206.44	133.94	-671.28	-79.49	40°32'24.297"N	104°45'36.504"W	2.48	
9071.00	90.150	268.890	7206.44	228.75	-673.12	-174.47	40°32'24.279"N	104°45'37.734"W	0.32	
9165.00	89.910	268.310	7206.39	322.60	-675.42	-268.44	40°32'24.256"N	104°45'38.951"W	0.67	
9260.00	90.030	268.360	7206.44	417.47	-678.18	-363.40	40°32'24.229"N	104°45'40.181"W	0.14	
9354.00	89.850	269.450	7206.54	511.28	-679.97	-457.39	40°32'24.211"N	104°45'41.399"W	1.18	
9448.00	89.970	267.860	7206.69	605.12	-682.18	-551.36	40°32'24.189"N	104°45'42.616"W	1.70	
9543.00	90.180	269.110	7206.56	699.98	-684.69	-646.32	40°32'24.164"N	104°45'43.846"W	1.33	
9637.00	90.120	270.910	7206.32	793.66	-684.68	-740.32	40°32'24.164"N	104°45'45.063"W	1.92	
9732.00	90.090	271.400	7206.14	888.17	-682.76	-835.30	40°32'24.183"N	104°45'46.293"W	0.52	
9827.00	90.090	272.360	7205.99	982.54	-679.64	-930.25	40°32'24.214"N	104°45'47.523"W	1.01	
9922.00	89.910	271.920	7205.99	1076.87	-676.10	-1025.18	40°32'24.249"N	104°45'48.753"W	0.50	
10017.00	90.030	271.410	7206.04	1171.29	-673.34	-1120.14	40°32'24.276"N	104°45'49.983"W	0.55	
10111.00	90.030	271.350	7205.99	1264.77	-671.07	-1214.11	40°32'24.299"N	104°45'51.200"W	0.06	
10206.00	90.090	270.910	7205.89	1359.28	-669.20	-1309.09	40°32'24.317"N	104°45'52.430"W	0.47	
10300.00	90.060	270.440	7205.77	1452.87	-668.09	-1403.09	40°32'24.328"N	104°45'53.648"W	0.50	
10394.00	90.120	270.110	7205.62	1546.52	-667.64	-1497.08	40°32'24.332"N	104°45'54.865"W	0.36	
10490.00	90.060	269.490	7205.47	1642.22	-667.98	-1593.08	40°32'24.329"N	104°45'56.108"W	0.65	
10584.00	89.940	269.910	7205.47	1735.95	-668.47	-1687.08	40°32'24.324"N	104°45'57.326"W	0.46	
10679.00	90.150	268.470	7205.40	1830.73	-669.81	-1782.07	40°32'24.311"N	104°45'58.556"W	1.53	
10773.00	90.000	267.600	7205.28	1924.63	-673.03	-1876.01	40°32'24.279"N	104°45'59.773"W	0.94	
10868.00	90.090	267.580	7205.20	2019.55	-677.03	-1970.93	40°32'24.239"N	104°46'01.002"W	0.10	
10963.00	90.030	267.840	7205.10	2114.47	-680.82	-2065.85	40°32'24.202"N	104°46'02.232"W	0.28	
11057.00	89.820	267.160	7205.22	2208.40	-684.92	-2159.76	40°32'24.161"N	104°46'03.448"W	0.76	
11152.00	89.750	267.510	7205.58	2303.34	-689.34	-2254.66	40°32'24.117"N	104°46'04.677"W	0.38	
11247.00	89.940	267.230	7205.84	2398.28	-693.70	-2349.56	40°32'24.074"N	104°46'05.906"W	0.36	
11341.00	89.880	266.930	7205.99	2492.24	-698.49	-2443.44	40°32'24.027"N	104°46'07.122"W	0.33	
11436.00	89.880	268.220	7206.18	2587.16	-702.51	-2538.35	40°32'23.987"N	104°46'08.352"W	1.36	

Actual Wellpath Report

G & D HANKS V-27-28HN AWP

Page 6 of 10

REFERENCE WELLPATH IDENTIFICATION

Operator	BAYSWATER E & P LLC	Slot	SLOT#13 G & D HANKS V-27-28HN (1168'FSL & 1575'FEL,SEC.27)
Area	COLORADO	Well	G & D HANKS V-27-28HN
Field	WELD COUNTY (NAD83/TRUE NORTH)	Wellbore	G & D HANKS V-27-28HN AWP
Facility	SEC.27-T07N-R66W		

WELLPATH DATA (192 stations)

MD [ft]	Inclination [°]	Azimuth [°]	TVD [ft]	Vert Sect [ft]	North [ft]	East [ft]	Latitude	Longitude	DLS [°/100ft]	Comments
11530.00	89.910	270.210	7206.36	2680.94	-703.80	-2632.34	40°32'23.974"N	104°46'09.569"W	2.12	
11624.00	89.750	269.380	7206.64	2774.65	-704.13	-2726.33	40°32'23.971"N	104°46'10.787"W	0.90	
11719.00	90.000	265.730	7206.84	2869.56	-708.19	-2821.23	40°32'23.931"N	104°46'12.016"W	3.85	
11814.00	90.000	265.330	7206.84	2964.56	-715.59	-2915.94	40°32'23.857"N	104°46'13.242"W	0.42	
11908.00	89.940	268.020	7206.89	3058.53	-721.04	-3009.77	40°32'23.803"N	104°46'14.458"W	2.86	
12003.00	89.970	271.340	7206.97	3153.24	-721.57	-3104.76	40°32'23.798"N	104°46'15.688"W	3.49	
12097.00	90.060	274.060	7206.94	3246.45	-717.14	-3198.65	40°32'23.842"N	104°46'16.904"W	2.90	
12191.00	90.090	274.540	7206.82	3339.30	-710.10	-3292.38	40°32'23.911"N	104°46'18.118"W	0.51	
12286.00	90.120	273.310	7206.64	3433.23	-703.59	-3387.16	40°32'23.975"N	104°46'19.346"W	1.30	
12380.00	90.220	272.580	7206.37	3526.40	-698.76	-3481.03	40°32'24.023"N	104°46'20.562"W	0.78	
12475.00	90.000	271.430	7206.18	3620.76	-695.44	-3575.97	40°32'24.056"N	104°46'21.791"W	1.23	
12569.00	89.880	270.540	7206.28	3714.30	-693.82	-3669.96	40°32'24.071"N	104°46'23.009"W	0.96	
12664.00	90.220	270.410	7206.20	3808.91	-693.04	-3764.95	40°32'24.079"N	104°46'24.239"W	0.38	
12758.00	90.060	267.850	7205.97	3902.70	-694.46	-3858.93	40°32'24.065"N	104°46'25.456"W	2.73	
12853.00	90.000	269.140	7205.92	3997.55	-696.96	-3953.90	40°32'24.040"N	104°46'26.686"W	1.36	
12948.00	90.060	269.820	7205.87	4092.30	-697.82	-4048.90	40°32'24.031"N	104°46'27.917"W	0.72	
13042.00	90.280	269.970	7205.59	4186.00	-697.99	-4142.89	40°32'24.029"N	104°46'29.134"W	0.28	
13136.00	89.940	269.020	7205.41	4279.75	-698.82	-4236.89	40°32'24.021"N	104°46'30.352"W	1.07	
13231.00	90.120	269.370	7205.36	4374.53	-700.16	-4331.88	40°32'24.008"N	104°46'31.582"W	0.41	
13325.00	89.970	268.830	7205.29	4468.33	-701.63	-4425.87	40°32'23.993"N	104°46'32.799"W	0.60	
13420.00	90.060	267.060	7205.26	4563.23	-705.04	-4520.80	40°32'23.959"N	104°46'34.029"W	1.87	
13515.00	89.970	267.620	7205.24	4658.17	-709.45	-4615.70	40°32'23.915"N	104°46'35.258"W	0.60	
13609.00	90.060	269.700	7205.21	4752.00	-711.65	-4709.67	40°32'23.893"N	104°46'36.475"W	2.21	
13704.00	89.850	270.330	7205.29	4846.68	-711.62	-4804.67	40°32'23.894"N	104°46'37.706"W	0.70	
13799.00	89.910	270.330	7205.49	4941.32	-711.07	-4899.67	40°32'23.899"N	104°46'38.936"W	0.06	
13894.00	90.060	269.710	7205.51	5036.00	-711.04	-4994.67	40°32'23.899"N	104°46'40.167"W	0.67	
13988.00	90.060	270.510	7205.41	5129.67	-710.86	-5088.67	40°32'23.901"N	104°46'41.384"W	0.85	
14083.00	89.880	271.710	7205.46	5224.19	-709.02	-5183.65	40°32'23.919"N	104°46'42.614"W	1.28	
14177.00	90.030	273.430	7205.54	5317.43	-704.81	-5277.55	40°32'23.960"N	104°46'43.830"W	1.84	
14272.00	90.000	272.620	7205.51	5411.58	-699.79	-5372.41	40°32'24.009"N	104°46'45.059"W	0.85	

Actual Wellpath Report

G & D HANKS V-27-28HN AWP

Page 7 of 10

REFERENCE WELLPATH IDENTIFICATION

Operator	BAYSWATER E & P LLC	Slot	SLOT#13 G & D HANKS V-27-28HN (1168'FSL & 1575'FEL,SEC.27)
Area	COLORADO	Well	G & D HANKS V-27-28HN
Field	WELD COUNTY (NAD83/TRUE NORTH)	Wellbore	G & D HANKS V-27-28HN AWB
Facility	SEC.27-T07N-R66W		

WELLPATH DATA (192 stations)

MD [ft]	Inclination [°]	Azimuth [°]	TVD [ft]	Vert Sect [ft]	North [ft]	East [ft]	Latitude	Longitude	DLS [°/100ft]	Comments
14367.00	89.910	272.020	7205.59	5505.87	-695.95	-5467.34	40°32'24.047"N	104°46'46.289"W	0.64	
14461.00	90.000	269.150	7205.66	5599.46	-694.99	-5561.32	40°32'24.056"N	104°46'47.506"W	3.05	
14556.00	89.940	266.920	7205.71	5694.35	-698.24	-5656.26	40°32'24.024"N	104°46'48.736"W	2.35	
14651.00	89.850	266.240	7205.88	5789.33	-703.91	-5751.09	40°32'23.968"N	104°46'49.964"W	0.72	
14745.00	89.850	266.310	7206.13	5883.31	-710.02	-5844.89	40°32'23.907"N	104°46'51.179"W	0.07	
14840.00	90.000	267.900	7206.25	5978.27	-714.82	-5939.77	40°32'23.860"N	104°46'52.408"W	1.68	
14934.00	89.850	268.010	7206.38	6072.17	-718.17	-6033.71	40°32'23.826"N	104°46'53.624"W	0.20	
15028.00	90.000	269.580	7206.50	6165.99	-720.15	-6127.68	40°32'23.806"N	104°46'54.842"W	1.68	
15123.00	90.150	268.950	7206.38	6260.77	-721.37	-6222.67	40°32'23.794"N	104°46'56.072"W	0.68	
15217.00	89.970	268.030	7206.28	6354.62	-723.84	-6316.64	40°32'23.769"N	104°46'57.289"W	1.00	
15312.00	90.250	267.120	7206.09	6449.55	-727.86	-6411.55	40°32'23.729"N	104°46'58.518"W	1.00	
15406.00	90.150	265.860	7205.77	6543.52	-733.62	-6505.38	40°32'23.672"N	104°46'59.733"W	1.34	
15501.00	90.120	267.320	7205.54	6638.50	-739.27	-6600.20	40°32'23.616"N	104°47'00.962"W	1.54	
15596.00	90.030	267.650	7205.42	6733.43	-743.44	-6695.11	40°32'23.575"N	104°47'02.191"W	0.36	
15691.00	90.150	268.680	7205.27	6828.31	-746.48	-6790.06	40°32'23.545"N	104°47'03.421"W	1.09	
15785.00	90.180	269.790	7205.00	6922.09	-747.73	-6884.05	40°32'23.532"N	104°47'04.638"W	1.18	
15878.00	90.060	270.870	7204.80	7014.74	-747.20	-6977.05	40°32'23.537"N	104°47'05.843"W	1.17	
15973.00	90.000	271.350	7204.75	7109.25	-745.36	-7072.03	40°32'23.555"N	104°47'07.073"W	0.51	
16067.00	89.940	271.430	7204.80	7202.73	-743.08	-7166.00	40°32'23.577"N	104°47'08.290"W	0.11	
16162.00	89.880	270.670	7204.95	7297.25	-741.34	-7260.99	40°32'23.594"N	104°47'09.520"W	0.80	
16256.00	89.970	270.870	7205.08	7390.83	-740.07	-7354.98	40°32'23.606"N	104°47'10.738"W	0.23	
16351.00	89.940	271.680	7205.15	7485.31	-737.96	-7449.95	40°32'23.627"N	104°47'11.968"W	0.85	
16445.00	89.940	270.890	7205.25	7578.81	-735.85	-7543.93	40°32'23.647"N	104°47'13.185"W	0.84	
16540.00	89.940	270.150	7205.35	7673.41	-734.99	-7638.92	40°32'23.656"N	104°47'14.415"W	0.78	
16634.00	89.750	270.350	7205.60	7767.07	-734.58	-7732.92	40°32'23.659"N	104°47'15.633"W	0.29	
16729.00	89.970	269.830	7205.83	7861.74	-734.43	-7827.92	40°32'23.661"N	104°47'16.863"W	0.59	
16823.00	90.120	269.630	7205.76	7955.46	-734.87	-7921.92	40°32'23.656"N	104°47'18.081"W	0.27	
16917.00	89.910	271.180	7205.74	8049.09	-734.21	-8015.92	40°32'23.662"N	104°47'19.298"W	1.66	
17012.00	90.060	270.350	7205.76	8143.66	-732.94	-8110.91	40°32'23.674"N	104°47'20.529"W	0.89	
17106.00	89.970	268.130	7205.74	8237.43	-734.19	-8204.89	40°32'23.662"N	104°47'21.746"W	2.36	

Actual Wellpath Report

G & D HANKS V-27-28HN AWP

Page 8 of 10

REFERENCE WELLPATH IDENTIFICATION

Operator	BAYSWATER E & P LLC	Slot	SLOT#13 G & D HANKS V-27-28HN (1168'FSL & 1575'FEL,SEC.27)
Area	COLORADO	Well	G & D HANKS V-27-28HN
Field	WELD COUNTY (NAD83/TRUE NORTH)	Wellbore	G & D HANKS V-27-28HN AWB
Facility	SEC.27-T07N-R66W		

WELLPATH DATA (192 stations)

MD [ft]	Inclination [°]	Azimuth [°]	TVD [ft]	Vert Sect [ft]	North [ft]	East [ft]	Latitude	Longitude	DLS [°/100ft]	Comments
17201.00	90.060	268.570	7205.71	8332.30	-736.92	-8299.85	40°32'23.634"N	104°47'22.976"W	0.47	
17296.00	90.060	268.660	7205.61	8427.14	-739.22	-8394.82	40°32'23.611"N	104°47'24.206"W	0.09	
17390.00	90.030	269.050	7205.54	8520.97	-741.10	-8488.81	40°32'23.592"N	104°47'25.423"W	0.42	
17485.00	89.910	268.120	7205.59	8615.81	-743.44	-8583.78	40°32'23.569"N	104°47'26.653"W	0.99	
17580.00	89.910	267.460	7205.74	8710.72	-747.11	-8678.70	40°32'23.532"N	104°47'27.883"W	0.69	
17675.00	89.970	267.890	7205.84	8805.64	-750.96	-8773.63	40°32'23.494"N	104°47'29.112"W	0.46	
17769.00	89.910	267.910	7205.93	8899.55	-754.40	-8867.56	40°32'23.460"N	104°47'30.329"W	0.07	
17864.00	90.090	270.790	7205.93	8994.30	-755.48	-8962.55	40°32'23.449"N	104°47'31.559"W	3.04	
17959.00	89.910	270.700	7205.93	9088.88	-754.25	-9057.54	40°32'23.461"N	104°47'32.790"W	0.21	
18053.00	90.090	269.060	7205.93	9182.58	-754.44	-9151.54	40°32'23.458"N	104°47'34.007"W	1.76	
18144.00	89.970	267.840	7205.89	9273.44	-756.91	-9242.50	40°32'23.434"N	104°47'35.185"W	1.35	LAST BHGE SURVEY (512'FSL & 31'FWL,SEC.28)
18169.00	89.970	267.840	7205.90	9298.42	-757.85	-9267.48	40°32'23.424"N	104°47'35.509"W	0.00	PTB (511'FSL & 6'FWL,SEC.28)

HOLE & CASING SECTIONS - Ref Wellbore: G & D HANKS V-27-28HN AWB Ref Wellpath: G & D HANKS V-27-28HN AWP

String/Diameter	Start MD [ft]	End MD [ft]	Interval [ft]	Start TVD [ft]	End TVD [ft]	Start N/S [ft]	Start E/W [ft]	End N/S [ft]	End E/W [ft]
9.625in Casing	25.00	1550.00	1525.00	25.00	1517.87	0.00	0.00	-105.71	232.80

Actual Wellpath Report

G & D HANKS V-27-28HN AWP

Page 9 of 10

REFERENCE WELLPATH IDENTIFICATION

Operator	BAYSWATER E & P LLC	Slot	SLOT#13 G & D HANKS V-27-28HN (1168'FSL & 1575'FEL,SEC.27)
Area	COLORADO	Well	G & D HANKS V-27-28HN
Field	WELD COUNTY (NAD83/TRUE NORTH)	Wellbore	G & D HANKS V-27-28HN AWB
Facility	SEC.27-T07N-R66W		

TARGETS

Name	TVD [ft]	North [ft]	East [ft]	Grid East [US ft]	Grid North [US ft]	Latitude	Longitude	Shape
G & D HANKS V-27-28HN BHL REV-3 (510'FSL & 5'FWL,SEC.28)	7206.00	-758.98	-9268.35	3196442.99	1440286.28	40°32'23.413"N	104°47'35.520"W	point
G & D HANKS V-27-28HN LP REV-3 (510'FSL & 470'FEL,SEC.27)	7206.00	-645.23	1108.72	3206818.41	1440486.64	40°32'24.554"N	104°45'21.114"W	point
G & D HANKS V-27-28HN LP PLAT (510'FSL & 470'FEL,SEC.27)	7291.00	-645.19	1108.72	3206818.41	1440486.68	40°32'24.554"N	104°45'21.114"W	point
G & D HANKS V-27-28HN BHL PLAT (510'FSL & 5'FWL,SEC.28)	7336.00	-758.96	-9268.35	3196442.99	1440286.30	40°32'23.413"N	104°47'35.520"W	point
SEC.27,28-T07N-R66W HDL (460'FEL & 5'FWL)	9999.00	59.75	0.00	3205703.88	1441182.31	40°32'31.520"N	104°45'35.474"W	polygon
SEC.27-T07N-R66W	9999.00	59.75	0.00	3205703.88	1441182.31	40°32'31.520"N	104°45'35.474"W	polygon
SEC.28-T07N-R66W*	9999.00	59.75	0.00	3205703.88	1441182.31	40°32'31.520"N	104°45'35.474"W	polygon

WELLPATH COMPOSITION - Ref Wellbore: G & D HANKS V-27-28HN AWB Ref Wellpath: G & D HANKS V-27-28HN AWP

Start MD [ft]	End MD [ft]	Positional Uncertainty Model	Log Name/Comment	Wellbore
25.00	1177.00	BHI NaviTrak (Standard)	13.5" Surface NaviTrak (Standard) <137-1177>	G & D HANKS V-27-28HN AWB
1177.00	18144.00	BHI AutoTrak Curve (Short)	BHI AutoTrak Curve (Short) <1565-18144>	G & D HANKS V-27-28HN AWB
18144.00	18169.00	Blind Drilling (std)	Projection to bit	G & D HANKS V-27-28HN AWB

Actual Wellpath Report

G & D HANKS V-27-28HN AWP

Page 10 of 10

REFERENCE WELLPATH IDENTIFICATION

Operator	BAYSWATER E & P LLC	Slot	SLOT#13 G & D HANKS V-27-28HN (1168'FSL & 1575'FEL,SEC.27)
Area	COLORADO	Well	G & D HANKS V-27-28HN
Field	WELD COUNTY (NAD83/TRUE NORTH)	Wellbore	G & D HANKS V-27-28HN AWP
Facility	SEC.27-T07N-R66W		

WELLPATH COMMENTS

MD [ft]	Inclination [°]	Azimuth [°]	TVD [ft]	Comment
18144.00	89.970	267.840	7205.89	LAST BHGE SURVEY (512'FSL & 31'FWL,SEC.28)
18169.00	89.970	267.840	7205.90	PTB (511'FSL & 6'FWL,SEC.28)