



Edge Energy, LLC

Well Name:

Deporter 32-29-7H

Project Name:

Sec. 4-T10N-R65W

Pad Name:

Deporter 4-A

ANNOTATIONS

TVD	MD	Inc	Azi	+N/-S	+E/-W	VSec	Departure	Annotation
500.0	500.0	0.00	0.00	0.0	0.0	0.0	0.0	Start Build 2.00
2453.9	2650.2	43.00	331.89	679.0	-362.6	733.3	769.7	Hold 43 Inc, 331.89 Az
7758.0	9903.0	43.00	331.89	5042.4	-2693.2	5446.0	5716.5	KOP 8/100
8020.0	10567.5	90.00	0.35	5616.2	-2806.1	6030.8	6306.8	EP 90 Inc, .35 Az
8020.0	19916.8	90.00	0.35	14965.3	-2749.1	15215.7	15656.1	TD at 19916.8

DESIGN TARGET DETAILS

Name	TVD	+N/-S	+E/-W	Northing	Easting	Latitude	Longitude
SHL 260' FSI, 275' FWL Sec 4	0.0	0.0	0.0	1555844.12	3227949.73	40° 51' 22.540 N	104° 40' 33.534 W
BHL 600' FNL, 2420' FEL Sec 29	8020.0	14965.3	-2749.1	1570783.26	3225061.67	40° 53' 50.406 N	104° 41' 9.331 W
EP 600' FSL, 2420' FEL, Sec 32	8020.0	5616.2	-2806.1	1561434.02	3225091.53	40° 52' 18.031 N	104° 41' 10.060 W

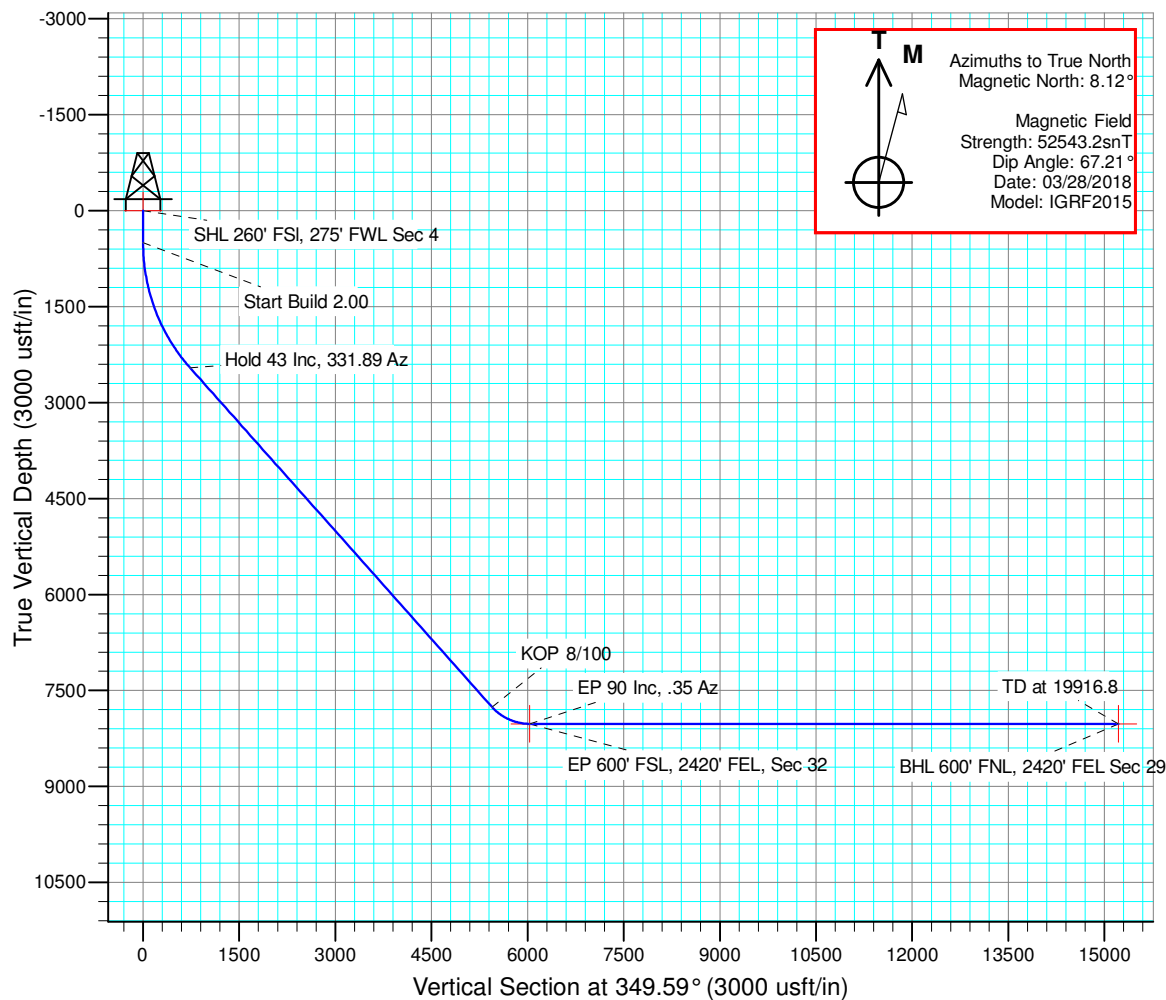

Geodetic Datum:

North American Datum 1983
US State Plane 1983, Colorado Northern Zone

Elevation:

Ground Elevation: 5385.0
WELL @ 5400.0usft (Original Well Elev)

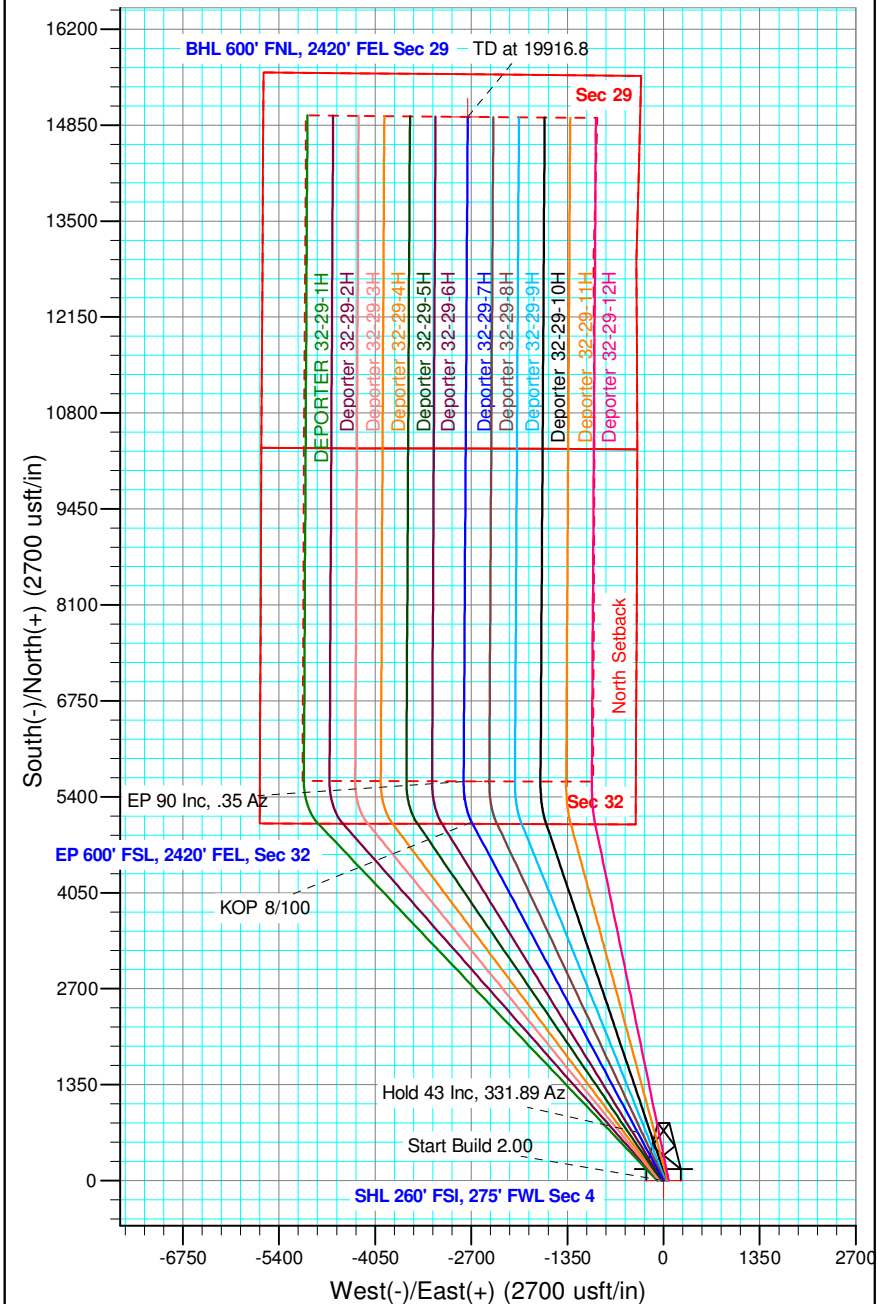



Edge Energy, LLC

Sec. 4-T10N-R65W

Deporter 4-A

Deporter 32-29-7H

Wellbore #1

Plan: Design #1 28Mar18 mnh

Standard Planning Report - Geographic

28 March, 2018

Database:	EDM 5000.1 Single User Db	Local Co-ordinate Reference:	Well Deporter 32-29-7H
Company:	Edge Energy, LLC	TVD Reference:	WELL @ 5400.0usft (Original Well Elev)
Project:	Sec. 4-T10N-R65W	MD Reference:	WELL @ 5400.0usft (Original Well Elev)
Site:	Deporter 4-A	North Reference:	True
Well:	Deporter 32-29-7H	Survey Calculation Method:	Minimum Curvature
Wellbore:	Wellbore #1		
Design:	Design #1 28Mar18 mnh		

Project	Sec. 4-T10N-R65W, Weld County, CO		
Map System:	US State Plane 1983	System Datum:	Mean Sea Level
Geo Datum:	North American Datum 1983		
Map Zone:	Colorado Northern Zone		

Site		Deporter 4-A				
Site Position:		Northing:	1,555,844.40 usft	Latitude:	40° 51' 22.551 N	
From:	Map	Easting:	3,227,859.77 usft	Longitude:	104° 40' 34.704 W	
Position Uncertainty:		0.0 usft	Slot Radius:	13-3/16 "	Grid Convergence:	0.53 °

Well		Deporter 32-29-7H				
Well Position	+N/-S	0.0 usft	Northing:	1,555,844.12 usft	Latitude:	40° 51' 22.540 N
	+E/-W	0.0 usft	Easting:	3,227,949.73 usft	Longitude:	104° 40' 33.534 W
Position Uncertainty		0.0 usft	Wellhead Elevation:		Ground Level:	5,385.0 usft

Wellbore	Wellbore #1				
Magnetics	Model Name	Sample Date	Declination (°)	Dip Angle (°)	Field Strength (nT)
	IGRF2015	03/28/18	8.12	67.21	52,543

Design	Design #1 28Mar18 mnh			
Audit Notes:				
Version:	Phase:	PLAN	Tie On Depth:	0.0
Vertical Section:	Depth From (TVD) (usft)	+N/-S (usft)	+E/-W (usft)	Direction (°)
	0.0	0.0	0.0	349.59

Plan Sections										
Measured Depth (usft)	Inclination (°)	Azimuth (°)	Vertical Depth (usft)	+N/-S (usft)	+E/-W (usft)	Dogleg Rate (°/100usft)	Build Rate (°/100usft)	Turn Rate (°/100usft)	TFO (°)	Target
0.0	0.00	0.00	0.0	0.0	0.0	0.00	0.00	0.00	0.00	
500.0	0.00	0.00	500.0	0.0	0.0	0.00	0.00	0.00	0.00	
2,650.2	43.00	331.89	2,453.9	679.0	-362.6	2.00	2.00	0.00	331.89	
9,903.0	43.00	331.89	7,758.0	5,042.4	-2,693.2	0.00	0.00	0.00	0.00	
10,567.5	90.00	0.35	8,020.0	5,616.2	-2,806.1	8.00	7.07	4.28	36.54	EP 600' FSL, 2420' FI
19,916.8	90.00	0.35	8,020.0	14,965.3	-2,749.1	0.00	0.00	0.00	0.00	BHL 600' FNL, 2420' I

Database:	EDM 5000.1 Single User Db	Local Co-ordinate Reference:	Well Reporter 32-29-7H
Company:	Edge Energy, LLC	TVD Reference:	WELL @ 5400.0usft (Original Well Elev)
Project:	Sec. 4-T10N-R65W	MD Reference:	WELL @ 5400.0usft (Original Well Elev)
Site:	Deporter 4-A	North Reference:	True
Well:	Deporter 32-29-7H	Survey Calculation Method:	Minimum Curvature
Wellbore:	Wellbore #1		
Design:	Design #1 28Mar18 mnh		

Planned Survey									
Measured Depth (usft)	Inclination (°)	Azimuth (°)	Vertical Depth (usft)	+N/-S (usft)	+E/-W (usft)	Map Northing (usft)	Map Easting (usft)	Latitude	Longitude
0.0	0.00	0.00	0.0	0.0	0.0	1,555,844.12	3,227,949.73	40° 51' 22.540 N	104° 40' 33.534 W
100.0	0.00	0.00	100.0	0.0	0.0	1,555,844.12	3,227,949.73	40° 51' 22.540 N	104° 40' 33.534 W
200.0	0.00	0.00	200.0	0.0	0.0	1,555,844.12	3,227,949.73	40° 51' 22.540 N	104° 40' 33.534 W
300.0	0.00	0.00	300.0	0.0	0.0	1,555,844.12	3,227,949.73	40° 51' 22.540 N	104° 40' 33.534 W
400.0	0.00	0.00	400.0	0.0	0.0	1,555,844.12	3,227,949.73	40° 51' 22.540 N	104° 40' 33.534 W
500.0	0.00	0.00	500.0	0.0	0.0	1,555,844.12	3,227,949.73	40° 51' 22.540 N	104° 40' 33.534 W
Start Build 2.00									
600.0	2.00	331.89	600.0	1.5	-0.8	1,555,845.66	3,227,948.90	40° 51' 22.556 N	104° 40' 33.544 W
700.0	4.00	331.89	699.8	6.2	-3.3	1,555,850.25	3,227,946.39	40° 51' 22.601 N	104° 40' 33.576 W
800.0	6.00	331.89	799.5	13.8	-7.4	1,555,857.90	3,227,942.21	40° 51' 22.677 N	104° 40' 33.630 W
900.0	8.00	331.89	898.7	24.6	-13.1	1,555,868.59	3,227,936.37	40° 51' 22.783 N	104° 40' 33.705 W
1,000.0	10.00	331.89	997.5	38.4	-20.5	1,555,882.32	3,227,928.87	40° 51' 22.920 N	104° 40' 33.800 W
1,100.0	12.00	331.89	1,095.6	55.2	-29.5	1,555,899.07	3,227,919.73	40° 51' 23.086 N	104° 40' 33.917 W
1,200.0	14.00	331.89	1,193.1	75.1	-40.1	1,555,918.81	3,227,908.95	40° 51' 23.282 N	104° 40' 34.055 W
1,300.0	16.00	331.89	1,289.6	97.9	-52.3	1,555,941.52	3,227,896.54	40° 51' 23.508 N	104° 40' 34.214 W
1,400.0	18.00	331.89	1,385.3	123.7	-66.1	1,555,967.18	3,227,882.53	40° 51' 23.762 N	104° 40' 34.393 W
1,500.0	20.00	331.89	1,479.8	152.4	-81.4	1,555,995.75	3,227,866.93	40° 51' 24.046 N	104° 40' 34.593 W
1,600.0	22.00	331.89	1,573.2	184.0	-98.3	1,556,027.20	3,227,849.75	40° 51' 24.358 N	104° 40' 34.813 W
1,700.0	24.00	331.89	1,665.2	218.5	-116.7	1,556,061.50	3,227,831.02	40° 51' 24.699 N	104° 40' 35.052 W
1,800.0	26.00	331.89	1,755.8	255.7	-136.6	1,556,098.58	3,227,810.77	40° 51' 25.067 N	104° 40' 35.311 W
1,900.0	28.00	331.89	1,844.9	295.8	-158.0	1,556,138.43	3,227,789.01	40° 51' 25.463 N	104° 40' 35.590 W
2,000.0	30.00	331.89	1,932.4	338.5	-180.8	1,556,180.97	3,227,765.77	40° 51' 25.885 N	104° 40' 35.887 W
2,100.0	32.00	331.89	2,018.1	384.0	-205.1	1,556,226.17	3,227,741.09	40° 51' 26.334 N	104° 40' 36.203 W
2,200.0	34.00	331.89	2,102.0	432.0	-230.7	1,556,273.97	3,227,714.99	40° 51' 26.809 N	104° 40' 36.536 W
2,300.0	36.00	331.89	2,183.9	482.6	-257.8	1,556,324.31	3,227,687.50	40° 51' 27.309 N	104° 40' 36.888 W
2,400.0	38.00	331.89	2,263.7	535.7	-286.1	1,556,377.12	3,227,658.65	40° 51' 27.833 N	104° 40' 37.257 W
2,500.0	40.00	331.89	2,341.4	591.2	-315.8	1,556,432.35	3,227,628.49	40° 51' 28.382 N	104° 40' 37.643 W
2,600.0	42.00	331.89	2,416.9	649.1	-346.7	1,556,489.93	3,227,597.05	40° 51' 28.953 N	104° 40' 38.045 W
2,650.2	43.00	331.89	2,453.9	679.0	-362.6	1,556,519.70	3,227,580.79	40° 51' 29.249 N	104° 40' 38.253 W
Hold 43 Inc, 331.89 Az									
2,700.0	43.00	331.89	2,490.3	708.9	-378.6	1,556,549.51	3,227,564.51	40° 51' 29.545 N	104° 40' 38.461 W
2,800.0	43.00	331.89	2,563.5	769.1	-410.8	1,556,609.37	3,227,531.82	40° 51' 30.139 N	104° 40' 38.880 W
2,900.0	43.00	331.89	2,636.6	829.3	-442.9	1,556,669.23	3,227,499.13	40° 51' 30.734 N	104° 40' 39.298 W
3,000.0	43.00	331.89	2,709.7	889.4	-475.0	1,556,729.09	3,227,466.44	40° 51' 31.328 N	104° 40' 39.716 W
3,100.0	43.00	331.89	2,782.9	949.6	-507.2	1,556,788.95	3,227,433.75	40° 51' 31.923 N	104° 40' 40.134 W
3,200.0	43.00	331.89	2,856.0	1,009.7	-539.3	1,556,848.81	3,227,401.06	40° 51' 32.517 N	104° 40' 40.552 W
3,300.0	43.00	331.89	2,929.1	1,069.9	-571.4	1,556,908.67	3,227,368.37	40° 51' 33.112 N	104° 40' 40.970 W
3,400.0	43.00	331.89	3,002.3	1,130.1	-603.6	1,556,968.53	3,227,335.68	40° 51' 33.706 N	104° 40' 41.389 W
3,500.0	43.00	331.89	3,075.4	1,190.2	-635.7	1,557,028.39	3,227,302.99	40° 51' 34.300 N	104° 40' 41.807 W
3,600.0	43.00	331.89	3,148.5	1,250.4	-667.8	1,557,088.25	3,227,270.30	40° 51' 34.895 N	104° 40' 42.225 W
3,700.0	43.00	331.89	3,221.6	1,310.5	-700.0	1,557,148.11	3,227,237.61	40° 51' 35.489 N	104° 40' 42.643 W
3,800.0	43.00	331.89	3,294.8	1,370.7	-732.1	1,557,207.97	3,227,204.92	40° 51' 36.084 N	104° 40' 43.061 W
3,900.0	43.00	331.89	3,367.9	1,430.9	-764.2	1,557,267.83	3,227,172.23	40° 51' 36.678 N	104° 40' 43.480 W
4,000.0	43.00	331.89	3,441.0	1,491.0	-796.4	1,557,327.69	3,227,139.54	40° 51' 37.273 N	104° 40' 43.898 W
4,100.0	43.00	331.89	3,514.2	1,551.2	-828.5	1,557,387.55	3,227,106.85	40° 51' 37.867 N	104° 40' 44.316 W
4,200.0	43.00	331.89	3,587.3	1,611.3	-860.6	1,557,447.41	3,227,074.16	40° 51' 38.461 N	104° 40' 44.734 W
4,300.0	43.00	331.89	3,660.4	1,671.5	-892.8	1,557,507.27	3,227,041.47	40° 51' 39.056 N	104° 40' 45.153 W
4,400.0	43.00	331.89	3,733.6	1,731.7	-924.9	1,557,567.13	3,227,008.78	40° 51' 39.650 N	104° 40' 45.571 W
4,500.0	43.00	331.89	3,806.7	1,791.8	-957.0	1,557,626.99	3,226,976.09	40° 51' 40.245 N	104° 40' 45.989 W
4,600.0	43.00	331.89	3,879.8	1,852.0	-989.2	1,557,686.85	3,226,943.40	40° 51' 40.839 N	104° 40' 46.407 W
4,700.0	43.00	331.89	3,953.0	1,912.2	-1,021.3	1,557,746.71	3,226,910.70	40° 51' 41.434 N	104° 40' 46.825 W
4,800.0	43.00	331.89	4,026.1	1,972.3	-1,053.4	1,557,806.57	3,226,878.01	40° 51' 42.028 N	104° 40' 47.244 W
4,900.0	43.00	331.89	4,099.2	2,032.5	-1,085.6	1,557,866.43	3,226,845.32	40° 51' 42.622 N	104° 40' 47.662 W
5,000.0	43.00	331.89	4,172.3	2,092.6	-1,117.7	1,557,926.29	3,226,812.63	40° 51' 43.217 N	104° 40' 48.080 W

Database:	EDM 5000.1 Single User Db	Local Co-ordinate Reference:	Well Reporter 32-29-7H
Company:	Edge Energy, LLC	TVD Reference:	WELL @ 5400.0usft (Original Well Elev)
Project:	Sec. 4-T10N-R65W	MD Reference:	WELL @ 5400.0usft (Original Well Elev)
Site:	Deporter 4-A	North Reference:	True
Well:	Deporter 32-29-7H	Survey Calculation Method:	Minimum Curvature
Wellbore:	Wellbore #1		
Design:	Design #1 28Mar18 mnh		

Planned Survey										
Measured Depth (usft)	Inclination (°)	Azimuth (°)	Vertical Depth (usft)	+N/-S (usft)	+E/-W (usft)	Map Northing (usft)	Map Easting (usft)	Latitude	Longitude	
5,100.0	43.00	331.89	4,245.5	2,152.8	-1,149.8	1,557,986.15	3,226,779.94	40° 51' 43.811 N	104° 40' 48.498 W	
5,200.0	43.00	331.89	4,318.6	2,213.0	-1,182.0	1,558,046.01	3,226,747.25	40° 51' 44.406 N	104° 40' 48.917 W	
5,300.0	43.00	331.89	4,391.7	2,273.1	-1,214.1	1,558,105.87	3,226,714.56	40° 51' 45.000 N	104° 40' 49.335 W	
5,400.0	43.00	331.89	4,464.9	2,333.3	-1,246.2	1,558,165.73	3,226,681.87	40° 51' 45.595 N	104° 40' 49.753 W	
5,500.0	43.00	331.89	4,538.0	2,393.4	-1,278.4	1,558,225.59	3,226,649.18	40° 51' 46.189 N	104° 40' 50.171 W	
5,600.0	43.00	331.89	4,611.1	2,453.6	-1,310.5	1,558,285.45	3,226,616.49	40° 51' 46.783 N	104° 40' 50.590 W	
5,700.0	43.00	331.89	4,684.3	2,513.8	-1,342.6	1,558,345.31	3,226,583.80	40° 51' 47.378 N	104° 40' 51.008 W	
5,800.0	43.00	331.89	4,757.4	2,573.9	-1,374.8	1,558,405.17	3,226,551.11	40° 51' 47.972 N	104° 40' 51.426 W	
5,900.0	43.00	331.89	4,830.5	2,634.1	-1,406.9	1,558,465.03	3,226,518.42	40° 51' 48.567 N	104° 40' 51.844 W	
6,000.0	43.00	331.89	4,903.7	2,694.2	-1,439.0	1,558,524.88	3,226,485.73	40° 51' 49.161 N	104° 40' 52.263 W	
6,100.0	43.00	331.89	4,976.8	2,754.4	-1,471.2	1,558,584.74	3,226,453.04	40° 51' 49.755 N	104° 40' 52.681 W	
6,200.0	43.00	331.89	5,049.9	2,814.6	-1,503.3	1,558,644.60	3,226,420.35	40° 51' 50.350 N	104° 40' 53.099 W	
6,300.0	43.00	331.89	5,123.0	2,874.7	-1,535.4	1,558,704.46	3,226,387.66	40° 51' 50.944 N	104° 40' 53.517 W	
6,400.0	43.00	331.89	5,196.2	2,934.9	-1,567.6	1,558,764.32	3,226,354.97	40° 51' 51.539 N	104° 40' 53.936 W	
6,500.0	43.00	331.89	5,269.3	2,995.1	-1,599.7	1,558,824.18	3,226,322.28	40° 51' 52.133 N	104° 40' 54.354 W	
6,600.0	43.00	331.89	5,342.4	3,055.2	-1,631.8	1,558,884.04	3,226,289.59	40° 51' 52.728 N	104° 40' 54.772 W	
6,700.0	43.00	331.89	5,415.6	3,115.4	-1,664.0	1,558,943.90	3,226,256.90	40° 51' 53.322 N	104° 40' 55.190 W	
6,800.0	43.00	331.89	5,488.7	3,175.5	-1,696.1	1,559,003.76	3,226,224.21	40° 51' 53.916 N	104° 40' 55.609 W	
6,900.0	43.00	331.89	5,561.8	3,235.7	-1,728.2	1,559,063.62	3,226,191.52	40° 51' 54.511 N	104° 40' 56.027 W	
7,000.0	43.00	331.89	5,635.0	3,295.9	-1,760.4	1,559,123.48	3,226,158.83	40° 51' 55.105 N	104° 40' 56.445 W	
7,100.0	43.00	331.89	5,708.1	3,356.0	-1,792.5	1,559,183.34	3,226,126.13	40° 51' 55.700 N	104° 40' 56.863 W	
7,200.0	43.00	331.89	5,781.2	3,416.2	-1,824.6	1,559,243.20	3,226,093.44	40° 51' 56.294 N	104° 40' 57.282 W	
7,300.0	43.00	331.89	5,854.3	3,476.3	-1,856.8	1,559,303.06	3,226,060.75	40° 51' 56.888 N	104° 40' 57.700 W	
7,400.0	43.00	331.89	5,927.5	3,536.5	-1,888.9	1,559,362.92	3,226,028.06	40° 51' 57.483 N	104° 40' 58.118 W	
7,500.0	43.00	331.89	6,000.6	3,596.7	-1,921.0	1,559,422.78	3,225,995.37	40° 51' 58.077 N	104° 40' 58.537 W	
7,600.0	43.00	331.89	6,073.7	3,656.8	-1,953.2	1,559,482.64	3,225,962.68	40° 51' 58.672 N	104° 40' 58.955 W	
7,700.0	43.00	331.89	6,146.9	3,717.0	-1,985.3	1,559,542.50	3,225,929.99	40° 51' 59.266 N	104° 40' 59.373 W	
7,800.0	43.00	331.89	6,220.0	3,777.1	-2,017.4	1,559,602.36	3,225,897.30	40° 51' 59.860 N	104° 40' 59.791 W	
7,900.0	43.00	331.89	6,293.1	3,837.3	-2,049.6	1,559,662.22	3,225,864.61	40° 52' 0.455 N	104° 41' 0.210 W	
8,000.0	43.00	331.89	6,366.3	3,897.5	-2,081.7	1,559,722.08	3,225,831.92	40° 52' 1.049 N	104° 41' 0.628 W	
8,100.0	43.00	331.89	6,439.4	3,957.6	-2,113.8	1,559,781.94	3,225,799.23	40° 52' 1.644 N	104° 41' 1.046 W	
8,200.0	43.00	331.89	6,512.5	4,017.8	-2,145.9	1,559,841.80	3,225,766.54	40° 52' 2.238 N	104° 41' 1.465 W	
8,300.0	43.00	331.89	6,585.7	4,078.0	-2,178.1	1,559,901.66	3,225,733.85	40° 52' 2.833 N	104° 41' 1.883 W	
8,400.0	43.00	331.89	6,658.8	4,138.1	-2,210.2	1,559,961.52	3,225,701.16	40° 52' 3.427 N	104° 41' 2.301 W	
8,500.0	43.00	331.89	6,731.9	4,198.3	-2,242.3	1,560,021.38	3,225,668.47	40° 52' 4.021 N	104° 41' 2.719 W	
8,600.0	43.00	331.89	6,805.0	4,258.4	-2,274.5	1,560,081.24	3,225,635.78	40° 52' 4.616 N	104° 41' 3.138 W	
8,700.0	43.00	331.89	6,878.2	4,318.6	-2,306.6	1,560,141.10	3,225,603.09	40° 52' 5.210 N	104° 41' 3.556 W	
8,800.0	43.00	331.89	6,951.3	4,378.8	-2,338.7	1,560,200.96	3,225,570.40	40° 52' 5.805 N	104° 41' 3.974 W	
8,900.0	43.00	331.89	7,024.4	4,438.9	-2,370.9	1,560,260.82	3,225,537.71	40° 52' 6.399 N	104° 41' 4.393 W	
9,000.0	43.00	331.89	7,097.6	4,499.1	-2,403.0	1,560,320.68	3,225,505.02	40° 52' 6.993 N	104° 41' 4.811 W	
9,100.0	43.00	331.89	7,170.7	4,559.2	-2,435.1	1,560,380.54	3,225,472.33	40° 52' 7.588 N	104° 41' 5.229 W	
9,200.0	43.00	331.89	7,243.8	4,619.4	-2,467.3	1,560,440.40	3,225,439.64	40° 52' 8.182 N	104° 41' 5.648 W	
9,300.0	43.00	331.89	7,317.0	4,679.6	-2,499.4	1,560,500.26	3,225,406.95	40° 52' 8.777 N	104° 41' 6.066 W	
9,400.0	43.00	331.89	7,390.1	4,739.7	-2,531.5	1,560,560.12	3,225,374.26	40° 52' 9.371 N	104° 41' 6.484 W	
9,500.0	43.00	331.89	7,463.2	4,799.9	-2,563.7	1,560,619.98	3,225,341.56	40° 52' 9.965 N	104° 41' 6.903 W	
9,600.0	43.00	331.89	7,536.4	4,860.1	-2,595.8	1,560,679.84	3,225,308.87	40° 52' 10.560 N	104° 41' 7.321 W	
9,700.0	43.00	331.89	7,609.5	4,920.2	-2,627.9	1,560,739.70	3,225,276.18	40° 52' 11.154 N	104° 41' 7.739 W	
9,800.0	43.00	331.89	7,682.6	4,980.4	-2,660.1	1,560,799.56	3,225,243.49	40° 52' 11.749 N	104° 41' 8.158 W	
9,900.0	43.00	331.89	7,755.7	5,040.5	-2,692.2	1,560,859.42	3,225,210.80	40° 52' 12.343 N	104° 41' 8.576 W	
9,903.0	43.00	331.89	7,758.0	5,042.4	-2,693.2	1,560,861.25	3,225,209.81	40° 52' 12.361 N	104° 41' 8.589 W	
KOP 8/100										
10,000.0	49.41	337.97	7,825.1	5,105.8	-2,722.6	1,560,924.36	3,225,179.79	40° 52' 12.987 N	104° 41' 8.972 W	
10,100.0	56.29	343.10	7,885.5	5,180.9	-2,749.0	1,560,999.22	3,225,152.71	40° 52' 13.729 N	104° 41' 9.315 W	
10,200.0	63.35	347.46	7,935.7	5,264.4	-2,770.8	1,561,082.57	3,225,130.11	40° 52' 14.555 N	104° 41' 9.599 W	



Planning Report - Geographic

Database:	EDM 5000.1 Single User Db	Local Co-ordinate Reference:	Well Reporter 32-29-7H
Company:	Edge Energy, LLC	TVD Reference:	WELL @ 5400.0usft (Original Well Elev)
Project:	Sec. 4-T10N-R65W	MD Reference:	WELL @ 5400.0usft (Original Well Elev)
Site:	Deporter 4-A	North Reference:	True
Well:	Deporter 32-29-7H	Survey Calculation Method:	Minimum Curvature
Wellbore:	Wellbore #1		
Design:	Design #1 28Mar18 mnh		

Planned Survey									
Measured Depth (usft)	Inclination (°)	Azimuth (°)	Vertical Depth (usft)	+N/-S (usft)	+E/-W (usft)	Map Northing (usft)	Map Easting (usft)	Latitude	Longitude
10,300.0	70.52	351.31	7,974.9	5,354.8	-2,787.7	1,561,172.77	3,225,112.42	40° 52' 15.448 N	104° 41' 9.819 W
10,400.0	77.77	354.82	8,002.2	5,450.2	-2,799.2	1,561,268.08	3,225,099.98	40° 52' 16.391 N	104° 41' 9.969 W
10,500.0	85.07	358.15	8,017.1	5,548.8	-2,805.3	1,561,366.63	3,225,093.04	40° 52' 17.365 N	104° 41' 10.048 W
10,567.5	90.00	0.35	8,020.0	5,616.2	-2,806.1	1,561,434.02	3,225,091.53	40° 52' 18.031 N	104° 41' 10.060 W
EP 90 Inc, .35 Az									
10,600.0	90.00	0.35	8,020.0	5,648.7	-2,805.9	1,561,466.53	3,225,091.43	40° 52' 18.352 N	104° 41' 10.057 W
10,700.0	90.00	0.35	8,020.0	5,748.7	-2,805.3	1,561,566.53	3,225,091.11	40° 52' 19.340 N	104° 41' 10.049 W
10,800.0	90.00	0.35	8,020.0	5,848.7	-2,804.7	1,561,666.53	3,225,090.79	40° 52' 20.328 N	104° 41' 10.042 W
10,900.0	90.00	0.35	8,020.0	5,948.7	-2,804.1	1,561,766.52	3,225,090.47	40° 52' 21.316 N	104° 41' 10.034 W
11,000.0	90.00	0.35	8,020.0	6,048.7	-2,803.5	1,561,866.52	3,225,090.15	40° 52' 22.304 N	104° 41' 10.026 W
11,100.0	90.00	0.35	8,020.0	6,148.7	-2,802.9	1,561,966.52	3,225,089.83	40° 52' 23.292 N	104° 41' 10.018 W
11,200.0	90.00	0.35	8,020.0	6,248.7	-2,802.3	1,562,066.52	3,225,089.51	40° 52' 24.280 N	104° 41' 10.010 W
11,300.0	90.00	0.35	8,020.0	6,348.7	-2,801.7	1,562,166.52	3,225,089.19	40° 52' 25.269 N	104° 41' 10.003 W
11,400.0	90.00	0.35	8,020.0	6,448.7	-2,801.1	1,562,266.52	3,225,088.87	40° 52' 26.257 N	104° 41' 9.995 W
11,500.0	90.00	0.35	8,020.0	6,548.7	-2,800.4	1,562,366.52	3,225,088.55	40° 52' 27.245 N	104° 41' 9.987 W
11,600.0	90.00	0.35	8,020.0	6,648.7	-2,799.8	1,562,466.52	3,225,088.23	40° 52' 28.233 N	104° 41' 9.979 W
11,700.0	90.00	0.35	8,020.0	6,748.7	-2,799.2	1,562,566.52	3,225,087.92	40° 52' 29.221 N	104° 41' 9.971 W
11,800.0	90.00	0.35	8,020.0	6,848.7	-2,798.6	1,562,666.52	3,225,087.60	40° 52' 30.209 N	104° 41' 9.964 W
11,900.0	90.00	0.35	8,020.0	6,948.7	-2,798.0	1,562,766.52	3,225,087.28	40° 52' 31.197 N	104° 41' 9.956 W
12,000.0	90.00	0.35	8,020.0	7,048.7	-2,797.4	1,562,866.52	3,225,086.96	40° 52' 32.185 N	104° 41' 9.948 W
12,100.0	90.00	0.35	8,020.0	7,148.7	-2,796.8	1,562,966.52	3,225,086.64	40° 52' 33.173 N	104° 41' 9.940 W
12,200.0	90.00	0.35	8,020.0	7,248.7	-2,796.2	1,563,066.52	3,225,086.32	40° 52' 34.161 N	104° 41' 9.932 W
12,300.0	90.00	0.35	8,020.0	7,348.7	-2,795.6	1,563,166.52	3,225,086.00	40° 52' 35.149 N	104° 41' 9.925 W
12,400.0	90.00	0.35	8,020.0	7,448.7	-2,795.0	1,563,266.51	3,225,085.68	40° 52' 36.137 N	104° 41' 9.917 W
12,500.0	90.00	0.35	8,020.0	7,548.7	-2,794.3	1,563,366.51	3,225,085.36	40° 52' 37.125 N	104° 41' 9.909 W
12,600.0	90.00	0.35	8,020.0	7,648.7	-2,793.7	1,563,466.51	3,225,085.04	40° 52' 38.113 N	104° 41' 9.901 W
12,700.0	90.00	0.35	8,020.0	7,748.7	-2,793.1	1,563,566.51	3,225,084.72	40° 52' 39.101 N	104° 41' 9.893 W
12,800.0	90.00	0.35	8,020.0	7,848.7	-2,792.5	1,563,666.51	3,225,084.40	40° 52' 40.089 N	104° 41' 9.886 W
12,900.0	90.00	0.35	8,020.0	7,948.7	-2,791.9	1,563,766.51	3,225,084.08	40° 52' 41.077 N	104° 41' 9.878 W
13,000.0	90.00	0.35	8,020.0	8,048.7	-2,791.3	1,563,866.51	3,225,083.76	40° 52' 42.065 N	104° 41' 9.870 W
13,100.0	90.00	0.35	8,020.0	8,148.7	-2,790.7	1,563,966.51	3,225,083.44	40° 52' 43.053 N	104° 41' 9.862 W
13,200.0	90.00	0.35	8,020.0	8,248.7	-2,790.1	1,564,066.51	3,225,083.12	40° 52' 44.041 N	104° 41' 9.855 W
13,300.0	90.00	0.35	8,020.0	8,348.7	-2,789.5	1,564,166.51	3,225,082.80	40° 52' 45.029 N	104° 41' 9.847 W
13,400.0	90.00	0.35	8,020.0	8,448.7	-2,788.9	1,564,266.51	3,225,082.49	40° 52' 46.018 N	104° 41' 9.839 W
13,500.0	90.00	0.35	8,020.0	8,548.7	-2,788.2	1,564,366.51	3,225,082.17	40° 52' 47.006 N	104° 41' 9.831 W
13,600.0	90.00	0.35	8,020.0	8,648.7	-2,787.6	1,564,466.51	3,225,081.85	40° 52' 47.994 N	104° 41' 9.823 W
13,700.0	90.00	0.35	8,020.0	8,748.7	-2,787.0	1,564,566.51	3,225,081.53	40° 52' 48.982 N	104° 41' 9.816 W
13,800.0	90.00	0.35	8,020.0	8,848.7	-2,786.4	1,564,666.50	3,225,081.21	40° 52' 49.970 N	104° 41' 9.808 W
13,900.0	90.00	0.35	8,020.0	8,948.7	-2,785.8	1,564,766.50	3,225,080.89	40° 52' 50.958 N	104° 41' 9.800 W
14,000.0	90.00	0.35	8,020.0	9,048.6	-2,785.2	1,564,866.50	3,225,080.57	40° 52' 51.946 N	104° 41' 9.792 W
14,100.0	90.00	0.35	8,020.0	9,148.6	-2,784.6	1,564,966.50	3,225,080.25	40° 52' 52.934 N	104° 41' 9.784 W
14,200.0	90.00	0.35	8,020.0	9,248.6	-2,784.0	1,565,066.50	3,225,079.93	40° 52' 53.922 N	104° 41' 9.777 W
14,300.0	90.00	0.35	8,020.0	9,348.6	-2,783.4	1,565,166.50	3,225,079.61	40° 52' 54.910 N	104° 41' 9.769 W
14,400.0	90.00	0.35	8,020.0	9,448.6	-2,782.8	1,565,266.50	3,225,079.29	40° 52' 55.898 N	104° 41' 9.761 W
14,500.0	90.00	0.35	8,020.0	9,548.6	-2,782.1	1,565,366.50	3,225,078.97	40° 52' 56.886 N	104° 41' 9.753 W
14,600.0	90.00	0.35	8,020.0	9,648.6	-2,781.5	1,565,466.50	3,225,078.65	40° 52' 57.874 N	104° 41' 9.745 W
14,700.0	90.00	0.35	8,020.0	9,748.6	-2,780.9	1,565,566.50	3,225,078.33	40° 52' 58.862 N	104° 41' 9.738 W
14,800.0	90.00	0.35	8,020.0	9,848.6	-2,780.3	1,565,666.50	3,225,078.01	40° 52' 59.850 N	104° 41' 9.730 W
14,900.0	90.00	0.35	8,020.0	9,948.6	-2,779.7	1,565,766.50	3,225,077.69	40° 53' 0.838 N	104° 41' 9.722 W
15,000.0	90.00	0.35	8,020.0	10,048.6	-2,779.1	1,565,866.50	3,225,077.38	40° 53' 1.826 N	104° 41' 9.714 W
15,100.0	90.00	0.35	8,020.0	10,148.6	-2,778.5	1,565,966.49	3,225,077.06	40° 53' 2.814 N	104° 41' 9.706 W
15,200.0	90.00	0.35	8,020.0	10,248.6	-2,777.9	1,566,066.48	3,225,076.74	40° 53' 3.802 N	104° 41' 9.699 W
15,300.0	90.00	0.35	8,020.0	10,348.6	-2,777.3	1,566,166.48	3,225,076.42	40° 53' 4.790 N	104° 41' 9.691 W
15,400.0	90.00	0.35	8,020.0	10,448.6	-2,776.7	1,566,266.48	3,225,076.10	40° 53' 5.778 N	104° 41' 9.683 W

Database:	EDM 5000.1 Single User Db	Local Co-ordinate Reference:	Well Reporter 32-29-7H
Company:	Edge Energy, LLC	TVD Reference:	WELL @ 5400.0usft (Original Well Elev)
Project:	Sec. 4-T10N-R65W	MD Reference:	WELL @ 5400.0usft (Original Well Elev)
Site:	Deporter 4-A	North Reference:	True
Well:	Deporter 32-29-7H	Survey Calculation Method:	Minimum Curvature
Wellbore:	Wellbore #1		
Design:	Design #1 28Mar18 mnh		

Planned Survey										
Measured Depth (usft)	Inclination (°)	Azimuth (°)	Vertical Depth (usft)	+N/-S (usft)	+E/-W (usft)	Map Northing (usft)	Map Easting (usft)	Latitude	Longitude	
15,500.0	90.00	0.35	8,020.0	10,548.6	-2,776.1	1,566,366.48	3,225,075.78	40° 53' 6.766 N	104° 41' 9.675 W	
15,600.0	90.00	0.35	8,020.0	10,648.6	-2,775.4	1,566,466.48	3,225,075.46	40° 53' 7.755 N	104° 41' 9.668 W	
15,700.0	90.00	0.35	8,020.0	10,748.6	-2,774.8	1,566,566.48	3,225,075.14	40° 53' 8.743 N	104° 41' 9.660 W	
15,800.0	90.00	0.35	8,020.0	10,848.6	-2,774.2	1,566,666.48	3,225,074.82	40° 53' 9.731 N	104° 41' 9.652 W	
15,900.0	90.00	0.35	8,020.0	10,948.6	-2,773.6	1,566,766.48	3,225,074.50	40° 53' 10.719 N	104° 41' 9.644 W	
16,000.0	90.00	0.35	8,020.0	11,048.6	-2,773.0	1,566,866.48	3,225,074.18	40° 53' 11.707 N	104° 41' 9.636 W	
16,100.0	90.00	0.35	8,020.0	11,148.6	-2,772.4	1,566,966.48	3,225,073.86	40° 53' 12.695 N	104° 41' 9.629 W	
16,200.0	90.00	0.35	8,020.0	11,248.6	-2,771.8	1,567,066.48	3,225,073.54	40° 53' 13.683 N	104° 41' 9.621 W	
16,300.0	90.00	0.35	8,020.0	11,348.6	-2,771.2	1,567,166.48	3,225,073.22	40° 53' 14.671 N	104° 41' 9.613 W	
16,400.0	90.00	0.35	8,020.0	11,448.6	-2,770.6	1,567,266.48	3,225,072.90	40° 53' 15.659 N	104° 41' 9.605 W	
16,500.0	90.00	0.35	8,020.0	11,548.6	-2,770.0	1,567,366.48	3,225,072.58	40° 53' 16.647 N	104° 41' 9.597 W	
16,600.0	90.00	0.35	8,020.0	11,648.6	-2,769.3	1,567,466.47	3,225,072.27	40° 53' 17.635 N	104° 41' 9.590 W	
16,700.0	90.00	0.35	8,020.0	11,748.6	-2,768.7	1,567,566.47	3,225,071.95	40° 53' 18.623 N	104° 41' 9.582 W	
16,800.0	90.00	0.35	8,020.0	11,848.6	-2,768.1	1,567,666.47	3,225,071.63	40° 53' 19.611 N	104° 41' 9.574 W	
16,900.0	90.00	0.35	8,020.0	11,948.6	-2,767.5	1,567,766.47	3,225,071.31	40° 53' 20.599 N	104° 41' 9.566 W	
17,000.0	90.00	0.35	8,020.0	12,048.6	-2,766.9	1,567,866.47	3,225,070.99	40° 53' 21.587 N	104° 41' 9.558 W	
17,100.0	90.00	0.35	8,020.0	12,148.6	-2,766.3	1,567,966.47	3,225,070.67	40° 53' 22.575 N	104° 41' 9.551 W	
17,200.0	90.00	0.35	8,020.0	12,248.6	-2,765.7	1,568,066.47	3,225,070.35	40° 53' 23.563 N	104° 41' 9.543 W	
17,300.0	90.00	0.35	8,020.0	12,348.6	-2,765.1	1,568,166.47	3,225,070.03	40° 53' 24.551 N	104° 41' 9.535 W	
17,400.0	90.00	0.35	8,020.0	12,448.6	-2,764.5	1,568,266.47	3,225,069.71	40° 53' 25.539 N	104° 41' 9.527 W	
17,500.0	90.00	0.35	8,020.0	12,548.6	-2,763.9	1,568,366.47	3,225,069.39	40° 53' 26.527 N	104° 41' 9.519 W	
17,600.0	90.00	0.35	8,020.0	12,648.6	-2,763.2	1,568,466.47	3,225,069.07	40° 53' 27.515 N	104° 41' 9.512 W	
17,700.0	90.00	0.35	8,020.0	12,748.6	-2,762.6	1,568,566.47	3,225,068.75	40° 53' 28.503 N	104° 41' 9.504 W	
17,800.0	90.00	0.35	8,020.0	12,848.6	-2,762.0	1,568,666.47	3,225,068.43	40° 53' 29.491 N	104° 41' 9.496 W	
17,900.0	90.00	0.35	8,020.0	12,948.6	-2,761.4	1,568,766.47	3,225,068.11	40° 53' 30.480 N	104° 41' 9.488 W	
18,000.0	90.00	0.35	8,020.0	13,048.6	-2,760.8	1,568,866.46	3,225,067.79	40° 53' 31.468 N	104° 41' 9.480 W	
18,100.0	90.00	0.35	8,020.0	13,148.6	-2,760.2	1,568,966.46	3,225,067.47	40° 53' 32.456 N	104° 41' 9.473 W	
18,200.0	90.00	0.35	8,020.0	13,248.6	-2,759.6	1,569,066.46	3,225,067.16	40° 53' 33.444 N	104° 41' 9.465 W	
18,300.0	90.00	0.35	8,020.0	13,348.6	-2,759.0	1,569,166.46	3,225,066.84	40° 53' 34.432 N	104° 41' 9.457 W	
18,400.0	90.00	0.35	8,020.0	13,448.6	-2,758.4	1,569,266.46	3,225,066.52	40° 53' 35.420 N	104° 41' 9.449 W	
18,500.0	90.00	0.35	8,020.0	13,548.6	-2,757.8	1,569,366.46	3,225,066.20	40° 53' 36.408 N	104° 41' 9.442 W	
18,600.0	90.00	0.35	8,020.0	13,648.6	-2,757.1	1,569,466.46	3,225,065.88	40° 53' 37.396 N	104° 41' 9.434 W	
18,700.0	90.00	0.35	8,020.0	13,748.6	-2,756.5	1,569,566.46	3,225,065.56	40° 53' 38.384 N	104° 41' 9.426 W	
18,800.0	90.00	0.35	8,020.0	13,848.6	-2,755.9	1,569,666.46	3,225,065.24	40° 53' 39.372 N	104° 41' 9.418 W	
18,900.0	90.00	0.35	8,020.0	13,948.5	-2,755.3	1,569,766.46	3,225,064.92	40° 53' 40.360 N	104° 41' 9.410 W	
19,000.0	90.00	0.35	8,020.0	14,048.5	-2,754.7	1,569,866.46	3,225,064.60	40° 53' 41.348 N	104° 41' 9.403 W	
19,100.0	90.00	0.35	8,020.0	14,148.5	-2,754.1	1,569,966.46	3,225,064.28	40° 53' 42.336 N	104° 41' 9.395 W	
19,200.0	90.00	0.35	8,020.0	14,248.5	-2,753.5	1,570,066.46	3,225,063.96	40° 53' 43.324 N	104° 41' 9.387 W	
19,300.0	90.00	0.35	8,020.0	14,348.5	-2,752.9	1,570,166.46	3,225,063.64	40° 53' 44.312 N	104° 41' 9.379 W	
19,400.0	90.00	0.35	8,020.0	14,448.5	-2,752.3	1,570,266.45	3,225,063.32	40° 53' 45.300 N	104° 41' 9.371 W	
19,500.0	90.00	0.35	8,020.0	14,548.5	-2,751.7	1,570,366.45	3,225,063.00	40° 53' 46.288 N	104° 41' 9.364 W	
19,600.0	90.00	0.35	8,020.0	14,648.5	-2,751.0	1,570,466.45	3,225,062.68	40° 53' 47.276 N	104° 41' 9.356 W	
19,700.0	90.00	0.35	8,020.0	14,748.5	-2,750.4	1,570,566.45	3,225,062.36	40° 53' 48.264 N	104° 41' 9.348 W	
19,800.0	90.00	0.35	8,020.0	14,848.5	-2,749.8	1,570,666.45	3,225,062.05	40° 53' 49.252 N	104° 41' 9.340 W	
19,900.0	90.00	0.35	8,020.0	14,948.5	-2,749.2	1,570,766.45	3,225,061.73	40° 53' 50.240 N	104° 41' 9.332 W	
19,916.8	90.00	0.35	8,020.0	14,965.3	-2,749.1	1,570,783.26	3,225,061.67	40° 53' 50.406 N	104° 41' 9.331 W	
TD at 19916.8										

Database:	EDM 5000.1 Single User Db	Local Co-ordinate Reference:	Well Deporter 32-29-7H
Company:	Edge Energy, LLC	TVD Reference:	WELL @ 5400.0usft (Original Well Elev)
Project:	Sec. 4-T10N-R65W	MD Reference:	WELL @ 5400.0usft (Original Well Elev)
Site:	Deporter 4-A	North Reference:	True
Well:	Deporter 32-29-7H	Survey Calculation Method:	Minimum Curvature
Wellbore:	Wellbore #1		
Design:	Design #1 28Mar18 mnh		

Design Targets									
Target Name	Dip Angle	Dip Dir.	TVD	+N/-S	+E/-W	Northing	Easting	Latitude	Longitude
- hit/miss target	(°)	(°)	(usft)	(usft)	(usft)	(usft)	(usft)		
- Shape									
SHL 260' FSI, 275' FWL - plan hits target center - Point	0.00	0.00	0.0	0.0	0.0	1,555,844.12	3,227,949.73	40° 51' 22.540 N	104° 40' 33.534 W
EP 600' FSL, 2420' FEL - plan hits target center - Point	0.00	0.00	8,020.0	5,616.2	-2,806.1	1,561,434.02	3,225,091.53	40° 52' 18.031 N	104° 41' 10.060 W
BHL 600' FNL, 2420' FE - plan hits target center - Point	0.00	0.00	8,020.0	14,965.3	-2,749.1	1,570,783.26	3,225,061.67	40° 53' 50.406 N	104° 41' 9.331 W

Plan Annotations				
Measured Depth	Vertical Depth	Local Coordinates		Comment
(usft)	(usft)	+N/-S (usft)	+E/-W (usft)	
500.0	500.0	0.0	0.0	Start Build 2.00
2,650.2	2,453.9	679.0	-362.6	Hold 43 Inc, 331.89 Az
9,903.0	7,758.0	5,042.4	-2,693.2	KOP 8/100
10,567.5	8,020.0	5,616.2	-2,806.1	EP 90 Inc, .35 Az
19,916.8	8,020.0	14,965.3	-2,749.1	TD at 19916.8