

BAYSWATER E & P, LLC

Location	Weld County, CO	Slot	Hester Farms II K-31-32HN
Field	WATTENBERG	Well	W Hester Farms II K-31-32HN
Installation	Hester Farms II Pad	Wellbore	W Hester Farms II K-31-32HN (PWB)

East (Feet) ->

-3200 -1600 0 1600 3200 4800 6400 8000 9600 11200
Scale 1 cm = 800 ft

N
GRID

Surface 0.00 N 0.00 E

Hester Farms II K-31-32HN - BH

Hester Farms II K-31-32HN - EP

1600
0
-1600
-3200
Scale 1 cm = 800 ft
North (Feet)

WELL PROFILE DATA

Point	MD	Inc	Azi	TVD	North	East	deg/100ft	V. Sect
Tie on	25.00	0.00	0.00	25.00	S 0.00	W 0.00		0.00
KOP	1025.00	0.00	233.37	1025.00	S 0.00	W 0.00	0.00	0.00
End of Build	1483.14	9.16	233.37	1481.19	S 21.81	W 29.34	2.00	-28.57
End of Hold	6665.44	9.16	233.37	6597.36	S 514.13	W 691.62	0.00	-673.53
Target Hester...N - EP	7640.71	90.06	88.66	7242.00	S 560.90	W 121.69	10.00	-102.33
T.D. & Target Hes... BH	17408.38	90.06	88.66	7232.00	S 331.84	E 9643.28	0.00	9648.99

Dec-20-2017
EMM-2015 [2000.0-2020.0] Dip: 66.96 deg Field: 52420.0 n
Lat: N40 32 1.4136 Long: W104 49 47.9172 Elev: 4917.00 ft
Magnetic North is 8.24 deg East of True North
GRID North is 0.43 deg East of True North
To correct azimuth from True to GRID subtract 0.43 deg
To correct azimuth from Magnetic to GRID add 7.81 deg

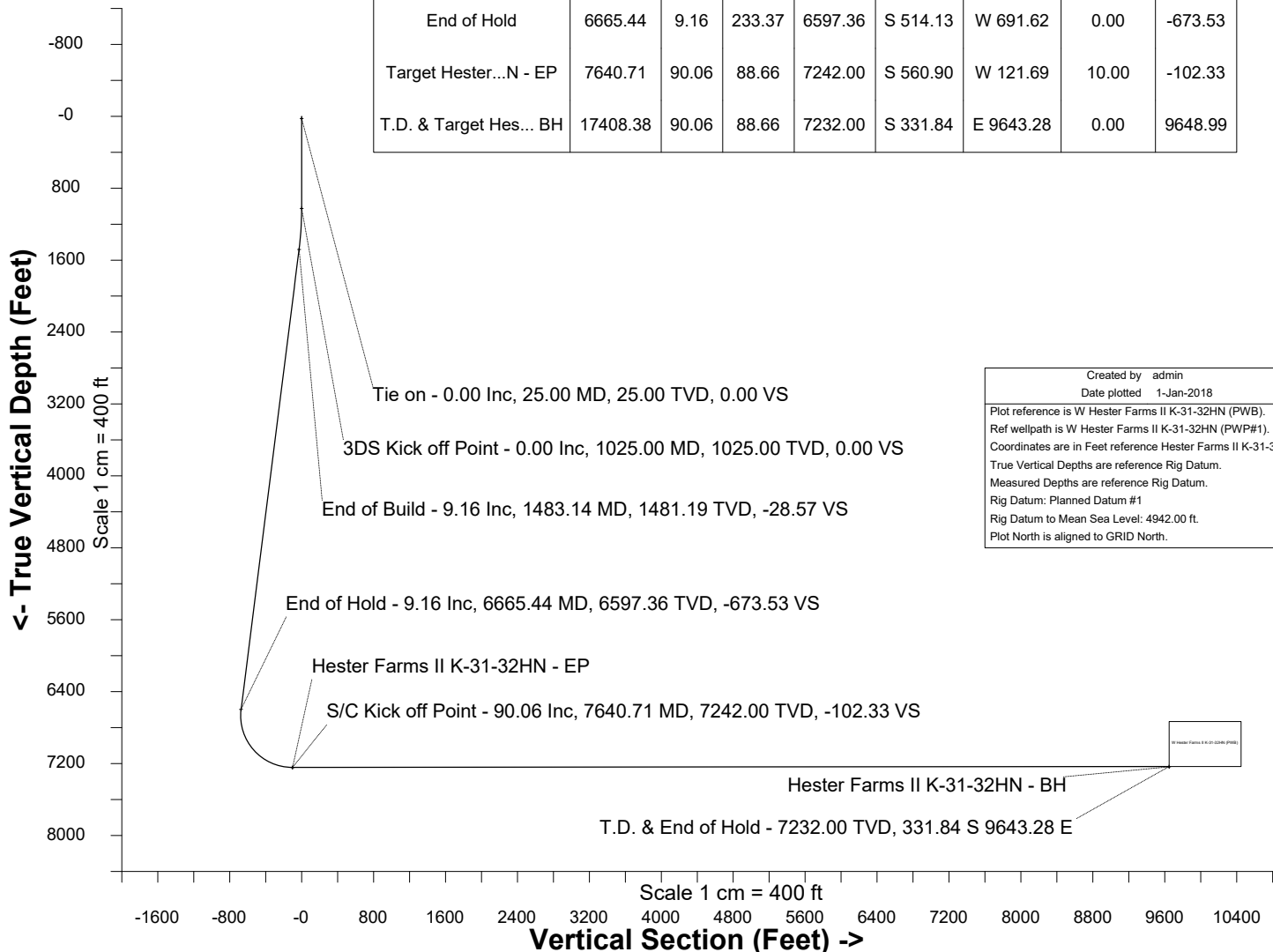

Created by admin
Date plotted 1-Jan-2018
Plot reference is W Hester Farms II K-31-32HN (PWB).
Ref wellpath is W Hester Farms II K-31-32HN (PWP#1).
Coordinates are in Feet reference Hester Farms II K-31-32HN.
True Vertical Depths are reference Rig Datum.
Measured Depths are reference Rig Datum.
Rig Datum: Planned Datum #1
Rig Datum to Mean Sea Level: 4942.00 ft.
Plot North is aligned to GRID North.



SYSDRILL
Well Design Combined Report
Wellbore: W Hester Farms II K-31-32HN (PWB)



Wellhead Details

Name	Latitude	Longitude	Northing	Easting	North	East	Slot Elevation Above Ground
Hester Farms II K-31-32HN	40.53331400	-104.82998100	1437830.6216	3186238.4933	150.10S	0.02E	0.00

Declination

Date	Source	Time
Dec-20-2017	EMM-2015 [2000.0-2020.0]	11:12

Installation Details

Name	Installation Position (Latitude)	Installation Position (Longitude)	Northing	Easting	Coord System Name	North Alignment
Hester Farms II Pad	40.53372600	-104.82997700	1437980.7208	3186238.4710	CO83-NF on NORTH AMERICAN DATUM 1983 datum	Grid

Summary Wellpath

MD[ft]	Inc[deg]	Azi[deg]	TVD[ft]	North[ft]	East[ft]	Dogleg [deg/100ft]	Vertical Section[ft]	Northing	Easting
25.00	0.00	0.000	25.00	0.00N	0.00E		0.00	1437830.62	3186238.49
1025.00	0.00	233.370	1025.00	0.00N	0.00E	==>	0.00	1437830.62	3186238.49
1483.14	9.16	233.370	1481.19	21.81S	29.34W	2.00	-28.57	1437808.81	3186209.16
6665.44	9.16	233.370	6597.36	514.13S	691.62W	==>	-673.53	1437316.51	3185546.89
7640.71	90.06	88.660	7242.00	560.90S	121.69W	10.00	-102.33	1437269.74	3186116.81
17408.38	90.06	88.660	7232.00	331.84S	9643.28E	==>	9648.99	1437498.79	3195881.46

Interpolated Wellpath

MD[ft]	Inc[deg]	Azi[deg]	TVD[ft]	North[ft]	East[ft]	Dogleg [deg/100ft]	Vertical Section[ft]	All Station Comments
0.00	0.00	0.000	0.00	0.00N	0.00E		0.00	Rig Datum
25.00	0.00	0.000	25.00	0.00N	0.00E	==>	0.00	Slot Datum
100.00	0.00	0.000	100.00	0.00N	0.00E	==>	0.00	
200.00	0.00	0.000	200.00	0.00N	0.00E	==>	0.00	
300.00	0.00	0.000	300.00	0.00N	0.00E	==>	0.00	
400.00	0.00	0.000	400.00	0.00N	0.00E	==>	0.00	
500.00	0.00	0.000	500.00	0.00N	0.00E	==>	0.00	
600.00	0.00	0.000	600.00	0.00N	0.00E	==>	0.00	
700.00	0.00	0.000	700.00	0.00N	0.00E	==>	0.00	
800.00	0.00	0.000	800.00	0.00N	0.00E	==>	0.00	
900.00	0.00	0.000	900.00	0.00N	0.00E	==>	0.00	
1000.00	0.00	0.000	1000.00	0.00N	0.00E	==>	0.00	
1100.00	1.50	233.370	1099.99	0.59S	0.79W	2.00	-0.77	
1200.00	3.50	233.370	1199.89	3.19S	4.29W	2.00	-4.18	
1300.00	5.50	233.370	1299.58	7.87S	10.58W	2.00	-10.31	
1400.00	7.50	233.370	1398.93	14.62S	19.67W	2.00	-19.15	
1500.00	9.16	233.370	1497.83	23.41S	31.49W	==>	-30.67	
1525.00	9.16	233.370	1522.52	25.78S	34.69W	==>	-33.78	
1625.00	9.16	233.370	1621.24	35.28S	47.47W	==>	-46.23	
1725.00	9.16	233.370	1719.96	44.78S	60.25W	==>	-58.67	
1825.00	9.16	233.370	1818.69	54.28S	73.03W	==>	-71.12	
1925.00	9.16	233.370	1917.41	63.78S	85.81W	==>	-83.56	
2025.00	9.16	233.370	2016.14	73.29S	98.59W	==>	-96.01	
2125.00	9.16	233.370	2114.86	82.79S	111.37W	==>	-108.45	
2225.00	9.16	233.370	2213.58	92.29S	124.15W	==>	-120.90	
2325.00	9.16	233.370	2312.31	101.79S	136.93W	==>	-133.34	
2425.00	9.16	233.370	2411.03	111.29S	149.70W	==>	-145.79	
2525.00	9.16	233.370	2509.76	120.79S	162.48W	==>	-158.23	
2625.00	9.16	233.370	2608.48	130.29S	175.26W	==>	-170.68	
2725.00	9.16	233.370	2707.20	139.79S	188.04W	==>	-183.13	
2825.00	9.16	233.370	2805.93	149.29S	200.82W	==>	-195.57	
2925.00	9.16	233.370	2904.65	158.79S	213.60W	==>	-208.02	

All data is in Feet unless otherwise stated
Coordinates are from Slot MD's are from Rig and TVD's are from Rig (Planned Datum #1 4942.0ft above Mean Sea Level)
Vertical Section is from 0.00N 0.00E on azimuth 91.970 degrees
Bottom hole distance is 9648.99 Feet on azimuth 91.97 degrees from Wellhead
Calculation method uses Minimum Curvature method
Prepared by Microsoft
Date Printed: 1-Jan-2018



SYSDRILL
Well Design Combined Report
Wellbore: W Hester Farms II K-31-32HN (PWB)



Interpolated Wellpath								
MD[ft]	Inc[deg]	Azi[deg]	TVD[ft]	North[ft]	East[ft]	Dogleg [deg/100ft]	Vertical Section[ft]	All Station Comments
3025.00	9.16	233.370	3003.38	168.29S	226.38W	==>	-220.46	
3125.00	9.16	233.370	3102.10	177.79S	239.16W	==>	-232.91	
3225.00	9.16	233.370	3200.82	187.29S	251.94W	==>	-245.35	
3325.00	9.16	233.370	3299.55	196.79S	264.72W	==>	-257.80	
3425.00	9.16	233.370	3398.27	206.29S	277.50W	==>	-270.24	
3525.00	9.16	233.370	3497.00	215.79S	290.28W	==>	-282.69	
3625.00	9.16	233.370	3595.72	225.29S	303.06W	==>	-295.14	
3725.00	9.16	233.370	3694.44	234.79S	315.84W	==>	-307.58	
3825.00	9.16	233.370	3793.17	244.29S	328.62W	==>	-320.03	
3925.00	9.16	233.370	3891.89	253.79S	341.40W	==>	-332.47	
4025.00	9.16	233.370	3990.62	263.29S	354.18W	==>	-344.92	
4125.00	9.16	233.370	4089.34	272.79S	366.96W	==>	-357.36	
4225.00	9.16	233.370	4188.06	282.29S	379.74W	==>	-369.81	
4325.00	9.16	233.370	4286.79	291.79S	392.52W	==>	-382.25	
4425.00	9.16	233.370	4385.51	301.29S	405.30W	==>	-394.70	
4525.00	9.16	233.370	4484.24	310.79S	418.08W	==>	-407.14	
4625.00	9.16	233.370	4582.96	320.29S	430.86W	==>	-419.59	
4725.00	9.16	233.370	4681.68	329.79S	443.64W	==>	-432.04	
4825.00	9.16	233.370	4780.41	339.29S	456.42W	==>	-444.48	
4925.00	9.16	233.370	4879.13	348.79S	469.20W	==>	-456.93	
5025.00	9.16	233.370	4977.86	358.29S	481.98W	==>	-469.37	
5125.00	9.16	233.370	5076.58	367.79S	494.76W	==>	-481.82	
5225.00	9.16	233.370	5175.30	377.29S	507.54W	==>	-494.26	
5325.00	9.16	233.370	5274.03	386.79S	520.32W	==>	-506.71	
5425.00	9.16	233.370	5372.75	396.29S	533.10W	==>	-519.15	
5525.00	9.16	233.370	5471.48	405.79S	545.88W	==>	-531.60	
5625.00	9.16	233.370	5570.20	415.29S	558.66W	==>	-544.05	
5725.00	9.16	233.370	5668.92	424.79S	571.44W	==>	-556.49	
5825.00	9.16	233.370	5767.65	434.29S	584.22W	==>	-568.94	
5925.00	9.16	233.370	5866.37	443.79S	597.00W	==>	-581.38	
6025.00	9.16	233.370	5965.10	453.29S	609.78W	==>	-593.83	
6125.00	9.16	233.370	6063.82	462.79S	622.56W	==>	-606.27	
6225.00	9.16	233.370	6162.54	472.29S	635.34W	==>	-618.72	
6325.00	9.16	233.370	6261.27	481.79S	648.12W	==>	-631.16	
6425.00	9.16	233.370	6359.99	491.29S	660.90W	==>	-643.61	
6525.00	9.16	233.370	6458.72	500.79S	673.68W	==>	-656.05	
6625.00	9.16	233.370	6557.44	510.29S	686.46W	==>	-668.50	
6725.00	5.53	194.550	6656.46	519.74S	696.15W	10.00	-677.87	
6825.00	10.01	120.530	6755.72	528.85S	689.86W	10.00	-671.27	
6925.00	19.21	104.170	6852.42	537.31S	666.37W	10.00	-647.49	
7025.00	28.94	98.360	6943.62	544.88S	626.37W	10.00	-607.26	
7125.00	38.80	95.320	7026.55	551.31S	571.10W	10.00	-551.80	
7225.00	48.71	93.360	7098.70	556.43S	502.23W	10.00	-482.80	
7325.00	58.64	91.920	7157.87	560.07S	421.85W	10.00	-402.34	
7425.00	68.59	90.760	7202.26	562.11S	332.41W	10.00	-312.88	
7525.00	78.54	89.740	7230.52	562.51S	236.62W	10.00	-217.14	
7625.00	88.49	88.800	7241.80	561.24S	137.40W	10.00	-118.01	
7725.00	90.06	88.660	7241.91	558.92S	37.42W	==>	-18.18	
7825.00	90.06	88.660	7241.81	556.57S	62.55E	==>	81.65	
7925.00	90.06	88.660	7241.71	554.23S	162.52E	==>	181.48	
8025.00	90.06	88.660	7241.61	551.88S	262.49E	==>	281.32	
8125.00	90.06	88.660	7241.50	549.54S	362.46E	==>	381.15	
8225.00	90.06	88.660	7241.40	547.19S	462.44E	==>	480.98	
8325.00	90.06	88.660	7241.30	544.85S	562.41E	==>	580.82	
8425.00	90.06	88.660	7241.20	542.50S	662.38E	==>	680.65	
8525.00	90.06	88.660	7241.09	540.16S	762.35E	==>	780.48	
8625.00	90.06	88.660	7240.99	537.81S	862.33E	==>	880.31	
8725.00	90.06	88.660	7240.89	535.47S	962.30E	==>	980.15	
8825.00	90.06	88.660	7240.79	533.12S	1062.27E	==>	1079.98	

All data is in Feet unless otherwise stated
Coordinates are from Slot MD's are from Rig and TVD's are from Rig (Planned Datum #1 4942.0ft above Mean Sea Level)
Vertical Section is from 0.00N 0.00E on azimuth 91.970 degrees
Bottom hole distance is 9648.99 Feet on azimuth 91.97 degrees from Wellhead
Calculation method uses Minimum Curvature method
Prepared by Microsoft
Date Printed: 1-Jan-2018



SYSDRILL
Well Design Combined Report
Wellbore: W Hester Farms II K-31-32HN (PWB)



Interpolated Wellpath								
MD[ft]	Inc[deg]	Azi[deg]	TVD[ft]	North[ft]	East[ft]	Dogleg [deg/100ft]	Vertical Section[ft]	All Station Comments
8925.00	90.06	88.660	7240.69	530.78S	1162.24E	==>	1179.81	
9025.00	90.06	88.660	7240.58	528.43S	1262.22E	==>	1279.64	
9125.00	90.06	88.660	7240.48	526.09S	1362.19E	==>	1379.48	
9225.00	90.06	88.660	7240.38	523.74S	1462.16E	==>	1479.31	
9325.00	90.06	88.660	7240.28	521.40S	1562.13E	==>	1579.14	
9425.00	90.06	88.660	7240.17	519.05S	1662.11E	==>	1678.97	
9525.00	90.06	88.660	7240.07	516.71S	1762.08E	==>	1778.81	
9625.00	90.06	88.660	7239.97	514.36S	1862.05E	==>	1878.64	
9725.00	90.06	88.660	7239.87	512.02S	1962.02E	==>	1978.47	
9825.00	90.06	88.660	7239.76	509.67S	2062.00E	==>	2078.31	
9925.00	90.06	88.660	7239.66	507.33S	2161.97E	==>	2178.14	
10025.00	90.06	88.660	7239.56	504.98S	2261.94E	==>	2277.97	
10125.00	90.06	88.660	7239.46	502.64S	2361.91E	==>	2377.80	
10225.00	90.06	88.660	7239.35	500.29S	2461.89E	==>	2477.64	
10325.00	90.06	88.660	7239.25	497.95S	2561.86E	==>	2577.47	
10425.00	90.06	88.660	7239.15	495.60S	2661.83E	==>	2677.30	
10525.00	90.06	88.660	7239.05	493.26S	2761.80E	==>	2777.13	
10625.00	90.06	88.660	7238.94	490.91S	2861.78E	==>	2876.97	
10725.00	90.06	88.660	7238.84	488.57S	2961.75E	==>	2976.80	
10825.00	90.06	88.660	7238.74	486.22S	3061.72E	==>	3076.63	
10925.00	90.06	88.660	7238.64	483.88S	3161.69E	==>	3176.46	
11025.00	90.06	88.660	7238.54	481.53S	3261.67E	==>	3276.30	
11125.00	90.06	88.660	7238.43	479.19S	3361.64E	==>	3376.13	
11225.00	90.06	88.660	7238.33	476.84S	3461.61E	==>	3475.96	
11325.00	90.06	88.660	7238.23	474.50S	3561.58E	==>	3575.80	
11425.00	90.06	88.660	7238.13	472.15S	3661.56E	==>	3675.63	
11525.00	90.06	88.660	7238.02	469.81S	3761.53E	==>	3775.46	
11625.00	90.06	88.660	7237.92	467.46S	3861.50E	==>	3875.29	
11725.00	90.06	88.660	7237.82	465.12S	3961.47E	==>	3975.13	
11825.00	90.06	88.660	7237.72	462.77S	4061.45E	==>	4074.96	
11925.00	90.06	88.660	7237.61	460.43S	4161.42E	==>	4174.79	
12025.00	90.06	88.660	7237.51	458.08S	4261.39E	==>	4274.62	
12125.00	90.06	88.660	7237.41	455.74S	4361.36E	==>	4374.46	
12225.00	90.06	88.660	7237.31	453.39S	4461.34E	==>	4474.29	
12325.00	90.06	88.660	7237.20	451.05S	4561.31E	==>	4574.12	
12425.00	90.06	88.660	7237.10	448.70S	4661.28E	==>	4673.95	
12525.00	90.06	88.660	7237.00	446.36S	4761.25E	==>	4773.79	
12625.00	90.06	88.660	7236.90	444.01S	4861.23E	==>	4873.62	
12725.00	90.06	88.660	7236.79	441.67S	4961.20E	==>	4973.45	
12825.00	90.06	88.660	7236.69	439.32S	5061.17E	==>	5073.29	
12925.00	90.06	88.660	7236.59	436.98S	5161.14E	==>	5173.12	
13025.00	90.06	88.660	7236.49	434.63S	5261.11E	==>	5272.95	
13125.00	90.06	88.660	7236.39	432.29S	5361.09E	==>	5372.78	
13225.00	90.06	88.660	7236.28	429.94S	5461.06E	==>	5472.62	
13325.00	90.06	88.660	7236.18	427.60S	5561.03E	==>	5572.45	
13425.00	90.06	88.660	7236.08	425.25S	5661.00E	==>	5672.28	
13525.00	90.06	88.660	7235.98	422.91S	5760.98E	==>	5772.11	
13625.00	90.06	88.660	7235.87	420.56S	5860.95E	==>	5871.95	
13725.00	90.06	88.660	7235.77	418.22S	5960.92E	==>	5971.78	
13825.00	90.06	88.660	7235.67	415.87S	6060.89E	==>	6071.61	
13925.00	90.06	88.660	7235.57	413.53S	6160.87E	==>	6171.44	
14025.00	90.06	88.660	7235.46	411.18S	6260.84E	==>	6271.28	
14125.00	90.06	88.660	7235.36	408.84S	6360.81E	==>	6371.11	
14225.00	90.06	88.660	7235.26	406.49S	6460.78E	==>	6470.94	
14325.00	90.06	88.660	7235.16	404.15S	6560.76E	==>	6570.77	
14425.00	90.06	88.660	7235.05	401.80S	6660.73E	==>	6670.61	
14525.00	90.06	88.660	7234.95	399.46S	6760.70E	==>	6770.44	
14625.00	90.06	88.660	7234.85	397.11S	6860.67E	==>	6870.27	
14725.00	90.06	88.660	7234.75	394.77S	6960.65E	==>	6970.11	

All data is in Feet unless otherwise stated
Coordinates are from Slot MD's are from Rig and TVD's are from Rig (Planned Datum #1 4942.0ft above Mean Sea Level)
Vertical Section is from 0.00N 0.00E on azimuth 91.970 degrees
Bottom hole distance is 9648.99 Feet on azimuth 91.97 degrees from Wellhead
Calculation method uses Minimum Curvature method
Prepared by Microsoft
Date Printed: 1-Jan-2018



SYSDRILL
Well Design Combined Report
Wellbore: W Hester Farms II K-31-32HN (PWB)



Interpolated Wellpath								
MD[ft]	Inc[deg]	Azi[deg]	TVD[ft]	North[ft]	East[ft]	Dogleg [deg/100ft]	Vertical Section[ft]	All Station Comments
14825.00	90.06	88.660	7234.64	392.42S	7060.62E	==>	7069.94	
14925.00	90.06	88.660	7234.54	390.08S	7160.59E	==>	7169.77	
15025.00	90.06	88.660	7234.44	387.73S	7260.56E	==>	7269.60	
15125.00	90.06	88.660	7234.34	385.39S	7360.54E	==>	7369.44	
15225.00	90.06	88.660	7234.24	383.04S	7460.51E	==>	7469.27	
15325.00	90.06	88.660	7234.13	380.70S	7560.48E	==>	7569.10	
15425.00	90.06	88.660	7234.03	378.35S	7660.45E	==>	7668.93	
15525.00	90.06	88.660	7233.93	376.01S	7760.43E	==>	7768.77	
15625.00	90.06	88.660	7233.83	373.66S	7860.40E	==>	7868.60	
15725.00	90.06	88.660	7233.72	371.32S	7960.37E	==>	7968.43	
15825.00	90.06	88.660	7233.62	368.97S	8060.34E	==>	8068.26	
15925.00	90.06	88.660	7233.52	366.63S	8160.32E	==>	8168.10	
16025.00	90.06	88.660	7233.42	364.28S	8260.29E	==>	8267.93	
16125.00	90.06	88.660	7233.31	361.94S	8360.26E	==>	8367.76	
16225.00	90.06	88.660	7233.21	359.59S	8460.23E	==>	8467.60	
16325.00	90.06	88.660	7233.11	357.25S	8560.21E	==>	8567.43	
16425.00	90.06	88.660	7233.01	354.90S	8660.18E	==>	8667.26	
16525.00	90.06	88.660	7232.90	352.56S	8760.15E	==>	8767.09	
16625.00	90.06	88.660	7232.80	350.21S	8860.12E	==>	8866.93	
16725.00	90.06	88.660	7232.70	347.87S	8960.10E	==>	8966.76	
16825.00	90.06	88.660	7232.60	345.52S	9060.07E	==>	9066.59	
16925.00	90.06	88.660	7232.49	343.18S	9160.04E	==>	9166.42	
17025.00	90.06	88.660	7232.39	340.83S	9260.01E	==>	9266.26	
17125.00	90.06	88.660	7232.29	338.49S	9359.99E	==>	9366.09	
17225.00	90.06	88.660	7232.19	336.14S	9459.96E	==>	9465.92	
17325.00	90.06	88.660	7232.09	333.80S	9559.93E	==>	9565.75	
17408.38	90.06	88.660	7232.00	331.84S	9643.28E	==>	9648.99	

All data is in Feet unless otherwise stated
Coordinates are from Slot MD's are from Rig and TVD's are from Rig (Planned Datum #1 4942.0ft above Mean Sea Level)
Vertical Section is from 0.00N 0.00E on azimuth 91.970 degrees
Bottom hole distance is 9648.99 Feet on azimuth 91.97 degrees from Wellhead
Calculation method uses Minimum Curvature method
Prepared by Microsoft
Date Printed: 1-Jan-2018



SYS DRILL
Well Design Combined Report
Wellbore: W Hester Farms II K-31-32HN (PWB)



Targets							
Name	North[ft]	East[ft]	TVD[ft]	Latitude	Longitude	Northing	Easting
Hester Farms II K-31-32HN - BH	331.84S	9643.28E	7232.00	40.53219800	-104.79530000	1437498.79	3195881.46
Hester Farms II K-31-32HN - EP	560.90S	121.69W	7242.00	40.53177700	-104.83043400	1437269.74	3186116.81

Survey Tool Program					
Reference	Survey Name	MD[ft]	TVD[ft]	Survey Tool	Error Model
597837	Planned	1525.00	1522.52	WdW Rate Gyro	Standard
597836	Planned	17408.38	7232.00	ISCWSA MWD	Rev 4 + SAG + FLT

Notes



SYSDRILL
Closest Approach + Clearance Factor Summary Report
Wellbore: W Hester Farms II K-31-32HN (PWB)



Ellipse separations are reported ONLY if BOTH wells have uncertainty data
Only Depth and Magnetic Reference Field error terms are correlated across tie points
Scan limit is calculated on CENTRE to CENTRE distance
Summary data uses Closest Approach clearance calculation for all minima
Hole size/Casings ARE included
Hole size/Casings are NOT subtracted from Centre-Centre distance
Confidence limit of 95.00% / 2.80 SD.

Wellbore		
Name	Created	Last Revised
W Hester Farms II K-31-32HN (PWB)	Dec-20-2017	Dec-20-2017

Well		
Name	Government ID	Last Revised
W Hester Farms II K-31-32HN		Dec-20-2017

Slot						
Name	Latitude	Longitude	Grid Northing	Grid Easting	North	East
Hester Farms II K-31-32HN	40.53331400	-104.82998100	1437830.6216	3186238.4933	150.10S	0.02E

Installation						
Name	Installation Position (Latitude)	Installation Position (Longitude)	Easting	Northing	Coord System Name	North Alignment
Hester Farms II Pad	40.53372600	-104.82997700	3186238.4710	1437980.7208	CO83-NF on NORTH AMERICAN DATUM 1983 datum	Grid

Clearance Summary							
Offset WellName	Separation [ft]	MD[ft]	Diverging From[ft]	Ellipse Separation [ft]	Ellipse MD[ft]	Clearance Factor	Clearance MD[ft]
W Galloway 1	33.71	17209.15	17209.15	-71.51	17167.39	0.36	17200.20
W Rotharmel 12-32	84.47	13206.18	13206.18	-148.40	13206.18	0.36	13206.18
W Rotharmel 22-32	106.26	14374.16	14374.16	-170.71	14374.16	0.38	14374.16
W Galloway 1	181.54	17020.42	17020.42	89.29	17019.75	1.96	17003.35
W Deines 31-14	203.77	11873.60	11873.60	20.98	11873.60	1.11	11873.60
W Hester Farms II J-31-32HN	227.59	7525.00	17408.38	-483.37	17408.38	0.32	17408.38
W Moody 32-32D	230.70	15879.78	15879.78	-133.09	15879.78	0.63	15879.78
W Hester Farms II L-31-32HC	252.53	7525.00	7525.00	-325.50	17397.05	0.46	17397.05
W Hester 31-23	280.75	7927.08	7927.08	234.93	7931.82	6.07	7964.63
W Hester 31-24	287.55	9105.95	9105.95	205.86	9112.93	3.52	9125.00
HESTER FARMS K-36HC	311.27	7525.00	7525.00	277.32	7525.00	9.17	7525.00
W Moody 42-32D	336.30	17340.54	17340.54	-92.82	17340.54	0.78	17340.54
HESTER FARMS L-36HN	421.72	7525.00	7525.00	389.33	7525.00	13.02	7525.00
W Hester Farms II I-31-32HN	426.14	7525.00	17408.38	-331.08	17408.38	0.56	17408.38
HESTER FARMS J-36HN	430.22	7525.00	7525.00	376.56	7525.00	8.02	7525.00
HESTER FARMS	515.82	7525.00	7525.00	482.35	7525.00	15.41	7525.00

All data is in Feet unless otherwise stated
Coordinates are from Slot MD's are from Rig and TVD's are from Rig (Planned Datum #1 4942.0ft above Mean Sea Level)
Vertical Section is from 0.00N 0.00E on azimuth 91.970 degrees
Prepared by Microsoft
Date Printed: 2-Jan-2018



SYSDRILL
Closest Approach + Clearance Factor Summary Report
Wellbore: W Hester Farms II K-31-32HN (PWB)



Clearance Summary							
Offset WellName	Separation [ft]	MD[ft]	Diverging From[ft]	Ellipse Separation [ft]	Ellipse MD[ft]	Clearance Factor	Clearance MD[ft]
I-36HN							
W Hester Farms II H-31-32HC	643.14	7525.00	7525.00	-90.36	17408.38	0.88	17408.38
HESTER FARMS H-36HC	682.61	7525.00	7525.00	615.30	7525.00	10.14	7525.00
HESTER FARMS G-36HN	835.09	7525.00	7525.00	781.05	7525.00	15.45	7525.00
W Rotharmel 11-32H	836.71	17408.38	17408.38	269.42	17408.38	1.47	17408.38
W Hester Farms II G-31-32HN	837.77	7525.00	7525.00	437.58	12574.21	2.08	12590.62
W Hester 31-25	947.77	8371.36	8371.36	889.78	8391.14	15.38	8653.61
W Hester Farms II F-31-32HN	1051.74	7525.00	7525.00	287.04	17408.38	1.37	17408.38
W Hester Farms F-36HN	1145.04	7525.00	7525.00	1077.60	7525.00	16.98	7525.00
W Hester Farms II E-31-32HN	1256.60	7525.00	7525.00	491.71	17408.38	1.64	17408.38
W Hester Farms E-36HC	1264.07	7525.00	7525.00	1196.04	7525.00	18.53	7800.59
W Hester Farms D-36HN	1417.57	7525.00	7525.00	1349.72	7525.00	20.41	8013.85
W Moody 41-32D	1420.39	17206.61	17206.61	997.06	17249.41	3.35	17315.03
W Hester Farms II D-31-32HC	1467.21	7525.00	7525.00	716.11	17408.38	1.94	17408.38
W Moody 31-32D	1590.46	15963.10	15963.10	1222.81	16002.69	4.31	16084.71
W Deines 31-11	1599.27	12106.83	12106.83	1406.90	12164.11	8.18	12344.55
W Hester 31-21	1615.64	9452.24	9452.24	1521.03	9506.63	15.88	9933.14
W Hester 31-22	1661.41	8174.20	8174.20	1608.85	8210.70	26.01	8981.69
W Hester Farms II C-31-32HN	1671.32	7525.00	17408.38	908.61	17408.38	2.18	17408.38
W Rotharmel 21-32	1692.21	14546.29	14546.29	1407.84	14591.93	5.90	14723.16
W Rotharmel 11-32	1712.39	13256.72	13256.72	1476.68	13312.40	7.18	13476.44
W Hester Farms C-36HN	1745.67	7525.00	7525.00	1678.48	7525.00	24.04	8358.33
W Hester Farms B-36HC	1867.43	7525.00	7525.00	1800.08	7525.00	24.53	8505.97
W Hester Farms II B-31-32HN	1883.06	7525.00	7525.00	1121.63	17408.38	2.46	17408.38
W Hester Farms A-36HN	2020.21	7525.00	7525.00	1953.07	7525.00	25.55	8735.63
W Hester Farms II A-31-32HN	2062.35	7525.00	17408.38	1330.78	17408.38	2.73	17408.38

All data is in Feet unless otherwise stated
Coordinates are from Slot MD's are from Rig and TVD's are from Rig (Planned Datum #1 4942.0ft above Mean Sea Level)
Vertical Section is from 0.00N 0.00E on azimuth 91.970 degrees
Prepared by Microsoft
Date Printed: 2-Jan-2018

