



Lat40°, Inc. 6250 W. 10th Street, Unit 2, Greeley, CO 970-515-5294

HYDROLOGY MAP

BRASKALAND LLC 6N64W7F PAD

SECTION: 7
TOWNSHIP: 6N
RANGE: 64W
6TH. P.M.
WELD COUNTY, CO

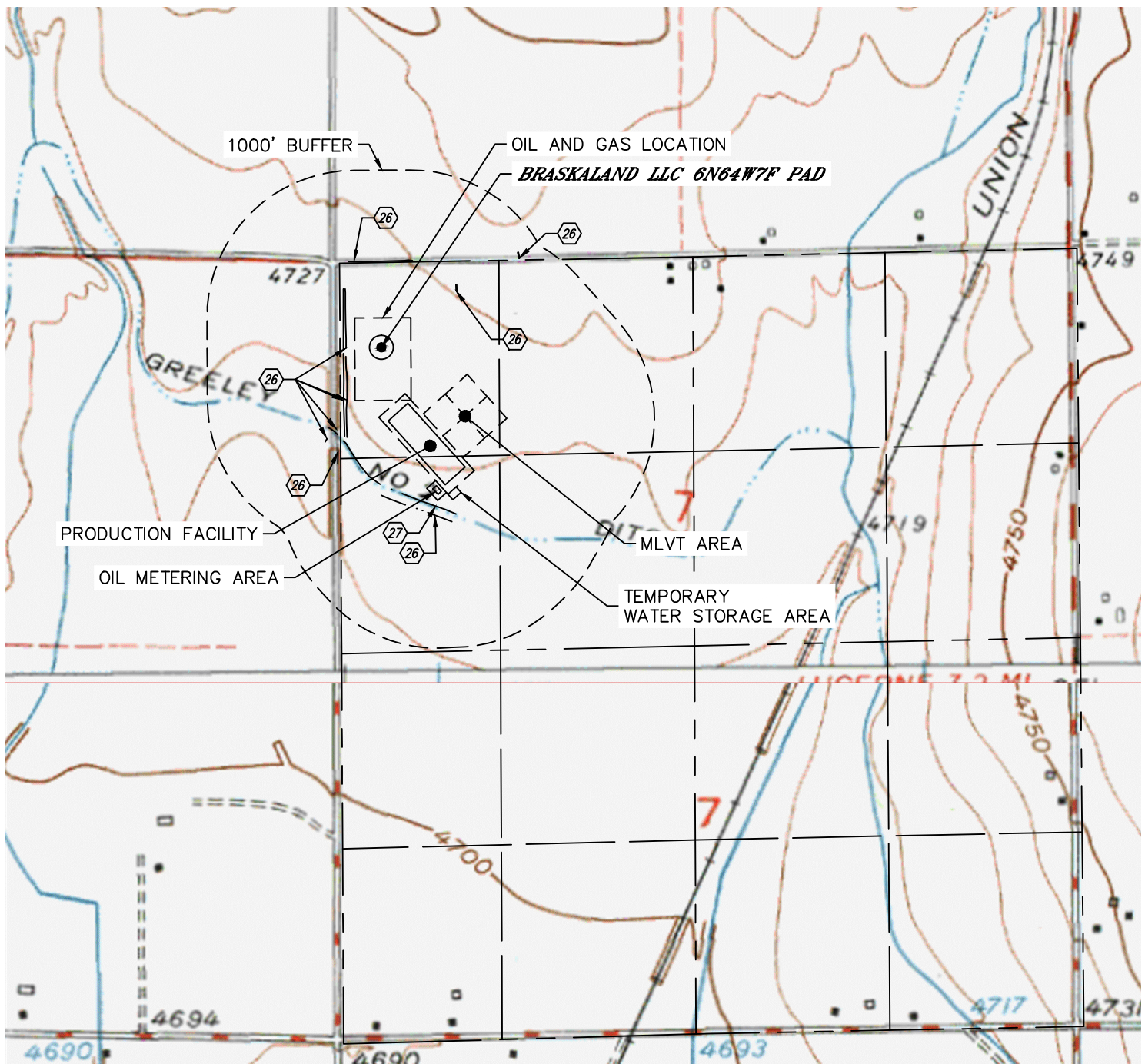

DISTANCES MEASURED FROM THE EDGE OF THE OIL AND GAS LOCATION.

- ②⑥ DITCH 55', 59' & 77' W, 99' SW, 230', 321' & 362' SW, 357' & 836' NE, 381' N
- ②⑦ GREELEY NO 2 DITCH 40' SW

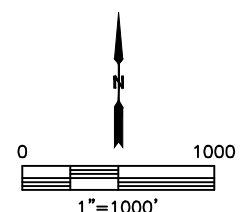

NEAREST DOWN GRADIENT SURFACE WATER: GREELEY NO 2 DITCH 40' SW

DATE: 9/26/2016
PROJECT#: 2015150