

US ROCKIES WATTENBERG PLANNING

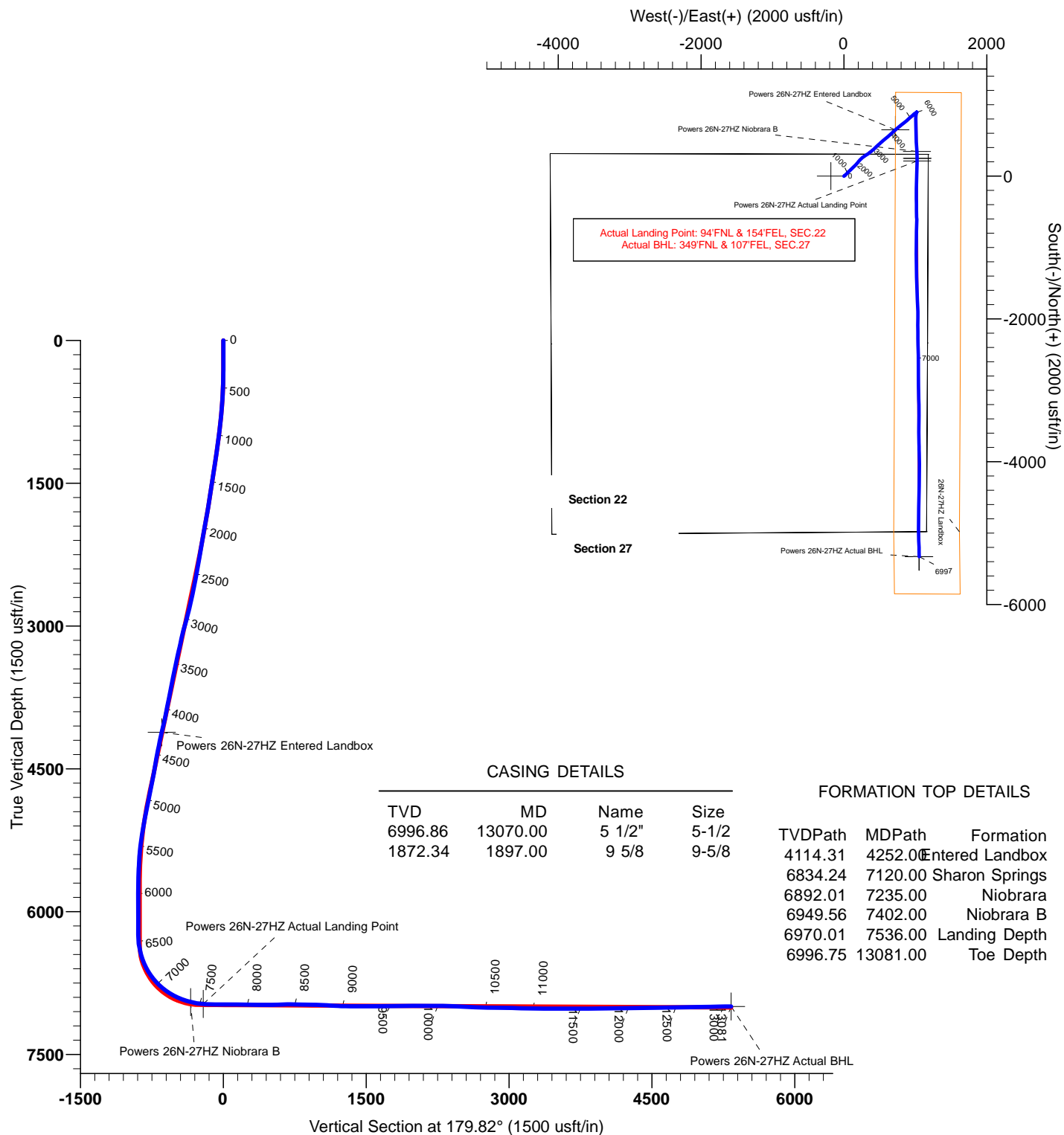

Project: WELD-NAD83-UTMFT13N
 Site: 2N-65W-22 Powers 2-22 Pad
 Well: POWERS 26N-27HZ
 Wellbore: POWERS 26N-27HZ
 Design: PDD Actual Surveys



TARGET DETAILS							
Name	TVD	+N/-S	+E/-W	Northing	Easting	Latitude	Longitude
Powers 26N-27HZ Entered Landbox	4117.15	648.30	721.84	14575114.72	1740402.28	40.132310	-104.642283
Powers 26N-27HZ Niobrara B	6949.56	346.03	1022.69	14574813.66	1740704.34	40.131480	-104.641206
Powers 26N-27HZ Actual Landing Point	6970.01	213.83	1026.19	14574681.48	1740708.36	40.131117	-104.641194
Powers 26N-27HZ Actual BHL	6996.75	-5328.56	1055.91	14569139.25	1740760.22	40.115897	-104.641088

PREMIER DIRECTIONAL DRILLING
 12941 North Freeway Suite 400, Houston, TX, 77060
 Phone: 281-673-4000



US ROCKIES WATTENBERG PLANNING

**WELD-NAD83-UTMFT13N
2N-65W-22 Powers 2-22 Pad
POWERS 26N-27HZ**

POWERS 26N-27HZ

Design: PDD Actual Surveys

Standard Survey Report

11 November, 2015

PDD

Survey Report

Company:	US ROCKIES WATTENBERG PLANNING	Local Co-ordinate Reference:	Well POWERS 26N-27HZ
Project:	WELD-NAD83-UTMFT13N	TVD Reference:	4894'+25' @ 4919.00usft (H&P307)
Site:	2N-65W-22 Powers 2-22 Pad	MD Reference:	4894'+25' @ 4919.00usft (H&P307)
Well:	POWERS 26N-27HZ	North Reference:	True
Wellbore:	POWERS 26N-27HZ	Survey Calculation Method:	Minimum Curvature
Design:	PDD Actual Surveys	Database:	EDM 5000.1 Single User Db

Project	WELD-NAD83-UTMFT13N		
Map System:	Universal Transverse Mercator (US Survey Feet)	System Datum:	Mean Sea Level
Geo Datum:	North American Datum 1983		
Map Zone:	Zone 13N (108 W to 102 W)		

Site	2N-65W-22 Powers 2-22 Pad, centered on 2N-27HZ				
Site Position:		Northing:	14,574,462.82 usft	Latitude:	40.130530
From:	Lat/Long	Easting:	1,739,503.03 usft	Longitude:	-104.645509
Position Uncertainty:	0.00 usft	Slot Radius:	13-3/16 "	Grid Convergence:	0.23 °

Well		POWERS 26N-27HZ				
Well Position	+N/-S	0.00 usft	Northing:	14,574,463.54 usft	Latitude:	40.130530
	+E/-W	0.00 usft	Easting:	1,739,683.04 usft	Longitude:	-104.644865
Position Uncertainty		3.28 usft	Wellhead Elevation:	0.00 usft	Ground Level:	4,894.00 usft

Wellbore	POWERS 26N-27HZ				
Magnetics	Model Name	Sample Date	Declination (°)	Dip Angle (°)	Field Strength (nT)
	IGRF2010	10/26/2015	8.19	66.70	52,542

Design	PDD Actual Surveys				
Audit Notes:					
Version:	1.0	Phase:	ACTUAL	Tie On Depth:	0.00
Vertical Section:	Depth From (TVD) (usft)	+N/-S (usft)	+E/-W (usft)	Direction (°)	
	0.00	0.00	0.00	179.82	

Survey Program	Date	11/11/2015			
From (usft)	To (usft)	Survey (Wellbore)	Tool Name	Description	
133.00	1,847.00	SDI MWD Surveys (POWERS 26N-27HZ)	APC_ISCWSA REV 2 MWD	Fixed:v2:standard declination	
1,991.00	13,017.00	PDD MWD+IFR+MSA Surveys (POWERS 26N-27HZ)	APC_ISCWSA REV 2 MWD+	Fixed:v2:Rockies, crustal dec + 3-axis correction	

Survey										
Measured Depth (usft)	Inclination (°)	Azimuth (°)	Vertical Depth (usft)	+N/-S (usft)	+E/-W (usft)	Vertical Section (usft)	Dogleg Rate (°/100usft)	Build Rate (°/100usft)	Turn Rate (°/100usft)	
0.00	0.00	0.00	0.00	0.00	0.00	0.00	0.00	0.00	0.00	
133.00	0.66	143.97	133.00	-0.62	0.45	0.62	0.50	0.50	0.00	
223.00	0.26	123.87	222.99	-1.15	0.93	1.16	0.47	-0.44	-22.33	
312.00	1.42	50.85	311.98	-0.57	1.95	0.57	1.54	1.30	-82.04	
435.00	2.72	53.38	434.90	2.13	5.47	-2.12	1.06	1.06	2.06	
525.00	3.24	43.85	524.78	5.24	8.95	-5.21	0.80	0.58	-10.59	
615.00	4.56	50.41	614.57	9.36	13.47	-9.31	1.55	1.47	7.29	
705.00	5.79	45.98	704.20	14.79	19.49	-14.73	1.44	1.37	-4.92	
840.00	8.42	43.44	838.15	26.70	31.18	-26.60	1.96	1.95	-1.88	
931.00	9.23	43.33	928.08	36.85	40.77	-36.72	0.89	0.89	-0.12	

PDD

Survey Report

Company:	US ROCKIES WATTENBERG PLANNING	Local Co-ordinate Reference:	Well POWERS 26N-27HZ
Project:	WELD-NAD83-UTMFT13N	TVD Reference:	4894'+25' @ 4919.00usft (H&P307)
Site:	2N-65W-22 Powers 2-22 Pad	MD Reference:	4894'+25' @ 4919.00usft (H&P307)
Well:	POWERS 26N-27HZ	North Reference:	True
Wellbore:	POWERS 26N-27HZ	Survey Calculation Method:	Minimum Curvature
Design:	PDD Actual Surveys	Database:	EDM 5000.1 Single User Db

Survey									
Measured Depth (usft)	Inclination (°)	Azimuth (°)	Vertical Depth (usft)	+N/-S (usft)	+E/-W (usft)	Vertical Section (usft)	Dogleg Rate (°/100usft)	Build Rate (°/100usft)	Turn Rate (°/100usft)
1,020.00	10.17	43.75	1,015.80	47.72	51.11	-47.56	1.06	1.06	0.47
1,156.00	12.78	44.88	1,149.07	67.05	70.03	-66.83	1.93	1.92	0.83
1,246.00	12.27	47.56	1,236.93	80.56	84.11	-80.30	0.86	-0.57	2.98
1,336.00	12.36	46.76	1,324.86	93.61	98.18	-93.30	0.21	0.10	-0.89
1,426.00	12.18	48.22	1,412.80	106.54	112.28	-106.18	0.40	-0.20	1.62
1,516.00	12.08	46.36	1,500.80	119.36	126.17	-118.96	0.45	-0.11	-2.07
1,606.00	12.50	47.33	1,588.73	132.46	140.15	-132.02	0.52	0.47	1.08
1,696.00	12.61	44.02	1,676.58	146.13	154.14	-145.64	0.81	0.12	-3.68
1,786.00	13.11	43.93	1,764.32	160.54	168.05	-160.02	0.56	0.56	-0.10
1,847.00	13.44	41.96	1,823.69	170.80	177.59	-170.24	0.92	0.54	-3.23
1,991.00	12.91	38.17	1,963.91	195.89	198.72	-195.26	0.70	-0.37	-2.63
2,086.00	13.23	42.83	2,056.45	212.21	212.67	-211.54	1.16	0.34	4.91
2,180.00	13.37	42.40	2,147.93	228.12	227.31	-227.40	0.18	0.15	-0.46
2,275.00	14.79	45.57	2,240.07	244.72	243.37	-243.95	1.70	1.49	3.34
2,369.00	15.53	49.61	2,330.80	261.27	261.53	-260.45	1.37	0.79	4.30
2,464.00	16.87	55.66	2,422.03	277.29	282.60	-276.40	2.27	1.41	6.37
2,559.00	18.12	57.47	2,512.64	293.01	306.44	-292.05	1.43	1.32	1.91
2,653.00	20.40	58.47	2,601.37	309.44	332.73	-308.40	2.45	2.43	1.06
2,747.00	20.94	51.98	2,689.33	328.36	359.93	-327.23	2.50	0.57	-6.90
2,842.00	20.71	50.79	2,778.13	349.43	386.32	-348.22	0.51	-0.24	-1.25
2,936.00	21.93	47.01	2,865.70	371.91	412.04	-370.62	1.95	1.30	-4.02
3,031.00	21.00	46.74	2,954.11	395.68	437.41	-394.30	0.98	-0.98	-0.28
3,126.00	20.17	45.73	3,043.04	418.77	461.54	-417.32	0.95	-0.87	-1.06
3,220.00	19.21	50.05	3,131.55	440.02	485.00	-438.49	1.85	-1.02	4.60
3,314.00	18.11	47.12	3,220.61	459.89	507.56	-458.29	1.54	-1.17	-3.12
3,409.00	19.41	49.23	3,310.56	480.25	530.34	-478.58	1.54	1.37	2.22
3,504.00	17.67	47.47	3,400.63	500.30	552.92	-498.56	1.92	-1.83	-1.85
3,598.00	17.31	52.90	3,490.29	518.38	574.59	-516.58	1.78	-0.38	5.78
3,693.00	18.00	50.16	3,580.81	536.31	597.13	-534.43	1.14	0.73	-2.88
3,787.00	15.99	47.18	3,670.71	554.42	617.78	-552.48	2.33	-2.14	-3.17
3,882.00	16.84	47.62	3,761.83	572.59	637.54	-570.58	0.90	0.89	0.46
3,976.00	17.51	50.26	3,851.64	590.81	658.48	-588.74	1.09	0.71	2.81
4,071.00	16.30	48.53	3,942.54	608.77	679.46	-606.64	1.38	-1.27	-1.82
4,165.00	19.26	46.90	4,032.04	628.11	700.67	-625.90	3.19	3.15	-1.73
4,260.00	18.65	45.75	4,121.88	649.41	722.99	-647.14	0.75	-0.64	-1.21
4,354.00	17.87	50.84	4,211.16	669.01	744.94	-666.67	1.89	-0.83	5.41
4,449.00	16.82	49.10	4,301.84	687.21	766.63	-684.80	1.23	-1.11	-1.83
4,544.00	17.45	53.41	4,392.62	704.70	788.46	-702.22	1.49	0.66	4.54
4,638.00	16.01	51.59	4,482.64	721.16	809.93	-718.61	1.63	-1.53	-1.94
4,733.00	15.27	50.11	4,574.12	737.32	829.80	-734.71	0.88	-0.78	-1.56
4,827.00	17.87	50.90	4,664.21	754.36	850.49	-751.68	2.78	2.77	0.84
4,922.00	17.42	49.77	4,754.74	772.74	872.66	-769.99	0.60	-0.47	-1.19
5,016.00	17.89	49.11	4,844.32	791.28	894.31	-788.46	0.54	0.50	-0.70

PDD Survey Report

Company:	US ROCKIES WATTENBERG PLANNING	Local Co-ordinate Reference:	Well POWERS 26N-27HZ
Project:	WELD-NAD83-UTMFT13N	TVD Reference:	4894'+25' @ 4919.00usft (H&P307)
Site:	2N-65W-22 Powers 2-22 Pad	MD Reference:	4894'+25' @ 4919.00usft (H&P307)
Well:	POWERS 26N-27HZ	North Reference:	True
Wellbore:	POWERS 26N-27HZ	Survey Calculation Method:	Minimum Curvature
Design:	PDD Actual Surveys	Database:	EDM 5000.1 Single User Db

Survey										
Measured Depth (usft)	Inclination (°)	Azimuth (°)	Vertical Depth (usft)	+N/-S (usft)	+E/-W (usft)	Vertical Section (usft)	Dogleg Rate (°/100usft)	Build Rate (°/100usft)	Turn Rate (°/100usft)	
5,111.00	15.91	43.67	4,935.21	810.25	914.34	-807.37	2.67	-2.08	-5.73	
5,205.00	16.43	52.31	5,025.51	827.70	933.76	-824.76	2.62	0.55	9.19	
5,300.00	14.65	49.18	5,117.03	843.77	953.48	-840.77	2.07	-1.87	-3.29	
5,394.00	13.43	47.05	5,208.22	858.98	970.47	-855.92	1.41	-1.30	-2.27	
5,489.00	10.91	52.36	5,301.08	871.99	985.67	-868.89	2.90	-2.65	5.59	
5,584.00	9.49	62.74	5,394.59	881.06	999.75	-877.92	2.44	-1.49	10.93	
5,678.00	6.13	56.46	5,487.71	887.39	1,010.83	-884.21	3.68	-3.57	-6.68	
5,773.00	3.40	48.61	5,582.37	892.05	1,017.17	-888.86	2.95	-2.87	-8.26	
5,867.00	1.65	21.75	5,676.28	895.16	1,019.76	-891.95	2.20	-1.86	-28.57	
6,056.00	0.69	214.01	5,865.26	896.74	1,020.13	-893.53	1.23	-0.51	-88.75	
6,245.00	0.33	262.42	6,054.25	895.72	1,018.96	-892.52	0.28	-0.19	25.61	
6,340.00	0.82	285.40	6,149.24	895.87	1,018.03	-892.67	0.56	0.52	24.19	
6,434.00	0.67	297.67	6,243.24	896.30	1,016.89	-893.10	0.23	-0.16	13.05	
6,529.00	7.78	189.34	6,337.95	890.21	1,015.36	-887.01	8.44	7.48	-114.03	
6,623.00	13.62	187.73	6,430.28	872.95	1,012.83	-869.76	6.22	6.21	-1.71	
6,718.00	22.31	186.96	6,520.56	843.91	1,009.14	-840.73	9.15	9.15	-0.81	
6,812.00	27.51	180.31	6,605.80	804.45	1,006.85	-801.29	6.28	5.53	-7.07	
6,907.00	38.62	178.80	6,685.29	752.71	1,007.36	-749.54	11.73	11.69	-1.59	
7,001.00	43.45	178.60	6,756.18	691.03	1,008.76	-687.86	5.14	5.14	-0.21	
7,096.00	52.18	178.88	6,819.91	620.72	1,010.30	-617.55	9.19	9.19	0.29	
7,190.00	61.26	178.68	6,871.44	542.24	1,011.98	-539.06	9.66	9.66	-0.21	
7,285.00	67.75	176.72	6,912.31	456.61	1,015.46	-453.42	7.08	6.83	-2.06	
7,379.00	73.53	175.85	6,943.46	368.15	1,021.21	-364.94	6.21	6.15	-0.93	
7,473.00	82.36	178.37	6,963.07	276.44	1,025.81	-273.22	9.75	9.39	2.68	
7,568.00	86.34	182.22	6,972.43	181.94	1,025.31	-178.72	5.81	4.19	4.05	
7,662.00	89.65	181.45	6,975.72	88.06	1,022.30	-84.85	3.62	3.52	-0.82	
7,757.00	89.65	181.48	6,976.30	-6.91	1,019.87	10.11	0.03	0.00	0.03	
7,852.00	90.45	181.70	6,976.21	-101.87	1,017.24	105.07	0.87	0.84	0.23	
7,946.00	88.80	180.16	6,976.83	-195.85	1,015.71	199.04	2.40	-1.76	-1.64	
8,041.00	89.22	179.58	6,978.47	-290.84	1,015.93	294.03	0.75	0.44	-0.61	
8,135.00	90.18	179.85	6,978.96	-384.83	1,016.40	388.02	1.06	1.02	0.29	
8,230.00	90.65	178.85	6,978.27	-479.82	1,017.47	483.02	1.16	0.49	-1.05	
8,324.00	91.43	178.35	6,976.57	-573.78	1,019.77	576.98	0.99	0.83	-0.53	
8,418.00	90.76	180.40	6,974.77	-667.75	1,020.79	670.95	2.29	-0.71	2.18	
8,513.00	88.77	181.62	6,975.16	-762.73	1,019.12	765.92	2.46	-2.09	1.28	
8,607.00	89.01	181.58	6,976.98	-856.67	1,016.50	859.86	0.26	0.26	-0.04	
8,702.00	89.03	181.40	6,978.61	-951.63	1,014.03	954.81	0.19	0.02	-0.19	
8,796.00	87.10	180.05	6,981.78	-1,045.56	1,012.84	1,048.74	2.51	-2.05	-1.44	
8,891.00	86.29	180.13	6,987.26	-1,140.40	1,012.69	1,143.58	0.86	-0.85	0.08	
8,985.00	88.15	178.69	6,991.82	-1,234.28	1,013.66	1,237.46	2.50	1.98	-1.53	
9,080.00	89.86	178.14	6,993.47	-1,329.22	1,016.28	1,332.41	1.89	1.80	-0.58	
9,174.00	89.83	178.35	6,993.72	-1,423.18	1,019.16	1,426.37	0.23	-0.03	0.22	
9,269.00	90.65	177.93	6,993.32	-1,518.13	1,022.25	1,521.33	0.97	0.86	-0.44	

PDD Survey Report

Company:	US ROCKIES WATTENBERG PLANNING	Local Co-ordinate Reference:	Well POWERS 26N-27HZ
Project:	WELD-NAD83-UTMFT13N	TVD Reference:	4894'+25' @ 4919.00usft (H&P307)
Site:	2N-65W-22 Powers 2-22 Pad	MD Reference:	4894'+25' @ 4919.00usft (H&P307)
Well:	POWERS 26N-27HZ	North Reference:	True
Wellbore:	POWERS 26N-27HZ	Survey Calculation Method:	Minimum Curvature
Design:	PDD Actual Surveys	Database:	EDM 5000.1 Single User Db

Survey									
Measured Depth (usft)	Inclination (°)	Azimuth (°)	Vertical Depth (usft)	+N/-S (usft)	+E/-W (usft)	Vertical Section (usft)	Dogleg Rate (°/100usft)	Build Rate (°/100usft)	Turn Rate (°/100usft)
9,363.00	90.46	178.07	6,992.41	-1,612.06	1,025.53	1,615.28	0.25	-0.20	0.15
9,458.00	90.01	177.73	6,992.02	-1,707.00	1,029.01	1,710.22	0.59	-0.47	-0.36
9,552.00	90.26	177.20	6,991.80	-1,800.91	1,033.16	1,804.14	0.62	0.27	-0.56
9,647.00	90.23	179.00	6,991.40	-1,895.85	1,036.31	1,899.10	1.89	-0.03	1.89
9,741.00	91.26	180.78	6,990.17	-1,989.84	1,036.49	1,993.08	2.19	1.10	1.89
9,836.00	89.18	179.85	6,989.81	-2,084.83	1,035.97	2,088.07	2.40	-2.19	-0.98
9,930.00	89.97	179.81	6,990.51	-2,178.82	1,036.25	2,182.07	0.84	0.84	-0.04
10,024.00	90.32	178.96	6,990.27	-2,272.82	1,037.26	2,276.07	0.98	0.37	-0.90
10,119.00	87.64	178.89	6,991.96	-2,367.78	1,039.04	2,371.03	2.82	-2.82	-0.07
10,213.00	87.50	179.05	6,995.94	-2,461.68	1,040.73	2,464.94	0.23	-0.15	0.17
10,308.00	86.88	179.21	7,000.60	-2,556.55	1,042.17	2,559.81	0.67	-0.65	0.17
10,402.00	88.41	180.12	7,004.46	-2,650.47	1,042.72	2,653.73	1.89	1.63	0.97
10,497.00	88.87	179.22	7,006.72	-2,745.44	1,043.27	2,748.70	1.06	0.48	-0.95
10,591.00	88.65	179.57	7,008.75	-2,839.41	1,044.26	2,842.68	0.44	-0.23	0.37
10,686.00	89.07	178.84	7,010.64	-2,934.38	1,045.58	2,937.65	0.89	0.44	-0.77
10,780.00	88.81	179.10	7,012.38	-3,028.35	1,047.27	3,031.63	0.39	-0.28	0.28
10,875.00	88.84	179.17	7,014.33	-3,123.32	1,048.70	3,126.60	0.08	0.03	0.07
10,969.00	88.35	178.92	7,016.63	-3,217.28	1,050.27	3,220.56	0.59	-0.52	-0.27
11,064.00	88.78	179.10	7,019.01	-3,312.23	1,051.91	3,315.52	0.49	0.45	0.19
11,158.00	90.42	181.40	7,019.67	-3,406.22	1,051.50	3,409.51	3.01	1.74	2.45
11,253.00	90.19	180.28	7,019.16	-3,501.21	1,050.10	3,504.49	1.20	-0.24	-1.18
11,348.00	90.09	179.89	7,018.93	-3,596.21	1,049.96	3,599.49	0.42	-0.11	-0.41
11,442.00	90.36	179.29	7,018.56	-3,690.20	1,050.64	3,693.49	0.70	0.29	-0.64
11,537.00	89.81	178.15	7,018.42	-3,785.18	1,052.76	3,788.47	1.33	-0.58	-1.20
11,631.00	90.31	179.53	7,018.32	-3,879.16	1,054.66	3,882.45	1.56	0.53	1.47
11,725.00	90.47	179.13	7,017.68	-3,973.15	1,055.76	3,976.44	0.46	0.17	-0.43
11,820.00	90.39	178.15	7,016.97	-4,068.12	1,058.01	4,071.42	1.03	-0.08	-1.03
11,915.00	92.03	180.13	7,014.96	-4,163.08	1,059.44	4,166.38	2.71	1.73	2.08
12,009.00	90.27	182.71	7,013.08	-4,257.02	1,057.11	4,260.32	3.32	-1.87	2.74
12,104.00	90.49	182.32	7,012.45	-4,351.92	1,052.94	4,355.21	0.47	0.23	-0.41
12,198.00	90.39	180.82	7,011.73	-4,445.88	1,050.37	4,449.16	1.60	-0.11	-1.60
12,293.00	90.98	180.58	7,010.59	-4,540.87	1,049.21	4,544.14	0.67	0.62	-0.25
12,387.00	91.43	180.41	7,008.61	-4,634.84	1,048.40	4,638.11	0.51	0.48	-0.18
12,482.00	91.64	180.06	7,006.07	-4,729.81	1,048.01	4,733.08	0.43	0.22	-0.37
12,576.00	90.18	180.75	7,004.58	-4,823.79	1,047.34	4,827.06	1.72	-1.55	0.73
12,671.00	90.76	180.30	7,003.80	-4,918.78	1,046.47	4,922.05	0.77	0.61	-0.47
12,765.00	91.79	179.72	7,001.70	-5,012.76	1,046.45	5,016.02	1.26	1.10	-0.62
12,860.00	91.36	177.66	6,999.09	-5,107.69	1,048.63	5,110.96	2.21	-0.45	-2.17
12,954.00	90.19	178.19	6,997.82	-5,201.62	1,052.03	5,204.90	1.37	-1.24	0.56
13,017.00	90.58	178.27	6,997.40	-5,264.59	1,053.97	5,267.87	0.63	0.62	0.13
13,081.00	90.58	178.27	6,996.75	-5,328.56	1,055.91	5,331.85	0.00	0.00	0.00

PDD Survey Report

Company:	US ROCKIES WATTENBERG PLANNING	Local Co-ordinate Reference:	Well POWERS 26N-27HZ
Project:	WELD-NAD83-UTMFT13N	TVD Reference:	4894'+25' @ 4919.00usft (H&P307)
Site:	2N-65W-22 Powers 2-22 Pad	MD Reference:	4894'+25' @ 4919.00usft (H&P307)
Well:	POWERS 26N-27HZ	North Reference:	True
Wellbore:	POWERS 26N-27HZ	Survey Calculation Method:	Minimum Curvature
Design:	PDD Actual Surveys	Database:	EDM 5000.1 Single User Db

Design Targets									
Target Name - hit/miss target - Shape	Dip Angle (°)	Dip Dir. (°)	TVD (usft)	+N/-S (usft)	+E/-W (usft)	Northing (usft)	Easting (usft)	Latitude	Longitude
Powers 26N-27HZ Enter - actual wellpath hits target center - Point	0.00	0.00	4,117.15	648.30	721.84	14,575,114.72	1,740,402.28	40.132310	-104.642283
Powers 26N-27HZ Niobr - actual wellpath misses target center by 0.02usft at 7401.98usft MD (6949.56 TVD, 346.05 N, 1022.69 E) - Point	0.00	0.00	6,949.56	346.03	1,022.69	14,574,813.65	1,740,704.34	40.131480	-104.641206
Powers 26N-27HZ Actua - actual wellpath misses target center by 0.01usft at 7536.01usft MD (6970.01 TVD, 213.83 N, 1026.19 E) - Point	0.00	0.00	6,970.01	213.83	1,026.19	14,574,681.47	1,740,708.36	40.131117	-104.641194
Powers 26N-27HZ Actua - actual wellpath hits target center - Point	0.00	0.00	6,996.75	-5,328.56	1,055.91	14,569,139.25	1,740,760.22	40.115897	-104.641088

Casing Points					
Measured Depth (usft)	Vertical Depth (usft)	Name	Casing Diameter (")	Hole Diameter (")	
1,897.00	1,872.34	9 5/8	9-5/8	13-1/2	
13,070.00	6,996.86	5 1/2"	5-1/2	8-1/2	

Formations					
Measured Depth (usft)	Vertical Depth (usft)	Name	Lithology	Dip (°)	Dip Direction (°)
4,252.00	4,114.31	Entered Landbox		0.00	
7,120.00	6,834.24	Sharon Springs		0.00	
7,235.00	6,892.01	Niobrara		0.00	
7,402.00	6,949.56	Niobrara B		0.00	
7,536.00	6,970.01	Landing Depth		0.00	
13,081.00	6,996.75	Toe Depth		0.00	

Design Annotations					
Measured Depth (usft)	Vertical Depth (usft)	Local Coordinates		Comment	
		+N/-S (usft)	+E/-W (usft)		
13,081.00	6,996.75	-5,328.56	1,055.91	Projection to Bit	

Checked By: _____ Approved By: _____ Date: _____