

TEKTON WINDSOR, LLC			
Location	Windsor, CO, USA(Imported)	Slot	Slot #1
Field	Windsor Project	Well	Pavistma South 1 #1-5-32-090-4-NH
Installation	Pavistma South	Wellbore	Pavistma South 1 #1-5-32-090-4-NH (PWB)

Slot	Slot #1
------	---------

**Well** Pavistma South 1 #1-5-32-090-4-NH

**Wellbore Pavistma South 1 #1-5-32-090-4-NH (PWB)**

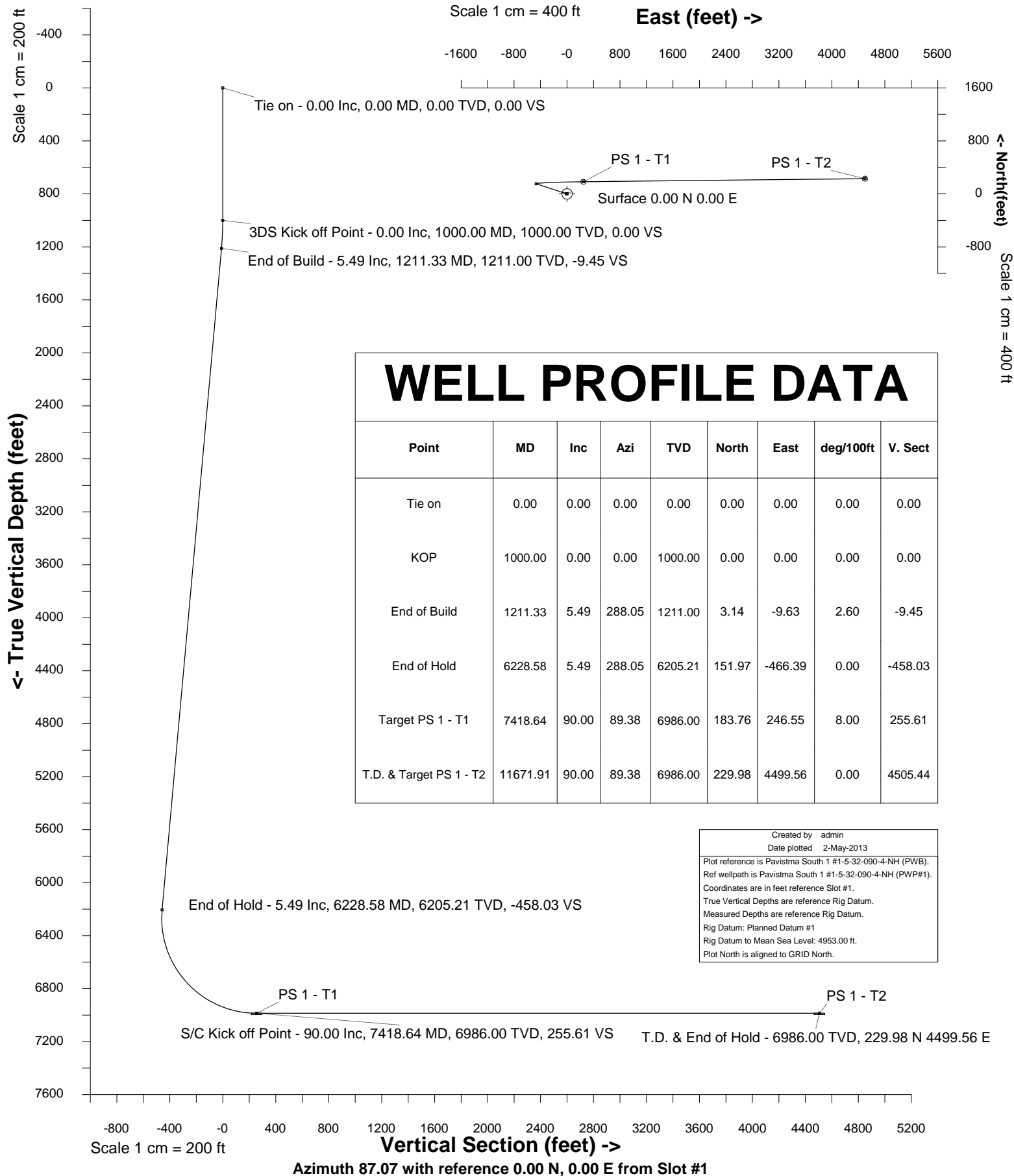

INTEGRATED PETROLEUM TECHNOLOGIES, INC  
SYSDRILL  
Well Design Combined Report  
Wellbore: Pavistma South 1 #1-5-32-090-4-NH (PWB)  
Wellpath: Pavistma South 1 #1-5-32-090-4-NH (PWP#1)

Wellhead Details							
Name	Northing	Easting	Latitude	Longitude	North	East	Slot Elevation Above Installation
Slot #1	1403844.6909	3160105.0426	N40 26 25.9080	W104 55 29.2440	0.00N	0.00E	-0.00

Declination		
Date	Source	Time
8-Mar-2013	IGRF Model [1900.0-2015.0]	16:01

Site Details				
Name	Northing	Easting	Coord System Name	North Alignment
Pavistma South	1403844.6909	3160105.0426	CO83-NF on NORTH AMERICAN DATUM 1983 datum	Grid

Summary Wellpath									
MD[ft]	Inc[deg]	Azi[deg]	TVD[ft]	North[ft]	East[ft]	Dogleg [deg/100ft]	Vertical Section[ft]	Northing	Easting
0.00	0.00	0.000	0.00	0.00N	0.00E		0.00	1403844.69	3160105.04
1000.00	0.00	0.000	1000.00	0.00N	0.00E	==>	0.00	1403844.69	3160105.04
1211.33	5.49	288.050	1211.00	3.14N	9.63W	2.60	-9.45	1403847.83	3160095.42
6228.58	5.49	288.050	6205.21	151.97N	466.39W	==>	-458.03	1403996.66	3159638.67
7418.64	90.00	89.380	6986.00	183.76N	246.55E	8.00	255.61	1404028.45	3160351.58
11671.91	90.00	89.380	6986.00	229.98N	4499.56E	==>	4505.44	1404074.66	3164604.43

Interpolated Wellpath									
MD[ft]	Inc[deg]	Azi[deg]	TVD[ft]	North[ft]	East[ft]	Dogleg [deg/100ft]	Vertical Section[ft]	Northing	Easting
0.00	0.00	0.000	0.00	0.00N	0.00E		0.00	1403844.69	3160105.04
100.00	0.00	0.000	100.00	0.00N	0.00E	==>	0.00	1403844.69	3160105.04
200.00	0.00	0.000	200.00	0.00N	0.00E	==>	0.00	1403844.69	3160105.04
300.00	0.00	0.000	300.00	0.00N	0.00E	==>	0.00	1403844.69	3160105.04
400.00	0.00	0.000	400.00	0.00N	0.00E	==>	0.00	1403844.69	3160105.04
500.00	0.00	0.000	500.00	0.00N	0.00E	==>	0.00	1403844.69	3160105.04
600.00	0.00	0.000	600.00	0.00N	0.00E	==>	0.00	1403844.69	3160105.04
700.00	0.00	0.000	700.00	0.00N	0.00E	==>	0.00	1403844.69	3160105.04
800.00	0.00	0.000	800.00	0.00N	0.00E	==>	0.00	1403844.69	3160105.04
900.00	0.00	0.000	900.00	0.00N	0.00E	==>	0.00	1403844.69	3160105.04
1000.00	0.00	0.000	1000.00	0.00N	0.00E	==>	0.00	1403844.69	3160105.04
1100.00	2.60	288.050	1099.97	0.70N	2.16W	2.60	-2.12	1403845.39	3160102.89
1200.00	5.20	288.050	1199.73	2.81N	8.62W	2.60	-8.47	1403847.50	3160096.42
1211.33	5.49	288.050	1211.00	3.14N	9.63W	2.60	-9.45	1403847.83	3160095.42
1300.00	5.49	288.050	1299.27	5.77N	17.70W	==>	-17.38	1403850.46	3160087.34
1400.00	5.49	288.050	1398.81	8.73N	26.80W	==>	-26.32	1403853.42	3160078.24
1500.00	5.49	288.050	1498.35	11.70N	35.91W	==>	-35.26	1403856.39	3160069.14
1600.00	5.49	288.050	1597.89	14.67N	45.01W	==>	-44.20	1403859.36	3160060.03
1700.00	5.49	288.050	1697.43	17.63N	54.12W	==>	-53.14	1403862.32	3160050.93
1800.00	5.49	288.050	1796.97	20.60N	63.22W	==>	-62.09	1403865.29	3160041.83
1900.00	5.49	288.050	1896.51	23.57N	72.32W	==>	-71.03	1403868.26	3160032.72
2000.00	5.49	288.050	1996.05	26.53N	81.43W	==>	-79.97	1403871.22	3160023.62
2100.00	5.49	288.050	2095.59	29.50N	90.53W	==>	-88.91	1403874.19	3160014.52
2200.00	5.49	288.050	2195.13	32.47N	99.63W	==>	-97.85	1403877.15	3160005.41
2300.00	5.49	288.050	2294.67	35.43N	108.74W	==>	-106.79	1403880.12	3159996.31
2400.00	5.49	288.050	2394.21	38.40N	117.84W	==>	-115.73	1403883.09	3159987.20
2500.00	5.49	288.050	2493.76	41.36N	126.95W	==>	-124.67	1403886.05	3159978.10
2600.00	5.49	288.050	2593.30	44.33N	136.05W	==>	-133.61	1403889.02	3159969.00
2700.00	5.49	288.050	2692.84	47.30N	145.15W	==>	-142.55	1403891.99	3159959.89
2800.00	5.49	288.050	2792.38	50.26N	154.26W	==>	-151.49	1403894.95	3159950.79
2900.00	5.49	288.050	2891.92	53.23N	163.36W	==>	-160.43	1403897.92	3159941.69
3000.00	5.49	288.050	2991.46	56.20N	172.47W	==>	-169.37	1403900.89	3159932.58
3100.00	5.49	288.050	3091.00	59.16N	181.57W	==>	-178.31	1403903.85	3159923.48
3200.00	5.49	288.050	3190.54	62.13N	190.67W	==>	-187.25	1403906.82	3159914.38
3300.00	5.49	288.050	3290.08	65.10N	199.78W	==>	-196.19	1403909.78	3159905.27

All data is in Feet unless otherwise stated  
Coordinates are from Slot MD's are from Rig and TVD's are from Rig ( Planned Datum #1 4953.0ft above Mean Sea Level )  
Vertical Section is from 0.00N 0.00E on azimuth 87.070 degrees  
Bottom hole distance is 4505.44 Feet on azimuth 87.07 degrees from Wellhead  
Calculation method uses Minimum Curvature method  
Prepared by Peterson Energy  
Date Printed: 2-May-2013



INTEGRATED PETROLEUM TECHNOLOGIES, INC  
SYSDRILL  
Well Design Combined Report  
Wellbore: Pavistma South 1 #1-5-32-090-4-NH (PWB)  
Wellpath: Pavistma South 1 #1-5-32-090-4-NH (PWP#1)

Interpolated Wellpath									
MD[ft]	Inc[deg]	Azi[deg]	TVD[ft]	North[ft]	East[ft]	Dogleg [deg/100ft]	Vertical Section[ft]	Northing	Easting
3400.00	5.49	288.050	3389.62	68.06N	208.88W	==>	-205.14	1403912.75	3159896.17
3500.00	5.49	288.050	3489.16	71.03N	217.99W	==>	-214.08	1403915.72	3159887.07
3600.00	5.49	288.050	3588.70	74.00N	227.09W	==>	-223.02	1403918.68	3159877.96
3700.00	5.49	288.050	3688.24	76.96N	236.19W	==>	-231.96	1403921.65	3159868.86
3800.00	5.49	288.050	3787.78	79.93N	245.30W	==>	-240.90	1403924.62	3159859.75
3900.00	5.49	288.050	3887.32	82.89N	254.40W	==>	-249.84	1403927.58	3159850.65
4000.00	5.49	288.050	3986.86	85.86N	263.51W	==>	-258.78	1403930.55	3159841.55
4100.00	5.49	288.050	4086.40	88.83N	272.61W	==>	-267.72	1403933.51	3159832.44
4200.00	5.49	288.050	4185.94	91.79N	281.71W	==>	-276.66	1403936.48	3159823.34
4300.00	5.49	288.050	4285.48	94.76N	290.82W	==>	-285.60	1403939.45	3159814.24
4400.00	5.49	288.050	4385.03	97.73N	299.92W	==>	-294.54	1403942.41	3159805.13
4500.00	5.49	288.050	4484.57	100.69N	309.03W	==>	-303.48	1403945.38	3159796.03
4600.00	5.49	288.050	4584.11	103.66N	318.13W	==>	-312.42	1403948.35	3159786.93
4700.00	5.49	288.050	4683.65	106.63N	327.23W	==>	-321.36	1403951.31	3159777.82
4800.00	5.49	288.050	4783.19	109.59N	336.34W	==>	-330.30	1403954.28	3159768.72
4900.00	5.49	288.050	4882.73	112.56N	345.44W	==>	-339.25	1403957.25	3159759.62
5000.00	5.49	288.050	4982.27	115.53N	354.54W	==>	-348.19	1403960.21	3159750.51
5100.00	5.49	288.050	5081.81	118.49N	363.65W	==>	-357.13	1403963.18	3159741.41
5200.00	5.49	288.050	5181.35	121.46N	372.75W	==>	-366.07	1403966.14	3159732.30
5300.00	5.49	288.050	5280.89	124.42N	381.86W	==>	-375.01	1403969.11	3159723.20
5400.00	5.49	288.050	5380.43	127.39N	390.96W	==>	-383.95	1403972.08	3159714.10
5500.00	5.49	288.050	5479.97	130.36N	400.06W	==>	-392.89	1403975.04	3159704.99
5600.00	5.49	288.050	5579.51	133.32N	409.17W	==>	-401.83	1403978.01	3159695.89
5700.00	5.49	288.050	5679.05	136.29N	418.27W	==>	-410.77	1403980.98	3159686.79
5800.00	5.49	288.050	5778.59	139.26N	427.38W	==>	-419.71	1403983.94	3159677.68
5900.00	5.49	288.050	5878.13	142.22N	436.48W	==>	-428.65	1403986.91	3159668.58
6000.00	5.49	288.050	5977.67	145.19N	445.58W	==>	-437.59	1403989.87	3159659.48
6100.00	5.49	288.050	6077.21	148.16N	454.69W	==>	-446.53	1403992.84	3159650.37
6200.00	5.49	288.050	6176.76	151.12N	463.79W	==>	-455.47	1403995.81	3159641.27
6228.58	5.49	288.050	6205.21	151.97N	466.39W	==>	-458.03	1403996.66	3159638.67
6300.00	1.84	15.480	6276.50	154.13N	469.34W	8.00	-460.86	1403998.82	3159635.72
6400.00	8.69	77.750	6376.06	157.28N	461.52W	8.00	-452.89	1404001.97	3159643.54
6500.00	16.60	83.450	6473.56	160.52N	439.91W	8.00	-431.15	1404005.21	3159665.15
6600.00	24.57	85.520	6567.11	163.78N	404.94W	8.00	-396.05	1404008.47	3159700.12
6700.00	32.55	86.610	6654.87	167.00N	357.28W	8.00	-348.29	1404011.69	3159747.78
6800.00	40.54	87.310	6735.14	170.12N	297.86W	8.00	-288.79	1404014.80	3159807.19
6900.00	48.53	87.820	6806.36	173.07N	227.85W	8.00	-218.72	1404017.76	3159877.20
7000.00	56.53	88.210	6867.15	175.81N	148.59W	8.00	-139.42	1404020.49	3159956.46
7100.00	64.52	88.540	6916.31	178.27N	61.64W	8.00	-52.46	1404022.95	3160043.40
7200.00	72.52	88.820	6952.90	180.40N	31.31E	8.00	40.48	1404025.09	3160136.35
7300.00	80.51	89.080	6976.20	182.18N	128.46E	8.00	137.59	1404026.86	3160233.50
7400.00	88.51	89.330	6985.76	183.55N	227.91E	8.00	236.98	1404028.24	3160332.95
7418.64	90.00	89.380	6986.00	183.76N	246.55E	8.00	255.61	1404028.45	3160351.58
7500.00	90.00	89.380	6986.00	184.65N	327.90E	==>	336.90	1404029.33	3160432.93
7600.00	90.00	89.380	6986.00	185.73N	427.90E	==>	436.82	1404030.42	3160532.92
7700.00	90.00	89.380	6986.00	186.82N	527.89E	==>	536.74	1404031.50	3160632.91
7800.00	90.00	89.380	6986.00	187.91N	627.89E	==>	636.66	1404032.59	3160732.90
7900.00	90.00	89.380	6986.00	188.99N	727.88E	==>	736.58	1404033.68	3160832.89
8000.00	90.00	89.380	6986.00	190.08N	827.87E	==>	836.50	1404034.76	3160932.88
8100.00	90.00	89.380	6986.00	191.17N	927.87E	==>	936.42	1404035.85	3161032.87
8200.00	90.00	89.380	6986.00	192.25N	1027.86E	==>	1036.34	1404036.93	3161132.86
8300.00	90.00	89.380	6986.00	193.34N	1127.86E	==>	1136.26	1404038.02	3161232.85
8400.00	90.00	89.380	6986.00	194.42N	1227.85E	==>	1236.17	1404039.11	3161332.84
8500.00	90.00	89.380	6986.00	195.51N	1327.84E	==>	1336.09	1404040.19	3161432.83
8600.00	90.00	89.380	6986.00	196.60N	1427.84E	==>	1436.01	1404041.28	3161532.83
8700.00	90.00	89.380	6986.00	197.68N	1527.83E	==>	1535.93	1404042.37	3161632.82
8800.00	90.00	89.380	6986.00	198.77N	1627.83E	==>	1635.85	1404043.45	3161732.81
8900.00	90.00	89.380	6986.00	199.86N	1727.82E	==>	1735.77	1404044.54	3161832.80
9000.00	90.00	89.380	6986.00	200.94N	1827.82E	==>	1835.69	1404045.63	3161932.79
9100.00	90.00	89.380	6986.00	202.03N	1927.81E	==>	1935.61	1404046.71	3162032.78
9200.00	90.00	89.380	6986.00	203.12N	2027.80E	==>	2035.53	1404047.80	3162132.77

All data is in Feet unless otherwise stated  
Coordinates are from Slot MD's are from Rig and TVD's are from Rig ( Planned Datum #1 4953.0ft above Mean Sea Level )  
Vertical Section is from 0.00N 0.00E on azimuth 87.070 degrees  
Bottom hole distance is 4505.44 Feet on azimuth 87.07 degrees from Wellhead  
Calculation method uses Minimum Curvature method  
Prepared by Peterson Energy  
Date Printed: 2-May-2013



INTEGRATED PETROLEUM TECHNOLOGIES, INC  
 SYSDRILL  
 Well Design Combined Report  
 Wellbore: Pavistma South 1 #1-5-32-090-4-NH (PWB)  
 Wellpath: Pavistma South 1 #1-5-32-090-4-NH (PWP#1)

Interpolated Wellpath									
MD[ft]	Inc[deg]	Azi[deg]	TVD[ft]	North[ft]	East[ft]	Dogleg [deg/100ft]	Vertical Section[ft]	Northing	Easting
9300.00	90.00	89.380	6986.00	204.20N	2127.80E	==>	2135.45	1404048.89	3162232.76
9400.00	90.00	89.380	6986.00	205.29N	2227.79E	==>	2235.37	1404049.97	3162332.75
9500.00	90.00	89.380	6986.00	206.38N	2327.79E	==>	2335.29	1404051.06	3162432.74
9600.00	90.00	89.380	6986.00	207.46N	2427.78E	==>	2435.20	1404052.15	3162532.73
9700.00	90.00	89.380	6986.00	208.55N	2527.77E	==>	2535.12	1404053.23	3162632.72
9800.00	90.00	89.380	6986.00	209.64N	2627.77E	==>	2635.04	1404054.32	3162732.71
9900.00	90.00	89.380	6986.00	210.72N	2727.76E	==>	2734.96	1404055.41	3162832.70
10000.00	90.00	89.380	6986.00	211.81N	2827.76E	==>	2834.88	1404056.49	3162932.69
10100.00	90.00	89.380	6986.00	212.90N	2927.75E	==>	2934.80	1404057.58	3163032.68
10200.00	90.00	89.380	6986.00	213.98N	3027.74E	==>	3034.72	1404058.66	3163132.67
10300.00	90.00	89.380	6986.00	215.07N	3127.74E	==>	3134.64	1404059.75	3163232.66
10400.00	90.00	89.380	6986.00	216.16N	3227.73E	==>	3234.56	1404060.84	3163332.65
10500.00	90.00	89.380	6986.00	217.24N	3327.73E	==>	3334.48	1404061.92	3163432.64
10600.00	90.00	89.380	6986.00	218.33N	3427.72E	==>	3434.40	1404063.01	3163532.63
10700.00	90.00	89.380	6986.00	219.42N	3527.72E	==>	3534.32	1404064.10	3163632.62
10800.00	90.00	89.380	6986.00	220.50N	3627.71E	==>	3634.24	1404065.18	3163732.61
10900.00	90.00	89.380	6986.00	221.59N	3727.70E	==>	3734.15	1404066.27	3163832.60
11000.00	90.00	89.380	6986.00	222.67N	3827.70E	==>	3834.07	1404067.36	3163932.59
11100.00	90.00	89.380	6986.00	223.76N	3927.69E	==>	3933.99	1404068.44	3164032.58
11200.00	90.00	89.380	6986.00	224.85N	4027.69E	==>	4033.91	1404069.53	3164132.57
11300.00	90.00	89.380	6986.00	225.93N	4127.68E	==>	4133.83	1404070.62	3164232.56
11400.00	90.00	89.380	6986.00	227.02N	4227.67E	==>	4233.75	1404071.70	3164332.55
11500.00	90.00	89.380	6986.00	228.11N	4327.67E	==>	4333.67	1404072.79	3164432.54
11600.00	90.00	89.380	6986.00	229.19N	4427.66E	==>	4433.59	1404073.88	3164532.53
11671.91	90.00	89.380	6986.00	229.98N	4499.56E	==>	4505.44	1404074.66	3164604.43

All data is in Feet unless otherwise stated  
 Coordinates are from Slot MD's are from Rig and TVD's are from Rig ( Planned Datum #1 4953.0ft above Mean Sea Level )  
 Vertical Section is from 0.00N 0.00E on azimuth 87.070 degrees  
 Bottom hole distance is 4505.44 Feet on azimuth 87.07 degrees from Wellhead  
 Calculation method uses Minimum Curvature method  
 Prepared by Peterson Energy  
 Date Printed: 2-May-2013



INTEGRATED PETROLEUM TECHNOLOGIES, INC  
 SYSDRILL  
 Well Design Combined Report  
 Wellbore: Pavistma South 1 #1-5-32-090-4-NH (PWB)  
 Wellpath: Pavistma South 1 #1-5-32-090-4-NH (PWP#1)

Hole Sections								
Diameter	Start	Start	Start	Start	End	End	End	End
[in]	MD[ft]	TVD[ft]	North[ft]	East[ft]	MD[ft]	TVD[ft]	North[ft]	East[ft]
12 1/4	0.00	0.00	0.00N	0.00E	850.00	850.00	0.00N	0.00E
8 3/4	850.00	850.00	0.00N	0.00E	7419.00	6986.00	183.77N	246.91E
6 1/8	7419.00	6986.00	183.77N	246.91E	11671.91	6986.00	229.98N	4499.56E

Casings								
Name	Top	Top	Top	Top	Shoe	Shoe	Shoe	Shoe
	MD[ft]	TVD[ft]	North[ft]	East[ft]	MD[ft]	TVD[ft]	North[ft]	East[ft]
9 5/8in Surface Casing	0.00	0.00	0.00N	0.00E	850.00	850.00	0.00N	0.00E
7.0in Intermediate Casing	0.00	0.00	0.00N	0.00E	7419.00	6986.00	183.77N	246.91E
4 1/2in Production Liner	6300.00	6276.50	154.13N	469.34W	11671.91	6986.00	229.98N	4499.56E

Targets								
Name	North[ft]	East[ft]	TVD[ft]	Latitude	Longitude	Northing	Easting	Last Revised
PS 1 - T1	183.76N	246.55E	6986.00	N40 26 27.7080	W104 55 26.0400	1404028.45	3160351.58	8-Mar-2013
PS 1 - T2	229.98N	4499.56E	6986.00	N40 26 27.8880	W104 54 31.0320	1404074.66	3164604.43	8-Mar-2013

Survey Tool Program					
Reference	Survey Name	MD[ft]	TVD[ft]	Survey Tool	Error Model
5311	Planned	11671.91	6986.00	WdW Rate Gyro	Standard

Notes

All data is in Feet unless otherwise stated  
 Coordinates are from Slot MD's are from Rig and TVD's are from Rig ( Planned Datum #1 4953.0ft above Mean Sea Level )  
 Vertical Section is from 0.00N 0.00E on azimuth 87.070 degrees  
 Bottom hole distance is 4505.44 Feet on azimuth 87.07 degrees from Wellhead  
 Calculation method uses Minimum Curvature method  
 Prepared by Peterson Energy  
 Date Printed: 2-May-2013



SYSDRILL  
Closest Approach + Clearance Factor Summary Report  
Wellbore: Pavistma South 1 #1-5-32-090-4-NH (PWB)  
Wellpath: Pavistma South 1 #1-5-32-090-4-NH (PWP#1)

Ellipse separations are reported ONLY if BOTH wells have uncertainty data  
Only Depth and Magnetic Reference Field error terms are correlated across tie points  
Cutoff is calculated on CENTRE to CENTRE distance

Summary data uses Closest Approach clearance calculation for all minima  
Hole size/Casings ARE included  
Hole size/Casings are NOT subtracted from Centre-Centre distance  
Confidence limit of 95.00% / 2.80 SD.

Wellbore		
Name	Created	Last Revised
Pavistma South 1 #1-5-32-090-4-NH (PWB)	8-Mar-2013	2-May-2013

Well		
Name	Government ID	Last Revised
Pavistma South 1 #1-5-32-090-4-NH		8-Mar-2013

Slot						
Name	Grid Northing	Grid Easting	Latitude	Longitude	North	East
Slot #1	1403844.6909	3160105.0426	N40 26 25.9080	W104 55 29.2440	0.00N	0.00E

Installation					
Name	Easting	Northing	Coord System Name	North Alignment	
Pavistma South	3160105.0426	1403844.6909	CO83-NF on NORTH AMERICAN DATUM 1983 datum	Grid	

Field					
Name	Easting	Northing	Coord System Name	North Alignment	
Windsor Project	3162710.0707	1407271.6545	CO83-NF on NORTH AMERICAN DATUM 1983 datum	Grid	

Clearance Summary										
Offset WellName	Offset Wellbore	Offset Slot	Offset Structure	Separation [ft]	MD[ft]	Diverging From[ft]	Ellipse Separation [ft]	Ellipse MD[ft]	Clearance Factor	Clearance MD[ft]
Pavistma South 2 #1-5-32-09 0-4-CH	Pavistma South 2 #1-5-32-090-4 -CH (PWB)	Slot #2	Pavistma South	13.76	1000.66	1000.66	11.49	1000.66	4.74	11671.91
Pavistma South 3 #1-6-32-09 0-4-NH	Pavistma South 3 #1-6-32-090-4 -NH (PWB)	Slot #3	Pavistma South	32.09	984.25	984.25	29.83	1000.00	9.12	11671.91
Pavistma South 4 #1-7-32-09 0-4-CH	Pavistma South 4 #1-7-32-090-4 -CH (PWB)	Slot #4	Pavistma South	48.79	984.25	984.25	46.54	1000.66	16.80	11671.91
Pavistma South 5 #1-8-32-09 0-4-NH	Pavistma South 5 #1-8-32-090-4 -NH (PWB)	Slot #5	Pavistma South	62.54	984.25	984.25	60.28	1000.00	19.37	11671.91
FRYE FARMS 13 #5-5-32-09 0-6-CH	FRYE FARMS 13 #5-5-32-090-6 -CH (PWB)	Slot #13	Frye Farms	113.65	9677.03	9677.03	76.53	9678.48	3.06	9678.48
PAVISTMA 11-32	PAVISTMA 11-32 (AWB)	PAVISTMA 11-32	Pavistma (Anadarko)	114.93	8909.62	8909.62	50.39	8909.62	1.78	8909.62
PAVISTMA 12-32	PAVISTMA 12-32 (AWB)	PAVISTMA 12-32	Pavistma (Anadarko)	130.51	7587.36	7587.36	112.87	7587.36	7.37	7595.14
PAVISTMA 19-32	PAVISTMA 19-32 (AWB)	PAVISTMA 19-32	Pavistma (Anadarko)	206.43	1345.14	8252.28	201.93	1345.14	12.76	8366.14
CENTER POINT 5 #8-1-32-18	CENTER POINT 5 #8-1-32-180-4	Slot #5	Center Point	219.37	11671.91	11671.91	173.11	11671.91	4.74	11671.91

All data is in Feet unless otherwise stated  
Coordinates are from Slot MD's are from Rig and TVD's are from Rig ( Planned Datum #1 4953.0ft above Mean Sea Level )  
Vertical Section is from 0.00N 0.00E on azimuth 87.070 degrees  
Prepared by Peterson Energy  
Date Printed: 2-May-2013



SYSDRILL  
Closest Approach + Clearance Factor Summary Report  
Wellbore: Pavistma South 1 #1-5-32-090-4-NH (PWB)  
Wellpath: Pavistma South 1 #1-5-32-090-4-NH (PWP#1)

Clearance Summary										
Offset WellName	Offset Wellbore	Offset Slot	Offset Structure	Separation [ft]	MD[ft]	Diverging From[ft]	Ellipse Separation [ft]	Ellipse MD[ft]	Clearance Factor	Clearance MD[ft]
0-4-NH	-NH (PWB)									
FRYE FARM 7-5-32	FRYE FARM 7-5-32 (AWB)	FRYE FARMS #7-5-32	Frye Farms	452.96	9716.28	9716.28	391.19	9727.69	7.31	9744.09
PAVISTMA 5-3-32	PAVISTMA 5-3-32 (AWB)	PAVISTMA 5-3-32	Pavistma	459.70	0.00	8229.24	458.20	639.76	18.45	8415.35
PAVISTMA 4-2-32	PAVISTMA 4-2-32 (AWB)	PAVISTMA 4-2-32	Pavistma	477.77	0.00	7649.16	476.54	82.02	43.04	8480.97
PAVISTMA 5-1-32	PAVISTMA 5-1-32 (AWB)	PAVISTMA 5-1-32	Pavistma	492.00	153.99	6955.56	490.47	153.99	47.96	6463.25
FRYE FARMS 9 #1-5-33-09 0-4-NH	FRYE FARMS 9 #1-5-33-090-4 -NH (PWB)	Slot #9	Frye Farms	524.25	11671.91	11671.91	496.34	11671.91	18.78	11671.91
CENTER POINT 7 #0-1-33-18 0-4-NH	CENTER POINT 7 #0-1-33-180-4 -NH (PWB)	Slot #7	Center Point	530.29	11671.91	11671.91	483.95	11671.91	11.44	11671.91
FRYE FARMS 8 #1-5-33-09 0-4-NH	FRYE FARMS 8 #1-5-33-090-4 -NH (PWB)	Slot #8	Frye Farms	536.11	11671.91	11671.91	515.50	11671.91	26.01	11671.91
PAVISTMA 6 #1-4-32-09 0-4-NH	PAVISTMA 6 #1-4-32-090-4 -NH (PWB)	Slot #6	Pavistma	542.00	1000.66	11515.75	539.70	1035.20	7.97	11564.96
PAVISTMA 7 #1-4-32-09 0-8-CH	PAVISTMA 7 #1-4-32-090-8 -CH (PWB)	Slot #7	Pavistma	557.95	1000.66	11671.91	555.68	1000.66	11.53	11671.91
PAVISTMA 8 #1-3-32-09 0-4-NH	PAVISTMA 8 #1-3-32-090-4 -NH (PWB)	Slot #8	Pavistma	573.90	1000.66	11483.50	571.63	1000.66	13.18	11597.77
PAVISTMA 9 #1-3-32-09 0-4-NH	PAVISTMA 9 #1-3-32-090-4 -NH (PWB)	Slot #9	Pavistma	589.85	1000.66	1000.66	587.58	1000.66	17.22	11671.91
PAVISTMA 10 #1-3-32-09 0-8-CH	PAVISTMA 10 #1-3-32-090-8 -CH (PWB)	Slot #10	Pavistma	605.80	1000.66	11671.91	603.53	1000.66	19.16	11671.91
PAVISTMA 11 #1-3-32-09 0-4-NH	PAVISTMA 11 #1-3-32-090-4 -NH (PWB)	Slot #11	Pavistma	621.76	1000.66	11473.04	619.49	1000.66	21.20	11671.91
PAVISTMA 12 #1-2-32-09 0-4-NH	PAVISTMA 12 #1-2-32-090-4 -NH (PWB)	Slot #12	Pavistma	637.71	1000.66	11467.81	635.45	1000.66	25.19	11671.91
FRYE FARMS 10 #1-4-33-09 0-4-NH	FRYE FARMS 10 #1-4-33-090-4 -NH (PWB)	Slot #10	Frye Farms	685.60	11671.91	11671.91	644.85	11671.91	16.82	11671.91
FRYE FARMS 7 #1-6-33-09 0-4-NH	FRYE FARMS 7 #1-6-33-090-4 -NH (PWB)	Slot #7	Frye Farms	714.68	11671.91	11671.91	681.21	11671.91	21.36	11671.91

All data is in Feet unless otherwise stated  
Coordinates are from Slot MD's are from Rig and TVD's are from Rig ( Planned Datum #1 4953.0ft above Mean Sea Level )  
Vertical Section is from 0.00N 0.00E on azimuth 87.070 degrees  
Prepared by Peterson Energy  
Date Printed: 2-May-2013



SYSDRILL  
Closest Approach + Clearance Factor Summary Report  
Wellbore: Pavistma South 1 #1-5-32-090-4-NH (PWB)  
Wellpath: Pavistma South 1 #1-5-32-090-4-NH (PWP#1)

Clearance Summary										
Offset WellName	Offset Wellbore	Offset Slot	Offset Structure	Separation [ft]	MD[ft]	Diverging From[ft]	Ellipse Separation [ft]	Ellipse MD[ft]	Clearance Factor	Clearance MD[ft]
FRYE FARMS 6 #1-6-33-09 0-4-NH	FRYE FARMS 6 #1-6-33-090-4 -NH (PWB)	Slot #6	Frye Farms	969.87	11671.91	11671.91	929.73	11671.91	24.16	11671.91
FRYE FARMS 11 #1-4-33-09 0-4-NH	FRYE FARMS 11 #1-4-33-090-4 -NH (PWB)	Slot #11	Frye Farms	1003.07	11671.91	11671.91	956.97	11671.91	21.76	11671.91
Lind #13-32	Lind #13-32 (AWB)	Lind #13-32	Lind (Anadarko)	1186.66	7743.22	7743.22	1151.83	7726.38	31.88	7381.89
RANCHO WATER VALLEY 13 #7-6-33-27 0-6-CH	RANCHO WATER VALLEY 13 #7-6-33-270-6 -CH (PWB)	Slot #13	Rancho Water Valley	1198.03	11671.91	11671.91	1165.68	11671.91	37.04	11671.91
FRYE FARMS 12 #1-3-33-09 0-4-NH	FRYE FARMS 12 #1-3-33-090-4 -NH (PWB)	Slot #12	Frye Farms	1279.98	11671.91	11671.91	1233.12	11671.91	27.31	11671.91
Anderson #1	Anderson #1 (AWB)	Anderson #1	Anderson (J.K. Wadley)	1407.60	1000.66	1000.66	1406.01	836.61	249.33	9251.97
RANCHO WATER VALLEY 12 #7-7-33-27 0-4-NH	RANCHO WATER VALLEY 12 #7-7-33-270-4 -NH (PWB)	Slot #12	Rancho Water Valley	1571.19	11671.91	11671.91	1439.40	11671.91	11.92	11671.91
RANCHO WATER VALLEY 11 #7-7-33-27 0-6-CH	RANCHO WATER VALLEY 11 #7-7-33-270-6 -CH (PWB)	Slot #11	Rancho Water Valley	1713.79	11671.91	11671.91	1660.29	11671.91	32.04	11671.91
RANCHO WATER VALLEY 11 #7-7-33-27 0-6-CH	RANCHO WATER VALLEY 11 #7-7-33-270-6 -CH (AWB)	Slot #11	Rancho Water Valley	1720.67	11671.91	11671.91	1584.55	11671.91	12.64	11671.91
RANCHO WATER VALLEY 7 #7-8-33-27 0-5-CH	RANCHO WATER VALLEY 7 #7-8-33-270-5 -CH (PWB)	Slot #07	Rancho Water Valley	1757.82	11671.91	11671.91	1665.84	11671.91	19.11	11658.97
HILLSIDE 17 #3-1-33-09 0-4-NH	HILLSIDE 17 #3-1-33-090-4 -NH (PWB)	Slot #17	Hillside	1770.15	11671.91	11671.91	1708.08	11671.91	28.52	11671.91
FRYE FARMS #9-7-32	FRYE FARMS #9-7-32 (AWB)	FRYE FARMS #9-7-32	Frye Farms	1792.52	11194.29	11194.29	1744.14	11204.07	35.15	11671.91
FRYE FARMS #9-5-32	FRYE FARMS #9-5-32 (AWB)	FRYE FARMS #9-5-32	Frye Farms	1797.90	9884.63	9884.63	1738.30	9875.33	29.97	9727.69
RANCHO WATER VALLEY 10 #7-8-33-27 0-4-NH	RANCHO WATER VALLEY 10 #7-8-33-270-4 -NH (PWB)	Slot #10	Rancho Water Valley	1855.39	11671.91	11671.91	1798.44	11671.91	32.58	11671.91
RANCHO WATER	RANCHO WATER	Slot #06	Rancho	1920.65	11671.91	11671.91	1828.53	11671.91	20.85	11663.39

All data is in Feet unless otherwise stated  
Coordinates are from Slot MD's are from Rig and TVD's are from Rig ( Planned Datum #1 4953.0ft above Mean Sea Level )  
Vertical Section is from 0.00N 0.00E on azimuth 87.070 degrees  
Prepared by Peterson Energy  
Date Printed: 2-May-2013



SYSDRILL  
Closest Approach + Clearance Factor Summary Report  
Wellbore: Pavistma South 1 #1-5-32-090-4-NH (PWB)  
Wellpath: Pavistma South 1 #1-5-32-090-4-NH (PWP#1)

Clearance Summary										
Offset WellName	Offset Wellbore	Offset Slot	Offset Structure	Separation [ft]	MD[ft]	Diverging From[ft]	Ellipse Separation [ft]	Ellipse MD[ft]	Clearance Factor	Clearance MD[ft]
VALLEY 6 #0-7-4-270 -5-NH	VALLEY 6 #0-7-4-270-5- NH (PWB)		Water Valley							
HILLSIDE 18 #2-1-33-09 0-4-NH	HILLSIDE 18 #2-1-33-090-4 -NH (PWB)	Slot #18	Hillside	2082.81	11671.91	11671.91	2021.50	11671.91	33.97	11671.91
RAINDANCE CE 6 #1-2-32-09 0-4-CH	RAINDANCE 6 #1-2-32-090-4 -CH (PWB)	Slot #6	Raindance	2185.50	11456.07	11456.07	1957.17	11450.13	9.57	11433.73
HILLSIDE 15 #2-1-33-09 0-4-CH	HILLSIDE 15 #2-1-33-090-4 -CH (PWB)	Slot #15	Hillside	2244.45	11671.91	11671.91	2183.92	11671.91	37.08	11671.91
RAINDANCE CE 5 #1-2-32-09 0-4-NH	RAINDANCE 5 #1-2-32-090-4 -NH (PWB)	Slot #5	Raindance	2332.90	11455.81	11455.81	2103.17	11450.13	10.15	11433.73
HILLSIDE 14 #2-1-33-09 0-4-NH	HILLSIDE 14 #2-1-33-090-4 -NH (PWB)	Slot #14	Hillside	2402.72	11671.91	11671.91	2341.79	11671.91	39.43	11671.91
RANCHO WATER VALLEY 4 #7-1-4-270 -4-NH	RANCHO WATER VALLEY 4 #7-1-4-270-4- NH (PWB)	Slot #04	Rancho Water Valley	2619.51	11671.91	11671.91	2429.47	11671.91	13.78	11671.91
RAINDANCE CE 4 #1-1-32-09 0-4-NH	RAINDANCE 4 #1-1-32-090-4 -NH (PWB)	Slot #4	Raindance	2660.81	11451.60	11451.60	2431.37	11451.60	11.60	11466.54
CENTER POINT 2 #1-1-33-09 0-4-NH	CENTER POINT 2 #1-1-33-090-4 -NH (PWB)	Slot #2	Center Point	2746.02	11671.91	11671.91	2695.54	11671.91	54.40	11671.91
RAINDANCE CE 3 #1-1-32-09 0-4-CH	RAINDANCE 3 #1-1-32-090-4 -CH (PWB)	Slot #3	Raindance	2840.82	11451.29	11451.29	2612.71	11466.54	12.45	11500.00
HILLSIDE 2-4-32	HILLSIDE 2-4-32 (PWB)	HILLSIDE 2-4-32	Hillside	2862.44	8743.44	8743.44	2819.03	8776.25	58.09	9793.31
CENTER POINT 1 #1-1-33-09 0-4-CH	CENTER POINT 1 #1-1-33-090-4 -CH (PWB)	Slot #1	Center Point	2907.62	11671.91	11671.91	2856.05	11671.91	56.39	11671.91
RAINDANCE CE 2 #1-1-32-09 0-4-NH	RAINDANCE 2 #1-1-32-090-4 -NH	Slot #2	Raindance	2988.65	11450.13	11450.13	2759.87	11466.54	13.05	11532.15
CENTER POINT 3 #1-1-33-09 0-4-NH	CENTER POINT 3 #1-1-33-090-4 -NH (PWB)	Slot #3	Center Point	3067.22	11671.91	11671.91	3016.27	11671.91	60.20	11671.91
RANCHO WATER VALLEY 5 #7-2-4-270 -4-NH	RANCHO WATER VALLEY 5 #7-2-4-270-4- NH (PWB)	Slot #05	Rancho Water Valley	3176.10	11671.91	11671.91	2970.04	11671.91	15.41	11671.91

All data is in Feet unless otherwise stated  
Coordinates are from Slot MD's are from Rig and TVD's are from Rig ( Planned Datum #1 4953.0ft above Mean Sea Level )  
Vertical Section is from 0.00N 0.00E on azimuth 87.070 degrees  
Prepared by Peterson Energy  
Date Printed: 2-May-2013



SYSDRILL  
Closest Approach + Clearance Factor Summary Report  
Wellbore: Pavistma South 1 #1-5-32-090-4-NH (PWB)  
Wellpath: Pavistma South 1 #1-5-32-090-4-NH (PWP#1)

Clearance Summary										
Offset WellName	Offset Wellbore	Offset Slot	Offset Structure	Separation [ft]	MD[ft]	Diverging From[ft]	Ellipse Separation [ft]	Ellipse MD[ft]	Clearance Factor	Clearance MD[ft]
RAINDANCE 9 #1-0-32-090-4-NH	RAINDANCE 9 #1-0-32-090-4-NH (PWB)	Slot #9	Raindance	3263.81	11450.13	11450.13	3177.94	11466.54	37.45	11671.91
HILLSIDE 11 #0-7-28-000-4-CH	HILLSIDE 11 #0-7-28-000-4-CH (PWB)	Slot #11	Hillside	3279.02	11671.91	11671.91	3187.43	11671.91	35.80	11671.91
CENTER POINT 4 #1-0-33-090-4-NH	CENTER POINT 4 #1-0-33-090-4-NH (PWB)	Slot #4	Center Point	3299.71	11671.91	11671.91	3248.46	11671.91	64.38	11671.91
HILLSIDE 9 #7-7-29-000-4-CH	HILLSIDE 9 #7-7-29-000-4-NH (PWB)	Slot #9	Hillside	3371.82	11330.38	11330.38	3295.03	11368.11	42.49	11671.91
CENTER POINT 6 #1-0-33-090-4-CH	CENTER POINT 6 #1-0-33-090-4-CH (PWB)	Slot #6	Center Point	3412.25	11671.91	11671.91	3360.64	11671.91	66.12	11671.91
HILLSIDE 7 #7-7-29-000-4-CH	HILLSIDE 7 #7-7-29-000-4-CH (PWB)	Slot #7	Hillside	3414.06	11189.48	11189.48	3364.05	11220.47	63.72	11671.91
HILLSIDE 2 #5-7-29-000-4-CH	HILLSIDE 2 #5-7-29-000-4-CH (PWB)	Slot #2	Hillside	3419.90	9810.44	9810.44	3391.60	9842.52	95.43	11515.75
HILLSIDE 10 #8-7-29-000-4-CH	HILLSIDE 10 #8-7-29-000-4-NH (PWB)	Slot #10	Hillside	3426.27	11646.98	11646.98	3337.97	11671.91	38.76	11671.91
HILLSIDE 8 #7-7-29-000-4-CH	HILLSIDE 8 #7-7-29-000-4-NH (PWB)	Slot #8	Hillside	3429.99	11040.03	11040.03	3363.69	11072.83	48.47	11671.91
HILLSIDE 3 #5-7-29-000-4-CH	HILLSIDE 3 #5-7-29-000-4-NH (PWB)	Slot #3	Hillside	3433.86	10285.43	10285.43	3393.23	10318.24	72.33	11646.98
HILLSIDE 4 #5-7-29-000-4-CH	HILLSIDE 4 #5-7-29-000-4-NH (PWB)	Slot #4	Hillside	3435.99	9730.83	9730.83	3407.65	9760.50	97.61	11417.32
RAINDANCE 8 #1-0-32-090-4-CH	RAINDANCE 8 #1-0-32-090-4-CH (PWB)	Slot #8	Raindance	3438.68	11450.13	11450.13	3353.17	11466.54	39.56	11671.91
HILLSIDE 6 #6-7-29-000-4-CH	HILLSIDE 6 #6-7-29-000-4-CH (PWB)	Slot #6	Hillside	3457.13	10433.07	10433.07	3411.72	10465.88	66.36	11671.91
HILLSIDE 5 #6-7-29-000-4-CH	HILLSIDE 5 #6-7-29-000-4-NH (PWB)	Slot #5	Hillside	3460.48	10744.75	10744.75	3404.24	10777.56	55.97	11671.91
CENTER POINT 8 #1-0-33-090-4	CENTER POINT 8 #1-0-33-090-4	Slot #8	Center Point	3472.04	11671.91	11671.91	3420.11	11671.91	66.85	11671.91

All data is in Feet unless otherwise stated  
Coordinates are from Slot MD's are from Rig and TVD's are from Rig ( Planned Datum #1 4953.0ft above Mean Sea Level )  
Vertical Section is from 0.00N 0.00E on azimuth 87.070 degrees  
Prepared by Peterson Energy  
Date Printed: 2-May-2013



SYSDRILL  
Closest Approach + Clearance Factor Summary Report  
Wellbore: Pavistma South 1 #1-5-32-090-4-NH (PWB)  
Wellpath: Pavistma South 1 #1-5-32-090-4-NH (PWP#1)

Clearance Summary										
Offset WellName	Offset Wellbore	Offset Slot	Offset Structure	Separation [ft]	MD[ft]	Diverging From[ft]	Ellipse Separation [ft]	Ellipse MD[ft]	Clearance Factor	Clearance MD[ft]
0-4-NH	-NH (PWB)									
RAINDAN CE 7 #1-0-32-090-4-NH	RAINDANCE 7 #1-0-32-090-4-NH (PWB)	Slot #7	Raindance	3483.64	11443.89	11443.89	3398.10	11466.54	40.04	11671.91
RAINDAN CE 1 #1-1-32	RAINDANCE 1 #1-1-32 (PWB)	Slot #1	Raindance	3500.40	6840.55	6840.55	3487.04	6840.55	174.27	9973.75
Poudre #36-28	Poudre #36-28 (AWB)	Poudre #36-28	Poudre (Kerr-McGee Oil & Gas)	4594.88	11671.91	11671.91	4539.28	11671.91	82.63	11671.91
Poudre #14-28	Poudre #14-28 (AWB)	Poudre #14-28	Poudre (Kerr-McGee Oil & Gas)	4653.85	11671.91	11671.91	4613.34	11671.91	114.90	11671.91
RANCHO WATER VALLEY #2-6-4	RANCHO WATER VALLEY #2-6-4 (AWB)	Slot #03	Rancho Water Valley	4766.61	11671.91	11671.91	4706.29	11671.91	79.03	11671.91
Poudre #19-28	Poudre #19-28 (AWB)	Poudre #19-28	Poudre (Kerr-McGee Oil & Gas)	5087.26	11671.91	11671.91	5027.02	11671.91	84.45	11671.91
RANCHO WATER VALLEY 9 #8-7-33-000-4-CH	RANCHO WATER VALLEY 9 #8-7-33-000-4-CH (PWB)	Slot #09	Rancho Water Valley	5309.23	11671.91	11671.91	5217.87	11671.91	58.12	11671.91
Poudre #15-28	Poudre #15-28 (AWB)	Poudre #15-28	Poudre (Kerr-McGee Oil & Gas)	5409.80	11671.91	11671.91	5352.76	11671.91	94.84	11671.91
RANCHO WATER VALLEY 8 #8-7-33-000-4-NH	RANCHO WATER VALLEY 8 #8-7-33-000-4-NH (PWB)	Slot #08	Rancho Water Valley	5411.57	11671.91	11671.91	5372.82	11671.91	139.66	11671.91
Poudre #23-28	Poudre #23-28 (AWB)	Poudre #23-28	Poudre (Kerr-McGee Oil & Gas)	5564.73	11671.91	11671.91	5522.58	11671.91	132.02	11671.91
RANCHO WATER VALLEY #2-8-4	RANCHO WATER VALLEY 2-8-4 (AWB)	Slot #02	Rancho Water Valley	5870.66	11671.91	11671.91	5833.61	11671.91	158.47	11671.91
Poudre #11-28	Poudre #11-28 (AWB)	Poudre #11-28	Poudre (Kerr-McGee Oil & Gas)	5912.59	11671.91	11671.91	5859.58	11671.91	111.55	11671.91
Kodak 15 #7-4-28-270-4-NH	Kodak 15 #7-4-28-270-4-NH (PWB)	Slot #15	Kodak	6073.93	11671.91	11671.91	5983.19	11671.91	66.94	11671.91
Kodak 14 #7-4-28-270-4-CH	Kodak 14 #7-4-28-270-4-CH (PWB)	Slot #14	Kodak	6245.06	11671.91	11671.91	6154.19	11671.91	68.73	11671.91
Kodak 13 #7-4-28-270-4-NH	Kodak 13 #7-4-28-270-4-NH (PWB)	Slot #13	Kodak	6401.93	11671.91	11671.91	6310.85	11671.91	70.29	11671.91
Poudre #10-28	Poudre #10-28 (AWB)	Poudre #10-28	Poudre (Kerr-McGee Oil & Gas)	6464.14	11671.91	11671.91	6412.59	11671.91	125.40	11671.91
RANCHO	RANCHO	Slot #01	Rancho	6581.69	11671.91	11671.91	6533.90	11671.91	137.72	11671.91

All data is in Feet unless otherwise stated  
Coordinates are from Slot MD's are from Rig and TVD's are from Rig ( Planned Datum #1 4953.0ft above Mean Sea Level )  
Vertical Section is from 0.00N 0.00E on azimuth 87.070 degrees  
Prepared by Peterson Energy  
Date Printed: 2-May-2013



SYSDRILL  
Closest Approach + Clearance Factor Summary Report  
Wellbore: Pavistma South 1 #1-5-32-090-4-NH (PWB)  
Wellpath: Pavistma South 1 #1-5-32-090-4-NH (PWP#1)

Clearance Summary										
Offset WellName	Offset Wellbore	Offset Slot	Offset Structure	Separation [ft]	MD[ft]	Diverging From[ft]	Ellipse Separation [ft]	Ellipse MD[ft]	Clearance Factor	Clearance MD[ft]
WATER VALLEY #3-9-4	WATER VALLEY #3-9-4 (AWB)		Water Valley							
Poudre #25-28	Poudre #25-28 (AWB)	Poudre #25-28	Poudre (Kerr-McGee Oil & Gas)	6642.54	11671.91	11671.91	6588.84	11671.91	123.69	11671.91
Kodak 12 #7-3-28-27 0-4-NH	Kodak 12 #7-3-28-270-4 -NH (PWB)	Slot #12	Kodak	6730.11	11671.91	11671.91	6638.72	11671.91	73.64	11671.91
Kodak 11 #7-3-28-27 0-4-CH	Kodak 11 #7-3-28-270-4 -CH (PWB)	Slot #11	Kodak	6900.71	11671.91	11671.91	6809.21	11671.91	75.42	11671.91
Kodak 10 #7-3-28-27 0-4-NH	Kodak 10 #7-3-28-270-4 -NH (PWB)	Slot #10	Kodak	7058.48	11671.91	11671.91	6966.81	11671.91	76.99	11671.91
W Great Western #27-14	W Great Western #27-14 (AWB)	Great Western #27-14	Great Western (Great Western Oil & Gas)	7319.86	11671.91	11671.91	7296.68	11671.91	315.78	11671.91
Kodak 9 #7-2-28-27 0-4-NH	Kodak 9 #7-2-28-270-4 -NH (PWB)	Slot #9	Kodak	7386.97	11671.91	11671.91	7295.01	11671.91	80.33	11671.91
Kodak 8 #7-2-28-27 0-4-CH	Kodak 8 #7-2-28-270-4 -CH (PWB)	Slot #8	Kodak	7557.11	11671.91	11671.91	7465.07	11671.91	82.11	11671.91
Kodak 7 #7-2-28-27 0-4-NH	Kodak 7 #7-2-28-270-4 -NH (PWB)	Slot #7	Kodak	7715.56	11671.91	11671.91	7623.36	11671.91	83.68	11671.91
Kodak 6 #7-1-28-27 0-4-NH	Kodak 6 #7-1-28-270-4 -NH (PWB)	Slot #6	Kodak	8044.26	11671.91	11671.91	7951.80	11671.91	87.00	11671.91
Great Western 27-13	W #12 Great Western 27-13 (AWB)	Great Western #27-13	Great Western (Great Western Oil & Gas)	8167.78	11671.91	11671.91	8140.49	11671.91	299.37	11671.91
Kodak 5 #7-1-28-27 0-4-CH	Kodak 5 #7-1-28-270-4 -CH (PWB)	Slot #5	Kodak	8214.05	11671.91	11671.91	8121.51	11671.91	88.76	11671.91
W Great Western # 27-53	W Great Western # 27-53 (AWB)	Great Western # 27-53	Great Western (Great Western Oil & Gas)	8237.25	11671.91	11671.91	8213.32	11671.91	344.19	11671.91
Kodak 4 #7-1-28-27 0-4-NH	Kodak 4 #7-1-28-270-4 -NH (PWB)	Slot #4	Kodak	8373.09	11671.91	11671.91	8280.40	11671.91	90.34	11671.91
Kodak 3 #7-0-28-27 0-4-NH	Kodak 3 #7-0-28-270-4 -NH (PWB)	Slot #3	Kodak	8701.99	11671.91	11671.91	8609.06	11671.91	93.64	11671.91
W Great Western #27-23	W Great Western #27-23 (AWB)	Great Western #27-23	Great Western (Great Western Oil & Gas)	8777.89	11671.91	11671.91	8753.85	11671.91	365.13	11671.91
Kodak 2 #7-0-28-27	Kodak 2 #7-0-28-270-4	Slot #2	Kodak	8871.46	11671.91	11671.91	8778.46	11671.91	95.39	11671.91

All data is in Feet unless otherwise stated  
Coordinates are from Slot MD's are from Rig and TVD's are from Rig ( Planned Datum #1 4953.0ft above Mean Sea Level )  
Vertical Section is from 0.00N 0.00E on azimuth 87.070 degrees  
Prepared by Peterson Energy  
Date Printed: 2-May-2013



SYSDRILL  
Closest Approach + Clearance Factor Summary Report  
Wellbore: Pavistma South 1 #1-5-32-090-4-NH (PWB)  
Wellpath: Pavistma South 1 #1-5-32-090-4-NH (PWP#1)

Clearance Summary										
Offset WellName	Offset Wellbore	Offset Slot	Offset Structure	Separation [ft]	MD[ft]	Diverging From[ft]	Ellipse Separation [ft]	Ellipse MD[ft]	Clearance Factor	Clearance MD[ft]
0-4-CH	-CH (PWB)									
Kodak 1 #7-8-21-27 0-4-NH	Kodak 1 #7-8-21-270-4 -NH (PWB)	Slot #1	Kodak	9030.92	11671.91	11671.91	8937.77	11671.91	96.94	11671.91
W Great Western #27-12	W Great Western #27-12 (AWB)	Great Western #27-12	Great Western 66N67W	9097.50	11671.91	11671.91	9067.19	11671.91	300.11	11671.91
DIAMOND VALLEY SW 9-5-22	DIAMOND VALLEY SW 1 #4-7-22-270-6 -NH (PWB #2)	Slot #1	Diamond Valley SW	9359.83	11671.91	11671.91	9257.96	11671.91	91.88	11671.91
DIAMOND VALLEY SW 2	DIAMOND VALLEY SW 2 #4-7-22-270-6 -CH (PWB #2)	Slot #2	Diamond Valley SW	9527.90	11671.91	11671.91	9425.93	11671.91	93.44	11671.91
DIAMOND VALLEY SW 9-5-22	DIAMOND VALLEY SW 1 #4-7-22-270-6 -NH (PWB)	Slot #1	Diamond Valley SW	9562.85	11671.91	11671.91	9460.87	11671.91	93.77	11671.91
DIAMOND VALLEY SW 3	DIAMOND VALLEY SW 3 #4-7-22-270-6 -NH (PWB #2)	Slot #3	Diamond Valley SW	9688.47	11671.91	11671.91	9586.39	11671.91	94.91	11671.91
DIAMOND VALLEY SW 2	DIAMOND VALLEY SW 2 #3-7-22-270-6 -CH (PWB)	Slot #2	Diamond Valley SW	9733.87	11671.91	11671.91	9631.90	11671.91	95.46	11671.91
DIAMOND VALLEY SW 3	DIAMOND VALLEY SW 3 #3-6-22-270-6 -NH (PWB)	Slot #3	Diamond Valley SW	9893.42	11671.91	11671.91	9791.22	11671.91	96.80	11671.91
W Great Western #27-22	W Great Western #27-22 (AWB)	Great Western #27-22	Great Western 66N67W	9933.74	11671.91	11671.91	9907.22	11671.91	374.66	11671.91
DIAMOND VALLEY SW 4	DIAMOND VALLEY SW 4 #4-6-22-270-6 -NH (PWB #2)	Slot #4	Diamond Valley SW	10017.62	11671.91	11671.91	9915.35	11671.91	97.95	11671.91
W Great Western #27-52	W Great Western #27-52 (AWB)	Great Western #27-52	Great Western 66N67W	10025.67	11671.91	11671.91	9995.49	11671.91	332.16	11671.91
W Great Western #27-11	W Great Western #27-11 (AWB)	Great Western #27-11	Great Western 66N67W	10116.40	11671.91	11671.91	10083.87	11671.91	311.00	11671.91
DIAMOND VALLEY SW 8-2-22	DIAMOND VALLEY SW 5 #4-6-22-270-6 -CH (PWB)	Slot #5	Diamond Valley SW	10186.44	11671.91	11671.91	10084.10	11671.91	99.54	11671.91

All data is in Feet unless otherwise stated  
Coordinates are from Slot MD's are from Rig and TVD's are from Rig ( Planned Datum #1 4953.0ft above Mean Sea Level )  
Vertical Section is from 0.00N 0.00E on azimuth 87.070 degrees  
Prepared by Peterson Energy  
Date Printed: 2-May-2013



SYSDRILL  
Closest Approach + Clearance Factor Summary Report  
Wellbore: Pavistma South 1 #1-5-32-090-4-NH (PWB)  
Wellpath: Pavistma South 1 #1-5-32-090-4-NH (PWP#1)

Clearance Summary										
Offset WellName	Offset Wellbore	Offset Slot	Offset Structure	Separation [ft]	MD[ft]	Diverging From[ft]	Ellipse Separation [ft]	Ellipse MD[ft]	Clearance Factor	Clearance MD[ft]
#2)										
DIAMOND VALLEY SW 4	DIAMOND VALLEY SW 4 #3-6-22-270-6-NH (PWB)	Slot #4	Diamond Valley SW	10220.40	11671.91	11671.91	10118.00	11671.91	99.81	11671.91
DIAMOND VALLEY SW 6	DIAMOND VALLEY SW 6 #4-6-22-270-6-NH (PWB #2)	Slot #6	Diamond Valley SW	10346.73	11671.91	11671.91	10244.28	11671.91	100.99	11671.91
DIAMOND VALLEY SW 8-2-22	DIAMOND VALLEY SW 5 #3-6-22-270-6-CH (PWB)	Slot #5	Diamond Valley SW	10391.75	11671.91	11671.91	10289.33	11671.91	101.46	11671.91
DIAMOND VALLEY SW 6	DIAMOND VALLEY SW 6 (PWB)	Slot #6	Diamond Valley SW	10551.08	11671.91	11671.91	10448.48	11671.91	102.83	11671.91
DIAMOND VALLEY SW 7	DIAMOND VALLEY SW 7 #4-5-22-270-6-NH (PWB #2)	Slot #7	Diamond Valley SW	10675.93	11671.91	11671.91	10573.25	11671.91	103.97	11671.91
DIAMOND VALLEY SW 8	DIAMOND VALLEY SW 8 #4-5-22-270-6-CH (PWB #2)	Slot #8	Diamond Valley SW	10844.51	11671.91	11671.91	10741.75	11671.91	105.53	11671.91
DIAMOND VALLEY SW 7	DIAMOND VALLEY SW 7 #3-5-22-270-6-NH (PWB)	Slot #7	Diamond Valley SW	10882.00	11671.91	11671.91	10779.29	11671.91	105.95	11671.91
W Great Western #27-21	W Great Western #27-21 (AWB)	Great Western #27-21	Great Western 66N67W	10965.57	11671.91	11671.91	10937.77	11671.91	394.46	11671.91
Great Western 27-31-8	Great Western 27-31-8 (AWB)	Great Western 27-31-8	Great Western Diamond Valley	10966.37	11671.91	11671.91	10938.65	11671.91	395.61	11671.91
DIAMOND VALLEY SW 8	DIAMOND VALLEY SW 8 #3-5-22-270-6-CH PWB)	Slot #8	Diamond Valley SW	10994.98	11671.91	11671.91	10892.23	11671.91	107.01	11671.91
DIAMOND VALLEY SW 9	DIAMOND VALLEY SW 9 #4-5-22-270-6-NH (PWB #2)	Slot #9	Diamond Valley SW	11005.13	11671.91	11671.91	10902.26	11671.91	106.98	11671.91
DIAMOND VALLEY SW 9	DIAMOND VALLEY SW 9 #3-4-22-270-6-NH (PWB)	Slot #9	Diamond Valley SW	11209.15	11671.91	11671.91	11106.15	11671.91	108.83	11671.91

All data is in Feet unless otherwise stated  
Coordinates are from Slot MD's are from Rig and TVD's are from Rig ( Planned Datum #1 4953.0ft above Mean Sea Level )  
Vertical Section is from 0.00N 0.00E on azimuth 87.070 degrees  
Prepared by Peterson Energy  
Date Printed: 2-May-2013



SYSDRILL  
Closest Approach + Clearance Factor Summary Report  
Wellbore: Pavistma South 1 #1-5-32-090-4-NH (PWB)  
Wellpath: Pavistma South 1 #1-5-32-090-4-NH (PWP#1)

Clearance Summary										
Offset WellName	Offset Wellbore	Offset Slot	Offset Structure	Separation [ft]	MD[ft]	Diverging From[ft]	Ellipse Separation [ft]	Ellipse MD[ft]	Clearance Factor	Clearance MD[ft]
DIAMOND VALLEY SW 8-2-22	DIAMOND VALLEY SW 8-2-22 (PWB)	Slot #5	Diamond Valley SW	11216.12	11671.91	11671.91	11151.61	11671.91	173.87	11671.91
DIAMOND VALLEY SW 10	DIAMOND VALLEY SW 10 #3-4-22-270-6-NH (PWB)	Slot #10	Diamond Valley SW	11540.20	11671.91	11671.91	11437.12	11671.91	111.96	11671.91
Great Western 27-21-3	Great Western 27-21-3 (AWB)	Great Western 27-21-3	Great Western Diamond Valley	11891.94	11671.91	11671.91	11861.99	11671.91	397.12	11671.91
DIAMOND VALLEY SW 2	DIAMOND VALLEY SW 8-4-22 (PWB)	Slot #2	Diamond Valley SW	11985.52	11671.91	11671.91	11949.74	11671.91	335.04	11671.91
DIAMOND VALLEY SW 7	DIAMOND VALLEY SW 7-3-22 (PWB)	Slot #7	Diamond Valley SW	12128.84	11671.91	11671.91	12072.18	11671.91	214.07	11671.91
DIAMOND VALLEY SW 8	DIAMOND VALLEY SW 6-2-22 (PWB)	Slot #8	Diamond Valley SW	12284.15	11671.91	11671.91	12207.82	11671.91	160.93	11671.91
Diamond Valley 22-34	Diamond Valley 22-34 (AWB)	Diamond Valley 22-34	Great Western Diamond Valley	12759.23	11671.91	11671.91	12729.49	11671.91	428.97	11671.91
Great Western 27-31-2	Great Western 27-31-2 (AWB)	Great Western 27-31-2	Great Western Diamond Valley	12804.25	11671.91	11671.91	12776.31	11671.91	458.26	11671.91
Diamond Valley 22-23-18	Diamond Valley 22-23-18 (AWB)	Diamond Valley 22-23-18	Great Western Diamond Valley	12909.63	11671.91	11671.91	12877.89	11671.91	406.74	11671.91
DIAMOND VALLEY SW 10	DIAMOND VALLEY SW 6-4-22 (PWB)	Slot #10	Diamond Valley SW	12973.45	11671.91	11671.91	12926.07	11671.91	273.81	11671.91
Great Western 27-41-10	Great Western 27-41-10 (AWB)	Great Western 27-41-10	Great Western Diamond Valley	13005.42	11671.91	11671.91	12981.75	11671.91	549.32	11671.91
Diamond Valley 22-54	Diamond Valley 22-54 (AWB)	Diamond Valley 22-54	Great Western Diamond Valley	13625.81	11671.91	11671.91	13596.93	11671.91	471.70	11671.91
Diamond Valley 22-22-13	Diamond Valley 22-22-13 (AWB)	Diamond Valley 22-22-13	Great Western Diamond Valley	13669.12	11671.91	11671.91	13640.97	11671.91	485.45	11671.91
Diamond Valley 22-44	Diamond Valley 22-44 (AWB)	Diamond Valley 22-44	Great Western Diamond Valley	13720.38	11671.91	11671.91	13692.88	11671.91	498.85	11671.91
Diamond Valley 22-33	Diamond Valley 22-33 (AWB)	Diamond Valley 22-33	Great Western Diamond Valley	13731.85	11671.91	11671.91	13703.21	11671.91	479.39	11671.91
Great Western	Great Western 27-41-1	Great Western	Great Western Diamond	13762.50	11671.91	11671.91	13736.41	11671.91	527.60	11671.91

All data is in Feet unless otherwise stated  
Coordinates are from Slot MD's are from Rig and TVD's are from Rig ( Planned Datum #1 4953.0ft above Mean Sea Level )  
Vertical Section is from 0.00N 0.00E on azimuth 87.070 degrees  
Prepared by Peterson Energy  
Date Printed: 2-May-2013



SYSDRILL  
Closest Approach + Clearance Factor Summary Report  
Wellbore: Pavistma South 1 #1-5-32-090-4-NH (PWB)  
Wellpath: Pavistma South 1 #1-5-32-090-4-NH (PWP#1)

Clearance Summary										
Offset WellName	Offset Wellbore	Offset Slot	Offset Structure	Separation [ft]	MD[ft]	Diverging From[ft]	Ellipse Separation [ft]	Ellipse MD[ft]	Clearance Factor	Clearance MD[ft]
27-41-1	(AWB)	27-41-1	Valley							
Diamond Valley 22-32-12	Diamond Valley 22-32-12 (AWB)	Diamond Valley 22-32-12	Great Western Diamond Valley	13907.99	11671.91	11671.91	13881.13	11671.91	517.85	11671.91
Diamond Valley 22-43	Diamond Valley 22-43 (AWB)	Diamond Valley 22-43	Great Western Diamond Valley	13985.46	11671.91	11671.91	13958.98	11671.91	528.07	11671.91