

# T6S, R95W, 6th P.M.

19942 SHERIDAN  
PLACER No. 4

19942 SHERIDAN  
PLACER No. 5

19942 SHERIDAN  
PLACER No. 6

19942 SHERIDAN  
PLACER No. 7

19942 SHERIDAN  
PLACER No. 8

N89°53'W - 5286.60' (G.L.O.)

1921 Brass Cap  
1.2' High  
Lot: 39.532097  
Long: 108.013072

LINE TABLE		
LINE	BEARING	LENGTH
LS	S89°57'16"W	66.00'

N00°03'W - 2640.00' (G.L.O.)

1921 Brass Cap  
1.2' High  
Lot: 39.524914  
Long: 108.031792

19837 LA PAZ  
No. 9 PLACER

EXXONMOBIL  
AP 323-17-695  
TARGET BOTTOM HOLE

Lot 2

Lot 1

19837 LA PAZ  
No. 11 PLACER

19837 LA PAZ  
No. 10 PLACER

NOTE:  
A LINE BETWEEN THE SW CORNER OF  
SECTION 17, T6S, R95W, 6th P.M. &  
LA PAZ PLACER 10 CORNER #4 BEARS  
S76°20'29"E 2591.68'.

N00°04'53"W - 2643.34' (Meas.)

N00°01'50"W - 5261.11' (Meas.)

WC 1921 Brass  
Cap 1.0' High,  
Pile of Stones  
Lot: 39.517658  
Long: 108.013317

EXXONMOBIL  
AP 323-17-695  
SURFACE LOCATION

1921 Brass Cap  
1.4' High, Steel Post  
Lot: 39.517661  
Long: 108.031786

## LEGEND:

- 90° SYMBOL
- PROPOSED WELL HEAD.
- SECTION CORNERS LOCATED.
- SECTION CORNERS RE-ESTAB.  
(Not Set on Ground)

LA PAZ PLACER 10  
Corner #4 (19837),  
Steel Cap, 1.5" Pipe  
Lot: 39.515975  
Long: 108.022864

NAD 83 (TARGET BOTTOM HOLE)  
LATITUDE = 39°31'26.39" (39.523997)  
LONGITUDE = 108°01'33.87" (108.026075)

STATE PLANE-(COLO. CENTRAL-NAD 83)  
N = 1625651.200  
E = 2287516.100

## WILLIAMS PRODUCTION RMT COMPANY

Well location, EXXONMOBIL AP 323-17-695  
(TARGET BOTTOM HOLE), located as shown in  
19837 LA PAZ No.1 Placer of Section 17, T6S,  
R95W, 6th P.M., Garfield County, Colorado.

### BASIS OF ELEVATION

SPOT ELEVATION AT THE NORTHWEST CORNER OF SECTION  
30, T6S, R95W, 6th P.M. TAKEN FROM THE FORKED GULCH  
QUADRANGLE, COLORADO, GARFIELD COUNTY, 7.5 MINUTE  
SERIES (TOPOGRAPHICAL MAP) PUBLISHED BY THE UNITED  
STATES DEPARTMENT OF THE INTERIOR, GEOLOGICAL SURVEY.  
SAID ELEVATION IS MARKED AS BEING 5966 FEET.

### BASIS OF BEARINGS

BASIS OF BEARINGS IS A G.P.S. OBSERVATION.

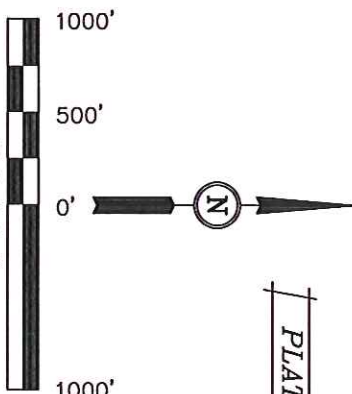

### CERTIFICATE

THIS IS TO CERTIFY THAT THE ABOVE PLAT WAS PREPARED AND  
LOCATION AS SHOWN WAS TAKEN ON THE GROUND FROM FIELD  
NOTES OF ACTUAL SURVEYS MADE BY ME OR UNDER MY  
SUPERVISION AND THAT THE SAME ARE TRUE AND CORRECT TO  
THE BEST OF MY KNOWLEDGE AND BELIEF.

REGISTERED AND SURVEYOR  
REGISTRATION NO. 17492  
STATE OF COLORADO

Revised: 09-26-11 D.R.B.

UTAH ENGINEERING & LAND SURVEYING

85 SOUTH 200 EAST - VERNAL, UTAH 84078

(435) 789-1017

SCALE  
1" = 1000'

DATE SURVEYED: 04-28-10 DATE DRAWN: 03-17-11

PARTY

B.B.

B.U.

D.R.B.

REFERENCES

G.L.O. PLAT

WEATHER

COOL

FILE

WILLIAMS PRODUCTION RMT COMPANY



T6S, R95W, 6th P.M.

WILLIAMS PRODUCTION RMT COMPANY

Well location, EXXONMOBIL AP 323-17-695 (SURFACE LOCATION), located as shown in 19837 LA PAZ No.10 Placer of Section 20, T6S, R95W, 6th P.M., Garfield County, Colorado.

BASIS OF ELEVATION

SPOT ELEVATION AT THE NORTHWEST CORNER OF SECTION 30, T5S, R95W, 6th P.M. TAKEN FROM THE FORKED GULCH QUADRANGLE, COLORADO, GARFIELD COUNTY, 7.5 MINUTE SERIES (TOPOGRAPHICAL MAP) PUBLISHED BY THE UNITED STATES DEPARTMENT OF THE INTERIOR, GEOLOGICAL SURVEY. SAID ELEVATION IS MARKED AS BEING 5966 FEET.

BASIS OF BEARINGS

BASIS OF BEARINGS IS A G.P.S. OBSERVATION.

NOTE: SEE CURRENT FOOTAGE PLAT #6 FOR EXISTING IMPROVEMENT WITHIN 400' OF THE PROPOSED WELL DISTURBANCE.



CERTIFICATE

THIS IS TO CERTIFY THAT THE ABOVE PLAT WAS PREPARED AND LOCATION AS SHOWN WAS STAKED ON THE GROUND FROM FIELD NOTES OF ACTUAL SURVEYS MADE BY ME OR UNDER MY SUPERVISION AND THAT THE SAME ARE TRUE AND CORRECT TO THE BEST OF MY KNOWLEDGE AND BELIEF.

Revised: 09-26-11 D.R.B.

WC 1921 Brass  
Cap 1.2' High  
Lat: 39.502167°  
Long: 108.013114°

REGISTERED LAND SURVEYOR  
REGISTRATION NO. 17492  
STATE OF COLORADO  
10-09-2011

UNTAH ENGINEERING & LAND SURVEYING

85 SOUTH 200 EAST - VERNAL, UTAH 84078  
(435) 789-1017

SCALE 1" = 1000'  
DATE SURVEYED: 04-28-10  
DATE DRAWN: 03-17-11

PARTY B.B. B.J. D.R.B. G.L.O. PLAT  
REFERENCES

WEATHER COOL FILE  
WILLIAMS PRODUCTION RMT COMPANY

WC 1921 Brass Cap  
1.0' High, File  
of Stones  
Lat: 39.517658°  
Long: 108.013317°

EXXONMOBIL

AP 323-17-695

Elev. Ungrazed Ground = 6909.0'

LA PAZ PLACER 10  
Corner #3 (19837)  
Steel Cap, 1.5" Pipe  
Lat: 39.515992°  
Long: 108.020526°  
LA PAZ PLACER 10  
Corner #4 (19837)  
Steel Cap, 1.5" Pipe  
Lat: 39.515975°  
Long: 108.022864°

NOTE: THE PROPOSED BOTTOM HOLE FOR THIS WELL IS LOCATED IN 19837 LA PAZ No. 1 PLACER OF SECTION 17, T6S, R95W, 6th P.M. AT A DISTANCE OF 2310' FSL 1613' FWL. IT BEARS N20°37'09"W 2485.58' FROM THE PROPOSED WELL HEAD.

LINE	BEARING	LENGTH
L1	N00°12'34"W	198.17'
L2	N00°01'10"E	118.31'
L3	S89°37'52"W	253.21'
L4	N00°05'21"E	66.00'
L5	S89°57'16"W	66.00'
L6	N87°55'56"E	200.68'
L7	S89°44'21"W	184.35'
L8	S89°44'21"W	2634.02'
L9	S88°31'24"W	2639.05'
L10	S00°04'13"W	1989.28'
L11	S89°25'25"W	660.12'

20

LA PAZ PLACER 10  
Corner #5 (19837)  
Steel Cap, 1.5" Pipe  
Lat: 39.510514°  
Long: 108.022881°  
LA PAZ PLACER 10  
Corner #6 (19837)  
Steel Cap, 1.5" Pipe  
Lat: 39.510353°  
Long: 108.032228°

19837 LA PAZ  
No. 10 PLACER

1921 Brass Cap  
1.5" High, Steel Post  
Lat: 39.510417°  
Long: 108.031772°

1921 Brass Cap  
1.4' High, Steel Post  
Lat: 39.517661°  
Long: 108.031786°

S89°57'16"W -  
5278.27' (Meas.)

2485'

19837 LA PAZ  
No. 11 PLACER

NOTE: A LINE BETWEEN THE NW CORNER OF SECTION 20, T6S, R95W, 6th P.M. & LA PAZ PLACER 10 CORNER #4 BEARS S76°20'29"E 2591.68'.

19837 LA PAZ  
No. 12 PLACER

L9

Lot 4

Lot 5

Lot 7

Lot 6

Lot 8

Lot 9

Section Corner  
Re-Established by  
Single Proportion  
Method. (Not Set)

S 1/4 Cor.  
Sec. 19  
True Position

— S89°44'21"W - 2671.76' (Meas.) -  
1921 Brass Cap  
1.2' High, File  
of Stones  
Lat: 39.502486°  
Long: 108.022417°

1921 Brass Cap  
1.2' High, File  
of Stones  
Lat: 39.502506°  
Long: 108.021706°

WC 1921 Brass Cap  
1.2' High, Steel Post  
Lat: 39.501953°  
Long: 108.012214°

True Position

True Position

True Position

True Position

True Position

LEGEND:

— = 90° SYMBOL

● = PROPOSED WELL HEAD.

▲ = SECTION CORNERS LOCATED.

△ = SECTION CORNERS RE-ESTAB.

(Not Set on Ground)

PDOP = 5.9

NAD 83 (SURFACE LOCATION)

LATITUDE = 39°31'03.40" (39.517611)

LONGITUDE = 108°01'22.73" (108.022981)

STATE PLANE-COLO. CENTRAL-NAD 83

N = 1623301.402  
E = 2288323.985