

# CONSTRUCTION LAYOUT DRAWING

1 of 2

PAD 300'X300' ELEV= 4917.5'

DISTURBED AREA=3.1± ACRES

ESTIMATED DIRT QUANTITIES

CUTx10%	FILL	PIT	TOPSOIL	EXCESS
5,300	3,460	2,590	1,820	20

NOTE: VOLUMES IN CUBIC YARDS. TOPSOIL INCLUDED IN VOLUMES AT A DEPTH OF 6". PIT NOT INCLUDED IN TOTAL EXCESS.

VEGETATION:  
PASTURE

SURFACE USE:  
GRAZING

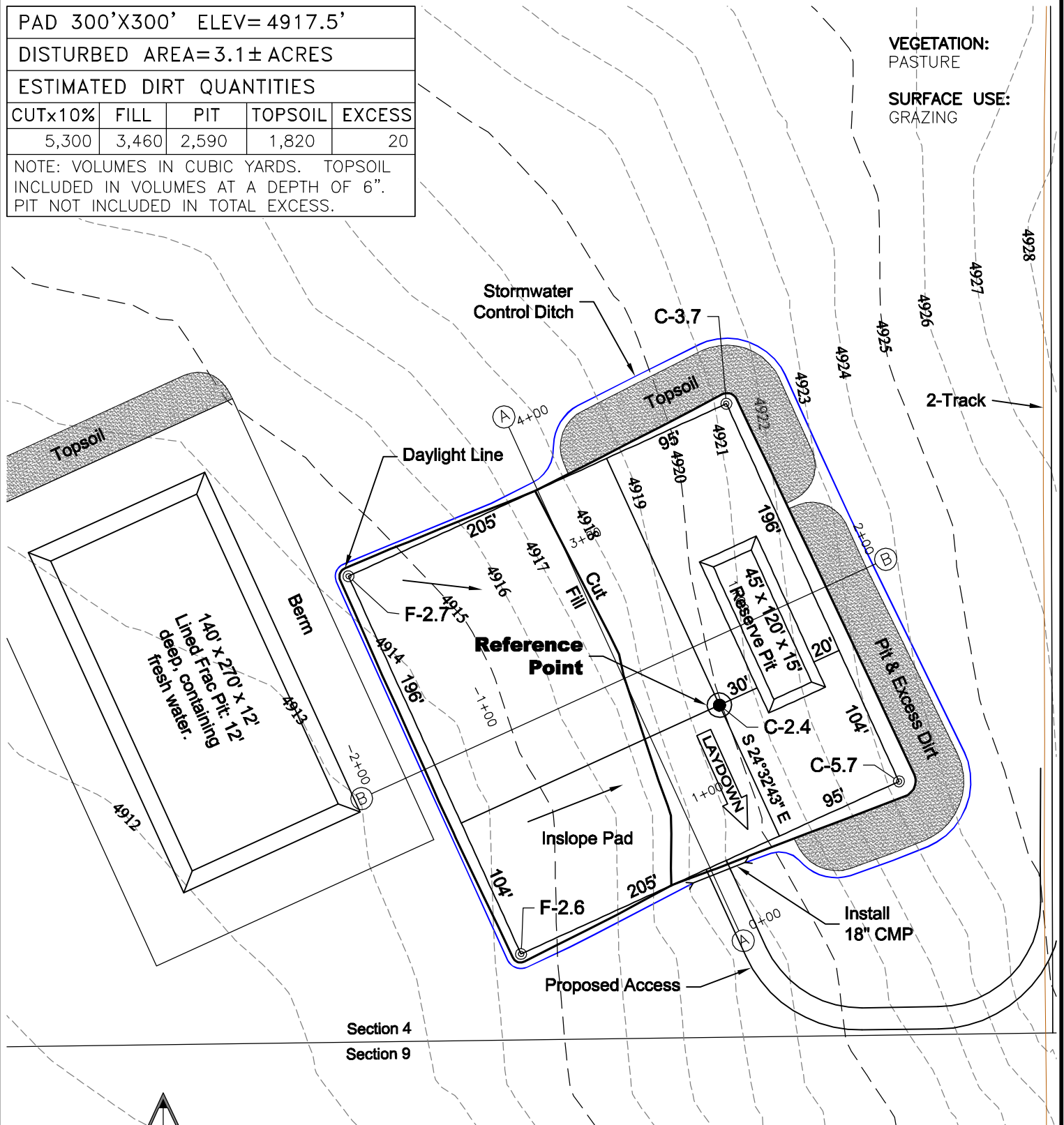

Section 4

Section 9

NOTE:

10% ALLOWANCE IS MADE FOR SOIL EXPANSION.

3/21/11



North

0 100 200

Graphic Scale in Feet  
1 inch = 100 feet



**GEO  
SURV**

LAND SURVEYING AND MAPPING  
LAFAYETTE - WINTER PARK  
Ph 303 666 0379 Fx 303 665 6320

**CARRIZO OIL & GAS, INC**  
**PERGAMOS 4-44-7-60 PAD**

**SE1/4 SE1/4 SEC. 4 T7N R60W**  
**6th PM WELD COUNTY COLORADO**

# CONSTRUCTION LAYOUT DRAWING

2 of 2

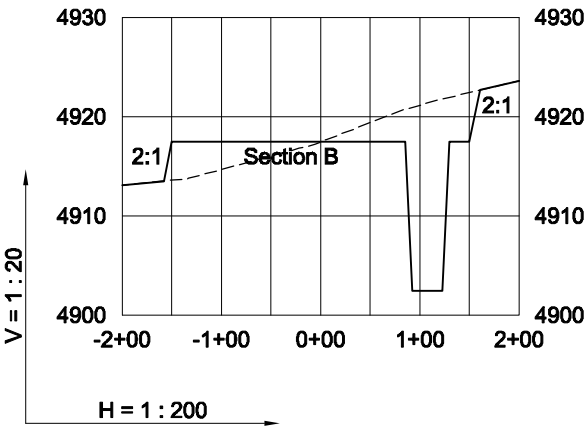
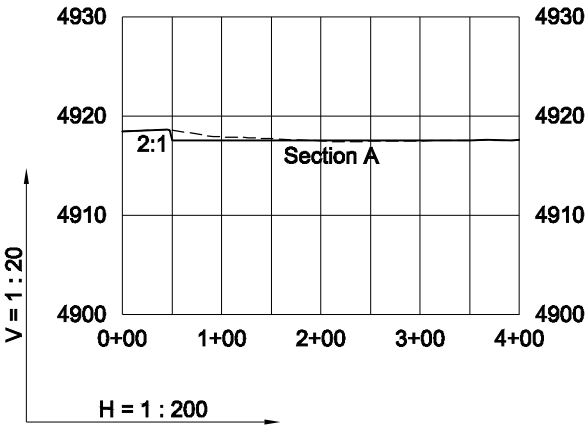

3/21/11

----- Existing Ground  
----- Proposed Grade

  
LAND SURVEYING AND MAPPING  
LAFAYETTE - WINTER PARK  
Ph 303 666 0379 Fx 303 665 6320

**CARRIZO OIL & GAS, INC**  
**PERGAMOS 4-44-7-60 PAD**

**SE1/4 SE1/4 SEC. 4 T7N R60W**  
**6th PM WELD COUNTY COLORADO**